

C1 52429

SEQUENCE NO. (MDE USE ONLY)

STATE OF MARYLAND WELL COMPLETION REPORT

THIS REPORT MUST BE SUBMITTED WITHIN 45 DAYS AFTER WELL IS COMPLETED.

(THIS NUMBER IS TO BE PUNCHED IN COLS. 3-6 ON ALL CARDS)

COUNTY NUMBER

ST/CO USE ONLY DATE Received

DATE WELL COMPLETED

Depth of Well

PERMIT NO. FROM "PERMIT TO DRILL WELL"

09/11/17

06/13/17

350

12/4/17 HO-17-0115

OWNER: Elm Street Development; WELL SITE ADDRESS: HAULAND MILL RD; TOWN: CLARKSVILLE; SUBDIVISION: Mill Creek; SECTION: ; LOT: 18

WELL LOG table with columns: DESCRIPTION, FEET (FROM, TO), check if water bearing. Includes entries for Soil, Brown shale, Med Gray Rock, and Well #1 - 500' Dry (Backfilled).

GROUTING RECORD section including: WELL HAS BEEN GROUTED (Y), TYPE OF GROUTING MATERIAL (CM), CEMENT (18 bags), BENTONITE CLAY (BC), NO. OF BAGS (18), NO. OF POUNDS (1350), GALLONS OF WATER (90), DEPTH OF GROUT SEAL (0 to 45 ft).

CASING RECORD section including: casing types (ST, CO, PL, OT), MAIN CASING TYPE (PL), Nominal diameter (6 inches), Total depth of main casing (45 feet).

OTHER CASING (if used) section with columns for diameter and depth.

SCREEN RECORD section including: screen type (ST, BR, HO, PL, OT), DEPTH (45, 350).

NUMBER OF UNSUCCESSFUL WELLS: 1; WELL HYDROFRACTURED: Y

CIRCLE APPROPRIATE LETTER: A (Well abandoned and sealed), E (Electric log obtained), P (Test well converted to production well)

I HEREBY CERTIFY THAT THIS WELL HAS BEEN CONSTRUCTED IN ACCORDANCE WITH COMAR 26.04.04 "WELL CONSTRUCTION" AND IN CONFORMANCE WITH ALL CONDITIONS STATED IN THE ABOVE CAPTIONED PERMIT...

DRILLERS LIC. NO. MD 355; DRILLERS SIGNATURE; LIC. NO. WRD 113

SITE SUPERVISOR (sign. of driller or journeyman responsible for sitework if different from permittee)

C2 DEPTH (nearest ft.) table with columns 1-21 and values 45, 350

GRAVEL PACK IF WELL DRILLED WAS FLOWING WELL INSERT F IN BOX 68

MDE USE ONLY (NOT TO BE FILLED IN BY DRILLER) section with fields T, W, Q, 70, 72, 74-76, TELESCOPE CASING, LOG INDICATOR, OTHER DATA

C3 PUMPING TEST section including: HOURS PUMPED (6), PUMPING RATE (2.0 gal. per min.), METHOD USED TO MEASURE PUMPING RATE (Submersible), WATER LEVEL (50 ft. before, 140 ft. when pumping), TYPE OF PUMP USED (S submersible)

PUMP INSTALLED section including: DRILLER INSTALLED PUMP (YES), TYPE OF PUMP INSTALLED (S), CAPACITY: GALLONS PER MINUTE, PUMP HORSE POWER, PUMP COLUMN LENGTH, CASING HEIGHT (+ above, - below), LAND SURFACE

LATITUDE 39.18446; LONGITUDE 76.99953; (DEFAULT COORD. WGS 84)

Pursuant to §10-624 of the State Govt. Article of the Maryland Code personal info. requested on this form is used in processing this form pursuant to COMAR 26.04.04. Failure to provide the info. may result in this form not being processed.

B 1 32976

SEQUENCE NO. (MDE USE ONLY)

STATE OF MARYLAND APPLICATION FOR PERMIT TO DRILL WELL 559843-Q please type

STATE PERMIT NUMBER HO-17-0115 fill in this form completely

Date Received (APA) 11/16/16

OWNER INFORMATION

8 MM DO YY 13 15 Last Name Owner First Name 34 36 Street or RFD 55 57 Town 70 State 72 Zip 76 Elm Street Development 555 Beverly Rd, Suite 240 McClean, VA 22101

B 3

LOCATION OF WELL

8 COUNTY 21 23 SUBDIVISION 42 52 NEAREST TOWN 71 Howard Mill Creek Clarksville

DRILLER INFORMATION

Driller's Name 76 License No. 81 Firm Name 34 Address 37 Signature 39 Date 11-3-16 Michael Barion M W D 355 Barion Well Drilling 502 Underwood Ln, Bel Air 21014

B 4

SOURCES OF DRILLING WATER

1. Well 2. 3.

11 STREET ADDRESS 30 ON WHICH SIDE OF ROAD (CIRCLE APPROPRIATE BOX) NORTH WEST EAST SOUTH 34 1100 37 DISTANCE FROM ROAD FT 38 39 ENTER FT OR MI 39 BLK: 6 PARCEL 0001

B 2

WELL INFORMATION

1 24 APPROX. PUMPING RATE (GAL. PER MIN.) 8 5 12 AVERAGE DAILY QUANTITY NEEDED (GAL. PER DAY) 14 750 20

USE FOR WATER (CIRCLE APPROPRIATE BOX)

- DOMESTIC POTABLE SUPPLY & RESIDENTIAL IRRIGATION FARMING (LIVESTOCK WATERING & AGRICULTURAL IRRIGATION) INDUSTRIAL, COMMERCIAL, DEWATERING PUBLIC WATER SUPPLY WELL TEST, OBSERVATION, MONITORING OPEN LOOP GEOTHERMAL CLOSED LOOP GEOTHERMAL

NOT TO BE FILLED IN BY DRILLER HEALTH DEPARTMENT APPROVAL

HOWARD 546 326-Q 13 COUNTY NAME COUNTY NO. STATE SIGNATURE INSERT S DATE ISSUED 3/6/17 CO SIGNATURE 3/6/18 EXP. DATE 43 MM DD YY 48

DON: 3/16/17(S) DOG: 4/14/17(S) DOY: 6/13/17(S)

APPROXIMATE DEPTH OF WELL 24 300 28 FEET

APPROXIMATE DIAMETER OF WELL 6 INCH NEAREST

METHOD OF DRILLING (circle one)

BORED (or Augered) JETTED Jetted & DRIVEN 30 AIR-ROTARY AIR-PERCussion ROTARY (Hydraulic Rotary) 37 CABLE Reverse ROTARY DRIVE-POINT other

REPLACEMENT OR DEEPEMED WELLS (CIRCLE APPROPRIATE BOX)

- THIS WELL WILL NOT REPLACE AN EXISTING WELL THIS WELL WILL REPLACE A WELL THAT WILL BE ABANDONED AND SEALED THIS WELL WILL REPLACE A WELL THAT WILL BE USED AS A STANDBY-CONTACT LOCAL APPROVING AUTHORITY FOR POLICY ON STANDBY WELLS THIS WELL WILL DEEPEM AN EXISTING WELL

PERMIT NUMBER OF WELL TO BE REPLACED OR DEEPEMED (IF AVAILABLE) 41 52

Not to be filled in by driller (MDE OR COUNTY USE ONLY)

APPROP. PERMIT NUMBER HO 2016G002 PERMIT No. HO-17-0115

PROPOSED LOCATION OF WELL ON LOT SHOW PERMANENT STRUCTURES SUCH AS BUILDINGS, SEPTIC SYSTEM, ROADS AND/OR LANDMARKS AND INDICATE NOT LESS THAN TWO DISTANCE MEASUREMENTS TO WELL

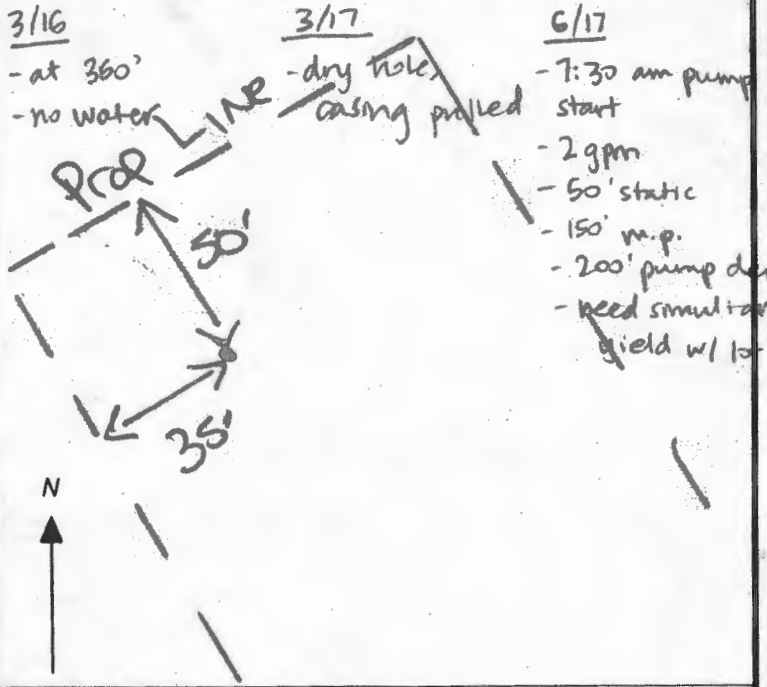

SPECIAL CONDITIONS

SEE ATTACHED MEMO



MICHAEL BARLOW WELL DRILLING & SERVICE, INC.

522 Underwood Lane
(410) 838-6910

Bel Air, Maryland 21014
Fax (410) 838-3582

WELL YIELD REPORT

* Simultaneous yield
w/ lot 17 *

Date Test Completed:	October 9, 2017		
Well Depth:	350	feet	
Customer	Elm Street Development	Permit #	HO-17-0115
Road	Haviland Mill Road	Subdivision	Mill Creek
City	Clarksville	Section	
State	Maryland	Lot #	18

Time	Water Level feet	Time to Fill 1-gallon bucket seconds	G.P.M.
9:15 AM	51	4	15.00
9:30 AM	130	25	2.40
9:45 AM	137	30	2.00
10:00 AM	137	30	2.00
10:15 AM	137	30	2.00
10:30 AM	137	30	2.00
10:45 AM	137	30	2.00
11:00 AM	137	30	2.00
11:15 AM	137	30	2.00
11:30 AM	137	30	2.00
11:45 AM	137	30	2.00
12:00 PM	137	30	2.00
12:15 PM	137	30	2.00
12:30 PM	137	30	2.00
12:45 PM	137	30	2.00
1:00 PM	137	30	2.00
1:15 PM	137	30	2.00
1:30 PM	137	30	2.00
1:45 PM	137	30	2.00
2:00 PM	137	30	2.00
2:15 PM	137	30	2.00
2:30 PM	137	30	2.00
2:45 PM	137	30	2.00
3:00 PM	137	30	2.00
3:15 PM	137	30	2.00
3:30 PM	137	30	2.00
This yield test report is for informational purposes only. Please note the yield may increase or decrease over time and the GPM indicated above is not a guarantee.			



MICHAEL BARLOW WELL DRILLING & SERVICE, INC.

522 Underwood Lane
(410) 838-6910

Bel Air, Maryland 21014
Fax (410) 838-3582

WELL YIELD REPORT

Date Test Completed:		June 13, 2017	
Well Depth:		350	feet
Customer	Elm Street Development	Permit #	HO-17-0115
Road	Haviland Mill Road	Subdivision	Mill Creek
City	Clarksville	Section	
State	Maryland	Lot #	18

Time	Water Level feet	Time to Fill 1-gallon bucket seconds	G.P.M.
7:30 AM	50	4	15.00
7:45 AM	140	30	2.00
8:00 AM	140	30	2.00
8:15 AM	140	30	2.00
8:30 AM	140	30	2.00
8:45 AM	140	30	2.00
9:00 AM	140	30	2.00
9:15 AM	140	30	2.00
9:30 AM	140	30	2.00
9:45 AM	140	30	2.00
10:00 AM	140	30	2.00
10:15 AM	140	30	2.00
10:30 AM	140	30	2.00
10:45 AM	140	30	2.00
11:00 AM	140	30	2.00
11:15 AM	140	30	2.00
11:30 AM	140	30	2.00
11:45 AM	140	30	2.00
12:00 PM	140	30	2.00
12:15 PM	140	30	2.00
12:30 PM	140	30	2.00
12:45 PM	140	30	2.00
1:00 PM	140	30	2.00
1:15 PM	140	30	2.00
1:30 PM	140	30	2.00
1:45 PM	140	30	2.00

This yield test report is for informational purposes only. Please note the yield may increase or decrease over time and the GPM indicated above is not a guarantee.

Maura J. Rossman, M.D., Health Officer

Information Form for the Installation of the Well Pump, Pitless Adapter, and Supply Piping

NOTE: The installer is responsible for requesting an inspection prior to 9 am on the day of the desired inspection. No work is to be covered until approved by the Health Department. All installations must comply with the National Standard Plumbing Code (NSPC, as amended locally) and COMAR 26.04.04 (MD Well Construction Regulations). Submission of a complete form is required prior to Use and Occupancy approval.

Company Name: Fogles Well Pump & Wt LLC Telephone #: 410 795 9670
 Address: 540 Obrecht Rd
Sikesville, MD 21784

Must circle one: Licensed Plumber / Licensed Well Driller / Licensed Well Pump Installer

License # and name of individual responsible for the field installation:

Name (Print): David C Fogle License# MSD226

*A licensed individual must perform the actual installation. Apprentices must be under the supervision of a licensed journeyman or master plumber, pump installer or well driller. Licenses may be subjected to field verification. Unlicensed individuals may be reported to the appropriate licensing agency.

Name of Property Owner: NVR Inc Telephone #: _____
 Subdivision: Mill Creek Lot #: 18 Well Tag #: HO-17-0115 ✓ 02/11/2020
 Site Address: 13855 Mill Creek Ct
Clarksville, MD 21029

Submersible Pump Data

Make: GALAS
 Model #: 7H507422
 Pump Capacity 7
 Well Yield: 2
 Depth of well encountered at time of pump installation: 350 (feet)

Pitless Adapter

Make: Campbell+
 Model#: _____
 GPM Depth: 36" (36" min)
 GPM NSF/WSC approved: YES

Well Cap and Electric Conduit

Two piece watertight cap: YES
 Screened, vented well cap: YES
 Cap secured to casing: YES
 Conduit min 18" B.G.: YES
 Conduit secured to well cap: YES

If pump capacity exceeds well yield, a low water cut off switch is required by NSPC 1990 Section 17.8.4

Must circle one: Torque arrestors / Cable guards / Other acceptable method used

Safety rope, if used, attached to brass rope adapter or other acceptable method inside of well casing ~~NA~~ NA

Piping to house

Type: 1" poly pipe
 PSI: 200 (160 psi min)
 Depth of supply line: 36" (36" min)

House Connection

PVC sleeve to undisturbed soil at wall penetration: YES
 Length of sleeve (5' minimum from foundation): 10'
 Sleeve sealed properly: YES

The water supply line is required to be at least ten feet from the septic tank, pump chamber, sewage piping, distribution box, drainfields, and sewage reserve area. If this cannot be accomplished, contact this office for approval prior to installation.

Signature of company representative responsible for installation: [Signature] date: 2/11/2020

For Health Department Use Only - Not to be completed by Installer

Date Insp. Requested: 02/11/2020 Date Insp. Approved: 02/11/2020 Inspector: [Signature]
 Inspection Data: Pitless adapter watertight & water supply line at least 36" below grade
 Two piece cap installed and attached to casing securely
 Elec. conduit extends at least 18" below grade/attached to cap properly
 Safety rope not outside of well cap/casing
 Correct well tag attached properly and casing 8" above finished grade
 Water supply line sleeved adequately at house connection
 Adequate grout observed below pitless adapter

✓ 41" 02/11/2020
 ✓ 38" 02/11/2020
 ✓ 00 02/11/2020

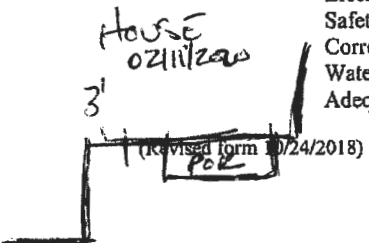

INTERIM CERTIFICATE OF POTABILITY

Expiration Date – OCTOBER 7, 2020

April 7, 2020

Homeowner
13855 Mill Creek Court
Clarksville, MD 21029

RE: Mill Creek, Lot 18
13855 Mill Creek Court
Building Permit: B19003851
Well Permit: HO-17-0115

Dear Homeowner:

This is to advise you that the septic system installation and water well construction for the above referenced property have been inspected and approved. Final approval of the septic system was granted on **4/3/2020**. Final approval of the well line connection to the dwelling was granted on **2/11/2020**. The well construction was completed on **6/13/2017**. Water samples were collected on **3/12/2020, 4/1/2020**.

The water sample results indicate that the water samples submitted for testing were free of coliform and fecal coliform bacteria at the time of sampling and are bacteriologically safe for drinking. This certifies that the initial sampling requirements of COMAR 26.04.04 "Well Regulations" have been met for the water supply system installed under well permit HO-17-0155. Although the submitted sample results are in compliance with COMAR standards, the Health Department does not guarantee water supplies.

This Interim Certificate of Potability will expire **six months** from the date of issuance. Submission of a second bacteriological test indicating the water is free of coliform and fecal coliform bacteria is required prior to the expiration date, after which time a Final Certificate of Potability will be issued. **Failure to submit an additional sample and obtain a Final Certificate of Potability will result in a Notice of Violation and is punishable as a misdemeanor under the *Annotated Code of Maryland, Environment Article, 9-1311*, subject to a fine of up to \$500 or imprisonment not to exceed three months.**

Please contact (410) 313-1773 to schedule a final water sample appointment or contact a Maryland certified water laboratory to schedule a water sample. A list of laboratories certified by the state of Maryland may be found at the following website:
<http://www.mde.state.md.us/assets/document/WSP-Labs-2010apr16.pdf>

Maura J. Rossman, M.D., Health Officer

In closing, please refer to our "Homeowner Fact Sheet" which illustrates a better understanding for your Onsite Sewage Disposal System. You will also find a link to Maryland Department of the Environments website which describes in further detail operation and maintenance of your septic system.

Approving Authority,

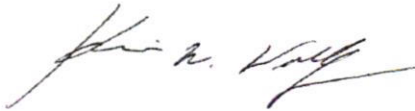

Kevin M. Wolf, LEHS, R.S./REHS, Supervisor
Groundwater Management Section
Well & Septic Program

cc: Howard County Dept. of Inspections, Licenses, and Permits
Community Hygiene Program
File

FOUNTAIN VALLEY ANALYTICAL LABORATORY, INC.

1413 Old Taneytown Rd. Westminster, MD (410) 848-1014 (410) 876-4554 FAX (410) 848-0298

REPORT OF ANALYSIS

Laboratory ID #:	136196	Account #:	1933
Reference:	Mill Creek Lot 18	Company:	Fogles Well Pump & Treatment
Location:	13855 Mill Creek Court Clarksville, MD 21029	Requested By:	Dave Fogle
Date/ Time Collected:	3/12/2020 0850	Source:	Well Water
Date/Time Rec'd:	3/12/2020 0954	Site:	Pressure Tank
Chlorine ppm:	Free: ND Total: ND	Treatment:	None
Collected By:	C. Condon 0020CC	pH:	7.6
		Well #:	HO-17-0115

PARAMETERS	RESULTS	UNITS	REFERENCE	METHOD	DATE/TIME/ANALYST
Bacteria, Coliform, Total, MPN	<1.0	MPN/ 100 ml	<1.0	SM20 9223B	3/13/2020 / 0920 / RER
Bacteria, E. coli, MPN	<1.0	MPN/ 100 ml	<1.0	SM20 9223B	3/13/2020 / 0920 / RER
Nitrate	1.26	mg/L	10	601	3/12/2020 / 1030 / CRS
Turbidity	17.6	NTU	<10	SM20 2130B	3/12/2020 / 1115 / CRS
Sand	Present	mg/L	5	Visual/Gravimetric	3/13/2020 / 0945 / RER

NOTES

- 1 mg/L = milligrams per liter (also, parts per million)
- 2 MPN/ 100 ml = Most Probable Number [of viable bacteria] per 100 ml of sample.
- 3 NS = None Seen (NS indicates less than 5 mg/L)
- 4 NTU = Nephelometric Turbidity Units
- 5 Results less than or within the reference range are considered satisfactory and within potable water limits at the time of sampling.
- 6 Sample collected by client, analyzed as received
- 7 ND:None Detected
- 8 pH and Chlorine level tested in lab (pH tested after recommended holding time)
- 9 Visual well check: Sealed, vented cap

Reason for Test : Use & Occupancy**Building Permit # :** B19002851Date Reported: 3/13/2020

FOUNTAIN VALLEY ANALYTICAL LABORATORY, INC.

1413 Old Taneytown Rd. Westminster, MD (410) 848-1014 (410) 876-4554 FAX (410) 848-0298

REPORT OF ANALYSIS

Laboratory ID #: 136584 Account #: 1933
Reference: Mill Creek Lot 18 Company: Fogles Well Pump & Treatment
Location: 13855 Mill Creek Court Requested By: Dave Fogle
Clarksville, MD 21029 Source: Well Water
Date/ Time Collected: 4/1/2020 0730 Site: Kitchen Sink Tap
Date/Time Rec'd: 4/1/2020 1155 Treatment: None
Chlorine ppm: Free: ND Total: ND pH: 7.4
Collected By: B. Wilkerson 9315BW Well #: HO-17-0115

PARAMETERS	RESULTS	UNITS	REFERENCE	METHOD	DATE/TIME/ANALYST
Turbidity	0.53	NTU	<10	SM20 2130B	4/2/2020 / 0935 / RER
Sand	NS	mg/L	5	Visual/Gravimetric	4/2/2020 / 0935 / RER

NOTES

- 1 mg/L = milligrams per liter (also, parts per million)
- 2 NS = None Seen (NS indicates less than 5 mg/L)
- 3 NTU = Nephelometric Turbidity Units
- 4 Results less than or within the reference range are considered satisfactory and within potable water limits at the time of sampling.
- 5 Sample collected by client, analyzed as received
- 6 ND:None Detected
- 7 pH and Chlorine level tested in lab (pH tested after recommended holding time)
- 8 Visual well check: Sealed, vented cap

Reason for Test : Use & Occupancy
Building Permit # : B19002851

Date Reported: 4/2/2020

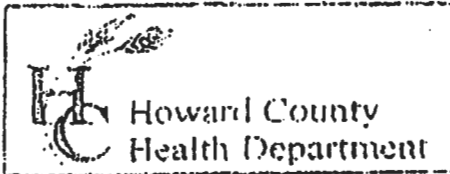

3525 H Ellicott Mills Drive, Ellicott City, MD 21043
(410) 313-2640 Fax (410) 313-2648
TDD (410) 313-2323 Toll Free 1-866-313-6300
website: www.hchealth.org

Penny E. Borenstein, M.D., M.P.H., Health Officer

TO ALL INTERESTED PARTIES

When submitting a well permit application for a proposed well for new construction, please indicate one of the following:

All individual well sites for lots 2-23 of Mill Creek are staked + properly labeled

The well site has been staked by Bohler Engineering,
(professional land surveyor or company employing professional land surveyors)
on 3/3/17 (date) and does not require a site inspection.

The well driller, builder or property owner will call the Health Department to schedule a time to meet in the field to verify the proposed well site location.

This sheet, along with two copies of an acceptable well site plan, must be attached to the green well permit application.



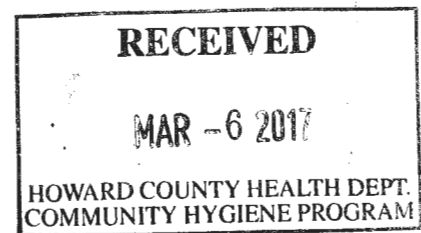

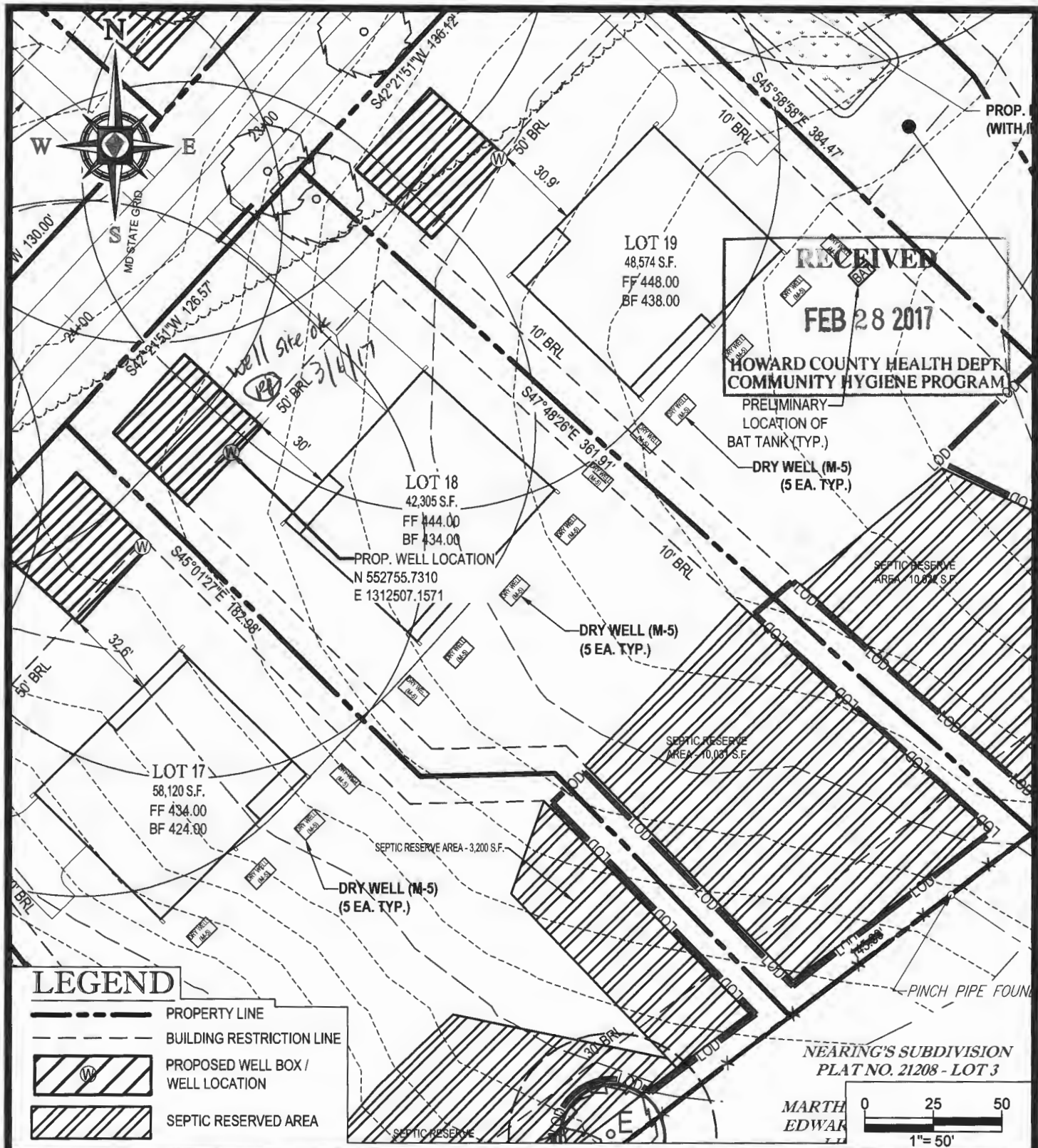
Revised 6/10/03





RECEIVED
FEB 28 2017
 HOWARD COUNTY HEALTH DEPT.
 COMMUNITY HYGIENE PROGRAM

LEGEND

-  PROPERTY LINE
-  BUILDING RESTRICTION LINE
-  PROPOSED WELL BOX / WELL LOCATION
-  SEPTIC RESERVED AREA

NEARING'S SUBDIVISION
 PLAT NO. 21208 - LOT 3

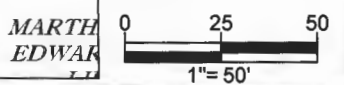

PROJECT NAME: **MILL CREEK SUBDIVISION**
PROPOSED LOTS 1-23 & NONBUILDABLE PRESERVATION PARCEL A - GHO-17-0115
 6780 HAVILAND MILL ROAD, CLARKSVILLE, MD

SHEET TITLE:
WELL EXHIBIT - LOT 18
 1 OF 1



BOHLER
 ENGINEERING

SCALE: 1" = 50'	DATE: 11-01-16	CAD ID: EXO	PROJECT NUMBER: MD142038
--------------------	-------------------	----------------	-----------------------------

22636 DAVIS DRIVE, SUITE 250 STERLING, VA 20164
 PHONE: (703) 709-9500 FAX: (703) 709-9501

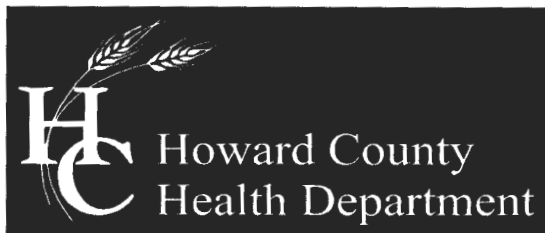

Bureau of Environmental Health

8930 Stanford Blvd, Columbia, MD 21045
Main: 410-313-2640 | Fax: 410-313-2648
TDD 410-313-2323 | Toll Free 1-866-313-6300
www.hchealth.org

Maura J. Rossman, M.D., Health Officer

LOT 18

MEMORANDUM

TO: Barlow Well Drilling

FROM: Ryan Rappaport, L.E.H.S. (RR) Well and Septic Program

DATE: March 1, 2017

RE: **State Water Appropriation and Use Permit for Crawford Property/Mill Creek Subdivision #HO2016G002(01) & Special Conditions**

The State Water Appropriation and Use Permit for the Crawford Property/Mill Creek Subdivision has a requirement regarding well spacing and testing:

15. The Permittee shall conduct simultaneous yield tests of wells closer than 100 feet apart, if at least one of the wells is on a lot less than one acre in size. The yield testing shall be conducted to ensure that the minimum yield requirements of COMAR 26.04.04.26 are met. In the event that a well that has been tested simultaneously with other wells does not meet minimum yield standards, the Permittee may relocate a well so as to achieve the 100-foot separation distance, deepen or otherwise modify the well to improve its yield or drill a second well to be used in tandem to meet the minimum yield standards during simultaneous testing. All wells shall comply with well construction standards.

The lots of the Crawford Property/Mill Creek Subdivision that are less than an acre are lots 2, 3, 12, 13 and 18. If a well on one of these lots is within 100' of another well, a simultaneous yield test of both wells will be required.

SPECIAL CONDITIONS

- All drilling, grouting and yields must be called into the Health Department for inspection. Call 410-313-1771 for scheduling.
- Since all 23 lots have the well locations staked and not the lot's well boxes it is required that if during the drilling a dry hole is encountered, the Health Department must be notified immediately before any additional drilling is completed on that particular lot.
- The wells on lots 1, 7, 15 and 19 will require TDS, sodium and chloride water samples during the yield test.
- The wells on lots 20 and 21 must be drilled using steel casing that extends to at least 50 feet depth or 10 feet into competent bedrock, whichever is deeper.

Feel free to contact me with any questions at 410-313-1781 or RRappaport@howardcountymd.gov.

Cc: File

MARYLAND DEPARTMENT OF THE ENVIRONMENT, WATER MANAGEMENT ADMINISTRATION
1800 Washington Blvd., Baltimore, Maryland 21230 (410) 537-3784

WATER WELL ABANDONMENT-SEALING REPORT FORM

SUBMIT COPIES OF COMPLETED FORM TO:

- * COUNTY ENVIRONMENTAL AGENCY (contact MDE, WMA if address needed)
- * WELL OWNER
- * MDE, WATER MANAGEMENT ADMINISTRATION, WELL PROGRAM

DATE WELL ABANDONED: 6/13/17 (month/day/year)

* PERMIT NUMBER OF ABANDONED WELL (if any)

* PERMIT NUMBER OF REPLACEMENT WELL:

Ho-17-0115

* PERSON ABANDONING WELL: Michael Barkow WELL DRILLER'S LICENSE NUMBER: 355

CIRCLE (MWD) / MSD / MGD

* OWNER'S NAME: Elm Street Development

SITE LOCATION MAP

Drilled within Approved Well Area

* WELL LOCATION:
COUNTY: Howard
NEAREST TOWN: Clarksville
TAX MAP 39 BLOCK 6 PARCEL 0001
SUBDIVISION: Mill Creek
SECTION: _____ LOT: 18
STREET ADDRESS: Haviland Mill Rd

LATITUDE 3 9.18447

LONGITUDE 7 6.99931

LOG OF SEALING MATERIAL

MATERIAL	FEET	
	FROM	TO
Drill Cuttings	500	25
Cement GROUT	25	0

* TYPE OF WELL BEING ABANDONED:
 DRILLED JETTED
 BORED HAND DUG
 OTHER (specify) _____

* USE CODE:
 DOMESTIC MUNICIPAL/PUBLIC
 IRRIGATION INDUSTRIAL
 TEST/OBSERVATION GEOTHERMAL

* TYPE OF CASING:
 STEEL PLASTIC
 CONCRETE OTHER (specify) Drill Pipe

SIZE OF CASING: 6 INCHES IN DIAMETER

DEPTH OF WELL: 500 FEET DEEP

WAS ANY CASING REMOVED? YES NO
If yes, length removed, in feet: _____

WAS CASING RIPPED OR PERFORATED? YES NO

[Signature]
SIGNATURE-MASTER WELL DRILLER OR SUPERVISING SANITARIAN LICENSE# 355

Pursuant to § 10-624 of the State Govt. Article of the Maryland Code, personal info requested on this form is used in processing this form pursuant to COMAR 26.04.04. Failure to provide the info may result in this form not being processed. You have the right to inspect, amend, or correct this form. The Maryland Department of the Environment is subject to the Maryland Public Information Act. This form may be made available on the Internet via MDE's website and is subject to inspection or copying, in whole or in part, by the public and other governmental agencies, if not protected by federal or State Law.

(MWD) / MSD / MGS
CIRCLE ONE

12/18/17
DATE

COUNTY