

Bureau of Environmental Health
 8930 Stanford Boulevard, Columbia, MD 21045
 Main: 410-313-2640 | Fax: 410-313-2648
 TDD 410-313-2323 | Toll Free 1-866-313-6300
www.hchealth.org
 Facebook: www.facebook.com/hocohealth

Maura J. Rossman, M.D., Health Officer

RECEIPT DATE: 5/20/19 **ONSITE SEWAGE DISPOSAL SYSTEM** P 565495
 APPROVAL DATE: 06/17/2019 **PERMIT: MINOR REPAIR** A _____
 PROPERTY ADDRESS: 16146 Ed Warfield Road
 SUBDIVISION: _____ LOT: _____ TAX ID: 04-332547
 CONTRACTOR: Fogles Septic Clean Inc. EMAIL: kim@foglesinc.com
 CONTRACTOR ADDRESS: 580 Obrecht Road, Sykesville, MD 21784 PHONE: 410-795-5670
 PROPERTY OWNER: Robert Crowe EMAIL: BOB-24-68@HOTMAIL.COM
 OWNER ADDRESS: 16146 Ed Warfield Road, Woodbine, MD 21797 Phone: 410-489-4750

SEPTIC TANK SIZE (GALLONS): Existing PUMP CHAMBER CAPACITY (GALLONS): N/A PUMP SIZE: —
 NUMBER OF BEDROOMS: 4 HOUSE SQ. FT. — APPLICATION RATE: —
 DISTRIBUTION SYSTEM: GRAVITY FED LOW PRESSURE DOSED

TRENCHES:	LINEAR FEET REQUIRED: <u>N/A</u>	INLET DEPTH: _____
	TRENCH WIDTH: _____	MAXIMUM BOTTOM DEPTH: _____
	MINIMUM SPACE BETWEEN TRENCHES: _____	EFFECTIVE AREA BEGINNING DEPTH: _____

LOCATION: **TO BE STAKED BY SANITARIAN DURING PRE-CONSTRUCTION INSPECTION.**

NOTES: Pump/collapse existing Draywell. Reconnect plumbing to existing trench off drywells. Add obs port sampler in line of existing trench. Add manhole over the tank.
EMAIL HOME OWNER FILE

ISSUED BY: K. Wolf ISSUE DATE: 6/13/19 EXPIRATION DATE: 6/10/20

- NOTE: **CONTRACTOR MUST SCHEDULE A PRE-CONSTRUCTION INSPECTION PRIOR TO BEGINNING ANY INSTALLATION**
- NOTE: **CONTRACTOR MUST SCHEDULE AN INSPECTION AND GAIN APPROVAL OF ALL COMPONENTS PRIOR TO COVERING**
- NOTE: **STONE MUST BE APPROVED BY HEALTH DEPARTMENT AND GRAVEL TICKET MUST BE AVAILABLE FOR REVIEW.**
- NOTE: **WATERTIGHT SEPTIC TANKS REQUIRED**
- NOTE: **ALL PARTS OF SEPTIC SYSTEM SHALL BE AT LEAST 100 FEET DOWNGRADIENT FROM ANY WATER WELL**
- NOTE: **MANHOLE RISERS REQUIRED ON ALL SEPTIC TANKS AND PUMP CHAMBERS**
- NOTE: **AN ELECTRICAL PERMIT IS REQUIRED FOR INSTALLATION OF ANY ELECTRICAL COMPONENTS OF THE SYSTEM**
 ELECTRICAL PERMIT ISSUED E N/A
- NOTE: **THE HCHD DOES NOT WARRANTY ANY SYSTEM AND CANNOT GUARANTEE THE PERFORMANCE OF THIS SYSTEM AS DESIGNED. BY ACCEPTING THIS PERMIT, THE OWNER AND/OR APPLICANT ACKNOWLEDGE THAT THE SPECIFICATIONS DETAILED IN THIS DESIGN ARE ONE POSSIBLE OPTION AND THAT THE HCHD WILL REVIEW OTHER PROPOSALS. YOU HAVE THE OPTION TO SEEK THE ADVICE OF A QUALIFIED DESIGN CONSULTANT OR PROFESSIONAL ENGINEER FOR FURTHER GUIDANCE.**
- NOTE: **MDE RECOMMENDS SEPTIC TANKS, BAT, AND OTHER PRETREATMENT UNITS BE PUMPED AT A FREQUENCY ADEQUATE TO ENSURE THAT SOLIDS ARE NOT DISCHARGED TO THE DISPOSAL AREA**

**NEITHER THE HOWARD COUNTY COUNCIL NOR THE HEALTH DEPARTMENT IS RESPONSIBLE FOR THE SUCCESSFUL OPERATION OF ANY SYSTEM.
 PERMITTEE RESPONSIBLE FOR OBTAINING FINAL APPROVAL ON THIS PERMIT.
 CALL 410-313-1771 TO SCHEDULE INSPECTIONS.**

NOT TO SCALE

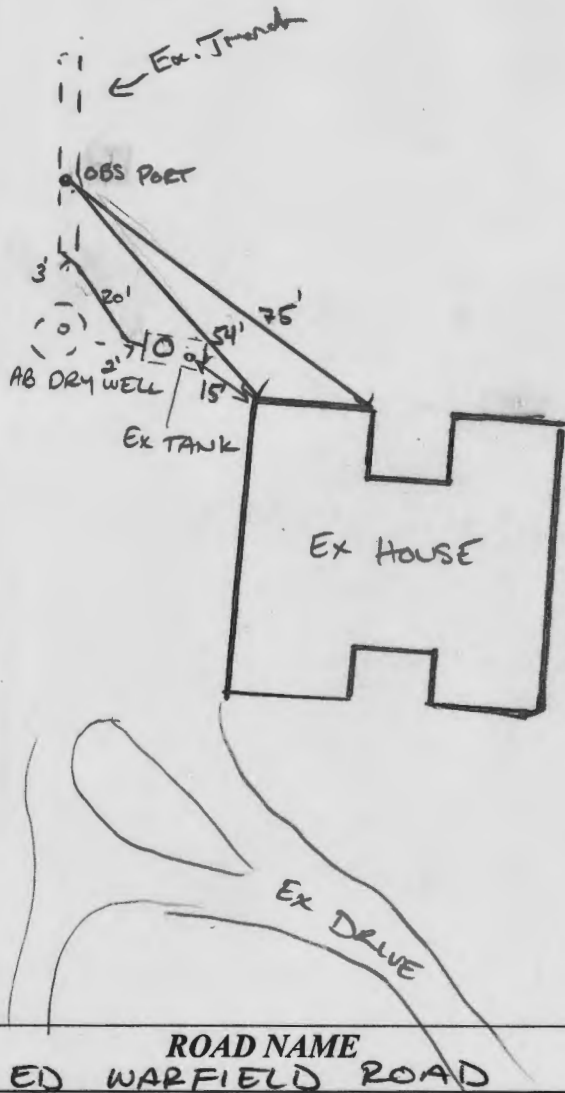

TRENCH/DRAINFIELD DATA

WIDTH N/A INLET _____ BOTTOM _____
 NUMBER OF TRENCHES _____
 TOTAL LENGTH _____
 ABSORPTION AREA _____
 DISTRIBUTION BOX LEVEL _____
 DISTRIBUTION BOX BAFFLE _____
 DISTRIBUTION BOX PORT _____

SEPTIC TANK DATA

SEPTIC TANK 1 LEVEL Exists
 MANUFACTURER _____
 CAPACITY 1000 GAL
 SEAM LOC mid
 TANK LID DEPTH 3'
 (NEW) → BAFFLES YES
 BAFFLE FILTER N/A
 (NEW) → MANHOLE LOC YES
 6" PORT LOC FRONT
 WATERTIGHT TEST -OK-
 SLOTTED no
 DATE ON LID N/A

PUMP/SEPTIC TANK LEVEL

MANUFACTURER _____
 CAPACITY _____ GAL
 SEAM LOC _____
 TANK LID DEPTH _____
 BAFFLES _____
 BAFFLE FILTER _____
 MANHOLE LOC _____
 6" PORT LOC _____
 WATERTIGHT TEST _____
 SLOTTED _____
 DATE ON LID _____

PRE-CONSTRUCTION:

6/13/19 Existing Drywell to be pumped / collapsed / filled in.
 Install new plumbing from ex. s.t. to ex. trench.
 Add obs pipe to ex trench. (KMD)

INSTALLATION:

6/14/19 RISER ADDED TO EX TANK. 4" SCH 40 PVC EFFLUENT LINE TO TRENCH INSTALLED TO NEW CLEAN OBS. PORT. EX DRY WELL PUMPED, CRUSHED, AND FILLED WITH CLEAN FILL. (KMD)

FINAL INSPECTOR

DATE OF APPROVAL

06/17/2019



Bureau of Environmental Health

8930 Stanford Boulevard, Columbia, MD 21045

Main: 410-313-2640 | Fax: 410-313-2648

TDD 410-313-2323 | Toll Free 1-866-313-6300

www.hchealth.org

Facebook: www.facebook.com/hccohealth

Twitter: HowardCoHealthDep

Dr. Maura J. Rossman, M.D., Health Officer

INFORMATION FORM - SEPTIC SYSTEM REPAIR/UPGRADE

Reason for Request:

- Failing System
- System relocation for proposed addition
- System upgrade for proposed addition
- Inadequate treatment zone
- Collapsed septic tank
- Collapsed drywell

Has the septic tank been pumped within the last month?

- Yes Date pumped: 5/17/19
- No

Was a visual inspection of the septic tank and/or drain fields conducted?

- Yes Explain observations: _____
- No

Existing system design

- Drywell
- Trench
- Mound
- Unknown
- Other: _____

Was a visual inspection of the sewage line conducted?

- Yes
 - Blockage leading to the tank
 - Yes Explain: _____
 - No
 - Blockage leading to the field
 - Yes Explain: _____
 - No
- No

Is discharge surfacing on the ground?

- Yes
- No

Additional Comments: _____

*For REPAIRS, are the owners proposing, or do they plan to add in the future, any additions or modifications to the property, i.e. pools, living space additions, garages, etc? This information must be disclosed at the time of this application. The Health Department will not be able to accommodate requests in the field for property modifications unrelated to the repair request. Such requests may require an additional fee, testing, and submittal of a Percolation Certification Plan, if the property does not meet current Code and Regulation.

Septic Contractor: Fogle's Septics Contractor's Phone: 410-795-5670
 Contractor's Address: 580 Bennett Rd Sykesville 21784

Property Address: 16146 Ed Warfield Rd County file: _____
 Subdivision: _____ Lot _____ Year Built: _____

Owner's Name: Robert Crowe Owner's Phone: 410-489-4750

Name of previous owners: _____ Existing bedrooms: _____
 Proposed bedrooms: _____

Has this request been previously discussed with a Sanitarian? (Name): _____
 Public Sewer available/nearby: _____

*A Sanitarian will be in contact within three business days, depending upon the urgency of the situation, to coordinate the scheduling/review of the repair or upgrade.

Prior to scheduling inspections, scaled plans should be submitted to clarify the nature of the addition.
 Print out a copy of Real Property Data via Dept. of Taxation website _____ Indexed file found _____

If public sewer may be nearby, verify whether sewer is technically "available" through the Bureau of Engineering.
 If sewer is available and the property is within the Metropolitan District, connection to sewer is required. If the owner believes reason for exemption exists, the owner should justify the request in writing.

If soil/site conditions are limited and sewer and/or Metro District status is not conducive to connection, the Sanitarian may recommend pursuit of Emergency Sewer Extension or Emergency Metro District Inclusion. The Owner should contact the Bureau of Utilities for details.

No permit is to be issued nor inspection to be scheduled without prior fee collection at the office unless an emergency situation exists. The contractor is to notify office of the emergency situation as soon as possible.



HOWARD COUNTY HEALTH DEPARTMENT

65495

PS

DATE
5/20/19

Received From

Tosler Septic
Clean, Inc.

PHONE # 410 795-5670

For

Peric Repair - 16/16
Ed Warford
RE

CASH

CHECK

NO.
64500

Three hundred thirty Dollars

\$ 330.00

Received By

Okierp