

WATER WELL ABANDONMENT-SEALING REPORT FORM

SUBMIT COPIES OF COMPLETED FORM TO:

- * COUNTY ENVIRONMENTAL AGENCY (contact MDE, WMA if address needed)
- * WELL OWNER
- * MDE, WATER MANAGEMENT ADMINISTRATION, WELL PROGRAM

APPROVED
 07/16/2021

DATE WELL ABANDONED: APRIL 16, 2020 (month/day/year)

* PERMIT NUMBER OF ABANDONED WELL (if any): _____

* PERMIT NUMBER OF REPLACEMENT WELL: _____

* PERSON ABANDONING WELL: Brace Thompson WELL DRILLER'S LICENSE NUMBER: JD 0380

CIRCLE: MWD / MSD / MGD

* OWNER'S NAME: Monticello Reserve LLC

SITE LOCATION MAP

* WELL LOCATION:
 COUNTY: HOWARD
 NEAREST TOWN: COLUMBIA
 TAX MAP _____ BLOCK _____ PARCEL _____
 SUBDIVISION: _____
 SECTION: _____ LOT: _____
 STREET ADDRESS: 4489 CENTENNIAL LANE

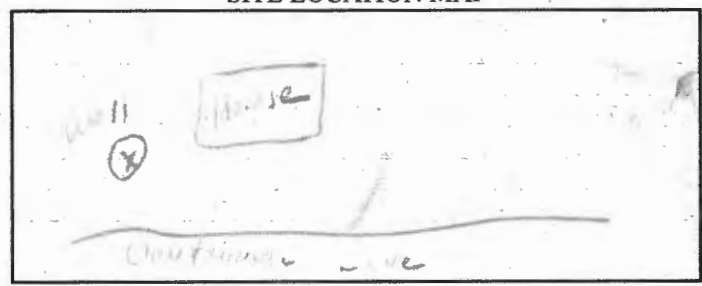

LATITUDE 39.247933

LONGITUDE 76.867027

LOG OF SEALING MATERIAL

MATERIAL	FEET	
	FROM	TO
<u>Bestonite</u>	<u>30</u>	<u>2</u>
<u>DIRT</u>	<u>2</u>	<u>0</u>
VOLUME OF MATERIAL USED		
<u>150# concrete mixed for slurry</u>		

* TYPE OF WELL BEING ABANDONED:
 DRILLED _____ JETTED _____
 BORED _____ HAND DUG _____
 OTHER (specify) _____

* USE CODE:
 DOMESTIC _____ MUNICIPAL/PUBLIC _____
 IRRIGATION _____ INDUSTRIAL _____
 TEST/OBSERVATION _____ GEOTHERMAL _____

* TYPE OF CASING:
 STEEL _____ PLASTIC _____
 CONCRETE _____ OTHER (specify) _____

SIZE OF CASING: 6 INCHES IN DIAMETER

DEPTH OF WELL: 30 FEET DEEP

WAS ANY CASING REMOVED? YES NO
 If yes, length removed, in feet: 2

WAS CASING RIPPED OR PERFORATED? YES NO

SIGNATURE-MASTER WELL DRILLER OR SUPERVISING SANITARIAN LICENSE# 040

MWD / MSD / MGS
 CIRCLE ONE

4-16-20
 DATE

OWNER

Pursuant to § 10-624 of the State Govt. Article of the Maryland Code, personal info requested on this form is used in processing this form pursuant to COMAR 26.04.04. Failure to provide the info may result in this form not being processed. You have the right to inspect, amend, or correct this form. The Maryland Department of the Environment is subject to the Maryland Public Information Act. This form may be made available on the Internet via MDE's website and is subject to inspection or copying, in whole or in part, by the public and other governmental agencies, if not protected by federal or State Law.