

LAYOUT 4/3/2012 INSP 4 \_\_\_\_\_  
 INSP 2 4/6/12 INSP 5 \_\_\_\_\_  
 INSP 3 \_\_\_\_\_ INSP 6 \_\_\_\_\_

ISSUE DATE: 3/29/2012

# PERMIT

P 536785

APPROVAL DATE: 4/9/12

A UPGRADE

Tax ID # 1405369169

**ON-SITE SEWAGE DISPOSAL SYSTEM  
 HOWARD COUNTY HEALTH DEPARTMENT  
 BUREAU OF ENVIRONMENTAL HEALTH**

Fogle's Septic Clean, Inc. IS PERMITTED TO INSTALL  ALTER

ADDRESS: 580 Obrecht Road Sykesville 21784 PHONE NUMBER: 410-795-5670

SUBDIVISION: VanNoy Property LOT NUMBER: Lot 1

ADDRESS: 7319 Browns Bridge Rd PROPERTY OWNER: John Korslund

SEPTIC TANK CAPACITY (GALLONS): 2,000 OUTLET BAFFLE FILTER REQUIRED

PUMP CHAMBER CAPACITY (GALLONS): N/A COMPARTMENTED TANK REQUIRED

NUMBER OF BEDROOMS: 5 APPLICATION RATE: 0.8

SQUARE FOOTAGE OF HOUSE: ukwn *Trenches 3' Wide  
Inlet 4'*  
 LINEAR FEET OF TRENCH REQUIRED: ~~104~~ 160' Bottom 7' 4x40' Trenches

TRENCHES:	Trenches to be <u>3</u> feet wide. Inlet <u>4</u> feet below original grade with <u>2.5</u> feet of stone below distribution pipe. Bottom maximum depth is <u>6.5</u> feet below grade. Effective area begins at <u>4.5</u> feet below original grade. Maintain at least <u>9</u> feet spacing between trenches. <u>4'</u>
LOCATION:	Set septic tank 20' from house outside of top corner of easement. Set new distribution box approx. 60' from front left corner of house and 10' from proposed property line. Install 2 x 97' trenches on contour. Abandon existing septic tank,
NOTES:	<b>Do not</b> order the septic tank until after layout inspection and Sanitarian approval. Stake septic easement corners. Call for layout inspection. Mark utilities. Gravel tickets must be available for Environmental Sanitarians. Stone must be approved by the Howard County Health Department. A written variance request is required for tanks deeper than 3 feet. A traffic bearing lid is required for tanks deeper than 4 feet.

PLANS APPROVED: HS DATE: 3/29/2012

- NOTE: PERMIT VOID AFTER 2 YEARS
- NOTE: CONTRACTOR RESPONSIBLE FOR SCHEDULING A PRE-CONSTRUCTION INSPECTION FOR ALL INSTALLATIONS
- NOTE: WATERTIGHT SEPTIC TANKS REQUIRED
- NOTE: ALL PARTS OF SEPTIC SYSTEM SHALL BE 100 FEET FROM ANY WATER WELL
- NOTE: MANHOLE RISERS REQUIRED ON ALL SEPTIC TANKS AND PUMP CHAMBERS
- NOTE: AN ELECTRICAL PERMIT IS REQUIRED FOR INSTALLATION OF ANY ELECTRICAL COMPONENTS OF THE SYSTEM

**NEITHER THE HOWARD COUNTY COUNCIL OR THE HEALTH DEPARTMENT IS  
 RESPONSIBLE FOR THE SUCCESSFUL OPERATION OF ANY SYSTEM  
 PERMITTEE RESPONSIBLE FOR OBTAINING FINAL APPROVAL ON THIS PERMIT  
 CALL 410-313-1771 FOR INSPECTION OF SEPTIC SYSTEM**



Well In Shed

NOT TO SCALE

(30)

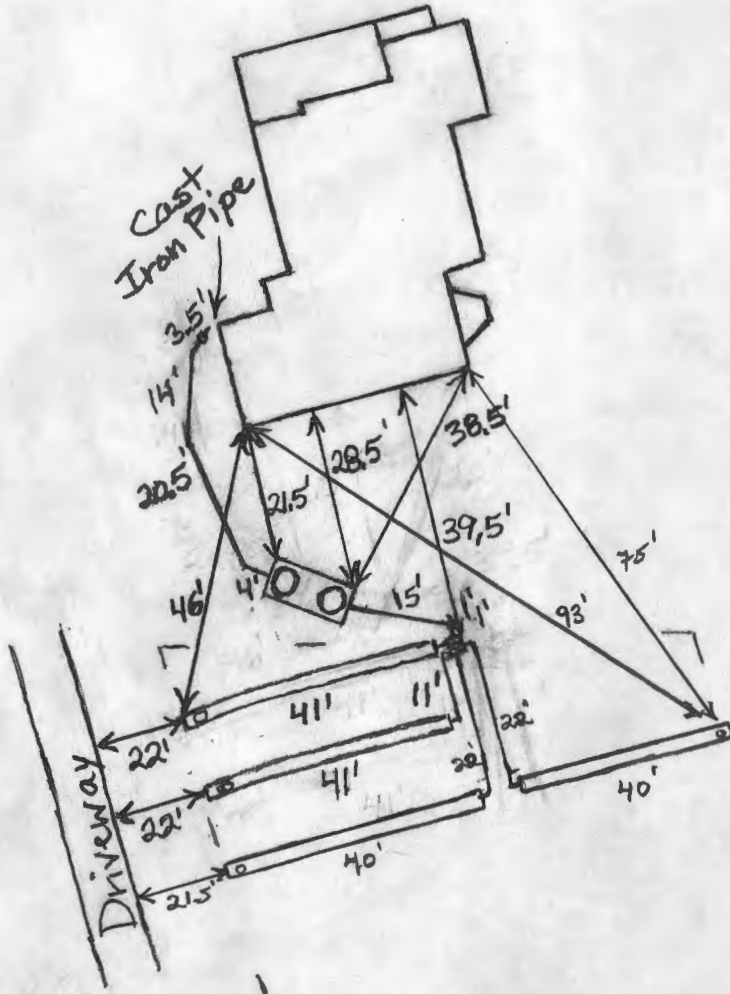

TRENCH/DRAINFIELD DATA		
WIDTH	INLET	BOTTOM
3'	4'	7'
NUMBER OF TRENCHES		4
TOTAL LENGTH _____		
ABSORPTION AREA _____		
DISTRIBUTION BOX LEVEL _____		
DISTRIBUTION BOX BAFFLE		Yes
DISTRIBUTION BOX PORT		Yes

SEPTIC TANK DATA	
SEPTIC TANK 1 LEVEL	Yes
MANUFACTURER	Babylon
CAPACITY	2000 GAL
SEAM LOC	Top
TANK LID DEPTH	1.5'-2'
BAFFLES	Yes
BAFFLE FILTER	No
MANHOLE LOC	Front+Rear
6" PORT LOC	None
WATERTIGHT TEST	No
SLOTTED	Yes
DATE ON LID	2/19/2012
PUMP/SEPTIC TANK LEVEL N/A	
MANUFACTURER	_____
CAPACITY	_____ GAL
SEAM LOC	_____
TANK LID DEPTH	_____
BAFFLES	_____
BAFFLE FILTER	_____
MANHOLE LOC	_____
6" PORT LOC	_____
WATERTIGHT TEST	_____
SLOTTED	_____
DATE ON LID	_____

PRE-CONSTRUCTION:

4/3/2012 Set the distribution box in the top middle of the easement. Install 40' trenches on contour in both directions. Install the tank just above the north eastern part of the easement. (BB)

INSTALLATION: 4/6/2012 Tank installed. House connection made. Top two trenches are done. (BB)

4/9/12 Last 2 trenches complete. D box leveled. OK to cover all work (pw)

FINAL INSPECTOR J. Half DATE OF APPROVAL 4/9/12