



RECEIVED  
 HOWARD COUNTY HEALTH DEPT.  
 ENVIRONMENTAL HEALTH  
 Health Department  
 2010 JUN -1 AM 11:57

# APPLICATION

## FOR PERCOLATION TESTING AND SITE EVALUATION

TEST DATE(S) \_\_\_\_\_ TEST TIME \_\_\_\_\_ @P 5332ldo

AGENCY REVIEW: \_\_\_\_\_ DATE 6-1-10

**DO NOT WRITE ABOVE THIS LINE**

I HEREBY APPLY FOR THE NECESSARY TESTING/EVALUATION PRIOR TO ISSUANCE OF SEWAGE DISPOSAL SYSTEM PERMIT(S) TO:

CHECK AS NEEDED:

- CONSTRUCT NEW SEPTIC SYSTEM(S)
- REPAIR/ADD TO AN EXISTING SEPTIC SYSTEM
- REPLACE AN EXISTING SEPTIC SYSTEM

CHECK AS NEEDED:

- NEW STRUCTURE(S)
- ADDITION TO AN EXISTING STRUCTURE
- REPLACE AN EXISTING STRUCTURE

CHECK ONE:

- CREATE NEW LOT(S)
- BUILD ON AN EXISTING LOT IN A SUBDIVISION
- BUILD ON AN EXISTING PARCEL OF RECORD

IS THE PROPERTY WITHIN 2500' OF ANY RESERVOIR?

- YES
- NO

THE TYPE OF STRUCTURE IS:

- RESIDENTIAL WITH UNKNOWN PROPOSED BEDROOMS IN THE COMPLETED STRUCTURE (NOTE UNKNOWN IF APPROPRIATE)
- COMMERCIAL (PROVIDE DETAIL OF NUMBERS AND TYPES OF EMPLOYEES/ CUSTOMERS ON ACCOMPANYING PLAN)
- INSTITUTIONAL/GOVERNMENT (PROVIDE DETAIL OF NUMBERS AND TYPES OF EMPLOYEES/USERS ON ACCOMPANYING PLAN)

PROPERTY OWNER(S) Richard C. Hudson

DAYTIME PHONE \_\_\_\_\_ CELL \_\_\_\_\_ FAX \_\_\_\_\_

MAILING ADDRESS 13801 Forsythe Rd. Springville MD 21081  
 STREET CITY/TOWN STATE ZIP

APPLICANT Norman Lennon Future Builders & Const. Co. Inc.

DAYTIME PHONE 443-742-6652 CELL 443-742-6652 FAX 443 546-3013

MAILING ADDRESS 12020 Windsor Moss Ellicott City Md. 21042  
 STREET CITY/TOWN STATE ZIP

APPLICANT'S ROLE: DEVELOPER BUILDER BUYER RELATIVE/FRIEND REALTOR CONSULTANT

PROPERTY LOCATION  
 SUBDIVISION/PROPERTY NAME Hudson Property LOT NO. \_\_\_\_\_

PROPERTY ADDRESS 14205 Old Frederick Rd. Cooksville, MD. 21023  
7142751 STREET TOWN/POST OFFICE

TAX MAP PAGE(S) 8 GRID 17 PARCEL(S) [blacked out] PROPOSED LOT SIZE 9.075 AC

AS APPLICANT, I UNDERSTAND THE FOLLOWING: THE SYSTEM INSTALLED SUBSEQUENT TO THIS APPLICATION IS ACCEPTABLE ONLY UNTIL PUBLIC SEWERAGE IS AVAILABLE. THIS APPLICATION IS COMPLETE WHEN ALL APPLICABLE FEES AND A SUITABLE SITE PLAN HAVE BEEN RECEIVED. I ACCEPT THE RESPONSIBILITY FOR COMPLIANCE WITH ALL M.O.S.H.A. AND "MISS UTILITY" REQUIREMENTS. APPROVAL IS BASED UPON SATISFACTORY REVIEW OF A PERC CERTIFICATION PLAN.

TEST RESULTS WILL BE MAILED TO APPLICANT.

[Signature]  
 SIGNATURE OF APPLICANT

HOWARD COUNTY HEALTH DEPARTMENT, BUREAU OF ENVIRONMENTAL HEALTH, WELL AND SEPTIC PROGRAM  
 1718 COLUMBIA GATEWAY DRIVE COLUMBIA, MARYLAND 21046 (410) 313-2640 FAX (410) 313-2648  
 TDD (410) 313-2323 TOLL FREE 1-877-4MD-DHMH

Hudson Property  
14285 Old Frederick Rd.

AVP \_\_\_\_\_

③  
brn sl 2.8'  
brn stsl 1'  
yel red vstsl 2.8'  
R  
57' ← 19'

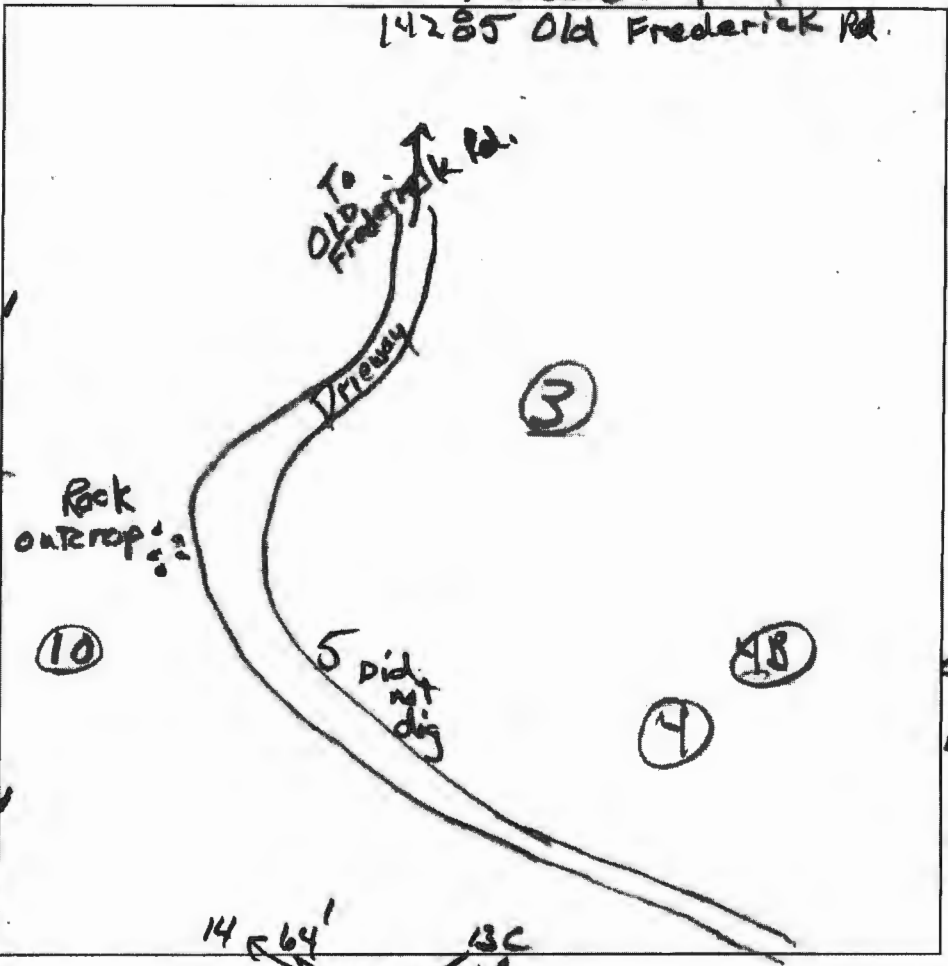

⑬ D  
2.3'  
Very stony & bouldery  
5' R

⑩  
dk gray-brn sl 9.5'  
yel-brn vstsl 2.3'  
R

9 offset 57'  
2.5' brn sl  
1.8' brn sl  
4' yel-red sl  
5' yel-red stsl  
5' R

DATE	TEST #	DEPTH	START	BREAK 1" DROP	STOP 2" DROP	TIME OF 2ND INCH	P/F/H
7/28/10	3	2.8'	Visual	Refusal	very stony		F
7/28/10	10	2.3'	Visual	Refusal	very stony		F
7/28/10	13D	5'	Visual	Refusal	very stony	25'	F
7/28/10	9	5'	Visual	Refusal	very stony	4'	F

REMARKS #4 Passed, 25' x 40' area OK; All others FAIL <sup>on this page</sup>  
 SANITARIAN RB BACKHOE Sean Baker OTHERS Norman Lennon  
 TEST HOLES USED IN SDA \_\_\_\_\_ AVG. PERC TIME \_\_\_\_\_ SQ. FT/BR \_\_\_\_\_  
 TRENCH WIDTH \_\_\_\_\_ INLET DEPTH \_\_\_\_\_ MAX. BOT DEPTH \_\_\_\_\_ EFFECTIVE SAW \_\_\_\_\_

Hudson Property  
14285 Old Frederick Rd.

AP 12  
dk brn sl 0.8  
brn scl 2msbk to 1msbk 2.5  
yel-red sl heavy (0.8 to 0.8) 3.8  
yel-red sl few mica 5  
Common line mica (H) red-yel sl few stones 9'  
H. grey brn flsl saprolitel 12  
13 13-B  
1 brn sl 2msbk  
1 stoney layer 1'  
1 brn scl 3msbk 2'  
2 yel-red sl common mica dense, (0.4) 3.0  
3 yel-brn sl few channels common mica 6.8  
H. brn-grey 10.5  
yel-brn sl few channels 10.5  
H. brn-grey st sl 12.5  
13-C  
grey brn sl  
2 brn scl 2msbk dense sl  
5 yel-red sl few mica  
W H. brn-grey flsl 6.5  
flsl 25% 8.5  
H. brn grey 60% rock 9'  
15  
3 yel-red sl  
3 vstsl  
w/ boulders  
50% rock

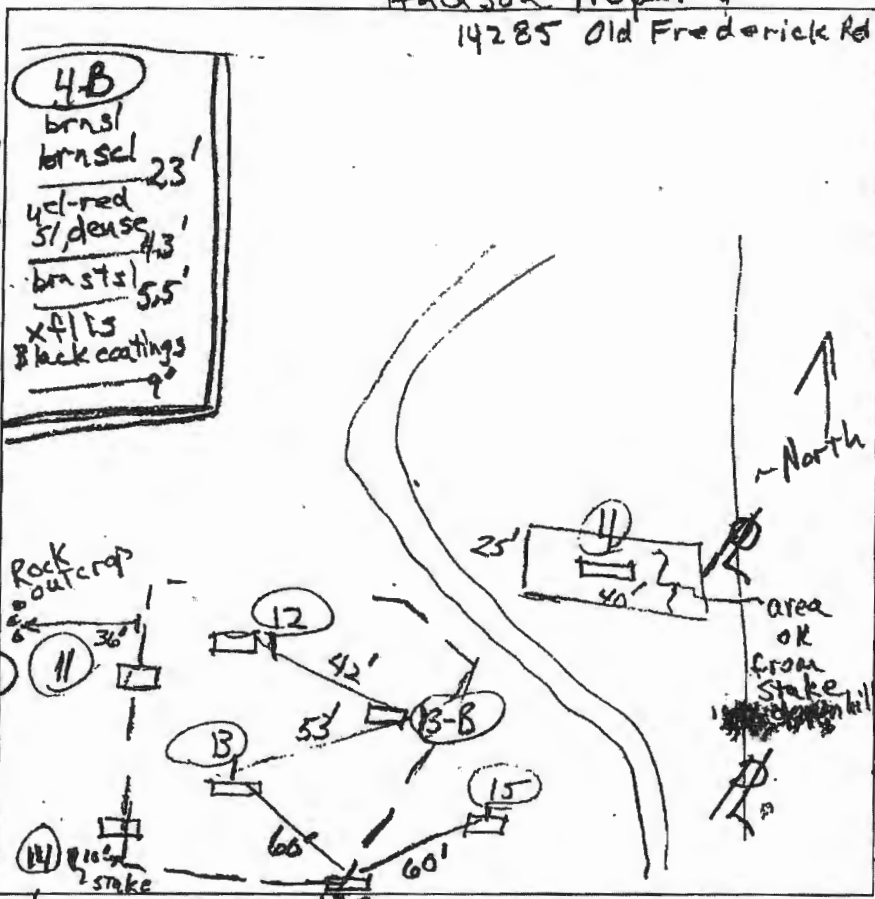

(14) offset 10'  
0.8 brn scl 2msbk few stones  
1.6 yel-red stsl dense, heavy  
3.3 yel-red, dk brn & yel-brn sl many mica  
6.5 H. grey-brn sl, few stones  
7.3 H. brn grey sl 20% mica increasing  
8.8  
11  
0.5 dk. grey brn sl  
1.3 brn scl 2msbk  
2.5 yel-red sl dense, heavy  
5.5 yel-red sl few mica few stones  
7 H. brn grey stsl 25%  
9 H. brn grey vstsl 40%  
4  
1.6 brn scl 2msbk 6.5  
2.6 brn scl 1msbk  
2.6 yel-red sl dense, heavy  
5.5 grey-brn yel-brn & yel-red sl  
10.5 H. grey brn flsl 25%  
12

DATE	TEST #	DEPTH	START	BREAK 1" DROP	STOP 2" DROP	TIME OF 2ND INCH	P/F/H
7/28/10	12	5.5' / 12'	10:44	10:46	10:49	3	P
7/28/10	13	5.7' / 12.5'	10:56	10:59	11:03	4	P
7/28/10	13-B	12.5'	Visual	Sidewall 3' to 8'	1.29 rd 4.2		P
7/28/10	13-C	3.8' / 8.5'	11:39	11:42	11:46	4	P
7/28/10	14	4.4' / 8.8'	12:20	12:22	12:24.30	2.5'	P
7/28/10	11	4' / 9'	1:12	1:18	1:32	14	P
7/28/10	4	5.5' / 12'	1:34	1:48	Pulled; reshelf		
	reshelf 4	6' / 12'	1:55	2:03	2:18	15	P
7/28/10	4B	5.5'	Visual	80% to 90% rock to 9'			F
	11, 14 & 15	3'	Visual	> 50% rock			F

REMARKS 11, 14 & 15 are boundaries

SANITARIAN RB BACKHOE Sean Baker OTHERS Norm Lennan

TEST HOLES USED IN SDA AVG. PERC TIME SQ. FT/HR

TRENCH WIDTH INLET DEPTH MAX. BOT DEPTH EFFECTIVE S/W

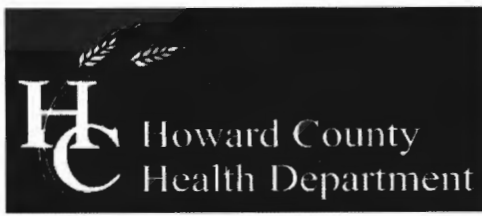

Bureau of Environmental Health  
7178 Columbia Gateway Drive, Columbia, MD 21046-2147  
(410) 313-2640 Fax (410) 313-2648  
TDD (410) 313-2323 Toll Free 1-866-313-6300  
website: www.hchealth.org

**Peter L. Beilenson, M.D., M.P.H., Health Officer**

August 4, 2010

Norman Lennon, Applicant  
Future Building and Construction Company, Inc.  
12020 Windsor Moss  
Ellicott City, Maryland 21042

RE: PERCOLATION TEST RESULTS, 14285 Old Frederick Road', A-533266

Mr. Lennon,

Percolation testing was conducted on the subject property on July 28, 2010. Field data collected are shown on three Percolation Test Worksheets enclosed with this letter. Recommended Inlet and Trench Bottom Depths, and Usable Sidewall are provided for subsequent system design, and all are based on observed soil properties and characteristics at respective test locations as well as the particular soils materials tested.

Percolation test results indicate that soil conditions both satisfactory and unsatisfactory for wastewater disposal occur in the area investigated. Test locations were added in the field so as to define boundaries of the area approvable as a septic reserve. The relative locations of the tests are sketched on the field worksheets. The locations of the percolation tests need to be platted to determine if the usable area of satisfactory soils comprises 10,000 square feet.

Unsatisfactory soil conditions occur on various landscape positions, and are characterized by shallow depth to fractured rock greater than 50 percent (by volume) or 'refusal'. Unsatisfactory conditions occur at or near staked locations 15, 3, 10 and 9 (offset 57 ft. downslope), and at added locations '4-B' (approx. 25 feet upslope of #4) and '13-D' (downslope of #14 and #13-C).

Soil conditions satisfactory for wastewater disposal occur at staked locations 4, 11, 12, 13 and 14, and at added locations '13-B' and '13-C'. Because of soil characteristics observed in the respective excavations, locations 11, 14 and 13-C mark boundaries of a satisfactory septic reserve area. Generally, the approvable area has moderately rapid rate of infiltration in the soil layers tested. An exception is the area represented by location #4 where infiltration is moderately slow in a soil layer that begins at about 5.5 feet depth. The approvable area is dissected by, and therefore impacted by, a gravel driveway. Future use of the gravel drive is undetermined at this time.

The initial septic system distribution trenches for new construction are to be installed in the highest elevation of the septic reserve. On the subject property the highest portion of area approvable as a septic reserve is represented by location #4. Pending

location of the residence and elevation of the first floor, a pump tank may be required to distribute wastewater to the upper septic reserve area.

Further review of this proposal is contingent upon submission of a Percolation Certification Plan that meets state and county requirements. The Percolation Certification Plan for development of the subject property must show a septic reserve area of at least 10,000 square feet and three discrete well locations (or 1500 square foot wellbox), and proper spatial relationships to a proposed residence footprint or 'building envelope'. The plan will include a note stipulating that the well will be drilled and the Well Completion Report approved by the Health Department prior to Health Department approval of the building permit application.

If you have any questions regarding this matter, please contact me at the above address or by calling (410) 313-2691.

Respectfully,

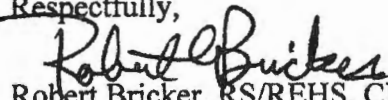
  
Robert Bricker, RS/REHS, CPSS  
Well and Septic Program  
Development Coordination Section

Enclosures

Copy: Richard C. Hudson, owner  
Scott Shanaberger, Shanaberger and Lane, Inc.  
File