

1/12/98  
wood  
1/20/98  
2:00

# PERMIT

## SEWAGE DISPOSAL SYSTEM

DEPARTMENT OF HEALTH AND MENTAL HYGIENE

04 - 350 818

P 59274

A 57065

DISTRICT 4th

DATE 12-19-97

DATE SYSTEM APPROVED 1-20-98

INSPECTOR ALM

HOWARD COUNTY HEALTH DEPARTMENT  
BUREAU OF ENVIRONMENTAL HEALTH  
~~XXXXXXXX~~ 410-313-2640

INDEXED

Renaissance Homes IS PERMITTED TO INSTALL  ALTER

ADDRESS 12030 Sunrise Valley Drive, Reston, Virginia 22191 PHONE 703-620-4100

SUBDIVISION Cattail Creek LOT 1 ROAD 3602 Broadleaf Court

PROPERTY OWNER Mr. and Mrs. Anthony Zimmerman

ADDRESS \_\_\_\_\_

SEPTIC TANK CAPACITY 1250 GALLONS

NUMBER OF BEDROOMS 4

180 SQUARE FEET PER BEDROOM

LINEAR FEET OF TRENCH REQUIRED 240

TRENCHES - Trench to be 3 feet wide. Inlet 4 feet below original grade. Bottom maximum depth 6 feet below original grade. Effective area begins at 4 feet below original grade. 2 feet of stone below distribution pipe.

LOCATION - Place distribution box 145 feet from right lot line (along Sycamore Valley Run) and 180 feet from front lot line as view from Broadleaf Court. Install trenches on contour initially toward rear lot line, then in both directions from distribution box.

NOTES - No trench to exceed 100 feet in length. Provide 6" - 8" diameter cleanout and cap to grade or above on septic tank.

ok km 9/29/97

PLANS APPROVED BY Ronald J. Pinkley DATE 09/26/97

COVER NO WORK UNTIL INSPECTED AND APPROVED

NEITHER THE HOWARD COUNTY COUNCIL NOR THE HEALTH DEPARTMENT IS RESPONSIBLE FOR THE SUCCESSFUL OPERATION OF ANY SYSTEM

NOTE: CLEANOUT REQUIRED EVERY 70 FEET OF SEWER LINE AND/OR AT 90° SWEEPS IN LINES FROM HOUSE TO DRAIN FIELDS, 90° ELBOWS NOT ACCEPTABLE.

NOTE: ALL PARTS OF SEPTIC SYSTEMS (I.E. TANK, DISTRIBUTION BOX TRENCHES) TO BE 100 FEET FROM WELL (UNLESS OTHERWISE SPECIFICALLY AUTHORIZED)

NOTE: IF DEEP TRENCH(ES) ARE USED CALL FOR INSPECTION BEFORE AND AFTER PLACING GRAVEL IN TRENCH(ES)

NOTE: NO DRY WELL SHALL EXCEED 15 FOOT IN DIAMETER NO ABSORPTION TRENCH TO EXCEED 100 FEET IN LENGTH

NOTE: ALL PIPE FROM HOUSE TO SEPTIC TANK MUST BE CAST IRON OR SCHEDULE 35/40 PVC OR ABS

PERMIT VOID AFTER TWO YEARS

NOTE: INSTALL STAND PIPE ON SEPTIC TANK AND DRY WELL STAND PIPES MUST BE 6 INCHES IN DIAMETER CAST IRON. CONCRETE OR TERRA COTTA OR PVA OR ABS ACCEPTED. IF TOP OF SEPTIC TANK IS DEEPER THAN 3 FEET. MANHOLE TO GRADE REQUIRED.

NOTE: DISTRIBUTION BOXES MUST HAVE BAFFLES

**\*INSTALLER IS RESPONSIBLE FOR OBTAINING FINAL APPROVAL ON THIS PERMIT**

A 57065

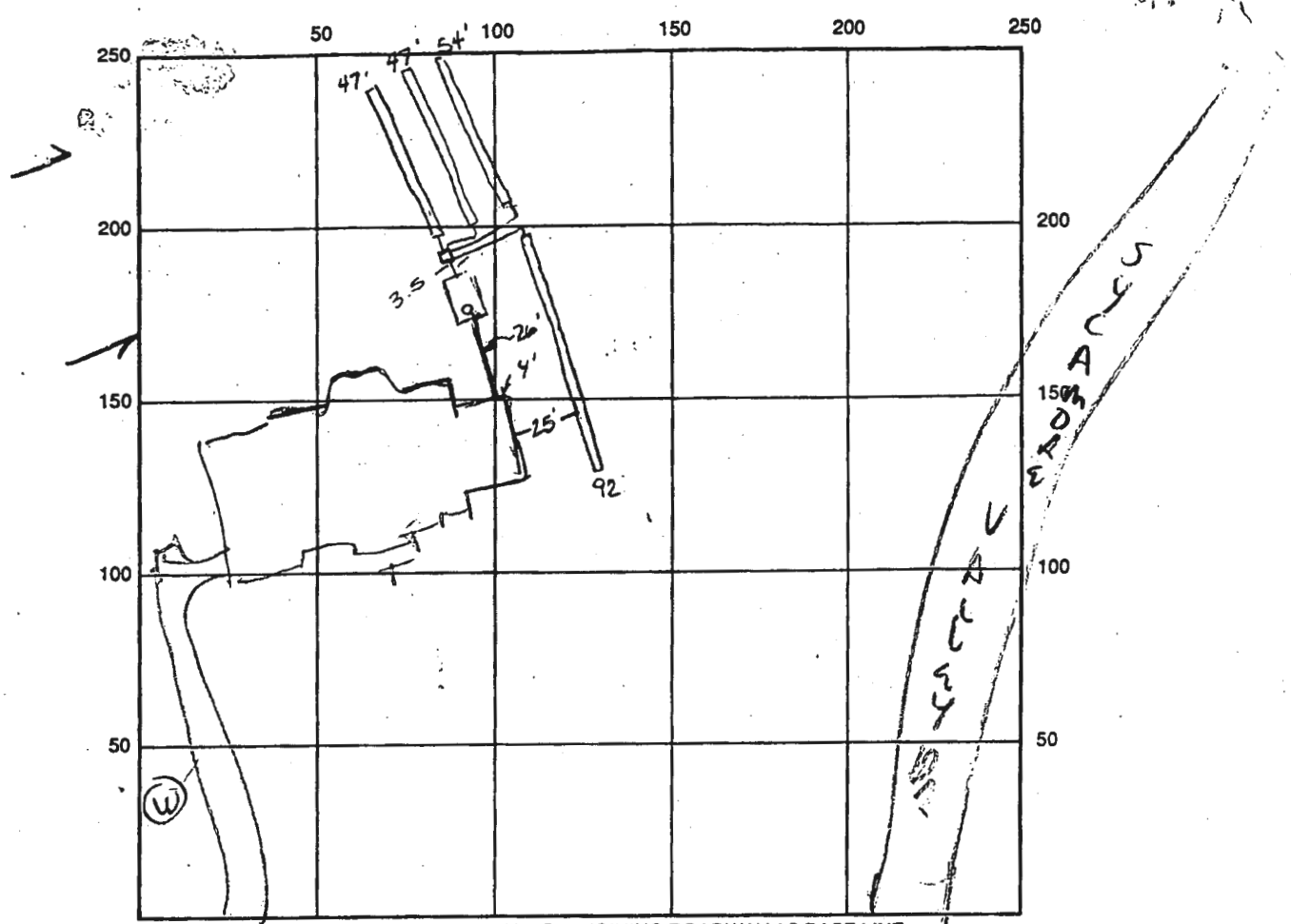

INDICATE NORTH - NAME ADJOINING ROADWAY AS BASE LINE  
*BROADWAY*

SEPTIC TANK LEVEL OK - 1250 CLEANOUTS 1 ON TANK  
 DISTRIBUTION BOX LEVEL OK baffle is in  
 DRAIN FIELD/TITLE DEPTH 6.0 FT. TRENCH WIDTH 3.0 FT. INLET DEPTH 4.0 FT.  
 EFFECTIVE GRAVEL DEPTH 2.0 FT. TOTAL LENGTH 240 FT.  
 NUMBER OF TRENCHES 3.0 ONE SIDEWALL/BOTTOM AREA 720 SQ. FT.  $\frac{240}{20}$   
 DRYWALL INSIDE DIAMETER      FT. EFFECTIVE DEPTH BELOW INLET      FT.  
 ABSORBENT AREA      SQ. FT.

REMARKS: 1-12-98 TANK SET, NO LINES YET COVER EXCEPT ENDS BECAUSE BY  
1-12-98 OK TO COVER TO DIST BOX. 1-20-98 OK TO COVER ALL WORK  
Final All

DATE SYSTEM APPROVED 1/20/98 INSPECTOR A McMillan