

Bureau of Environmental Health

8930 Stanford Boulevard, Columbia, MD 21045

Main: 410-313-2640 | Fax: 410-313-2648

TDD 410-313-2323 | Toll Free 1-866-313-6300

www.hchealth.org

Facebook: www.facebook.com/hocohealth

Maura J. Rossman, M.D., Health Officer

RECEIPT DATE: 05/01/2020 ONSITE SEWAGE DISPOSAL SYSTEM

P 567380

APPROVAL DATE: 05/17/2021 PERMIT: CONSTRUCTION

A

PROPERTY ADDRESS: 6510 Heather Glen Way, Clarksville, MD 21029

SUBDIVISION: Naecker Property LOT: 5 TAX ID: 05-593282

CONTRACTOR: Hatfields Equipment, Inc. EMAIL: ken@hatfieldsequipment.com

CONTRACTOR ADDRESS: P.O.Box 519, Annapolis Junction, MD 20701 PHONE: (301)490-4289

PROPERTY OWNER: Nadeem and Zeenat Hashmi EMAIL: Nhashmi108@gmail.com

OWNER ADDRESS: 10229 New Forest Court, Ellicott City, MD 21042 PHONE:

SEPTIC TANK SIZE (GALLONS): 2000 TANK MANUFACTURER: Mayer Bros., Inc.

PUMP MODEL: Goulds WE03 PUMP SIZE 0.3 HP PUMP TANK CAPACITY: 2000

DISTRIBUTION SYSTEM: [X] GRAVITY [] PRESSURE DOSED BEDROOMS: 6 APPLICATION RATE: 0.8

TRENCHES:	LINEAR FEET REQUIRED: 158	INLET DEPTH: 2
	TRENCH WIDTH: 3	MAXIMUM BOTTOM DEPTH: 6
	MINIMUM SPACE BETWEEN TRENCHES: 11	EFFECTIVE AREA BEGINNING DEPTH: 2
LOCATION:	PER APPROVED SITE PLAN. SEWAGE DISPOSAL AREA AND TANK LOCATIONS MUST BE STAKED BY LICENSED SURVEYOR PRIOR TO PRE-CONSTRUCTION INSPECTION.	
NOTES:	System must PASS a Pump & Alarm Test before attending Environmental Sanitarian grants Final Approval on this permit.	

ISSUED BY: R BRICKER ISSUE DATE: EXPIRATION DATE:

NOTE: CONTRACTOR MUST SCHEDULE A PRE-CONSTRUCTION INSPECTION PRIOR TO BEGINNING ANY INSTALLATION

NOTE: CONTRACTOR MUST SCHEDULE AN INSPECTION AND GAIN APPROVAL OF ALL COMPONENTS PRIOR TO COVERING

NOTE: STONE MUST BE APPROVED BY HEALTH DEPARTMENT AND GRAVEL TICKET MUST BE AVAILABLE FOR REVIEW.

NOTE: WATERTIGHT TANKS REQUIRED

NOTE: ALL PARTS OF SEPTIC SYSTEM SHALL BE AT LEAST 100 FEET DOWNGRADIENT FROM ANY WATER WELL

NOTE: MANHOLE RISERS REQUIRED ON ALL SEPTIC TANKS AND PUMP CHAMBERS

NOTE: AN ELECTRICAL PERMIT IS REQUIRED FOR INSTALLATION OF ANY ELECTRICAL COMPONENTS OF THE SYSTEM

[] ELECTRICAL PERMIT ISSUED E 70003683

NOTE: MDE RECOMMENDS SEPTIC TANKS, BAT, AND OTHER PRETREATMENT UNITS BE PUMPED AT A FREQUENCY ADEQUATE TO ENSURE THAT SOLIDS ARE NOT DISCHARGED TO THE DISPOSAL AREA

NEITHER THE HOWARD COUNTY COUNCIL NOR THE HEALTH DEPARTMENT IS RESPONSIBLE FOR THE SUCCESSFUL OPERATION OF ANY SYSTEM.

PERMITTEE RESPONSIBLE FOR OBTAINING FINAL APPROVAL ON THIS PERMIT.

CALL 410-313-1771 TO SCHEDULE INSPECTIONS.

© 11-22-20



TRENCH/DRAINFIELD DATA

WIDTH	INLET	BOTTOM
3'	2'	6'
NUMBER OF TRENCHES		4
TOTAL LENGTH		176 F
ABSORPTION AREA		528 SF + SIDE WALK
DISTRIBUTION BOX LEVEL		N/A
DISTRIBUTION BOX BAFFLE		YES
DISTRIBUTION BOX PORT		YES

PRE-CONSTRUCTION:

SEPTIC TANK DATA

SEPTIC TANK I LEVEL 48

MANUFACTURER Babylon

CAPACITY 2000 GAL

SEAM LOC top

TANK LID DEPTH 2'

BAFFLES front + back

BAFFLE FILTER -

MANHOLE LOC front + back

6" PORT LOC -

WATERTIGHT TEST -

SLOTTED yes

DATE ON LID 5-18-20

PUMP/SEPTIC TANK LEVEL yes

MANUFACTURER Babylon

CAPACITY 2000 GAL

SEAM LOC top

TANK LID DEPTH 1.5'

BAFFLES -

BAFFLE FILTER -

MANHOLE LOC front + back

6" PORT LOC -

WATERTIGHT TEST -

SLOTTED -

DATE ON LID 5-4-20

ROAD NAME

6/11/20 - layout complete, SDA stakes in place, tanks (x2) stakes in place, 4 40' trenches on contour, dbox & pump line painted. (RP)

INSTALLATION: 7/1/2020 SHC, tanks, force main and d-box set. (S) 07/02/2020 TRENCHES COMPLETE. PEINSPECT P/A.

↳ EXTRA LENGTH INSTALLED TO USE UP ORDERED STONE. (+)

05/18/2020 PUMP AND ALARM OK. (P)

FINAL INSPECTOR

[Signature]

DATE OF APPROVAL

05/17/2021

6510 Heather Glen Way
NOT TO SCALE

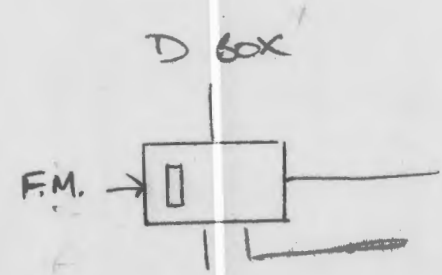
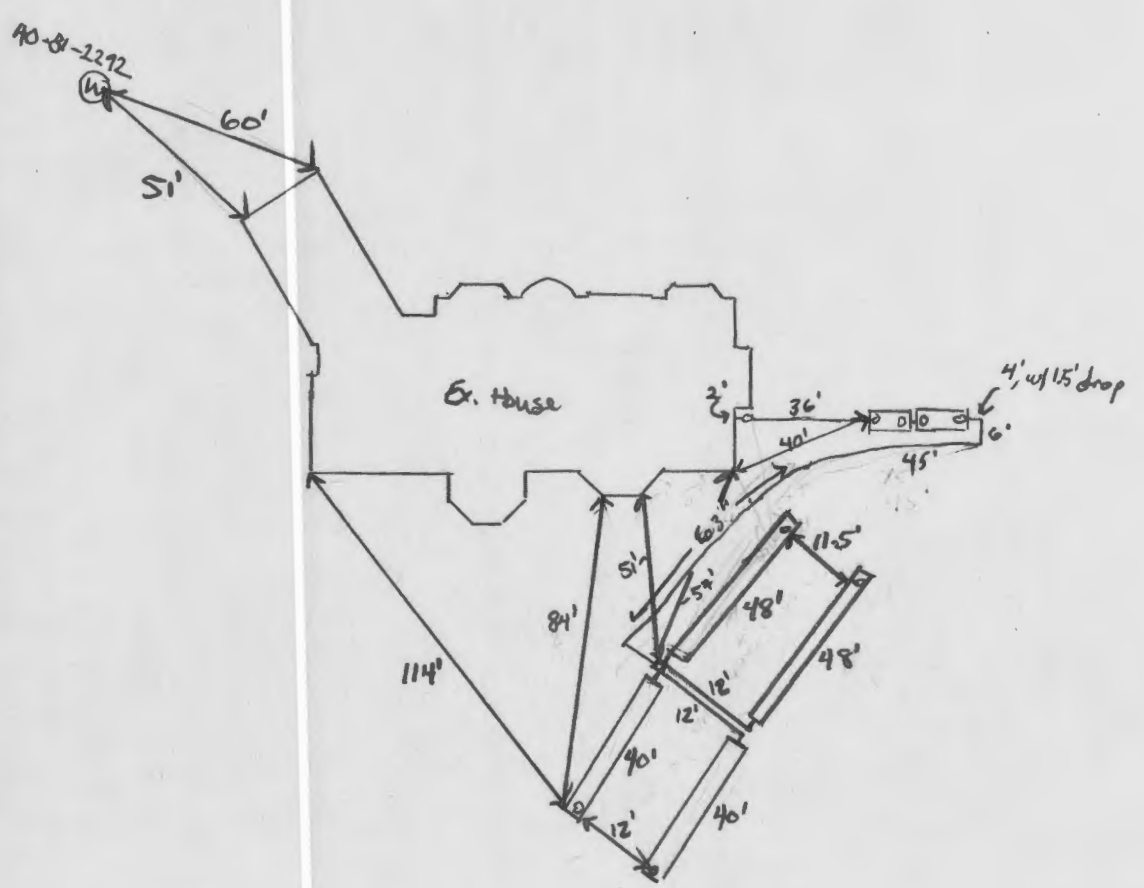

05-405556 12-22-87 11AM

PERMIT

P 40628

SEWAGE DISPOSAL SYSTEM

A 37656

MARYLAND STATE DEPARTMENT OF HEALTH*

DISTRICT 5th 6

HOWARD COUNTY
BUREAU OF ENVIRONMENTAL HEALTH
461-9933

INDEXED

DATE 12-10-87

DATE SYSTEM APPROVED 12/23/87

INSPECTOR C. Smith

{ I.C.O.P. issued only }
Time expired

Donald Kramer

IS PERMITTED TO INSTALL X ALTER

ADDRESS 4305 Ten Oaks Road, PHONE 531-2342

SUBDIVISION Naecker Property ROAD 6510 Prestwick Drive LOT 5

PROPERTY OWNER Randy Smith

ADDRESS _____

IF GARBAGE GRINDER IS USED INCREASE SEPTIC TANK CAPACITY BY 50% AND ABSORPTION AREA BY 22%.

GARBAGE GRINDER? YES _____ NO X

SEPTIC TANK CAPACITY 1000 GALLONS NUMBER OF BEDROOMS 3

TRENCHES - 180 sq. ft. per bedroom. Trench to be 3 feet wide. Inlet 3 feet below original grade. Bottom maximum depth 4.5 feet below original grade. Effective area begins at 3.0 feet below original grade. 1.5 feet of stone below distribution pipe.

LOCATION - Place the distribution box 150 feet down the right (435.6') lot line and 110 feet off the same lot line as seen when facing the lot from Right-of-way at Prestwick Drive. Run trenches on contour toward the left lot line.

NOTE - No trench to exceed 100 feet in length. Provide 6" - 8" diameter cleanout and cap to grade or above on septic tank. (L. JEN) 12-10-87

PLANS APPROVED BY S. Abel DATE 9/08/87

COVER NO WORK UNTIL INSPECTED AND APPROVED.

NEITHER THE HOWARD COUNTY COUNCIL NOR THE HEALTH DEPARTMENT IS RESPONSIBLE FOR THE SUCCESSFUL OPERATION OF ANY SYSTEM.

NOTE: CLEANOUT REQUIRED EVERY 70 FEET OF SEWER LINE AND/OR AT 90° SWEEPS IN LINES FROM HOUSE TO DRAIN FIELDS.

NOTE: ALL PARTS OF SEPTIC SYSTEMS (I.E., TANK, DISTRIBUTION BOX, TRENCHES) TO BE 100 FEET FROM WELL. (UNLESS OTHERWISE SPECIFICALLY AUTHORIZED)

NOTE: IF DEEP TRENCH(IES) ARE USED CALL FOR INSPECTION BEFORE AND AFTER PLACING GRAVEL IN TRENCH(IES).

NOTE: NO DRY WELL SHALL EXCEED 15 FOOT IN DIAMETER. NO ABSORPTION TRENCH TO EXCEED 100 FEET IN LENGTH.

NOTE: ALL PIPE FROM HOUSE TO SEPTIC TANK MUST BE CAST IRON OR SCHEDULE 40 PVC OR ABS.

PERMIT VOID AFTER TWO YEARS.

NOTE: INSTALL STAND PIPE ON SEPTIC TANK AND DRY WELL. STAND PIPES MUST BE 6 INCHES IN DIAMETER. CAST IRON, CONCRETE OR TERRA COTTA OR PVC OR ABS ACCEPTED. IF TOP OF SEPTIC TANK IS DEEPER THAN 3 FEET, MANHOLE TO GRADE REQUIRED.

NOTE: DISTRIBUTION BOXES MUST HAVE BAFFLES.

***INSTALLER IS RESPONSIBLE FOR OBTAINING FINAL APPROVAL ON THIS PERMIT**

*CALL 461-9933 FOR INSPECTION OF SEPTIC SYSTEMS.

EH - 2-1186

A 37656

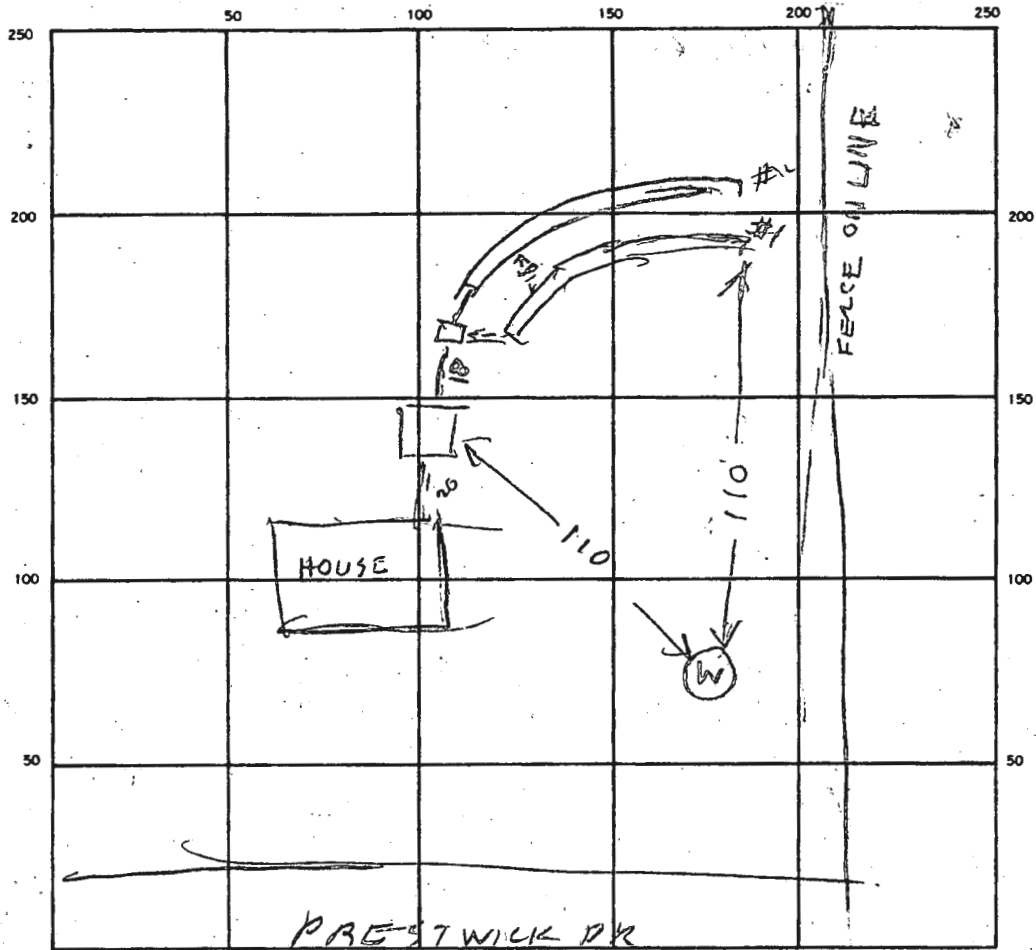

INDICATE NORTH. — NAME ADJOINING ROADWAY AS BASE LINE.

SEPTIC TANK LEVEL 1500 Babylon Vault CLEANOUTS 5/1

DISTRIBUTION BOX LEVEL _____

DRAIN FIELD/TILE FIELD DEPTH 1/2 / 5/5 FT. TRENCH WIDTH 2 / 3 FT. INLET DEPTH 1/2 FT.

EFFECTIVE GRAVEL DEPTH _____ FT. TOTAL LENGTH 112 / 99 FT.

NUMBER OF TRENCHES 2 ONE SIDEWALL/BOTTOM AREA _____ SQ. FT.

DRYWELL INSIDE DIAMETER _____ FT. EFFECTIVE DEPTH BELOW INLET _____ FT.

ABSORBENT AREA _____ SQ. FT.

REMARKS 12/4/87 LOCATION OK PER PLANS TRENCHES DUG

ADD STONE ITOOK UP TANK & BOX OK TO COVER PART OF HOUSE & WORK R/H

12/23/87 CONNECTIONS COMPLETE, CW

DATE SYSTEM APPROVED 12/23/87 INSPECTOR CW

Bricker, Robert

From: Jeremiah Reynolds <Jeremiah.Reynolds@timmons.com>
Sent: Monday, November 25, 2019 3:22 PM
To: Bricker, Robert
Cc: Williams, Jeffrey; Rob Vogel
Subject: RE: 6510 Heather Glen Way_revise OSDS Design Plan and Grading Plan
Attachments: HASHMI GRADING CROSS SECTION.pdf

[Note: This email originated from outside of the organization. Please only click on links or attachments if you know the sender.]

Robert,

We resubmitted the OSDS for the above project. In response to comment number 1 that you made concerning cutting in the SDA, I have attached an exhibit for you to review. The attached exhibit shows the proposed grading concept. See cross section A-A. We are not calling for any cut in the SDA. That area is to remain as existing grade. We are cutting up above the top of the SDA and toward the house in order to meet the clients desire for a walkout condition. I hope this clears things up. Due to your comment, I did move the proposed 432 contour out further from the upper edge of the SDA than what was originally proposed. This should create a little more buffer at the top of the SDA.

Jeremiah Reynolds

Designer

VOGEL ENGINEERING + TIMMONS GROUP | www.timmons.com
3300 North Ridge Road, Suite 110 | Ellicott City, MD 21043
Office: 410.461.7666 | Fax: 410.461.8961
Your Vision Achieved Through Ours

To send me files greater than 20MB [click here](#).

From: Bricker, Robert <RBricker@howardcountymd.gov>
Sent: Thursday, October 24, 2019 3:55 PM
To: Jeremiah Reynolds <Jeremiah.Reynolds@timmons.com>
Cc: Rob Vogel <Rob.Vogel@timmons.com>; 'raminor@comcast.net' <raminor@comcast.net>
Subject: 6510 Heather Glen Way_revise OSDS Design Plan and Grading Plan

See attached PDF.

ROBERT BRICKER, REHS/R.S., L.E.H.S.
ENVIRONMENTAL SANITARIAN II
BUREAU OF ENVIRONMENTAL HEALTH, WELL AND SEPTIC PROGRAM
8930 STANFORD BLVD., COLUMBIA, MD 21045

Phone: Desk, 410-313-2691; Program, 410-313-1771; Bureau, 410-313-1774
Fax: 410-313-2648

E-mail: rbricker@howardcountymd.gov



CONFIDENTIALITY NOTICE

This message and the accompanying documents are intended only for the use of the individual or entity to which they are addressed and may contain information that is privileged, confidential, or exempt from disclosure under applicable law. If the reader of this email is not the intended recipient, you are hereby notified that you are strictly prohibited from reading, disseminating, distributing, or copying this communication. If you have received this email in error, please notify the sender immediately and destroy the original transmission.

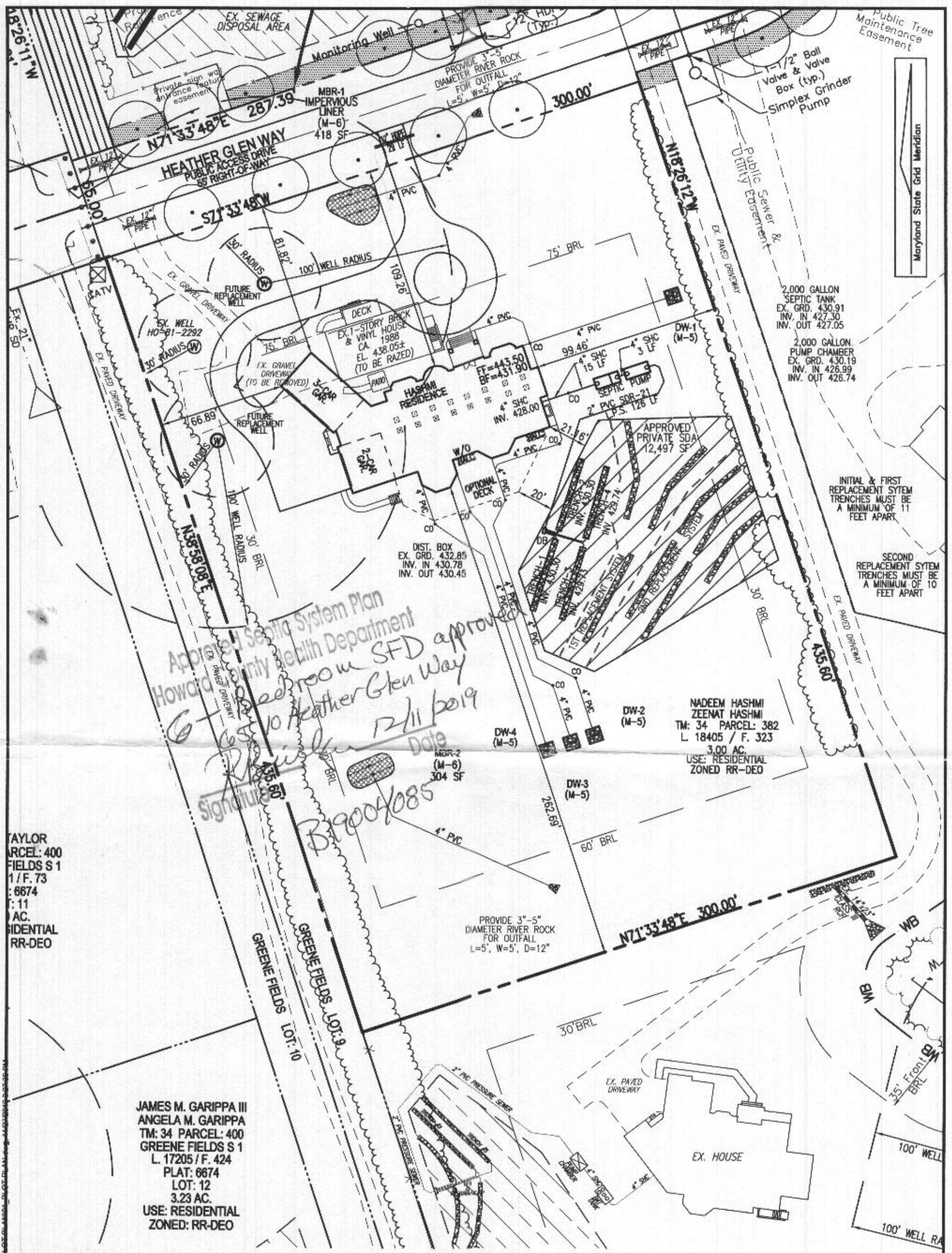

Approved Septic System Plan
 Howard County Health Department
 Approved by SFD approved
 6510 Heather Glen Way
 Date 12/11/2019
 Signature: B19004085

TAYLOR
 PARCEL: 400
 FIELDS S 1
 17 F. 73
 6674
 11
 AC.
 RESIDENTIAL
 RR-DEO

JAMES M. GARIPPA III
 ANGELA M. GARIPPA
 TM: 34 PARCEL: 400
 GREENE FIELDS S 1
 L. 17205 / F. 424
 PLAT: 6674
 LOT: 12
 3.23 AC.
 USE: RESIDENTIAL
 ZONED: RR-DEO

SITE LAYOUT
 SCALE: 1"=50'

VOGEL ENGINEERING

TIMMONS GROUP
 3300 NORTH RIDGE ROAD, SUITE 110, ELLICOTT CITY, MD 21043
 P: 410.461.7988 F: 410.461.8961 www.timmons.com

OWNER
 NADEEM HASHMI
 ZEENAT HASHMI
 10229 NEW FOREST CT.
 ELLICOTT CITY, MD 21042
 (410) 365-3702

BUILDER
 GREENFIELD HOMES, INC.
 6656 LUSTER DRIVE
 HIGHLAND, MD 20777
 (410) 365-3702

SCALE	AS SHOWN
DRAWN BY	JMR
CHECKED BY	RHV
DATE	NOVEMBER 27, 2019
W. O. #	14-33
SHEET#	1 OF 5

B19004085
 L 18405 / F. 323
 5TH ELECTION DISTRICT
 TAX MAP: 34 PARCEL: 382

PLOT PLAN
HASHMI PROPERTY
 6510 HEATHER GLEN WAY
 CLARKSVILLE, MD 21029
 REF: GP-20-037

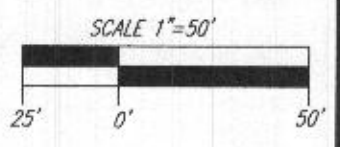

BLOCK: 17
 ZONED: RR-DEO
 HOWARD COUNTY, MARYLAND



PLAN VIEW
SCALE: 1"=50'

WELL LOCATION CERTIFICATION:
THE EXISTING WELL SHOWN ON THIS PLAN (TAG #HO-81-2292) HAS BEEN FIELD LOCATED AND IS ACCURATELY SHOWN

- GENERAL NOTES:**
1. ANY CHANGE TO THE LOCATIONS OR DEPTHS TO ANY COMPONENTS MUST BE APPROVED BY THE ENGINEER AND THE HOWARD COUNTY HEALTH DEPARTMENT PRIOR TO INSTALLATION. A REVISED SITE PLAN MAY BE REQUIRED.
 2. THE MAXIMUM EARTH COVER OVER THE TANK IS 3 FEET. GREATER EARTH COVER WILL REQUIRE A HEAVY LOAD BEARING TANK.
 3. ELECTRICAL WORK FOR THE INSTALLATION MUST BE PERFORMED BY A LICENSED ELECTRICIAN.
 4. THE WELL (HO-81-2292) HAS BEEN FIELD LOCATED AND IS ACCURATELY SHOWN.
 5. ALL WELLS AND SEPTIC SYSTEMS LOCATED WITHIN 100' OF THE PROPERTY BOUNDARIES AND 200' DOWN GRADIENT OF ANY WELLS AND/OR SEPTIC SYSTEMS HAVE BEEN SHOWN.
 6. ANY CHANGES TO A PRIVATE SEWAGE AREA SHALL REQUIRE A REVISED PERCOLATION CERTIFICATION PLAN.
 7. THE EXISTING TOPOGRAPHY SHOWN HEREON IS TAKEN FROM A FIELD RUN TOPOGRAPHICAL SURVEY, WITH 2'-FOOT CONTOUR INTERVALS, PREPARED BY VOGEL ENGINEERING + TIMMONS GROUP, DATED MARCH 04, 2019. SUPPLEMENTAL TOPOGRAPHY FROM CURRENT HOWARD COUNTY GIS DATA.

SYSTEM CALCULATIONS:

INITIAL SYSTEM:
6 BEDROOMS AT 900gpd / 0.8 ABSORPTION RATE = 1,125 SQ. FT.
1,125 SQ. FT. / 3 (TRENCH WIDTH) x .42 (SIDEWALL REDUCTION) = 158 LINEAR FEET
160 TOTAL LINEAR FEET OF TRENCH ARE PROVIDED WITH THE INITIAL SYSTEM.
(4 TRENCHES OF 40 FEET IN LENGTH)

FIRST REPLACEMENT SYSTEM:
6 BEDROOMS AT 900gpd / 0.8 ABSORPTION RATE = 1,125 SQ. FT.
1,125 SQ. FT. / 3 (TRENCH WIDTH) x .42 (SIDEWALL REDUCTION) = 158 LINEAR FEET
156 TOTAL LINEAR FEET OF TRENCH ARE PROVIDED WITH THE FIRST REPLACEMENT SYSTEM.
(3 TRENCHES OF 53 FEET IN LENGTH)

SECOND REPLACEMENT SYSTEM:
6 BEDROOMS AT 900gpd / 0.8 ABSORPTION RATE = 1,125 SQ. FT.
1,125 SQ. FT. / 3 (TRENCH WIDTH) x .63 (SIDEWALL REDUCTION) = 236 LINEAR FEET
240 TOTAL LINEAR FEET OF TRENCH ARE PROVIDED WITH THE SECOND REPLACEMENT SYSTEM.
(6 TRENCHES OF 48 FEET IN LENGTH)

INITIAL SYSTEM TRENCH INFO

TRENCH	LENGTH	TRENCH	TO BOTTOM OF EXISTING TRENCH	TO BOTTOM OF GROUND
1	40'	430.30	426.30	432.30
2	40'	430.30	426.30	432.30
3	40'	429.73	425.73	431.73
4	40'	429.74	425.74	431.74

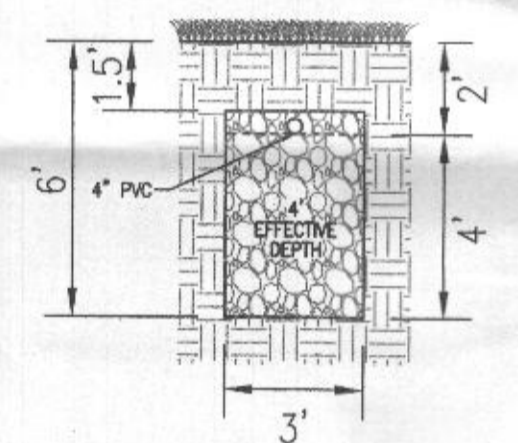

INITIAL & FIRST REPLACEMENT SYSTEM TRENCH DETAIL
NOT TO SCALE

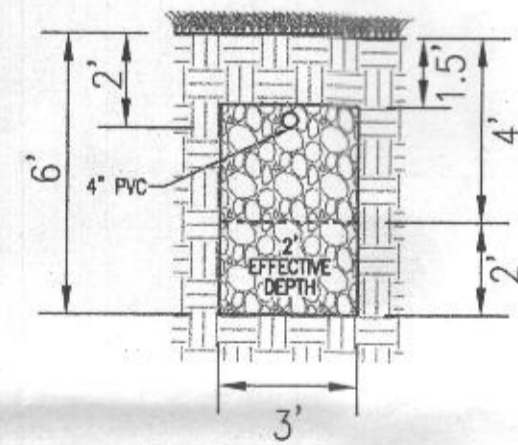

2ND REPLACEMENT SYSTEM TRENCH DETAIL
NOT TO SCALE

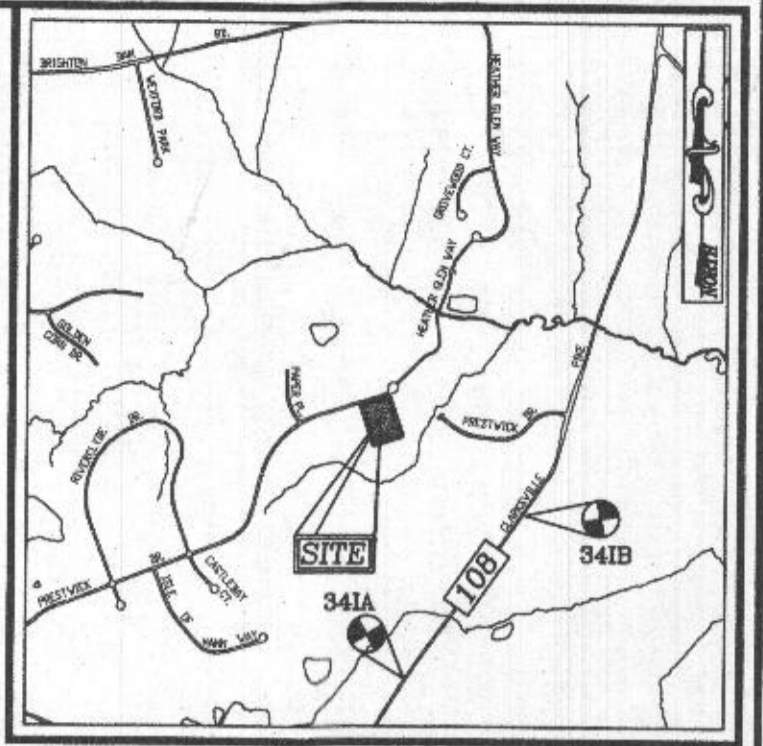

VICINITY MAP
SCALE: 1"=2000'
ADC MAP: PAGE 31 GRID C3

BENCHMARKS

HOWARD COUNTY BENCHMARK 341A (CONC. MON.)
N 553271.91 E 1325838.75 ELEV. 471.94
RT. 108, 1/2 MILE NE OF HIGHLAND ROAD

HOWARD COUNTY BENCHMARK 341B (CONC. MON.)
N 554973.52 E 1327078.77 ELEV. 442.60
RT. 108, 0.85 MILES NE OF HIGHLAND ROAD

- LEGEND:**
- PROPERTY LINE
 - - - RIGHT-OF-WAY LINE
 - - - ADJACENT PROPERTY LINE
 - - - EXISTING 10' CONTOUR
 - - - EXISTING 2' CONTOUR
 - - - EXISTING TREELINE
 - EXISTING WELL
 - EXISTING OBSERVATION WELL
 - REPLACEMENT WELL
 - - - PROPOSED 10' CONTOUR
 - - - PROPOSED 2' CONTOUR
 - ⊗ PASSED PERC. TEST
 - ⊗ FAILED PERC. TEST
 - ▨ PRIVATE SEWAGE DISPOSAL AREA (SDA)

Approved Septic System
Howard County Health Department
2000 gal Pump Tank with WECS pump
for 6-Bedroom SFD
P. Malik 11/27/2019
signature Date

OWNER
NADEEM HASHMI
ZEENAT HASHMI
10229 NEW FOREST CT.
ELLCOTT CITY, MD 21042
(410) 365-3702

BUILDER
GREENFIELD HOMES, INC.
6656 LUSTER DRIVE
HIGHLAND, MD 20777
(410) 365-3702

ONSITE SEWAGE DISPOSAL SYSTEM DESIGN PLAN

HASHMI PROPERTY
6510 HEATHER GLEN WAY
CLARKSVILLE, MD 21029
NAECKER PROPERTY - LOT 5
(L. 18405 / F. 323)
(3.00 AC.)

PARCEL: 382
ZONED: RR-DEO
HOWARD COUNTY, MARYLAND

ROBERT H. VOGEL ENGINEERING, INC.
ENGINEERS • SURVEYORS • PLANNERS
3300 N. RIDGE ROAD, SUITE 110
ELLCOTT CITY, MD 21043
TEL: 410.461.7666
FAX: 410.461.8961

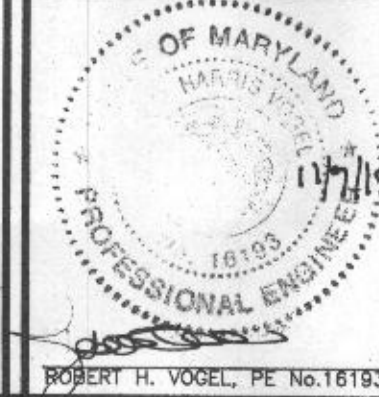

PROFESSIONAL CERTIFICATE

I HEREBY CERTIFY THAT THESE DOCUMENTS WERE PREPARED OR APPROVED BY ME AND THAT I AM A duly LICENSED PROFESSIONAL ENGINEER UNDER THE LAWS OF THE STATE OF MARYLAND, LICENSE NO. 161693, EXPIRATION DATE: 09-27-2020

DESIGN BY: RHY
DRAWN BY: JMR
CHECKED BY: RHY
DATE: NOVEMBER 2019
SCALE: AS SHOWN
W.O. NO.: 14-33

THIS AREA DESIGNATES A PRIVATE SEWAGE AREA OF AT LEAST 10,000 SQUARE FEET AS REQUIRED BY THE MARYLAND STATE DEPARTMENT OF THE ENVIRONMENT FOR INDIVIDUAL SEWAGE DISPOSAL. IMPROVEMENTS OF ANY NATURE IN THIS AREA ARE RESTRICTED UNTIL PUBLIC SEWERAGE IS AVAILABLE. THESE AREAS SHALL BECOME NULL AND VOID UPON CONNECTION TO A PUBLIC SEWERAGE SYSTEM. THE COUNTY HEALTH OFFICER SHALL HAVE THE AUTHORITY TO GRANT ADJUSTMENTS TO THE PRIVATE SEWAGE AREA. RECORDED OF A MODIFIED SEWAGE AREA SHALL NOT BE NECESSARY.

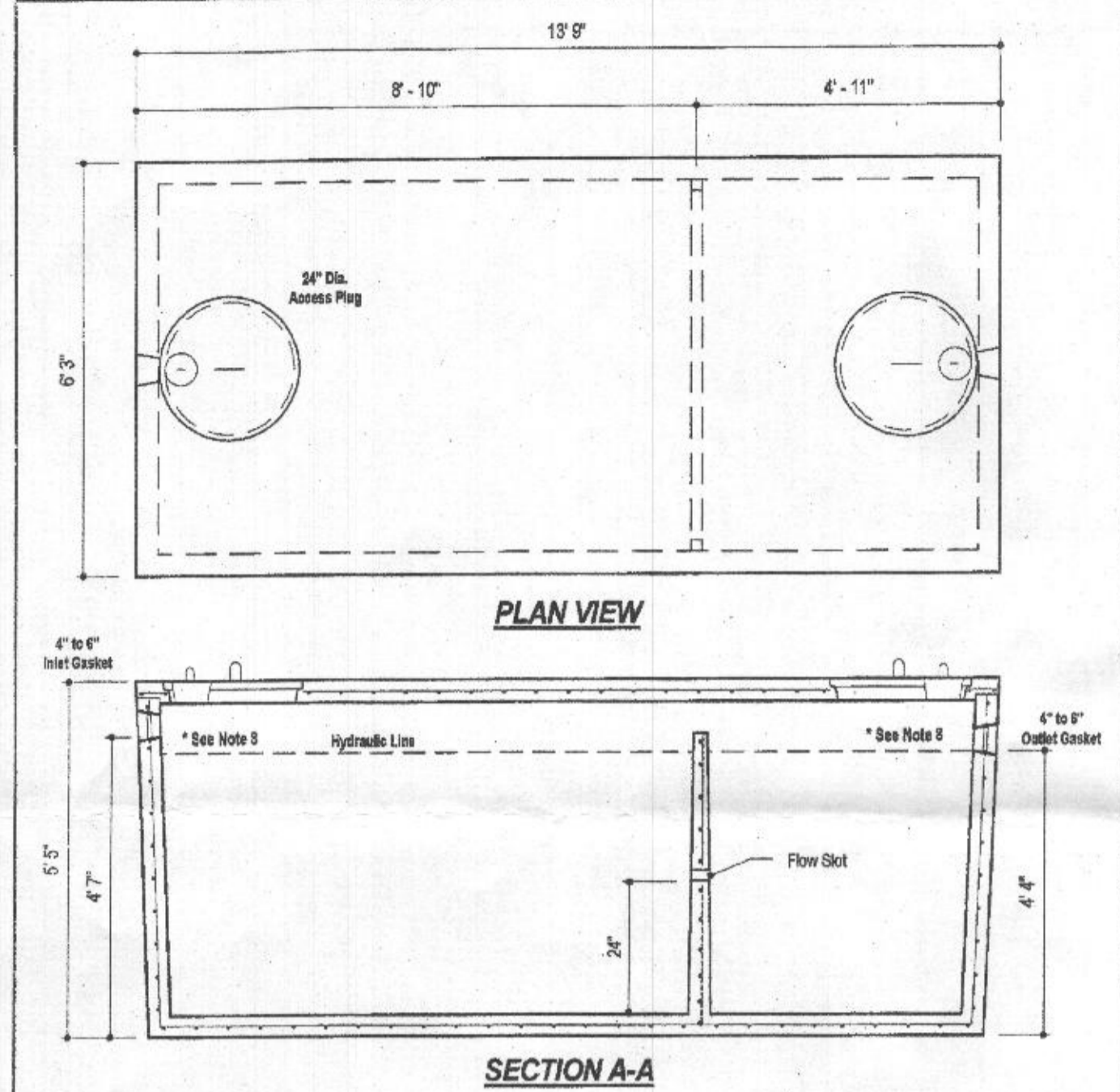

DESIGN DATA & GENERAL NOTES

- Concrete strength 4000 p.s.i. @ 28 days. Density = 150 pcf.
- Cement - Portland Type III per ASTM C 150-02.
- Admixtures & plasticizers per ASTM C 390-06 & C 494-02.
- Reinforcing per ASTM A 618. Min. 1-02" cover.
- Top slab sealed with butyl rope mastic.
- 4" wall, 4" base, & 8" top thickness.
- Max 1" of cover.
- Depending on use of tank, Inlet & Outlet baffles may be required by code.

2,000 GALLON SEPTIC TANK
2-Compartment
Stock Item [Approx. 19,900 lbs]

Mayer Bros, Inc. 6264 River Road, Elkridge, Maryland 21075. Tel: 410.796.1431, Fax: 410.796.1438. www.mayerbrosprecast.com

Dwg. No. 2000-2C No Scale Aug 11, 2008

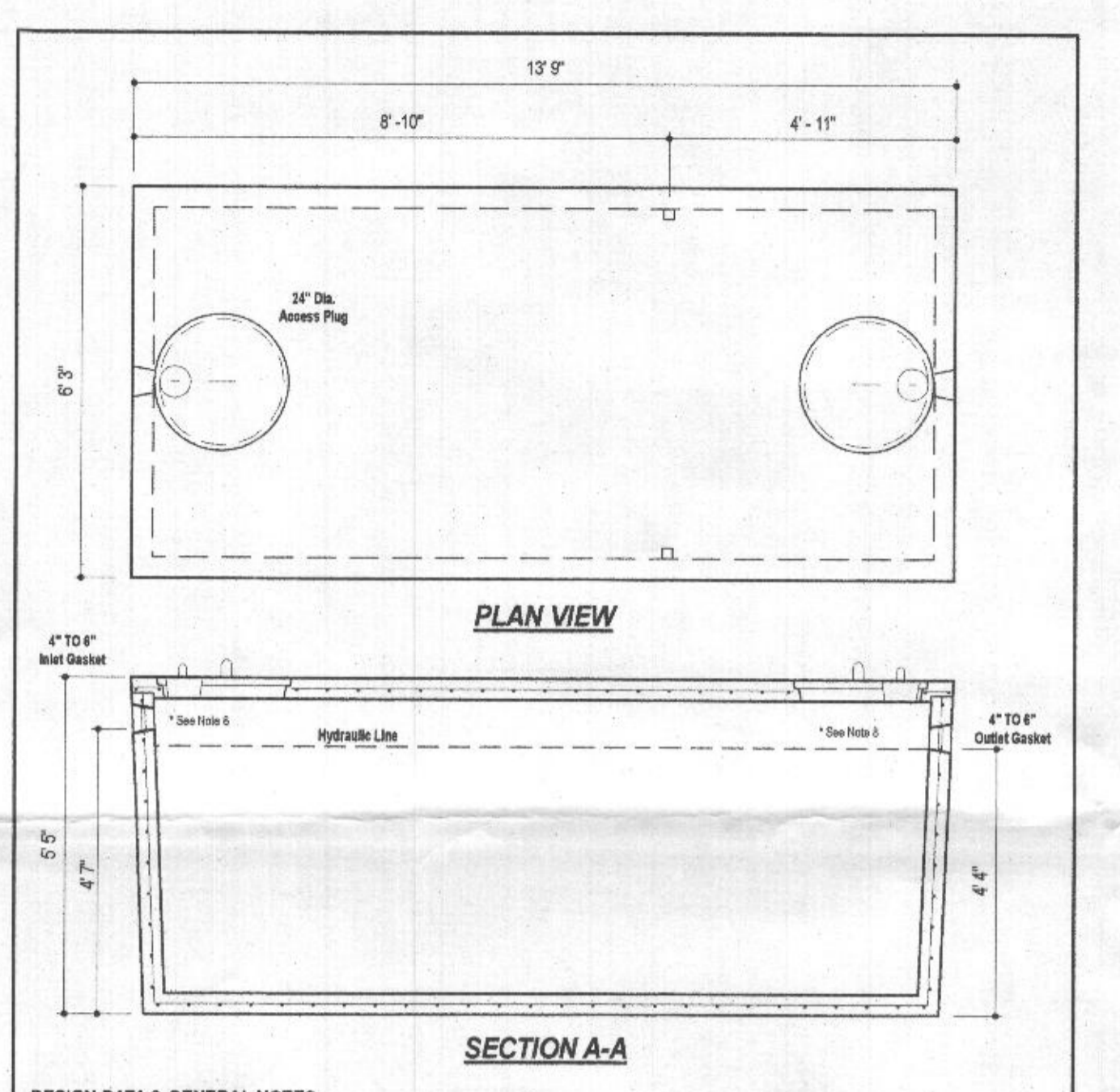

DESIGN DATA & GENERAL NOTES

- Concrete strength 4000 p.s.i. @ 28 days. Density = 150 pcf.
- Cement - Portland Type III per ASTM C 150-02.
- Admixtures & plasticizers per ASTM C 390-06 & C 494-02.
- Reinforcing per ASTM A 618. Min. 1-02" cover.
- Top slab sealed with butyl rope mastic.
- 4" wall, 4" base, & 8" top thickness.
- Max 1" of cover.
- Depending on use of tank, Inlet & Outlet baffles may be required by code.

2,000 GALLON PUMP CHAMBER
1-Compartment
Stock Item [Approx. 19,900 lbs]

Mayer Bros, Inc. 6264 River Road, Elkridge, Maryland 21075. Tel: 410.796.1431, Fax: 410.796.1438. www.mayerbrosprecast.com

Dwg. No. 2000-1C No Scale Aug 11, 2008

WEIGHT = 19,000 lbs.

2,000 GALLON PUMP CHAMBER

Goolds Water Technology

Wastewater

APPLICATIONS
Specifically designed for the following uses:
• Homes, Farms, Trailer Courts, Motels, Schools, Hospitals, Industry, Effluent Systems

SPECIFICATIONS

Pump

- Solids handling capabilities: 3/4" maximum
- Discharge size: 2" NPT
- Capacities: up to 140 GPM
- Total heads: up to 128 feet TDH
- Temperature: 104°F (40°C) continuous, 140°F (60°C) intermittent
- See order numbers on reverse side for specific HP, voltage, phase and RPM's available.

MOTORS

- Fully submerged in high-grade turbine oil for lubrication and efficient heat transfer.
- Class B insulation on 1/2 - 1 1/2 HP models.
- Class F insulation on 2 HP models.

Single phase (60 Hz):

- Capacitor start motors for maximum starting torque.
- Built-in overload with automatic reset.

AGENCY LISTINGS

Tested to UL 778 and CSA 22.2 108 Standards By Canadian Standards Association File #LR28549

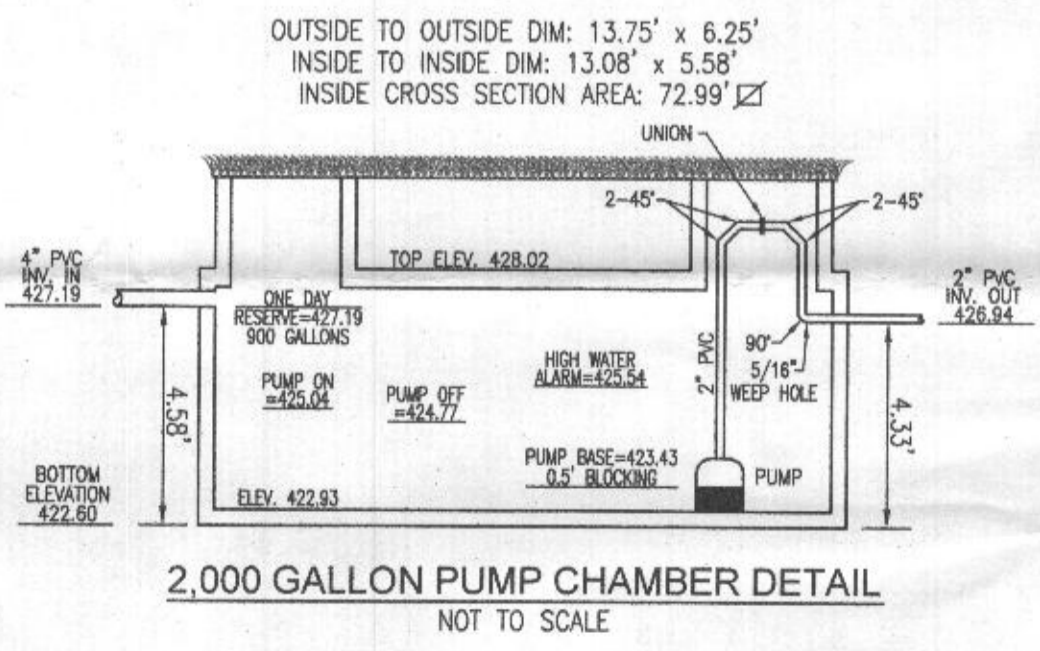
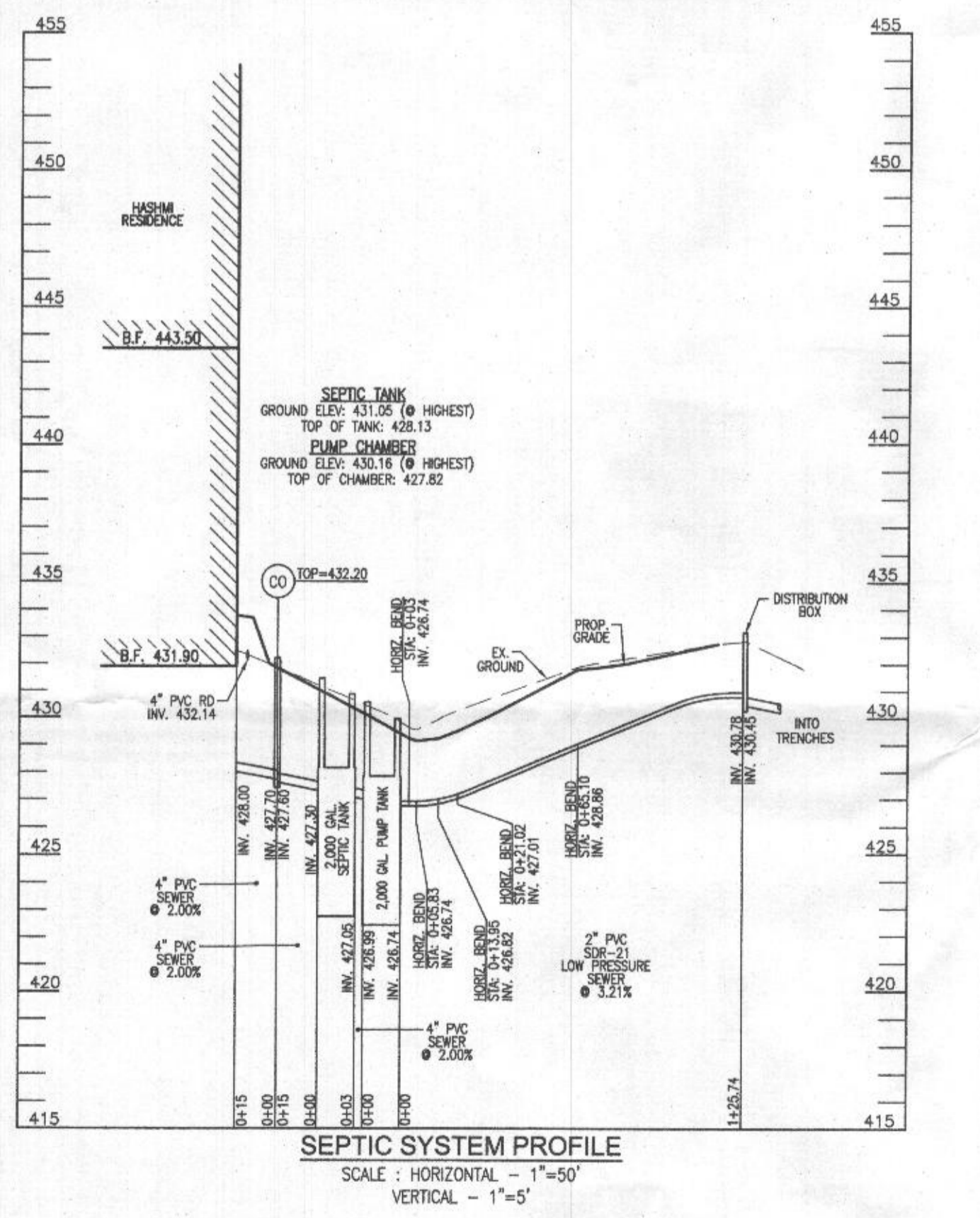
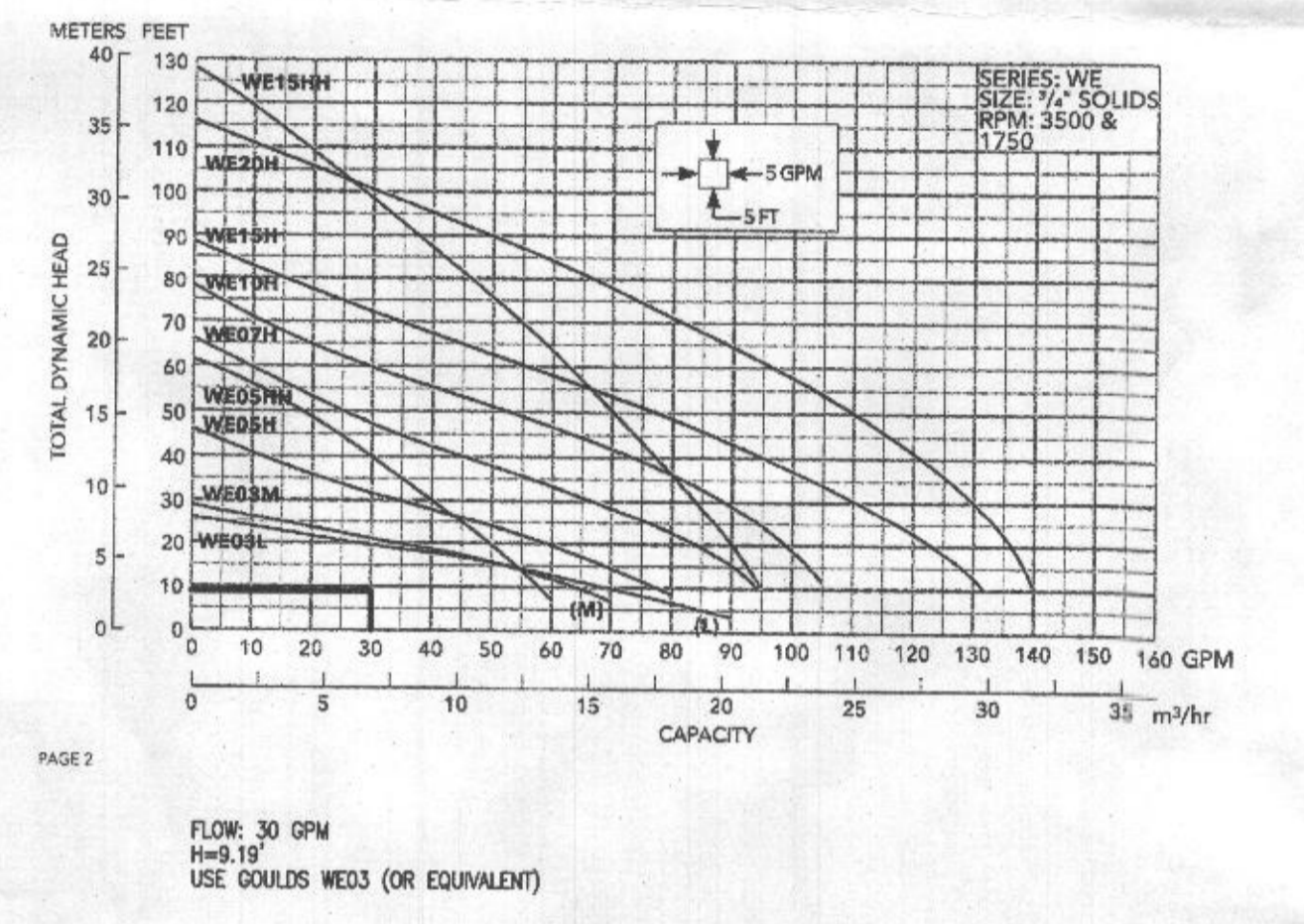

NO. BEDROOMS = 8
DESIGN FLOW = 6(150 GPD) = 900 GPD
DOSE: 1/8 DESIGN FLOW = 150 GPD
150 GALLONS/7.48 FT³/GAL = 20.05 FT³
20.05 FT³/72.99 SF = 0.27
ONE DAY RESERVE: 900 GALLONS/7.48 FT³/GAL = 120.32 FT³
120.32 FT³/72.99 = 1.65 FT

TDH (FRICTION + STATIC)
FRICTION FITTINGS: UNION: 1x2 = 2
45° ELBOW (H+V): 9x8 = 72
90° ELBOW: 1x7 = 7

FITTINGS EQ. LENGTH: 81.0 LF
PIPE LENGTH: 125.7 LF
TOTAL LENGTH: 206.7 LF

FRICTION LOSS (30 GPM): (1.54)(206.7)/100 = 3.18'
STATIC: 430.78 - 424.77 (PUMP OFF) = 6.01'
TDH: 6.01 + 3.18 = 9.19'
USE GOOLDS WE30 (OR EQUIVALENT)

Approved Septic System Plan
Howard County Health Department
2000-gal Septic Tank with
2000-gal Pump Tank and WE300 Pump
for 6-bedroom SFD or equivalent.
R. Bueker
Signature
11/27/2019
Date

OWNER
NADEEM HASHMI
ZEENAT HASHMI
10229 NEW FOREST CT.
ELLCOTT CITY, MD 21042
(410) 365-3702

BUILDER
GREENFIELD HOMES, INC.
6506 LUSTER DRIVE
HIGHLAND, MD 20777
(410) 365-3702

ONSITE SEWAGE DISPOSAL SYSTEM DESIGN PLAN

HASHMI PROPERTY
6510 HEATHER GLEN WAY
CLARKSVILLE, MD 21029
NACKER PROPERTY - LOT 5
(L. 18405 / F. 323)

5TH ELECTION DISTRICT
TAX MAP: 34 GRID: 17

PARCEL: 382
ZONED: RR-DEO
HOWARD COUNTY, MARYLAND

ROBERT H. VOGEL ENGINEERING, INC.
ENGINEERS • SURVEYORS • PLANNERS
3300 N. RIDGE ROAD, SUITE 110
ELLCOTT CITY, MD 21043
Tel: 410.461.7666
Fax: 410.461.8961

PROFESSIONAL CERTIFICATE

I HEREBY CERTIFY THAT THESE DOCUMENTS WERE PREPARED OR APPROVED BY ME AND THAT I AM A DULY LICENSED PROFESSIONAL ENGINEER UNDER THE LAWS OF THE STATE OF MARYLAND LICENSE NO. 18163 EXPIRATION DATE: 09-27-2020

DESIGN BY: RHV
DRAWN BY: JMR
CHECKED BY: RHV
DATE: NOVEMBER 2019
SCALE: AS SHOWN
W.O. NO.: 14-33

2 SHEET OF 2