

PERMIT

SEWAGE DISPOSAL SYSTEM

MARYLAND STATE DEPARTMENT OF HEALTH

HOWARD COUNTY

ELLICOTT CITY

DISTRICT 4

DATE 4/4/59

P 00704
A 00610

INDEXED

Carl V. Dorsey IS PERMITTED TO INSTALL ALTER
ADDRESS Bushy Park Rd. PHONE Syke. 484 & 4

A SEWAGE DISPOSAL SYSTEM LOCATED AT Bushy Park Rd - W. Side of Rt. 144
1 mi. off 144 South

SUBDIVISION _____ ROAD 14816 Bushy Road LOT _____

PROPERTY OWNER Carl V. Dorsey

ADDRESS William Randall 442-1314

SPECIFICATIONS

DRAIN FIELD _____ DEPTH _____ FEET, BOTTOM AREA _____ SQ. FT.

SEEPAGE PITS _____ ABSORBENT SIDE-WALL AREA 624 SQ. FT.

SEPTIC TANK CAPACITY 600 GALLONS

FOR GARBAGE GRINDER, INCREASE DISPOSAL AREA 22% & TANK CAPACITY 80%.

OTHER May use dry-well, and tile fields.

PLANS APPROVED BY J. Harrigan DATE 4/4/59

FILL SEPTIC TANK AND DISTRIBUTION BOX WITH WATER BEFORE CALLING FOR AN INSPECTION. COVER NO WORK UNTIL INSPECTED AND APPROVED.

NEITHER THE HOWARD COUNTY COMMISSIONERS NOR THE HEALTH DEPARTMENT IS RESPONSIBLE FOR THE SUCCESSFUL OPERATION OF ANY SYSTEM.

BLDG. PERMIT SIGNED AND RETURNED 3/24/59
Serial # 53000
1-cw garage

A00610

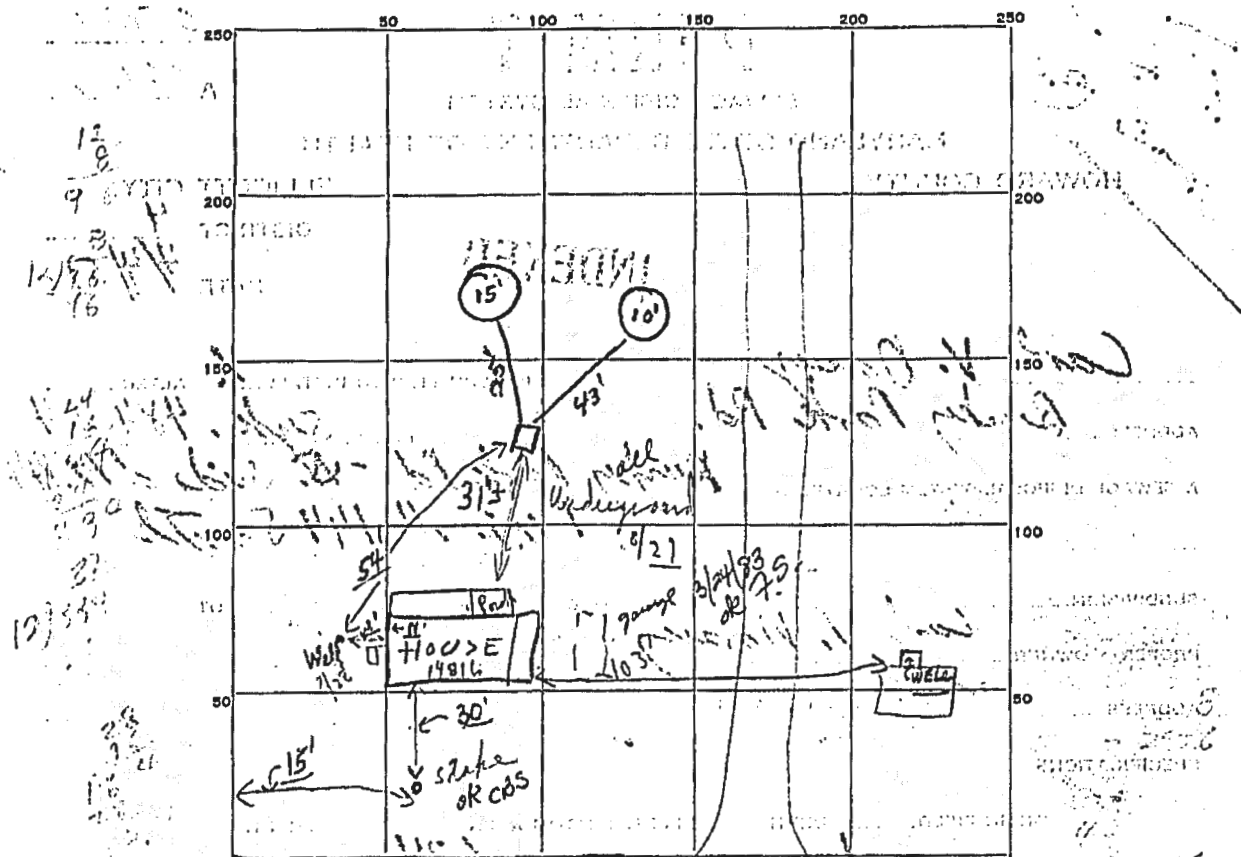

PERMIT CARD OK

SEPTIC TANK, LEVEL _____ CLEANOUTS OK 8" on Deep Well

DISTRIBUTION BOX, LEVEL _____

TILE FIELD, DEPTH _____ FT. TRENCH WIDTH _____ FT.

GRAVEL DEPTH _____ IN. TOTAL LENGTH _____ FT.

NUMBER OF TRENCHES _____ TOTAL BOTTOM AREA _____

SEEPAGE PITS, INSIDE DIAMETER: 10 | 15 FT. DEPTH BELOW INLET 8 | 8 FT.

ABSORBENT AREA 2.56 | 352 SQ. FT. = 608.5 SQ. FT.

REMARKS 4/15/59 Tanks & House sewers covered. All not back filled with gravel. Was OK Tanks & House sewers before
5/6/59 Deep Well Backfilled with gravel

DATE SYSTEM APPROVED 5/6/59 INSPECTOR Raymond Hodges