

LAYOUT 9/28/06 INSP 4 _____

INSP 2 9/29/06 INSP 5 _____

INSP 3 10/02/06 INSP 6 _____

ISSUE DATE: 7/12/2006

**PERMIT-MICROFAST 0.75
SEPTIC SYSTEM**

P 525156

APPROVAL DATE: 10/19/06

A 520021-B

TAX ID # 05-346126

**ON-SITE SEWAGE DISPOSAL SYSTEM
HOWARD COUNTY HEALTH DEPARTMENT
BUREAU OF ENVIRONMENTAL HEALTH**

Bethel Regency Homes, LLC IS PERMITTED TO INSTALL ALTER

ADDRESS: 4815 Prince Georges Ave, Beltsville MD 20705 PHONE NUMBER: 301-937-7500

SUBDIVISION _____ LOT _____

ADDRESS: 13675 Nichols Drive PROPERTY OWNER: Akin Bamisaiye

SEPTIC TANK CAPACITY (GALLONS): 1000 Top Seamed Two Compartment Tank

PUMP CHAMBER CAPACITY (GALLONS): 1000 Top seamed Two Compartment tank

MICROFAST 0.75 CAPACITY (GALLONS): 1250 High water alarm on separate circuit in the house

LOCATION:	Install trenches as shown on the approved building permit plan. Trench to be 2' wide, inlet at 4' below original grade, bottom max depth 8' below original grade, effective area begins at 6' below original grade. <u>8</u> of stone below distribution pipe.
NOTES:	A test of the pump system & distribution piping is required prior to covering the system. Water tightness test must include the risers. System is sized for a maximum of 4 bedrooms.

Note: This repair is a conventional system with pretreatment 25' of reservoir.

PLANS APPROVED: Mike Davis DATE: 7/11/06

NOTES: PERMIT VOID AFTER 2 YEARS
CONTRACTOR IS RESPONSIBLE FOR SCHEDULING A PRE-CONSTRUCTION INSPECTION FOR ALL INSTALLATIONS
WATERTIGHT SEPTIC TANKS REQUIRED
ALL PARTS OF SEPTIC SYSTEM SHALL BE 100 FEET FROM ANY WATER WELL UNLESS SPECIFICALLY AUTHORIZED
MANHOLE RISERS REQUIRED ON ALL SEPTIC TANKS AND PUMP CHAMBERS UNLESS SPECIFICALLY AUTHORIZED
CONTRACTOR RESPONSIBLE FOR COMPLIANCE WITH APPLICABLE REGULATIONS, GUIDELINES AND THE TERMS OF THIS PERMIT

**NEITHER THE HOWARD COUNTY COUNCIL NOR THE HEALTH DEPARTMENT IS
RESPONSIBLE FOR THE SUCCESSFUL OPERATION OF ANY SYSTEM
PERMITTEE RESPONSIBLE FOR OBTAINING FINAL APPROVAL ON THIS PERMIT
ALL 410-313-1771 FOR INSPECTION OF SEPTIC SYSTEM**

NOT TO SCALE

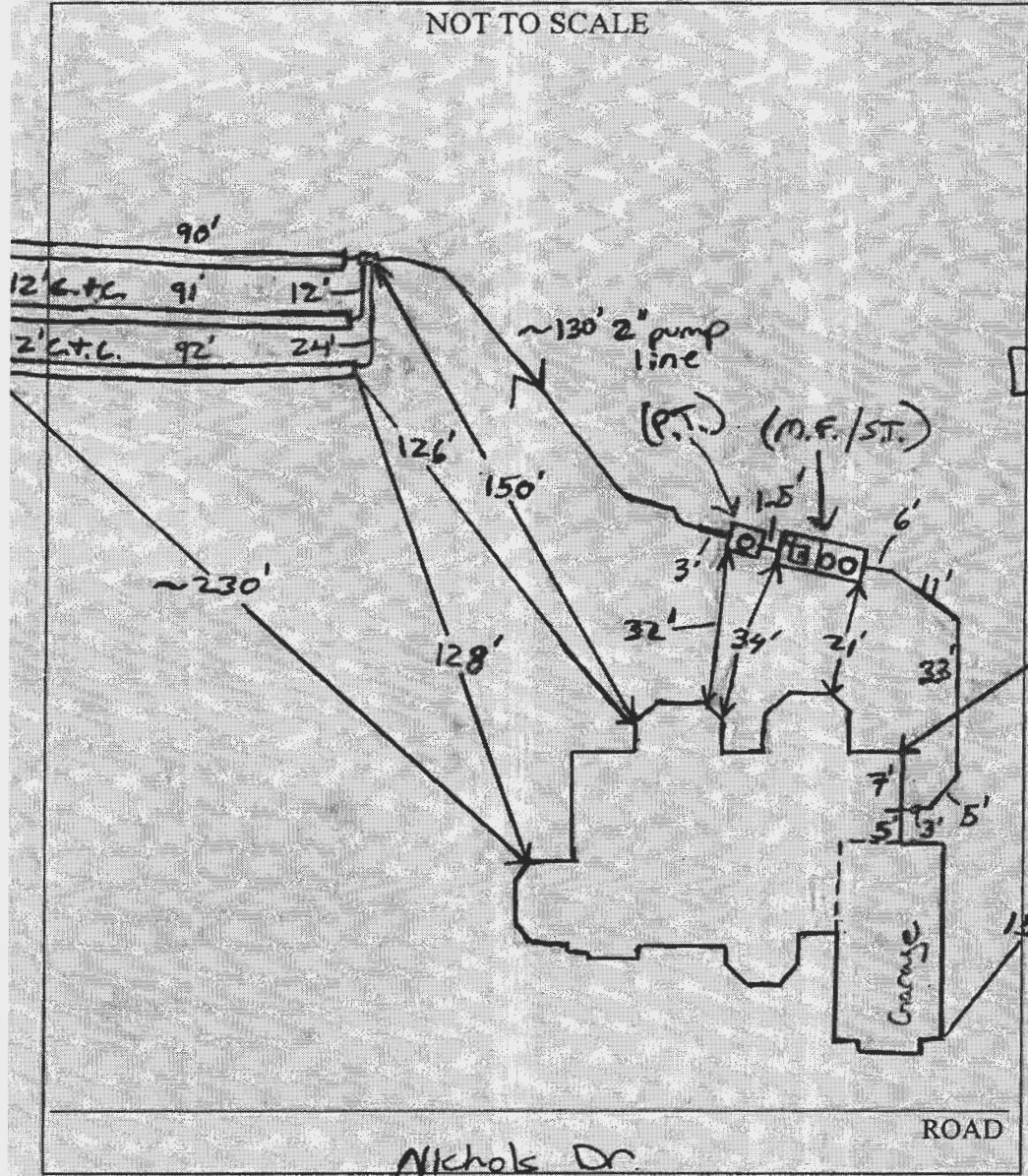

TRENCH/DRAINFIELD DATA		
WIDTH	INLET	BOTTOM
2'	3.5'-4'	8'
NUMBER OF TRENCHES		3
TOTAL LENGTH _____		
ABSORPTION AREA _____		
DISTRIBUTION BOX LEVEL		Yes
DISTRIBUTION BOX BAFFLE		NO (45')
DISTRIBUTION BOX PORT		Yes

Ex. well: HO-94-4098

SEPTIC TANK DATA		
SEPTIC TANK 1 LEVEL		
Capacity	1000	GAL
SEAM LOC	Top	
TANK LID DEPTH	1.5-2'	
BAFFLES	Yes	
BAFFLE FILTER	No	
MANHOLE LOC	Front/Rear	
6" PORT LOC	None	
WATERTIGHT TEST	NA	
PUMP TANK 1 LEVEL		
Capacity	1250	GAL
SEAM LOC	Top	
TANK LID DEPTH	2.5-3.5'	
BAFFLES	Yes (Front)	
BAFFLE FILTER	NA	
MANHOLE LOC	Center	
6" PORT LOC	Rear	
WATERTIGHT TEST	NA	
MICROFAST 0.75 TANK LEVEL		
Capacity	1000	GAL
SEAM LOC	Top	
TANK LID DEPTH	1.5-2'	
BAFFLES	Yes	
BAFFLE FILTER	-	
MANHOLE LOC	None	
6" PORT LOC	Side/Front	
WATERTIGHT TEST	-	

PRE-CONSTRUCTION

9/28/06 Install Trenches as shown per plan.

Two 85' trenches and one 90' trench. Septic tank & microfast tank will come as one unit separate of pump tank. Install tanks per plan make sure tanks are 20' from dwelling. (KW)

9/29/06 All tanks set. Septic / microfast tank sits 21' from house. No plumbing hooked up yet.

Pump line installed. (KW) 10/2/06 All plumbing

Installed. Three 90' trenches installed on contour. System complete

O.K. to backfill. Need pump/Alarm test & startup test (KW)

10/19/06 Pump and alarm working. Freeman did final

FINAL INSPECTOR Brian Baker DATE OF APPROVAL 10/19/06

inspection of unit, blower, etc. and said it was functioning properly. (BB)

Howard's
Map 13
H8



61670
Regency
Howard
Co.

8450 Cola Parkway • Shawnee, KS 66227 • Phone: 913-422-0707 • Fax: 913-422-0808
e-mail: onsite@biomicrobics.com • www.biomicrobics.com • 800-753-FAST(3278)

PRODUCT REGISTRATION REPORT

Product Registration Report must be completed and returned to Bio-Microbics, Inc. in order to effect warranty.

Date of Installation 10/19/06 Date Shipped to End User 9/29/06 Serial No. 30988 ✓ MF.75

OWNER	
NAME	<u>M/M Bamisaiye</u> <i>femi wants to be at S/U</i>
ADDRESS	<u>13675 Nichols Drive</u>
CITY/STATE/ZIP	<u>Clarksville, MD 21029</u> <i>301-343-4126</i>
PHONE/FAX	<i>call him</i>
BIO-MICROBICS DISTRIBUTOR	
NAME	Freemire & Associates, Inc.
ADDRESS	1215 Old Dorsey Road
CITY/STATE/ZIP	Harmans, MD 21077
PHONE/FAX	410-768-8500 410-768-3400 Fax
INSTALLER	
NAME	<u>Bethal Regency Homes</u>
ADDRESS	<u>4815 Prince Georges Avenue, Ste 204</u>
CITY/STATE/ZIP	<u>Beltsville, MD 20705</u>
PHONE/FAX	<u>301-937-7500</u>
CONSULTING ENGINEER (if applicable)	
NAME	
ADDRESS	
CITY/STATE/ZIP	
PHONE/FAX	

	Good	Bad	NA		Good	Bad	NA
ELECTRICAL PANEL(S)				TREATMENT UNIT(S)			
Visual alarm operating	<input checked="" type="checkbox"/>	<input type="checkbox"/>	<input type="checkbox"/>	Air vent clear	<input checked="" type="checkbox"/>	<input type="checkbox"/>	<input type="checkbox"/>
Audio alarm operating	<input checked="" type="checkbox"/>	<input type="checkbox"/>	<input type="checkbox"/>	Septic tank level	<input checked="" type="checkbox"/>	<input type="checkbox"/>	<input type="checkbox"/>
BLOWER(S)				Septic tank meets min. size	<input checked="" type="checkbox"/>	<input type="checkbox"/>	<input type="checkbox"/>
Wired for correct voltage	<input checked="" type="checkbox"/>	<input type="checkbox"/>	<input type="checkbox"/>	Septic tank filled to operating level	<input checked="" type="checkbox"/>	<input type="checkbox"/>	<input type="checkbox"/>
Inlet/outlet piped correctly	<input checked="" type="checkbox"/>	<input type="checkbox"/>	<input type="checkbox"/>	Air lift operation	<input checked="" type="checkbox"/>	<input type="checkbox"/>	<input type="checkbox"/>
Filter element installed	<input checked="" type="checkbox"/>	<input type="checkbox"/>	<input type="checkbox"/>	Recirculation tube in place	<input checked="" type="checkbox"/>	<input type="checkbox"/>	<input type="checkbox"/>
Blower hood secure	<input checked="" type="checkbox"/>	<input type="checkbox"/>	<input type="checkbox"/>	Fasteners tight	<input checked="" type="checkbox"/>	<input type="checkbox"/>	<input type="checkbox"/>
Blower works correctly	<input checked="" type="checkbox"/>	<input type="checkbox"/>	<input type="checkbox"/>	WATER-TIGHT JOINTS			
Blower located within 100' of Treatment unit	<input checked="" type="checkbox"/>	<input type="checkbox"/>	<input type="checkbox"/>	Treatment unit to septic tank	<input checked="" type="checkbox"/>	<input type="checkbox"/>	<input type="checkbox"/>
Air line clean	<input checked="" type="checkbox"/>	<input type="checkbox"/>	<input type="checkbox"/>	Entrance tube to insert cover	<input checked="" type="checkbox"/>	<input type="checkbox"/>	<input type="checkbox"/>
Air inlet screen clear	<input checked="" type="checkbox"/>	<input type="checkbox"/>	<input type="checkbox"/>	Insert to insert cover	<input checked="" type="checkbox"/>	<input type="checkbox"/>	<input type="checkbox"/>
Blower hood vents clear	<input checked="" type="checkbox"/>	<input type="checkbox"/>	<input type="checkbox"/>	Discharge line connection	<input checked="" type="checkbox"/>	<input type="checkbox"/>	<input type="checkbox"/>

Factory Authorized Personnel: Alan Barber Title: Service Tech.
 Firm: Freemire & Associates Date: 19 Oct. 06

SITE INSPECTION SHEET

OWNER: Errol & Dawn Watson PHONE #: 240-286-3907

ADDRESS: 13675 Nichols Drive CONTRACTOR: _____

WELL TAG #: _____

SUBDIVISION: _____ LOT: _____ COUNTY #: _____

PROPOSAL: replace SDA that would be encroached upon by 20-ft setback to inground pool

LOCATION DIAGRAM

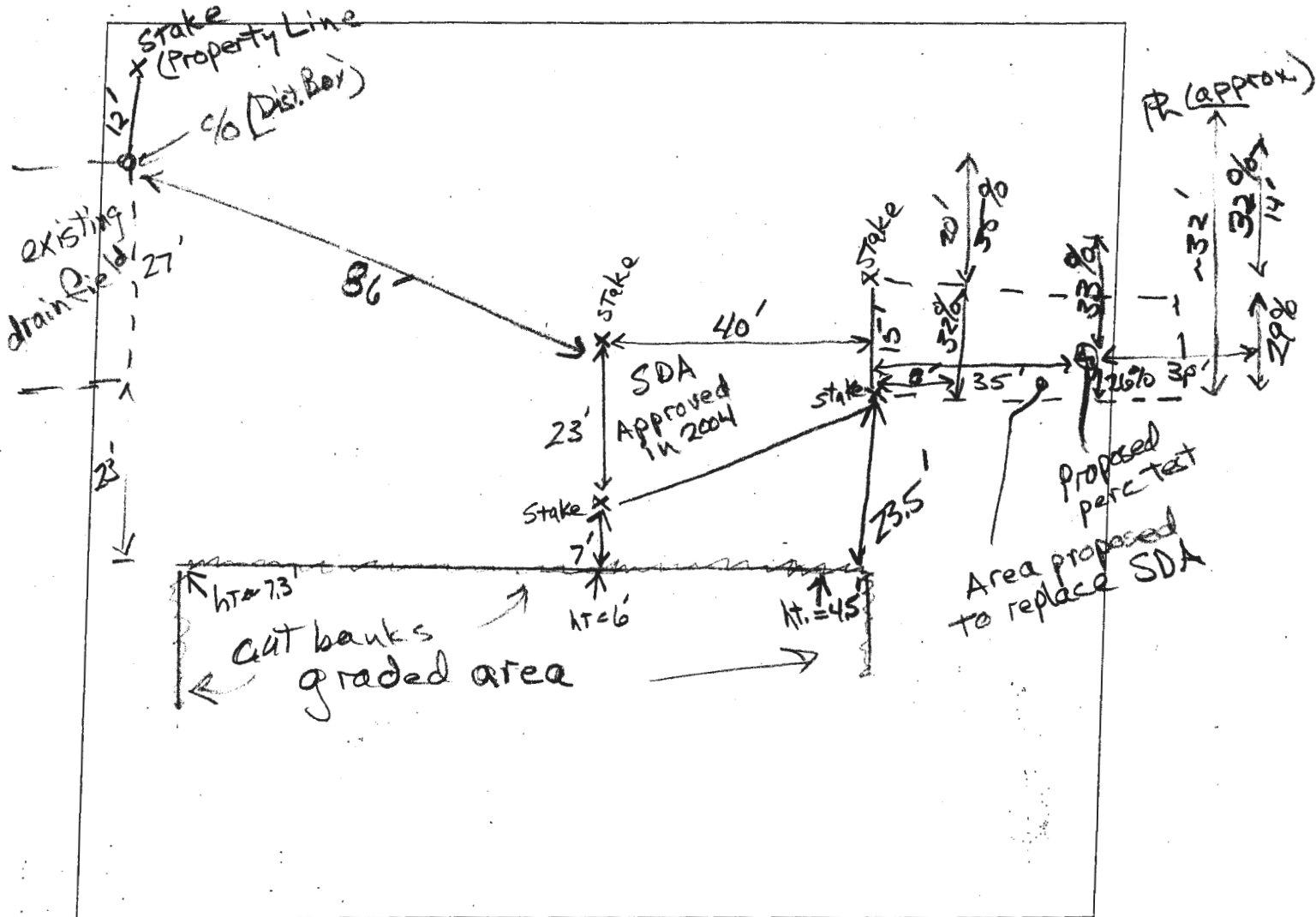

COMMENTS: Proposed SDA not approvable for conventional drain field design due to proximity of slopes > 25%. Grading encroaches on setback to existing SDA designated for innovative replacement drain field.

DATE: 2/23/2017

INSPECTOR: R. Bricker