

Maura J. Rossman, M.D., Health Officer

RECEIPT DATE: 8/26/20 **ONSITE SEWAGE DISPOSAL SYSTEM** P 567956

INSTALLATION APPROVAL DATE: 4/6/21 (ST) **PERMIT** A \_\_\_\_\_

**SEWER HOUSE CONNECTION**

PROPERTY ADDRESS: 8427 OLD FREDERICK ROAD

SUBDIVISION: SAUTER PROPERTY LOT: 2 TAX ID: \_\_\_\_\_

CONTRACTOR: SCHILDWACHTER PLUMBING EMAIL: \_\_\_\_\_

CONTRACTOR ADDRESS: 4406 TEETER ROAD, TAWNEYTOWN, MD 21787 PHONE: 410-596-5929

PROPERTY OWNER: LINDA AND JIM MCARTHUR EMAIL: \_\_\_\_\_

OWNER ADDRESS: 8427 OLD FREDERICK ROAD, ELLICOTT CITY, MD 21043 PHONE: \_\_\_\_\_

NUMBER OF BEDROOMS: \_\_\_\_\_ CONNECTED TO PUBLIC WATER:  YES  NO

LOCATION:	INSTALL 4" SEWER LINE PER APPROVED SITE PLAN.
NOTES:	RUN LINE FROM GARAGE TO SEWER LINE IN FRONT OF TANK. INSTALL CLEANOUTS AT WYE AND GARAGE. SLEEVE WATER LINE WHERE IT CROSSES SEWER LINE OR IS WITHIN 10 FEET.

ISSUED BY: J WILLIAMS ISSUE DATE: 4/5/21 EXPIRATION DATE: 8/26/21

**NOTE: HOWARD COUNTY BUREAU OF UTILITIES APPROVAL OF GRINDER PUMP INSTALLATION IS REQUIRED PRIOR TO SEPTIC PERMIT APPROVAL**

**NOTE: CONTRACTOR MUST SCHEDULE AN INSPECTION AND GAIN APPROVAL OF ALL COMPONENTS PRIOR TO COVERING**

**NOTE: AN ELECTRICAL PERMIT IS REQUIRED FOR INSTALLATION OF ANY ELECTRICAL COMPONENTS OF THE SYSTEM**

**NEITHER THE HOWARD COUNTY COUNCIL NOR THE HEALTH DEPARTMENT IS RESPONSIBLE FOR THE SUCCESSFUL OPERATION OF ANY SYSTEM.  
PERMITTEE RESPONSIBLE FOR OBTAINING FINAL APPROVAL ON THIS PERMIT.  
CALL 410-313-1771 FOR INSPECTION OF SEPTIC SYSTEM.**

NOT TO SCALE

**TRENCH/DRAINFIELD DATA**

WIDTH \_\_\_\_\_ INLET \_\_\_\_\_ BOTTOM \_\_\_\_\_

NUMBER OF TRENCHES \_\_\_\_\_

TOTAL LENGTH \_\_\_\_\_

ABSORPTION AREA \_\_\_\_\_

DISTRIBUTION BOX LEVEL \_\_\_\_\_

DISTRIBUTION BOX BAFFLE \_\_\_\_\_

DISTRIBUTION BOX PORT \_\_\_\_\_

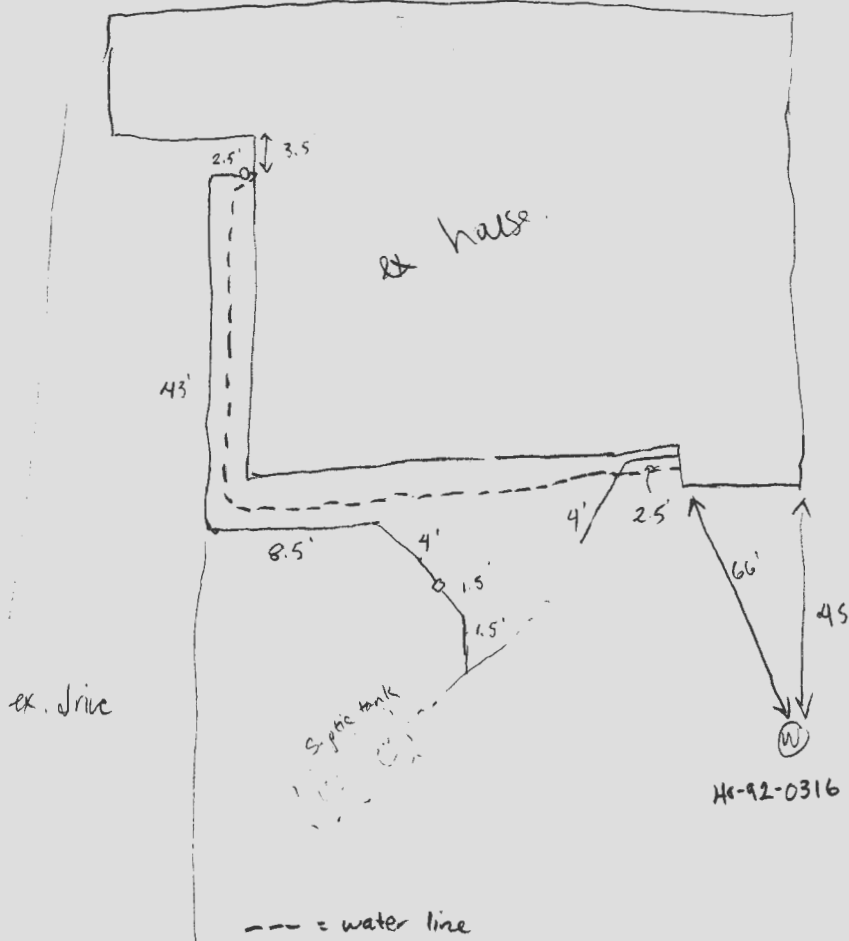

ROAD NAME

**SEPTIC TANK DATA**

SEPTIC TANK I LEVEL \_\_\_\_\_

MANUFACTURER \_\_\_\_\_

CAPACITY \_\_\_\_\_ GAL

SEAM LOC \_\_\_\_\_

TANK LID DEPTH \_\_\_\_\_

BAFFLES \_\_\_\_\_

BAFFLE FILTER \_\_\_\_\_

MANHOLE LOC \_\_\_\_\_

6" PORT LOC \_\_\_\_\_

WATERTIGHT TEST \_\_\_\_\_

SLOTTED \_\_\_\_\_

DATE ON LID \_\_\_\_\_

PUMP/SEPTIC TANK LEVEL \_\_\_\_\_

MANUFACTURER \_\_\_\_\_

CAPACITY \_\_\_\_\_ GAL

SEAM LOC \_\_\_\_\_

TANK LID DEPTH \_\_\_\_\_

BAFFLES \_\_\_\_\_

BAFFLE FILTER \_\_\_\_\_

MANHOLE LOC \_\_\_\_\_

6" PORT LOC \_\_\_\_\_

WATERTIGHT TEST \_\_\_\_\_

SLOTTED \_\_\_\_\_

DATE ON LID \_\_\_\_\_

PRE-CONSTRUCTION:

\_\_\_\_\_

\_\_\_\_\_

\_\_\_\_\_

\_\_\_\_\_

INSTALLATION: 4/6/21 sewer line installed from new single toilet bathroom in garage addition to septic tank. There are two 90° long sweeps in sewer line - first one near SHC, next at corner of house. Approved 90° turn in SL because this is only for one bathroom. Informed owner of presence of 90° turns and the potential for backups. Owner was ok with it. Water line from house is 3/4" and sleeved with 1.5" pipe. (SF)

FINAL INSPECTOR Susan Thomas

DATE OF APPROVAL 4/6/21

**Bureau of Environmental Health**

8930 Stanford Boulevard, Columbia, MD 21045

Main: 410-313-2640 | Fax: 410-313-2648

TDD 410-313-2323 | Toll Free 1-866-313-6300

[www.hchealth.org](http://www.hchealth.org)

Facebook: [www.facebook.com/hocohealth](http://www.facebook.com/hocohealth)

Maura J. Rossman, M.D., Health Officer

RECEIPT DATE: 8/26/20

**ONSITE SEWAGE DISPOSAL SYSTEM**

P 567956

INSTALLATION  
APPROVAL DATE: \_\_\_\_\_

**PERMIT**

A \_\_\_\_\_

**SEWER HOUSE CONNECTION**

PROPERTY ADDRESS: 8427 OLD FREDERICK ROAD

SUBDIVISION: SAUTER PROPERTY LOT: 2 TAX ID: \_\_\_\_\_

CONTRACTOR: SCHILDWACHTER PLUMBING EMAIL: \_\_\_\_\_

CONTRACTOR ADDRESS: 4406 TEETER ROAD, TAWNEYTOWN, MD 21787 PHONE: 410-596-5929

PROPERTY OWNER: LINDA AND JIM MCARTHUR EMAIL: \_\_\_\_\_

OWNER ADDRESS: 8427 OLD FREDERICK ROAD, ELLICOTT CITY, MD 21043 PHONE: \_\_\_\_\_

NUMBER OF BEDROOMS: \_\_\_\_\_ CONNECTED TO PUBLIC WATER:  YES  NO

LOCATION:	INSTALL 4" SEWER LINE PER APPROVED SITE PLAN.
NOTES:	RUN LINE FROM GARAGE TO SEWER LINE IN FRONT OF TANK. INSTALL CLEANOUTS AT WYE AND GARAGE. SLEEVE WATER LINE WHERE IT CROSSES SEWER LINE OR IS WITHIN 10 FEET.

ISSUED BY: J WILLIAMS ISSUE DATE: 4/5/21 EXPIRATION DATE: 8/26/21

**NOTE: HOWARD COUNTY BUREAU OF UTILITIES APPROVAL OF GRINDER PUMP INSTALLATION IS REQUIRED PRIOR TO SEPTIC PERMIT APPROVAL**

**NOTE: CONTRACTOR MUST SCHEDULE AN INSPECTION AND GAIN APPROVAL OF ALL COMPONENTS PRIOR TO COVERING**

**NOTE: AN ELECTRICAL PERMIT IS REQUIRED FOR INSTALLATION OF ANY ELECTRICAL COMPONENTS OF THE SYSTEM**

**NEITHER THE HOWARD COUNTY COUNCIL NOR THE HEALTH DEPARTMENT IS RESPONSIBLE FOR THE SUCCESSFUL OPERATION OF ANY SYSTEM.  
PERMITTEE RESPONSIBLE FOR OBTAINING FINAL APPROVAL ON THIS PERMIT.  
CALL 410-313-1771 FOR INSPECTION OF SEPTIC SYSTEM.**

NOT TO SCALE

**TRENCH/DRAINFIELD DATA**

WIDTH                      INLET                      BOTTOM

\_\_\_\_\_  
NUMBER OF TRENCHES \_\_\_\_\_  
TOTAL LENGTH \_\_\_\_\_  
ABSORPTION AREA \_\_\_\_\_  
DISTRIBUTION BOX LEVEL \_\_\_\_\_  
DISTRIBUTION BOX BAFFLE \_\_\_\_\_  
DISTRIBUTION BOX PORT \_\_\_\_\_

**SEPTIC TANK DATA**

SEPTIC TANK 1 LEVEL \_\_\_\_\_  
MANUFACTURER \_\_\_\_\_  
CAPACITY \_\_\_\_\_ GAL  
SEAM LOC \_\_\_\_\_  
TANK LID DEPTH \_\_\_\_\_  
BAFFLES \_\_\_\_\_  
BAFFLE FILTER \_\_\_\_\_  
MANHOLE LOC \_\_\_\_\_  
6" PORT LOC \_\_\_\_\_  
WATERTIGHT TEST \_\_\_\_\_  
SLOTTED \_\_\_\_\_  
DATE ON LID \_\_\_\_\_

PUMP/SEPTIC TANK LEVEL \_\_\_\_\_  
MANUFACTURER \_\_\_\_\_  
CAPACITY \_\_\_\_\_ GAL  
SEAM LOC \_\_\_\_\_  
TANK LID DEPTH \_\_\_\_\_  
BAFFLES \_\_\_\_\_  
BAFFLE FILTER \_\_\_\_\_  
MANHOLE LOC \_\_\_\_\_  
6" PORT LOC \_\_\_\_\_  
WATERTIGHT TEST \_\_\_\_\_  
SLOTTED \_\_\_\_\_  
DATE ON LID \_\_\_\_\_

*ROAD NAME*

PRE-CONSTRUCTION:

\_\_\_\_\_  
\_\_\_\_\_  
\_\_\_\_\_  
\_\_\_\_\_  
\_\_\_\_\_

INSTALLATION:

\_\_\_\_\_  
\_\_\_\_\_  
\_\_\_\_\_  
\_\_\_\_\_  
\_\_\_\_\_  
\_\_\_\_\_

FINAL INSPECTOR \_\_\_\_\_ DATE OF APPROVAL \_\_\_\_\_

# Howard County Health Department

Bureau of Environmental Health, Columbia, MD 21045 - 410-313-1771

SEWAGE DISPOSAL PERMIT NO. A- \_\_\_\_\_ P- 967956

RESIDENTIAL PERMIT   
(NUMBER OF BEDROOMS: \_\_\_\_\_)

COMMERCIAL PERMIT   
(DESIGN FLOW: \_\_\_\_\_ GPD)

PERMITEE: Schildwachter Plumbing

LOCATION: 8427 Old Frederick Road

**\*\*POST THIS CARD WHERE IT CAN BE SEEN FROM ROAD\*\***

STOP ALL CONSTRUCTION ON SEWAGE  
DISPOSAL SYSTEM AND CONTACT HEALTH  
DEPARTMENT BEFORE CONTINUING

\_\_\_\_\_  
Inspector

\_\_\_\_\_  
Date

WORK IS SATISFACTORY, OK TO  
CONTINUE

\_\_\_\_\_  
Inspector

\_\_\_\_\_  
Date

COMMENTS: \_\_\_\_\_  
\_\_\_\_\_

FINAL INSPECTION MADE, OK TO  
COVER ALL WORK

\_\_\_\_\_  
Inspector

\_\_\_\_\_  
Date



# HOWARD COUNTY HEALTH DEPARTMENT

67956

DATE 8 26 20

Received From

Linda McArthur

PHONE #

410 677-6566

For

~~Sept repair~~ - SAC su  
Well  
Permit

8427  
Old Frederick Rd.

CASH

CHECK

NO.

3245

One hundred sixty-five

Dollars

\$

165 00

Received By

King

**linmac5@aol.com**

---

**From:** Bricker, Robert <RBricker@howardcountymd.gov>  
**Sent:** Wednesday, August 26, 2020 4:04 PM  
**To:** linmac5@aol.com  
**Subject:** RE: 8427 Old Frederick Road\_B20002144

Mrs. McArthur,

I am responding to a voicemail I received from you concerning application for a septic system permit for the new sewer pipe connection. A Repair/Upgrade form (available on the well and Septic Program webpage, should be downloaded, completed, and submitted with the fee payment. The fee payment can be made by check for \$165 and made payable to 'Director of Finance'. During work hours, we have a Drop Box on the concrete porch under the awning at the Bureau of Environmental Health entrance on the North corner of the Ascend One Building (8430 Stanford Blvd), or you may mail the fee and form. We are in the Columbia 21045 zip code.

I have prepared a template for the permit. The permit will be issued after processing the fee payment. Please include a note with your payment directing where to send the permit, i.e. to you or to your plumber.

Please 'Reply' to this email with any questions you may have regarding these procedures.

Robert Bricker, REHS/RS, L.E.H.S.

**From:** linmac5@aol.com <linmac5@aol.com>  
**Sent:** Monday, July 27, 2020 6:12 PM  
**To:** Bricker, Robert <RBricker@howardcountymd.gov>  
**Subject:** RE: 8427 Old Frederick Road\_B20002144

Mr Bricker, please send  
Permit to me.  
8427 Old Frederick Rd.  
Ellicott City MD 21043

[Note: This email originated from outside of the organization. Please only click on links or attachments if you know the sender.]

Mr. Bricker, Please find attached the requested drawing of the additional sewer line and how it will connect to the septic tank. Please let me know if this is what you were looking for and what I need to do to proceed.

Thank you,  
Linda McArthur

**From:** Bricker, Robert <RBricker@howardcountymd.gov>  
**Sent:** Friday, July 24, 2020 11:40 AM  
**To:** linmac5@aol.com  
**Subject:** RE: 8427 Old Frederick Road\_B20002144

Thank you  
Linda McArthur

Thank you Mrs McArthur, I will look for your email next week.  
Robert Bricker, REHS/RS, L.E.H.S.

**From:** linmac5@aol.com <linmac5@aol.com>  
**Sent:** Friday, July 24, 2020 11:27 AM  
**To:** Bricker, Robert <RBricker@howardcountymd.gov>  
**Subject:** RE: 8427 Old Frederick Road\_B20002144

[Note: This email originated from outside of the organization. Please only click on links or attachments if you know the sender.]

Mr. Bricker, We have a meeting with the plumber on Monday and will submit the requested information shortly after.

Maura J. Rossman, M.D., Health Officer

**INFORMATION FORM - SEPTIC SYSTEM REPAIR/UPGRADE**

**Reason for Request:**

- Failing System
- System relocation for proposed addition
- System upgrade for proposed addition
- Inadequate treatment zone
- Collapsed septic tank
- Collapsed drywell

**Has the septic tank been pumped within the last month?**

Yes      Date pumped: \_\_\_\_\_  
 No

**Was a visual inspection of the septic tank and/or drain fields conducted?**

Yes      Explain observation: \_\_\_\_\_  
 No

**Existing system design**

- Drywell
- Trench
- Mound
- Unknown
- Other: \_\_\_\_\_

**Was a visual inspection of the sewage line conducted?**

Yes  
 No

**Blockage Leading to the field**

Yes      Explain \_\_\_\_\_  
 No

**Is discharge surfacing on the ground?**

Yes  
 No

**Additional Comments:**

We are adding a bathroom and need to connect wastewater pipe to SHC outside of foundation

\*For REPAIRS, are the owners proposing, or do they plan to add in the future any additions or modifications to the property, i.e. pools, living space additions, garages, etc? This information must be disclosed at the time of this application. The Health Department will not be able to accommodate requests in the field for property modifications unrelated to the repair request. Such requests may require an additional fee, testing, and submittal of a Percolation Certification Plan, if the property does not meet current Code and Regulations.

Septic Contractor: All Right Plumbing + Heating      Contractor's Phone: \_\_\_\_\_

Contractor's Address: 3601 Kings Point Rd

Property Address: 8427 Old Frederick Rd      County File: \_\_\_\_\_

Subdivision: 9001      Lot: 2      Year Built: 1993

Owner's Name: Linda + Jim McArthur      Existing bedrooms: 4

Name of previous owners: N/A      Existing bedrooms: \_\_\_\_\_

Proposed bedrooms: '

\*A Sanitarian will be in contact within three business days, depending upon the urgency of the situation, to coordinate the scheduling/review of the repair or upgrade.

\*Prior to scheduling inspections, scaled plans should be submitted to clarify the nature of the addition.\*

Print out a copy of Real Property Data via Dept. of Taxation website \_\_\_\_\_ Indexed file found \_\_\_\_\_

If soil/site conditions are limited and sewer and/or Metro District status is not conducive to connection, the Sanitarian may recommend pursuit of Emergency Sewer Extension or Emergency Metro District Inclusion. The Owner should contact the Bureau of Utilities for details.

No permit is to be issued nor inspection to be scheduled without prior fee collection at the office unless an emergency exists.

The contractor is to notify the office of the emergency as soon as possible.

2/2020