



HOWARD COUNTY HEALTH DEPARTMENT

68850

DATE 4 12 74

Received From

Tyles Septic cleaner

PHONE #

40 795-5070

For

Repair Perc/ 11821 Chapel woods ch.

CASH

CHECK

NO.

11656

Three hundred thirty

Dollars

\$ 330 00

Received By

King

56850



Bureau of Environmental Health
8930 Stanford Boulevard, Columbia, MD 21045
Main: 410-313-2540 | Fax: 410-313-2548
TDD: 410-313-2333 | Toll Free: 1-866-313-6300
www.bchealth.org
Facebook: www.facebook.com/hochhealth
Twitter: @wardcohealthdep

Dr. Maura J. Roszman, M.D., Health Officer

INFORMATION FORM - SEPTIC SYSTEM REPAIR/UPGRADE

Reason for Request

- Existing System
- System relocation for proposed addition
- System upgrade for proposed addition
- Inadequate treatment zone
- Collapsed septic tank
- Collapsed drywell

Has the septic tank been pumped within the last month?

- Yes Date pumped: _____
- No

Was a visual inspection of the septic tank and/or drain fields conducted?

- Yes Explain observations: _____
- No

Was a visual inspection of the sewage line conducted?

- Yes
 - Blockage leading to the tank
 - Yes Explain: _____
 - No
 - Blockage leading to the field
 - Yes Explain: _____
 - No

Existing system design

- Drywell
- French
- Mound
- Unknown
- Other: _____

Is discharge surfacing on the ground?

- Yes
- No

Additional Comments: _____

*For REPAIRS, are the owners proposing, or do they plan to add in the future, any additions or modifications to the property, i.e. pools, living space additions, garages, etc? This information must be disclosed at the time of this application. The Health Department will not be able to accommodate requests in the field for property modifications unrelated to the repair request. Such requests may require an additional fee, grading, and submittal of a Percolation Coordination Plan, if the property does not meet current Code and Regulation.

Septic Contractor: Fogel's Septic Clean Contractor's Phone: 410-745-5670
 Contractor's Address: 580 Oberlin Rd Syracuseville 21789
 Property Address: 11821 Chapel Woods Ct County file: _____
 Subdivision: _____ Lot: 22 Year Built: 1993
 Owner's Name: Gary Smith Owner's Phone: 413-418-9347

Name of previous owners: _____ Existing bedrooms: _____
 Proposed bedrooms: _____

Has this request been previously discussed with a Sanitarian? (Name): _____
 Public Sewer available/nearby: _____

*A Sanitarian will be in contact within three business days, depending upon the urgency of the situation, to coordinate the scheduling/review of the repair or upgrade.

Prior to scheduling inspections, scaled plans should be submitted to clarify the nature of the addition.

Print out a copy of Real Property Data via Dept. of Taxation website Indexed file found _____

If public sewer may be nearby, verify whether sewer is technically "available" through the Bureau of Engineering.

If sewer is available and the property is within the Metropolitan District, connection to sewer is required if the owner believes reason for occupation exists, the owner should justify the request in writing.

If land/site conditions are limited and sewer and/or Metro District status is not conducive to connection, the Sanitarian may recommend pursuit of Emergency Sewer Extension or Emergency Metro District Inclusion. The Owner should contact the Bureau of Utilities for details.

No permits to be issued nor inspection to be scheduled without prior fee collection at the office unless an emergency situation exists. The contractor is to notify office of the emergency situation as soon as possible.

Maura J. Rossman, M.D., Health Officer

RECEIPT DATE: 4/12/21 **ONSITE SEWAGE DISPOSAL SYSTEM** P 568850

APPROVAL DATE: 06/11/2021 **PERMIT:** **REPAIR** A 568850

PROPERTY ADDRESS: 11821 Chapel Woods Court

SUBDIVISION: CHAPEL WOODS S 2 A 3 LOT: 22 TAX ID: 05-408318

CONTRACTOR: Fogles Septic Clean Inc EMAIL: kim@foglesinc.com

CONTRACTOR ADDRESS: 580 Obrecht Road, Sykesville, MD 21784 PHONE: 410-795-5670

PROPERTY OWNER: Gary Smith EMAIL: _____

OWNER ADDRESS: 11821 Chapel Woods Court, Clarksville, MD 21029 PHONE: 443-418-4347

SEPTIC TANK SIZE (GALLONS): EXISTING PUMP CHAMBER CAPACITY (GALLONS): — PUMP SIZE: —

NUMBER OF BEDROOMS: 4 HOUSE SQ. FT. — APPLICATION RATE: 1.2

DISTRIBUTION SYSTEM: GRAVITY FED LOW PRESSURE DOSED

TRENCHES:	LINEAR FEET REQUIRED: <u>110'</u>	INLET DEPTH: <u>4'</u>
	TRENCH WIDTH: <u>2'</u>	MAXIMUM BOTTOM DEPTH: <u>9'</u>
	MINIMUM SPACE BETWEEN TRENCHES: <u>10'</u>	EFFECTIVE AREA BEGINNING DEPTH: <u>5'</u>
LOCATION:	TO BE STAKED BY SANITARIAN DURING PRE-CONSTRUCTION INSPECTION.	
NOTES:	INSTALL 3x37' TRENCHES	

ISSUED BY: CABANUG 001997 ISSUE DATE: 06/09/2021 EXPIRATION DATE: 06/09/2022

- NOTE: CONTRACTOR MUST SCHEDULE A PRE-CONSTRUCTION INSPECTION PRIOR TO BEGINNING ANY INSTALLATION
- NOTE: CONTRACTOR MUST SCHEDULE AN INSPECTION AND GAIN APPROVAL OF ALL COMPONENTS PRIOR TO COVERING
- NOTE: STONE MUST BE APPROVED BY HEALTH DEPARTMENT AND GRAVEL TICKET MUST BE AVAILABLE FOR REVIEW.
- NOTE: WATERTIGHT SEPTIC TANKS REQUIRED
- NOTE: ALL PARTS OF SEPTIC SYSTEM SHALL BE AT LEAST 100 FEET DOWNGRADIENT FROM ANY WATER WELL
- NOTE: MANHOLE RISERS REQUIRED ON ALL SEPTIC TANKS AND PUMP CHAMBERS
- NOTE: AN ELECTRICAL PERMIT IS REQUIRED FOR INSTALLATION OF ANY ELECTRICAL COMPONENTS OF THE SYSTEM
 ELECTRICAL PERMIT ISSUED E N/A
- NOTE: THE HCHD DOES NOT WARRANTY ANY SYSTEM AND CANNOT GUARANTEE THE PERFORMANCE OF THIS SYSTEM AS DESIGNED. BY ACCEPTING THIS PERMIT, THE OWNER AND/OR APPLICANT ACKNOWLEDGE THAT THE SPECIFICATIONS DETAILED IN THIS DESIGN ARE ONE POSSIBLE OPTION AND THAT THE HCHD WILL REVIEW OTHER PROPOSALS. YOU HAVE THE OPTION TO SEEK THE ADVICE OF A QUALIFIED DESIGN CONSULTANT OR PROFESSIONAL ENGINEER FOR FURTHER GUIDANCE.
- NOTE: MDE RECOMMENDS SEPTIC TANKS, BAT, AND OTHER PRETREATMENT UNITS BE PUMPED AT A FREQUENCY ADEQUATE TO ENSURE THAT SOLIDS ARE NOT DISCHARGED TO THE DISPOSAL AREA

NEITHER THE HOWARD COUNTY COUNCIL NOR THE HEALTH DEPARTMENT IS RESPONSIBLE FOR THE SUCCESSFUL OPERATION OF ANY SYSTEM.

PERMITTEE RESPONSIBLE FOR OBTAINING FINAL APPROVAL ON THIS PERMIT.

CALL 410-313-1771 TO SCHEDULE INSPECTIONS.

NOT TO SCALE

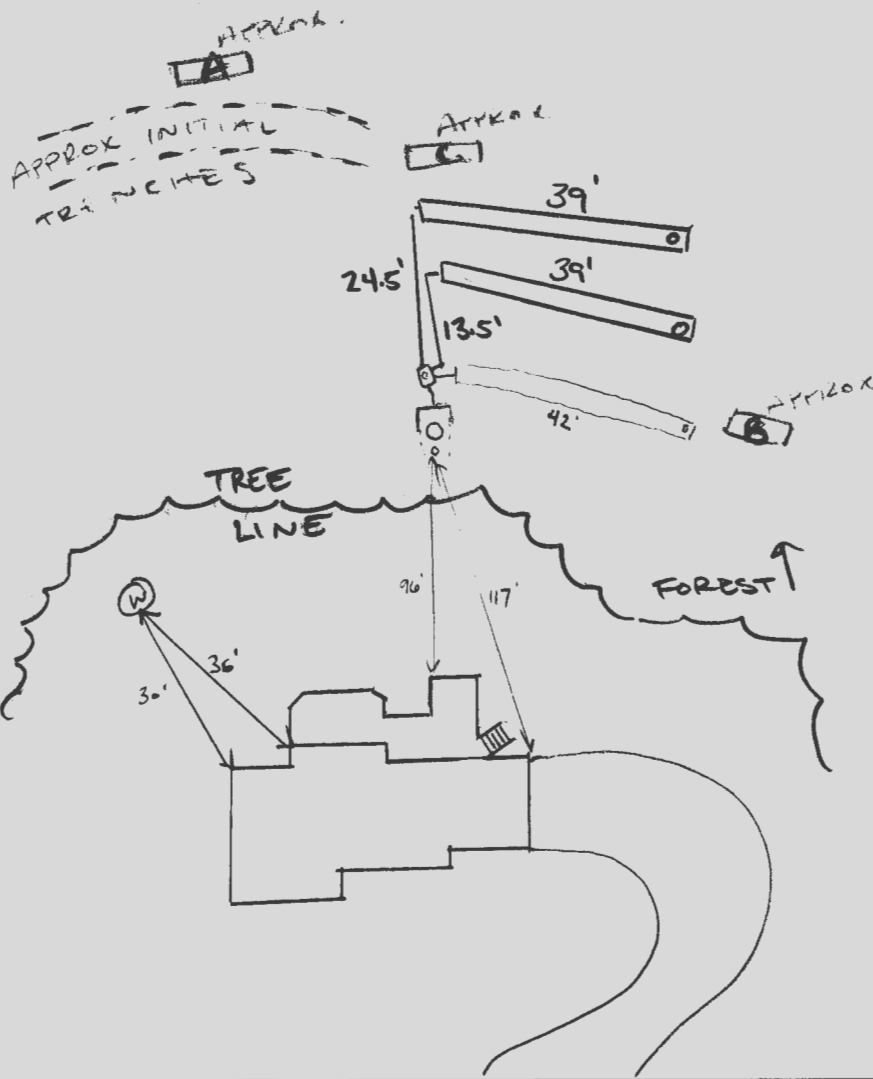

ROAD NAME
CHAPEL WOODS COURT

TRENCH/DRAINFIELD DATA

WIDTH	INLET	BOTTOM
2'	4'	9'
NUMBER OF TRENCHES <u>3</u>		
TOTAL LENGTH <u>120'</u>		
ABSORPTION AREA <u>240 SF + 4' SIDE WALL</u>		
DISTRIBUTION BOX LEVEL <u>SPEED</u>		
DISTRIBUTION BOX BAFFLE <u>YES</u>		
DISTRIBUTION BOX PORT <u>YES</u>		

SEPTIC TANK DATA

SEPTIC TANK 1 LEVEL EXISTING
 MANUFACTURER ?
 CAPACITY ~1250 GAL
 SEAM LOC mid
 TANK LID DEPTH 1.5'
 BAFFLES inlet (old) + outlet (new)
 BAFFLE FILTER -
 MANHOLE LOC middle
 6" PORT LOC inlet
 WATERTIGHT TEST -
 SLOTTED no
 DATE ON LID N/A

PUMP/SEPTIC TANK LEVEL

MANUFACTURER _____
 CAPACITY _____ GAL
 SEAM LOC _____
 TANK LID DEPTH _____
 BAFFLES _____
 BAFFLE FILTER _____
 MANHOLE LOC _____
 6" PORT LOC _____
 WATERTIGHT TEST _____
 SLOTTED _____
 DATE ON LID _____

PRE-CONSTRUCTION:

06/09/2021 Laid out 3x37' trenches by perc B. Prop line marked to confirm installation on property in owner and neighbor's yard

INSTALLATION:

6/9/21 New outlet baffle installed in tank. D-box set, one trench constructed (37) 06/14/2021 MID AND LOWER TRENCHES COMPLETE. LEVELED D Box WITH SPEED LEVELS. (4)

FINAL INSPECTOR

DATE OF APPROVAL

06/14/2021