

APPLICATION

PERCOLATION TESTING

HOWARD COUNTY HEALTH DEPARTMENT
BUREAU OF ENVIRONMENTAL HEALTH
3525-H ELLICOTT MILLS DRIVE/ELLICOTT CITY, MARYLAND 21043
TELEPHONE: 410-313-2640

A 515951

P _____

DISTRICT _____

DATE 7/20/2001

TO: THE COUNTY HEALTH OFFICER
ELLICOTT CITY, MARYLAND

I HEREBY APPLY FOR THE NECESSARY TEST PRIOR TO APPLICATION FOR PERMIT TO CONSTRUCT (OR RECONSTRUCT) A SEWAGE DISPOSAL SYSTEM.

PROPERTY OWNER Jeffrey Shumaker

ADDRESS 854 Route 97, Cooksville, MD 21723 PHONE _____

AGENT OR PROSPECTIVE BUYER Heritage Land Development

ADDRESS 3060 Washington Rd., Suite 220, Glenwood, MD 21738 PHONE 410-489-7900

PROPERTY LOCATION:

SUBDIVISION _____ LOT NO. 2

ROAD AND DESCRIPTION _____

854 Route 97

TAX MAP NO. 8 PARCEL # 237

SIZE OF LOT 3+ Acres TYPE OF BLDG. SFD
(SINGLE FAMILY DWELLING OR COMMERCIAL)

THE SYSTEM INSTALLED UNDER THIS APPLICATION IS ACCEPTABLE ONLY UNTIL PUBLIC FACILITIES BECOME AVAILABLE. I FULLY UNDERSTAND THE FEE CONNECTED WITH THE FILING OF THIS PERC TEST APPLICATION IS NON-REFUNDABLE UNDER ANY CIRCUMSTANCES. I ALSO AGREE TO COMPLY WITH ALL M.O.S.H.A. REQUIREMENTS IN TESTING THIS LOT.

(SIGNATURE OF APPLICANT)

APPROVED BY _____ FOR _____ DATE _____

DISAPPROVED BY _____ FOR _____ DATE _____

HOLD PENDING FURTHER TESTS _____

REASONS FOR REJECTION OR HOLDING _____

PERCOLATION TEST PLAT/PRELIMINARY PLAT - TITLE OR I.D. # _____ DATE _____

SITE DEVELOPMENT PLAN/FINAL PLAT - TITLE OR I.D. # _____ DATE _____

THIS IS NOT A PERMIT

COUNTY #

SOIL PROFILE

0' (9)
 1' Topsoil
 Rd brn
 Si CLm
 2' org brn
 beige
 tan
 Si Lm
 10-15%
 Rock Frag
 10' Bottom

0' (10)
 1' Topsoil
 Rd brn
 CL Lm
 4' H brn
 tan
 yellowish
 brn
 Si Lm
 10-20%
 Rock
 frag
 3 1/2' Bottom

0' (11)
 1' Topsoil
 tan
 org brn
 H brn
 Si Lm
 5-10% Rock
 3 1/2' tan
 org brn
 beige
 Si Lm
 2" Refusal

SOIL PROFILE

0' (12)
 1' Topsoil
 5-10%
 Rock Frag
 rd brn
 H brn
 tan
 beige
 Si Lm
 Bottom 10' 7"

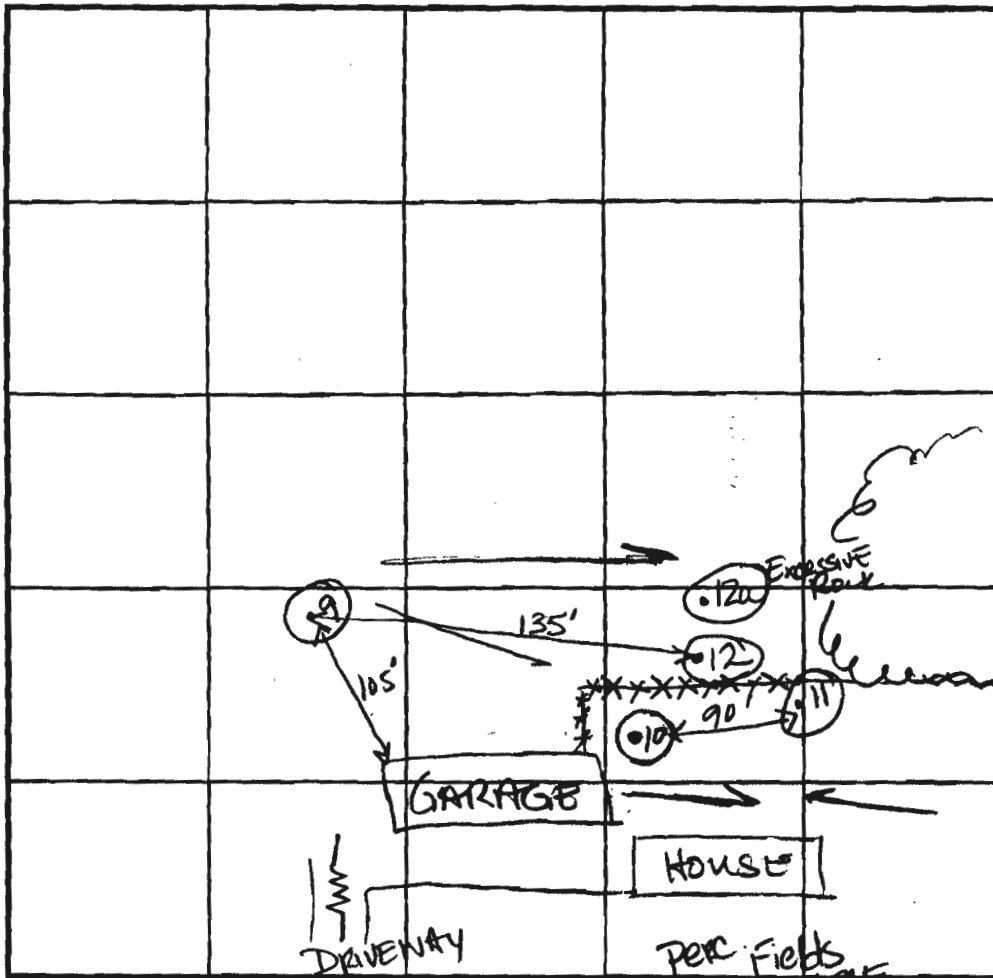

INDICATE NORTH - NAME ADJOINING ROADWAY AS BASE LINE. HERE
 ROUTE 97

DATE	TEST NO.	DEPTH	PRE-WET		TEST - 1" DROP		TIME	
			START	STOP	START	STOP		
8-6-01	9	3'S 10'D	2:31	2:32	2:32	2:33	1 min	
			2:35 ³⁰	2:37	2:37	2:38 ²⁰	1 1/2 min	
	10	4'S 6'S	2:44 ²⁰	less than 1" in 30 min		3:10	3:29	19 min
	12	3 1/2'S 10' 7"D	2:49 ⁰⁵	2:50 ⁰⁰	2:50 ⁰⁰	2:51 ³⁰	1 1/2 min	
	11	3'S 11' 2"D	3:41 ⁵⁰	3:50	3:50	3:59	9 min	
	12a	5'-7'D	Refusal				FAIL	

REMARKS _____
 TYPE OF SOIL _____
 TESTED BY KG ALSO PRESENT T. Feaga
 TRENCH DESIGN DATA: AVG. PERCOLATION TIME _____ TRENCH WIDTH _____
 INLET DEPTH _____ MAXIMUM BOTTOM DEPTH _____ SQ. FT./BEDROOM _____

AP _____

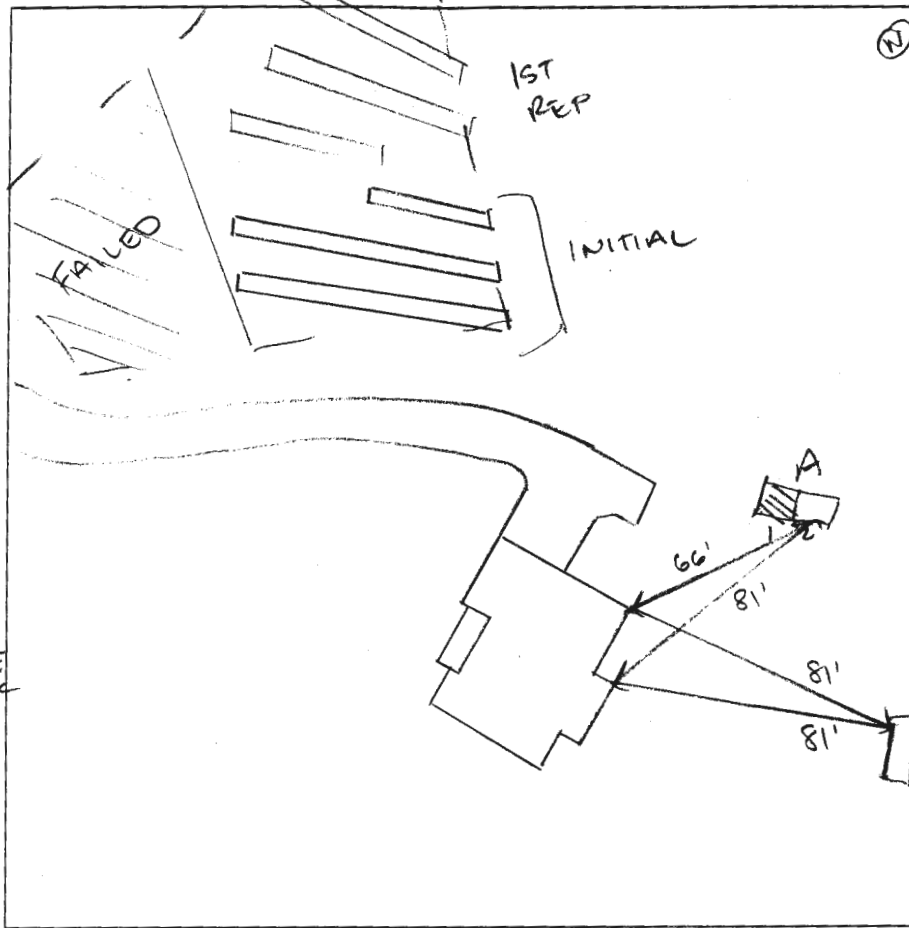

B
 RED BRN
 RED SCL SBK
 FEW FLAG BOULDERS <15% (QUARTZ)
 72" RED/BRN LS SBK
 FEW FLAG + BOULDERS (QUARTZ) <15%
 150"

A₁
 YEL/BRN LS BOULDERS
 36"
 YEL/BRN LS 45% R_x BOULDERS
 72"
 YEL/BRN LS 45-50% R_x LG BOULDERS
 120"
 REFUSE ROCK

A₂
 YEL/BRN SSL SBK WK FR
 32"
 YEL/BRN SL SBK WK FR
 72"
 NO BOULDERS AS IN A₁
 120"
 SAME HARD BOTTOM

SHELF/AT BOTTOM

DATE	TEST #	DEPTH	START	BREAK 1" DROP	STOP 2" DROP	TIME OF 2ND INCH	P/F/H
01/26/2021	A ₍₂₎	5' / 10'	0:00	1:30	3:30	2:00	P
01/26/2021	B	5' / 13'	0:00	23:00	51:00	28:00	P

REMARKS AREA WAS CLEARED PASS. REGRADE. ICE/SNOW VERY WET COND
 SANITARIAN CABAHUG 00992 BACKHOE J+A OTHERS _____
 TEST HOLES USED IN SDA _____ AVG. PERC TIME _____ SQ. FT/BR _____
 TRENCH WIDTH _____ INLET DEPTH _____ MAX. BOT DEPTH _____ EFFECTIVE SW _____

COUNTY #

SOIL PROFILE

0' (4)
 1' Topsoil
 org brn
 CL Lm
 25-35%
 rock
 frag
 2'
 tan
 brn
 1t brn
 Si Lm
 4'
 6'
 50-60%
 Rock
 frag
 7'9"
 Refusal

2' (4a)
 1' Topsoil
 1t brn
 beige
 tan
 Si Lm
 org
 brn
 CL
 Lm
 4 1/2'

beige
 tan
 Si Lm
 25-35%
 Rock
 frag
 7'7"
 Refusal
 (4b)

0' Topsoil
 tan
 1t brn
 Si CL Lm
 Rock
 frag
 ≥ 70%
 7'4"
 Refusal

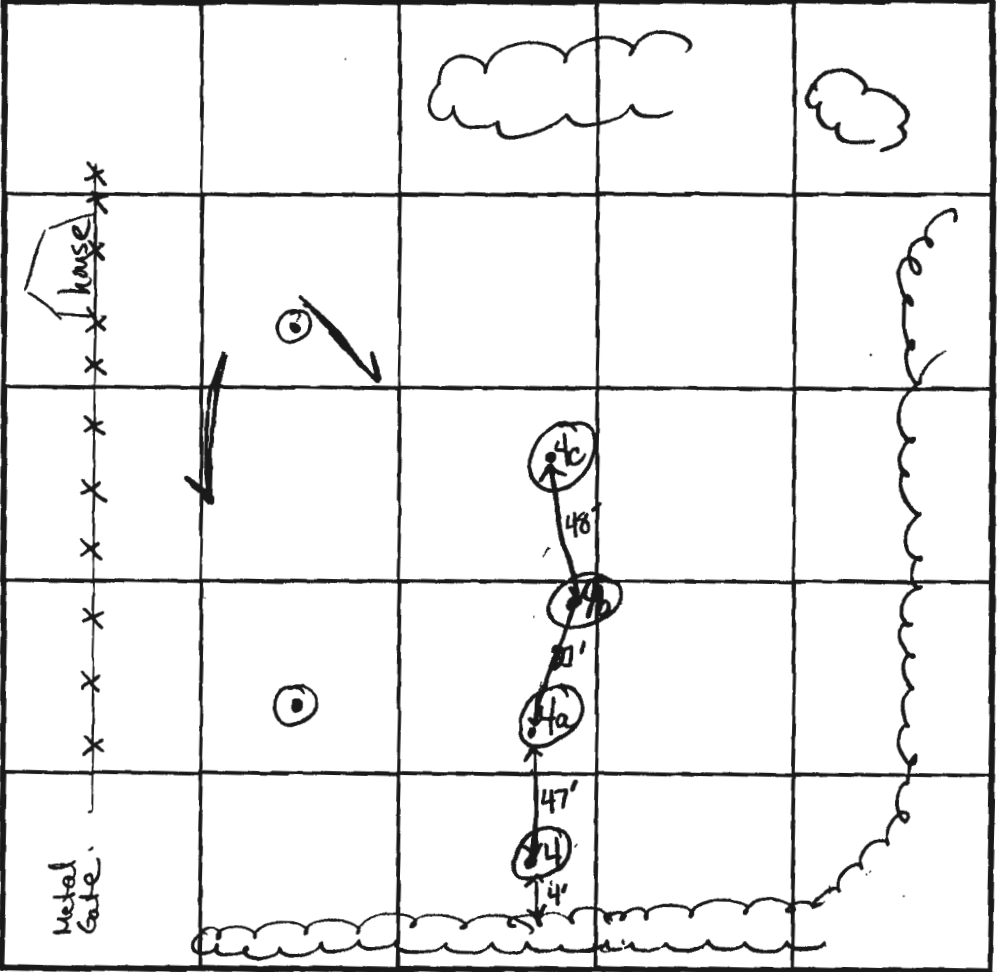

SOIL PROFILE

0' (4c)
 1' Topsoil
 org brn
 1t brn
 Si Lm
 5-10%
 Rock
 frag
 7'
 15-25%
 Rock
 frag
 Saphrolite
 tan
 brn
 Si Lm
 12'4"

INDICATE NORTH - NAME ADJOINING ROADWAY AS BASE LINE.

ROUTE 97

DATE	TEST NO.	DEPTH	PRE-WET		TEST - 1" DROP		TIME
			START	STOP	START	STOP	
8-6-01	4	7'9" Refusal	- see profile		→	→	Fail
	4a	7'7" Refusal	- see profile		→	→	Fail
	4b	7'4" Refusal	- see profile		→	→	Fail
	4c	3'5" S 12'4" D	11:11 ⁰⁰	11:11 ²⁰	11:11 ²⁰	11:12 ⁰⁵	>1min
			11:14	11:15 ⁴⁵	11:15 ⁴⁵	11:16 ⁴⁵	1min

REMARKS

TYPE OF SOIL Mostly Si Lm, some pockets of clay areas of excessive ra
 TESTED BY Goedeking, Kacie ALSO PRESENT Tim Feaga
 TRENCH DESIGN DATA: AVG. PERCOLATION TIME 1min TRENCH WIDTH _____
 INLET DEPTH 18" MAXIMUM BOTTOM DEPTH _____ SQ. FT./BEDROOM _____

APPLICATION

PERCOLATION TESTING

A 515951

P _____

HOWARD COUNTY HEALTH DEPARTMENT
BUREAU OF ENVIRONMENTAL HEALTH
3525-H ELLICOTT MILLS DRIVE/ELLICOTT CITY, MARYLAND 21043
TELEPHONE: 410-313-2640

DISTRICT _____

DATE 7/20/2001

TO: THE COUNTY HEALTH OFFICER
ELLICOTT CITY, MARYLAND

I HEREBY APPLY FOR THE NECESSARY TEST PRIOR TO APPLICATION FOR PERMIT TO CONSTRUCT (OR RECONSTRUCT) A SEWAGE DISPOSAL SYSTEM.

PROPERTY OWNER Jeffrey Shumaker

ADDRESS 854 Route 97, Cooksville, MD 21723 PHONE _____

AGENT OR PROSPECTIVE BUYER Heritage Land Development

ADDRESS 3060 Washington Rd., Suite 220, Glenwood, MD 21738 PHONE 410-489-7900

PROPERTY LOCATION:

SUBDIVISION _____ LOT NO. 2

ROAD AND DESCRIPTION _____

854 Route 97

TAX MAP NO. 8 PARCEL # 237

SIZE OF LOT 3+ Acres TYPE OF BLDG. SFD
(SINGLE FAMILY DWELLING OR COMMERCIAL)

THE SYSTEM INSTALLED UNDER THIS APPLICATION IS ACCEPTABLE ONLY UNTIL PUBLIC FACILITIES BECOME AVAILABLE. I FULLY UNDERSTAND THE FEE CONNECTED WITH THE FILING OF THIS PERC TEST APPLICATION IS NON-REFUNDABLE UNDER ANY CIRCUMSTANCES. I ALSO AGREE TO COMPLY WITH ALL M.O.S.H.A. REQUIREMENTS IN TESTING THIS LOT.

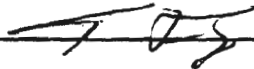

(SIGNATURE OF APPLICANT)

APPROVED BY _____ FOR _____ DATE _____

DISAPPROVED BY _____ FOR _____ DATE _____

HOLD PENDING FURTHER TESTS _____

REASONS FOR REJECTION OR HOLDING _____

PERCOLATION TEST PLAT/PRELIMINARY PLAT - TITLE OR I.D. # _____ DATE _____

SITE DEVELOPMENT PLAN/FINAL PLAT - TITLE OR I.D. # _____ DATE _____

THIS IS NOT A PERMIT

COUNTY # _____

SOIL PROFILE

0' (7a)

1' Topsoil

org brn
H brn
Si lm

5'

6'

>50%
Rock Frg
org brn
tan
H brn
beige
Si lm

11" Refusal

0' (8a)

1" Topsoil

org brn
tan
Si CLM
5-10%
Rock
Frg

6'

45-55%
Rock
Si LM

7'3" Refusal

0' (8)

1" Topsoil

org brn
beige
Si LM

6'

H brn
beige
brn
Si lm
15-25%
Rock Frg
Bottom

12'10"

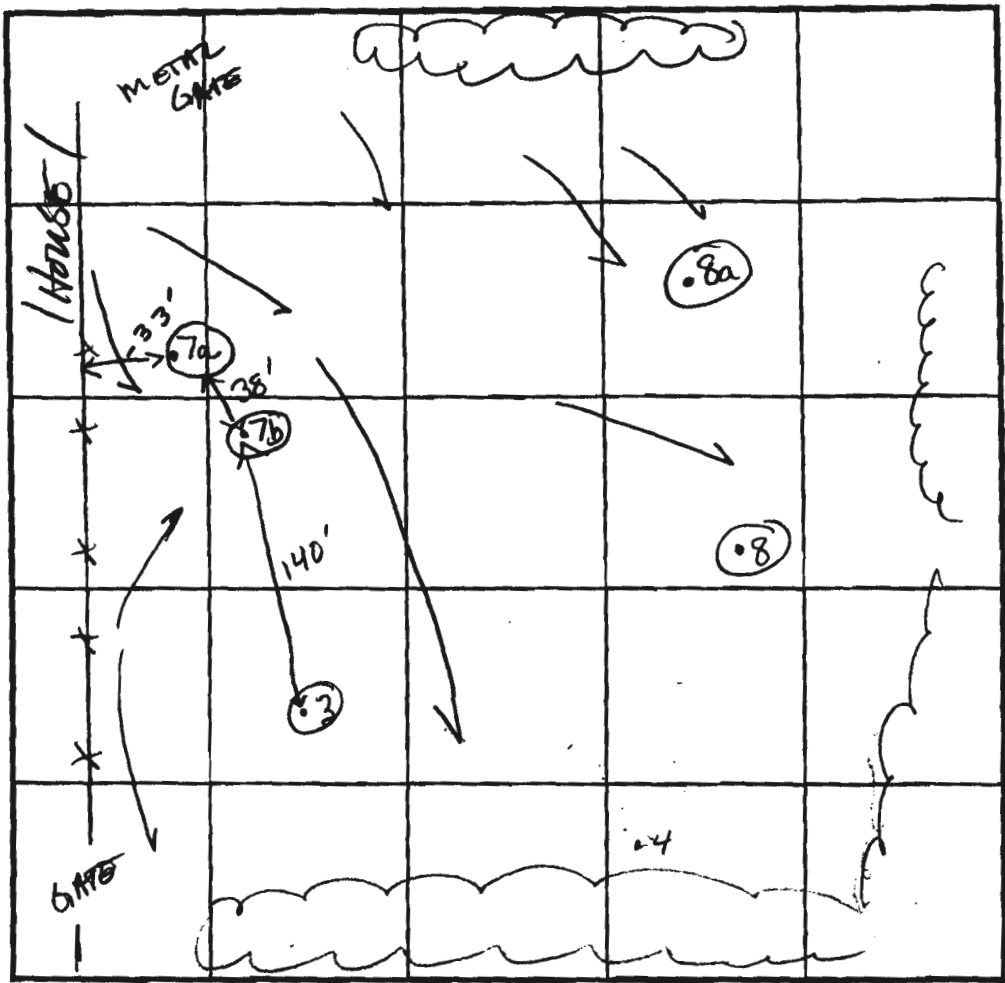

SOIL PROFILE

0' (7b)

1' Topsoil

rd brn
org brn
beige
Si CLM
Rock Frg
5-10%
Rock

6'1/2'

More beige
org brn
Si lm
25-35%
Rock
Frg

12'3" Refusal

0' (3)

1" Topsoil

rd brn org
Si CLM
Rock Frg

6'

>50%
Rock
Frg
org brn
tan
beige
Si LM

11'6" Refusal

INDICATE NORTH - NAME ADJOINING ROADWAY AS BASE LINE.

ROUTE 97

DATE	TEST NO.	DEPTH	PRE-WET		TEST - 1" DROP		TIME
			START	STOP	START	STOP	
8-6-01	7a	38 11'D	11:31 ⁴⁵	11:33 ⁰	11:33 ⁰	11:35	2min
	8a	2 1/2' S	11:45 ¹⁰	11:51 ⁴⁰	11:51 ⁴⁰	12:09 ³⁰	~19min
		6' M	11:53	11:57	11:57	12:02 ⁴⁰	~6min
		9'3" D	Refusal	- see profile			OK
	8	3' S	12:51	12:57	12:57	1:08	11min
		12'10" Bottom		- see profile			OK
	7b	5' S	1:05	1:19	1:19	1:45	26min
		12'3" Refusal		- see profile			OK
	3	3'10" S	1:19	1:20	1:20	1:24	4min
		11'6" Refusal		- see profile			OK

REMARKS _____

TYPE OF SOIL _____

TESTED BY Goedeking

TRENCH DESIGN DATA: AVG. PERCOLATION TIME _____

INLET DEPTH _____ MAXIMUM BOTTOM DEPTH _____

ALSO PRESENT Tim Feagg

TRENCH WIDTH _____

SQ. FT./BEDROOM _____

APPLICATION

PERCOLATION TESTING

A 515951

P _____

HOWARD COUNTY HEALTH DEPARTMENT
BUREAU OF ENVIRONMENTAL HEALTH
3525-H ELLICOTT MILLS DRIVE/ELLICOTT CITY, MARYLAND 21043
TELEPHONE: 410-313-2640

DISTRICT _____

DATE 7/20/2001

TO: THE COUNTY HEALTH OFFICER
ELLICOTT CITY, MARYLAND

I HEREBY APPLY FOR THE NECESSARY TEST PRIOR TO APPLICATION FOR PERMIT TO CONSTRUCT (OR RECONSTRUCT) A SEWAGE DISPOSAL SYSTEM.

PROPERTY OWNER Jeffrey Shumaker

ADDRESS 854 Route 97, Cooksville, MD 21723 PHONE _____

AGENT OR PROSPECTIVE BUYER Heritage Land Development

ADDRESS 3060 Washington Rd., Suite 220, Glenwood, MD 21738 PHONE 410-489-7900

PROPERTY LOCATION:

SUBDIVISION _____ LOT NO. 2

ROAD AND DESCRIPTION _____

854 Route 97

TAX MAP NO. 8 PARCEL # 237

SIZE OF LOT 3+ Acres TYPE OF BLDG. SFD
(SINGLE FAMILY DWELLING OR COMMERCIAL)

THE SYSTEM INSTALLED UNDER THIS APPLICATION IS ACCEPTABLE ONLY UNTIL PUBLIC FACILITIES BECOME AVAILABLE. I FULLY UNDERSTAND THE FEE CONNECTED WITH THE FILING OF THIS PERC TEST APPLICATION IS NON-REFUNDABLE UNDER ANY CIRCUMSTANCES. I ALSO AGREE TO COMPLY WITH ALL M.O.S.H.A. REQUIREMENTS IN TESTING THIS LOT.

 _____
(SIGNATURE OF APPLICANT)

APPROVED BY _____ FOR _____ DATE _____

DISAPPROVED BY _____ FOR _____ DATE _____

HOLD PENDING FURTHER TESTS _____

REASONS FOR REJECTION OR HOLDING _____

PERCOLATION TEST PLAT/PRELIMINARY PLAT - TITLE OR I.D. # _____ DATE _____

SITE DEVELOPMENT PLAN/FINAL PLAT - TITLE OR I.D. # _____ DATE _____

THIS IS NOT A PERMIT

COUNTY #

SOIL PROFILE

0' (6)
 1' Topsoil
 Rd brn
 org brn
 CL Lm
 Rock Frag
 3-5%

6' Tan
 beige
 brn
 Si Lm
 25-35%
 Rock Frag

4' Refusal
 (1C)

1' Topsoil
 org brn
 lt brn
 Si Lm
 10-15%
 Rock Frag

6' org brn
 lt brn
 Si Lm
 25-35%
 Rock Frag

9" Refusal
 (5a)

1' Topsoil
 lt brn
 brn
 tan
 Si Lm

rd brn
 org brn
 tan
 Si Lm
 15-20%
 Rock
 Saprolite

2' Refusal

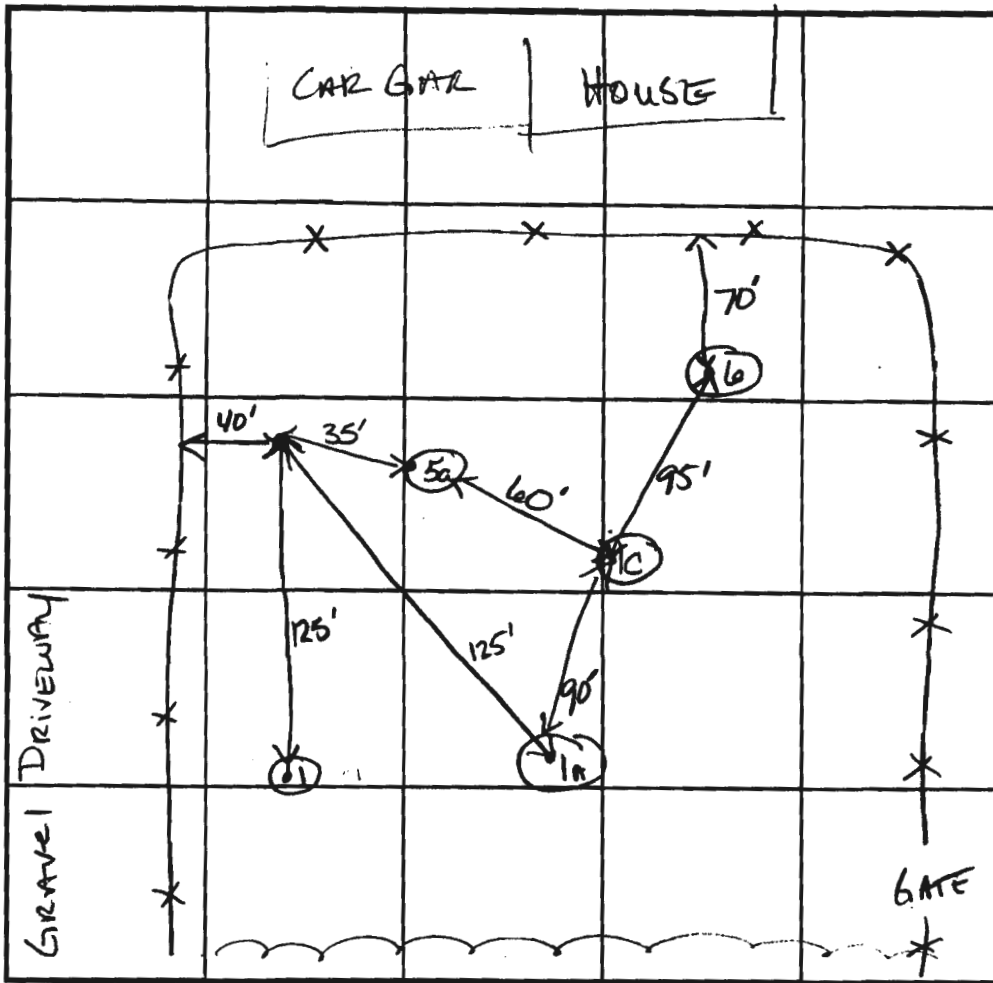

SOIL PROFILE

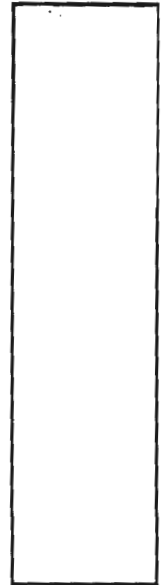

INDICATE NORTH - NAME ADJOINING ROADWAY AS BASE LINE.

RT 97

DATE	TEST NO.	DEPTH	PRE-WET		TEST - 1" DROP		TIME
			START	STOP	START	STOP	
8-6-01	6	2'4" S 12'4" D	1:45	1:52	1:52	2:14	22 min ok
	1C	3' S 10'9" D	1:51 ⁰⁰	1:52 ⁰⁰	1:52 ⁰⁰	1:53 ⁰⁰	1 min ok
	5a	3'3" S 12' D	2:05	2:07	2:07	2:08	1 min ok
			2:09	2:10	2:10	2:11	1 min ok
	5	6.0' ± D Refusal	(70% Rx @ 2')		→		FAIL
	1	6.0' ± D Refusal	(70% Rx @ 2')		→		FAIL
	1A	6.0' ± D Refusal	(70% Rx @ 2')		→		FAIL
	1B	6.0' ± D Refusal	(70% Rx @ 2')		→		FAIL

REMARKS

TYPE OF SOIL

TESTED BY Gnedeking, K

ALSO PRESENT T. Feaga

TRENCH DESIGN DATA: AVG. PERCOLATION TIME

TRENCH WIDTH

INLET DEPTH

MAXIMUM BOTTOM DEPTH

SQ. FT./BEDROOM

APPLICATION

PERCOLATION TESTING

A 515951

P _____

HOWARD COUNTY HEALTH DEPARTMENT
BUREAU OF ENVIRONMENTAL HEALTH
3525-H ELLICOTT MILLS DRIVE/ELLICOTT CITY, MARYLAND 21043
TELEPHONE: 410-313-2640

DISTRICT _____

DATE 7/20/2001

TO: THE COUNTY HEALTH OFFICER
ELLICOTT CITY, MARYLAND

I HEREBY APPLY FOR THE NECESSARY TEST PRIOR TO APPLICATION FOR PERMIT TO CONSTRUCT (OR RECONSTRUCT) A SEWAGE DISPOSAL SYSTEM.

PROPERTY OWNER Jeffrey Shumaker

ADDRESS 854 Route 97, Cooksville, MD 21723 PHONE _____

AGENT OR PROSPECTIVE BUYER Heritage Land Development

ADDRESS 3060 Washington Rd., Suite 220, Glenwood, MD 21738 PHONE 410-489-7900

PROPERTY LOCATION:

SUBDIVISION _____ LOT NO. 2

ROAD AND DESCRIPTION _____

854 Route 97

TAX MAP NO. 8 PARCEL # 237

SIZE OF LOT 3+ Acres TYPE OF BLDG. SFD

(SINGLE FAMILY DWELLING OR COMMERCIAL)

THE SYSTEM INSTALLED UNDER THIS APPLICATION IS ACCEPTABLE ONLY UNTIL PUBLIC FACILITIES BECOME AVAILABLE. I FULLY UNDERSTAND THE FEE CONNECTED WITH THE FILING OF THIS PERC TEST APPLICATION IS NON-REFUNDABLE UNDER ANY CIRCUMSTANCES. I ALSO AGREE TO COMPLY WITH ALL M.O.S.H.A. REQUIREMENTS IN TESTING THIS LOT.

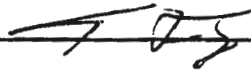

(SIGNATURE OF APPLICANT)

APPROVED BY _____ FOR _____ DATE _____

DISAPPROVED BY _____ FOR _____ DATE _____

HOLD PENDING FURTHER TESTS _____

REASONS FOR REJECTION OR HOLDING _____

PERCOLATION TEST PLAT/PRELIMINARY PLAT - TITLE OR I.D. # _____ DATE _____

SITE DEVELOPMENT PLAN/FINAL PLAT - TITLE OR I.D. # _____ DATE _____

THIS IS NOT A PERMIT



APPLICATION

FOR PERCOLATION TESTING AND SITE EVALUATION

TEST DATE(S) _____ TEST TIME _____ A/P _____

AGENCY REVIEW: _____ DATE _____

DO NOT WRITE ABOVE THIS LINE

I HEREBY APPLY FOR THE NECESSARY TESTING/EVALUATION PRIOR TO ISSUANCE OF SEWAGE DISPOSAL SYSTEM PERMIT(S) TO:

CHECK AS NEEDED:

- CONSTRUCT NEW SEPTIC SYSTEM(S)
- REPAIR/ADD TO AN EXISTING SEPTIC SYSTEM
- REPLACE AN EXISTING SEPTIC SYSTEM

CHECK AS NEEDED:

- NEW STRUCTURE(S)
- ADDITION TO AN EXISTING STRUCTURE
- REPLACE AN EXISTING STRUCTURE

CHECK ONE:

- CREATE NEW LOT(S)
- BUILD ON AN EXISTING LOT IN A SUBDIVISION
- BUILD ON AN EXISTING PARCEL OF RECORD

IS THE PROPERTY WITHIN 2500' OF ANY RESERVOIR?

- YES
- NO

THE TYPE OF STRUCTURE IS:

- RESIDENTIAL WITH _____ PROPOSED BEDROOMS IN THE COMPLETED STRUCTURE (NOTE *UNKNOWN* IF APPROPRIATE)
- COMMERCIAL (PROVIDE DETAIL OF NUMBERS AND TYPES OF EMPLOYEES/ CUSTOMERS ON ACCOMPANYING PLAN)
- INSTITUTIONAL/GOVERNMENT (PROVIDE DETAIL OF NUMBERS AND TYPES OF EMPLOYEES/USERS ON ACCOMPANYING PLAN)

PROPERTY OWNER(S) Marilyn Percival c/o Mildenberg Boender & Assoc., Inc

DAYTIME PHONE (410) 997-0296 CELL _____ FAX (410) 997-0298

MAILING ADDRESS 7350-B Grace Dr. Columbia Md 21044
STREET CITY/TOWN STATE ZIP

APPLICANT same as above

DAYTIME PHONE _____ CELL _____ FAX _____

MAILING ADDRESS _____
STREET CITY/TOWN STATE ZIP

APPLICANT'S ROLE: DEVELOPER BUILDER BUYER RELATIVE/FRIEND REALTOR CONSULTANT

PROPERTY LOCATION
SUBDIVISION/PROPERTY NAME Percival Property LOT NO. 2

PROPERTY ADDRESS Hoods Mill Rd. Cooksville MD 21723
STREET TOWN/POST OFFICE

TAX MAP PAGE(S) 08 GRID 05 PARCEL(S) 237 PROPOSED LOT SIZE 1.25 ac

AS APPLICANT, I UNDERSTAND THE FOLLOWING: THE SYSTEM INSTALLED SUBSEQUENT TO THIS APPLICATION IS ACCEPTABLE ONLY UNTIL PUBLIC SEWERAGE IS AVAILABLE. THIS APPLICATION IS COMPLETE WHEN ALL APPLICABLE FEES AND A SUITABLE SITE PLAN HAVE BEEN RECEIVED. I ACCEPT THE RESPONSIBILITY FOR COMPLIANCE WITH ALL M.O.S.H.A. AND "MISS UTILITY" REQUIREMENTS. APPROVAL IS BASED UPON SATISFACTORY REVIEW OF A PERC CERTIFICATION PLAN.

TEST RESULTS WILL BE MAILED TO APPLICANT. _____
SIGNATURE OF APPLICANT

HOWARD COUNTY HEALTH DEPARTMENT, BUREAU OF ENVIRONMENTAL HEALTH, WELL AND SEPTIC PROGRAM
7178 COLUMBIA GATEWAY DRIVE COLUMBIA, MARYLAND 21046 (410) 313-2640 FAX (410) 313-2648
TDD (410) 313-2323 TOLL FREE 1-877-4MD-DHMH

CLEARED AREA

A Marginal

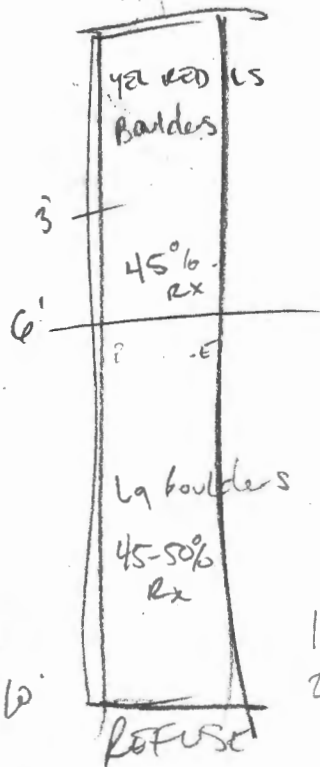

OBS HOLE was broken

PERC HOLE was not

