

DRILLER: COMPLETE THIS APPLICATION AND RETURN ALL PARTS OF THIS FORM INTACT TO THE ENVIRONMENTAL AGENCY IN THE COUNTY IN WHICH THE WELL IS TO BE DRILLED. PRESS FIRMLY FOR FOURTH COPY.

OS-34729

EMERGENCY/TEMP NO. IF ANY

B 1	65014	SEQUENCE NO. (MDE USE ONLY)	STATE OF MARYLAND APPLICATION FOR PERMIT TO DRILL WELL 565548 please type	STATE PERMIT NUMBER <del>10-18-0100</del> fill in this form completely 79
-----	-------	-----------------------------	---	---

Date Received (APA) 07/11/19

**OWNER INFORMATION**

8 MM DD YY 13: 07 11 19

15 Last Name: Wolf Michael + Rosamée T/E

36 Street or RFD: 7020 Columbia Gateway Dr

57 Town: Columbia MD 21046

70 State: MD 72 Zip: 21046

**LOCATION OF WELL**

8 COUNTY: Howard

23 SUBDIVISION: Allnut Farms Est

SECTION: Highland

LOT: 15

52 NEAREST TOWN: Highland

**DRILLER INFORMATION**

Driller's Name: Marshal Arnette M SD 106

76 License No. 81

Firm Name: Allied Well Drilling

Address: PO Box 129 Annapolis Junction MD 20701

Signature: Marshal Arnette Date: 07/21/19

**SOURCES OF DRILLING WATER**

1 Public

2

3

Open Space Ct

11 STREET ADDRESS 30

ON WHICH SIDE OF ROAD (CIRCLE APPROPRIATE BOX)

NORTH N

WEST W EAST E

SOUTH S

34 37 DISTANCE FROM ROAD

ENTER FT OR MI 38 39

TAX MAP: 0034 BLK: PARCEL 0375

**WELL INFORMATION**

APPROX. PUMPING RATE (GAL. PER MIN.) 10

8 12

AVERAGE DAILY QUANTITY NEEDED (GAL. PER DAY) 1,000

14 20

**USE FOR WATER (CIRCLE APPROPRIATE BOX)**

DOMESTIC POTABLE SUPPLY & RESIDENTIAL IRRIGATION

FARMING (LIVESTOCK WATERING & AGRICULTURAL IRRIGATION)

INDUSTRIAL, COMMERCIAL, DEWATERING

PUBLIC WATER SUPPLY WELL

TEST, OBSERVATION, MONITORING

OPEN LOOP GEOTHERMAL

CLOSED LOOP GEOTHERMAL

**NOT TO BE FILLED IN BY DRILLER HEALTH DEPARTMENT APPROVAL**

COUNTY NAME: COUNTY NO.:

STATE SIGNATURE: INSERT S → 41

DATE ISSUED: 43 MM DD YY 48 CO SIGNATURE EXP. DATE

APPROXIMATE DEPTH OF WELL 400 FEET

24 28

APPROXIMATE DIAMETER OF WELL 6 INCH

NEAREST INCH

**METHOD OF DRILLING (circle one)**

BORED (or Augered) JETTED Jetted & DRIVEN

30 AIR-ROTary AIR-PERCussion ROTARY (Hydraulic Rotary)

37 CABLE REVerse-ROTary Drive-POINT

other

**REPLACEMENT OR DEEPEMED WELLS (CIRCLE APPROPRIATE BOX)**

THIS WELL WILL NOT REPLACE AN EXISTING WELL

THIS WELL WILL REPLACE A WELL THAT WILL BE ABANDONED AND SEALED

39  THIS WELL WILL REPLACE A WELL THAT WILL BE USED AS A STANDBY-CONTACT LOCAL APPROVING AUTHORITY FOR POLICY ON STANDBY WELLS

THIS WELL WILL DEEPEM AN EXISTING WELL

PERMIT NUMBER OF WELL TO BE REPLACED OR DEEPEMED (IF AVAILABLE) 41 52

**Not to be filled in by driller (MDE OR COUNTY USE ONLY)**

APPROP. PERMIT NUMBER: G

PERMIT No. ~~10-18-0100~~

70 71 72 73 74 75 76 77 78 79

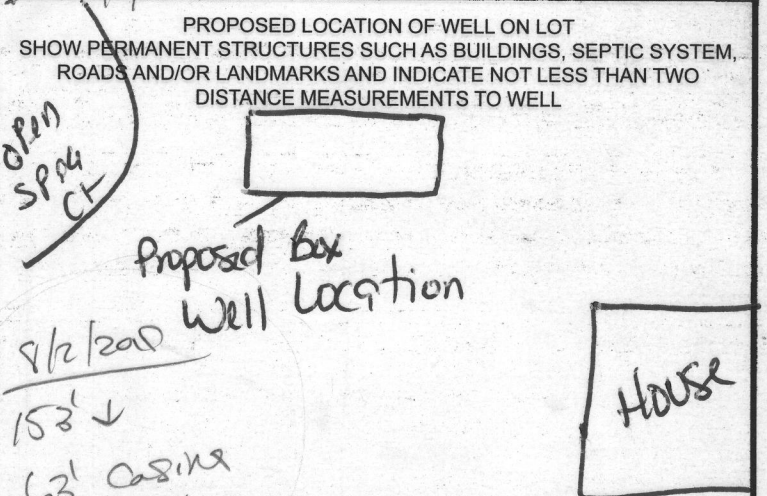

Pursuant to § 10-624 of the State Govt. Article of the Maryland Code, personal info requested on this form is used in processing this form pursuant to COMAR 26.04.04. Failure to provide the info may result in this form not being processed. You have the right to inspect, amend, or correct this form. The Maryland Department of the Environment is subject to the Maryland Public Information Act. This form may be made available on the Internet via MDE's website and is subject to inspection or copying, in whole or in part, by the public and other governmental agencies, if not protected by federal or State Law.

**SPECIAL CONDITIONS**

NOTE APPROVING AUTHORITIES SHOULD USE SEPARATE SHEET IF NEEDED

KNOWN Samples

**DRILLER: COMPLETE THIS FORM AND RETURN ALL PARTS OF THIS FORM INTACT TO THE ENVIRONMENTAL AGENCY IN THE COUNTY IN WHICH THE WELL IS TO BE DRILLED. PRESS FIRMLY FOR FIFTH COPY.**

<b>C 1</b> <b>41843</b>	SEQUENCE NO. (MDE USE ONLY)	<b>STATE OF MARYLAND</b> <b>WELL COMPLETION REPORT</b> FILL IN THIS FORM COMPLETELY PLEASE TYPE	THIS REPORT MUST BE SUBMITTED WITHIN 45 DAYS AFTER WELL IS COMPLETED.
1 2 3 6 (THIS NUMBER IS TO BE PUNCHED IN COLS. 3-6 ON ALL CARDS)		COUNTY NUMBER	
ST/CO USE ONLY DATE RECEIVED MM <u>01</u> DD <u>13</u> 19 <u>19</u>	DATE WELL COMPLETED MM <u>08</u> DD <u>06</u> YY <u>2019</u> 15 20	Approved <u>9/30/19</u> (ST)	DEPTH OF WELL <u>400</u> (TO NEAREST FOOT)
OWNER <u>Phillips</u> <u>Gregory</u>		PERMIT NO. FROM "PERMIT TO DRILL WELL" <u>Ho-18-0100</u>	
WELL SITE ADDRESS <u>Open Space Ct</u>		TOWN <u>Highland</u>	
SUBDIVISION <u>Alburt Farm Est</u>		SECTION <u>5</u> LOT <u>15</u>	
<b>WELL LOG</b> Not required for driven wells		<b>GROUTING RECORD</b>	
STATE THE KIND OF FORMATIONS PENETRATED, THEIR COLOR, DEPTH, THICKNESS AND IF WATER BEARING		WELL HAS BEEN GROUTED (Circle Appropriate Box) <b>Y</b> <b>N</b>	
DESCRIPTION (Use additional sheets if needed)	FEET		check if water bearing
	FROM	TO	
<u>Sand</u>	<u>0</u>	<u>49</u>	<input checked="" type="checkbox"/>
<u>Mica Rock</u>	<u>49</u>	<u>400</u>	<input checked="" type="checkbox"/>
<u>Water 46, 155'</u>			
TYPE OF GROUTING MATERIAL (Circle one)		NO. OF BAGS <u>16</u> NO. OF POUNDS <u>1304</u>	
CEMENT <b>CM</b> BENTONITE CLAY <b>BC</b>		GALLONS OF WATER <u>96</u>	
DEPTH OF GROUT SEAL (to nearest foot)		GALLONS OF WATER <u>96</u>	
from <u>0</u> ft. to <u>60</u> ft.		GALLONS OF WATER <u>96</u>	
(enter 0 if from surface)		GALLONS OF WATER <u>96</u>	
Casing types insert appropriate code below		Casing Record	
		<b>ST</b> <b>CO</b> STEEL CONCRETE	
		<b>PL</b> <b>OT</b> PLASTIC OTHER	
MAIN CASING TYPE <u>5t</u>		Nominal diameter top (main) casing (nearest inch)! <u>6</u>	
60 61		Total depth of main casing (nearest foot) <u>63</u>	
63 64		66 70	
OTHER CASING (if used)		EACH CASING	
diameter depth (feet)		inch from to	
SCREEN RECORD		DEPTH (nearest ft.)	
screen type or open hole (insert appropriate code below)		<b>ST</b> <b>BR</b> <b>HO</b> STEEL BRASS OPEN HOLE	
		<b>PL</b> <b>OT</b> PLASTIC OTHER	
NUMBER OF UNSUCCESSFUL WELLS: <u>0</u>		WELL HYDROFRACTURED <b>Y</b> <b>N</b>	
CIRCLE APPROPRIATE LETTER		C 2	
<b>A</b> A WELL WAS ABANDONED AND SEALED WHEN THIS WELL WAS COMPLETED		T 2	
<b>E</b> ELECTRIC LOG OBTAINED		E 1 <u>Ho</u> <u>61</u> <u>400</u> ✓	
<b>P</b> TEST WELL CONVERTED TO PRODUCTION WELL		E 8 9 11 15 17 21	
I HEREBY CERTIFY THAT THIS WELL HAS BEEN CONSTRUCTED IN ACCORDANCE WITH COMAR 26.04.04 "WELL CONSTRUCTION" AND IN CONFORMANCE WITH ALL CONDITIONS STATED IN THE ABOVE CAPTIONED PERMIT, AND THAT THE INFORMATION PRESENTED HEREIN IS ACCURATE AND COMPLETE TO THE BEST OF MY KNOWLEDGE.		E 23 24 26 30 32 36	
DRILLERS LIC. NO.: <u>M5D027</u>		E 38 39 41 45 47 51	
DRILLERS SIGNATURE <u>[Signature]</u>		E 56 60	
(MUST MATCH SIGNATURE ON APPLICATION)		E 70 72	
LIC. NO.: <u>D</u>		E 74 75 76	
SITE SUPERVISOR (sign. of driller or journeyman responsible for sitework if different from permittee)		TELESCOPE CASING LOG INDICATOR OTHER DATA	
		GRAVEL PACK IF WELL DRILLED WAS FLOWING WELL INSERT F IN BOX 68 <u>68</u>	
		MDE USE ONLY (NOT TO BE FILLED IN BY DRILLER) T (E.R.O.S.) W Q	
		LATITUDE <u>39.19820</u>	
		LONGITUDE <u>76.96540</u>	
		(DEFAULT COORD. WGS 84)	
		Pursuant to §10-624 of the State Govt. Article of the Maryland Code personal info. requested on this form is used in processing this form pursuant to COMAR 26.04.04. Failure to provide the info. may result in this form not being processed. You have the right to inspect, amend, or correct this form. The Maryland Department of the Environment is subject to the Maryland Public Information Act. This form may be made available on the Internet via MDE's website and is subject to inspection or copying, in whole or in part, by the public and other governmental agencies, if not protected by federal or state law.	



## Oswald, Hank

---

**From:** Oswald, Hank  
**Sent:** Friday, July 12, 2019 4:39 PM  
**To:** 'gphillips@mred.us'  
**Cc:** Williams, Jeffrey; Wolf, Kevin; Cabahug, Joseph  
**Subject:** Well Permit Application\_Open Space Court Lot 15

Hi Greg:

Good afternoon. Our office is in receipt of a second well permit application from Allied Well Drilling for Open Space Court, Lot 15. Can you provide this office with an update? Did the owner change drillers because our office already issued the permit to Larry Mayne.

Thanks,

Hank

Hank Oswald  
Licensed Environmental Health Specialist  
Howard County Health Department  
Bureau of Environmental Health  
Well & Septic Program  
8930 Stanford Boulevard  
Columbia, MD 21045  
410.313.1786 (Office)  
[hoswald@howardcountymd.gov](mailto:hoswald@howardcountymd.gov)

### CONFIDENTIALITY NOTICE

This message and the accompanying documents are intended only for the use of the individual or entity to which they are addressed and may contain information that is privileged, confidential, or exempt from disclosure under applicable law. If the reader of this email is not the intended recipient, you are hereby notified that you are strictly prohibited from reading, disseminating, distributing, or copying this communication. If you have received this email in error, please notify the sender immediately and destroy the original transmission.



Maura J. Rossman, M.D., Health Officer

**INTERIM CERTIFICATE OF POTABILITY**  
**PERMANENT DEVIATION FOR RADIUM**

**Expiration Date – JULY 26, 2021**

January 26, 2021

Homeowner  
13488 Open Space Court  
Highland, MD 20777

**RE: Allnut Farm Est., Lot 15**  
13488 Open Space Court  
**Building Permit: B20000083**  
**Well Permit: HO-18-0100**

Dear Homeowner:

This is to advise you that the septic system installation and water well construction for the above referenced property have been inspected and approved. Final approval of the septic system was granted on **12/9/2020**. Final approval of the well line connection to the dwelling was granted on **11/25/2020**. The well construction was completed on **8/6/2019**. Water samples were collected on **5/14/2020**.

The water sample results indicate that the water samples submitted for testing were free of coliform and fecal coliform bacteria at the time of sampling and are bacteriologically safe for drinking.

Gross Alpha and Beta samples were also collected on **10/1/2019**. Results showed a Gross Alpha level of **24.4 ± 3.5 pCi/L** and a Gross Beta level of **38.2 ± 3.3 pCi/L**. **This exceeds the maximum contaminant level (MCL) combined Radium 226 and 228 of 5.0 pCi/L.**

After installation of a radionuclide removal device (Reverse Osmosis), post-treatment water samples were collected on **1/5/2021** and indicated a combined Radium 226/228 level of **<1.0 pCi/L** which is below the MCL of 5 pCi/L.

This Department will grant a **permanent deviation** to the Interim Certificate of Potability on condition that the radionuclide removal system effectively maintains a Gross Alpha level of less than **15 pCi/L**, a Gross Beta level of less than **50 pCi/L**, and a Radium 226/228 level of less than **5 pCi/L**.

**Furthermore, it will be necessary for you to comply with the following conditions:**

1. The system must be properly operated and maintained continuously in accordance with the service contract for the life of the residence.
2. It is recommended that a Maryland certified water laboratory certified for radionuclide analysis perform a yearly radionuclide analysis.

Maura J. Rossman, M.D., Health Officer

3. If you decide to sell or rent your home in the future, you must make any potential buyer/tenant aware of this permanent deviation. **A person who fails to make this disclosure is subject to the penalties set out in COMAR 26.04.04.12F Enforcement and Environment Article 9-1311, Annotated Code of Maryland.**

This certifies that the initial sampling requirements of COMAR 26.04.04 "Well Regulations" have been met for the water supply system installed under well permit HO-18-0100. Although the submitted sample results are in compliance with COMAR standards, the Health Department does not guarantee water supplies.

This Interim Certificate of Potability will expire **six months** from the date of issuance. Submission of a second bacteriological test indicating the water is free of coliform and fecal coliform bacteria is required prior to the expiration date, after which time a Final Certificate of Potability will be issued. **Failure to submit an additional sample and obtain a Final Certificate of Potability will result in a Notice of Violation and is punishable as a misdemeanor under the *Annotated Code of Maryland, Environment Article, 9-1311*, subject to a fine of up to \$500 or imprisonment not to exceed three months.**

Please contact (410) 313-1773 to schedule a final water sample appointment or contact a Maryland certified water quality laboratory to schedule a water sample. A list of laboratories certified by the state of Maryland may be found at the following website:  
<http://www.mde.state.md.us/assets/document/WSP-Labs-2010apr16.pdf>

In closing, please refer to our "[Homeowner Fact Sheet](#)" which illustrates a better understanding for your onsite sewage disposal system. You will also find a link to Maryland Department of the Environment website which describes in further detail operation and maintenance of your septic system.

Approving Authority,

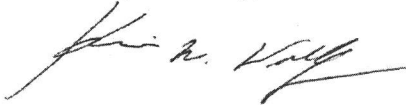

Kevin M Wolf, L.E.H.S., R.E.H.S./RS, Supervisor  
Groundwater Management Section  
Well & Septic Program

cc: Howard County Dept. of Inspections, Licenses, and Permits  
Community Hygiene Program  
File

**HOWARD COUNTY HEALTH DEPARTMENT  
BUREAU OF ENVIRONMENTAL HEALTH  
WELL & SEPTIC PROGRAM  
TEL: (410)313-1771 FAX: (410)313-2648**

**Information Form for the Installation of the Well Pump, Pitless Adapter, and Supply Piping**

**NOTE: The installer is responsible for requesting an inspection prior to 9 am on the day of the desired inspection. No work is to be covered until approved by the Health Department. All installations must comply with the National Standard Plumbing Code (NSPC, as amended locally) and COMAR 26.04.04 (MD Well Construction Regulations). Submission of a complete form is required prior to Use and Occupancy approval.**

Company Name: BARLOW Well Drilling Telephone #: 410-838-6910  
Address: 522 UNDERWOOD LANE  
Bel Air MD 21014

(Must circle one) Licensed Plumber  Licensed Well Driller  Licensed Well Pump Installer  
License # and name of individual responsible for the field installation:  
Name (Print): Michael Isom License# MSD 162

**\*A licensed individual must perform the actual installation. Apprentices must be under the supervision of a licensed journeyman or master plumber, pump installer or well driller. Licenses may be subjected to field verification. Unlicensed individuals may be reported to the appropriate licensing agency.**

Name of Property Owner: CARUSO Homes Telephone #: 301-832-5266  
Subdivision: ALNUH FARMS Lot #: 15 Well Tag #: HO-18-0100 (ST)  
Site Address: 13488 OPEN SPACE COURT  
HIGHLAND, MD 20777

<u>Submersible Pump Data</u>	<u>Pitless Adapter</u>	<u>Well Cap and Electric Conduit</u>
Make: <u>Starite</u>	Make: <u>BJJ</u>	Two piece watertight cap: <input checked="" type="checkbox"/>
Model #: <u>515P4HS20</u>	Model#: <u>P100SS</u>	Screened, vented well cap: <input checked="" type="checkbox"/>
Pump Capacity <u>15</u> GPM	Depth: <u>42</u> (36" min)	Cap secured to casing: <input checked="" type="checkbox"/>
Well Yield: <u>12</u> GPM	NSF/WSC approved: <u>Yes</u>	Conduit min 18" B.G.: <input checked="" type="checkbox"/>
Depth of well encountered at time of pump installation: _____ (feet)		Conduit secured to well cap: <input checked="" type="checkbox"/>

If pump capacity exceeds well yield, a low water cut off switch is required by NSPC 1990 Section 17.8.4  
Torque arrestors, Cable guards, or other acceptable method used- Must circle one  
Safety rope, if used, attached to brass rope adapter or other acceptable method inside of well casing

<u>Piping to house</u>	<u>House Connection</u>
Type: <u>P014-114"</u>	PVC sleeve to undisturbed soil at wall penetration: <input checked="" type="checkbox"/>
PSI: <u>200</u> (160 psi min)	Length of sleeve(5' minimum from foundation): <u>6'</u>
Depth of supply line: <u>42"</u> (36" min)	Sleeve sealed properly: <input checked="" type="checkbox"/>

**The water supply line is required to be at least ten feet from the septic tank, pump chamber, sewage piping, distribution box, drainfields, and sewage reserve area. If this cannot be accomplished, contact this office for approval prior to installation.**

Signature of company representative responsible for installation \_\_\_\_\_ date 5/12/2020

**For Health Department Use Only - Not to be completed by Installer**

Date Insp. Requested: 5/20/20 Date Insp. Approved: 5/20/20 <sup>11/25/20</sup> Inspector: (ST)

Inspection Data: Pitless adapter watertight & water supply line at least 36" below grade  49"  
Two piece cap installed and attached to casing securely   
Elec. conduit extends at least 18" below grade/attached to cap properly  40"  
Safety rope not outside of well cap/casing   
Correct well tag attached properly and casing 8" above finished grade  9"  
Water supply line sleeved adequately at house connection   
Adequate grout observed below pitless adapter

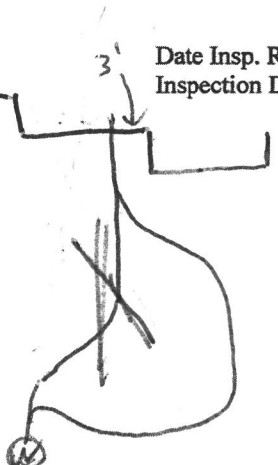

*not sleeved 5' from porch foundation, line takes turn to avoid being under steps & driveway (ST)  
11/25/20 sleeved until above septic area. New route (see as built) - (ST)*

**Re: RUSH 13488 Open Space Ct, Highland // 12-18-20 // 20.17003**

Wolf, Kevin <KWolf@howardcountymd.gov>

Mon 1/4/2021 12:36 PM

To: Ken At Caruso Homes <kknode@carusohomes.com>; Dipender Singh <dipender560@gmail.com>  
Cc: Timothy Edwards <tedwards@haguewaterofmd.com>

 2 attachments (2 MB)

20.17003.pdf; Radium Agreement 2.11.19.pdf;

Ken,

The submitted radium results appear to be above the recommended mcl which fail to meet EPA regulations. From the original potability report, it shows there is a softener installed in the house already. In order for me to approve the water safe and potable to issue the ICOP, the following will need to occur.

- Post treated samples for gross alpha/beta long term plus radium 226, 228 must be taken
- Radium agreement form (attached) needs to be completed, signed by the owner, reviewed and signed by the Health Department, and recorded with the Office of Land Records.



Let me know if you have questions on this.

Thanks,

Kevin M. Wolf, LEHS, REHS/RS  
Groundwater Mgmt. Sec. Supervisor  
Well & Septic Program  
Howard County Health Department  
8930 Stanford Blvd.  
Columbia, MD 21045  
410-313-2645 (Office)  
410-313-2648 (Fax)

[www.hchealth.org](http://www.hchealth.org)

 cid:image003.png@01D5EB16.8DB07FA0

 cid:image007.png@01D5EB16.8DB07FA0  cid:image010.png@01D5EB16.8DB07FA0

 logo-instagram-background-png

[kwolf@howardcountymd.gov](mailto:kwolf@howardcountymd.gov)

#### CONFIDENTIALITY NOTICE

This message and the accompanying documents are intended only for the use of the individual or entity to which they are addressed and may contain information that is privileged, confidential, or exempt from disclosure under applicable law. If the reader of this email is not the intended recipient, you are hereby notified that you are strictly prohibited from reading, disseminating, distributing, or copying this communication. If you have received this email in error, please notify the sender immediately and destroy the original transmission.

---

**From:** Timothy Edwards <tedwards@haguewaterofmd.com>

**Sent:** Thursday, December 31, 2020 2:53 PM

**To:** Ken At Caruso Homes <kknode@carusohomes.com>; Wolf, Kevin <KWolf@howardcountymd.gov>; Dipender Singh <dipender560@gmail.com>

**Subject:** Fwd: RUSH 13488 Open Space Ct, Highland // 12-18-20 // 20.17003

[Note: This email originated from outside of the organization. Please only click on links or attachments if you know the sender.]

Sent from my iPhone

Begin forwarded message:

**From:** Timothy Edwards <tedwards@haguewaterofmd.com>  
**Date:** December 31, 2020 at 2:46:30 PM EST  
**To:** Dipender Singh <dipender560@gmail.com>  
**Subject: Fwd: RUSH 13488 Open Space Ct, Highland // 12-18-20 // 20.17003**

Sent from my iPhone

Begin forwarded message:

**From:** Timothy Edwards <tedwards@haguewaterofmd.com>  
**Date:** December 31, 2020 at 2:26:41 PM EST  
**To:** Ken At Caruso Homes <kknode@carusohomes.com>  
**Subject: Fwd: RUSH 13488 Open Space Ct, Highland // 12-18-20 // 20.17003**

Sent from my iPhone

Begin forwarded message:

**From:** Kathleen Bridgeman <kbridgeman@haguewaterofmd.com>  
**Date:** December 30, 2020 at 5:15:07 PM EST  
**To:** Timothy Edwards <tedwards@haguewaterofmd.com>  
**Subject: Fwd: RUSH 13488 Open Space Ct, Highland // 12-18-20 // 20.17003**

Kathleen Bridgeman  
Director of Financial Services  
Hague Quality Water of Maryland &  
Chesapeake Cooler Company  
410-757-2992  
410-974-1821 fax  
814 E. College Parkway  
Annapolis, MD 21409  
[www.HagueWaterofMD.com](http://www.HagueWaterofMD.com)  
[www.ChesCoCo.com](http://www.ChesCoCo.com)

Review Us:

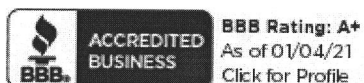

----- Forwarded message -----

From: <[jstottler@knlenvironmental.com](mailto:jstottler@knlenvironmental.com)>

Date: Wed, Dec 30, 2020 at 5:08 PM

Subject: RUSH 13488 Open Space Ct, Highland // 12-18-20 // 20.17003

To: Hague-Reports <[Testing@haguewaterofmd.com](mailto:Testing@haguewaterofmd.com)>

Please see attached and thank you!

Julie Stottler, Office Manager

KNL Environmental Testing

3202 N. Florida Ave.

Tampa, FL 33603

813-229-2879

[www.knlenvironmental.com](http://www.knlenvironmental.com)



HAGUE RUSH

**[jstottler@knlenvironmental.com](mailto:jstottler@knlenvironmental.com)**

---

**From:** jstottler@knlenvironmental.com  
**Sent:** Friday, January 08, 2021 3:23 PM  
**To:** Hague-Reports (Testing@HagueWaterofMD.com)  
**Cc:** 'Elizabeth Luffman (eluffman@knlenvironmental.com)'  
**Subject:** RUSH Request- 13488 Open Space Ct // 21.329

Hi Tim,

Per your conversation with Elizabeth, KNL will doing a 5-day RUSH analysis for 13488 Open Space Ct, Highland, MD

Julie Stottler, Office Manager  
KNL Environmental Testing  
3202 N. Florida Ave.  
Tampa, FL 33603  
813-229-2879  
[www.knlenvironmental.com](http://www.knlenvironmental.com)



# KNL Environmental

3202 N. Florida Ave. Tampa, FL 33603  
 Phone: (813) 229-2879 Fax: (813) 229-0002

## CHAIN OF CUSTODY RECORD

Email: jhayes@knlenvironmental.com

20.17003  
 RUSH 12-30-20

Company Name:

HAVE WATER OF MARYLAND

Address:

8149 COLLEGE PKWY

City/State/Zip:

ANNAPOLIS MD 21409

Phone #:

410-757-2992

Attn:

TIM

Preservative

# of containers  
 Analysis Requested

NO3

Random 2264228-RUS1

Shot + Low-Temp Gross A<sub>2</sub>P<sub>4</sub> + B<sub>2</sub>P<sub>4</sub>

RUSH - 57007

\*WW - Wastewater DW - Drinking Water GW - Groundwater SW - Surface Water SL - Sludge Other:  
 Special Instructions:

Relinquished By:		Accepted By:	
Print Name/Company	Signature	Print Name/Company	Signature
LIN EDWARDS		KNL	
	Signature		Signature
	Date/Time		Date/Time
	12/18/2020		12-22-20 1057
Relinquished By:		Accepted By:	
Print Name/Company	Signature	Print Name/Company	Signature
	Signature		Signature
	Date/Time		Date/Time
Relinquished By:		Accepted By:	
Print Name/Company	Signature	Print Name/Company	Signature
	Signature		Signature
	Date/Time		Date/Time

Maura J. Rossman, M.D., Health Officer

October 1, 2019

Dipender Singh & Jaspreet Kaur  
9559 Sea Shadow  
Columbia, Maryland 21046

RE: Allnut Farm Estates Lot 15  
Open Space Court  
Well Tag: HO - 18 - 0100

Dear Dipender Singh & Jaspreet Kaur:

A sample was collected during a yield test on August 6, 2019 and submitted to the Maryland Department of Health Laboratories to assess the possible presence of **Gross Alpha** and **Gross Beta** in the future well water supply. **Gross Alpha** and **Gross Beta** measure the total alpha and beta particle activity in a water supply. These naturally occurring radioactive nuclides have been demonstrated to be present in a certain type of geologic formation known as the Baltimore Gneiss which exists in your area of development within the County.

Results from this screening revealed a **Gross Alpha** of  $24.4 \pm 3.5$  picocuries/liter (pCi/L), while the **Gross Beta** level was  $38.2 \pm 3.3$  pCi/L. The **Gross Alpha** result was above its **maximum contaminant level (MCL)** of 15 pCi/L, while the **Gross Beta** level was below (though higher than typically seen) its targeted standard of 50 pCi/L (roughly equivalent to the **annual dose rate** of 4 millirems/year).

At the time of testing and with respect to these parameters, the well water supply **does not meet** EPA regulatory standards. Additional testing **for these parameters** will be required to secure the future Use & Occupancy. Additional raw water samples for **short and long term Gross Alpha and Gross Beta**, plus **Radium 226 / 228** will be needed to assess any future treatment needs. Alternatively, treatment such as a water softener system or point of use reverse osmosis (R/O) could be considered. If installed, post-treated sampling for **short and long term Gross Alpha, Gross Beta and Radium 226 / 228** will be **required**. Please **note** that other standard testing parameters (bacteria, nitrate, turbidity and sand) will still be needed to help secure Use & Occupancy.

A copy of the test results is enclosed for your information. Please call this office at 410-313-1773 if you have any further questions or to schedule additional testing.

Sincerely,

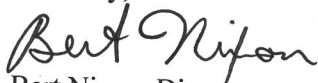

Bert Nixon, Director  
Bureau of Environmental Health

Enclosure  
cc: Property file

Howard County Health Department  
Bureau of Environmental Health  
8930 Stanford Blvd.  
Columbia, Maryland 21045

State of Maryland  
DHMH - Laboratories Administration  
Division of Environmental Sciences  
**RADIATION LABORATORY**  
1770 Ashland Avenue  
Baltimore, Maryland 21205

Lab No. 294-72

**LABORATORY ANALYSIS REQUEST FORM**

Plant/Site Name: ALLIANT FARM EST LOT 15 County: HOWARD

Sample Source: OPEN SPACE COURT Location: HO-18-0100

Radon-222 Bottle A HOLCOICORA Radon-222 Field Blank Bottle A \_\_\_\_\_  
RADIUM Bottle B \_\_\_\_\_ Bottle B \_\_\_\_\_

County 13 Plant No. \_\_\_\_\_

CHECK (one per Box)

Type	Service	Point of Collection	Testing
Drinking Water <input checked="" type="checkbox"/>	Community <input type="checkbox"/>	Source (Raw) <input checked="" type="checkbox"/>	Emergency <input type="checkbox"/>
Landfill <input type="checkbox"/>	Non-Community <input type="checkbox"/>	Distribution (treated) <input type="checkbox"/>	Routine <input checked="" type="checkbox"/>
Stream <input type="checkbox"/>	Private <input checked="" type="checkbox"/>	MCL <input type="checkbox"/>	Recheck <input type="checkbox"/>
Other <input type="checkbox"/>	Other <input type="checkbox"/>		Special <input type="checkbox"/>

Submitters Code: 4 F Federal Project: \_\_\_\_\_  
Collector: CABANUC 001997 Telephone No.: 410 313 2043  
Date Collected: 08/06/2019 Time Collected: 10:15 a.m. \_\_\_\_\_ p.m.  
Field pH: 7.0 Field Chlorine: N/A  
Nitric Acid Preserved: Yes  No  Iced: Yes  No

Remarks: COLLECTED AT YIELD

✓	TEST	EPA Code	Lab No.	Method No.	Results (pCi/L)	Date Analyzed	Analyst	Date Reported
<input checked="" type="checkbox"/>	Gross Alpha	4000	<u>294-C</u>	<u>EPA 900.0</u>	<u>24.4 ± 3.5</u>	<u>8/13/19</u>	<u>RH</u>	<u>8/14/19</u>
<input checked="" type="checkbox"/>	Gross Beta	4100	<u>294-C</u>	<u>EPA 900.0</u>	<u>23.2 ± 3.3</u>	<u>8/13/19</u>	<u>RH</u>	<u>8/14/19</u>
<input type="checkbox"/>	Radium-226	4020						
<input type="checkbox"/>	Radium-228	4030						
<input type="checkbox"/>	Total Uranium	4006						
<input type="checkbox"/>	Radon-222 (Bottle A)	4004						
<input type="checkbox"/>	Radon-222 (Bottle B)	4004						
<input type="checkbox"/>	Radon Field Blank A	4004						
<input type="checkbox"/>	Radon Field Blank B	4004						
<input type="checkbox"/>	Tritium							
<input type="checkbox"/>								
<input type="checkbox"/>								

Date Received: 8/14/19 Received By: [Signature]  
Data Release Signature: [Signature] Date: 8/14/19

Lab Use Only	Yes	No	N/A
Sample Intact upon arrival?	<input checked="" type="checkbox"/>		
Sample pH <2.0?	<input checked="" type="checkbox"/>		
Received within holding time?	<input checked="" type="checkbox"/>		

•Tel. No.: (443) 681-3766 •Fax No.: (443) 681-4507

SEND REPORT TO:

State of Maryland  
DHMH - Laboratories Administration  
Division of Environmental Sciences  
**RADIATION LABORATORY**  
1770 Ashland Avenue  
Baltimore, Maryland 21205

Lab No.

**Howard County Health Department**  
**Bureau of Environmental Health**  
8930 Stanford Blvd.  
Columbia, Maryland 21045

**LABORATORY ANALYSIS REQUEST FORM**

Plant/Site Name: ALPINE FARM EST LOT 15 County: HOWARD

Sample Source: OPEN SPACE COURT Location: E113  
(Well no., lab sink, sample tap, etc.)

Radon-222 Bottle A \_\_\_\_\_ Radon-222 Field Blank Bottle A \_\_\_\_\_  
Bottle B \_\_\_\_\_ Bottle B \_\_\_\_\_

County: 112 Plant No. [ ] [ ] [ ] [ ] [ ] [ ] [ ] [ ] [ ] [ ]

CHECK (one per Box)

Type	Service	Point of Collection	Testing
Drinking Water <input checked="" type="checkbox"/>	Community <input type="checkbox"/>	Source (Raw) <input checked="" type="checkbox"/>	Emergency <input type="checkbox"/>
Landfill <input type="checkbox"/>	Non-Community <input type="checkbox"/>	Distribution (treated) <input type="checkbox"/>	Routine <input checked="" type="checkbox"/>
Stream <input type="checkbox"/>	Private <input checked="" type="checkbox"/>	MCL <input type="checkbox"/>	Recheck <input type="checkbox"/>
Other <input type="checkbox"/>	Other <input type="checkbox"/>		Special <input type="checkbox"/>

Submitters Code: 4 F Federal Project: [ ]

Collector: CABRILLO 001997 Telephone No.: 410 332 643

Date Collected: 08/06/2019 Time Collected: \_\_\_\_\_ a.m. \_\_\_\_\_ p.m.

Field pH: \_\_\_\_\_ Field Chlorine: NEG

Nitric Acid Preserved: Yes  No  Iced: Yes  No

Remarks: FIELD BLANK

✓	TEST	EPA Code	Lab No.	Method No.	Results (pCi/L)	Date Analyzed	Analyst	Date Reported
<input checked="" type="checkbox"/>	Gross Alpha	4000	293	EPA900.0	1.1 ± 0.9	8/8/19	RH	8/13/19
<input checked="" type="checkbox"/>	Gross Beta	4100	293	EPA900.0	1.6 ± 0.5	8/8/19	RH	8/13/19
<input type="checkbox"/>	Radium-226	4020						
<input type="checkbox"/>	Radium-228	4030						
<input type="checkbox"/>	Total Uranium	4006						
<input type="checkbox"/>	Radon-222 (Bottle A)	4004						
<input type="checkbox"/>	Radon-222 (Bottle B)	4004						
<input type="checkbox"/>	Radon Field Blank A	4004						
<input type="checkbox"/>	Radon Field Blank B	4004						
<input type="checkbox"/>	Tritium							
<input type="checkbox"/>								
<input type="checkbox"/>								

Date Received: 8/7/19 Received By: [Signature]

Data Release Signature: [Signature] Date: 8/14/19

Lab Use Only	Yes	No	N/A
Sample Intact upon arrival?	<input checked="" type="checkbox"/>	<input type="checkbox"/>	<input type="checkbox"/>
Sample pH <2.0?	<input checked="" type="checkbox"/>	<input type="checkbox"/>	<input type="checkbox"/>
Received within holding time?	<input checked="" type="checkbox"/>	<input type="checkbox"/>	<input type="checkbox"/>

•Tel. No.: (443) 681-3766 •Fax No.: (443) 681-4507

FORM REVISED 05/15  
DHMH 4540 05/17

# HOME LAND

## L A B S

9106 Philadelphia Road, Suite 106  
 Rosedale, MD 21237  
 Phone 443.505.8375  
 lab@homelandhealthyhomes.com  
 State Certified Water Quality Lab 353

108 Old Solomons Island Road, Suite I2  
 Annapolis, MD 21401  
 Phone 443.505.8375  
 lab@homelandhealthyhomes.com  
 State Certified Water Quality Lab 106

3430 Rockefeller Court  
 Waldorf, MD 20602  
 Phone 443.505.8375  
 lab@homelandhealthyhomes.com  
 State Certified Water Quality Lab 139

### Certificate of Analysis

Date Reported: 10/28/2020

Hague Quality Water  
 814 E. College Parkway  
 Annapolis, MD 21409

Date & Time Received: 10/27/2020 16:00

*This report is the sole property of Hague Quality Water. Any questions about the report MUST be directed to Hague Quality Water at (410) 757-2992.*

*Home Land Labs is not at liberty to discuss this report without written consent from Hague Quality Water.*

Sample Number: 195181-01      Sample Time: 10/27/20 13:35      Preservation: Ice  
 Location: 13488 Open Space Court      Chlorine Residual: 0.0      Sampler: BEdwards 7618BE (Exp. 5/14/2022)  
 Highland, MD 20777      Field pH: 7.5      Sample Point: Water Treatment Test Spigot

Parameter	Method	Result	Pass/Fail or Acceptable/High	RL	Units	MCL / SMCL	Date of Analysis	Analyst
Bacteria-Total Coliform	Colitag Test	Absent	Pass	1	Per/100ml	Present	10/28/2020	MAV-106
Bacteria-E.coli	Colitag Test	Absent	Pass	1	Per/100ml	Present	10/28/2020	MAV-106
Nitrate + Nitrite as N	EPA 353.2	Not Detected	Pass	0.5	mg/l	10	10/28/2020	DLB-139
Turbidity ✓	EPA 180.1	3.8	Acceptable	0.5	NTU	10	10/27/2020	MAV-106

Approved By Kevin Barnette  
 Lab Director

Chain of Custody Form  
**HOME LAND**  
**LABS**

195181
Date Due: 10/29/2
Client: Hague Quality Water
Project:

9106 Philadelphia Road, Suite 106  
 Rosedale, MD 21237  
 (443) 505-8375  
 MD Lab # 353

108 Old Solomons Island Road, Suite L2  
 Annapolis, MD 21401  
 (410) 224-4304  
 MD Lab # 106

3430 Rockefeller Court  
 Waldorf, MD 20602  
 (410) 224-4304  
 MD Lab # 139

Client Name: Hague Quality Water of MD  
 Email Address: testing@haguewaterofmd.com  
 Phone Number: 410 757 2992

Property Address:  
13488 Open Space Ct  
Highland MD 20777

**Field Collection Information**

Sampler Name: <u>Brian Edwards</u>	Field pH: <u>7.8</u>
Sampler ID #: <u>7688E</u>	Field Chlorine (mg/L): <u>0.0</u>
Date and Time Sampled: <u>10/27/20 1:35pm</u>	Sand: <u>NO</u>
Well Tag Number:	Clarity: <u>Clear</u>

**Well Casing and Cap Condition**

Height Above Grade:	Cap Type:	Casing:	Conduit:
Sample Point: <u>Water Treatment Test Spigot</u>	Water Conditioning: <u>Softener</u>		

**Requested Testing: (Please check all that apply)**

- Potability (Bacteria, Nitrates, pH, Turbidity)
- FHA/VA (Bacteria, Nitrates, Nitrites, pH, Turbidity, Lead and Iron)
- Bacteria
  - Lead
  - Nitrates
  - Iron
  - Gross Alpha
  - Saltwater Intrusion
- Arsenic
- Cadmium
- Fluoride
- Pesticides
- VOC
- Hardness
- Other: \_\_\_\_\_
- Other: \_\_\_\_\_
- Other: \_\_\_\_\_
- Other: \_\_\_\_\_
- Other: \_\_\_\_\_

List rush samples below  
 \*Refer to table for rush turnaround times and fees\*

**Release Signatures**

Released By: [Signature] Date/Time: 10/27/20 4:00pm

Released By: \_\_\_\_\_ Date/Time: \_\_\_\_\_

Released By: \_\_\_\_\_ Date/Time: \_\_\_\_\_

Received in lab by: [Signature] Date/Time: 10/27/2020 4:00pm



FL DOH Certification #E84025  
MD Laboratory Certification #283

Report Date: January 15, 2021

Hague Quality Water of Maryland  
814 E. College Pkwy.  
Annapolis, MD 21409

Field Custody: Client  
Client/Field ID: 13488 Open Space  
Highland, MD  
Sample Collection: 01-05-21/1330  
Lab ID No: 21.329  
Lab Custody Date: 01-08-21/1020  
Sample Description: Water

### CERTIFICATE OF ANALYSIS

Parameter	Results	Units	Method	Analysis Date	Detection Limit
Gross Alpha	1.3 ± 0.5	pCi/l	EPA 900.0	1-11-21/1702	1.1
Gross Beta	0.8 ± 1.1	pCi/l	EPA 900.0	1-11-21/1702	2.6
Combined Radium (Radium 226 + Radium 228)	0.8 ± 0.5	pCi/l	Calc	Calc	0.6
Radium 226	0.4 ± 0.3	pCi/l	EPA 903.0*	1-14-21/1319	0.4
Radium 228	0.4 ± 0.5	pCi/l	EPA Ra-05	1-14-21/1230	0.6

Alpha Standard: Th-230  
\* 98% carrier recovery

Thomas J. Weeks  
Laboratory Manager

Test results meet all requirements of the 2016 TNI standards. Statement of estimated uncertainty available upon request. Test results refer only to sample(s) listed.  
Contact person: Thomas Weeks (813) 229-2879.

Page 1 of 1.

3202 N. Florida Ave. Tampa, FL 33603  
 Phone: (813) 229-2879 Fax: (813) 229-0002

**CHAIN OF CUSTODY RECORD**  
 Email: jhayes@knlenvironmental.com

Company Name:		HASE WASTE OF MEYERSON		PRESERVING	
Address:		814 E. College Parkway		PRESERVING	
City/State/Zip:		Aurora, MO 64409		PRESERVING	
Phone #:		417-353-8501		PRESERVING	
Att:		TIM EDWARDS		PRESERVING	
5 day RUSH				PRESERVING	
1 - 15 - 2021				PRESERVING	
SAMPLE ID	SAMPLE DESCRIPTION/LOCATION	DATE/TIME	MATRIX*	# of containers	Analysis Requested
	13488 Open Spect.	1/5/2021			GROSS ALPHA/BETA LSIG TEST
	HIGHLAND, MO	1:30pm			RADIUM 226 + 228
21.329					
*WW - Wastewater DW - Drinking Water GW - Groundwater SW - Surface Water SL - Sludge Other:					
Special Instructions:					
Print Name/Company		Signature	Date/Time	Print Name/Company	Date/Time
TIM EDWARDS		[Signature]	1/6/2021 1:45p		
Print Name/Company		Signature	Date/Time	Print Name/Company	Date/Time
Print Name/Company		Signature	Date/Time	Print Name/Company	Date/Time



FL DOH Certification #E84025  
MD Laboratory Certification #283

Report Date: December 30, 2020

Hague Quality Water of Maryland  
814 E. College Pkwy.  
Annapolis, MD 21409

Field Custody: Client  
Client/Field ID: 13488 Open Space  
Highland, MD  
Sample Collection: 12-18-20/1500  
Lab ID No: 20.17003  
Lab Custody Date: 12-22-20/1037  
Sample description: Water

### CERTIFICATE OF ANALYSIS

Parameter	Results	Units	Method	Analysis Date	Detection Limit
Gross Alpha	4.4 ± 0.8	pCi/l	EPA 900.0	12-29-20/2358	0.9
Gross Beta	19.5 ± 1.7	pCi/l	EPA 900.0	12-29-20/2358	2.1
Combined Radium (Radium 226 + Radium 228)	13.9 ± 1.0	pCi/l	Calc	Calc	0.7
Radium 226	3.6 ± 0.4	pCi/l	EPA 903.0*	12-28-20/1317	0.2
Radium 228	10.3 ± 1.0	pCi/l	EPA Ra-05	12-30-20/1209	0.7

Alpha Standard: Th-230  
\* 106% carrier recovery

Thomas J. Weeks  
Laboratory Manager

Test results meet all requirements of the 2016 TNI standards. Statement of estimated uncertainty available upon request. Test results refer only to sample(s) listed.  
Contact person: Thomas Weeks (813) 229-2879.

Page 1 of 1

**Oswald, Hank**

---

**From:** Williams, Jeffrey  
**Sent:** Tuesday, July 30, 2019 12:40 PM  
**To:** 'gphillips@mred.us'  
**Cc:** Wolf, Kevin; Cabahug, Joseph; Oswald, Hank; Najib Roshan  
**Subject:** RE: Well Permit Application\_Open Space Court Lot 15

I don't see where we told you to switch from a well box to 3 well sites. Hank made comments on 7/8 to show the well box at 1500 square feet and the next submittal on 7/11 was with 3 well sites. Regardless, that is not directly related to the well permit that was already released as of 7/9 with a well box staked in the field.

It's up to you if you want a well box or 3 well sites. Either way, you and the surveyor/engineer need to follow the required process. This whole thing would not be so twisted if we were just working out the perc cert for approval before releasing the well permit, which is our standard process for good reason.

I've reviewed the perc cert and have no additional comments other than what Hank had on 7/22. If you want to stay with the 3 well sites, you will need to submit 2 copies of a well exhibit meeting the requirements in the memo I provided. Then, we will conduct a site visit to confirm the stakes, then if all looks good, we will call Mayne to let him loose.

---

**From:** gphillips@mred.us <gphillips@mred.us>  
**Sent:** Tuesday, July 30, 2019 9:38 AM  
**To:** Williams, Jeffrey <jewilliams@howardcountymd.gov>  
**Cc:** Wolf, Kevin <KWolf@howardcountymd.gov>; Cabahug, Joseph <jcabahug@howardcountymd.gov>; Oswald, Hank <hoswald@howardcountymd.gov>; Najib Roshan <roshannj@aol.com>  
**Subject:** Re: Well Permit Application\_Open Space Court Lot 15

[Note: This email originated from outside of the organization. Please only click on links or attachments if you know the sender.]

Jeff,

You keep saying that the surveyor just moved these on his own which is just not true.

You have two full sized plans based on the July 22, 2019, review comments that I dropped off yesterday. In that review it stated to go to three well sites and not use the well box because again, we were never told that we could have a well box less than 1,500 s.f.

Either approve what I dropped off yesterday or put in writing that we can go with less than 1,500 s.f. and I will drop a revised version.

At this point we just want to drill the well and close the sale between the parties.

Your call.

Gregory Phillips  
Maryland Real Estate Development

6100 Day Long Lane  
Suite 100  
Clarksville, Maryland 21029

Direct 410.977.0864  
[gphillips@MRED.US](mailto:gphillips@MRED.US)



On Jul 30, 2019, at 9:31 AM, Williams, Jeffrey <[jewilliams@howardcountymd.gov](mailto:jewilliams@howardcountymd.gov)> wrote:

Greg, the perc cert review is not the same as the well permit in process with a driller. The engineer/surveyor cannot just move approved staked locations in the field without going through the proper submittals and approvals or even telling us. The driller has an approved well location from us with the permit and we would expect them to not drill if they arrive onsite to see stakes different from the approved exhibit they received from us. Luckily Mayne is not ready to drill there yet anyway.

This whole process was further confused by my agreement to allow the drilling to proceed while we work through perc cert approval because it was a previously approved lot of record and your appeals for expediency because of a property sale. I assure you that bending of the process will not happen again.

The well exhibit you attached is not in the proper format and is not to scale. See the attached memo describing the acceptable format for well exhibits. We need 2 paper copies submitted to us to proceed. I will also review the perc cert and let you know if there are any comments for revision.

Jeff

---

**From:** [gphillips@mred.us](mailto:gphillips@mred.us) <[gphillips@mred.us](mailto:gphillips@mred.us)>  
**Sent:** Monday, July 29, 2019 3:02 PM  
**To:** Williams, Jeffrey <[jewilliams@howardcountymd.gov](mailto:jewilliams@howardcountymd.gov)>  
**Subject:** Re: Well Permit Application\_Open Space Court Lot 15

[Note: This email originated from outside of the organization. Please only click on links or attachments if you know the sender.]

Jeff,

This makes no sense and I take exception to you calling off my well driller today as you were informed and commented on the change in a July 22, 2019, memo.

The first well is in the exact same location as it was when it was part of the well box. We submitted a revised plan with well sites per the July 22, 2019, comments as the well site method was more compliant with the well box method. We were never told that the well box could be 1,300 s.f. Just so you are aware I dropped off the paper copies of that plan today based on the July 22, 2019, comments as I had my PET scan testing last week and there was no change to the first well drill location.

This is a lot by record plat which your department could not provide the perc data and we have been working with you in good faith since March. I have perc'd it twice and we have submitted 4 paper copies sets over that same time.

I am at my engineers office and will drop off the originals of the attached shortly.

Regards,

Gregory Phillips  
Maryland Real Estate Development  
6100 Day Long Lane  
Suite 100  
Clarksville, Maryland 21029

Direct 410.977.0864  
[gphillips@MRED.US](mailto:gphillips@MRED.US)

<image001.png>

On Jul 29, 2019, at 9:27 AM, Williams, Jeffrey <[jewilliams@howardcountymd.gov](mailto:jewilliams@howardcountymd.gov)> wrote:

Please submit a well staked form to that effect and two copies of a well exhibit with the well locations shown as they are currently staked. We will then review the locations to see if we can approve the driller to proceed.

---

**From:** [roshannj@aol.com](mailto:roshannj@aol.com) <[roshannj@aol.com](mailto:roshannj@aol.com)>

**Sent:** Friday, July 26, 2019 4:12 PM

**To:** Williams, Jeffrey <[jewilliams@howardcountymd.gov](mailto:jewilliams@howardcountymd.gov)>; [gphillips@mred.us](mailto:gphillips@mred.us)

**Cc:** Cabahug, Joseph <[jcabahug@howardcountymd.gov](mailto:jcabahug@howardcountymd.gov)>; Wolf, Kevin <[KWolf@howardcountymd.gov](mailto:KWolf@howardcountymd.gov)>; Oswald, Hank <[hoswald@howardcountymd.gov](mailto:hoswald@howardcountymd.gov)>

**Subject:** Re: Well Permit Application\_Open Space Court Lot 15

[Note: This email originated from outside of the organization. Please only click on links or attachments if you know the sender.]

Good afternoon,

We staked the three well locations the same day as I forwarded the attached revised plan to Mr. Oswald on July 23rd.

Thank you  
Najib Roshan, LS  
NJR & Associates, LLC  
2770 Route 32  
West Friendship, MD 21794  
PH (240) 508-3200  
[roshannj@aol.com](mailto:roshannj@aol.com)

-----Original Message-----

From: Williams, Jeffrey <[jewilliams@howardcountymd.gov](mailto:jewilliams@howardcountymd.gov)>

To: 'MRED' <[gphillips@mred.us](mailto:gphillips@mred.us)>

Cc: Cabahug, Joseph <jcabahug@howardcountymd.gov>; Wolf, Kevin <KWolf@howardcountymd.gov>; Oswald, Hank <hoswald@howardcountymd.gov>; Najib Roshan <roshannj@aol.com>

Sent: Fri, Jul 26, 2019 3:45 pm

Subject: RE: Well Permit Application\_Open Space Court Lot 15

Thank you. While you previously said that Mayne was drilling the well, you never addressed the issue of the allied permit at all when we questioned it. Based on what you said now, we will inform Allied that per the property owner, their permit application is not authorized and we will discard it.

As to the box changing to 3 well sites, we were not informed that the area was re-staked, so I was working on the understanding that the box was still what was staked in the field. The box is what I looked at and gave the green light to release the well permit.

A surveyor cannot just change field stakes for a driller without letting us know and certainly not after a well permit has already been released to the driller for a different approved well area. This is all further muddied because I gave a concession of allowing the well to proceed before signing the perc cert. We have to know where the driller is going to drill and the driller has to know that the staked area matches the approved well exhibit we gave them with the permit.

At this point, we are going to tell Mayne not to drill until we receive a revised staked form from the surveyor stating when they re-staked the lot and 2 copies of a revised well exhibit showing the new area. I will also have to review the new proposed well sites to see if we can approve them. Finally, we will have to conduct a site visit to confirm the new staked areas and if we can approve all of that, we will then tell Mayne that he is free to drill.

---

**From:** MRED <gphillips@mred.us>

**Sent:** Friday, July 26, 2019 3:26 PM

**To:** Williams, Jeffrey <jewilliams@howardcountymd.gov>

**Cc:** Cabahug, Joseph <jcabahug@howardcountymd.gov>; Wolf, Kevin <KWolf@howardcountymd.gov>; Oswald, Hank <hoswald@howardcountymd.gov>; Najib Roshan <roshannj@aol.com>

**Subject:** Re: Well Permit Application\_Open Space Court Lot 15

[Note: This email originated from outside of the organization. Please only click on links or attachments if you know the sender.]

Jeff,

I have made it clear that Mayne is drilling the well with both your staff and Andy from Allied since you had the Mayne application in hand and that was the fastest permit to achieve.

As far as the well box vs the three sites goes we were never told that we could make the well box less than 1,500 s.f. thus NJ went the three well site route. Those three well sites are staked out in the filed as the primary location and replacement 1 & 2. If you prefer a well box that is less than 1,500 s.f. we can provide that as well.

I am not sure why you are upset with me as we were told that the Mayne permit was issued on the 9th but Betty did not receive it until the 23rd and all I was attempting to do was find the permit as it was not clear whether it was actually mailed or was waiting upfront for Joe to pick up.

Please advise.

Gregory Phillips  
Maryland Real Estate Development  
6100 Day Long Lane  
Suite 100  
Clarksville, Maryland 21029

Direct 410.977.0864  
[gphillips@MRED.US](mailto:gphillips@MRED.US)

<image001.png>

On Jul 26, 2019, at 9:04 AM, Williams, Jeffrey <[jewilliams@howardcountymd.gov](mailto:jewilliams@howardcountymd.gov)> wrote:

Greg, 2 things:

1. We have two well permit applications for this property. We issued a permit to Joe Mayne. We have Allied telling us as recently as Wednesday that they are drilling this well. You state in your email that Joe is drilling the well, but you have offered no explanation as to why we have an application from Allied or why they continue to this day to believe that they are the ones drilling it. Please advise.
2. As we discussed in the beginning, the original approved plan for this property from years ago had one approved well site. We made a concession to you to allow you to stake out the proposed well box to start drilling while we work through the perc cert approval. I even let it go with the staked box being less than 1500 square feet with the idea that you could get the box larger for the perc cert and not affect the staked area. We now have a perc cert proposal that changes the well box to three discrete well locations. That is not what is staked in the field and that is not what Mayne (or Allied?) will be drilling. I'm inclined to call Mayne and tell them that the permit is on hold and do not drill until we get a signed perc cert plan so we all know exactly what well areas are requested and approved. Please advise

Jeff

---

**From:** MRED <[gphillips@mred.us](mailto:gphillips@mred.us)>  
**Sent:** Thursday, July 25, 2019 6:16 PM  
**To:** Cabahug, Joseph <[jcabahug@howardcountymd.gov](mailto:jcabahug@howardcountymd.gov)>  
**Cc:** Wolf, Kevin <[KWolf@howardcountymd.gov](mailto:KWolf@howardcountymd.gov)>; Williams, Jeffrey <[jewilliams@howardcountymd.gov](mailto:jewilliams@howardcountymd.gov)>  
**Subject:** Re: Well Permit Application\_Open Space Court Lot 15

[Note: This email originated from outside of the organization. Please only click on links or attachments if you know the sender.]

Joe,

Per my email of the 22nd Mayne is drilling the well at Open Space. I am not sure why you had a conversation in the filed with Mayne today otherwise.

Please confirm that you are in receipt of this email as we have now lost another day in getting this well drilled.

Regards,

Gregory Phillips  
Maryland Real Estate Development  
6100 Day Long Lane  
Suite 100  
Clarksville, Maryland 21029

Direct 410.977.0864  
[gphillips@MRED.US](mailto:gphillips@MRED.US)

<image001.png>

On Jul 22, 2019, at 12:29 PM, MRED <[gphillips@mred.us](mailto:gphillips@mred.us)> wrote:

Gentlemen,

Joe Mayne is fine to be the well driller for this site. However, no permit has been received by Betty Mayne.

Do you have it in hand or did it get mailed out? I would like to get this drilled this week.

Regards,

Gregory Phillips  
Maryland Real Estate Development  
6100 Day Long Lane  
Suite 100  
Clarksville, Maryland 21029

Direct 410.977.0864  
[gphillips@MRED.US](mailto:gphillips@MRED.US)

<PastedGraphic-3.png>

On Jul 22, 2019, at 9:39 AM, Wolf, Kevin  
<[KWolf@howardcountymd.gov](mailto:KWolf@howardcountymd.gov)> wrote:

Andy,

This permit was issued to Joe Mayne on 7/9/19. They will need to supply us with something in writing stating the transfer of the permit to Allied. You will also need to provide us with something in writing (email will suffice) stating that Allied is accepting the transfer of the permit. Once we (the approving authority) receive notices from both parties, approval from us will be given so you may commence well construction activities.

Kevin

---

**From:** Andy Capelle <[acapelle@alliedwells.com](mailto:acapelle@alliedwells.com)>  
**Sent:** Monday, July 22, 2019 9:03 AM  
**To:** Wolf, Kevin <[KWolf@howardcountymd.gov](mailto:KWolf@howardcountymd.gov)>  
**Subject:** Re: FW: Well Permit Application\_Open Space Court Lot 15

[Note: This email originated from outside of the organization. Please only click on links or attachments if you know the sender.]

Yes we are drilling the job now. Call me if yiu have any questions.

On Fri, Jul 19, 2019 at 3:38 PM Wolf, Kevin  
<[KWolf@howardcountymd.gov](mailto:KWolf@howardcountymd.gov)> wrote:

Andy,  
See below.

**From:** Oswald, Hank  
**Sent:** Friday, July 12, 2019 4:39 PM  
**To:** 'gphillips@mred.us' <gphillips@mred.us>  
**Cc:** Williams, Jeffrey <jewilliams@howardcountymd.gov>; Wolf, Kevin <KWolf@howardcountymd.gov>; Cabahug, Joseph <jcabahug@howardcountymd.gov>  
**Subject:** Well Permit Application\_Open Space Court Lot 15

Hi Greg:

Good afternoon. Our office is in receipt of a second well permit application from Allied Well Drilling for Open Space Court, Lot 15. Can you provide this office with an update? Did the owner change drillers because our office already issued the permit to Larry Mayne.

Thanks,

Hank

Hank Oswald  
Licensed Environmental Health Specialist  
Howard County Health Department  
Bureau of Environmental Health  
Well & Septic Program  
8930 Stanford Boulevard  
Columbia, MD 21045  
410.313.1786 (Office)  
[hoswald@howardcountymd.gov](mailto:hoswald@howardcountymd.gov)

**CONFIDENTIALITY NOTICE**

This message and the accompanying documents are intended only for the use of the individual or entity to which they are addressed and may contain information that is privileged, confidential, or exempt from disclosure under applicable law. If the reader of this email is not the intended recipient, you are hereby notified that you are strictly prohibited from reading, disseminating, distributing, or copying this communication. If you have received this email in error, please notify the sender immediately and destroy the original transmission.

--

**Andy Capelle**  
Vice President

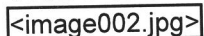

P.O. Box 129  
Annapolis Junction, MD 20701  
410-371-2219 cell  
301-776-8370 office  
301-776-8374 fax  
[alliedwells.com](http://alliedwells.com)

<Well site plan memo.pdf>

## Williams, Jeffrey

---

**From:** Williams, Jeffrey  
**Sent:** Tuesday, July 30, 2019 12:40 PM  
**To:** 'gphillips@mred.us'  
**Cc:** Wolf, Kevin; Cabahug, Joseph; Oswald, Hank; Najib Roshan  
**Subject:** RE: Well Permit Application\_Open Space Court Lot 15

I don't see where we told you to switch from a well box to 3 well sites. Hank made comments on 7/8 to show the well box at 1500 square feet and the next submittal on 7/11 was with 3 well sites. Regardless, that is not directly related to the well permit that was already released as of 7/9 with a well box staked in the field.

It's up to you if you want a well box or 3 well sites. Either way, you and the surveyor/engineer need to follow the required process. This whole thing would not be so twisted if we were just working out the perc cert for approval before releasing the well permit, which is our standard process for good reason.

I've reviewed the perc cert and have no additional comments other than what Hank had on 7/22. If you want to stay with the 3 well sites, you will need to submit 2 copies of a well exhibit meeting the requirements in the memo I provided. Then, we will conduct a site visit to confirm the stakes, then if all looks good, we will call Mayne to let him loose.

---

**From:** gphillips@mred.us <gphillips@mred.us>  
**Sent:** Tuesday, July 30, 2019 9:38 AM  
**To:** Williams, Jeffrey <jewilliams@howardcountymd.gov>  
**Cc:** Wolf, Kevin <KWolf@howardcountymd.gov>; Cabahug, Joseph <jcabahug@howardcountymd.gov>; Oswald, Hank <hoswald@howardcountymd.gov>; Najib Roshan <roshannj@aol.com>  
**Subject:** Re: Well Permit Application\_Open Space Court Lot 15

[Note: This email originated from outside of the organization. Please only click on links or attachments if you know the sender.]

Jeff,

You keep saying that the surveyor just moved these on his own which is just not true.

You have two full sized plans based on the July 22, 2019, review comments that I dropped off yesterday. In that review it stated to go to three well sites and not use the well box because again, we were never told that we could have a well box less than 1,500 s.f.

Either approve what I dropped off yesterday or put in writing that we can go with less than 1,500 s.f. and I will drop a revised version.

At this point we just want to drill the well and close the sale between the parties.

Your call.

Gregory Phillips  
Maryland Real Estate Development

6100 Day Long Lane  
Suite 100  
Clarksville, Maryland 21029

Direct 410.977.0864  
[gphillips@MRED.US](mailto:gphillips@MRED.US)



On Jul 30, 2019, at 9:31 AM, Williams, Jeffrey <[jewilliams@howardcountymd.gov](mailto:jewilliams@howardcountymd.gov)> wrote:

Greg, the perc cert review is not the same as the well permit in process with a driller. The engineer/surveyor cannot just move approved staked locations in the field without going through the proper submittals and approvals or even telling us. The driller has an approved well location from us with the permit and we would expect them to not drill if they arrive onsite to see stakes different from the approved exhibit they received from us. Luckily Mayne is not ready to drill there yet anyway.

This whole process was further confused by my agreement to allow the drilling to proceed while we work through perc cert approval because it was a previously approved lot of record and your appeals for expediency because of a property sale. I assure you that bending of the process will not happen again.

The well exhibit you attached is not in the proper format and is not to scale. See the attached memo describing the acceptable format for well exhibits. We need 2 paper copies submitted to us to proceed. I will also review the perc cert and let you know if there are any comments for revision.  
Jeff

---

**From:** [gphillips@mred.us](mailto:gphillips@mred.us) <[gphillips@mred.us](mailto:gphillips@mred.us)>  
**Sent:** Monday, July 29, 2019 3:02 PM  
**To:** Williams, Jeffrey <[jewilliams@howardcountymd.gov](mailto:jewilliams@howardcountymd.gov)>  
**Subject:** Re: Well Permit Application\_Open Space Court Lot 15

[Note: This email originated from outside of the organization. Please only click on links or attachments if you know the sender.]

Jeff,

This makes no sense and I take exception to you calling off my well driller today as you were informed and commented on the change in a July 22, 2019, memo.

The first well is in the exact same location as it was when it was part of the well box. We submitted a revised plan with well sites per the July 22, 2019, comments as the well site method was more compliant with the well box method. We were never told that the well box could be 1,300 s.f. Just so you are aware I dropped off the paper copies of that plan today based on the July 22, 2019, comments as I had my PET scan testing last week and there was no change to the first well drill location.

This is a lot by record plat which your department could not provide the perc data and we have been working with you in good faith since March. I have perc'd it twice and we have submitted 4 paper copies sets over that same time.

I am at my engineers office and will drop off the originals of the attached shortly.

Regards,

Gregory Phillips  
Maryland Real Estate Development  
6100 Day Long Lane  
Suite 100  
Clarksville, Maryland 21029

Direct 410.977.0864  
[gphillips@MRED.US](mailto:gphillips@MRED.US)

<image001.png>

On Jul 29, 2019, at 9:27 AM, Williams, Jeffrey <[jewilliams@howardcountymd.gov](mailto:jewilliams@howardcountymd.gov)> wrote:

Please submit a well staked form to that effect and two copies of a well exhibit with the well locations shown as they are currently staked. We will then review the locations to see if we can approve the driller to proceed.

---

**From:** [roshannj@aol.com](mailto:roshannj@aol.com) <[roshannj@aol.com](mailto:roshannj@aol.com)>

**Sent:** Friday, July 26, 2019 4:12 PM

**To:** Williams, Jeffrey <[jewilliams@howardcountymd.gov](mailto:jewilliams@howardcountymd.gov)>; [gphillips@mred.us](mailto:gphillips@mred.us)

**Cc:** Cabahug, Joseph <[jcabahug@howardcountymd.gov](mailto:jcabahug@howardcountymd.gov)>; Wolf, Kevin <[KWolf@howardcountymd.gov](mailto:KWolf@howardcountymd.gov)>; Oswald, Hank <[hoswald@howardcountymd.gov](mailto:hoswald@howardcountymd.gov)>

**Subject:** Re: Well Permit Application\_Open Space Court Lot 15

[Note: This email originated from outside of the organization. Please only click on links or attachments if you know the sender.]

Good afternoon,

We staked the three well locations the same day as I forwarded the attached revised plan to Mr. Oswald on July 23rd.

Thank you  
Najib Roshan, LS  
NJR & Associates, LLC  
2770 Route 32  
West Friendship, MD 21794  
PH (240) 508-3200  
[roshannj@aol.com](mailto:roshannj@aol.com)

-----Original Message-----

From: Williams, Jeffrey <[jewilliams@howardcountymd.gov](mailto:jewilliams@howardcountymd.gov)>  
To: 'MRED' <[gphillips@mred.us](mailto:gphillips@mred.us)>

Cc: Cabahug, Joseph <[jcabahug@howardcountymd.gov](mailto:jcabahug@howardcountymd.gov)>; Wolf, Kevin <[KWolf@howardcountymd.gov](mailto:KWolf@howardcountymd.gov)>; Oswald, Hank <[hoswald@howardcountymd.gov](mailto:hoswald@howardcountymd.gov)>; Najib Roshan <[roshannj@aol.com](mailto:roshannj@aol.com)>  
Sent: Fri, Jul 26, 2019 3:45 pm  
Subject: RE: Well Permit Application\_Open Space Court Lot 15

Thank you. While you previously said that Mayne was drilling the well, you never addressed the issue of the allied permit at all when we questioned it. Based on what you said now, we will inform Allied that per the property owner, their permit application is not authorized and we will discard it.

As to the box changing to 3 well sites, we were not informed that the area was re-staked, so I was working on the understanding that the box was still what was staked in the field. The box is what I looked at and gave the green light to release the well permit.

A surveyor cannot just change field stakes for a driller without letting us know and certainly not after a well permit has already been released to the driller for a different approved well area. This is all further muddied because I gave a concession of allowing the well to proceed before signing the perc cert. We have to know where the driller is going to drill and the driller has to know that the staked area matches the approved well exhibit we gave them with the permit.

At this point, we are going to tell Mayne not to drill until we receive a revised staked form from the surveyor stating when they re-staked the lot and 2 copies of a revised well exhibit showing the new area. I will also have to review the new proposed well sites to see if we can approve them. Finally, we will have to conduct a site visit to confirm the new staked areas and if we can approve all of that, we will then tell Mayne that he is free to drill.

---

**From:** MRED <[gphillips@mred.us](mailto:gphillips@mred.us)>  
**Sent:** Friday, July 26, 2019 3:26 PM  
**To:** Williams, Jeffrey <[jewilliams@howardcountymd.gov](mailto:jewilliams@howardcountymd.gov)>  
**Cc:** Cabahug, Joseph <[jcabahug@howardcountymd.gov](mailto:jcabahug@howardcountymd.gov)>; Wolf, Kevin <[KWolf@howardcountymd.gov](mailto:KWolf@howardcountymd.gov)>; Oswald, Hank <[hoswald@howardcountymd.gov](mailto:hoswald@howardcountymd.gov)>; Najib Roshan <[roshannj@aol.com](mailto:roshannj@aol.com)>  
**Subject:** Re: Well Permit Application\_Open Space Court Lot 15

[Note: This email originated from outside of the organization. Please only click on links or attachments if you know the sender.]

Jeff,

I have made it clear that Mayne is drilling the well with both your staff and Andy from Allied since you had the Mayne application in hand and that was the fastest permit to achieve.

As far as the well box vs the three sites goes we were never told that we could make the well box less than 1,500 s.f. thus NJ went the three well site route. Those three well sites are staked out in the filed as the primary location and replacement 1 & 2. If you prefer a well box that is less than 1,500 s.f. we can provide that as well.

I am not sure why you are upset with me as we were told that the Mayne permit was issued on the 9th but Betty did not receive it until the 23rd and all I was attempting to do was find the permit as it was not clear wether it was actually mailed or was waiting upfront for Joe to pick up.

Please advise.

Gregory Phillips  
Maryland Real Estate Development  
6100 Day Long Lane  
Suite 100  
Clarksville, Maryland 21029

Direct 410.977.0864  
[gphillips@MRED.US](mailto:gphillips@MRED.US)

<image001.png>

On Jul 26, 2019, at 9:04 AM, Williams, Jeffrey <[jewilliams@howardcountymd.gov](mailto:jewilliams@howardcountymd.gov)> wrote:

Greg, 2 things:

1. We have two well permit applications for this property. We issued a permit to Joe Mayne. We have Allied telling us as recently as Wednesday that they are drilling this well. You state in your email that Joe is drilling the well, but you have offered no explanation as to why we have an application from Allied or why they continue to this day to believe that they are the ones drilling it. Please advise.
2. As we discussed in the beginning, the original approved plan for this property from years ago had one approved well site. We made a concession to you to allow you to stake out the proposed well box to start drilling while we work through the perc cert approval. I even let it go with the staked box being less than 1500 square feet with the idea that you could get the box larger for the perc cert and not affect the staked area. We now have a perc cert proposal that changes the well box to three discrete well locations. That is not what is staked in the field and that is not what Mayne (or Allied?) will be drilling. I'm inclined to call Mayne and tell them that the permit is on hold and do not drill until we get a signed perc cert plan so we all know exactly what well areas are requested and approved. Please advise

Jeff

---

**From:** MRED <[gphillips@mred.us](mailto:gphillips@mred.us)>  
**Sent:** Thursday, July 25, 2019 6:16 PM  
**To:** Cabahug, Joseph <[jcabahug@howardcountymd.gov](mailto:jcabahug@howardcountymd.gov)>  
**Cc:** Wolf, Kevin <[KWolf@howardcountymd.gov](mailto:KWolf@howardcountymd.gov)>; Williams, Jeffrey <[jewilliams@howardcountymd.gov](mailto:jewilliams@howardcountymd.gov)>  
**Subject:** Re: Well Permit Application\_Open Space Court Lot 15

[Note: This email originated from outside of the organization. Please only click on links or attachments if you know the sender.]

Joe,

Per my email of the 22nd Mayne is drilling the well at Open Space. I am not sure why you had a conversation in the filed with Mayne today otherwise.

Please confirm that you are in receipt of this email as we have now lost another day in getting this well drilled.

Regards,

Gregory Phillips  
Maryland Real Estate Development  
6100 Day Long Lane  
Suite 100  
Clarksville, Maryland 21029

Direct 410.977.0864  
[gphillips@MRED.US](mailto:gphillips@MRED.US)

<image001.png>

**From:** Oswald, Hank  
**Sent:** Friday, July 12, 2019 4:39 PM  
**To:** 'gphillips@mred.us' <gphillips@mred.us>  
**Cc:** Williams, Jeffrey <jewilliams@howardcountymd.gov>; Wolf, Kevin <KWolf@howardcountymd.gov>; Cabahug, Joseph <jcabahug@howardcountymd.gov>  
**Subject:** Well Permit Application\_Open Space Court Lot 15

Hi Greg:

Good afternoon. Our office is in receipt of a second well permit application from Allied Well Drilling for Open Space Court, Lot 15. Can you provide this office with an update? Did the owner change drillers because our office already issued the permit to Larry Mayne.

Thanks,

Hank

Hank Oswald  
Licensed Environmental Health Specialist  
Howard County Health Department  
Bureau of Environmental Health  
Well & Septic Program  
8930 Stanford Boulevard  
Columbia, MD 21045  
410.313.1786 (Office)  
[hoswald@howardcountymd.gov](mailto:hoswald@howardcountymd.gov)

**CONFIDENTIALITY NOTICE**

This message and the accompanying documents are intended only for the use of the individual or entity to which they are addressed and may contain information that is privileged, confidential, or exempt from disclosure under applicable law. If the reader of this email is not the intended recipient, you are hereby notified that you are strictly prohibited from reading, disseminating, distributing, or copying this communication. If you have received this email in error, please notify the sender immediately and destroy the original transmission.

--

**Andy Capelle**  
Vice President



P.O. Box 129  
Annapolis Junction, MD 20701  
410-371-2219 cell  
301-776-8370 office  
301-776-8374 fax  
[alliedwells.com](http://alliedwells.com)

<Well site plan memo.pdf>

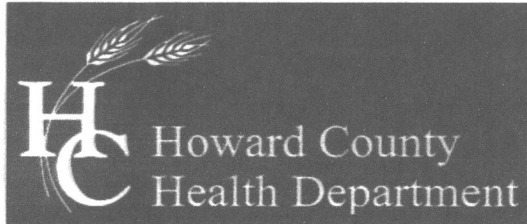

Bureau of Environmental Health

8930 Stanford Boulevard, Columbia, MD 21045

Main: 410-313-2640 | Fax: 410-313-2648

TDD 410-313-2323 | Toll Free 1-866-313-6300

www.hchealth.org

Facebook: www.facebook.com/hocohealth

Twitter: HowardCoHealthDep

Dr. Maura J. Rossman, M.D., Health Officer

TO ALL INTERESTED PARTIES

When submitting a well permit application for a proposed well for new construction, please indicate one of the following:

Well Site Location:

Allnut Farm Estates SECTION - S 15 Open Space Court
Subdivision/Property Name Lot # Road Name

The well site has been staked by NJR & Assoc. LLC on 07/23/2019 (date) and does not require a site inspection.

The well driller, builder or property owner will call the Health Department to schedule a time to meet in the field to verify the proposed well site location.

This sheet, along with two copies of an acceptable well site plan, must be attached to the green well permit application.

Handwritten signature and date 07/29/2019

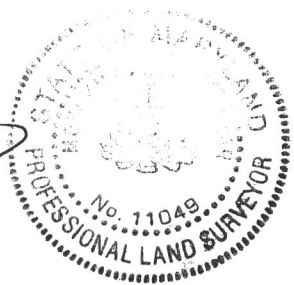

## Oswald, Hank

---

**From:** Williams, Jeffrey  
**Sent:** Friday, July 26, 2019 9:04 AM  
**To:** 'MRED'; Cabahug, Joseph  
**Cc:** Wolf, Kevin; Oswald, Hank  
**Subject:** RE: Well Permit Application\_Open Space Court Lot 15

Greg, 2 things:

1. We have two well permit applications for this property. We issued a permit to Joe Mayne. We have Allied telling us as recently as Wednesday that they are drilling this well. You state in your email that Joe is drilling the well, but you have offered no explanation as to why we have an application from Allied or why they continue to this day to believe that they are the ones drilling it. Please advise.
2. As we discussed in the beginning, the original approved plan for this property from years ago had one approved well site. We made a concession to you to allow you to stake out the proposed well box to start drilling while we work through the perc cert approval. I even let it go with the staked box being less than 1500 square feet with the idea that you could get the box larger for the perc cert and not affect the staked area. We now have a perc cert proposal that changes the well box to three discrete well locations. That is not what is staked in the field and that is not what Mayne (or Allied?) will be drilling. I'm inclined to call Mayne and tell them that the permit is on hold and do not drill until we get a signed perc cert plan so we all know exactly what well areas are requested and approved. Please advise

Jeff

---

**From:** MRED <gphillips@mred.us>  
**Sent:** Thursday, July 25, 2019 6:16 PM  
**To:** Cabahug, Joseph <jcabahug@howardcountymd.gov>  
**Cc:** Wolf, Kevin <KWolf@howardcountymd.gov>; Williams, Jeffrey <jewilliams@howardcountymd.gov>  
**Subject:** Re: Well Permit Application\_Open Space Court Lot 15

[Note: This email originated from outside of the organization. Please only click on links or attachments if you know the sender.]

Joe,

Per my email of the 22nd Mayne is drilling the well at Open Space. I am not sure why you had a conversation in the filed with Mayne today otherwise.

Please confirm that you are in receipt of this email as we have now lost another day in getting this well drilled.

Regards,

Gregory Phillips  
Maryland Real Estate Development  
6100 Day Long Lane  
Suite 100  
Clarksville, Maryland 21029

Direct 410.977.0864  
[gphillips@MRED.US](mailto:gphillips@MRED.US)



On Jul 22, 2019, at 12:29 PM, MRED <[gphillips@mred.us](mailto:gphillips@mred.us)> wrote:

Gentlemen,

Joe Mayne is fine to be the well driller for this site. However, no permit has been received by Betty Mayne.

Do you have it in hand or did it get mailed out? I would like to get this drilled this week.

Regards,

Gregory Phillips  
Maryland Real Estate Development  
6100 Day Long Lane  
Suite 100  
Clarksville, Maryland 21029

Direct 410.977.0864  
[gphillips@MRED.US](mailto:gphillips@MRED.US)

<PastedGraphic-3.png>

On Jul 22, 2019, at 9:39 AM, Wolf, Kevin <[KWolf@howardcountymd.gov](mailto:KWolf@howardcountymd.gov)> wrote:

Andy,

This permit was issued to Joe Mayne on 7/9/19. They will need to supply us with something in writing stating the transfer of the permit to Allied. You will also need to provide us with something in writing (email will suffice) stating that Allied is accepting the transfer of the permit. Once we (the approving authority) receive notices from both parties, approval from us will be given so you may commence well construction activities.

Kevin

---

**From:** Andy Capelle <[acapelle@alliedwells.com](mailto:acapelle@alliedwells.com)>

**Sent:** Monday, July 22, 2019 9:03 AM

## Oswald, Hank

---

**From:** Williams, Jeffrey  
**Sent:** Friday, July 26, 2019 9:04 AM  
**To:** 'MRED'; Cabahug, Joseph  
**Cc:** Wolf, Kevin; Oswald, Hank  
**Subject:** RE: Well Permit Application\_Open Space Court Lot 15

Greg, 2 things:

1. We have two well permit applications for this property. We issued a permit to Joe Mayne. We have Allied telling us as recently as Wednesday that they are drilling this well. You state in your email that Joe is drilling the well, but you have offered no explanation as to why we have an application from Allied or why they continue to this day to believe that they are the ones drilling it. Please advise.
2. As we discussed in the beginning, the original approved plan for this property from years ago had one approved well site. We made a concession to you to allow you to stake out the proposed well box to start drilling while we work through the perc cert approval. I even let it go with the staked box being less than 1500 square feet with the idea that you could get the box larger for the perc cert and not affect the staked area. We now have a perc cert proposal that changes the well box to three discrete well locations. That is not what is staked in the field and that is not what Mayne (or Allied?) will be drilling. I'm inclined to call Mayne and tell them that the permit is on hold and do not drill until we get a signed perc cert plan so we all know exactly what well areas are requested and approved. Please advise

Jeff

---

**From:** MRED <gphillips@mred.us>  
**Sent:** Thursday, July 25, 2019 6:16 PM  
**To:** Cabahug, Joseph <jcabahug@howardcountymd.gov>  
**Cc:** Wolf, Kevin <KWolf@howardcountymd.gov>; Williams, Jeffrey <jewilliams@howardcountymd.gov>  
**Subject:** Re: Well Permit Application\_Open Space Court Lot 15

[Note: This email originated from outside of the organization. Please only click on links or attachments if you know the sender.]

Joe,

Per my email of the 22nd Mayne is drilling the well at Open Space. I am not sure why you had a conversation in the filed with Mayne today otherwise.

Please confirm that you are in receipt of this email as we have now lost another day in getting this well drilled.

Regards,

Gregory Phillips  
Maryland Real Estate Development  
6100 Day Long Lane  
Suite 100  
Clarksville, Maryland 21029

**To:** Wolf, Kevin <[KWolf@howardcountymd.gov](mailto:KWolf@howardcountymd.gov)>

**Subject:** Re: FW: Well Permit Application\_Open Space Court Lot 15

[Note: This email originated from outside of the organization. Please only click on links or attachments if you know the sender.]

Yes we are drilling the job now. Call me if yiu have any questions.

On Fri, Jul 19, 2019 at 3:38 PM Wolf, Kevin <[KWolf@howardcountymd.gov](mailto:KWolf@howardcountymd.gov)> wrote:

Andy,  
See below.

---

**From:** Oswald, Hank

**Sent:** Friday, July 12, 2019 4:39 PM

**To:** 'gphillips@mred.us' <[gphillips@mred.us](mailto:gphillips@mred.us)>

**Cc:** Williams, Jeffrey <[jewilliams@howardcountymd.gov](mailto:jewilliams@howardcountymd.gov)>; Wolf, Kevin

<[KWolf@howardcountymd.gov](mailto:KWolf@howardcountymd.gov)>; Cabahug, Joseph <[jcabahug@howardcountymd.gov](mailto:jcabahug@howardcountymd.gov)>

**Subject:** Well Permit Application\_Open Space Court Lot 15

Hi Greg:

Good afternoon. Our office is in receipt of a second well permit application from Allied Well Drilling for Open Space Court, Lot 15. Can you provide this office with an update? Did the owner change drillers because our office already issued the permit to Larry Mayne.

Thanks,

Hank

Hank Oswald  
Licensed Environmental Health Specialist  
Howard County Health Department  
Bureau of Environmental Health  
Well & Septic Program  
8930 Stanford Boulevard  
Columbia, MD 21045  
410.313.1786 (Office)  
[hoswald@howardcountymd.gov](mailto:hoswald@howardcountymd.gov)

**CONFIDENTIALITY NOTICE**

This message and the accompanying documents are intended only for the use of the individual or entity to which they are addressed and may contain information that is privileged, confidential, or exempt from disclosure under applicable law. If the reader of this email is not the intended recipient, you are hereby notified that you are strictly prohibited from reading, disseminating, distributing, or copying this communication. If you have received this email in error, please notify the sender immediately and destroy the original transmission.

--

**Andy Capelle**  
Vice President

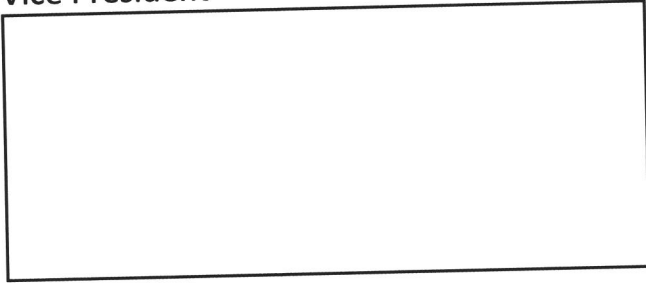

P.O. Box 129  
Annapolis Junction, MD 20701  
410-371-2219 cell  
301-776-8370 office  
301-776-8374 fax  
[alliedwells.com](http://alliedwells.com)

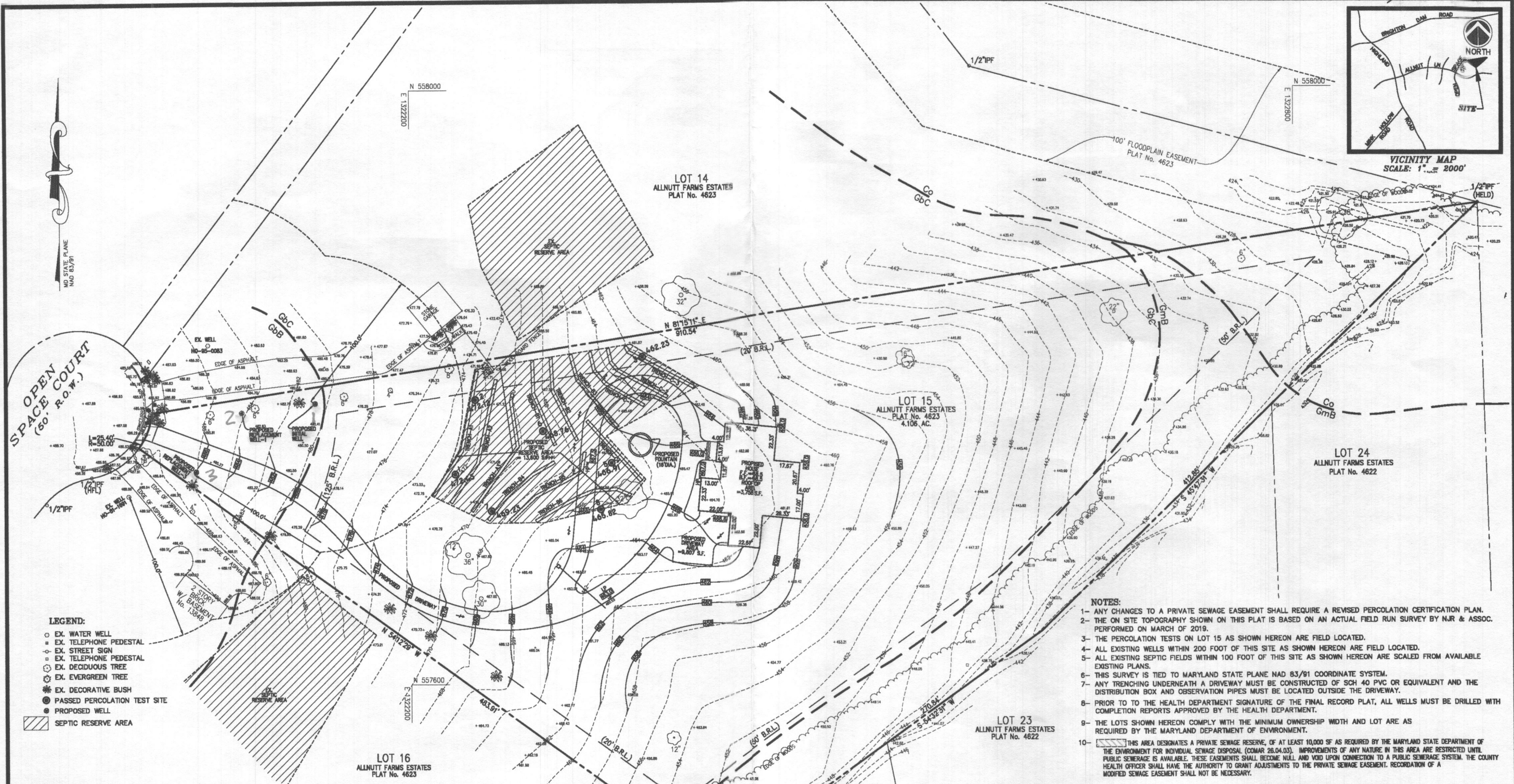
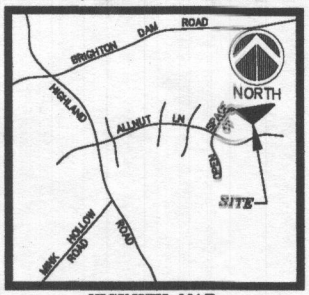

- LEGEND:**
- EX. WATER WELL
  - EX. TELEPHONE PEDESTAL
  - ◇ EX. STREET SIGN
  - EX. TELEPHONE PEDESTAL
  - EX. DECIDUOUS TREE
  - EX. EVERGREEN TREE
  - EX. DECORATIVE BUSH
  - PASSED PERCOLATION TEST SITE
  - PROPOSED WELL
  - ▨ SEPTIC RESERVE AREA

- NOTES:**
- 1- ANY CHANGES TO A PRIVATE SEWAGE EASEMENT SHALL REQUIRE A REVISED PERCOLATION CERTIFICATION PLAN.
  - 2- THE ON SITE TOPOGRAPHY SHOWN ON THIS PLAT IS BASED ON AN ACTUAL FIELD RUN SURVEY BY NJR & ASSOC. PERFORMED ON MARCH OF 2019.
  - 3- THE PERCOLATION TESTS ON LOT 15 AS SHOWN HEREON ARE FIELD LOCATED.
  - 4- ALL EXISTING WELLS WITHIN 200 FOOT OF THIS SITE AS SHOWN HEREON ARE FIELD LOCATED.
  - 5- ALL EXISTING SEPTIC FIELDS WITHIN 100 FOOT OF THIS SITE AS SHOWN HEREON ARE SCALED FROM AVAILABLE EXISTING PLANS.
  - 6- THIS SURVEY IS TIED TO MARYLAND STATE PLANE NAD 83/91 COORDINATE SYSTEM.
  - 7- ANY TRENCHING UNDERNEATH A DRIVEWAY MUST BE CONSTRUCTED OF SCH 40 PVC OR EQUIVALENT AND THE DISTRIBUTION BOX AND OBSERVATION PIPES MUST BE LOCATED OUTSIDE THE DRIVEWAY.
  - 8- PRIOR TO THE HEALTH DEPARTMENT SIGNATURE OF THE FINAL RECORD PLAT, ALL WELLS MUST BE DRILLED WITH COMPLETION REPORTS APPROVED BY THE HEALTH DEPARTMENT.
  - 9- THE LOTS SHOWN HEREON COMPLY WITH THE MINIMUM OWNERSHIP WIDTH AND LOT AREA AS REQUIRED BY THE MARYLAND DEPARTMENT OF ENVIRONMENT.
  - 10- THIS AREA DESIGNATES A PRIVATE SEWAGE RESERVE OF AT LEAST 10,000 SF AS REQUIRED BY THE MARYLAND STATE DEPARTMENT OF THE ENVIRONMENT FOR INDIVIDUAL SEWAGE DISPOSAL (COMAR 26.04.03). IMPROVEMENTS OF ANY NATURE IN THIS AREA ARE RESTRICTED UNTIL PUBLIC SEWERAGE IS AVAILABLE. THESE EASEMENTS SHALL BECOME NULL AND VOID UPON CONNECTION TO A PUBLIC SEWERAGE SYSTEM. THE COUNTY HEALTH OFFICER SHALL HAVE THE AUTHORITY TO GRANT ADJUSTMENTS TO THE PRIVATE SEWAGE EASEMENT. RECORDATION OF A MODIFIED SEWAGE EASEMENT SHALL NOT BE NECESSARY.

APPROVED FOR PRIVATE WATER AND PRIVATE SEWERAGE SYSTEMS.

HEALTH OFFICER, HOWARD COUNTY HEALTH DEPARTMENT. DATE

**PURPOSE NOTE:**  
THE PURPOSE OF THIS PLAN IS TO APPROVE THE INITIAL WELL AND TWO FUTURE REPLACEMENT WELL LOCATIONS, SHOW THE NEW PERCOLATION TEST LOCATIONS AND TO APPROVE THE RECONFIGURED PRIVATE SEWAGE RESERVE AREA TO ACCOMMODATE THE PROPOSED SINGLE FAMILY DWELLING ON LOT 15.

**A-INITIAL SEPTIC SYSTEM CALCULATIONS**

DRAINFIELD AREA: 8 BEDROOMS AT 1200 gpd / 0.8 ABSORPTION RATE=1500 SQ. FT.  
SIDEWALL REDUCTION CREDIT:  $\frac{WIDTH+2}{WIDTH+2(DEPTH)} \times 2+2(4) \times 11 = 0.36$

LENGTH OF TRENCHES:  $\frac{1500 \text{ SQ. FT.} \times 0.36}{2} = 270 \text{ LINEAR FEET}$

3 TRENCHES OF 90 FEET IN LENGTH, 10 FOOT SPACED ARE PROVIDED

---

**B-FIRST REPLACEMENT SEPTIC SYSTEM CALCULATIONS**

DRAINFIELD AREA: 8 BEDROOMS AT 1200 gpd / 0.8 ABSORPTION RATE=2000 SQ. FT.  
SIDEWALL REDUCTION CREDIT:  $\frac{WIDTH+2}{WIDTH+2(DEPTH)} \times 2+2(4) \times 11 = 0.36$

LENGTH OF TRENCHES:  $\frac{2000 \text{ SQ. FT.} \times 0.36}{2} = 360 \text{ LINEAR FEET}$

6 TRENCHES OF 60 FEET IN LENGTH, 10 FOOT SPACED ARE PROVIDED

---

**C-SECOND REPLACEMENT SEPTIC SYSTEM CALCULATIONS**

DRAINFIELD AREA: 8 BEDROOMS AT 1200 gpd / 1.2 ABSORPTION RATE=1000 SQ. FT.  
SIDEWALL REDUCTION CREDIT:  $\frac{WIDTH+2}{WIDTH+2(DEPTH)} \times 2+2(3) \times 9 = 0.44$

LENGTH OF TRENCHES:  $\frac{1000 \text{ SQ. FT.} \times 0.44}{2} = 220 \text{ LINEAR FEET}$

4 TRENCHES OF 55 FEET IN LENGTH, 10 FOOT SPACED ARE PROVIDED

**SOIL TABLE**

SYMBOL	NAME/DESCRIPTION	TYPE	HYDROLIC
GbB	Gladstone loam, 3 to 8% slope	A	No
GbC	Gladstone loam, 8 to 15% slope	A	No
GmB	Glenville silt loam, 3 to 8% slope	C/D	Yes
Co	Codorus and Hatboro silt loam 3 to 8% slope	C	Yes

<p>PLAN PREPARED BY:</p> <p><b>NJR &amp; ASSOCIATES</b> Land Surveying and Planning 2770 STATE ROUTE 92 WEST FRIENDSHIP, MD 21794 TEL: (240) 508-3200</p>		<p>I HEREBY CERTIFY THAT THESE DOCUMENTS WERE PREPARED OR APPROVED BY ME, AND THAT I AM A duly LICENSED PROFESSIONAL LAND SURVEYOR UNDER THE LAWS OF THE STATE OF MARYLAND, LICENSE # 11049, EXPIRATION DATE: 2/7/2021.</p> <p style="text-align: right;">DATE: JULY 22, 2019</p>	<p>DEVELOPER</p> <p>CARUSO HOMES 2120 BALDWIN AVENUE, Ste 200 CROFTON, MD 21144 (301) 281-0277</p>	<p><b>PERCOLATION CERTIFICATION PLAN</b> <b>ALLNUT FARM ESTATES, SECTION-5</b> <b>LOTS 15</b> PLAT No. 4623 OPEN SPACE COURT, HIGHLAND, MD 20777 TAX MAP 34, GRID 15, PARCEL 375 5TH ELECTION DISTRICT HOWARD COUNTY, MARYLAND</p> <p>SCALE: 1" = 30'    JOB NO.: 3534    DATE: JULY 22, 2019    SHEET: 1 OF 1</p>
---	--	---	--	--

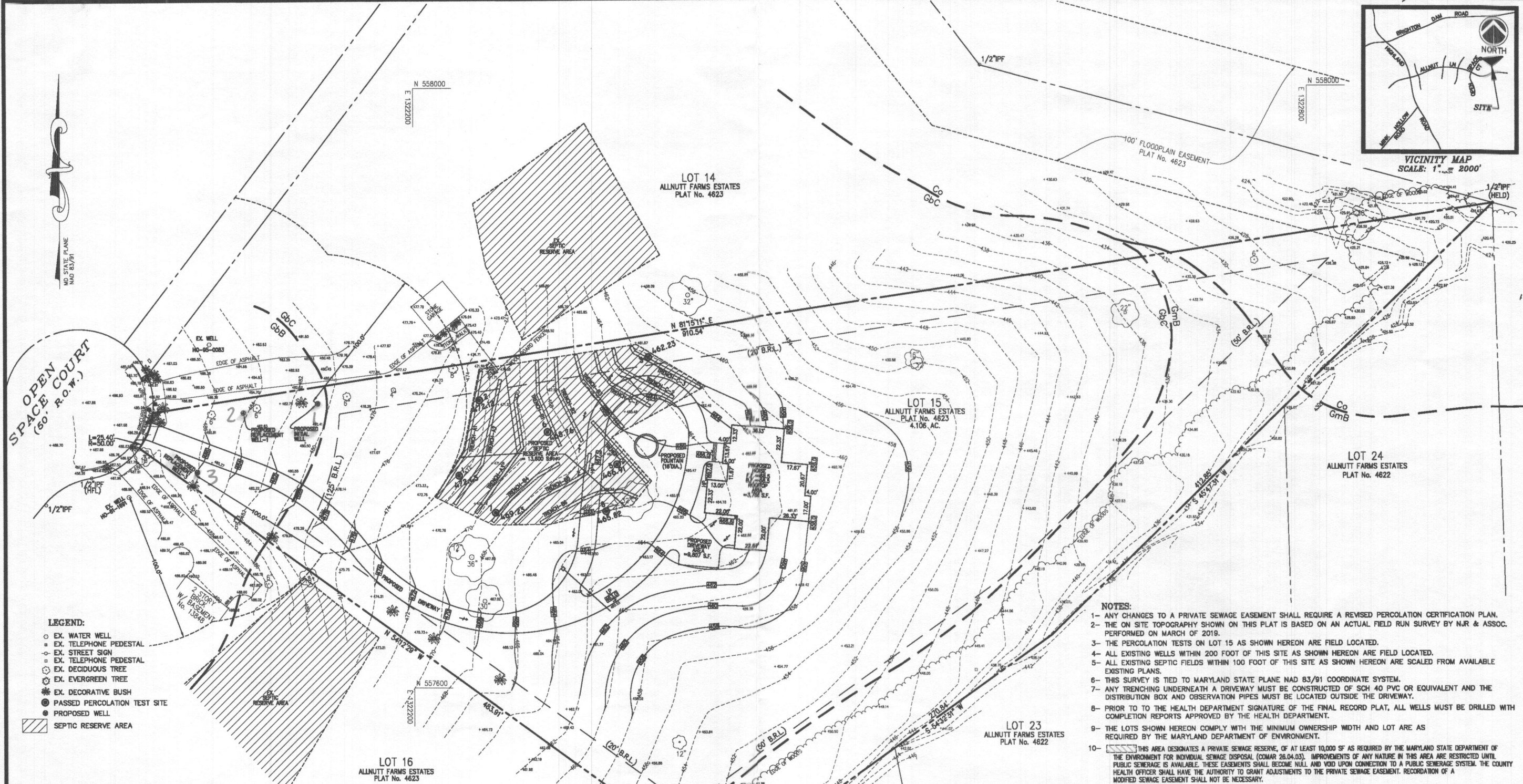
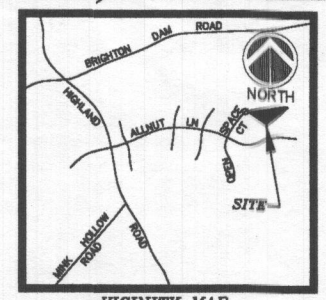

- NOTES:**
- 1- ANY CHANGES TO A PRIVATE SEWAGE EASEMENT SHALL REQUIRE A REVISED PERCOLATION CERTIFICATION PLAN.
  - 2- THE ON SITE TOPOGRAPHY SHOWN ON THIS PLAT IS BASED ON AN ACTUAL FIELD RUN SURVEY BY NJR & ASSOC. PERFORMED ON MARCH OF 2019.
  - 3- THE PERCOLATION TESTS ON LOT 15 AS SHOWN HEREON ARE FIELD LOCATED.
  - 4- ALL EXISTING WELLS WITHIN 200 FOOT OF THIS SITE AS SHOWN HEREON ARE FIELD LOCATED.
  - 5- ALL EXISTING SEPTIC FIELDS WITHIN 100 FOOT OF THIS SITE AS SHOWN HEREON ARE SCALED FROM AVAILABLE EXISTING PLANS.
  - 6- THIS SURVEY IS TIED TO MARYLAND STATE PLANE NAD 83/91 COORDINATE SYSTEM.
  - 7- ANY TRENCHING UNDERNEATH A DRIVEWAY MUST BE CONSTRUCTED OF SCH 40 PVC OR EQUIVALENT AND THE DISTRIBUTION BOX AND OBSERVATION PIPES MUST BE LOCATED OUTSIDE THE DRIVEWAY.
  - 8- PRIOR TO THE HEALTH DEPARTMENT SIGNATURE OF THE FINAL RECORD PLAT, ALL WELLS MUST BE DRILLED WITH COMPLETION REPORTS APPROVED BY THE HEALTH DEPARTMENT.
  - 9- THE LOTS SHOWN HEREON COMPLY WITH THE MINIMUM OWNERSHIP WIDTH AND LOT AREA AS REQUIRED BY THE MARYLAND DEPARTMENT OF ENVIRONMENT.
  - 10- THIS AREA DESIGNATES A PRIVATE SEWAGE RESERVE, OF AT LEAST 10,000 SF AS REQUIRED BY THE MARYLAND STATE DEPARTMENT OF ENVIRONMENT FOR INDIVIDUAL SEWAGE DISPOSAL (COMAR 26.04.03). IMPROVEMENTS OF ANY NATURE IN THIS AREA ARE RESTRICTED UNTIL PUBLIC SEWERAGE IS AVAILABLE. THESE EASEMENTS SHALL BECOME NULL AND VOID UPON CONNECTION TO A PUBLIC SEWERAGE SYSTEM. THE COUNTY HEALTH OFFICER SHALL HAVE THE AUTHORITY TO GRANT ADJUSTMENTS TO THE PRIVATE SEWAGE EASEMENT. RECORDED OF A MODIFIED SEWAGE EASEMENT SHALL NOT BE NECESSARY.

APPROVED FOR PRIVATE WATER AND PRIVATE SEWERAGE SYSTEMS.

HEALTH OFFICER, HOWARD COUNTY HEALTH DEPARTMENT. DATE \_\_\_\_\_

**PURPOSE NOTE:**  
THE PURPOSE OF THIS PLAN IS TO APPROVE THE INITIAL WELL AND TWO FUTURE REPLACEMENT WELL LOCATIONS, SHOW THE NEW PERCOLATION TEST LOCATIONS AND TO APPROVE THE RECONFIGURED PRIVATE SEWAGE RESERVE AREA TO ACCOMMODATE THE PROPOSED SINGLE FAMILY DWELLING ON LOT 15.

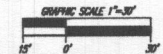

- LEGEND:**
- EX. WATER WELL
  - EX. TELEPHONE PEDESTAL
  - ◇ EX. STREET SIGN
  - ◇ EX. TELEPHONE PEDESTAL
  - EX. DECIDUOUS TREE
  - EX. EVERGREEN TREE
  - EX. DECORATIVE BUSH
  - PASSED PERCOLATION TEST SITE
  - PROPOSED WELL
  - ▨ SEPTIC RESERVE AREA

**A-INITIAL SEPTIC SYSTEM CALCULATIONS**

DRAINFIELD AREA: 8 BEDROOMS AT 1200 gpd / 0.8 ABSORPTION RATE=1500 SQ. FT.  
SIDEWALL REDUCTION CREDIT:  $\frac{2+2}{\text{WIDTH}+2(\text{DEPTH})} = \frac{4}{2+2(4)} = 11$  @ 0.38  
LENGTH OF TRENCHES:  $\frac{1500 \text{ SQ. FT.} \times 0.38}{2} = 270 \text{ LINEAR FEET}$   
3 TRENCHES OF 90 FEET IN LENGTH, 10 FOOT SPACED ARE PROVIDED

**B-FIRST REPLACEMENT SEPTIC SYSTEM CALCULATIONS**

DRAINFIELD AREA: 8 BEDROOMS AT 1500 gpd / 0.8 ABSORPTION RATE=2000 SQ. FT.  
SIDEWALL REDUCTION CREDIT:  $\frac{2+2}{\text{WIDTH}+2(\text{DEPTH})} = \frac{4}{2+2(4)} = 11$  @ 0.38  
LENGTH OF TRENCHES:  $\frac{2000 \text{ SQ. FT.} \times 0.38}{2} = 360 \text{ LINEAR FEET}$   
6 TRENCHES OF 90 FEET IN LENGTH, 10 FOOT SPACED ARE PROVIDED

**C-SECOND REPLACEMENT SEPTIC SYSTEM CALCULATIONS**

DRAINFIELD AREA: 8 BEDROOMS AT 1200 gpd / 1.2 ABSORPTION RATE=1000 SQ. FT.  
SIDEWALL REDUCTION CREDIT:  $\frac{2+2}{\text{WIDTH}+2(\text{DEPTH})} = \frac{4}{2+2(3)} = 9$  @ 0.44  
LENGTH OF TRENCHES:  $\frac{1000 \text{ SQ. FT.} \times 0.44}{2} = 220 \text{ LINEAR FEET}$   
4 TRENCHES OF 55 FEET IN LENGTH, 10 FOOT SPACED ARE PROVIDED

**SOIL TABLE**

SYMBOL	NAME/DESCRIPTION	TYPE	HYDROLIC
GbB	Gladstone loam, 3 to 8% slope	A	No
GbC	Gladstone loam, 8 to 15% slope	A	No
GmB	Glenville silt loam, 3 to 8% slope	C/D	Yes
Co	Codorus and Hatboro silt loam 3 to 8% slope	C	Yes

PLAN PREPARED BY:  
**NJR & ASSOCIATES**  
Land Surveying and Planning  
2770 STATE ROUTE 32  
WEST FRIENDSHIP, MD 21794  
TEL: (240) 608-3200

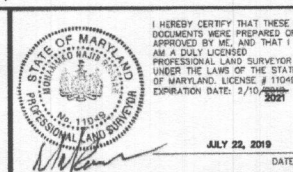

I HEREBY CERTIFY THAT THESE DOCUMENTS WERE PREPARED OR APPROVED BY ME, AND THAT I AM A QUALIFIED PROFESSIONAL LAND SURVEYOR UNDER THE LAWS OF THE STATE OF MARYLAND, LICENSE # 11049, EXPIRATION DATE: 2/10/2021

DATE: JULY 22, 2019

**PERCOLATION CERTIFICATION PLAN**  
**ALLNUT FARM ESTATES, SECTION-5**  
**LOTS 15**  
PLAT No. 4623  
OPEN SPACE COURT, HIGHLAND, MD 20777  
TAX MAP 34, GRID 15, PARCEL 375  
5TH ELECTION DISTRICT HOWARD COUNTY, MARYLAND

DEVELOPER  
CARUSO HOMES  
2120 BALDWIN AVENUE,  
Ste 200  
CROFTON, MD 21144  
(301) 281-0277

SCALE: 1" = 30' JOB NO.: 3534 DATE: JULY 22, 2019 SHEET: 1 OF 1