

HPA# 21267 AC.

PASTURE GREEN

D=50.00'
L=20.18'

57°57'06" E
15.00'

Approved
B20002369
ALZ 8/10/2020

Project Address
13733 Pasture Green
Clarksville, MD 21029

Scale: 1" = 60'

Date: 7/8/20

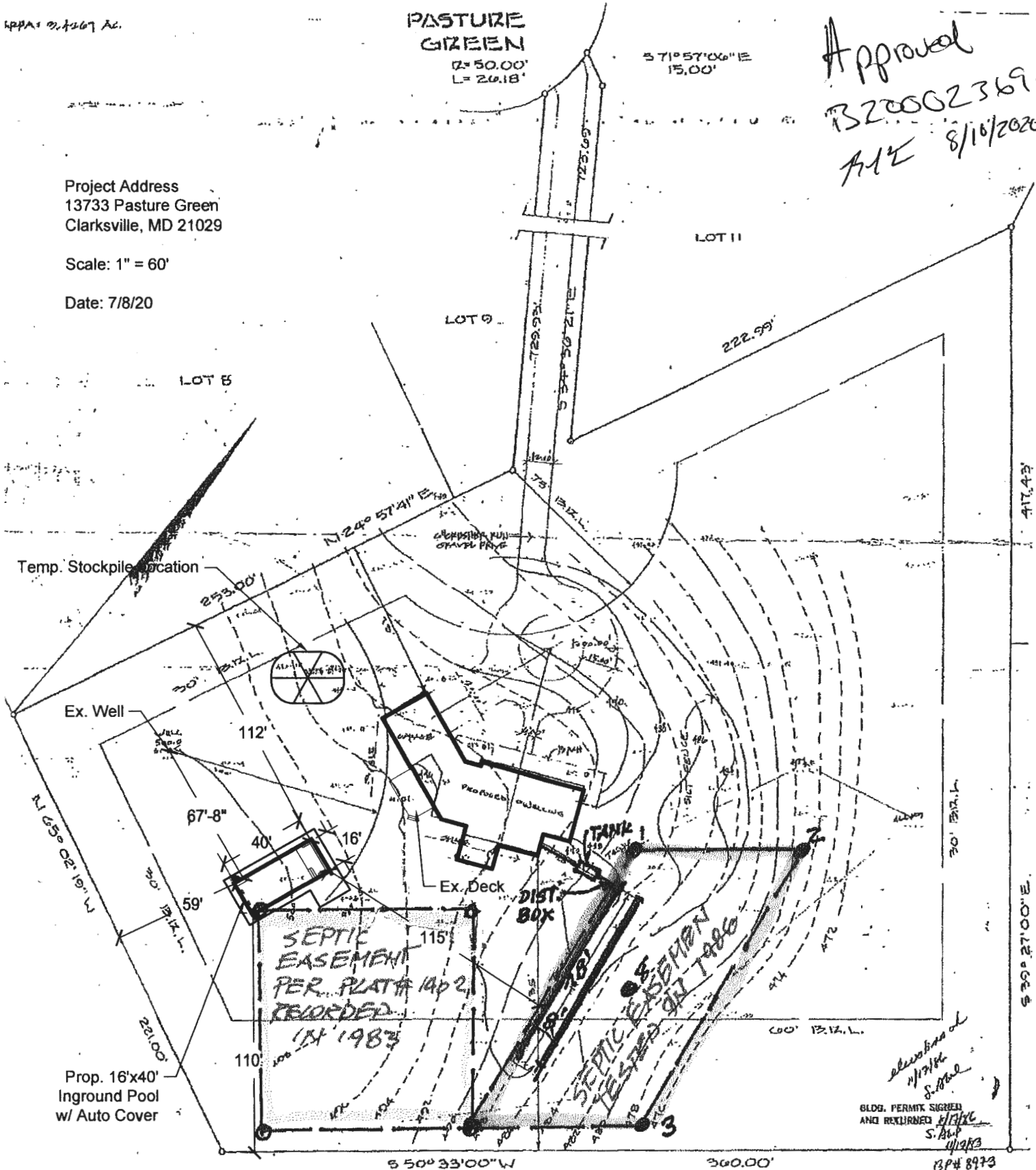

Temp. Stockpile Location

Ex. Well

Ex. Deck

SEPTIC EASEMENT
PER PLAT # 1402
RECORDED
12/1983

TANK

DIST. BOX

SEPTIC EASEMENT
1986

Prop. 16'x40'
Inground Pool
w/ Auto Cover

division of
1/13/18
S. B. P.
1/12/18
BLOG. PERMIT SIGNED
AND RETURNED
S. B. P.
1/12/18
CP# 8973

CHARLES RUPPERT, JR.

TRENCH, EXISTING GRADE = 188.5V
INVERT = 164.5V

TANK EXISTING GRADE = 170.0V
INVERT OUT = 184.1V
INVERT IN = 185.0V

INVERT AT HOUSE = 485.4V

WELL = 500.00V

MANHOLE
COVER
PROVIDED

FIRST FLOOR = 406.40V
BASEMENT = 401.40V
GARAGE = 401.75V

SCALE: 1"=60'

SCALE 1/2"