

Approved a 129 / 20 - H.O.

Menu Save Reset Cancel Help

Record Detail * (This section is required.)

Permit Type	Permit Number	Opened Date
Building/Residential/Misc/Porch	B20003253	09/25/2020
Description of Work		
SFD/ CONSTRUCT 14 X 20 SCREEN PORCH ON EXISTING DECK, REPLACE EXISTING WINDOW WITH NEW 32" EXTERIOR DOOR		

check spelling

Address * (This section is required.)

Search Reset Clear Get Parcel & Owner

Street #	Street Name	Street Type	
15534	FOXPAW	TRL	
Unit Type	Unit #	X Coordinate	Y Coordinate
--Select--		-77.04807	39.31735
City	State	Zip Code	Primary
WOODBINE	MD	21797	Yes

Parcel * (This section is required.)

Search Reset Clear Get Address & Owner

GIS ID *	Parcel	Parcel Area	Land Value	Improved Value	Exemption Value	Plan Area
909923	233	3.11	258300	730100	471800	RURAL
Legal Description						
IMPSLOT 14 3.1112 A[]15534 FOXPAW TRL[]FOXPORT PLANT RSB LOT 1						

check spelling

Block	Lot	Census Tract	Council Dist	Inspection Dist	Supervisor Dist	Map #	DAP Zone
	14	605601	5				
Plan Area	State Tax Id	Subdivision Name					
	1404348621	FOXPORT PLANTATION					
Section	Area	Tax Map					
		8					
Grid	Zoning District	ADC Map					
8-20	RC-DEO	4692-C10					
SDP No.	Final Plan No.	WP File No.					
Record Plat No.	WS Contract No.	FDP No.	Primary				
8430			Yes				
Owner Occupied	Year Built	Historic District					
<input type="radio"/> Yes <input checked="" type="radio"/> No	1990	<input type="radio"/> Yes <input checked="" type="radio"/> No					
Historic District Registry No.	Stat Area	Flood Plain					
	4-06	<input type="radio"/> Yes <input checked="" type="radio"/> No					
Building No							

Owner * (This section is required.)

Search Reset Clear

Name *

Josh Araujo		
Address Line 1		
15534 Foxpaw Trail		
Address Line 2		
Address Line 3		
Mail City	Mail State	Mail Zip Code
Woodbine	MD	21797
Phone	Primary	
760-468-4956	Yes	
E-mail		
josh.araujo@gmail.com		
Cell Number	Fax Number	

Professionals (This section is not required.)

Search Reset Clear

License # *	Business Name		
08010038011	J R TRAWICK COMPANY INC		
License Type *	First Name	Middle Name	Last Name
MHIC Ind	JAMES		TRAWICK
Primary	Address Line 1		
Yes	604 WEST WATERSVILLE RD		
	Address Line 2		
	604 WEST WATERSVILLE ROAD		
	City	State	ZIP Code
	MOUNT AIRY	MD	21771-0000
	Phone 1	Phone 2	Fax
	3014424517		3016079017
E-mail			
JRTRAWICK@JUNO.COM			

Applicant (This section is not required.)

Search As Owner As Lic. Prof As Contact

Type *	First Name	MI	Last Name
Applicant	JAMES		TRAWICK
Relationship	Full Name		
--Select--			
Primary	Organization Name		
Yes	J R TRAWICK COMPANY INC		
	Street Address		
	604 WEST WATERSVILLE RD		
	Address Line 2		
	604 WEST WATERSVILLE ROAD		
	City	State	Zip Code
	MOUNT AIRY	MD	21771-0000
	Phone	Cell	Fax
	3014424517		3016079017
E-mail *			

JRTRAWICK@JUNO.COM

Addtl Info

Est Construction Cost *	Housing Units *	Number of Buildings *	Public Owned
30000	0	0	No
Construction Type			
--Select--			

PORCH INFORMATION

PORCH INFORMATION

Capital Project-No Fee *	Capital Project Number	Fee Exempt *	Roadside Tree Project Permit *	Roadside Tree Project Permit #
<input type="radio"/> Yes <input checked="" type="radio"/> No		<input type="radio"/> Yes <input checked="" type="radio"/> No	<input type="radio"/> Yes <input checked="" type="radio"/> No	
Existing Use *	Type of Porch *	Type of Porch Foundation *	Total Square Footage *	
SFD	Open and Screened Poi	Existing Deck	280 SQFT	
Water Supply	Sewage Disposal	Expiration Date		
Private	Private	3/27/2021		

PAYMENT INFORMATION

Check 1	Payee 1	Check 2	Payee 2	SAP Doc No	SAP Entered

Submit Cancel

THIS DOCUMENT IS CERTIFIED TO:

J.R. Trawick
Company, Inc.



J.R. Trawick
Company, Inc.

CASE #: *****

Home Owner
Josh Araujo

BUSHY PARK ROAD

N87°34'53"E
398.41'

R=837.23
A=160.0' (Comp)

LOT 14
3.112 Ac. ±

SEE DETAIL

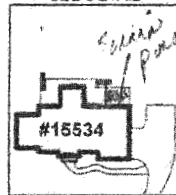

S36°14'19"W
569.65'

Putting
Screen porch
on Bushy
Dale

DETAIL: 1"=50'

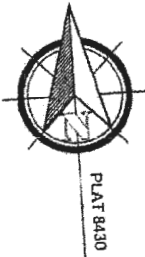
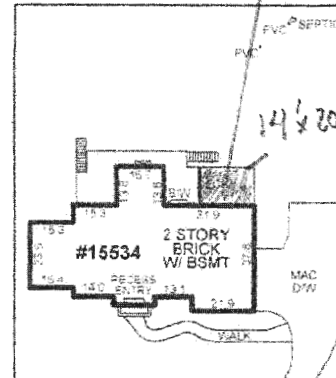

R=50.00
A=50.00'
FOXPAW TRAIL

LOCATION DRAWING OF:

**#15534 FOXPAW TRAIL
LOT 14**

4th ELECTION DISTRICT
FOXPORT PLANTATION
PLAT No. 8430

HOWARD COUNTY, MARYLAND

SCALE: 1"=100' DATE: 09-18-2020
DRAWN BY: AP FILE #: 209212-200

LEGEND:

- FENCE
- B/E - BASEMENT ENTRANCE
- B/W - BAY WINDOW
- BR - BRICK
- BR/L - BLDG RESTRICTION LINE
- BSMT - BASEMENT
- C/S - CONCRETE STOOP
- CONG - CONCRETE
- D/W - DRIVEWAY
- EX - EXISTING
- FR - FRAME
- MAC - MACHADAM
- G - GATE
- OH - OVERHANG
- PUE - PUBLIC UTILITY ESDT
- P/E - PUBLIC IMPROVEMENT ESDT

COLOR KEY:

- FEED - RECORD INFORMATION
- BLVD - IMPROVEMENTS

A Land Surveying Company



DULEY

and
Associates, Inc.

Serving D.C. and MD.

14604 Elm Street, Upper Marlboro, MD 20772

Phone: 301-888-1111

Fax: 301-888-1114

Email: orders@duley.biz

On the web: www.duley.biz

SURVEYOR'S CERTIFICATE

I HEREBY STATE THAT I WAS IN RESPONSIBLE CHARGE OVER THE PREPARATION OF THIS DRAWING AND THE SURVEY WORK REFLECTED HEREIN AND IT IS IN COMPLIANCE WITH THE REQUIREMENTS SET FORTH IN REGULATION 12 CHAPTER 28.13 OF THE CODE OF MARYLAND ANNOTATED REGULATIONS. THIS SURVEY IS NOT TO BE USED OR RELIED UPON FOR THE ESTABLISHMENT OF FENCES, BUILDING, OR OTHER IMPROVEMENTS. THIS PLAT DOES NOT PROVIDE FOR THE ACCURATE IDENTIFICATION OF PROPERTY BOUNDARY LINES, BUT SUCH IDENTIFICATION MAY NOT BE REQUIRED FOR THE TRANSFER OF TITLE OR SECURING FINANCING OR REFINANCING. THIS PLAT IS OF BENEFIT TO A CONSUMER ONLY INsofar as it is required by a LENDER OR A TITLE INSURANCE COMPANY OR ITS AGENTS IN CONNECTION WITH THE CONTEMPLATED TRANSFER, FINANCING OR REFINANCING. THE LEVEL OF ACCURACY FOR THIS DRAWING IS 1". NO TITLE REPORT WAS FURNISHED TO NOR DONE BY THIS COMPANY. SAID PROPERTY SUBJECT TO ALL NOTES, RESTRICTIONS AND EASEMENTS OF RECORD. BUILDING RESTRICTION LINES AND EASEMENTS MAY NOT BE SHOWN ON THIS SURVEY. IMPROVEMENTS WHICH IN THE SURVEYOR'S OPINION APPEAR TO BE IN A STATE OF DISREPAIR OR MAY BE CONSIDERED TEMPORARY MAY NOT BE SHOWN. IF IT APPEARS ENCROACHMENTS MAY EXIST, A BOUNDARY SURVEY IS RECOMMENDED.

DULEY & ASSOC.

WILL GIVE YOU A 100% FULL CREDIT TOWARDS UPGRADING THIS SURVEY TO A "BOUNDARY/STAKE" SURVEY FOR ONE YEAR FROM THE DATE OF THIS SURVEY.

(EXCLUDING D.C. & BALT. CITY)

