

~~#21/63~~  
11/22/63 OK/1/17

# PERMIT

SEWAGE DISPOSAL SYSTEM

P 07651

A 07162

MARYLAND STATE DEPARTMENT OF HEALTH

HOWARD COUNTY

ELLICOTT CITY

DISTRICT 5

DATE 10/30/63

## INDEXED

Elwood Soaggs IS PERMITTED TO INSTALL ALTER

ADDRESS \_\_\_\_\_ PHONE \_\_\_\_\_

A SEWAGE DISPOSAL SYSTEM LOCATED AT \_\_\_\_\_

SUBDIVISION Greenwood Farms ROAD Greendell Lane LOT 34

PROPERTY OWNER Robert D. Wanner

ADDRESS \_\_\_\_\_

### SPECIFICATIONS

DRAIN FIELD \_\_\_\_\_ DEPTH \_\_\_\_\_ FEET, BOTTOM AREA \_\_\_\_\_ SQ. FT.

SEEPAGE PITS 1 ABSORBENT SIDE-WALL AREA 10' X 10' SQ. FT. below inlet.

SEPTIC TANK CAPACITY 750 GALLONS

FOR GARBAGE GRINDER, INCREASE DISPOSAL AREA 22% & TANK CAPACITY 50%.

OTHER Locate system 96 ft. from front lot line and 20 ft. from left lot line

as seen when facing lot from Greendell Lane.

PLANS APPROVED BY JHennigan DATE 7/23/63

FILL SEPTIC TANK AND DISTRIBUTION BOX WITH WATER BEFORE CALLING FOR AN INSPECTION. COVER NO WORK UNTIL INSPECTED AND APPROVED.

NEITHER THE HOWARD COUNTY COMMISSIONERS NOR THE HEALTH DEPARTMENT IS RESPONSIBLE FOR THE SUCCESSFUL OPERATION OF ANY SYSTEM.

A 07162

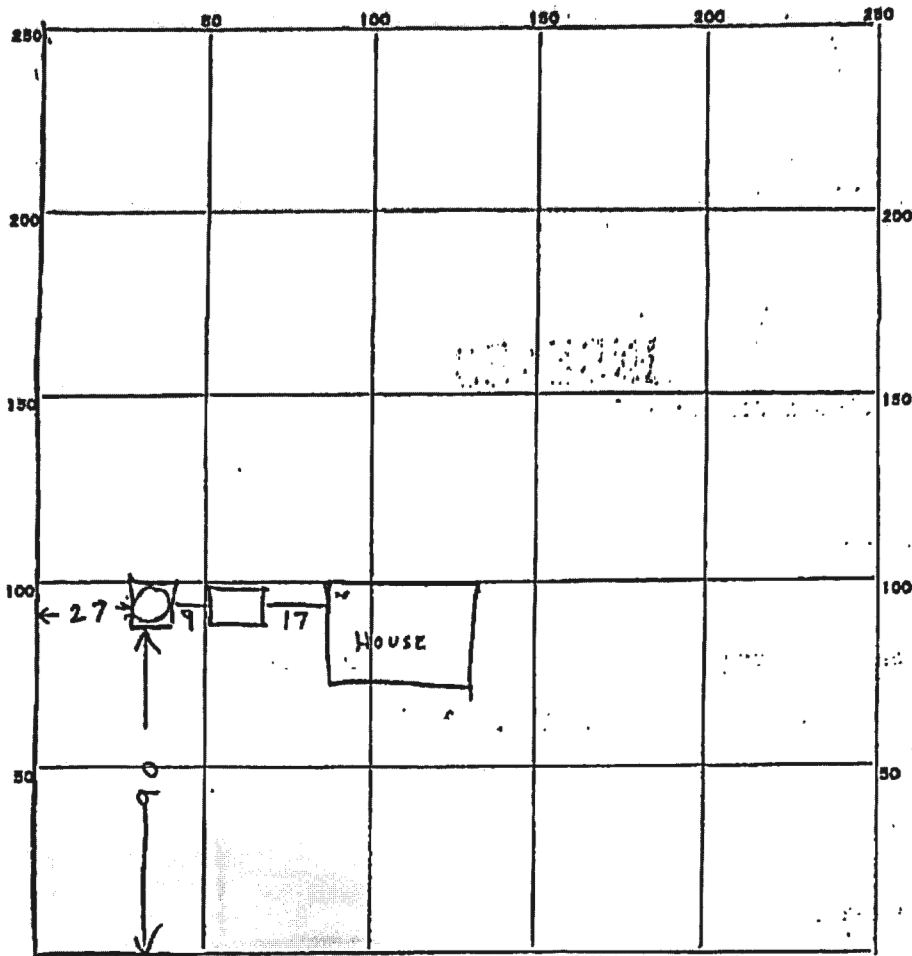

PERMIT CARD 759

SEPTIC TANK, LEVEL OK concrete 750  
Top is 4-ft below grade  
 DISTRIBUTION BOX, LEVEL \_\_\_\_\_

CLEANOUTS OK

TILE FIELD, DEPTH \_\_\_\_\_ FT. TRENCH WIDTH \_\_\_\_\_ FT.

GRAVEL DEPTH \_\_\_\_\_ IN. TOTAL LENGTH \_\_\_\_\_ FT.

NUMBER OF TRENCHES \_\_\_\_\_ TOTAL BOTTOM AREA \_\_\_\_\_

SEEPAGE PITS, INSIDE DIAMETER 9 1/2 FT. DEPTH BELOW INLET 10 FT.

ABSORBENT AREA 290 SQ. FT. not counting stone

REMARKS Dry Well inlet is 3 ft below grade  
Aloud 1 ft stone around outside of Dry well

DATE SYSTEM APPROVED 22 NOV 63

INSPECTOR Raymond Hodges

A# 07162

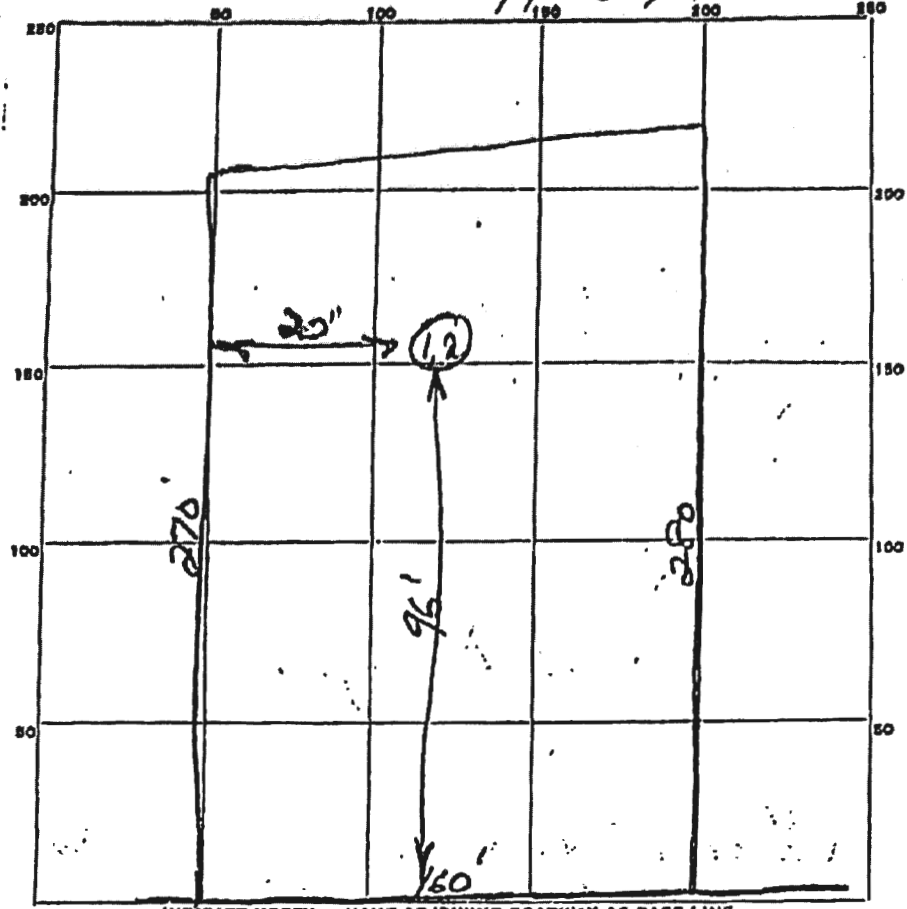

INDICATE NORTH - NAME ADJOINING ROADWAY AS BASE LINE.

GREENWELL LANE

DATE	TEST NO.	DEPTH	PRE-WET		TEST - 1" DROP		TIME
			START	STOP	START	STOP	
7-23-63	8-1	5'	11:28	11:31	11:31	11:37	62 min
	8-2	9'	11:28	11:28	11:28	11:30	22 min

SOIL AUGER FINDING \_\_\_\_\_

TESTED BY J.H.

REMARKS \_\_\_\_\_

7-23-63  
ALSO PRESENT Aluminum LOT NO. 34