



7612 Browns Bridge Road
 Highland, MD 20777
 301-776-2666
 301-776-2886 fax
 info@TransformingArchitecture.com
 www.TransformingArchitecture.com



STAMP

I CERTIFY THAT THESE DOCUMENTS WERE PREPARED OR APPROVED BY ME, AND THAT I AM A DULY LICENSED ARCHITECT UNDER THE LAWS OF THE STATE OF MARYLAND, LICENSE NUMBER 13662, EXPIRATION 10-22-2021.

NOTE: THESE DRAWINGS ARE THE PROPERTY OF TRANSFORMING ARCHITECTURE AND, AS SUCH, MAY NOT BE RE-USED OR REPRODUCED, EITHER WHOLLY OR IN PART, WITHOUT PRIOR WRITTEN CONSENT OF TRANSFORMING ARCHITECTURE.

PROJECT PHASE

PERMIT

PROJECT TITLE

THE REDDY RESIDENCE

5046 Grape Myrtle Court
 Ellicott City, MD 21042

REVISIONS

SYMBOL	DATE	ISSUED FOR

PROJECT NUMBER 19-467
 DATE 10/23/2020
 SCALE AS NOTED

DRAWING TITLE
EXTERIOR + INTERIOR ELEVATIONS

SHEET NUMBER
A-201



1 REAR ELEVATION
 A201 SCALE: 1/4"=1'-0"

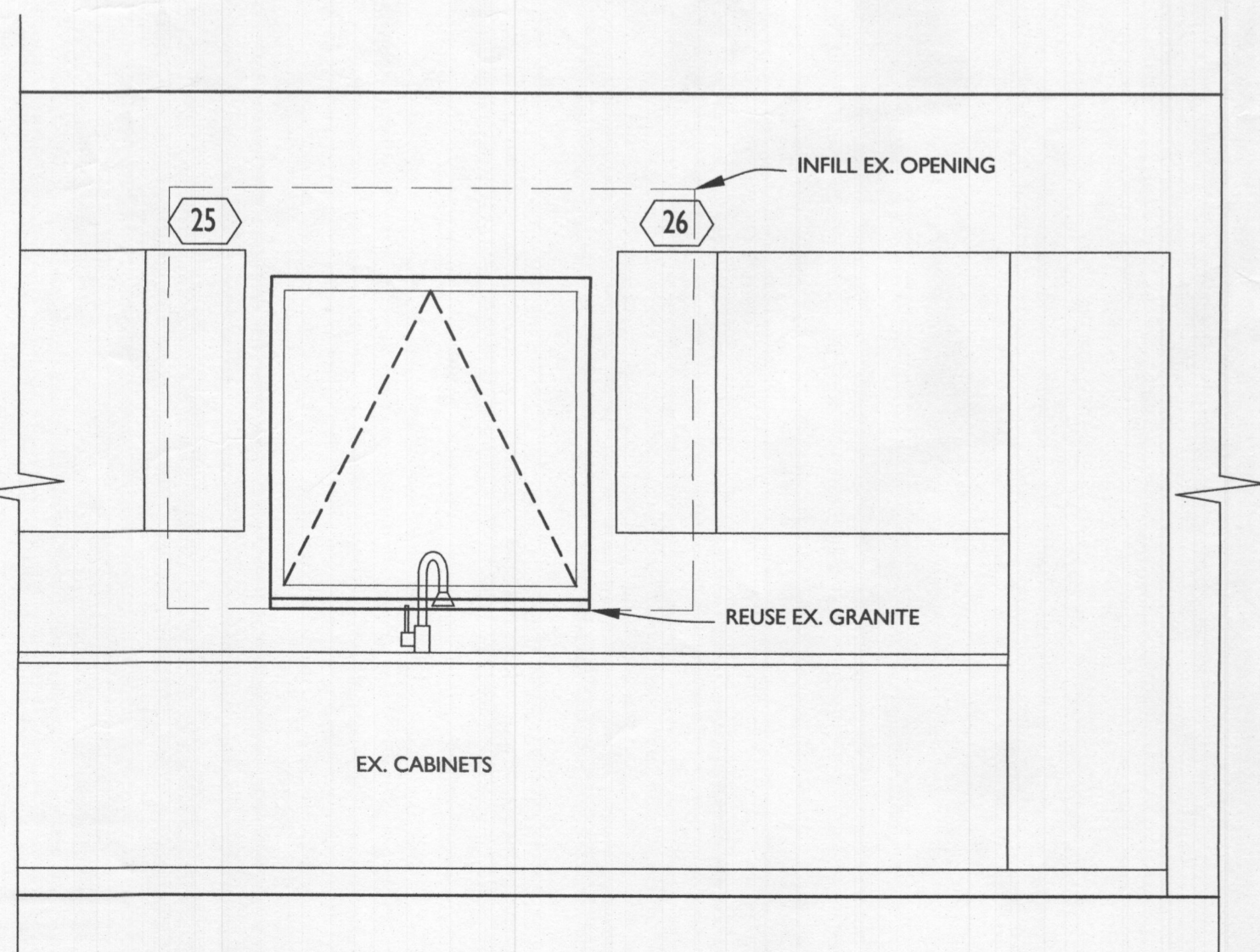

2 KITCHEN ELEVATION
 A201 SCALE: 1/2"=1'-0"



7612 Browns Bridge Road
 Highland, MD 20777
 301-776-2666
 301-776-2886 fax
 info@TransformingArchitecture.com
 www.TransformingArchitecture.com

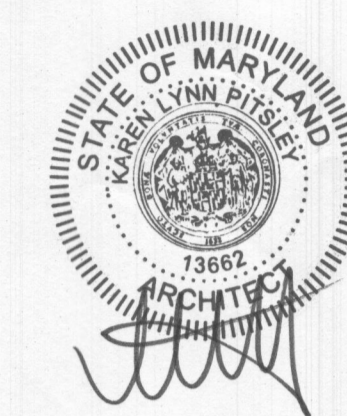

STAMP

I CERTIFY THAT THESE DOCUMENTS WERE PREPARED OR APPROVED BY ME, AND THAT I AM A DULY LICENSED ARCHITECT UNDER THE LAWS OF THE STATE OF MARYLAND, LICENSE NUMBER 13662, EXPIRATION 10-22-2021.

NOTE: THESE DRAWINGS ARE THE PROPERTY OF TRANSFORMING ARCHITECTURE AND, AS SUCH, MAY NOT BE REPRODUCED OR REPRODUCED EITHER WHOLLY OR IN PART, WITHOUT PRIOR WRITTEN CONSENT OF TRANSFORMING ARCHITECTURE.

PROJECT PHASE

PERMIT

PROJECT TITLE

THE
 REDDY
 RESIDENCE

5046 Crape Myrtle Court
 Ellicott City, MD 21042

REVISIONS

SYMBOL	DATE	ISSUED FOR

PROJECT NUMBER 19-467

DATE 10/23/2020

SCALE AS NOTED

DRAWING TITLE

BUILDING SECTION

SHEET NUMBER

A-300

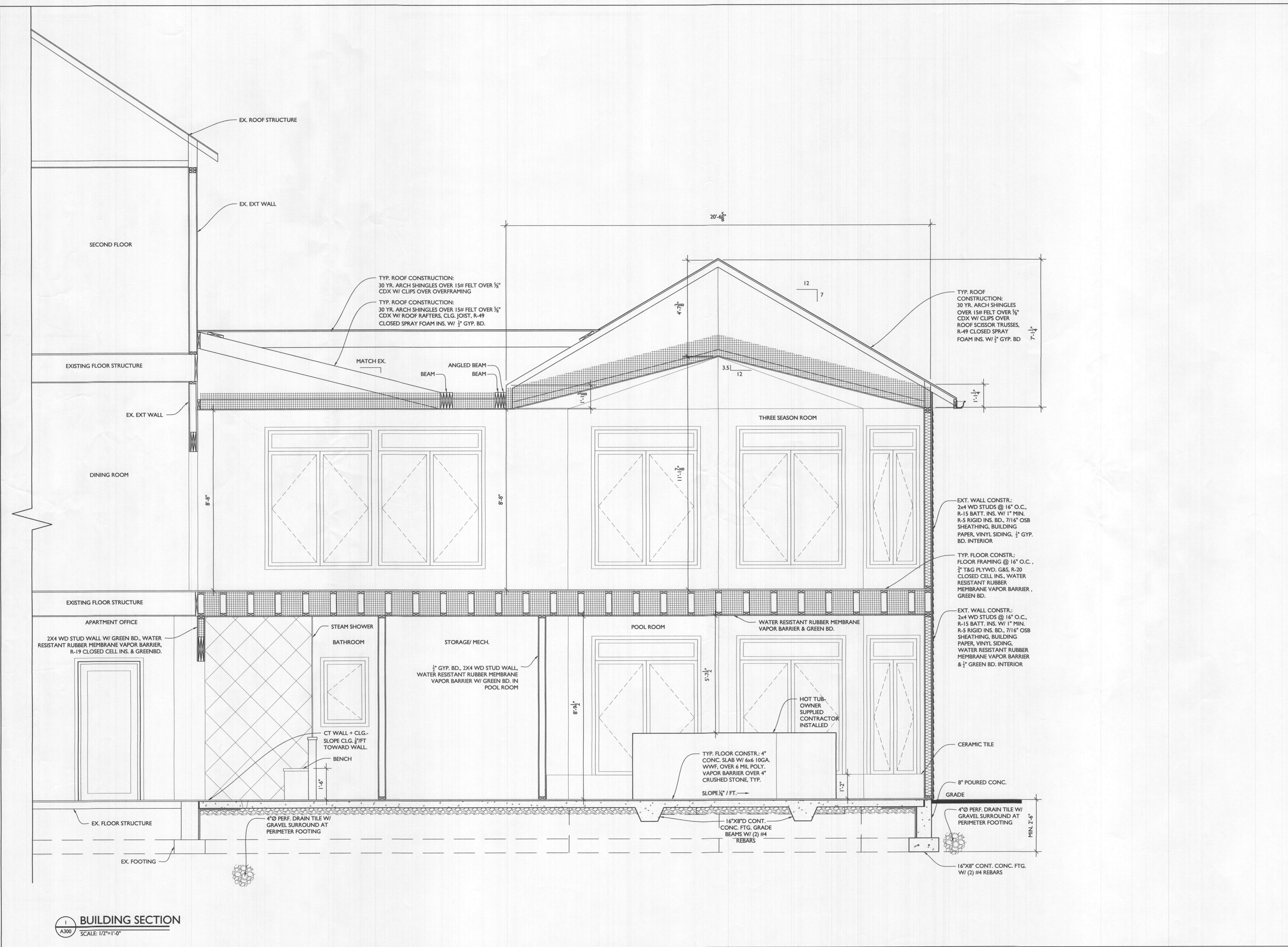

BUILDING SECTION
 SCALE: 1/2"=1'-0"

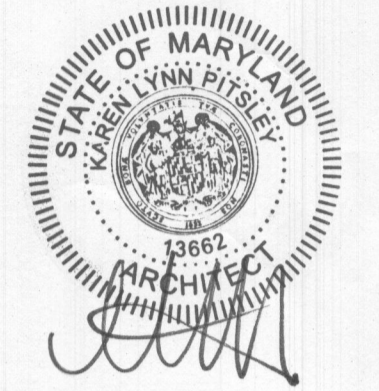

STAMP

I CERTIFY THAT THESE DOCUMENTS WERE PREPARED OR APPROVED BY ME AND THAT I AM A DULY LICENSED ARCHITECT UNDER THE LAWS OF THE STATE OF MARYLAND, LICENSE NUMBER 13662, EXPIRATION 10-22-2021.

NOTE: THESE DRAWINGS ARE THE PROPERTY OF TRANSFORMING ARCHITECTURE AND, AS SUCH, MAY NOT BE RE-USED OR REPRODUCED, EITHER WHOLLY OR IN PART, WITHOUT PRIOR WRITTEN CONSENT OF TRANSFORMING ARCHITECTURE.

PROJECT PHASE

PERMIT

PROJECT TITLE

THE REDDY RESIDENCE

5046 Crape Myrtle Court
Ellicott City, MD 21042

REVISIONS

SYMBOL	DATE	ISSUED FOR

PROJECT NUMBER 19-467

DATE 10/23/2020

SCALE AS NOTED

DRAWING TITLE

BUILDING SECTIONS

SHEET NUMBER

A-301

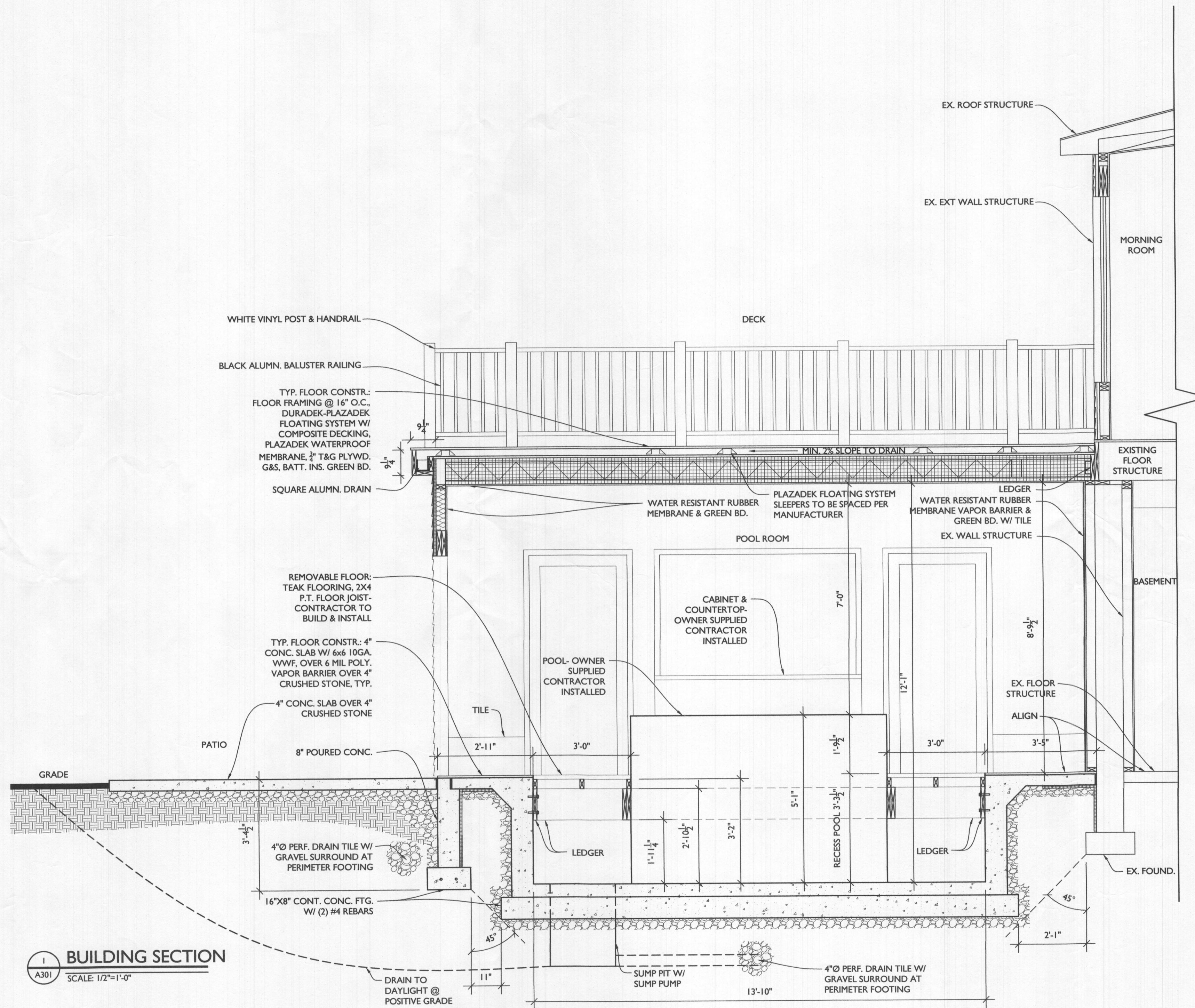

1 BUILDING SECTION
A301 SCALE: 1/2"=1'-0"

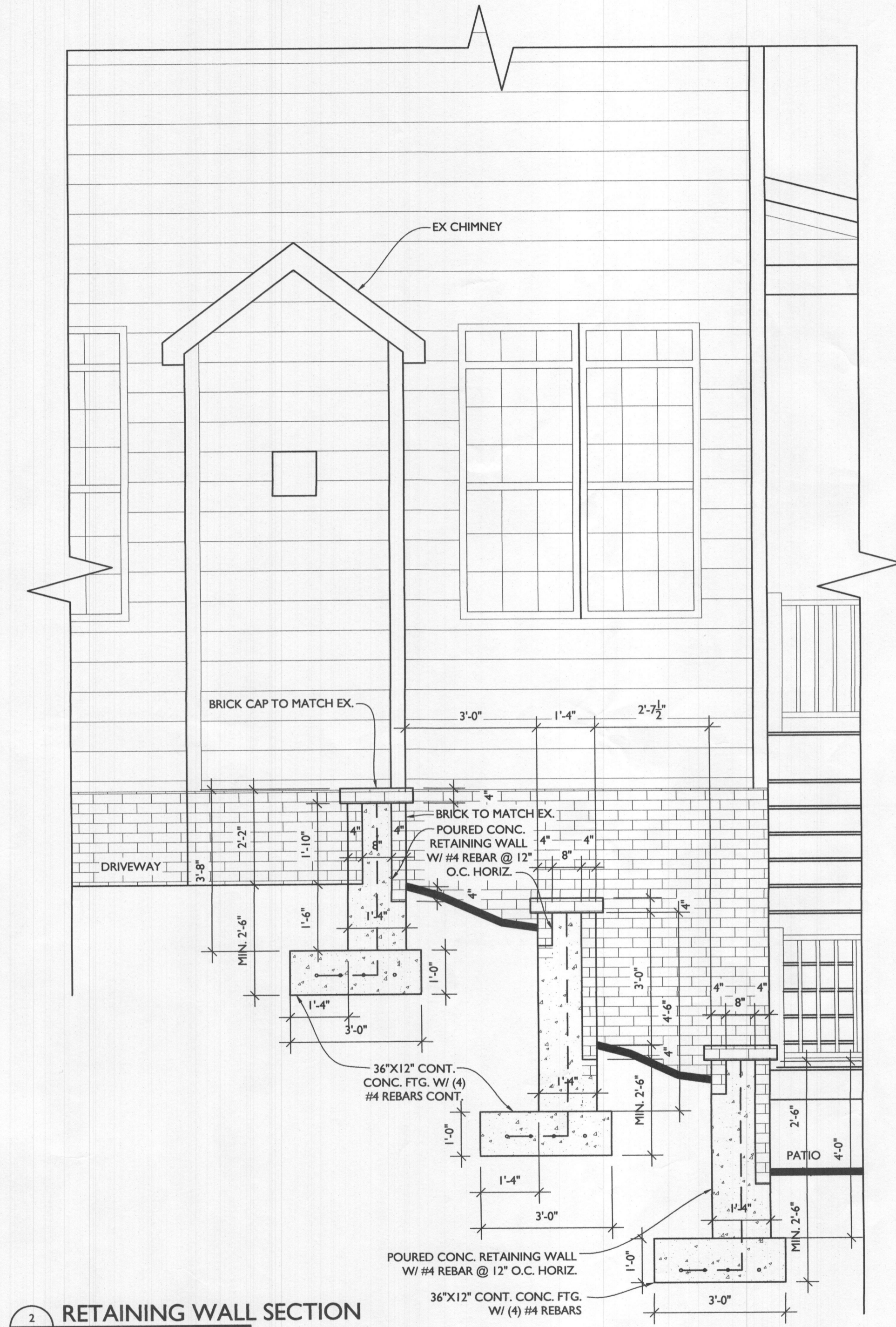

2 RETAINING WALL SECTION
A301 SCALE: 1/2"=1'-0"



7612 Browns Bridge Road
 Highland, MD 20777
 301-776-2666
 301-776-2886 fax
 info@TransformingArchitecture.com
 www.TransformingArchitecture.com

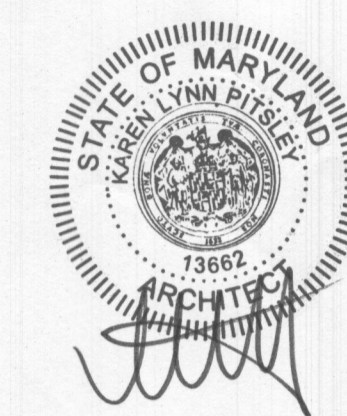

STAMP

I CERTIFY THAT THESE DOCUMENTS WERE PREPARED OR APPROVED BY ME, AND THAT I AM A DULY LICENSED ARCHITECT UNDER THE LAWS OF THE STATE OF MARYLAND, LICENSE NUMBER 13662, EXPIRATION 10-22-2021.

NOTE: THESE DRAWINGS ARE THE PROPERTY OF TRANSFORMING ARCHITECTURE AND, AS SUCH, MAY NOT BE REPRODUCED OR REPRODUCED EITHER WHOLLY OR IN PART, WITHOUT PRIOR WRITTEN CONSENT OF TRANSFORMING ARCHITECTURE.

PROJECT PHASE

PERMIT

PROJECT TITLE

THE REDDY RESIDENCE

5046 Crape Myrtle Court
 Ellicott City, MD 21042

REVISIONS

SYMBOL	DATE	ISSUED FOR

PROJECT NUMBER 19-467

DATE 10/23/2020

SCALE AS NOTED

DRAWING TITLE



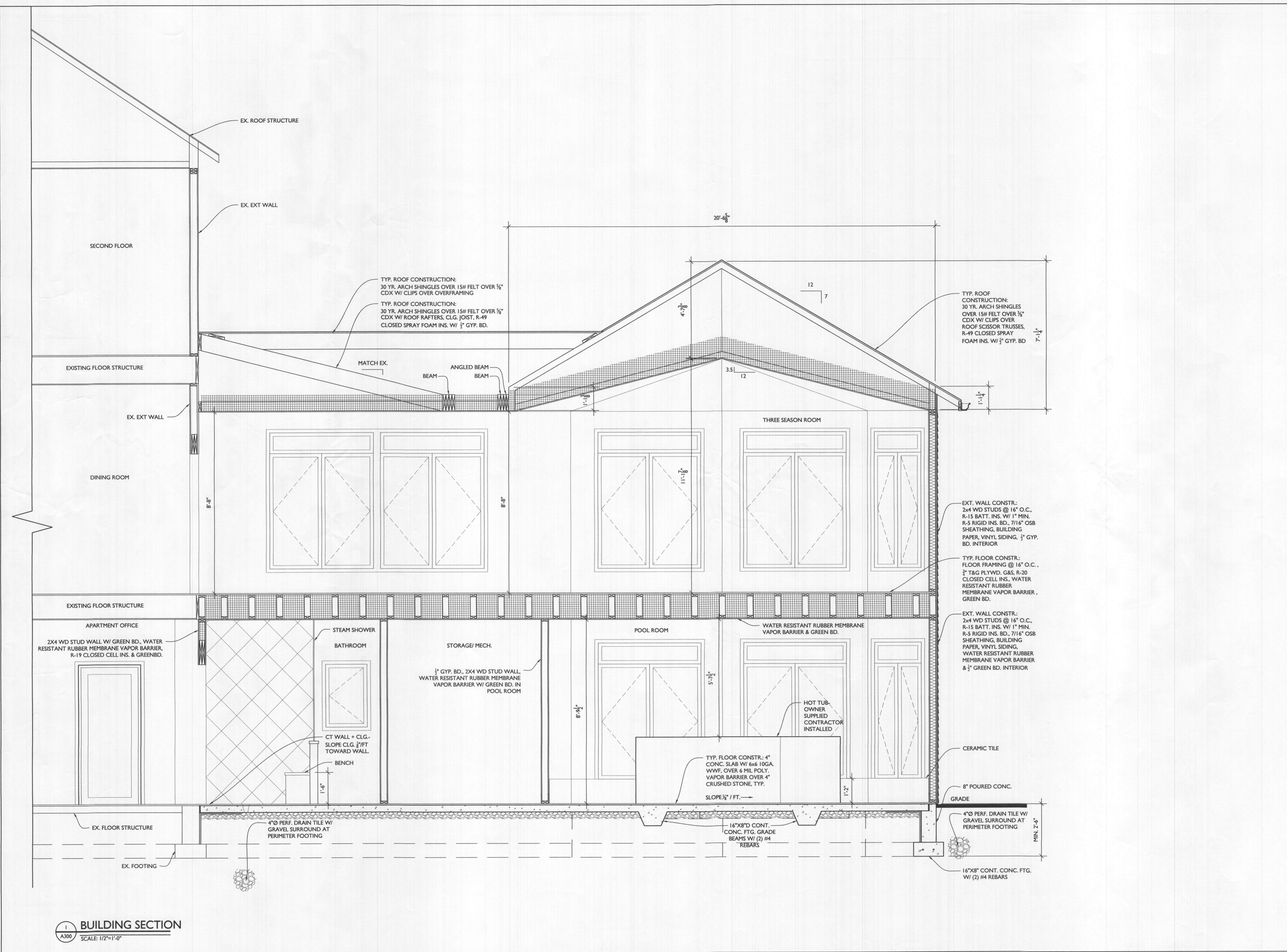

BUILDING SECTION

SHEET NUMBER



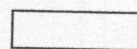
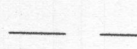







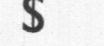
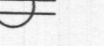

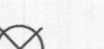

A-300

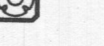

BUILDING SECTION
 A300 SCALE: 1/2"=1'-0"

- LINE TYPE KEY:**
- NEW WALL 
 - EXIST. WALL 
 - ABOVE LINE 
 - FDN. WALL 
 - DEMO WALL 
 - LOAD BEARING WALL 

ELECTRICAL LEGEND

-  SWITCH
-  OUTLET
-  GFI OUTLET
-  RECESSED LED CLG. LIGHT
-  LED WALL MOUNT FIXTURE
-  LED CLG. FIXTURE
-  EXHAUST FAN WITH HUMIDISTAT
-  CLG. FAN W/ LIGHT
-  CABLE TV
-  HARDWIRED SMOKE DETECTOR W/ WINTERAL BATTERY & CARBON MONOXIDE DETECTOR (COMBINED UNIT)
-  SPEAKER
-  HOME RUN ALL SPEAKER WIRES TO THIS LOCATION
-  2-HEAD FLOOD
-  HOSE BIB
-  LED UNDER LEDGE STEP LIGHTING

ELECTRICAL NOTES:

1. OUTLETS PER CODE UNLESS OTHERWISE NOTED @ 18" H, 42" H ABOVE COUNTERTOPS.
2. MOUNT LIGHT SWITCHES @ 42" H. MAX. ROCKER-TYPE
3. PROVIDE HARD-WIRED SMOKE DETECTORS PER CODE
4. QUIET FANS W/ LIGHT FIXTURES
5. PROVIDE UNDER-CABINET LIGHTING
6. HINGE SWITCHES IN ALL CLOSETS U.N.O
7. ALL FIXTURES ON DIMMERS
8. EXHAUST HOOD TO EXTERIOR
9. PROVIDE POST LIGHTING ON DECK
10. EXTEND SPRINKLER SYSTEM
11. DEHUMIDIFIER SYSTEM

PLUMBING NOTES:

1. EXTEND SPRINKLER SYSTEM PER CODE
2. CONNECT ALL POOL EQUIPMENT & HOT TUB PER MANUF. SPECS

HVAC NOTES:

1. HVAC SYSTEM DESIGNED FOR HUMIDITY CONTROL OF POOL. SUBMIT TO ARCHITECT FOR APPROVAL.



7612 Browns Bridge Road
Highland, MD 20777
301-776-2666
301-776-2886 fax
info@TransformingArchitecture.com
www.TransformingArchitecture.com

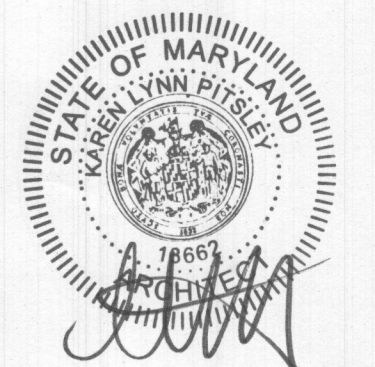

STAMP

I CERTIFY THAT THESE DOCUMENTS WERE PREPARED OR APPROVED BY ME, AND THAT I AM A DULY LICENSED ARCHITECT UNDER THE LAWS OF THE STATE OF MARYLAND, LICENSE NUMBER 13662, EXPIRATION 10-22-2021.

NOTE: THESE DRAWINGS ARE THE PROPERTY OF TRANSFORMING ARCHITECTURE AND, AS SUCH, MAY NOT BE RE-USED OR REPRODUCED, EITHER WHOLLY OR IN PART, WITHOUT PRIOR WRITTEN CONSENT OF TRANSFORMING ARCHITECTURE.

PROJECT PHASE

PERMIT

PROJECT TITLE

THE REDDY RESIDENCE

5046 Crape Myrtle Court
Ellicott City, MD 21042

REVISIONS

SYMBOL	DATE	ISSUED FOR

PROJECT NUMBER 19-467

DATE 10/23/2020

SCALE AS NOTED

DRAWING TITLE

ELEC. LAYOUTS

SHEET NUMBER

E-100

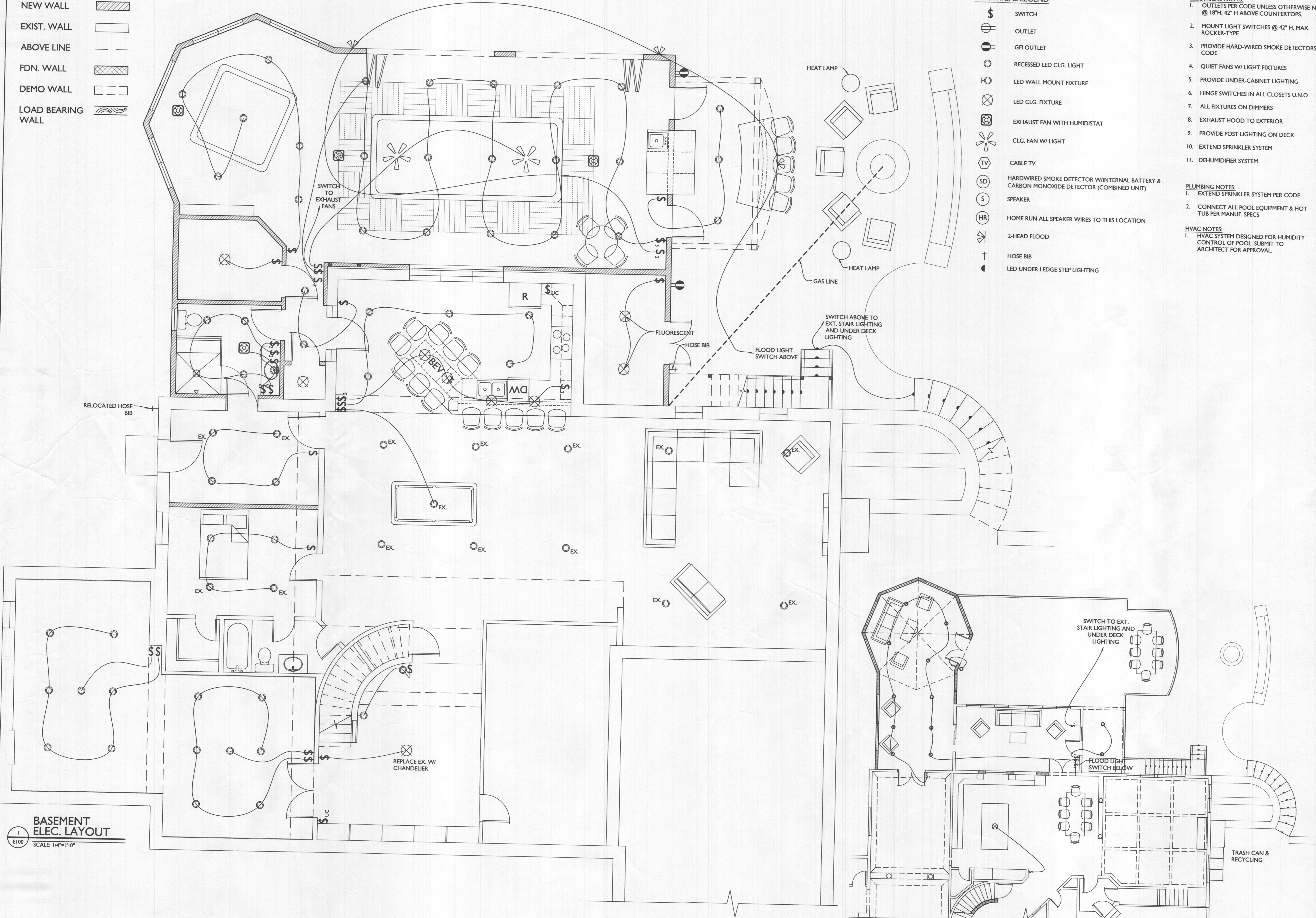

BASEMENT ELEC. LAYOUT
E100 SCALE: 1/4"=1'-0"

FIRST FLOOR ELEC. LAYOUT
E100 SCALE: 1/8"=1'-0"