

- LINE TYPE KEY:
- NEW WALL
 - EXIST. WALL
 - ABOVE LINE
 - FDN. WALL
 - DEMO WALL

TRANSFORMING ARCHITECTURE
• ELUSION DESIGN • FEAT. FLEX •

7612 Browns Bridge Road
 Highland, MD 20777
 301-776-2666
 301-776-2886 fax
 info@TransformingArchitecture.com
 www.TransformingArchitecture.com

STAMP

I CERTIFY THAT THESE DOCUMENTS WERE PREPARED OR APPROVED BY ME, AND THAT I AM A DULY LICENSED ARCHITECT UNDER THE LAWS OF THE STATE OF MARYLAND, LICENSE NUMBER 13662, EXPIRATION 10-22-2021.

NOTE: THESE DRAWINGS ARE THE PROPERTY OF TRANSFORMING ARCHITECTURE AND, AS SUCH, MAY NOT BE RE-USED OR REPRODUCED, EITHER WHOLLY OR IN PART, WITHOUT PRIOR WRITTEN CONSENT OF TRANSFORMING ARCHITECTURE.

PROJECT PHASE
PERMIT

PROJECT TITLE
THE REDDY RESIDENCE

5046 Crape Myrtle Court
 Ellicott City, MD 21042

REVISIONS

SYMBOL	DATE	ISSUED FOR

PROJECT NUMBER 19-467
 DATE 10/23/2020
 SCALE AS NOTED

DRAWING TITLE
BASEMENT FLOOR PLAN

SHEET NUMBER
A-101

BASEMENT PLAN
 A101 SCALE: 1/4"=1'-0"

- LINE TYPE KEY:
- NEW WALL
 - EXIST. WALL
 - ABOVE LINE
 - FDN. WALL
 - DEMO WALL
 - LOAD BEARING WALL



7612 Browns Bridge Road
 Highland, MD 20777
 301-776-2666
 301-776-2886 fax
 info@TransformingArchitecture.com
 www.TransformingArchitecture.com

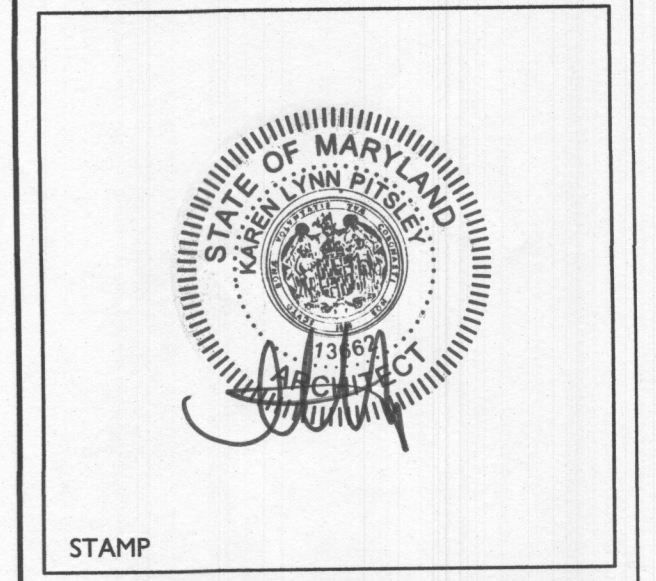

I CERTIFY THAT THESE DOCUMENTS WERE PREPARED OR APPROVED BY ME, AND THAT I AM A DULY LICENSED ARCHITECT UNDER THE LAWS OF THE STATE OF MARYLAND, LICENSE NUMBER 13662, EXPIRATION 10-22-2021.

NOTE: THESE DRAWINGS ARE THE PROPERTY OF TRANSFORMING ARCHITECTURE AND, AS SUCH, MAY NOT BE RE-USED OR REPRODUCED, EITHER WHOLLY OR IN PART, WITHOUT PRIOR WRITTEN CONSENT OF TRANSFORMING ARCHITECTURE.

PROJECT PHASE
PERMIT

PROJECT TITLE
THE REDDY RESIDENCE
 5046 Crape Myrtle Court
 Ellicott City, MD 21042

REVISIONS

SYMBOL	DATE	ISSUED FOR

PROJECT NUMBER 19-467
 DATE 10/23/2020
 SCALE AS NOTED

DRAWING TITLE
FIRST FLOOR PLAN

SHEET NUMBER
A-102

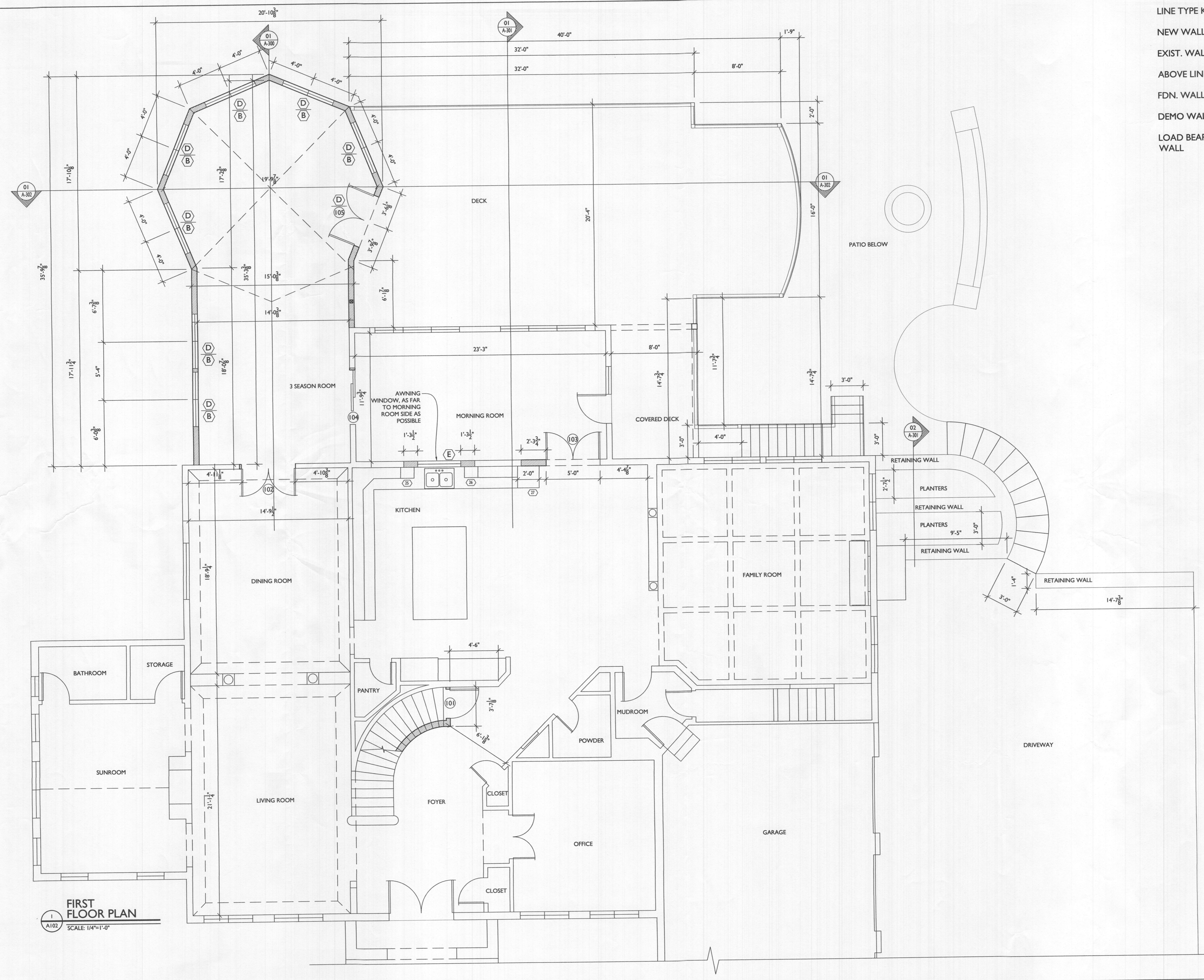

FIRST FLOOR PLAN
 SCALE: 1/4"=1'-0"



1 SIDE ELEVATION
A200 SCALE: 1/4"=1'-0"



2 SIDE ELEVATION
A200 SCALE: 1/4"=1'-0"



7612 Browns Bridge Road
Highland, MD 20777
301-776-2666
301-776-2886 fax
info@TransformingArchitecture.com
www.TransformingArchitecture.com



STAMP
I CERTIFY THAT THESE DOCUMENTS WERE PREPARED OR APPROVED BY ME, AND THAT I AM A DULY LICENSED ARCHITECT UNDER THE LAWS OF THE STATE OF MARYLAND, LICENSE NUMBER 13662, EXPIRATION 10-22-2021.

NOTE: THESE DRAWINGS ARE THE PROPERTY OF TRANSFORMING ARCHITECTURE AND, AS SUCH, MAY NOT BE RE-USED OR REPRODUCED, EITHER WHOLLY OR IN PART, WITHOUT PRIOR WRITTEN CONSENT OF TRANSFORMING ARCHITECTURE.

PROJECT PHASE
PERMIT

PROJECT TITLE
THE REDDY RESIDENCE
5046 Crape Myrtle Court
Ellicott City, MD 21042

REVISIONS		
SYMBOL	DATE	ISSUED FOR

PROJECT NUMBER 19-467
DATE 10/23/2020
SCALE AS NOTED

DRAWING TITLE
EXTERIOR + ELEVATIONS

SHEET NUMBER
A-200