



Building Permit Application

Howard County Maryland
Department of Inspections, Licenses and Permits
3430 Court House Drive
Permits: 410-313-2455
www.howardcountymd.gov

Date Received: _____

Permit No.: _____

Building Address: 13787 Frederick Road
 City: West Friendship State: MD Zip Code: 21794
 Suite/Apt. # _____ SDP/WP/BA #: _____
 Subdivision: Rentfro Property
 Lot: _____ Tax Map: _____ Parcel: _____

Existing Use: Single family house
 Proposed Use: _____
 Estimated Construction Cost: \$ _____

Description of Work: add wood frame deck at rear of house with steps 8'x11' and 30'x16 with steps

Occupant/Tenant Name: _____
 Was tenant space previously occupied? Yes No
 Contact Name: _____
 Address: _____
 City: _____ State: _____ Zip Code: _____
 Phone: _____ Fax: _____
 Email: _____

Property Owner's Name: Taylor Paris
 Address: 13787 Frederick Road
 City: West Friendship State: MD Zip Code: 21794
 Phone: 443-864-3479 Fax: _____
 Email: tparis@NVAIAC.com

Applicant's Name & Mailing Address, (If other than stated herein)
 Applicant's Name: Decatur Building Services
 Address: PO. box 552
 City: Woodbine State: MD Zip Code: 21797
 Phone: 443-309-7792 Fax: _____
 Email: Jim@DecaturBuildingServices.com

Contractor Company: Homeowner
 Contact Person: Taylor Paris
 Address: 13787 Frederick Road
 City: West Friendship State: MD Zip Code: 21794
 License No.: Homeowner
 Phone: _____ Fax: _____
 Email: tparis@NVAIAC.com

Engineer/Architect Company: _____
 Responsible Design Prof.: _____
 Address: _____
 City: _____ State: _____ Zip Code: _____
 Phone: _____ Fax: _____
 Email: _____

Commercial Building Characteristics	Residential Building Characteristics	
Height:	<input type="checkbox"/> SF Dwelling <input type="checkbox"/> SF Townhouse	
No. of stories:	Depth	Width
Gross area, sq. ft./floor:	1 st floor:	
	2 nd floor:	
Area of construction (sq. ft.):	Basement:	
	<input type="checkbox"/> Finished Basement	
Use group:	<input type="checkbox"/> Unfinished Basement	
	<input type="checkbox"/> Crawl Space	
Construction type:	<input type="checkbox"/> Slab on Grade	
<input type="checkbox"/> Reinforced Concrete	No. of Bedrooms:	
<input type="checkbox"/> Structural Steel	Multi-family Dwelling	
<input type="checkbox"/> Masonry	No. of efficiency units:	
<input type="checkbox"/> Wood Frame	No. of 1 BR units:	
<input type="checkbox"/> State Certified Modular	No. of 2 BR units:	
	No. of 3 BR units:	
	Other Structure:	
	Dimensions:	
Roadside Tree Project Permit	Footings:	
<input type="checkbox"/> Yes <input type="checkbox"/> No	Roof:	
Roadside Tree Project Permit #	<input type="checkbox"/> State Certified Modular	
	<input type="checkbox"/> Manufactured Home	

Utilities	
Electric:	<input type="checkbox"/> Yes <input type="checkbox"/> No
Gas:	<input type="checkbox"/> Yes <input type="checkbox"/> No
Water Supply	
<input type="checkbox"/> Public	
<input checked="" type="checkbox"/> Private	
Sewage Disposal	
<input type="checkbox"/> Public	
<input checked="" type="checkbox"/> Private	
Heating System	
<input type="checkbox"/> Electric	<input type="checkbox"/> Oil
<input type="checkbox"/> Natural Gas	<input type="checkbox"/> Propane Gas
<input type="checkbox"/> Other:	
Sprinkler System:	
<input type="checkbox"/> Yes	<input type="checkbox"/> No
Grading Permit Number:	
Building Shell Permit Number:	

THE UNDERSIGNED HEREBY CERTIFIES AND AGREES AS FOLLOWS: (1) THAT HE/SHE IS AUTHORIZED TO MAKE THIS APPLICATION; (2) THAT THE INFORMATION IS CORRECT; (3) THAT HE/SHE WILL COMPLY WITH ALL REGULATIONS OF HOWARD COUNTY WHICH ARE APPLICABLE THERETO; (4) THAT HE/SHE WILL PERFORM NO WORK ON THE ABOVE REFERENCED PROPERTY NOT SPECIFICALLY DESCRIBED IN THIS APPLICATION; (5) THAT HE/SHE GRANTS COUNTY OFFICIALS THE RIGHT TO ENTER ONTO THIS PROPERTY FOR THE PURPOSE OF INSPECTING THE WORK PERMITTED AND POSTING NOTICES.

Jim Decatur
 Applicant's Signature
Jim@DecaturBuildingServices.com
 Email Address
Agent.
 Title/Company

Jim Kerwin
 Print Name

 Date

Checks Payable to: DIRECTOR OF FINANCE OF HOWARD COUNTY
 PLEASE WRITE NEATLY & LEGIBLY
 -FOR OFFICE USE ONLY-

AGENCY	DATE	SIGNATURE OF APPROVAL
State Highways		
Building Officials		
PSZA (Zoning)		
PSZA (Engineering)		
Health	<u>4/5/19</u>	<u>[Signature]</u>

Is Sediment Control approval required for issuance? Yes No
 CONTINGENCY CONSTRUCTION START

DPZ SETBACK INFORMATION
Front:
Rear:
Side:
Side St.:
All minimum setbacks met? <input type="checkbox"/> Yes <input type="checkbox"/> No
Is Entrance Permit Required? <input type="checkbox"/> Yes <input type="checkbox"/> No
Historic District? <input type="checkbox"/> Yes <input type="checkbox"/> No
Lot Coverage for New Town Zone:
SDP/Red-line approval date:

Filing Fee	\$
Permit Fee	\$
Tech Fee	\$
Excise Tax	\$
PSFS	\$
Guaranty Fund	\$
Add'l per Fee	\$
Total Fees	\$
Sub- Total Paid	\$
Balance Due	\$
Check	#

Distribution of Copies: White: Building Officials Green: PSZA,Zoning Yellow: PSZA,Engineering Pink: Health Gold: SHA

BUILDING PERMIT PLAN NOTES:

1. THE LOT SHOWN HEREON WAS RECORDED ON THE PLAT FOR RENFRO PROPERTY, PLAT Nos. 22465-22466. REFER TO THE PLATS FOR LOT DIMENSIONS, LOT AREAS, ALL EASEMENTS AND CONDITIONS.
2. SEDIMENT AND EROSION CONTROLS WERE APPROVED BY HOWARD SOIL CONSERVATION
3. TOPOGRAPHY SHOWN HEREON IS TAKEN FROM THE APPROVED ROAD CONSTRUCTION PLANS AND TOPOGRAPHIC INFORMATION PROVIDED BY F-13-040, ON OR ABOUT FEBRUARY, 2013. ALL SEDIMENT AND EROSION CONTROL FEATURES USED ON THIS SITE SHALL COMPLY WITH THE 2011 MARYLAND STANDARDS AND SPECIFICATIONS FOR SOIL EROSION AND SEDIMENT CONTROL.
4. ALL DRAINAGE AND STORMWATER MANAGEMENT FEATURES USED ON THIS SITE MUST COMPLY WITH THE APPROVED SUPPLEMENTAL CONSTRUCTION PLANS EXCEPT AS WAIVED OR REDESIGNED.
5. THE EXISTING WELL SHOWN ON THIS PLAN, HO-95-2480, WILL BE FIELD LOCATED BY BENCHMARK ENGINEERING, INC. PRIOR TO BUILDING PERMIT ISSUANCE.
6. THERE ARE NO EXISTING WELLS OR SEPTIC SYSTEMS WITHIN 100' OF THIS PROJECT'S BOUNDARY EXCEPT AS NOTED.
7. ANY CHANGES TO A PRIVATE SEWAGE DISPOSAL AREA OR WELL BOX SHALL REQUIRE A REVISED PERCOLATION CERTIFICATION PLAN.
8. STORMWATER MANAGEMENT FOR THIS LOT WAS DESIGNED AND PROVIDED BY TWO MICRO-BIORETENTION FACILITIES. MICRO-BIORETENTION SHALL HAVE EITHER A 4" OR 6" ROOF LEADER DEPENDING ON ROOF-TOP AREA.
9. THE SEPTIC TANK WILL HAVE A 2000 GALLON 2 COMPARTMENT TANK.

WELL: 75' FROM DECK
SEPTIC: 80' FROM DECK

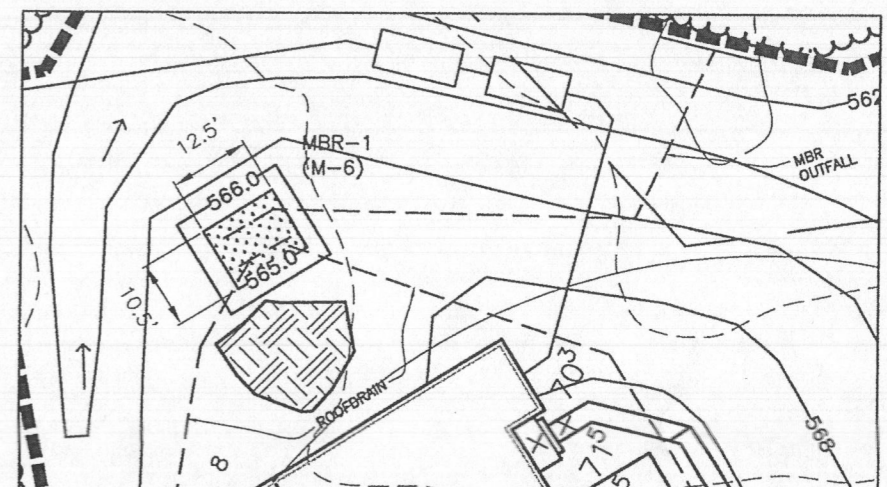

MBR#1 DETAIL
1" = 30'

BUILDER:
TAYLOR FARIS
7233 DARBY DOWNS
ELKRIDGE, MD 21075
443-864-3479

OWNER:
HAROLD E. RENFRO, JR.
MERILYN S. RENFRO
13765 FREDERICK ROAD
WEST FRIENDSHIP, MD 21794
301-854-6782

BENCHMARK
ENGINEERS & LAND SURVEYORS & PLANNERS
ENGINEERING, INC.
8480 BALTIMORE NATIONAL PIKE & SUITE 315
ELLCOTT CITY, MARYLAND 21043
(P) 410-465-6105 & (F) 410-465-6644
WWW.BEI-CIVILENGINEERING.COM

Professional Certification. I hereby certify that these documents were prepared or approved by me, and that I am a duly licensed professional engineer under the laws of the State of Maryland, License No. 45577, Expiration Date: 06-08-2018.

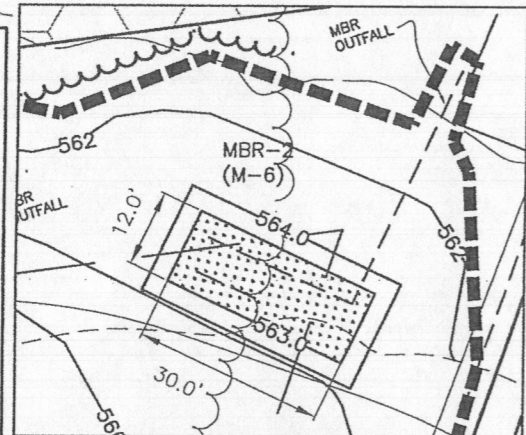
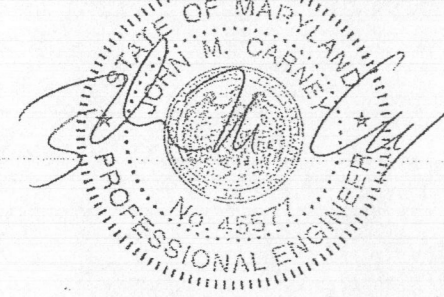

MBR#4 DETAIL
1" = 30'

PLAN VIEW
1" = 60'

NOTE: ELEVATIONS LISTED IN CHART ARE ELEVATIONS AT BOTTOM OF THE SWALE. THIS SWALE DOES NOT PROVIDE STORMWATER MANAGEMENT.

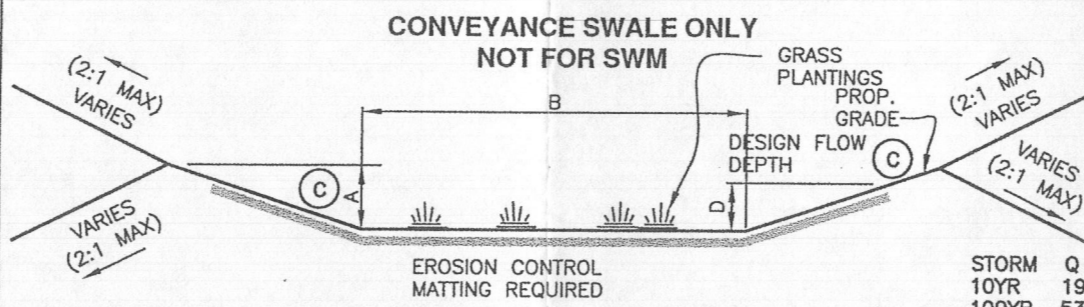

GRASS SWALE TYPICAL SECTION DETAIL

SWALE # 1	
A	2.0'
B	3.0'
C	3:1
D10	0.72'
SLOPE	3.0%
BOTTOM DIMS	
LENGTH	170'
WIDTH	3.0'

	STORM Q (RUNOFF)	VELOCITY
10YR	19.71 CFS	5.31 FPS
100YR	53.38 CFS	6.92 FPS

GRASS SWALE DESIGN TABLE

PROJECT:	RENFRO PROPERTY	
	LOT 1	
LOCATION:	TAX MAP: 15, GRID: 1, PARCEL: 178, ZONED: RC-DEO #13787 FREDERICK ROAD THIRD ELECTION DISTRICT, HOWARD COUNTY, MD TAX ID NUMBER 03-595654	
TITLE:	BUILDING PERMIT PLAN	
HOUSE TYPE:	PARKER	
DATE:	JANUARY, 2018	PROJECT NO. 2876
SCALE:	AS SHOWN	DRAWING 1 OF 2

1/22/18