



HEALTH

Howard County Maryland
 Department of Inspections, Licenses and Permits
 3430 Court House Drive
 Permits: 410-313-2455
 www.howardcountymd.gov

Date received: _____
 Permit No.: **B19003157**

Building Address: 13828 Mill Creek Ct
 City: Clarksville State: MD Zip Code: 21029
 Suite/Apt. #: _____ SDP/WP/BA #: _____
 Subdivision: Crawford Subdivision
 Lot: 5 Tax Map: 34 Parcel: 52

Existing Use: SFD
 Proposed Use: SFD w/ propane TANK
 Estimated Construction Cost: \$ 8000
 Description of Work:
Install wood gallon in-ground propane Tank

Occupant/Tenant Name: _____
 Was tenant-space previously occupied? Yes No
 Contact Name: _____
 Address: owner
 City: _____ State: _____ Zip Code: _____
 Phone: _____ Fax: _____
 Email: _____

Commercial Building Characteristics	Residential Building Characteristics
Height:	<input checked="" type="checkbox"/> SF Dwelling <input type="checkbox"/> SF Townhouse
No. of stories:	Depth Width
Gross area, sq. ft./floor:	1 st floor:
Area of construction (sq. ft.):	2 nd floor:
Use group:	Basement:
	<input type="checkbox"/> Finished Basement
	<input type="checkbox"/> Unfinished Basement
	<input type="checkbox"/> Crawl Space
	<input type="checkbox"/> Slab on Grade
Construction type:	No. of Bedrooms:
<input type="checkbox"/> Reinforced Concrete	Multi-family Dwelling
<input type="checkbox"/> Structural Steel	No. of efficiency units:
<input type="checkbox"/> Masonry	No. of 1 BR units:
<input type="checkbox"/> Wood Frame	No. of 2 BR units:
<input type="checkbox"/> State Certified Modular	No. of 3 BR units:
	Other Structure:
	Dimensions:
<input checked="" type="checkbox"/> Roadside Tree Project Permit	Footings:
<input type="checkbox"/> Yes <input checked="" type="checkbox"/> No	Roof:
Roadside Tree Project Permit #	<input type="checkbox"/> State Certified Modular
	<input type="checkbox"/> Manufactured Home

Property Owner's Name: NUR Inc
 Address: 9720 Patuxent Woods Dr
 City: Columbia State: MD Zip Code: 21046
 Phone: 410-848-5210 Fax: _____
 Email: _____

Applicant's Name & Mailing Address, (If other than stated herein)
 Applicant's Name: Michelle Clancy
 Address: Po Box 310
 City: Perry Hall State: MD Zip Code: 21124
 Phone: 443-610-7514 Fax: _____
 Email: Michelle @ AppliedAndApproved.com

Contractor Company: TECH AIR
 Contact Person: Dennis Feag
 Address: 1560 Ard Caton Center Dr
 City: Baltimore State: MD Zip Code: 21227
 License No.: 81215
 Phone: 410-984-5681 Fax: _____
 Email: _____

Engineer/Architect Company: _____
 Responsible Design Prof.: _____
 Address: Contractor
 City: _____ State: _____ Zip Code: _____
 Phone: _____ Fax: _____
 Email: _____

Utilities	
Electric:	<input type="checkbox"/> Yes <input checked="" type="checkbox"/> No
Gas:	<input checked="" type="checkbox"/> Yes <input type="checkbox"/> No
Water Supply	
<input type="checkbox"/> Public	
<input checked="" type="checkbox"/> Private	
Sewage Disposal	
<input type="checkbox"/> Public	
<input checked="" type="checkbox"/> Private	
Heating System	
<input type="checkbox"/> Electric <input type="checkbox"/> Oil	
<input type="checkbox"/> Natural Gas <input type="checkbox"/> Propane Gas	
<input type="checkbox"/> Other:	
Sprinkler System:	
<input type="checkbox"/> Yes <input checked="" type="checkbox"/> No	
Grading Permit Number:	<u>619000201</u>
Building Shell Permit Number:	<u>B19002638</u>

THE UNDERSIGNED HEREBY CERTIFIES AND AGREES AS FOLLOWS: (1) THAT HE/SHE IS AUTHORIZED TO MAKE THIS APPLICATION; (2) THAT THE INFORMATION IS CORRECT; (3) THAT HE/SHE WILL COMPLY WITH ALL REGULATIONS OF HOWARD COUNTY WHICH ARE APPLICABLE THERETO; (4) THAT HE/SHE WILL PERFORM NO WORK ON THE ABOVE REFERENCED PROPERTY NOT SPECIFICALLY DESCRIBED IN THE APPLICATION; (5) THAT HE/SHE GRANTS COUNTY OFFICIALS THE RIGHT TO ENTER ONTO THIS PROPERTY FOR THE PURPOSE OF INSPECTING THE WORK PERMITTED AND POSTING NOTICES.

Applicant's Signature: Michelle Clancy
 Email Address: Michelle @ AppliedAndApproved.com
 Title/Company: Permits

Print Name: Michelle Clancy
 Date: 9/18/19

RECEIVED
 SEP 18 2019
 LICENSES & PERMITS DIVISION

Checks Payable to: DIRECTOR OF FINANCE OF HOWARD COUNTY

PLEASE WRITE NEATLY & LEGIBLY
FOR OFFICE USE ONLY

AGENCY	DATE	SIGNATURE OF APPROVAL
State Highways		
Building Officials		
PSZA (Zoning)		
PSZA (Engineering)		
Health	<u>9/27/19</u>	<u>[Signature]</u>

Is Sediment Control approval required for issuance? Yes No
 CONTINGENCY CONSTRUCTION START

DPZ SETBACK INFORMATION
Front:
Rear:
Side:
Side St.:
All minimum setbacks met? <input type="checkbox"/> Yes <input type="checkbox"/> No
Is Entrance Permit Required? <input type="checkbox"/> Yes <input type="checkbox"/> No
Historic District? <input type="checkbox"/> Yes <input type="checkbox"/> No
Lot Coverage for New Town Zone:
SDP/Red-line approval date:

Filing Fee	\$
Permit Fee	\$ <u>100</u>
Tech Fee	\$ <u>18</u>
Excise Tax	\$
PSFS	\$
Guaranty Fund	\$
Add'l per Fee	\$
Total Fees	\$ <u>110.00</u>
Sub- Total Paid	\$
Balance Due	\$
Check	# <u>7308</u>

Distribution of Copies: White: Building Officials Green: PSZA,Zoning Yellow: PSZA,Engineering Pink: Health Gold: SHA

AK



Building Permit Application

Howard County Maryland
Department of Inspections, Licenses and Permits
3430 Court House Drive
Permits: 410-313-2455
www.howardcountymd.gov

Date Received: 8/9/19

Permit No.: B19002638

Building Address: 13928 Mill Creek Court
 City: Clarksville State: MD Zip Code: 21029
 Suite/Apt. # _____ WP/BA #: GP 20-009
 Subdivision: Mill Creek
 Lot: 5 Tax Map: _____ Parcel: _____

Existing Use: Vacant lot
 Proposed Use: Single Family home
 Estimated Construction Cost: \$ 230,000

Description of Work: New 2 story "longwood" EW 'L', with 2 car garage, 1 car side attached garage, and finished lower level (Rear, Bedroom, Bathroom + wet bar)

Occupant/Tenant Name: _____
 Was tenant space previously occupied? Yes No
 Contact Name: _____
 Address: _____
 City: _____ State: _____ Zip Code: _____
 Phone: _____ Fax: _____
 Email: _____

Property Owner's Name: NVR Inc.
 Address: 9720 Patuxent Woods Dr
 City: Columbia State: MD Zip Code: 21046
 Phone: 410-379-5956 Fax: _____
 Email: _____

Applicant's Name & Mailing Address, (if other than stated herein)
 Applicant's Name: Decatur Building Services
 Address: PO Box 552
 City: Woodbine State: MD Zip Code: 21797
 Phone: 443-309-7792 Fax: _____
 Email: jin@decaturbuilding.com

Contractor Company: NV Homes
 Contact Person: Clint Cagle
 Address: 9720 Patuxent Woods Dr
 City: Columbia State: MD Zip Code: 21046
 License No.: 56
 Phone: 410-379-5956 Fax: _____
 Email: ccagle@nvrinc.com

Engineer/Architect Company: _____
 Responsible Design Prof.: _____
 Address: _____
 City: _____ State: _____ Zip Code: _____
 Phone: _____ Fax: _____
 Email: _____

Commercial Building Characteristics	Residential Building Characteristics
Height: _____	<input checked="" type="checkbox"/> SF Dwelling <input type="checkbox"/> SF Townhouse
No. of stories: _____	Depth Width
Gross area, sq. ft./floor: _____	1st floor: <u>47</u> x <u>64</u>
Area of construction (sq. ft.): _____	2nd floor: <u>41</u> x <u>50</u>
Use group: _____	Basement: <u>47</u> x <u>64</u>
<u>Construction type:</u>	<input checked="" type="checkbox"/> Finished Basement
<input type="checkbox"/> Reinforced Concrete	<input type="checkbox"/> Unfinished Basement
<input type="checkbox"/> Structural Steel	<input type="checkbox"/> Crawl Space
<input type="checkbox"/> Masonry	<input type="checkbox"/> Slab on Grade
<input type="checkbox"/> Wood Frame	No. of Bedrooms: <u>5</u>
<input type="checkbox"/> State Certified Modular	<u>Multi-family Dwelling</u>
<input checked="" type="checkbox"/> Roadside Tree Project Permit	No. of efficiency units: _____
<input type="checkbox"/> Yes <input checked="" type="checkbox"/> No	No. of 1 BR units: _____
Roadside Tree Project Permit # _____	No. of 2 BR units: _____
	No. of 3 BR units: _____
	Other Structure: _____
	Dimensions: _____
	Footings: _____
	Roof: _____
	<input type="checkbox"/> State Certified Modular
	<input type="checkbox"/> Manufactured Home

Utilities	
Electric:	<input checked="" type="checkbox"/> Yes <input type="checkbox"/> No
Gas:	<input checked="" type="checkbox"/> Yes <input type="checkbox"/> No
Water Supply	
<input type="checkbox"/> Public	
<input checked="" type="checkbox"/> Private	
Sewage Disposal	
<input type="checkbox"/> Public	
<input checked="" type="checkbox"/> Private	
Heating System	
<input type="checkbox"/> Electric	<input type="checkbox"/> Oil
<input type="checkbox"/> Natural Gas	<input type="checkbox"/> Propane Gas
<input type="checkbox"/> Other: _____	
Sprinkler System:	
<input checked="" type="checkbox"/> Yes	<input type="checkbox"/> No
Grading Permit Number: _____	
Building Shell Permit Number: _____	

THE UNDERSIGNED HEREBY CERTIFIES AND AGREES AS FOLLOWS: (1) THAT HE/SHE IS AUTHORIZED TO MAKE THIS APPLICATION; (2) THAT THE INFORMATION IS CORRECT; (3) THAT HE/SHE WILL COMPLY WITH ALL REGULATIONS OF HOWARD COUNTY WHICH ARE APPLICABLE THERETO; (4) THAT HE/SHE WILL PERFORM NO WORK ON THE ABOVE REFERENCED PROPERTY NOT SPECIFICALLY DESCRIBED IN THIS APPLICATION; (5) THAT HE/SHE GRANTS COUNTY OFFICIALS THE RIGHT TO ENTER ONTO THIS PROPERTY FOR THE PURPOSE OF INSPECTING THE WORK PERMITTED AND POSTING NOTICES.

Applicant's Signature: Jim Kerwin Print Name: Jim Kerwin
 Email Address: jin@decaturbuilding.com Date: 8/9/2019
 Title/Company: Agent/NV Homes

RECEIVED
AUG 09 2019

Checks Payable to: DIRECTOR OF FINANCE OF HOWARD COUNTY
PLEASE WRITE NEATLY & LEGIBLY
-FOR OFFICE USE ONLY-

AGENCY	DATE	SIGNATURE OF APPROVAL
State Highways		
Building Officials		
PSZA (Zoning)		
PSZA (Engineering)		
Health	<u>8/29/19</u>	<u>Bernard</u>
Is Sediment Control approval required for issuance? <input type="checkbox"/> Yes <input type="checkbox"/> No		
<input type="checkbox"/> CONTINGENCY CONSTRUCTION START		

DPZ SETBACK INFORMATION	
Front:	
Rear:	
Side:	
Side St.:	
All minimum setbacks met?	<input type="checkbox"/> Yes <input type="checkbox"/> No
Is Entrance Permit Required?	<input type="checkbox"/> Yes <input type="checkbox"/> No
Historic District?	<input type="checkbox"/> Yes <input type="checkbox"/> No
Lot Coverage for New Town Zone:	
SDP/Red-line approval date:	

Filing Fee	\$ <u>100</u>
Permit Fee	\$
Tech Fee	\$
Excise Tax	\$
PSFS	\$
Guaranty Fund	\$ <u>50</u>
Add'l per Fee	\$
Total Fees	\$
Sub- Total Paid	\$
Balance Due	\$
Check	# <u>271477</u>

13828 Mill Creek Court
Lot 5

LONGWOOD

Health Dept

B19002638



NVR, Inc.
5285 Westview Drive, Suite 100
Frederick, MD 21703

STANDARD DETAILS	FULL BASEMENT		STANDARD DETAILS
	QTY	SYMBOL	
AD-1			
DR-1			
DR-2			
DR-3			
ET-1			
ET-1b			
ET-1c			
ET-1e			
ET-1f			
ET-1h			
ET-2			
ET-3			
ET-3b			
F-1			
FC-1			
FC-2			
FC-4			
FD-1			
FD-2			
FD-2b			
FD-3			
FP-1			
FP-1b			
GB-1			
IT-1			
IT-1b			
IT-1c			
IT-2			
JT-1			
JT-3			
JT-3b			
KT-1			
RF-1			
RF-1b			
SEP-1			
SEP-2			
SEP-3			
SEP-4			
SP-1			
SP-2			
SP-3			
ST-1			
ST-2			
ST-3b			
MB-1			
MB-2			
MD-1			
MD-2			
MD-3			
MS-1			

FIRST FLOOR SQUARE FOOTAGE	
DESCRIPTION	TOTAL SQ. FT.
1ST FLOOR (BASE SF)	1654 SF
1ST FLOOR ELEV. "L" OR "R" (ADD SF)	20 SF
	1682 SF

SECOND FLOOR SQUARE FOOTAGE	
DESCRIPTION	TOTAL SQ. FT.
2ND FLOOR (BASE SF)	1661 SF
2ND FLOOR ELEV. "L" (ADD. SF)	20 SF
2ND FLOOR ELEV. "L" AT OWNERS BEDROOM (ADD. SF)	20 SF
	1901 SF

GARAGE SQUARE FOOTAGE	
DESCRIPTION	TOTAL SQ. FT.
GARAGE	460 SF
ONE CAR SIDE ATTACHED GARAGE	324 SF
	784 SF

BASEMENT SQUARE FOOTAGE	
DESCRIPTION	TOTAL SQ. FT.
FINISHED BASEMENT	NA SF
FINISHED BASEMENT AREA 2 (ADD. SF)	323 SF
	323 SF

UNFINISHED SQUARE FOOTAGE	
DESCRIPTION	TOTAL SQ. FT.
MECHANICAL	242 SF
UNFINISHED BASEMENT ELEV. "L" OR "R" (ADD. SF)	24 SF
	210 SF

TOTAL FINISHED SQUARE FOOTAGE	
DESCRIPTION	TOTAL SQ. FT.
1ST FLOOR (BASE SF)	1654 SF
1ST FLOOR ELEV. "L" OR "R" (ADD SF)	20 SF
2ND FLOOR (BASE SF)	1661 SF
2ND FLOOR ELEV. "L" (ADD. SF)	20 SF
2ND FLOOR ELEV. "L" AT OWNERS BEDROOM (ADD. SF)	20 SF
	3594 SF

SET - VERSION
14000 - 01

CS-1

C:\NVR\Projects\LONGWOOD_14000_01\MOE-MC-0005\131362\Sheet\Lot_Spec\16_CS-1_COVERSHEET.dwg 07/19/19 - 7:51 am

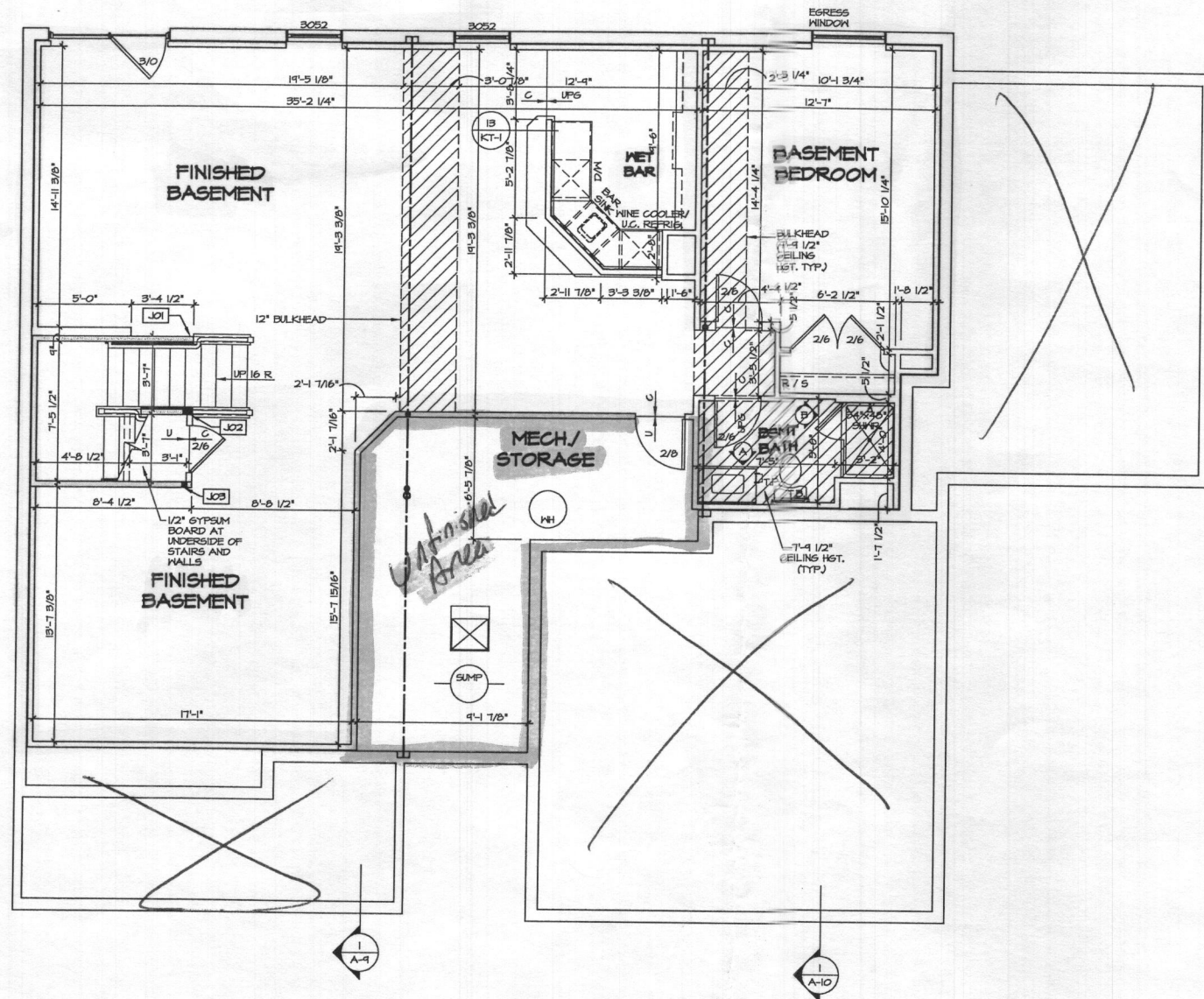

- FLOOR PLAN NOTES**
1. ALL HEADERS ARE (2) 2x6 W/ 2x4 WALLS OR (3) 2x6 W/ 2x6 WALLS, UNLESS OTHERWISE NOTED.
 2. ALL HEADERS TO HAVE (1) 2x4 OR 2x6 JACK EACH END, UNLESS OTHERWISE NOTED.
 3. ALL EXTERIOR WALLS TO BE 4" AND ALL INTERIOR WALLS TO BE 3 1/2", UNLESS OTHERWISE NOTED.
 4. HATCHED AREAS INDICATE DROPPED CEILINGS. ALL DROPPED CEILINGS ARE 12" UNLESS OTHERWISE NOTED.
 5. SEE BRACED WALL PANEL DETAIL SHEET FOR SPECIAL WALL FRAMING LOCATIONS AND HEADER SIZES, IF APPLICABLE.
 6. SEE STANDARD DETAIL CATEGORY "IT" SHEET(S) FOR INTERIOR TRIM DETAILS.
 7. SEE ARCHITECTURAL DETAIL SHEET "AD" FOR HOUSE SPECIFIC INTERIOR TRIM OPTION TABLE.
 8. ALL WINDOWS HAVE 7'-0 1/2" HEADER HEIGHT UNLESS OTHERWISE NOTED.
 9. ALL CASED OPENINGS AT 7'-11", UNLESS OTHERWISE NOTED.

- GYPSUM NOTES**
- AT GARAGE:
5/8" DRYMALL ON COMMON WALLS, CEILING, AND BEARING WALLS AS REQUIRED.
- AT STAIRS:
1/2" GYPSUM BOARD AT UNDERSIDE OF STAIRS AND WALLS IN CLOSET.
- WITH OPTION "SG1" - DRYMALL UNFINISHED BASEMENT CEILING AREA.

- NOTES:**
- 1/2" GYPSUM WALL BOARD REQUIRED ON CEILING IN UNFINISHED AREAS WHEN NO SPRINKLER SYSTEM IS INSTALLED.
 - A MAXIMUM AREA OF 80 SQ FT MAY BE OMITTED AS NEEDED FOR INSTALLATION OF PLUMBING, ELECTRICAL, AND/OR HVAC (TYPICALLY AN 8'-0"x8'-0" CEILING SPACE ABOVE MECHANICAL AREA).
 - PROVIDE FIRE BLOCKING AS REQUIRED AT PERIMETER OF ANY AREAS WHERE DRYMALL HAS BEEN OMITTED.

LEGEND

- BEARING WALL
- NON BEARING WALL
- INDICATES BEARING FROM POINT-LOAD ABOVE
- JACKS
- BEAM/HEADER
- PAD FOOTING
- STEEL COLUMN
- PORTAL FRAME
- JOIST/TRUSS
- LVL
- ENGINEERING PAGE NUMBER

SEE FC DETAILS FOR FRAMING CONNECTORS

BASEMENT JACK SCHEDULE

IDENTIFIER	DESCRIPTION	OPTIONS	ENG. NUM.	REMARKS
J01	JACK - (2) 2X4 SFF STUD GRADE	MAG	BO020	
J02	JACK - (4) 2X4 SFF STUD GRADE	MAG	BO016, BO018	
J03	JACK - (2) 2X4 SFF STUD GRADE	MAG	BO016	

1
A-6
SCALE: 1/4" = 1'-0"

BASEMENT FLOOR PLAN

REMARKS

REV. NO. DATE

© NVR, Inc. expressly reserves the right to make changes to these plans at any time without notice. These plans are not to be reproduced, changed, or otherwise used in any way without the written consent of NVR, Inc.

NVR
NVR, Inc. Suite 100
5285 Westport Road
Frederick, MD 21703

SET NO. 14000
VERSION 01
DRAWN BY NG3
DATE:
OPTION

MODEL: **LONGWOOD**
DRAWING TITLE: **BASEMENT FLOOR PLAN**
OPTION DESCRIPTION

SHEET NO. **A-6**

22

CA:\NVR\Software\LONGWOOD-14000-01A.MD-MC-0005\1313647\Sheet\A-6-BSMT-LS.dwg 07/19/19 - 7:51 am

ALL WINDOWS HAVE 8'-0" 1/2" HEADER HEIGHT UNLESS OTHERWISE NOTED.

FLOOR PLAN NOTES

- ALL HEADERS ARE (2) 2x6 w/ 2x4 WALLS OR (3) 2x6 w/ 2x6 WALLS, UNLESS OTHERWISE NOTED.
- ALL HEADERS TO HAVE (1) 2x4 OR 2x6 JACK EACH END, UNLESS OTHERWISE NOTED.
- ALL EXTERIOR WALLS TO BE 4" AND ALL INTERIOR WALLS TO BE 3 1/2" UNLESS OTHERWISE NOTED.
- HATCHED AREAS INDICATE DROPPED CEILINGS. ALL DROPPED CEILINGS ARE 12" UNLESS OTHERWISE NOTED.
- SEE "BRACED WALL PANEL DETAIL SHEET" FOR SPECIAL WALL FRAMING LOCATIONS AND HEADER SIZES, IF APPLICABLE.
- SEE STANDARD DETAIL CATEGORY "IT" SHEET(S) FOR INTERIOR TRIM DETAILS.
- SEE ARCHITECTURAL DETAIL SHEET "AD" FOR HOUSE SPECIFIC INTERIOR TRIM OPTION TABLE.
- ALL WINDOWS HAVE T-1/2" HEADER HEIGHT UNLESS OTHERWISE NOTED.
- ALL CASED OPENINGS AT T-11", UNLESS OTHERWISE NOTED.

GYPSUM NOTES

AT GARAGE:
5/8" DRYWALL ON COMMON WALLS, CEILING, AND BEARING WALLS AS REQUIRED.

AT STAIRS:
1/2" GYPSUM BOARD AT UNDERSIDE OF STAIRS AND WALLS IN CLOSET.

WITH OPTION "SG1" - DRYWALL UNFINISHED BASEMENT CEILING AREA

- NOTES:**
- 1/2" GYPSUM WALL BOARD REQUIRED ON CEILING IN UNFINISHED AREAS WHEN NO SPRINKLER SYSTEM IS INSTALLED.
 - A MAXIMUM AREA OF 80 SQ FT MAY BE OMITTED AS NEEDED FOR INSTALLATION OF PLUMBING, ELECTRICAL, AND/OR HVAC (TYPICALLY AN 8'-0" x 8'-0" CEILING SPACE ABOVE MECHANICAL AREA).
 - PROVIDE FIRE BLOCKING AS REQUIRED AT PERIMETER OF ANY AREAS WHERE DRYWALL HAS BEEN OMITTED.

LEGEND

- BEARING WALL
 - - - NON BEARING WALL
 - ⊗ INDICATES BEARING FROM POINT-LOAD ABOVE
 - J JACKS
 - B BEAM/HEADER
 - F PAD FOOTING
 - ◇ STEEL COLUMN
 - X PORTAL FRAME
 - X JOIST/TRUSS
 - LVL LVL
 - ⊗ ENGINEERING PAGE NUMBER
- SEE FC DETAILS FOR FRAMING CONNECTORS

LVL PLY TO PLY FASTENING SCHEDULE: (WHERE APPLICABLE BASED ON LVL USAGE)

1A - (2) PLY UP TO AND INCLUDING 11 7/8" TALL; FASTEN PLYS W/ (2) ROWS 16D NAILS AT 12" O.C.
 2A - (2) PLY 14" TO AND INCLUDING 18" TALL (INCLUSIVE); FASTEN PLYS W/ (3) ROWS 16D NAILS AT 12" O.C.
 3A - (2) PLY 20" TALL AND OVER; FASTEN PLYS W/ (4) ROWS 16D NAILS AT 12" O.C.
 4A - (3) PLY UP TO AND INCLUDING 11 7/8" TALL; FASTEN PLYS W/ (2) ROWS 16D NAILS AT 12" O.C. FROM EACH SIDE.
 5A - (3) PLY 14" TO AND INCLUDING 18" TALL (INCLUSIVE); FASTEN PLYS W/ (3) ROWS 16D NAILS AT 12" O.C. FROM EACH SIDE.
 6A - (3) PLY 20" TALL AND OVER; FASTEN PLYS W/ (4) ROWS 16D NAILS AT 12" O.C. FROM EACH SIDE.

FIRST FLOOR BEAM/HEADER SCHEDULE

IDENTIFIER	DESCRIPTION	LENGTH	OPTIONS	ENG. NUM.	REMARKS
B103	INT HEADER - 2x8 - 2 PLY	5'-4"	GAA	1031	
B108	BEAM STEEL - W10X41	22'-5"	GCC	1071, 1078, 107B	
PF104-2	LVL - 11-04	13'-9"	GAA	1085	PORTAL FRAME - 1A
PF115-3	LVL - 22	22'-4 1/2"	GCC/GAA	1087, 1084, 1041	PORTAL FRAME - 6A

STEEL COLUMN SCHEDULE

IDENTIFIER	STYLE	HEIGHT	OPTIONS	ENG. NUM.	REMARKS
C103	STANCHION - 3 IN SCHED 40	8'-4 5/8"	GCC	1071, 1078, 107B	

FIRST FLOOR JACK SCHEDULE

IDENTIFIER	DESCRIPTION	OPTIONS	ENG. NUM.	REMARKS
J101	JACK - (1) 2X4 SFF		1024	
J102	JACK - (1) 2X4 SFF STUD GRADE		1024	
J104	JACK - (2) 2X4 SFF STUD GRADE		1052	
J114	JACK - (2) 2X4 SFF STUD GRADE	GAA	1085	
J120	JACK - (2) 2X4 SFF STUD GRADE	GAA	1085	
J121	JACK - (2) 2X4 SFF STUD GRADE	GAA	1091	
J124	JACK - (2) 2X6 SFF STUD GRADE	GAA	1091	
J125	JACK - (2) 2X4 SFF STUD GRADE		1011	
J126	JACK - (2) 2X4 SFF STUD GRADE		1013	
J129	JACK - (3) 2X4 SFF	ELL	200B	
J130	JACK - (3) 2X4 SFF	ELL	200B	
J133	JACK - (2) 2X6 SFF STUD GRADE	ELB, ELK, ELL, ELR	1017	
J137	JACK - (2) 2X6 SFF STUD GRADE	GCC	1087, 1084, 1041	
J138	JACK - (3) 2X6 SFF STUD GRADE	GCC	1087, 1084, 1041	
J139	JACK - (2) 2X4 SFF STUD GRADE		1059	
J140	JACK - (2) 2X4 SFF STUD GRADE		1059	
J150	JACK - (2) 2X6 SFF STUD GRADE	MCF	1023	
J151	JACK - (2) 2X6 SFF STUD GRADE	MCF	1023	
J153	JACK - (2) 2X6 SFF STUD GRADE	GCC, ELB, ELK, ELL, ELR	1017	CRIPPLES

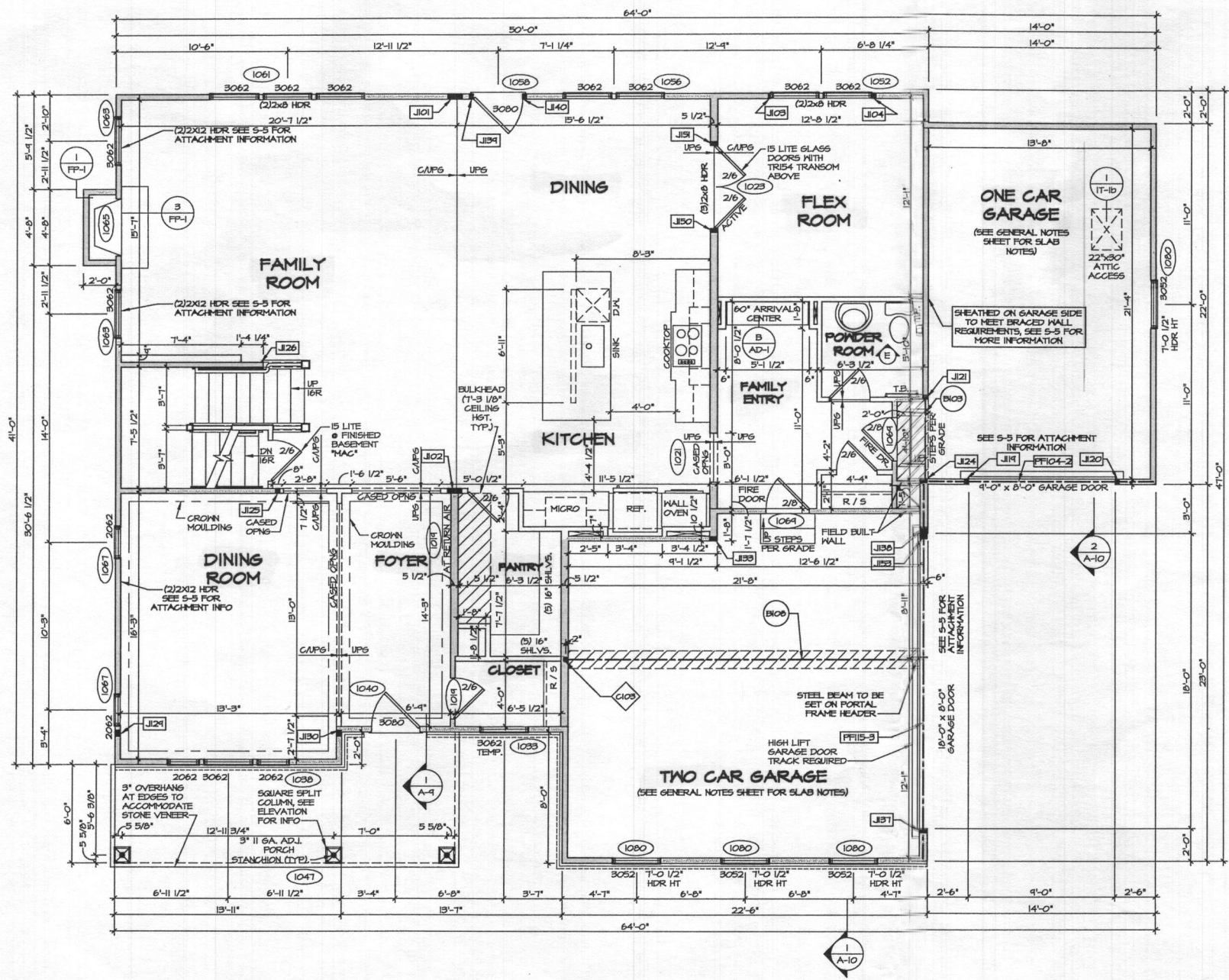

FIRST FLOOR PLAN
SCALE: 1/4" = 1'-0"

REVISIONS

REV. NO.	DATE	DESCRIPTION

© NVR, Inc., is a registered provider of continuing education for architects, engineers, planners, interior designers, and landscape architects. These plans are not to be reproduced, stored in a retrieval system, or transmitted in any form or by any means, electronic, mechanical, photocopying, recording, or by any information storage and retrieval system, without the prior written consent of NVR, Inc.

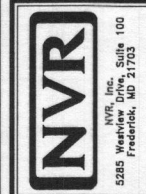

SET NO. 14000
VERSION 01
DRAWN BY NSB
DATE: _____
OPTION _____

MODEL: LONGWOOD
DRAWING TITLE: FIRST FLOOR PLAN
OPTION DESCRIPTION: _____

SHEET NO. **A-7**
24

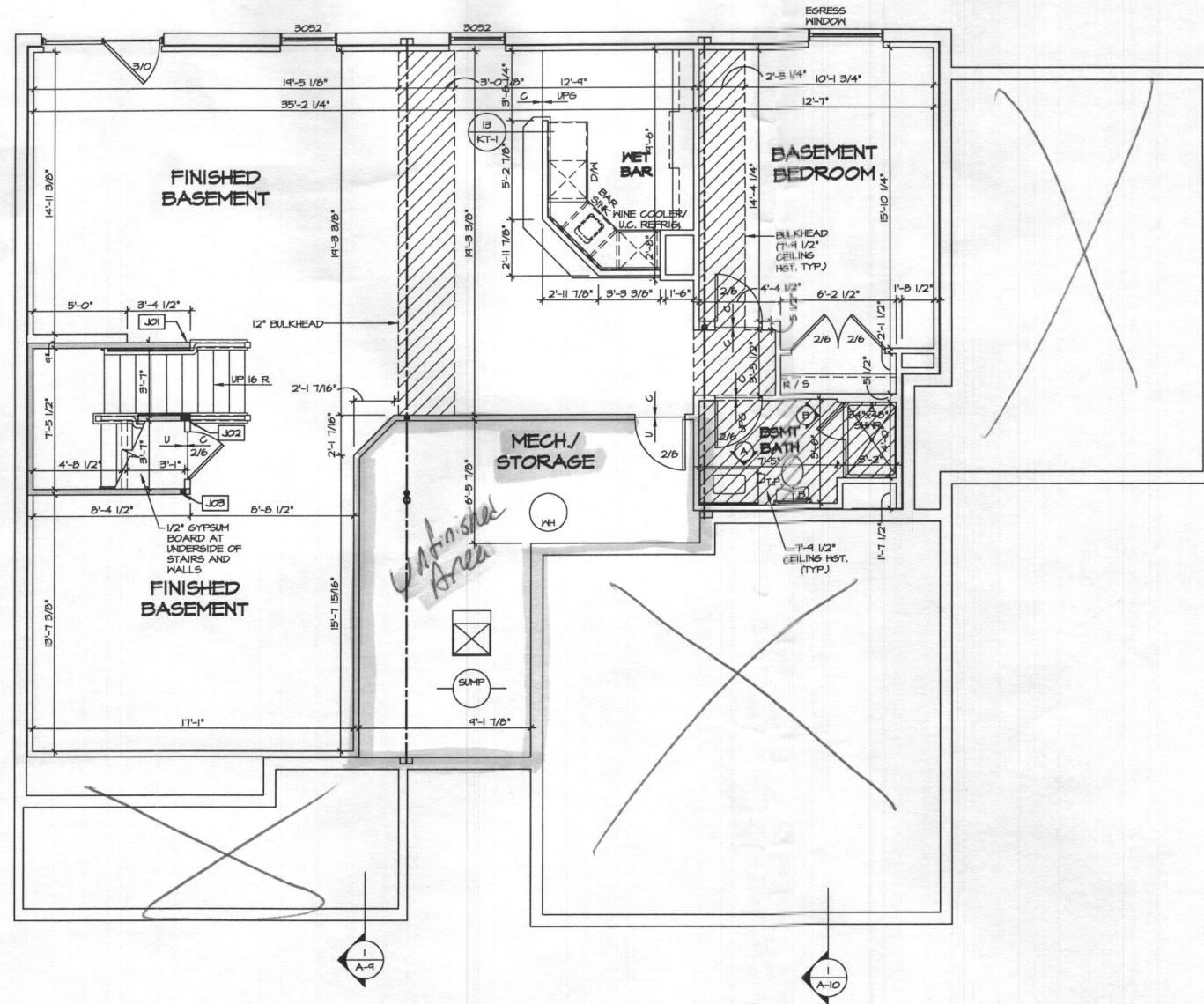

BASEMENT FLOOR PLAN
 SCALE: 1/4" = 1'-0"

FLOOR PLAN NOTES

1. ALL HEADERS ARE (2) 2x6 w/ 2x4 WALLS OR (3) 2x6 w/ 2x6 WALLS, UNLESS OTHERWISE NOTED.
2. ALL HEADERS TO HAVE (1) 2x4 OR 2x6 JACK EACH END, UNLESS OTHERWISE NOTED.
3. ALL EXTERIOR WALLS TO BE 4" AND ALL INTERIOR WALLS TO BE 3 1/2", UNLESS OTHERWISE NOTED.
4. HATCHED AREAS INDICATE DROPPED CEILINGS. ALL DROPPED CEILINGS ARE 12" UNLESS OTHERWISE NOTED. SEE BRACED WALL PANEL DETAIL SHEET FOR SPECIAL WALL FRAMING LOCATIONS AND HEADER SIZES, IF APPLICABLE.
5. SEE STANDARD DETAIL CATEGORY "11" SHEET(S) FOR INTERIOR TRIM DETAILS.
6. SEE ARCHITECTURAL DETAIL SHEET "AD" FOR HOUSE SPECIFIC INTERIOR TRIM OPTION TABLE.
7. ALL WINDOWS HAVE T-O 1/2" HEADER HEIGHT UNLESS OTHERWISE NOTED.
8. ALL CASED OPENINGS AT 7'-11", UNLESS OTHERWISE NOTED.

GYPSUM NOTES

AT GARAGE:
 5/8" DRYWALL ON COMMON WALLS, CEILING, AND BEARING WALLS AS REQUIRED.

AT STAIRS:
 1/2" GYPSUM BOARD AT UNDERSIDE OF STAIRS AND WALLS IN CLOSET.

WITH OPTION "SCI" - DRYWALL UNFINISHED BASEMENT CEILING AREA

NOTES:

- 1/2" GYPSUM WALL BOARD REQUIRED ON CEILING IN UNFINISHED AREAS WHEN NO SPRINKLER SYSTEM IS INSTALLED.
- A MAXIMUM AREA OF 80 SQ FT MAY BE OMITTED AS NEEDED FOR INSTALLATION OF PLUMBING, ELECTRICAL, AND/OR HVAC (TYPICALLY AN 8'-0" X 8'-0" CEILING SPACE ABOVE MECHANICAL AREA).
- PROVIDE FIRE BLOCKING AS REQUIRED AT PERIMETER OF ANY AREAS WHERE DRYWALL HAS BEEN OMITTED.

LEGEND

- BEARING WALL
 - NON BEARING WALL
 - INDICATES BEARING FROM POINT-LOAD ABOVE
 - JACKS
 - BEAMHEADER
 - PAD FOOTING
 - STEEL COLUMN
 - PORTAL FRAME
 - JOIST/TRUSS
 - LVL
 - ENGINEERING PAGE NUMBER
- SEE FC DETAILS FOR FRAMING CONNECTORS

BASEMENT JACK SCHEDULE

IDENTIFIER	DESCRIPTION	OPTIONS	ENG. NUM.	REMARKS
JO1	JACK - (2) 2X4 SFF STUD GRADE	MAC	BO020	
JO2	JACK - (4) 2X4 SFF STUD GRADE	MAC	BO016, BO018	
JO3	JACK - (2) 2X4 SFF STUD GRADE	MAC	BO016	

The owner, expressly reserves the right to make changes to these plans. These plans are not to be reproduced, copied, or otherwise used in any way without the written consent of NVR, Inc.

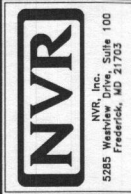

SET NO. 14000
 VERSION C1
 DRAWN BY NSB
 DATE: _____
 OPTION _____

SHEET NO. **A-6**
 MODEL **LONGWOOD**
 DRAWING TITLE **BASEMENT FLOOR PLAN**
 OPTION DESCRIPTION
 22

ALL WINDOWS HAVE 8'-0" 1/2" HEADER HEIGHT UNLESS OTHERWISE NOTED.

FLOOR PLAN NOTES

- ALL HEADERS ARE (2) 2x6 W/ 2x4 WALLS OR (3) 2x6 W/ 2x6 WALLS, UNLESS OTHERWISE NOTED.
- ALL HEADERS TO HAVE (1) 2x4 OR 2x6 JACK EACH END, UNLESS OTHERWISE NOTED.
- ALL EXTERIOR WALLS TO BE 4" AND ALL INTERIOR WALLS TO BE 3 1/2", UNLESS OTHERWISE NOTED.
- HATCHED AREAS INDICATE DROPPED CEILINGS. ALL DROPPED CEILINGS ARE 12" UNLESS OTHERWISE NOTED.
- SEE "BRACED WALL PANEL DETAIL SHEET" FOR SPECIAL WALL FRAMING LOCATIONS AND HEADER SIZES, IF APPLICABLE.
- SEE STANDARD DETAIL CATEGORY "IT" SHEET(S) FOR INTERIOR TRIM DETAILS.
- SEE ARCHITECTURAL DETAIL SHEET "AD" FOR HOUSE SPECIFIC INTERIOR TRIM OPTION TABLE.
- ALL WINDOWS HAVE 7'-0" 1/2" HEADER HEIGHT UNLESS OTHERWISE NOTED.
- ALL CASED OPENINGS AT 7'-11", UNLESS OTHERWISE NOTED.

GYPSUM NOTES

AT GARAGE:
5/8" DRYWALL ON COMMON WALLS, CEILING, AND BEARING WALLS AS REQUIRED.
1/2" GYPSUM BOARD AT UNDERSIDE OF STAIRS AND WALLS IN CLOSET

AT STAIRS:
WITH OPTION "SG1" - DRYWALL UNFINISHED BASEMENT CEILING AREA

- NOTES:**
- 1/2" GYPSUM WALL BOARD REQUIRED ON CEILING IN UNFINISHED AREAS WHEN NO SPRINKLER SYSTEM IS INSTALLED.
 - A MAXIMUM AREA OF 80 SQ FT MAY BE OMITTED AS NEEDED FOR INSTALLATION OF PLUMBING, ELECTRICAL, AND/OR HVAC (TYPICALLY AN 8'-0" X 8'-0" CEILING SPACE ABOVE MECHANICAL AREA).
 - PROVIDE FIRE BLOCKING AS REQUIRED AT PERIMETER OF ANY AREAS WHERE DRYWALL HAS BEEN OMITTED.

LEGEND

- BEARING WALL
 - NON BEARING WALL
 - INDICATES BEARING FROM POINT-LOAD ABOVE
 - JACKS
 - BEAM-HEADER
 - PAD FOOTING
 - STEEL COLUMN
 - PORTAL FRAME
 - JOIST/TRUSS
 - LVL
 - ENGINEERING PAGE NUMBER
- SEE FC DETAILS FOR FRAMING CONNECTORS

LVL PLY TO PLY FASTENING SCHEDULE: (WHERE APPLICABLE BASED ON LVL USAGE)

1A - (2) PLY UP TO AND INCLUDING 11 7/8" TALL; FASTEN FLIES W/ (2) ROWS 16D NAILS AT 12" O.C.
 2A - (2) PLY 14" TO AND 18" TALL (INCLUSIVE); FASTEN FLIES W/ (3) ROWS 16D NAILS AT 12" O.C.
 3A - (2) PLY 20" TALL AND OVER; FASTEN FLIES W/ (4) ROWS 16D NAILS AT 12" O.C.
 4A - (3) PLY UP TO AND INCLUDING 11 7/8" TALL; FASTEN FLIES W/ (2) ROWS 16D NAILS AT 12" O.C. FROM EACH SIDE
 5A - (3) PLY 14" TO AND 18" TALL (INCLUSIVE); FASTEN FLIES W/ (3) ROWS 16D NAILS AT 12" O.C. FROM EACH SIDE
 6A - (3) PLY 20" TALL AND OVER; FASTEN FLIES W/ (4) ROWS 16D NAILS AT 12" O.C. FROM EACH SIDE

FIRST FLOOR BEAM/HEADER SCHEDULE

IDENTIFIER	DESCRIPTION	LENGTH	OPTIONS	ENS. N.M.	REMARKS
B103	INT HEADER - 2X8 - 2 PLY	5'-4"	GAA	1031	
B108	BEAM STEEL - W10X44	22'-5"	GCC	1071, 1075, 1078	
PF104-2	LVL - 11-04	13'-4"	GAA	1085	PORTAL FRAME - 1A
PF115-3	LVL - 22	22'-4 1/2"	GCC/GAA	1087, 1089, 1091	PORTAL FRAME - 6A

STEEL COLUMN SCHEDULE

IDENTIFIER	STYLE	HEIGHT	OPTIONS	ENS. N.M.	REMARKS
C103	STANCHION - 3 IN SCHED 40	8'-4 5/8"	GCC	1071, 1075, 1078	

FIRST FLOOR JACK SCHEDULE

IDENTIFIER	DESCRIPTION	OPTIONS	ENS. N.M.	REMARKS
J101	JACK - (1) 2X4 SFF#		1024	
J102	JACK - (1) 2X4 SFF STUD GRADE		1024	
J103	JACK - 2X4 SFF STUD GRADE		1052	
J104	JACK - (2) 2X4 SFF STUD GRADE		1052	
J111	JACK - (2) 2X4 SFF STUD GRADE	GAA	1085	
J120	JACK - (2) 2X4 SFF STUD GRADE	GAA	1085	
J121	JACK - (2) 2X4 SFF STUD GRADE	GAA	1031	
J124	JACK - (2) 2X6 SFF STUD GRADE	GAA	1031	
J125	JACK - (2) 2X4 SFF STUD GRADE		1011	
J126	JACK - (2) 2X4 SFF STUD GRADE		1013	
J129	JACK - (3) 2X4 SFF#	ELL	2008	
J130	JACK - (3) 2X4 SFF#	ELL	2008	
J135	JACK - (2) 2X6 SFF STUD GRADE	ELB, ELK, ELL, ELR	1017	
J137	JACK - (2) 2X6 SFF STUD GRADE	GCC	1087, 1089, 1091	
J138	JACK - (3) 2X6 SFF STUD GRADE	GCC	1087, 1089, 1091	
J139	JACK - (2) 2X4 SFF STUD GRADE		1050	
J140	JACK - (2) 2X4 SFF STUD GRADE		1050	
J150	JACK - (2) 2X6 SFF STUD GRADE	MCF	1023	
J151	JACK - (2) 2X6 SFF STUD GRADE	MCF	1023	
J153	JACK - (2) 2X6 SFF STUD GRADE	GCC, ELB/ELK/ELL/ELR	1017	CRIPPLES

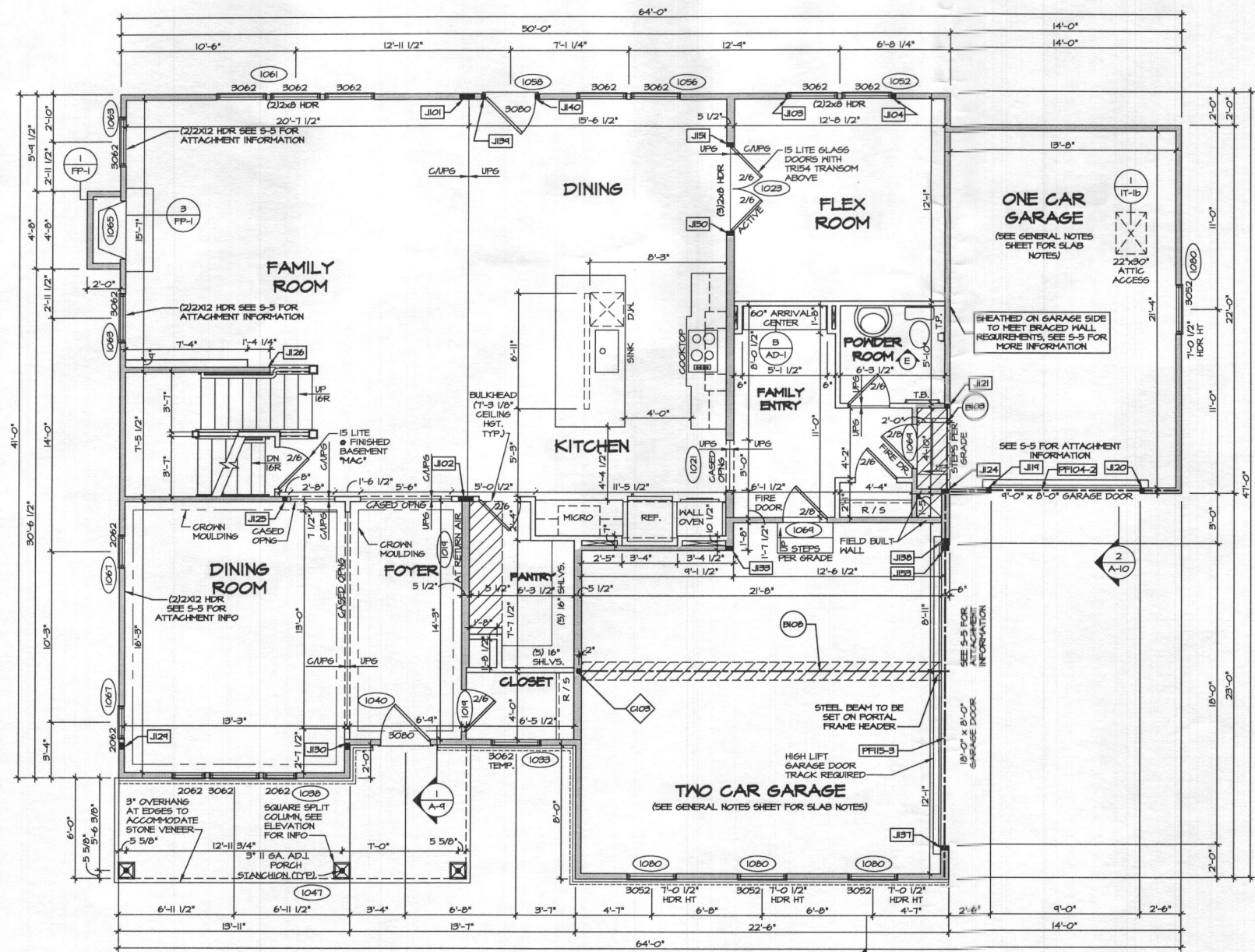

FIRST FLOOR PLAN
SCALE: 1/4" = 1'-0"

REMARKS

The undersigned hereby certifies that the information shown on these plans was prepared by or under the direct supervision of a duly licensed professional engineer or architect, and that he is a duly licensed professional engineer or architect in the State of Maryland.

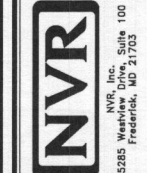

SET NO. 14000
VERSION 01
DRAWN BY: NGB
DATE: _____
OPTION: _____

MODEL: LONGWOOD
DRAWING TITLE: FIRST FLOOR PLAN
OPTION DESCRIPTION: _____

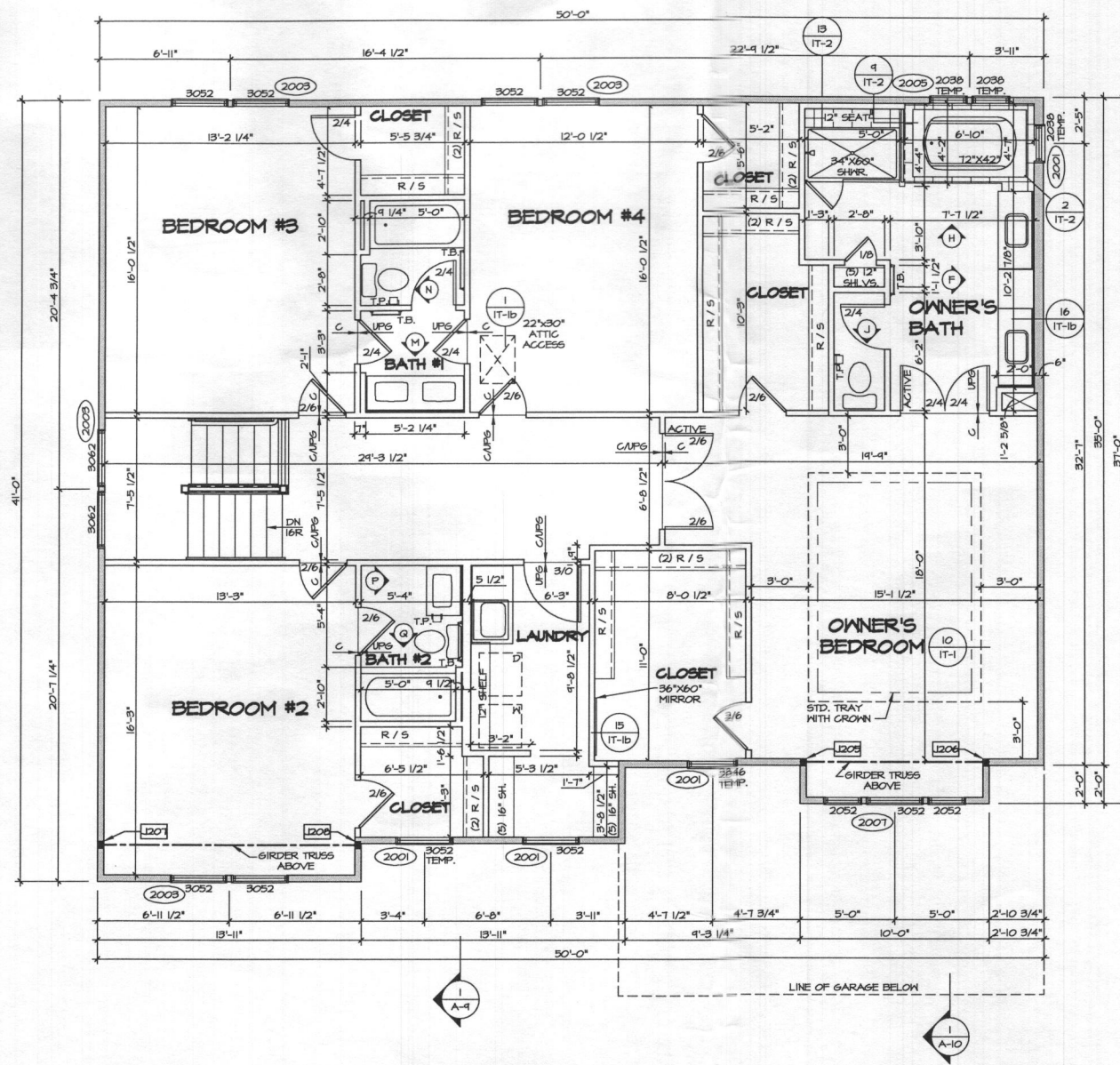

1 SECOND FLOOR PLAN
 A-B SCALE: 1/4" = 1'-0"

FLOOR PLAN NOTES

1. ALL HEADERS ARE (2) 2x6 w/ 2x4 WALLS OR (3) 2x6 w/ 2x6 WALLS, UNLESS OTHERWISE NOTED.
2. ALL HEADERS TO HAVE (1) 2x4 OR 2x6 JACK EACH END, UNLESS OTHERWISE NOTED.
3. ALL EXTERIOR WALLS TO BE 4" AND ALL INTERIOR WALLS TO BE 3 1/2", UNLESS OTHERWISE NOTED.
4. HATCHED AREAS INDICATE DROPPED CEILINGS. ALL DROPPED CEILINGS ARE 12" UNLESS OTHERWISE NOTED.
5. SEE BRACED WALL PANEL DETAIL SHEET FOR SPECIAL WALL FRAMING LOCATIONS AND HEADER SIZES, IF APPLICABLE.
6. SEE STANDARD DETAIL CATEGORY "IT" SHEET(S) FOR INTERIOR TRIM DETAILS.
7. SEE ARCHITECTURAL DETAIL SHEET "AD" FOR HOUSE SPECIFIC INTERIOR TRIM OPTION TABLE.
8. ALL WINDOWS HAVE T-O 1/2" HEADER HEIGHT UNLESS OTHERWISE NOTED.
9. ALL CASED OPENINGS AT T-11", UNLESS OTHERWISE NOTED.

GYPSUM NOTES

- AT GARAGE:**
 5/8" DRYWALL ON COMMON WALLS, CEILING, AND BEARING WALLS AS REQUIRED.
- AT STAIRS:**
 1/2" GYPSUM BOARD AT UNDERSIDE OF STAIRS AND WALLS IN CLOSET

LEGEND

- BEARING WALL
 - NON BEARING WALL
 - ⊗ INDICATES BEARING FROM POINT-LOAD ABOVE
 - ⊥ JACKS
 - ⊔ BEAM/HEADER
 - ⊔ PAD FOOTING
 - ⊔ STEEL COLUMN
 - ⊔ PORTAL FRAME
 - ⊔ JOIST/TRUSS
 - LVL
 - ⊗ ENGINEERING PAGE NUMBER
- SEE FC DETAILS FOR FRAMING CONNECTORS

SECOND FLOOR JACK SCHEDULE

IDENTIFIER	DESCRIPTION	OPTIONS	ENG. NUM.	REMARKS
J205	JACK - (B) 2X4 SFF STUD GRADE	ELL	2008	
J206	JACK - (B) 2X4 SFF STUD GRADE	ELL	2008	
J207	JACK - (B) 2X4 SFF	ELL	2008	EXTEND THRU TOP PLATE
J208	JACK - (B) 2X4 SFF	ELL	2008	EXTEND THRU TOP PLATE

REMARKS

REV. NO. DATE

© NVR, Inc. The contractor expressly warrants the accuracy of the information provided in these plans. These plans are not to be used for construction or other purposes without the express written consent of NVR, Inc.



SET NO. 14000
 VERSION 01
 DRAWN BY GAP
 DATE:
 OPTION

MODEL LONGWOOD
 DRAWING TITLE SECOND FLOOR PLAN
 OPTION DESCRIPTION

SHEET NO. A-8
 26