



HOWARD COUNTY HEALTH DEPARTMENT

66444

DATE 11/7/19

Received From

Fogles Septic Clearing ^{11/19} PHONE # 745-5040

For

Rec / Repair - BPR
11111 Lane

CASH

CHECK

NO.

0006

Three hundred thirty Dollars

\$ 330.00

Received By

Kemp

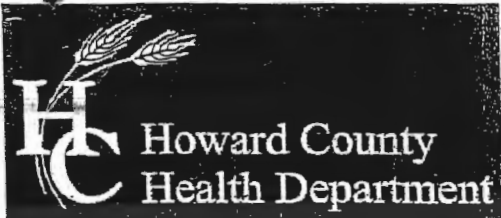

Bureau of Environmental Health

8930 Stanford Boulevard, Columbia, MD 21045

Main: 410-313-2640 | Fax: 410-313-2648

TDD 410-313-2323 | Toll Free 1-866-313-6300

www.hchealth.org

Facebook: www.facebook.com/hocohealth

Twitter: HowardCoHealthDep

Maura J. Rossman, M.D., Health Officer

1510444

APPLICATION

FOR PERCOLATION TESTING AND SITE EVALUATION

PROPERTY LOCATION

SUBDIVISION/PROPERTY NAME

Allnut Farms Estates

PROPERTY ADDRESS

13428 Allnut Lane

Highland

20777

TAX ACCOUNT #

379938

TAX MAP

34

GRID

15

PARCEL

3166

LOT NO.

12

PROPOSED LOT SIZE (ACRES)

ZONING CATEGORY

TIER

PROPERTY OWNER(S)

Amar Satnarain

DAYTIME PHONE

301-503-1682

CELL

EMAIL

MAILING ADDRESS

13428 Allnut Lane

Highland

20777

APPLICANT

Fogle's Septic Clean

RELATIONSHIP TO OWNER:

Contractor

DAYTIME PHONE

410-795-5670

CELL

EMAIL

MAILING ADDRESS

580 Obrecht Ad

Sykesville

21784

I HEREBY APPLY FOR THE NECESSARY TESTING/EVALUATION PRIOR TO ISSUANCE OF SEWAGE DISPOSAL SYSTEM PERMIT(S):

PROPERTY:

- PROPERTY: SUBDIVISION: NUMBER OF LOTS INCLUDING RESIDUE: SUBDIVISION CLASSIFICATION (PER DEPT. OF PLANNING AND ZONING) MAJOR MINOR CONSTRUCT NEW OSDS ON UNDEVELOPED LOT REPAIR OR REPLACE FAILING OSDS UPGRADE EXISTING OSDS

BUILDING:

- BUILDING: RESIDENTIAL WITH 4 EXISTING OR PROPOSED BEDROOMS IN THE COMPLETED STRUCTURE COMMERCIAL (PROVIDE DETAIL OF TYPE OF USE AND NUMBERS OF EMPLOYEES/CUSTOMERS ON ACCOMPANYING PLAN)

IS THE PROPERTY WITHIN 2500 FEET OF ANY RESERVOIR?

- YES NO

AS APPLICANT, I UNDERSTAND THE FOLLOWING:

- THIS APPLICATION IS VALID FOR TWO(2) YEARS FROM DATE OF FEE PAYMENT AND APPROVAL IS BASED UPON HEALTH OFFICER SIGNATURE OF A PERC CERTIFICATION PLAN PRIOR TO EXPIRATION OF THIS PERMIT. THE APPLICATION FEE IS NON-REFUNDABLE THIS APPLICATION MUST BE ACCOMPANIED BY ALL APPLICABLE FEES AND A SUITABLE SITE PLAN IN ORDER TO BE PROCESSED THIS IS A PUBLIC DOCUMENT

I declare and affirm that to the best of my knowledge, the information contained herein is correct. I declare that I am the owner of the property or duly authorized to make this application on behalf of the owner. I agree to comply with all applicable state and county regulations.

By signature of this application, I hereby grant Howard County Health Department officials the right to enter onto the property for the purpose of inspecting the property as directly related to the requested permit/service.

SIGNATURE OF APPLICANT

DATE

AAC

0.6 dk brn L, 1 v fsbk
 0.6 brn L 2 fsbk
 red-brn cl 2 fsbk, ss
 1 5-15% gravel
 6.5 red-brn L 1 fsbk, ss
 2 red-brn fsL thick platy common mica f 3p (grey)
 3.4 brn lfs and yellow lfs thin platy many fine mica
 7' yel-red fsL thin platy many fine mica
 10' v. blk. brn ch ls many mica moist

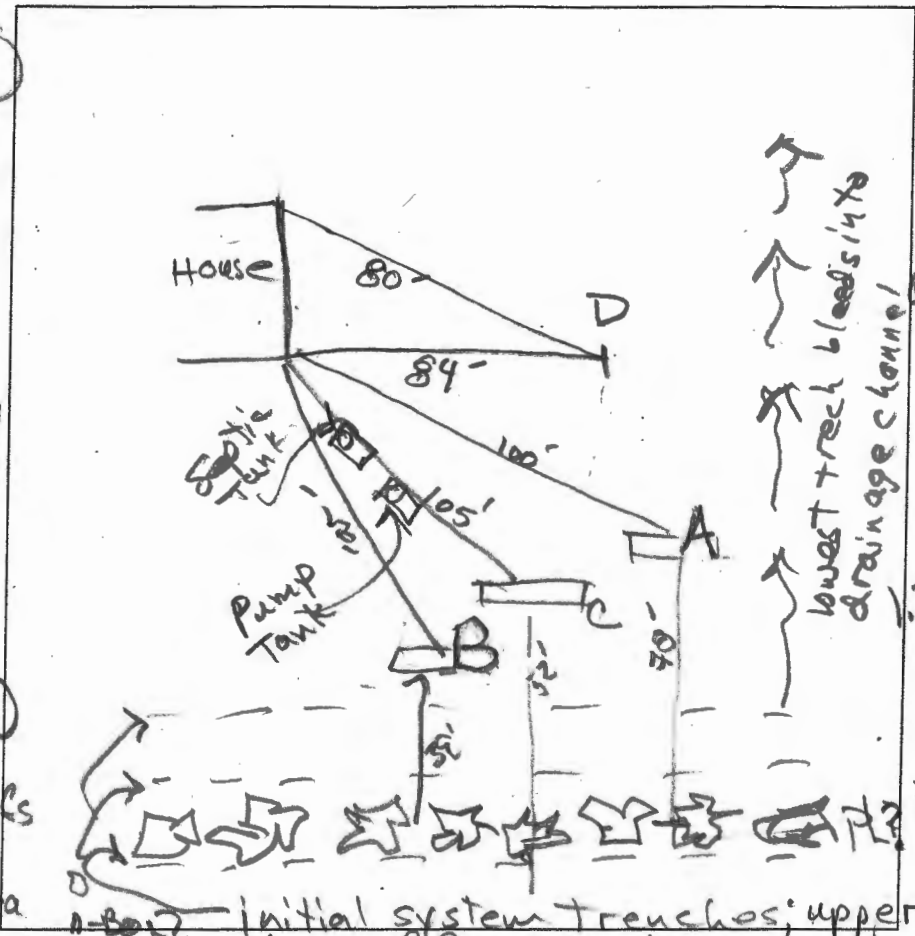

initial system trenches; upper trench may be off property

DATE	TEST #	DEPTH	START	BREAK 1" DROP	STOP 2" DROP	TIME OF 2ND INCH	P/F/H
11/19/19	A	5.4' / 10'	10:56	10:59	11:04	5	P
11/19/19	B	5' / 10'	11:17	11:32 ⁺	(1/4" movement)		
	resurf B	6.5' / 10'	11:42	11:44	11:48	4	F below
11/19/19	C	5' / 10'	12:16	12:38	1:32 ⁺	54 ⁺	F
11/19/19	P	4.9' / 10'	0	1.3	2.8	1.5	P

B
 0.1 dk brn L 1 v fsbk
 0.7 yel-red L 2 fsbk
 dk brn L 2 fsbk many fine depletions, Fe enrichments in former root channels
 3' yel-red L 3 fsbk & 3 fsbk many clay coatings
 3.5 red-yel & grey-brn fsL many thick fine platy mica
 6' brn & yellow lfs, many mica
 7' yel-red lfs, thin platy many mica
 12'

lowest trench bleed into drainage channel

D

0.3 dk brn L 2 v fsbk
 1' brn L 2 fsbk
 red-yellow ls, sm
 1.9 variegated yel & grey-brn ls, thick platy common mica
 4.5 yel & grey brn lfs thin platy many mica
 10' red-yellow, yellow & brn grey lfs, moist, water @ 11.5'

REMARKS
 SANITARIAN R Bicker BACKHOE Fogel's (Ricky) OTHERS Joseph Cabanog
 TEST HOLES USED IN SDA _____ AVG. PERC TIME _____ SQ. FT/BR _____
 TRENCH WIDTH _____ INLET DEPTH _____ MAX. BOT DEPTH _____ EFFECTIVE S/W _____

SITE INSPECTION SHEET

OWNER: Amar & DHANWATTIE Setnarain PHONE #: _____

ADDRESS: 13428 Almutt Lane CONTRACTOR: Fogel's

WELL TAG #: _____

SUBDIVISION: Almutt Farm Estates LOT: 12 COUNTY #: _____

PROPOSAL: Trenches full of solution, Two trenches exposed; third trench apparently on neighboring property.

LOCATION DIAGRAM

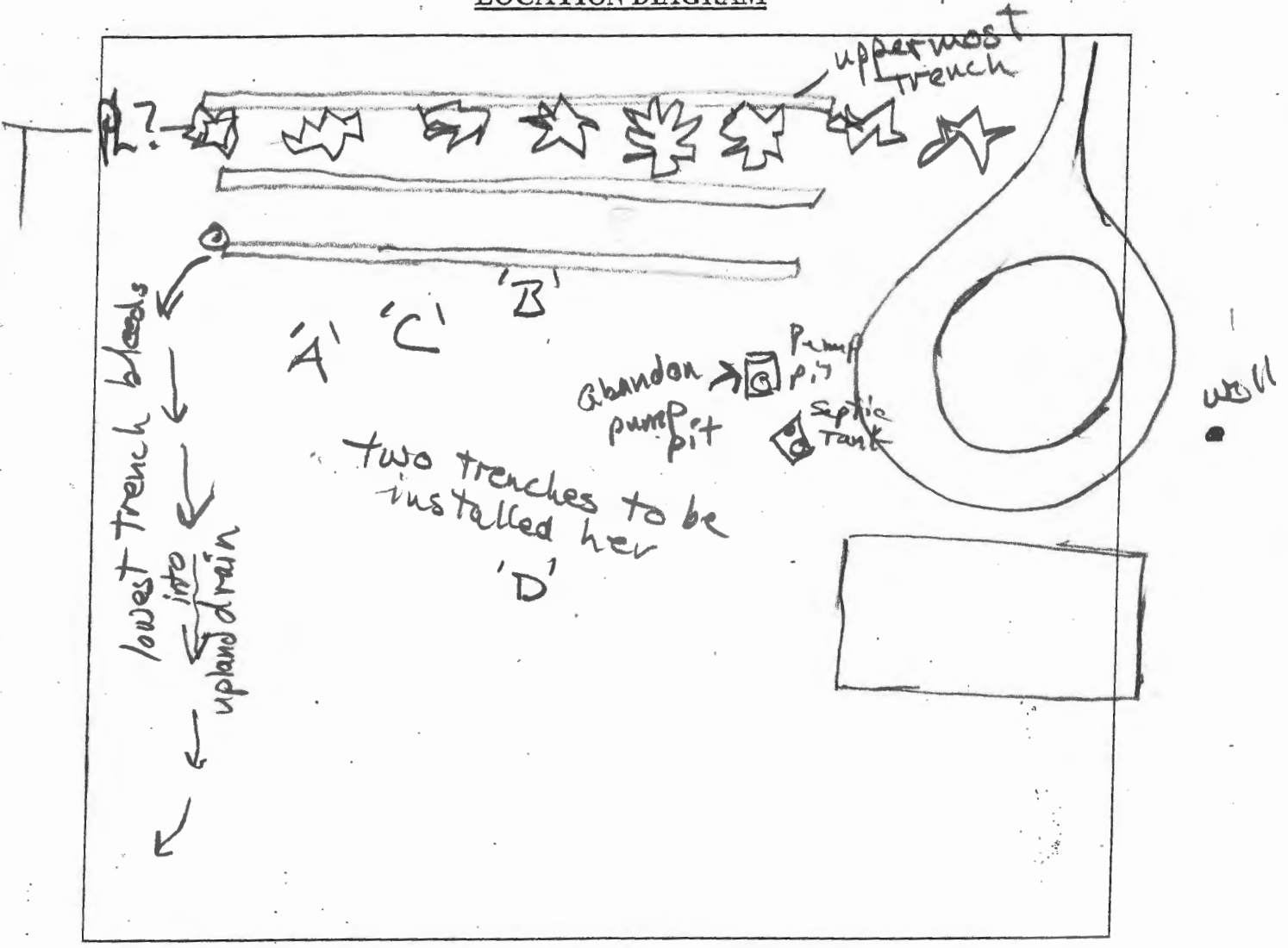

COMMENTS: Area around septic tank access is eroded; leaves observed in septic tank. Pump pit man hole has roots growing in it; Access not secure. Mud and leaves observed on pipes above pumps. Install man holes.

DATE: 11/19/2019

INSPECTOR: K Bricker