

**Bureau of Environmental Health**  
 8930 Stanford Boulevard, Columbia, MD 21045  
 Main: 410-313-2640 | Fax: 410-313-2648  
 TDD 410-313-2323 | Toll Free 1-866-313-6300  
[www.hchealth.org](http://www.hchealth.org)  
 Facebook: [www.facebook.com/hocohealth](http://www.facebook.com/hocohealth)

Maura J. Rossman, M.D., Health Officer

RECEIPT DATE: 11/7/2019      **ONSITE SEWAGE DISPOSAL SYSTEM**      P 566444

APPROVAL DATE: 11/26/2019      **PERMIT:**      **REPAIR**      A \_\_\_\_\_

PROPERTY ADDRESS: 13428 ALLNUTT LANE, HIGHLAND, MD 20777

SUBDIVISION: ALLNUTT FARM ESTATES      LOT: 12      TAX ID: 05-379938

CONTRACTOR: FOGLE'S SEPTIC CLEAN, INC.      EMAIL: \_\_\_\_\_

CONTRACTOR ADDRESS: 580 OBRECHT ROAD, SYKESVILLE, MD 21784      PHONE: (410)795-5670

PROPERTY OWNER: AMAR and DHANWATTIE SATNARAIN      EMAIL: \_\_\_\_\_

OWNER ADDRESS: 13428 ALLNUTT LANE, HIGHLAND, MD 20777      PHONE: \_\_\_\_\_

SEPTIC TANK SIZE (GALLONS): 1250      PUMP CHAMBER CAPACITY (GALLONS): TBA      PUMP SIZE: UNK

NUMBER OF BEDROOMS: 5 (per owner)      HOUSE SQ. FT. \_\_\_\_\_      APPLICATION RATE: 1.2

DISTRIBUTION SYSTEM:      GRAVITY FED       LOW PRESSURE DOSED

TRENCHES:	LINEAR FEET REQUIRED: <u>115</u>	INLET DEPTH: <u>3.0</u>
	TRENCH WIDTH: <u>3</u>	MAXIMUM BOTTOM DEPTH: <u>6.0</u>
	MINIMUM SPACE BETWEEN TRENCHES: <u>10</u>	EFFECTIVE AREA BEGINNING DEPTH: <u>3.5</u>
LOCATION:	TO BE STAKED BY SANITARIAN DURING PRE-CONSTRUCTION INSPECTION.	
NOTES:	<ul style="list-style-type: none"> <li>INSTALL MANHOLE AND STANDPIPE ON EXISTING SEPTIC TANK TO PREVENT SOIL, ROCKS, ETC. FROM ENTERING THE TANK, AND FOR PROPER MAINTENANCE.</li> <li>ABANDON PUMP TANK AS IT IS NOT NEEDED IN SUPPORT OF THE REPLACEMENT TRENCHES, AND THE CAPACITY IS TOO SMALL FOR A FIVE BEDROOM RESIDENCE. <i>→ May be kept if tank is 'ok' structurally. (-km)</i></li> </ul>	

ISSUED BY: R BRICKER      ISSUE DATE: 11/20/2019      EXPIRATION DATE: 11/7/2020

- NOTE: CONTRACTOR MUST SCHEDULE A PRE-CONSTRUCTION INSPECTION PRIOR TO BEGINNING ANY INSTALLATION**
- NOTE: CONTRACTOR MUST SCHEDULE AN INSPECTION AND GAIN APPROVAL OF ALL COMPONENTS PRIOR TO COVERING**
- NOTE: STONE MUST BE APPROVED BY HEALTH DEPARTMENT AND GRAVEL TICKET MUST BE AVAILABLE FOR REVIEW.**
- NOTE: WATERTIGHT SEPTIC TANKS REQUIRED**
- NOTE: ALL PARTS OF SEPTIC SYSTEM SHALL BE AT LEAST 100 FEET DOWNGRADIENT FROM ANY WATER WELL**
- NOTE: MANHOLE RISERS REQUIRED ON ALL SEPTIC TANKS AND PUMP CHAMBERS**
- NOTE: AN ELECTRICAL PERMIT IS REQUIRED FOR INSTALLATION OF ANY ELECTRICAL COMPONENTS OF THE SYSTEM**  
 ELECTRICAL PERMIT ISSUED      E N.A.
- NOTE: THE HCHD DOES NOT WARRANTY ANY SYSTEM AND CANNOT GUARANTEE THE PERFORMANCE OF THIS SYSTEM AS DESIGNED. BY ACCEPTING THIS PERMIT, THE OWNER AND/OR APPLICANT ACKNOWLEDGE THAT THE SPECIFICATIONS DETAILED IN THIS DESIGN ARE ONE POSSIBLE OPTION AND THAT THE HCHD WILL REVIEW OTHER PROPOSALS. YOU HAVE THE OPTION TO SEEK THE ADVICE OF A QUALIFIED DESIGN CONSULTANT OR PROFESSIONAL ENGINEER FOR FURTHER GUIDANCE.**
- NOTE: MDE RECOMMENDS SEPTIC TANKS, BAT, AND OTHER PRETREATMENT UNITS BE PUMPED AT A FREQUENCY ADEQUATE TO ENSURE THAT SOLIDS ARE NOT DISCHARGED TO THE DISPOSAL AREA**

**NEITHER THE HOWARD COUNTY COUNCIL NOR THE HEALTH DEPARTMENT IS RESPONSIBLE FOR THE SUCCESSFUL OPERATION OF ANY SYSTEM.**

**PERMITTEE RESPONSIBLE FOR OBTAINING FINAL APPROVAL ON THIS PERMIT.**

**CALL 410-313-1771 TO SCHEDULE INSPECTIONS.**

NOT TO SCALE

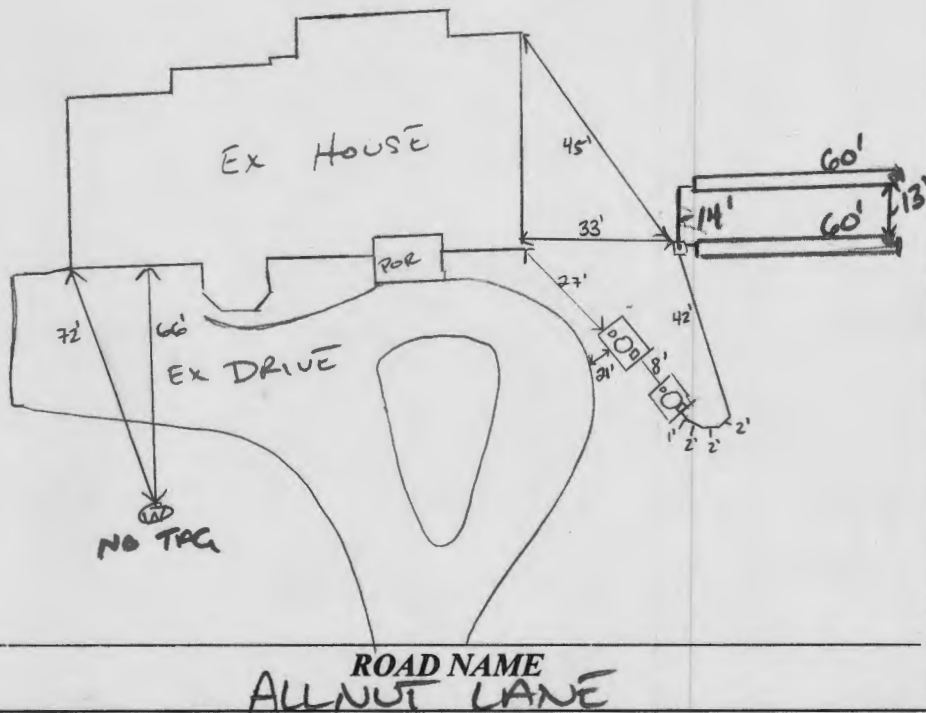

TRENCH/DRAINFIELD DATA		
WIDTH	INLET	BOTTOM
3'	3" Lapped	6"
	8" Lapped	
NUMBER OF TRENCHES 6 2		
TOTAL LENGTH 120 F		
ABSORPTION AREA 360 SF ± 3 DE		
DISTRIBUTION BOX LEVEL SPEED		
DISTRIBUTION BOX BAFFLE 405		
DISTRIBUTION BOX PORT 40		

SEPTIC TANK DATA	
SEPTIC TANK 1 LEVEL	_____
MANUFACTURER	_____
CAPACITY	1250 GAL
SEAM LOC	2' MID
TANK LID DEPTH	2'
BAFFLES	(EX CONC BUILT IN)
BAFFLE FILTER	_____
MANHOLE LOC	_____
6" PORT LOC	_____
WATERTIGHT TEST	_____
SLOTTED	_____
DATE ON LID	_____
PUMP/SEPTIC TANK LEVEL	_____
MANUFACTURER	_____
CAPACITY	1000 GAL
SEAM LOC	MID
TANK LID DEPTH	3'
BAFFLES	MID (NEW) / OUTLET (NEW)
BAFFLE FILTER	_____
MANHOLE LOC	_____
6" PORT LOC	_____
WATERTIGHT TEST	_____
SLOTTED	_____
DATE ON LID	_____

PRE-CONSTRUCTION:

11/25/2019 LAY OUT 2x60' TRENCH. SET IN BETWEEN FERE HOLES.

INSTALLATION:

11/25/2019 INSTALL 2x36" RISERS, 2x 6" C/O ON EX ST AND PUMP TANK. INSTALL NEW PVC SCH 40 IN BETWEEN TANKS, SET DBOX. REMOVED 2 PUMPS FROM TANK. 11/26/2019 2x60' TRENCH COMPLETE LEVEL D BOX W/ SPEED LEVELS. OK TO BACKFILL. (D)

FINAL INSPECTOR

*[Handwritten Signature]*

DATE OF APPROVAL

11/26/2019

RECEIPT ON PERC  
7566444



Bureau of Environmental Health  
8930 Stanford Boulevard, Columbia, MD 21045  
Main: 410-313-2640 | Fax: 410-313-2648  
TDD 410-313-2323 | Toll Free 1-866-313-6300  
www.hchealth.org  
Facebook: www.facebook.com/hocohealth  
Twitter: HowardCoHealthDep

Dr. Maura J. Rossman, M.D., Health Officer

INFORMATION FORM - SEPTIC SYSTEM REPAIR/UPGRADE

Reason for Request:

- Failing System
- System relocation for proposed addition
- System upgrade for proposed addition
- Inadequate treatment zone
- Collapsed septic tank
- Collapsed drywell

Has the septic tank been pumped within the last month?

- Yes Date pumped: \_\_\_\_\_
- No

Was a visual inspection of the septic tank and/or drain fields conducted?

- Yes Explain observations: \_\_\_\_\_
- No

Existing system design

- Drywell
- Trench
- Mound
- Unknown
- Other: \_\_\_\_\_

Was a visual inspection of the sewage line conducted?

- Yes
  - Blockage leading to the tank
    - Yes Explain: \_\_\_\_\_
    - No
  - Blockage leading to the field
    - Yes Explain: \_\_\_\_\_
    - No

Is discharge surfacing on the ground?

- Yes
- No

Additional Comments: \_\_\_\_\_

\*For REPAIRS, are the owners proposing, or do they plan to add in the future, any additions or modifications to the property, i.e. pools, living space additions, garages, etc? This information must be disclosed at the time of this application. The Health Department will not be able to accommodate requests in the field for property modifications unrelated to the repair request. Such requests may require an additional fee, testing, and submittal of a Percolation Certification Plan, if the property does not meet current Code and Regulation.

Septic Contractor: Fogles Septic Clean Contractor's Phone: 410-795-5670

Contractor's Address: 580 Obercent Rd Sykesville 21784

Property Address: 13428 Allnut Lane County file: \_\_\_\_\_

Subdivision: Allnut Farm Estates Lot: 12 Year Built: 1983

Owner's Name: Amar Satharain Owner's Phone: 301-503-1682

Name of previous owners: \_\_\_\_\_ Existing bedrooms: 4  
Proposed bedrooms: \_\_\_\_\_

Has this request been previously discussed with a Sanitarian? (Name): \_\_\_\_\_

Public Sewer available/nearby: \_\_\_\_\_

\*A Sanitarian will be in contact within three business days, depending upon the urgency of the situation, to coordinate the scheduling/review of the repair or upgrade.

\*Prior to scheduling inspections, scaled plans should be submitted to clarify the nature of the addition.\*

Print out a copy of Real Property Data via Dept. of Taxation website \_\_\_\_\_ Indexed file found \_\_\_\_\_

If public sewer may be nearby, verify whether sewer is technically "available" through the Bureau of Engineering.

If sewer is available and the property is within the Metropolitan District, connection to sewer is required. If the owner believes reason for exemption exists, the owner should justify the request in writing.

If soil/site conditions are limited and sewer and/or Metro District status is not conducive to connection, the Sanitarian may recommend pursuit of Emergency Sewer Extension or Emergency Metro District Inclusion. The Owner should contact the Bureau of Utilities for details.

No permit is to be issued nor inspection to be scheduled without prior fee collection at the office unless an emergency situation exists. The contractor is to notify office of the emergency situation as soon as possible.



Bureau of Environmental Health  
 8930 Stanford Boulevard, Columbia, MD 21045  
 Main: 410-313-2640 | Fax: 410-313-2648  
 TDD 410-313-2323 | Toll Free 1-866-313-6300  
 www.hchealth.org  
 Facebook: www.facebook.com/hocohealth  
 Twitter: HowardCoHealthDep

Maura J. Rossman, M.D., Health Officer

SEWAGE DISPOSAL SYSTEM SPECIFICATIONS WORKSHEET

Address: 13428 Allnutt Lane

Subdivision: Allnutt Farm Estates Lot: 12

Initial system: Application rate: \_\_\_\_\_ Effective area beginning depth: \_\_\_\_\_ Bottom maximum depth: \_\_\_\_\_

1<sup>st</sup> Replacement: Application rate: 1.2 Effective area beginning depth: 3.5 Bottom maximum depth: 6.0

2<sup>nd</sup> Replacement: Application rate: \_\_\_\_\_ Effective area beginning depth: \_\_\_\_\_ Bottom maximum depth: \_\_\_\_\_

Design Flow = 150 gallons per day per bedroom

Design flow ÷ application rate = square footage of drainfield required

Linear length of trench required = drainfield square footage x sidewall reduction percentage ÷ trench width

Sidewall reduction credit formula:

$$\frac{W + 2}{W + 1 + 2D} \times 100 = \text{Percent of length of standard trench where } W = \text{trench width and } D = \text{depth between effective area beginning depth and trench bottom.}$$

Standard design requirements:

- Trenches must be located to provide room for 3 systems in the disposal area
- All trenches must be equal length unless low pressure dosed
- All trenches must be on contour
- Tank and trenches must be placed as shallow as possible while maintaining 2% fall in pipe from house and at least 18" cover over trenches. If 2% fall from house is not possible, the minimum allowable fall is 1%.
- Minimum trench spacing: 10' for all trenches utilizing sidewall reduction credit. Additional spacing may be necessary for any trench using over 3.5' of effective sidewall. In those cases, the spacing formula is 2D + W up to a maximum spacing of 18'.
- Minimum trench spacing for trenches with no sidewall credit (bottom area only) is 6' for a 2' wide trench and 9' for a 3' wide trench (spacing is measured edge to edge)
- Maximum trench length is 100'
- Maximum pipe depth is 4'

Additional requirements:

*2 Trenches at 60 feet length (each).  
 Trenches to be 3-ft wide.  
 Plan for 3.0 ft Invert for Distribution Pipe  
 Install manhole and stand pipe on existing  
 Septic Tank. Abandon Pump Tank*

Approved: R Bricker

Date: 11/19/2019