



Howard County
Health Department

Maura J. Rossman, M.D., Health Officer

Bureau of Environmental Health

8930 Stanford Boulevard, Columbia, MD 21045
Main: 410-313-2640 | Fax: 410-313-2648
TDD 410-313-2323 | Toll Free 1-866-313-6300
www.hchealth.org
Facebook: www.facebook.com/hocohealth

RECEIPT DATE: 12/4/19 **ONSITE SEWAGE DISPOSAL SYSTEM** P 566482

APPROVAL DATE: 12/26/19 **PERMIT:** ST **REPAIR** A _____

PROPERTY ADDRESS: 15885 Meadow Walk Road

SUBDIVISION: _____ LOT: _____ TAX ID: 04-329791

CONTRACTOR: Hatfield's Equipment EMAIL: ken@hatfieldsequipment.com

CONTRACTOR ADDRESS: P.O. Box 519, Annapolis Junction, MD 21701 PHONE: 301-490-4289

PROPERTY OWNER: Earl Wright EMAIL: _____

OWNER ADDRESS: 15885 Meadow Walk Road, Woodbine, MD 21797 PHONE: _____

SEPTIC TANK SIZE (GALLONS): Existing PUMP CHAMBER CAPACITY (GALLONS): 1250g PUMP SIZE: 1/2 HP

NUMBER OF BEDROOMS: 3 HOUSE SQ. FT. _____ APPLICATION RATE: _____

DISTRIBUTION SYSTEM: GRAVITY FED LOW PRESSURE DOSED

TRENCHES:	LINEAR FEET REQUIRED: <u>79</u>	INLET DEPTH: <u>3'</u>
	TRENCH WIDTH: <u>3</u>	MAXIMUM BOTTOM DEPTH: <u>8'</u>
	MINIMUM SPACE BETWEEN TRENCHES: <u>8'</u>	EFFECTIVE AREA BEGINNING DEPTH: <u>4'</u>
LOCATION:	TO BE STAKED BY SANITARIAN DURING PRE-CONSTRUCTION INSPECTION.	
NOTES:	Install 2 x trenches above pipe B. upper trench to be 43' and lower trench to be	

ISSUED BY: K. Wolf ISSUE DATE: 12/4/19 EXPIRATION DATE: 12/4/20

- NOTE: CONTRACTOR MUST SCHEDULE A PRE-CONSTRUCTION INSPECTION PRIOR TO BEGINNING ANY INSTALLATION
- NOTE: CONTRACTOR MUST SCHEDULE AN INSPECTION AND GAIN APPROVAL OF ALL COMPONENTS PRIOR TO COVERING
- NOTE: STONE MUST BE APPROVED BY HEALTH DEPARTMENT AND GRAVEL TICKET MUST BE AVAILABLE FOR REVIEW.
- NOTE: WATERTIGHT SEPTIC TANKS REQUIRED
- NOTE: ALL PARTS OF SEPTIC SYSTEM SHALL BE AT LEAST 100 FEET DOWNGRADIENT FROM ANY WATER WELL
- NOTE: MANHOLE RISERS REQUIRED ON ALL SEPTIC TANKS AND PUMP CHAMBERS
- NOTE: AN ELECTRICAL PERMIT IS REQUIRED FOR INSTALLATION OF ANY ELECTRICAL COMPONENTS OF THE SYSTEM
 ELECTRICAL PERMIT ISSUED E 19006641
- NOTE: THE HCHD DOES NOT WARRANTY ANY SYSTEM AND CANNOT GUARANTEE THE PERFORMANCE OF THIS SYSTEM AS DESIGNED. BY ACCEPTING THIS PERMIT, THE OWNER AND/OR APPLICANT ACKNOWLEDGE THAT THE SPECIFICATIONS DETAILED IN THIS DESIGN ARE ONE POSSIBLE OPTION AND THAT THE HCHD WILL REVIEW OTHER PROPOSALS. YOU HAVE THE OPTION TO SEEK THE ADVICE OF A QUALIFIED DESIGN CONSULTANT OR PROFESSIONAL ENGINEER FOR FURTHER GUIDANCE.
- NOTE: MDE RECOMMENDS SEPTIC TANKS, BAT, AND OTHER PRETREATMENT UNITS BE PUMPED AT A FREQUENCY ADEQUATE TO ENSURE THAT SOLIDS ARE NOT DISCHARGED TO THE DISPOSAL AREA

NEITHER THE HOWARD COUNTY COUNCIL NOR THE HEALTH DEPARTMENT IS RESPONSIBLE FOR THE SUCCESSFUL OPERATION OF ANY SYSTEM.
PERMITTEE RESPONSIBLE FOR OBTAINING FINAL APPROVAL ON THIS PERMIT.
CALL 410-313-1771 TO SCHEDULE INSPECTIONS.

NOT TO SCALE

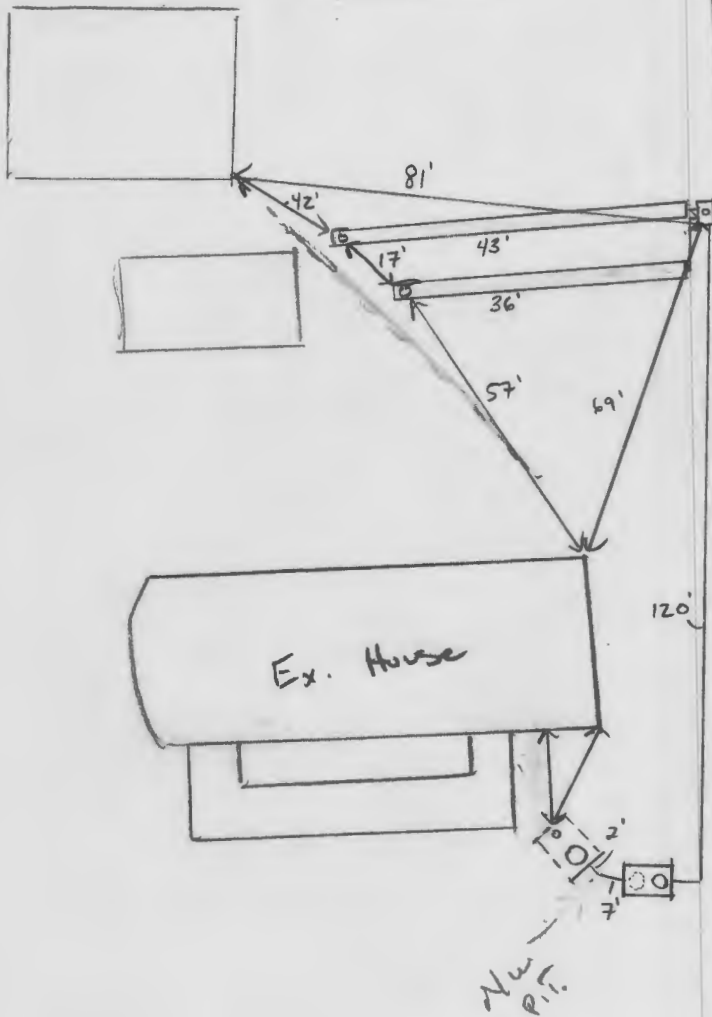

ROAD NAME

TRENCH/DRAINFIELD DATA

WIDTH	INLET	BOTTOM
3'	3'	8'
NUMBER OF TRENCHES		2
TOTAL LENGTH		79 F
ABSORPTION AREA		237 SF
DISTRIBUTION BOX LEVEL		NA
DISTRIBUTION BOX BAFFLE		YES
DISTRIBUTION BOX PORT		YES

SEPTIC TANK DATA

SEPTIC TANK 1 LEVEL	
MANUFACTURER	
CAPACITY	GAL
SEAM LOC	
TANK LID DEPTH	
BAFFLES	
BAFFLE FILTER	
MANHOLE LOC	
6" PORT LOC	
WATERTIGHT TEST	
SLOTTED	
DATE ON LID	

EXISTING

PUMP/SEPTIC TANK LEVEL	
MANUFACTURER	BABYLON
CAPACITY	1250 GAL
SEAM LOC	TOP
TANK LID DEPTH	2
BAFFLES	INLET
BAFFLE FILTER	-
MANHOLE LOC	OUTLET
6" PORT LOC	-
WATERTIGHT TEST	-
SLOTTED	-
DATE ON LID	10/02/2019

PRE-CONSTRUCTION:

11/25/19 set new P.I.T. just after ex. S.T. Install 2 trenches between property line and retaining wall. Trenches should be approx 8-10' removed from retaining wall (K)

INSTALLATION:

12/15/2019 D box SET AND TRENCHES. UPPER TRENCH NEEDS STONE FOR LAST 16'. REINSPEC @ 12/19/2019 UPPER TRENCH COMPLETED. TANK SET AND TIED IN TO EX ST. FORCE MAIN INSTALLED. NEW OUTLET RISER INSTALLED ON EX TANK. F.M. 90s DOWN INTO D BOX ON KNOCKED OVER BAFFLE @ 12/26/19 Observed water flowing in d-box when pump was on. Alarm works (alarm located outside next to pump tank manhole.) Pump and alarm on separate breakers. (ST)

FINAL INSPECTOR

Juden Thomas

DATE OF APPROVAL

12/26/19



Park Repair



Bureau of Environmental Health

8930 Stanford Boulevard, Columbia, MD 21045
Main: 410-313-2640 | Fax: 410-313-2648
TDD 410-313-2323 | Toll Free 1-866-313-6300
www.hchealth.org
Facebook: www.facebook.com/hocohealth
Twitter: HowardCoHealthDep

Dr. Maura J. Rossman, M.D., Health Officer

INFORMATION FORM - SEPTIC SYSTEM REPAIR/UPGRADE

Reason for Request:

- Failing System
System relocation for proposed addition
System upgrade for proposed addition
Inadequate treatment zone
Collapsed septic tank
Collapsed drywell

Has the septic tank been pumped within the last month?

- Yes Date pumped: NA
No

Was a visual inspection of the septic tank and/or drain fields conducted?

- Yes Explain observations:
No

Existing system design

- Drywell
Trench
Mound
Unknown
Other:

Was a visual inspection of the sewage line conducted?

- Yes
Blockage leading to the tank
Yes Explain:
No
Blockage leading to the field
Yes Explain: Failure
No

Is discharge surfacing on the ground?

- Yes
No

Additional Comments: Park Complete

*For REPAIRS, are the owners proposing, or do they plan to add in the future, any additions or modifications to the property, i.e. pools, living space additions, garages, etc? This information must be disclosed at the time of this application. The Health Department will not be able to accommodate requests in the field for property modifications unrelated to the repair request. Such requests may require an additional fee, testing, and submittal of a Percolation Certification Plan, if the property does not meet current Code and Regulation.

Septic Contractor: Hatfields Equipment Inc Contractor's Phone: 301 490 4259
Contractor's Address: P.O. Box 519 Annapolis Junction MD

Property Address: 15885 Meadow Walk Rd County file:
Subdivision: Lot: Year Built:
Owner's Name: Earl Wright Owner's Phone:

Name of previous owners: Existing bedrooms: 3
Proposed bedrooms:

Has this request been previously discussed with a Sanitarian? (Name): Kevin Wolf
Public Sewer available/nearby: No

*A Sanitarian will be in contact within three business days, depending upon the urgency of the situation, to coordinate the scheduling/review of the repair or upgrade.

Prior to scheduling inspections, scaled plans should be submitted to clarify the nature of the addition.

Print out a copy of Real Property Data via Dept. of Taxation website Indexed file found

If public sewer may be nearby, verify whether sewer is technically "available" through the Bureau of Engineering.

If sewer is available and the property is within the Metropolitan District, connection to sewer is required; if the owner believes reason for exemption exists, the owner should justify the request in writing.

If soil/site conditions are limited and sewer and/or Metro District status is not conducive to connection, the Sanitarian may recommend pursuit of Emergency Sewer Extension or Emergency Metro District Inclusion. The Owner should contact the Bureau of Utilities for details.

No permit is to be issued nor inspection to be scheduled without prior fee collection at the office unless an emergency situation exists. The contractor is to notify office of the emergency situation as soon as possible.