



# Building Permit Application

Howard County Maryland  
Department of Inspections, Licenses and Permits  
3430 Court House Drive  
Permits: 410-313-2455  
www.howardcountymd.gov

Date Received: \_\_\_\_\_

Permit No.: \_\_\_\_\_

Building Address: 2882 Evergreen Ct.  
City: Ellicott City State: MD Zip Code: 21042  
Suite/Apt. #: \_\_\_\_\_ SDP/WP/BA #: \_\_\_\_\_  
Subdivision: Green Henge  
Lot: \_\_\_\_\_ Tax Map: \_\_\_\_\_ Parcel: \_\_\_\_\_

Existing Use: Residential  
Proposed Use: Residential

Estimated Construction Cost: \$ \_\_\_\_\_  
Description of Work: Replace existing deck with new. No change in size/location

Occupant/Tenant Name: \_\_\_\_\_  
Was tenant space previously occupied?  Yes  No  
Contact Name: \_\_\_\_\_  
Address: \_\_\_\_\_  
City: \_\_\_\_\_ State: \_\_\_\_\_ Zip Code: \_\_\_\_\_  
Phone: \_\_\_\_\_ Fax: \_\_\_\_\_  
Email: \_\_\_\_\_

Property Owner's Name: Apex Investors, Inc.  
Address: 430 Lemley Dr.  
City: Oakland State: MD Zip Code: 21550  
Phone: 410-493-1732 Fax: \_\_\_\_\_  
Email: bobbydye123@gmail.com

Applicant's Name & Mailing Address, (if other than stated herein)  
Applicant's Name: \_\_\_\_\_  
Address: \_\_\_\_\_  
City: \_\_\_\_\_ State: \_\_\_\_\_ Zip Code: \_\_\_\_\_  
Phone: \_\_\_\_\_ Fax: \_\_\_\_\_  
Email: \_\_\_\_\_

Contractor Company: Owner to build  
Contact Person: Robert Dyke  
Address: 430 Lemley Dr.  
City: Oakland State: MD Zip Code: 21550  
License No.: N/A  
Phone: 410-493-1732 Fax: \_\_\_\_\_  
Email: bobbydye123@gmail.com

Engineer/Architect Company: \_\_\_\_\_  
Responsible Design Prof.: \_\_\_\_\_  
Address: \_\_\_\_\_  
City: \_\_\_\_\_ State: \_\_\_\_\_ Zip Code: \_\_\_\_\_  
Phone: \_\_\_\_\_ Fax: \_\_\_\_\_  
Email: \_\_\_\_\_

Commercial Building Characteristics	Residential Building Characteristics	
Height:	<input checked="" type="checkbox"/> SF Dwelling <input type="checkbox"/> SF Townhouse	
No. of stories:	Depth	Width
Gross area, sq. ft./floor:	1st floor:	
	2nd floor:	
Area of construction (sq. ft.):	Basement:	
	<input type="checkbox"/> Finished Basement	
Use group:	<input type="checkbox"/> Unfinished Basement	
	<input type="checkbox"/> Crawl Space	
<u>Construction type:</u>	<input type="checkbox"/> Slab on Grade	
<input type="checkbox"/> Reinforced Concrete	No. of Bedrooms:	
<input type="checkbox"/> Structural Steel	<u>Multi-family Dwelling</u>	
<input type="checkbox"/> Masonry	No. of efficiency units:	
<input type="checkbox"/> Wood Frame	No. of 1 BR units:	
<input type="checkbox"/> State Certified Modular	No. of 2 BR units:	
	No. of 3 BR units:	
	Other Structure:	
	Dimensions:	
<input checked="" type="checkbox"/> <b>Roadside Tree Project Permit</b>	Footings:	
<input type="checkbox"/> Yes <input type="checkbox"/> No	Roof:	
<b>Roadside Tree Project Permit #</b>	<input type="checkbox"/> State Certified Modular	
	<input type="checkbox"/> Manufactured Home	

Utilities	
Electric:	<input checked="" type="checkbox"/> Yes <input type="checkbox"/> No
Gas:	<input checked="" type="checkbox"/> Yes <input type="checkbox"/> No
Water Supply	
<input type="checkbox"/> Public	
<input checked="" type="checkbox"/> Private	
Sewage Disposal	
<input type="checkbox"/> Public	
<input checked="" type="checkbox"/> Private	
Heating System	
<input type="checkbox"/> Electric <input type="checkbox"/> Oil	
<input type="checkbox"/> Natural Gas <input type="checkbox"/> Propane Gas	
<input type="checkbox"/> Other:	
Sprinkler System:	
<input type="checkbox"/> Yes <input type="checkbox"/> No	
Grading Permit Number: _____	
Building Shell Permit Number: _____	

THE UNDERSIGNED HEREBY CERTIFIES AND AGREES AS FOLLOWS: (1) THAT HE/SHE IS AUTHORIZED TO MAKE THIS APPLICATION; (2) THAT THE INFORMATION IS CORRECT; (3) THAT HE/SHE WILL COMPLY WITH ALL REGULATIONS OF HOWARD COUNTY WHICH ARE APPLICABLE THERETO; (4) THAT HE/SHE WILL PERFORM NO WORK ON THE ABOVE REFERENCED PROPERTY NOT SPECIFICALLY DESCRIBED IN THIS APPLICATION; (5) THAT HE/SHE GRANTS COUNTY OFFICIALS THE RIGHT TO ENTER ONTO THIS PROPERTY FOR THE PURPOSE OF INSPECTING THE WORK PERMITTED AND POSTING NOTICES.

[Signature]  
Applicant's Signature  
bobbydye123@gmail.com  
Email Address

Robert Dyke  
Print Name  
Date: \_\_\_\_\_

Title/Company \_\_\_\_\_

Checks Payable to: DIRECTOR OF FINANCE OF HOWARD COUNTY  
\*\*PLEASE WRITE NEATLY & LEGIBLY\*\*  
-FOR OFFICE USE ONLY-

AGENCY	DATE	SIGNATURE OF APPROVAL
State Highways		
Building Officials		
PSZA ( Zoning )		
PSZA ( Engineering )		
Health		<u>N-15-D Beumud</u>

Is Sediment Control approval required for issuance?  Yes  No  
 CONTINGENCY CONSTRUCTION START

DPZ SETBACK INFORMATION
Front:
Rear:
Side:
Side St.:
All minimum setbacks met? <input type="checkbox"/> Yes <input type="checkbox"/> No
Is Entrance Permit Required? <input type="checkbox"/> Yes <input type="checkbox"/> No
Historic District? <input type="checkbox"/> Yes <input type="checkbox"/> No
Lot Coverage for New Town Zone:
SDP/Red-line approval date:

Filing Fee	\$
Permit Fee	\$
Tech Fee	\$
Excise Tax	\$
PSFS	\$
Guaranty Fund	\$
Add'l per Fee	\$
Total Fees	\$
Sub- Total Paid	\$
Balance Due	\$
Check	#

55  
(100.00) - NOV  
Gold: SHA

Distribution of Copies: White: Building Officials Green: PSZA,Zoning Yellow: PSZA,Engineering Pink: Health Gold: SHA

PROPERTY ADDRESS: 2882 EVERGREEN COURT

ELLCOTT CITY, MARYLAND 21042

SURVEY NUMBER: 1911.2291

FIELD WORK DATE: 11/14/2019

REVISION HISTORY: (REV.1 11/14/2019)

1911.2291  
LOCATION DRAWING  
LOT 30  
GREEN HEDGE  
HOWARD COUNTY, MARYLAND  
11-14-2019 SCALE 1"=50'

# APPROVED WALK-THRU BUILDING PERMIT

BP# \_\_\_\_\_ A# \_\_\_\_\_  
APP. SAN. D. Bernard DATE: 11-15 19  
TYPE OF WORK: replace existing Deck



P. HENNESSY  
34 / 581

LOT 30  
41,537 S.F.

**PLEASE NOTE**  
This House Location Drawing is for informational purposes only. Per Maryland State Code it may not be relied upon to determine property boundaries and may not be used for building permits or construction.

*Dry Well*

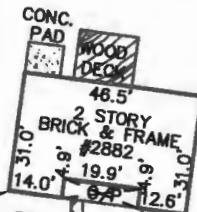

LOT 29  
20' D.E.

BRICK S/W

MAC. D/W

WELL



*William R. Hebert*  
EXPIRES 1-14-2021

R=50.00' A=59.70' (P)  
EVERGREEN COURT  
(50' R/W)



GRAPHIC SCALE (In Feet)  
1 inch = 50' ft.

ACCURACY=3±

POINTS OF INTEREST:  
NONE VISIBLE

CLIENT NUMBER:

DATE: 11/14/19

POWERED BY:

BUYER: ROBERT DYKE

SELLER: APEX INVESTORS INC

