



Health

# Building Permit Application

Howard County Maryland  
Department of Inspections, Licenses and Permits  
3430 Court House Drive  
Permits: 410-313-2455  
www.howardcountymd.gov

DILP 2019 DEC 16 PM 12:13  
Date Received: \_\_\_\_\_

Permit No.: B19004245

Building Address: 6855 HAVILAND MILL ROAD  
 City: CLARKSVILLE State: MD Zip Code: 21029  
 Suite/Apt. # \_\_\_\_\_ SDP/WP/BA #: \_\_\_\_\_  
 Census Tract: \_\_\_\_\_ Subdivision: \_\_\_\_\_  
 Section: \_\_\_\_\_ Area: \_\_\_\_\_ Lot: \_\_\_\_\_  
 Tax Map: \_\_\_\_\_ Parcel: \_\_\_\_\_ Grid: \_\_\_\_\_  
 Zoning: \_\_\_\_\_ Map Coordinates: \_\_\_\_\_ Lot Size: \_\_\_\_\_

Existing Use: SFD  
 Proposed Use: SFD W/PROPANE TANK  
 Estimated Construction Cost: \$ 4,000

Description of Work:  
INSTALL 330 GAL ABOVE GROUND  
PROPANE TANK

Occupant/Tenant Name: OWNER  
 Was tenant space previously occupied?  Yes  No  
 Contact Name: \_\_\_\_\_  
 Address: \_\_\_\_\_  
 City: \_\_\_\_\_ State: \_\_\_\_\_ Zip Code: \_\_\_\_\_  
 Phone: \_\_\_\_\_ Fax: \_\_\_\_\_  
 Email: \_\_\_\_\_

Property Owner's Name: TOM FIFER -CANBY  
 Address: 6855 HAVILAND MILL ROAD  
 City: CLARKSVILLE State: MD Zip Code: 21029  
 Phone: \_\_\_\_\_ Fax: \_\_\_\_\_  
 Email: \_\_\_\_\_

**Applicant's Name & Mailing Address, (If other than stated herein)**  
 Applicant's Name: MICHELLE CLANCY  
 Address: PO BOX 310  
 City: PERRY HALL State: MD Zip Code: 21128  
 Phone: 443-610-7514 Fax: \_\_\_\_\_  
 Email: MICHELLE@APPLIEDANDAPPROVED.COM

Contractor Company: HJ POIST  
 Contact Person: SEAN UNDERWOOD  
 Address: 360 MAIN STREET  
 City: LAUREL State: MD Zip Code: 20707  
 License No.: 103851  
 Phone: 301-725-3232 Fax: \_\_\_\_\_  
 Email: \_\_\_\_\_

Engineer/Architect Company: CONTRACTOR  
 Responsible Design Prof.: \_\_\_\_\_  
 Address: \_\_\_\_\_  
 City: \_\_\_\_\_ State: \_\_\_\_\_ Zip Code: \_\_\_\_\_  
 Phone: \_\_\_\_\_ Fax: \_\_\_\_\_  
 Email: \_\_\_\_\_

Commercial Building Characteristics	Residential Building Characteristics
Height:	<input checked="" type="checkbox"/> SF Dwelling <input type="checkbox"/> SF Townhouse
No. of stories:	<b>Depth</b> <b>Width</b>
Gross area, sq. ft./floor:	1 <sup>st</sup> floor:
Area of construction (sq. ft.):	2 <sup>nd</sup> floor:
Use group:	Basement:
	<input type="checkbox"/> Finished Basement
	<input type="checkbox"/> Unfinished Basement
	<input type="checkbox"/> Crawl Space
<b>Construction type:</b>	<input type="checkbox"/> Slab on Grade
<input type="checkbox"/> Reinforced Concrete	No. of Bedrooms:
<input type="checkbox"/> Structural Steel	<b>Multi-family Dwelling</b>
<input type="checkbox"/> Masonry	No. of efficiency units:
<input type="checkbox"/> Wood Frame	No. of 1 BR units:
<input type="checkbox"/> State Certified Modular	No. of 2 BR units:
	No. of 3 BR units:
	Other Structure:
	Dimensions:
<input checked="" type="checkbox"/> <b>Roadside Tree Project Permit</b>	Footings:
<input type="checkbox"/> Yes <input checked="" type="checkbox"/> No	Roof:
<b>Roadside Tree Project Permit #</b>	<input type="checkbox"/> State Certified Modular
	<input type="checkbox"/> Manufactured Home

Utilities	
Electric:	<input type="checkbox"/> Yes <input type="checkbox"/> No
Gas:	<input checked="" type="checkbox"/> Yes <input type="checkbox"/> No
Water Supply	
<input type="checkbox"/> Public	
<input checked="" type="checkbox"/> Private	
Sewage Disposal	
<input type="checkbox"/> Public	
<input checked="" type="checkbox"/> Private	
Heating System	
<input type="checkbox"/> Electric <input type="checkbox"/> Oil	
<input type="checkbox"/> Natural Gas <input type="checkbox"/> Propane Gas	
<input type="checkbox"/> Other:	
Sprinkler System:	
<input type="checkbox"/> Yes <input type="checkbox"/> No	
Grading Permit Number:	
Building Shell Permit Number:	

THE UNDERSIGNED HEREBY CERTIFIES AND AGREES AS FOLLOWS: (1) THAT HE/SHE IS AUTHORIZED TO MAKE THIS APPLICATION; (2) THAT THE INFORMATION IS CORRECT; (3) THAT HE/SHE WILL COMPLY WITH ALL REGULATIONS OF HOWARD COUNTY WHICH ARE APPLICABLE THERETO; (4) THAT HE/SHE WILL PERFORM NO WORK ON THE ABOVE REFERENCED PROPERTY NOT SPECIFICALLY DESCRIBED IN THIS APPLICATION; (5) THAT HE/SHE GRANTS COUNTY OFFICIALS THE RIGHT TO ENTER ONTO THIS PROPERTY FOR THE PURPOSE OF INSPECTING THE WORK PERMITTED AND POSTING NOTICES.

MICHELLE CLANCY  
 Applicant's Signature  
MICHELLE@APPLIEDANDAPPROVED.COM  
 Email Address  
PERMITS  
 Title/Company

MICHELLE CLANCY  
 Print Name  
12/17/19  
 Date

Checks Payable to: DIRECTOR OF FINANCE OF HOWARD COUNTY  
 \*\*PLEASE WRITE NEATLY & LEGIBLY\*\*  
 -FOR OFFICE USE ONLY-

AGENCY	DATE	SIGNATURE OF APPROVAL
State Highways		
Building Officials		
PSZA (Zoning)		
PSZA (Engineering)		
Health	<u>12/23/19</u>	<u>[Signature]</u>

Is Sediment Control approval required for issuance?  Yes  No  
 CONTINGENCY CONSTRUCTION START

DPZ SETBACK INFORMATION	
Front:	
Rear:	
Side:	
Side St.:	
All minimum setbacks met?	<input type="checkbox"/> Yes <input type="checkbox"/> No
Is Entrance Permit Required?	<input type="checkbox"/> Yes <input type="checkbox"/> No
Historic District?	<input type="checkbox"/> Yes <input type="checkbox"/> No
Lot Coverage for New Town Zone:	
SDP/Red-line approval date:	

Filing Fee	\$ <u>110.00</u>
Permit Fee	\$
Tech Fee	\$
Excise Tax	\$
PSFS	\$
Guaranty Fund	\$
Add'l per Fee	\$
Total Fees	\$
Sub-Total Paid	\$
Balance Due	\$
Check	# <u>7302</u>

Distribution of Copies: White: Building Officials Green: PSZA,Zoning Yellow: PSZA,Engineering Pink: Health Gold: SHA

FROM/TO	NUMBER (INSTR.)	QUANTITY	SIZE	DESCRIPTION	U.S. PIPE	MECH. NO.
1-2			R2	2" AL 15' X 1 1/2"		23-181

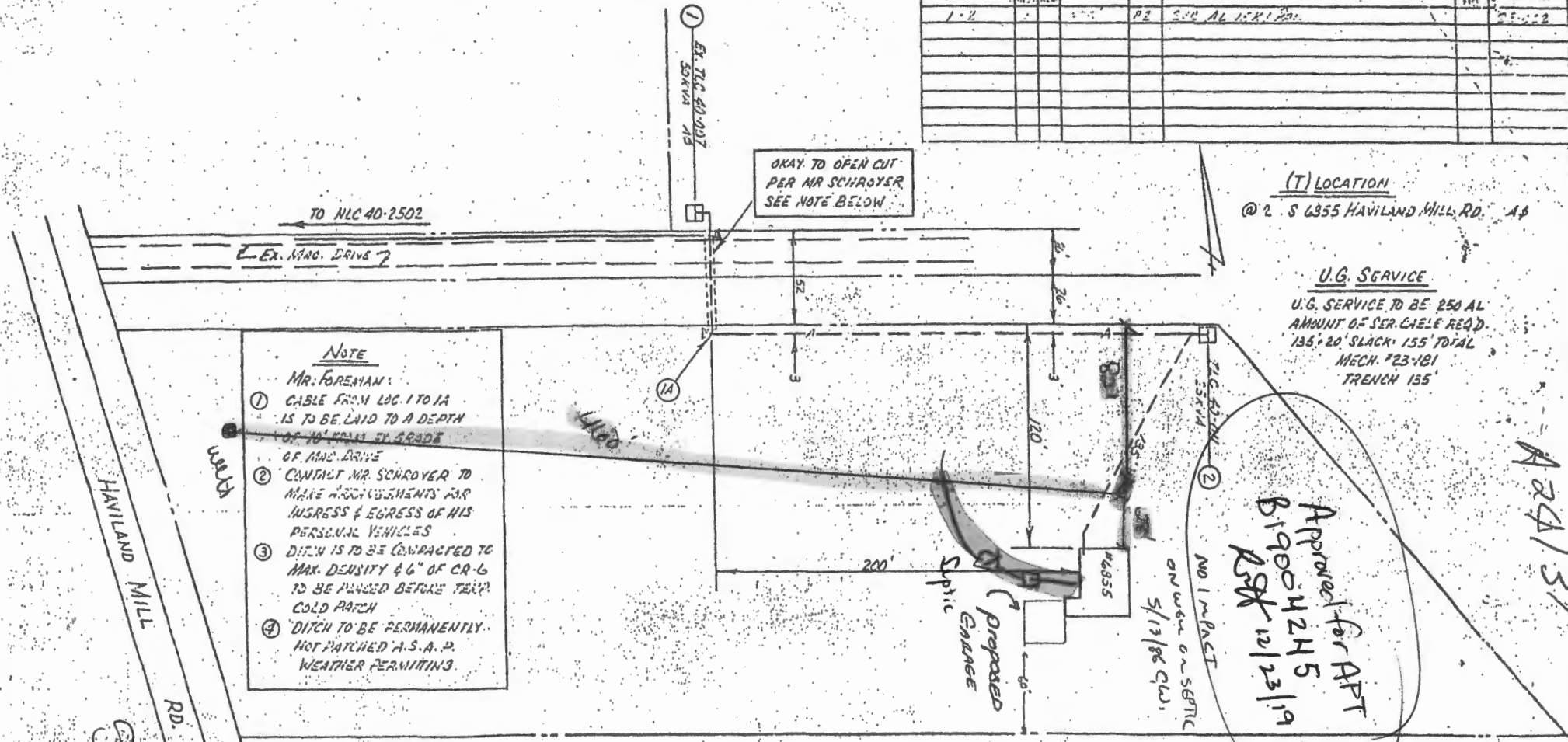

AGREEMENT FROM: [ ] R/W NO. [ ] DATE [ ]		LOCATION OF GAS & ELECTRIC FACILITIES APPROVED		SCALE 50 100		LOCATION 6855 HAVILAND MILL RD.	
CALL MISS UTILITY (COLLECT) 40 HRS. BEFORE STARTING WORK (301) 555-0100		TEST PSIG 450 PSIG		DESIGNER ALBANY		PHONE 7-8900	
SYMBOLS - SEE BOOK FOR DETAILS		PERMITS [ ] CITY [ ]		CONSTR. DESIGN [ ]		NAME THOMAS CANBY	
PROPOSED GAS AND/OR ELECTRIC TRENCH		STATE [ ]		ENGINEERING CK [ ]		LOCALITY CLARKSVILLE	
EXISTING GAS AND/OR ELECTRIC FACILITIES		ST. LT. CERTIF. [ ]		RIGHT-OF-WAY CK [ ]		OBJECT OF WORK INSTALL U.G. E.L.C. TO NEW CUSTOMER	
REVISION [ ] BY [ ] DATE [ ]		GAS <input type="checkbox"/> OH <input type="checkbox"/> UG <input type="checkbox"/>		PLATE NO. [ ]		BASED ON WORK WITH [ ]	
TRANS USE ( ) 2 3 4 5 6 7		STAKED YES NO		DIGGER YES NO		FILES 1-2145-A OF 1-2145-B OF 1-2145-C OF 1-2145-D OF 1-2145-E OF 1-2145-F OF 1-2145-G OF 1-2145-H OF 1-2145-I OF 1-2145-J OF 1-2145-K OF 1-2145-L OF 1-2145-M OF 1-2145-N OF 1-2145-O OF 1-2145-P OF 1-2145-Q OF 1-2145-R OF 1-2145-S OF 1-2145-T OF 1-2145-U OF 1-2145-V OF 1-2145-W OF 1-2145-X OF 1-2145-Y OF 1-2145-Z OF 1-2145-AA OF 1-2145-AB OF 1-2145-AC OF 1-2145-AD OF 1-2145-AE OF 1-2145-AF OF 1-2145-AG OF 1-2145-AH OF 1-2145-AI OF 1-2145-AJ OF 1-2145-AM OF 1-2145-AN OF 1-2145-AO OF 1-2145-AP OF 1-2145-AQ OF 1-2145-AR OF 1-2145-AS OF 1-2145-AT OF 1-2145-AU OF 1-2145-AV OF 1-2145-AW OF 1-2145-AX OF 1-2145-AY OF 1-2145-AZ OF 1-2145-BA OF 1-2145-BB OF 1-2145-BC OF 1-2145-BD OF 1-2145-BE OF 1-2145-BF OF 1-2145-BG OF 1-2145-BH OF 1-2145-BI OF 1-2145-BJ OF 1-2145-BM OF 1-2145-BN OF 1-2145-BO OF 1-2145-BP OF 1-2145-BQ OF 1-2145-BR OF 1-2145-BS OF 1-2145-BT OF 1-2145-BU OF 1-2145-BV OF 1-2145-BW OF 1-2145-BX OF 1-2145-BY OF 1-2145-BZ OF 1-2145-CA OF 1-2145-CB OF 1-2145-CC OF 1-2145-CD OF 1-2145-CE OF 1-2145-CF OF 1-2145-CG OF 1-2145-CH OF 1-2145-CI OF 1-2145-CJ OF 1-2145-CM OF 1-2145-CN OF 1-2145-CO OF 1-2145-CP OF 1-2145-CQ OF 1-2145-CR OF 1-2145-CS OF 1-2145-CT OF 1-2145-CU OF 1-2145-CV OF 1-2145-CW OF 1-2145-CX OF 1-2145-CY OF 1-2145-CZ OF 1-2145-DA OF 1-2145-DB OF 1-2145-DC OF 1-2145-DD OF 1-2145-DE OF 1-2145-DF OF 1-2145-DG OF 1-2145-DH OF 1-2145-DI OF 1-2145-DJ OF 1-2145-DM OF 1-2145-DN OF 1-2145-DO OF 1-2145-DP OF 1-2145-DQ OF 1-2145-DR OF 1-2145-DS OF 1-2145-DT OF 1-2145-DU OF 1-2145-DV OF 1-2145-DW OF 1-2145-DX OF 1-2145-DY OF 1-2145-DZ OF 1-2145-EA OF 1-2145-EB OF 1-2145-EC OF 1-2145-ED OF 1-2145-EE OF 1-2145-EF OF 1-2145-EG OF 1-2145-EH OF 1-2145-EI OF 1-2145-EJ OF 1-2145-EM OF 1-2145-EN OF 1-2145-EO OF 1-2145-EP OF 1-2145-EQ OF 1-2145-ER OF 1-2145-ES OF 1-2145-ET OF 1-2145-EU OF 1-2145-EV OF 1-2145-EW OF 1-2145-EX OF 1-2145-EY OF 1-2145-EZ OF 1-2145-FA OF 1-2145-FB OF 1-2145-FC OF 1-2145-FD OF 1-2145-FE OF 1-2145-FF OF 1-2145-FG OF 1-2145-FH OF 1-2145-FI OF 1-2145-FJ OF 1-2145-FM OF 1-2145-FN OF 1-2145-FO OF 1-2145-FP OF 1-2145-FQ OF 1-2145-FR OF 1-2145-FS OF 1-2145-FT OF 1-2145-FU OF 1-2145-FV OF 1-2145-FW OF 1-2145-FX OF 1-2145-FY OF 1-2145-FZ OF 1-2145-GA OF 1-2145-GB OF 1-2145-GC OF 1-2145-GD OF 1-2145-GE OF 1-2145-GF OF 1-2145-GG OF 1-2145-GH OF 1-2145-GI OF 1-2145-GJ OF 1-2145-GM OF 1-2145-GN OF 1-2145-GO OF 1-2145-GP OF 1-2145-GQ OF 1-2145-GR OF 1-2145-GS OF 1-2145-GT OF 1-2145-GU OF 1-2145-GV OF 1-2145-GW OF 1-2145-GX OF 1-2145-GY OF 1-2145-GZ OF 1-2145-HA OF 1-2145-HB OF 1-2145-HC OF 1-2145-HD OF 1-2145-HE OF 1-2145-HF OF 1-2145-HG OF 1-2145-HH OF 1-2145-HI OF 1-2145-HJ OF 1-2145-HM OF 1-2145-HN OF 1-2145-HO OF 1-2145-HP OF 1-2145-HQ OF 1-2145-HR OF 1-2145-HS OF 1-2145-HT OF 1-2145-HU OF 1-2145-HV OF 1-2145-HW OF 1-2145-HX OF 1-2145-HY OF 1-2145-HZ OF 1-2145-IA OF 1-2145-IB OF 1-2145-IC OF 1-2145-ID OF 1-2145-IE OF 1-2145-IF OF 1-2145-IG OF 1-2145-IH OF 1-2145-II OF 1-2145-IM OF 1-2145-IN OF 1-2145-IO OF 1-2145-IP OF 1-2145-IQ OF 1-2145-IR OF 1-2145-IS OF 1-2145-IT OF 1-2145-IU OF 1-2145-IV OF 1-2145-IW OF 1-2145-IX OF 1-2145-IY OF 1-2145-IZ OF 1-2145-JA OF 1-2145-JB OF 1-2145-JC OF 1-2145-JD OF 1-2145-JE OF 1-2145-JF OF 1-2145-JG OF 1-2145-JH OF 1-2145-JI OF 1-2145-JM OF 1-2145-JN OF 1-2145-JO OF 1-2145-JP OF 1-2145-JQ OF 1-2145-JR OF 1-2145-JS OF 1-2145-JT OF 1-2145-JU OF 1-2145-JV OF 1-2145-JW OF 1-2145-JX OF 1-2145-JY OF 1-2145-JZ OF 1-2145-KA OF 1-2145-KB OF 1-2145-KC OF 1-2145-KD OF 1-2145-KE OF 1-2145-KF OF 1-2145-KG OF 1-2145-KH OF 1-2145-KI OF 1-2145-KM OF 1-2145-KN OF 1-2145-KO OF 1-2145-KP OF 1-2145-KQ OF 1-2145-KR OF 1-2145-KS OF 1-2145-KT OF 1-2145-KU OF 1-2145-KV OF 1-2145-KW OF 1-2145-KX OF 1-2145-KY OF 1-2145-KZ OF 1-2145-LA OF 1-2145-LB OF 1-2145-LC OF 1-2145-LD OF 1-2145-LE OF 1-2145-LF OF 1-2145-LG OF 1-2145-LH OF 1-2145-LI OF 1-2145-LM OF 1-2145-LN OF 1-2145-LO OF 1-2145-LP OF 1-2145-LQ OF 1-2145-LR OF 1-2145-LS OF 1-2145-LT OF 1-2145-LU OF 1-2145-LV OF 1-2145-LW OF 1-2145-LX OF 1-2145-LY OF 1-2145-LZ OF 1-2145-MA OF 1-2145-MB OF 1-2145-MC OF 1-2145-MD OF 1-2145-ME OF 1-2145-MF OF 1-2145-MG OF 1-2145-MH OF 1-2145-MI OF 1-2145-MJ OF 1-2145-MM OF 1-2145-MN OF 1-2145-MO OF 1-2145-MP OF 1-2145-MQ OF 1-2145-MR OF 1-2145-MS OF 1-2145-MT OF 1-2145-MU OF 1-2145-MV OF 1-2145-MW OF 1-2145-MX OF 1-2145-MY OF 1-2145-MZ OF 1-2145-NA OF 1-2145-NB OF 1-2145-NC OF 1-2145-ND OF 1-2145-NE OF 1-2145-NF OF 1-2145-NG OF 1-2145-NH OF 1-2145-NI OF 1-2145-NM OF 1-2145-NN OF 1-2145-NO OF 1-2145-NP OF 1-2145-NQ OF 1-2145-NR OF 1-2145-NS OF 1-2145-NT OF 1-2145-NU OF 1-2145-NV OF 1-2145-NW OF 1-2145-NX OF 1-2145-NY OF 1-2145-NZ OF 1-2145-OA OF 1-2145-OB OF 1-2145-OC OF 1-2145-OD OF 1-2145-OE OF 1-2145-OF OF 1-2145-OG OF 1-2145-OH OF 1-2145-OI OF 1-2145-OJ OF 1-2145-OM OF 1-2145-ON OF 1-2145-OO OF 1-2145-OP OF 1-2145-OQ OF 1-2145-OR OF 1-2145-OS OF 1-2145-OT OF 1-2145-OU OF 1-2145-OV OF 1-2145-OW OF 1-2145-OX OF 1-2145-OY OF 1-2145-OZ OF 1-2145-PA OF 1-2145-PB OF 1-2145-PC OF 1-2145-PD OF 1-2145-PE OF 1-2145-PF OF 1-2145-PG OF 1-2145-PH OF 1-2145-PI OF 1-2145-PM OF 1-2145-PN OF 1-2145-PO OF 1-2145-PP OF 1-2145-PQ OF 1-2145-PR OF 1-2145-PS OF 1-2145-PT OF 1-2145-PU OF 1-2145-PV OF 1-2145-PW OF 1-2145-PX OF 1-2145-PY OF 1-2145-PZ OF 1-2145-QA OF 1-2145-QB OF 1-2145-QC OF 1-2145-QD OF 1-2145-QE OF 1-2145-QF OF 1-2145-QG OF 1-2145-QH OF 1-2145-QI OF 1-2145-QJ OF 1-2145-QM OF 1-2145-QN OF 1-2145-QO OF 1-2145-QP OF 1-2145-QL OF 1-2145-QR OF 1-2145-QS OF 1-2145-QU OF 1-2145-QV OF 1-2145-QW OF 1-2145-QX OF 1-2145-QY OF 1-2145-QZ OF 1-2145-RA OF 1-2145-RB OF 1-2145-RC OF 1-2145-RD OF 1-2145-RE OF 1-2145-RF OF 1-2145-RG OF 1-2145-RH OF 1-2145-RI OF 1-2145-RM OF 1-2145-RN OF 1-2145-RO OF 1-2145-RR OF 1-2145-RS OF 1-2145-RT OF 1-2145-RU OF 1-2145-RV OF 1-2145-RW OF 1-2145-RX OF 1-2145-RY OF 1-2145-RZ OF 1-2145-SA OF 1-2145-SB OF 1-2145-SC OF 1-2145-SD OF 1-2145-SE OF 1-2145-SF OF 1-2145-SG OF 1-2145-SH OF 1-2145-SI OF 1-2145-SM OF 1-2145-SN OF 1-2145-SO OF 1-2145-SS OF 1-2145-ST OF 1-2145-SU OF 1-2145-SV OF 1-2145-SW OF 1-2145-SX OF 1-2145-SY OF 1-2145-SZ OF 1-2145-TA OF 1-2145-TB OF 1-2145-TC OF 1-2145-TD OF 1-2145-TE OF 1-2145-TF OF 1-2145-TG OF 1-2145-TH OF 1-2145-TI OF 1-2145-TM OF 1-2145-TN OF 1-2145-TO OF 1-2145-TT OF 1-2145-TU OF 1-2145-TV OF 1-2145-TW OF 1-2145-TX OF 1-2145-TY OF 1-2145-TZ OF 1-2145-UA OF 1-2145-UB OF 1-2145-UC OF 1-2145-UD OF 1-2145-UE OF 1-2145-UF OF 1-2145-UG OF 1-2145-UH OF 1-2145-UI OF 1-2145-UJ OF 1-2145-UM OF 1-2145-UN OF 1-2145-UO OF 1-2145-UR OF 1-2145-US OF 1-2145-UT OF 1-2145-UY OF 1-2145-UZ OF 1-2145-VA OF 1-2145-VB OF 1-2145-VC OF 1-2145-VD OF 1-2145-VE OF 1-2145-VF OF 1-2145-VG OF 1-2145-VH OF 1-2145-VI OF 1-2145-VJ OF 1-2145-VM OF 1-2145-VN OF 1-2145-VO OF 1-2145-VR OF 1-2145-VS OF 1-2145-VT OF 1-2145-VU OF 1-2145-VV OF 1-2145-VW OF 1-2145-VX OF 1-2145-VY OF 1-2145-VZ OF 1-2145-WA OF 1-2145-WB OF 1-2145-WC OF 1-2145-WD OF 1-2145-WE OF 1-2145-WF OF 1-2145-WG OF 1-2145-WH OF 1-2145-WI OF 1-2145-WJ OF 1-2145-WM OF 1-2145-WN OF 1-2145-WO OF 1-2145-WS OF 1-2145-WT OF 1-2145-WU OF 1-2145-WV OF 1-2145-WX OF 1-2145-WY OF 1-2145-WZ OF 1-2145-XA OF 1-2145-XB OF 1-2145-XC OF 1-2145-XD OF 1-2145-XE OF 1-2145-XF OF 1-2145-XG OF 1-2145-XH OF 1-2145-XI OF 1-2145-XM OF 1-2145-XN OF 1-2145-XO OF 1-2145-XR OF 1-2145-XS OF 1-2145-XT OF 1-2145-XU OF 1-2145-XV OF 1-2145-XW OF 1-2145-XX OF 1-2145-XY OF 1-2145-XZ OF 1-2145-YA OF 1-2145-YB OF 1-2145-YC OF 1-2145-YD OF 1-2145-YE OF 1-2145-YF OF 1-2145-YG OF 1-2145-YH OF 1-2145-YI OF 1-2145-YM OF 1-2145-YN OF 1-2145-YO OF 1-2145-YR OF 1-2145-YS OF 1-2145-YT OF 1-2145-YU OF 1-2145-YV OF 1-2145-YW OF 1-2145-YX OF 1-2145-YY OF 1-2145-YZ OF 1-2145-ZA OF 1-2145-ZB OF 1-2145-ZC OF 1-2145-ZD OF 1-2145-ZE OF 1-2145-ZF OF 1-2145-ZG OF 1-2145-ZH OF 1-2145-ZI OF 1-2145-ZM OF 1-2145-ZN OF 1-2145-ZO OF 1-2145-ZR OF 1-2145-ZS OF 1-2145-ZT OF 1-2145-ZU OF 1-2145-ZV OF 1-2145-ZW OF 1-2145-ZX OF 1-2145-ZY OF 1-2145-ZZ	

BALTIMORE GAS & ELECTRIC COMPANY

1-280 Seal

A 24/31