

MARYLAND DEPARTMENT OF THE ENVIRONMENT, WATER MANAGEMENT ADMINISTRATION
 1800 Washington Blvd., Baltimore, Maryland 21230 (410) 537-3784

 WATER WELL ABANDONMENT-SEALING REPORT FORM

SUBMIT COPIES OF COMPLETED FORM TO:

- * COUNTY ENVIRONMENT AGENCY (contact MDE, WMA if address needed)
- * WELL OWNER
- * MDE, WATER MANAGEMENT ADMINISTRATION, WELL PROGRAM

DATE WELL ABANDONED: 2/27/08 (month/day/year)

* PERMIT NUMBER OF ABANDONED WELL (if any) _____

* PERMIT NUMBER OF REPLACEMENT WELL _____

* PERSON ABANDONING WELL: Richard A. Crummitt WELL DRILLERS LICENSE NUMBER: 1090014

CIRCLE: MWD/MSD/MGD

* OWNER'S NAME: Howard County Schools

SITE LOCATION MAP

* WELL LOCATION:
 COUNTY: Howard
 NEAREST TOWN: Glenwood
 TAX MAP _____ BLOCK _____ PARCEL _____
 SUBDIVISION: _____
 SECTION: _____ LOT: _____
 NEAREST ROAD: Route 97

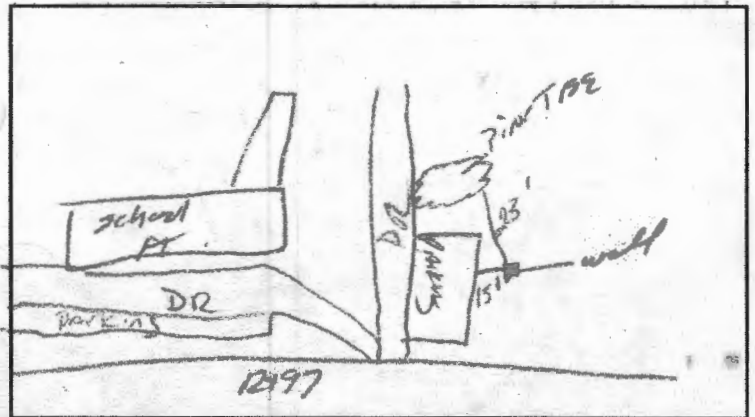

* TYPE OF WELL BEING ABANDONED:

- DRILLED JETTED
- BORED/AUGERED HAND DUG
- OTHER (specify) _____

* USE CODE:

- DOMESTIC MUNICIPAL/PUBLIC
- IRRIGATION INDUSTRIAL
- TEST/OBSERVATION GEOTHERMAL

* TYPE OF CASING:

- STEEL PLASTIC
- CONCRETE OTHER (specify) _____

* SIZE OF CASING: 6 INCHES IN DIAMETER

* DEPTH OF WELL: 130 FEET DEEP

* WAS ANY CASING REMOVED? YES NO
 if yes, length removed, in feet: _____

* WAS CASING RIPPED OR PERFORATED? YES NO

LOG OF SEALING MATERIAL

MATERIAL	FEET	
	FROM	TO
Bentowite	130	1
TOP soil	1	0
VOLUME OF MATERIAL USED		
<u>10 Bags of Bentowite</u>		

SIGNATURE-MASTER WELL DRILLER OR SUPERVISING SANITARIAN
Mary F. Pasterman

LICENSE # 040

CIRCLE ONE MWD/MSD/MGD DATE 4/28/08