

SITE INSPECTION SHEET

OWNER: Kamhran Zangna PHONE #: 301-225-3380
ADDRESS: 11471 Harding Rd. CONTRACTOR: _____
WELL TAG #: _____
SUBDIVISION: _____ LOT: _____ COUNTY #: _____
PROPOSAL: Owner considering converting a well to irrigation well.

LOCATION DIAGRAM

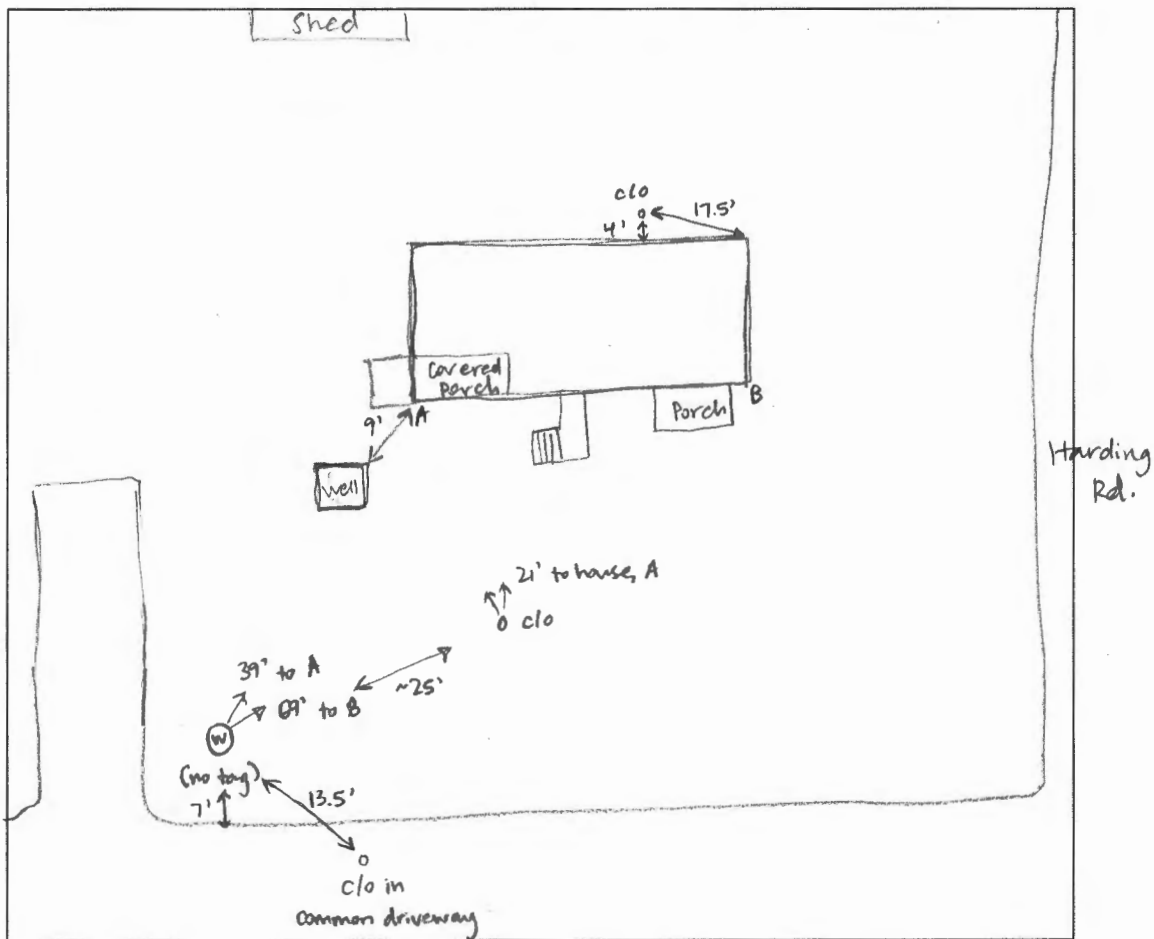

COMMENTS: Property owner says house is connected to public water + sewer. He is considering keeping one well for agriculture if it's cheaper than abandoning. Hand dug well is 4' diameter, 35' deep per owner. Hand dug well must be sealed. Drilled well can be kept if conditions in attached memo are met.

DATE: 8/27/18 INSPECTOR: Sarah Collins

HOWARD COUNTY DEPARTMENT OF HEALTH

BUREAU OF ENVIRONMENTAL HEALTH

ADMINISTRATIVE POLICY AND PROCEDURE

1.0 PURPOSE:

Establish a procedure to define if wells may be retained at the time a property is connected to public water and how the individual water supply system is designed to prevent cross connection.

2.0 POLICY:

It is the policy of the Howard County Health Department to prevent cross connections between non-potable wells and the public water system.

3.0 AUTHORITY:

Howard County Code Sec. 3.906. - Cross connection prohibited.

There shall not be cross connection between an individual water supply system and other individual or public water supply systems.

Howard County Code Sec. 3.908. - Connection to public water system required.

(a)Public Water Connection. Except for property located outside the planned service area for water service and the Metropolitan District, wherever a water main for public use exists in any street or alley and directly abuts the property, the owner of all buildings constructed for human habitation, occupancy, or use shall connect to the public water main.

(b)Wells Prohibited. A well for potable use shall not be constructed on a property accessible to an adequate public water supply.

COMAR 26.03.01.05 Individual Water Supply and Individual Sewerage Systems.

The installation of individual water supply or individual sewerage systems shall be subject to the following requirements:

A. An individual water supply or individual sewerage system may not be permitted to be installed where an adequate community water or sewerage facility is available. If an existing community water or sewerage facility is inadequate or is not available, an interim individual water and sewerage system may be used as set forth in §B(1), (2), and (3), of this regulation.

Howard County Plan for Water and Sewerage 2011 Amendment (page 1-18) or future amendments Within the Planned Service Area, regardless of when an "adequate community water and/or sewer system will be available, if the minimum lot size is three (3) acres a developer may utilize permanent on-site water supply and individual sewer systems.

4.0 DEFINITIONS:

Community water supply system means a source of water and a distribution system, including treatment and storage facilities, whether publicly or privately owned, serving two or more individual lots.

lot without

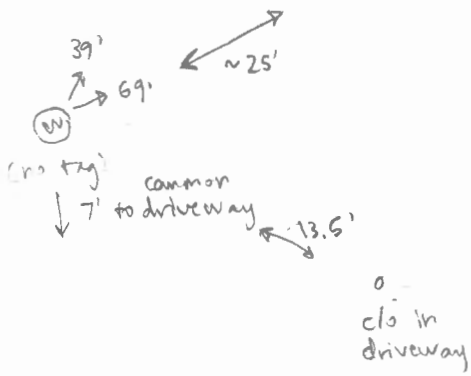
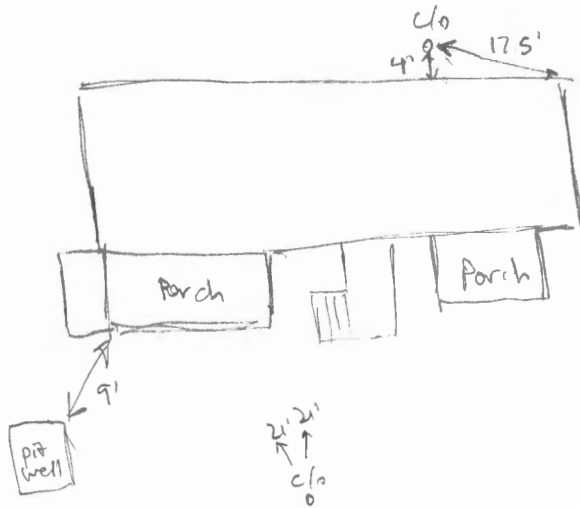

cross connection?
sewer line in backyard?
put into ave for nr - only outside spout
water test