

\*\*\*\*\*  
WATER WELL ABANDONMENT-SEALING REPORT FORM  
\*\*\*\*\*

SUBMIT COPIES OF COMPLETED FORM TO:

- \* COUNTY ENVIRONMENTAL AGENCY (contact MDE, WMA if address needed)
- \* WELL OWNER
- \* MDE, WATER MANAGEMENT ADMINISTRATION, WELL PROGRAM

APPROVED  
10/16/19

DATE WELL ABANDONED: 5/14/19 (month/day/year)

\* PERMIT NUMBER OF ABANDONED WELL (if any)

HO - 88 - 0276

\* PERMIT NUMBER OF REPLACEMENT WELL:

N/A

\* PERSON ABANDONING WELL: BRETT SWEENEY

WELL DRILLER'S LICENSE NUMBER: 237

CIRCLE: MWD / MSD / MGD

\* OWNER'S NAME: FCC

SITE LOCATION MAP

\* WELL LOCATION:  
COUNTY: HOWARD  
NEAREST TOWN: COLUMBIA  
TAX MAP \_\_\_\_\_ BLOCK \_\_\_\_\_ PARCEL \_\_\_\_\_  
SUBDIVISION: \_\_\_\_\_  
SECTION: \_\_\_\_\_ LOT: \_\_\_\_\_  
STREET ADDRESS: 7435 OAKLAND MILLS RD.

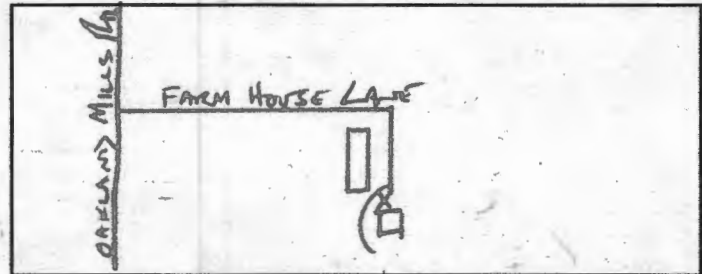

LATITUDE 39.167694

LONGITUDE 76.827917

LOG OF SEALING MATERIAL

MATERIAL	FEET	
	FROM	TO
<u>CONCRETE</u>	<u>0</u>	<u>2</u>
<u>BENTONITE</u>	<u>2</u>	<u>30</u>
VOLUME OF MATERIAL USED		
<u>1/2 BAG CONCRETE</u>		
<u>4 BAGS HOPE PLUG</u>		

\* TYPE OF WELL BEING ABANDONED:

- DRILLED  JETTED
- BORED  HAND DUG
- OTHER (specify) \_\_\_\_\_

\* USE CODE:

- DOMESTIC  MUNICIPAL/PUBLIC
- IRRIGATION  INDUSTRIAL
- TEST/OBSERVATION  GEOTHERMAL

\* TYPE OF CASING:

- STEEL  PLASTIC
- CONCRETE  OTHER (specify) \_\_\_\_\_

SIZE OF CASING: 4 INCHES IN DIAMETER

DEPTH OF WELL: 36 FEET DEEP

WAS ANY CASING REMOVED? YES  NO

If yes, length removed, in feet: \_\_\_\_\_

WAS CASING RIPPED OR PERFORATED? YES  NO

Pursuant to § 10-624 of the State Govt. Article of the Maryland Code, personal info requested on this form is used in processing this form pursuant to COMAR 26.04.04. Failure to provide the info may result in this form not being processed. You have the right to inspect, amend, or correct this form. The Maryland Department of the Environment is subject to the Maryland Public Information Act. This form may be made available on the Internet via MDE's website and is subject to inspection or copying, in whole or in part, by the public and other governmental agencies, if not protected by federal or State Law.

SIGNATURE: [Signature] MASTER WELL DRILLER OR SUPERVISING SANITARIAN LICENSE# 237

MWD / MSD / MGS

CIRCLE ONE

5/31/19 DATE

COUNTY

## Real Property Data Search ( w4)

## Search Result for HOWARD COUNTY

View Map		View GroundRent Redemption				View GroundRent Registration			
<b>Tax Exempt:</b>		<b>Special Tax Recapture:</b>							
<b>Exempt Class:</b>		NONE							
<b>Account Identifier:</b>		District - 06 Account Number - 439535							
Owner Information									
<b>Owner Name:</b>		FEDERAL COMMUNICATIONS COMMISS				<b>Use:</b>		EXEMPT COMMERCIAL	
<b>Mailing Address:</b>		7435 OAKLAND MILLS RD COLUMBIA MD 21046-1609				<b>Principal Residence:</b>		NO	
						<b>Deed Reference:</b>		/00170/ 00198	
Location & Structure Information									
<b>Premises Address:</b>		9200 FARM HOUSE LN JESSUP 20794-0000				<b>Legal Description:</b>		209.9049 A 9200 FARM HOUSE LN JESSUP	
<b>Map:</b>	<b>Grid:</b>	<b>Parcel:</b>	<b>Sub District:</b>	<b>Subdivision:</b>	<b>Section:</b>	<b>Block:</b>	<b>Lot:</b>	<b>Assessment Year:</b>	<b>Plat No:</b>
0042	0011	0230		0000				2017	<b>Plat Ref:</b>
<b>Special Tax Areas:</b>						<b>Town:</b>		NONE	
						<b>Ad Valorem:</b>		103	
						<b>Tax Class:</b>			
<b>Primary Structure Built</b>	<b>Above Grade Living Area</b>	<b>Finished Basement Area</b>		<b>Property Land Area</b>	<b>County Use</b>				
				209.9049 AC					
<b>Stories</b>	<b>Basement</b>	<b>Type</b>	<b>Exterior</b>	<b>Full/Half Bath</b>	<b>Garage</b>	<b>Last Major Renovation</b>			
Value Information									
		<b>Base Value</b>	<b>Value</b>		<b>Phase-in Assessments</b>				
			As of		As of		As of		
			01/01/2017		07/01/2018		07/01/2019		
<b>Land:</b>		13,878,500	13,878,500						
<b>Improvements</b>		495,300	487,400						
<b>Total:</b>		14,373,800	14,365,900		14,365,900		14,365,900		
<b>Preferential Land:</b>		0					0		
Transfer Information									
<b>Seller:</b>		<b>Date:</b>				<b>Price:</b>			
<b>Type:</b>		<b>Deed1:</b>				<b>Deed2:</b>			
<b>Seller:</b>		<b>Date:</b>				<b>Price:</b>			
<b>Type:</b>		<b>Deed1:</b>				<b>Deed2:</b>			
<b>Seller:</b>		<b>Date:</b>				<b>Price:</b>			
<b>Type:</b>		<b>Deed1:</b>				<b>Deed2:</b>			
Exemption Information									
<b>Partial Exempt Assessments:</b>		<b>Class</b>			07/01/2018	07/01/2019			
<b>County:</b>		100			14,365,900.00	14,365,900.00			
<b>State:</b>		100			14,365,900.00	14,365,900.00			
<b>Municipal:</b>		100			0.00 0.00	0.00 0.00			
<b>Tax Exempt:</b>		<b>Special Tax Recapture:</b>							
<b>Exempt Class:</b>		NONE							
Homestead Application Information									
<b>Homestead Application Status:</b> No Application									
Homeowners' Tax Credit Application Information									
<b>Homeowners' Tax Credit Application Status:</b> No Application					<b>Date:</b>				

WATER WELL ABANDONMENT-SEALING REPORT FORM

SUBMIT COPIES OF COMPLETED FORM TO:

- \* COUNTY ENVIRONMENTAL AGENCY (contact MDE, WMA if address needed)
- \* WELL OWNER
- \* MDE, WATER MANAGEMENT ADMINISTRATION, WELL PROGRAM

APPROVED  
10/16/2019

DATE WELL ABANDONED: 5/14/19 (month/day/year)

\* PERMIT NUMBER OF ABANDONED WELL (if any)

HO - 88 - 0274

\* PERMIT NUMBER OF REPLACEMENT WELL:

N/A - -

\* PERSON ABANDONING WELL: SCOTT SWEENEY

WELL DRILLER'S LICENSE NUMBER: 237

CIRCLE: MWD / MSD / MGD

\* OWNER'S NAME: FCC

SITE LOCATION MAP

\* WELL LOCATION:  
COUNTY: HOWARD  
NEAREST TOWN: COLUMBIA  
TAX MAP \_\_\_\_\_ BLOCK \_\_\_\_\_ PARCEL \_\_\_\_\_  
SUBDIVISION: \_\_\_\_\_  
SECTION: \_\_\_\_\_ LOT: \_\_\_\_\_  
STREET ADDRESS: Oakland Mills Rd

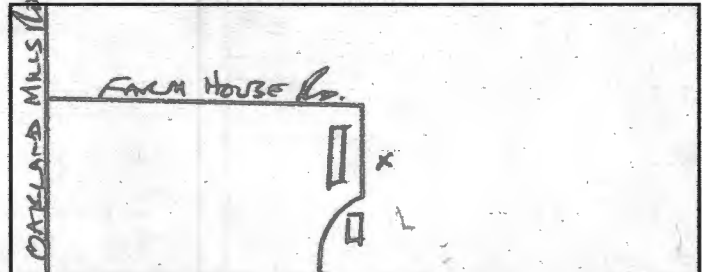

LATITUDE 39.167961

LONGITUDE 76.827827

LOG OF SEALING MATERIAL

MATERIAL	FEET	
	FROM	TO
<u>CONCRETE</u>	<u>0</u>	<u>2</u>
<u>BENTONITE</u>	<u>2</u>	<u>29</u>
VOLUME OF MATERIAL USED		
<u>1/2 BAG CONCRETE</u> <u>4 BAGS HOLE PLUG</u>		

\* TYPE OF WELL BEING ABANDONED:  
 DRILLED  JETTED  
 BORED  HAND DUG  
 OTHER (specify) \_\_\_\_\_

\* USE CODE:  
 DOMESTIC  MUNICIPAL/PUBLIC  
 IRRIGATION  INDUSTRIAL  
 TEST/OBSERVATION  GEOTHERMAL

\* TYPE OF CASING:  
 STEEL  PLASTIC  
 CONCRETE  OTHER (specify) \_\_\_\_\_

SIZE OF CASING: 4 INCHES IN DIAMETER

DEPTH OF WELL: 29 FEET DEEP

WAS ANY CASING REMOVED?  YES  NO  
If yes, length removed, in feet: 1

WAS CASING RIPPED OR PERFORATED?  YES  NO

SIGNATURE-MASTER WELL DRILLER OR SUPERVISING SANITARIAN [Signature] LICENSE# 237

MWD / MSD / MGS  
CIRCLE ONE

5/31/19  
DATE

COUNTY

Pursuant to § 10-624 of the State Govt. Article of the Maryland Code, personal info requested on this form is used in processing this form pursuant to COMAR 26.04.04. Failure to provide the info may result in this form not being processed. You have the right to inspect, amend, or correct this form. The Maryland Department of the Environment is subject to the Maryland Public Information Act. This form may be made available on the Internet via MDE's website and is subject to inspection or copying, in whole or in part, by the public and other governmental agencies, if not protected by federal or State Law.

## Real Property Data Search ( w4)

Search Result for HOWARD COUNTY

View Map		View GroundRent Redemption			View GroundRent Registration				
<b>Tax Exempt:</b>		<b>Special Tax Recapture:</b>							
<b>Exempt Class:</b>		NONE							
<b>Account Identifier:</b>		District - 06 Account Number - 439535							
Owner Information									
<b>Owner Name:</b>		FEDERAL COMMUNICATIONS COMMISS			<b>Use:</b>		EXEMPT COMMERCIAL		
<b>Mailing Address:</b>		7435 OAKLAND MILLS RD COLUMBIA MD 21046-1609			<b>Principal Residence:</b>		NO		
					<b>Deed Reference:</b>		/00170/ 00198		
Location & Structure Information									
<b>Premises Address:</b>		9200 FARM HOUSE LN JESSUP 20794-0000			<b>Legal Description:</b>		209.9049 A 9200 FARM HOUSE LN JESSUP		
<b>Map:</b>	<b>Grid:</b>	<b>Parcel:</b>	<b>Sub District:</b>	<b>Subdivision:</b>	<b>Section:</b>	<b>Block:</b>	<b>Lot:</b>	<b>Assessment Year:</b>	<b>Plat No:</b>
0042	0011	0230		0000				2017	<b>Plat Ref:</b>
<b>Special Tax Areas:</b>					<b>Town:</b>		NONE		
					<b>Ad Valorem:</b>		103		
					<b>Tax Class:</b>				
<b>Primary Structure Built</b>		<b>Above Grade Living Area</b>		<b>Finished Basement Area</b>		<b>Property Land Area</b>		<b>County Use</b>	
						209.9049 AC			
<b>Stories</b>	<b>Basement</b>	<b>Type</b>	<b>Exterior</b>	<b>Full/Half Bath</b>	<b>Garage</b>	<b>Last Major Renovation</b>			
Value Information									
		<b>Base Value</b>		<b>Value</b>		<b>Phase-in Assessments</b>			
				As of		As of		As of	
				01/01/2017		07/01/2018		07/01/2019	
<b>Land:</b>		13,878,500		13,878,500					
<b>Improvements</b>		495,300		487,400					
<b>Total:</b>		14,373,800		14,365,900		14,365,900		14,365,900	
<b>Preferential Land:</b>		0						0	
Transfer Information									
<b>Seller:</b>				<b>Date:</b>		<b>Price:</b>			
<b>Type:</b>				<b>Deed1:</b>		<b>Deed2:</b>			
<b>Seller:</b>				<b>Date:</b>		<b>Price:</b>			
<b>Type:</b>				<b>Deed1:</b>		<b>Deed2:</b>			
<b>Seller:</b>				<b>Date:</b>		<b>Price:</b>			
<b>Type:</b>				<b>Deed1:</b>		<b>Deed2:</b>			
Exemption Information									
<b>Partial Exempt Assessments:</b>		<b>Class</b>				07/01/2018		07/01/2019	
<b>County:</b>		100				14,365,900.00		14,365,900.00	
<b>State:</b>		100				14,365,900.00		14,365,900.00	
<b>Municipal:</b>		100				0.00 0.00		0.00 0.00	
<b>Tax Exempt:</b>		<b>Special Tax Recapture:</b>							
<b>Exempt Class:</b>		NONE							
Homestead Application Information									
<b>Homestead Application Status:</b> No Application									
Homeowners' Tax Credit Application Information									
<b>Homeowners' Tax Credit Application Status:</b> No Application					<b>Date:</b>				