

TAG: 3/6/17 (P)

B 1 19395
1 2 3 6

SEQUENCE NO.
(MDE USE ONLY)

STATE OF MARYLAND
APPLICATION FOR PERMIT TO DRILL WELL
559843B please type

STATE PERMIT NUMBER

HO-17-0040
70 fill in this form completely 79

Date Received (APA)
11/16/16

OWNER INFORMATION

8 MM DD YY 13
15 Last Name Owner First Name 34
Elm Street Development
36 1355 Beverly Rd, Suite 240 55
McClean VA 22101
57 Town 70 State 72 Zip 76

B 3

LOCATION OF WELL

8 COUNTY 21
Howard
23 SUBDIVISION 42
MILL CREEK
SECTION 44 46 LOT 3 48 50
52 NEAREST TOWN 71
CLARKSVILLE

DRILLER INFORMATION

66 Driller's Name 76 License No. 81
Michael Barlow MW D 355
67 Firm Name
Barlow Well Drilling
68 Address
522 UNDERWOOD LANE 21014
69 Signature 70 Date
11/3/16

B 4

SOURCES OF DRILLING WATER

1 Well
2
3 See file inquiry notes: well drilling insp missed - no notes and no grav insp. (PA)

11 STREET ADDRESS 30
HAVILAND MILL RD
ON WHICH SIDE OF ROAD (CIRCLE APPROPRIATE BOX)
NORTH
WEST EAST
SOUTH
34 500 37
DISTANCE FROM ROAD Ft
ENTER FT OR MI 38 39
TAX MAP: 39 BLK: 6 PARCEL 0001

B 2

WELL INFORMATION

1 APPROX. PUMPING RATE (GAL. PER MIN.) 2
5
3 AVERAGE DAILY QUANTITY NEEDED (GAL. PER DAY) 4
750
14 20

USE FOR WATER (CIRCLE APPROPRIATE BOX)

- DOMESTIC POTABLE SUPPLY & RESIDENTIAL IRRIGATION
- FARMING (LIVESTOCK WATERING & AGRICULTURAL IRRIGATION)
- INDUSTRIAL, COMMERCIAL, DEWATERING
- PUBLIC WATER SUPPLY WELL
- TEST, OBSERVATION, MONITORING
- OPEN LOOP GEOTHERMAL
- CLOSED LOOP GEOTHERMAL

NOT TO BE FILLED IN BY DRILLER HEALTH DEPARTMENT APPROVAL

Howard A546326-B 13
COUNTY NAME COUNTY NO.
STATE SIGNATURE INSERT S
DATE ISSUED 3/2/17
43 MM DD YY 49 CO SIGNATURE 3/2/18
50 EXP. DATE

APPROXIMATE DEPTH OF WELL 300 FEET
24 28

APPROXIMATE DIAMETER OF WELL 6 INCH
NEAREST INCH

METHOD OF DRILLING (circle one)

- BORED (or Augered) JETTED Jetted & DRIVEN
- 30 AIR-ROTary AIR-PERcussion ROTARY (Hydraulic Rotary)
- 37 CABLE REVerse-ROTary DRive-POINT
- other

REPLACEMENT OR DEEPEMED WELLS (CIRCLE APPROPRIATE BOX)

- THIS WELL WILL NOT REPLACE AN EXISTING WELL
 - THIS WELL WILL REPLACE A WELL THAT WILL BE ABANDONED AND SEALED
 - 39 THIS WELL WILL REPLACE A WELL THAT WILL BE USED AS A STANDBY-CONTACT LOCAL APPROVING AUTHORITY FOR POLICY ON STANDBY WELLS
 - THIS WELL WILL DEEPEM AN EXISTING WELL
- PERMIT NUMBER OF WELL TO BE REPLACED OR DEEPEMED (IF AVAILABLE) 41 52

PROPOSED LOCATION OF WELL ON LOT
SHOW PERMANENT STRUCTURES SUCH AS BUILDINGS, SEPTIC SYSTEM, ROADS AND/OR LANDMARKS AND INDICATE NOT LESS THAN TWO DISTANCE MEASUREMENTS TO WELL

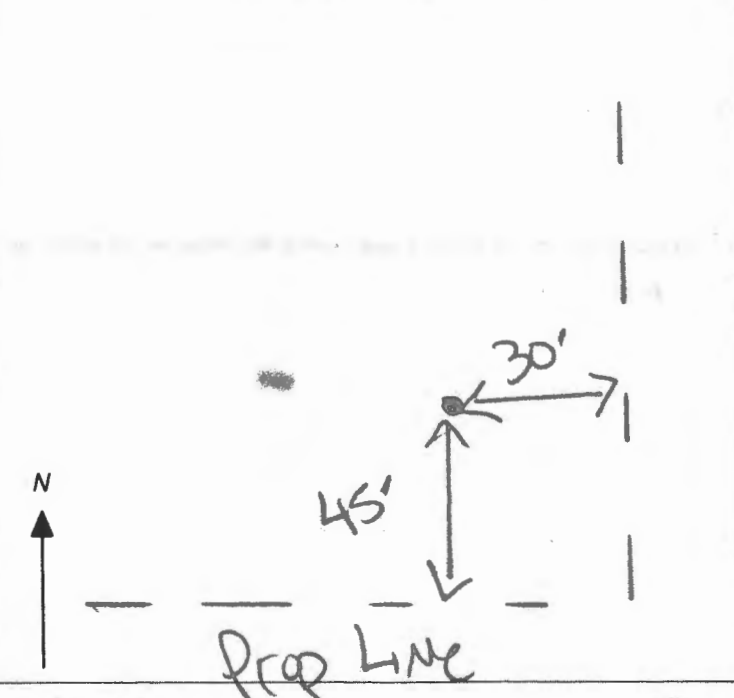

Not to be filled in by driller (MDE OR COUNTY USE ONLY)

APPROX. PERMIT NUMBER HO 2016G002
PERMIT No. HO-17-0040
70 71 72 73 74 75 76 77 78 79

SPECIAL CONDITIONS
NOTE APPROVING AUTHORITIES SHOULD USE SEPARATE SHEET IF NEEDED

SEE ATTACHED MEMO

C1 52467 SEQUENCE NO. (MDE USE ONLY)

STATE OF MARYLAND WELL COMPLETION REPORT FILL IN THIS FORM COMPLETELY PLEASE TYPE

THIS REPORT MUST BE SUBMITTED WITHIN 45 DAYS AFTER WELL IS COMPLETED.

1 2 3 6 (THIS NUMBER IS TO BE PUNCHED IN COLS. 3-6 ON ALL CARDS)

COUNTY NUMBER

ST/CO USE ONLY DATE RECEIVED MM DD YY 09/11/17

DATE WELL COMPLETED MM DD YY 09 17 17

Depth of Well 22 300 26 (TO NEAREST FOOT)

PERMIT NO. FROM "PERMIT TO DRILL WELL" HO 17-0040

OK 9/22/17 SC

28 29 30 31 32 33 34 35 36 37

OWNER: Elm Street Development WELL SITE ADDRESS: HAVILAND Mill Rd TOWN: CLARKSVILLE SUBDIVISION: Mill Creek SECTION: LOT: 3

WELL LOG

Not required for driven wells

STATE THE KIND OF FORMATIONS PENETRATED, THEIR COLOR, DEPTH, THICKNESS AND IF WATER BEARING

DESCRIPTION (Use additional sheets if needed) FEET FROM TO check if water bearing

Table with 3 columns: DESCRIPTION, FEET (FROM, TO), and check if water bearing. Rows include SOIL, Red clay, Brown Shale, Hard Gray Rock.

GROUTING RECORD

WELL HAS BEEN GROUDED (Circle appropriate box) Y N TYPE OF GROUDED MATERIAL (Circle one) CEMENT [CM] BENTONITE CLAY [BC] NO. OF BAGS 10 NO. OF POUNDS 120 GALLONS OF WATER 50 DEPTH OF GROUT SEAL (to nearest foot) from 0 ft. to 25 ft.

CASING RECORD

MAIN CASING TYPE PL Nominal diameter top (main) casing (nearest inch)! 6 Total depth of main casing (nearest foot) 25

OTHER CASING (if used)

Table for other casing with columns for diameter and depth.

SCREEN RECORD

screen type or open hole insert appropriate code below [ST] [BR] [HO] [PL] [OT]

C2

DEPTH (nearest ft.) HO 25 300 E A C H S C 3 R E E N SLOT SIZE 1 2 3 DIAMETER OF SCREEN (NEAREST INCH) 56 60 from to

GRAVEL PACK IF WELL DRILLED WAS FLOWING WELL INSERT F IN BOX 68

MDE USE ONLY (NOT TO BE FILLED IN BY DRILLER) T (E.R.O.S.) W Q

70 72 TELESCOPE CASING LOG INDICATOR OTHER DATA 74 75 76

C3

PUMPING TEST

HOURS PUMPED (nearest hour) 6 PUMPING RATE (gal. per min.) 3.0 METHOD USED TO MEASURE PUMPING RATE Submersible WATER LEVEL (distance from land surface) BEFORE PUMPING 40 ft. WHEN PUMPING 115 ft. TYPE OF PUMP USED (for test) [S] submersible

PUMP INSTALLED

DRILLER INSTALLED PUMP (CIRCLE) (YES) (NO) IF DRILLER INSTALLS PUMP, THIS SECTION MUST BE COMPLETED FOR ALL WELLS. TYPE OF PUMP INSTALLED PLACE (A,C,J,P,R,S,T,O) IN BOX 29. CAPACITY: GALLONS PER MINUTE (to nearest gallon) 31 35 PUMP HORSE POWER 37 41 PUMP COLUMN LENGTH (nearest ft.) 43 47 CASING HEIGHT (circle appropriate box and enter casing height) [+ above] [- below] LAND SURFACE 1 (nearest foot)

LATITUDE 39.18579 LONGITUDE 76.99725 (DEFAULT COORD. WGS 84)

Pursuant to §10-624 of the State Govt. Article of the Maryland Code personal info. requested on this form is used in processing this form pursuant to COMAR 26.04.04. Failure to provide the info. may result in this form not being processed. You have the right to inspect, amend, or correct this form. The Maryland Department of the Environment is subject to the Maryland Public Information Act. This form may be made available on the Internet via MDE's website and is subject to inspection or copying, in whole or in part, by the public and other governmental agencies, if not protected by federal or state law.

DRILLERS LIC. NO. M D 355 DRILLERS SIGNATURE (MUST MATCH SIGNATURE ON APPLICATION) LIC. NO. WRO 113 D SITE SUPERVISOR (sign. of driller or journeyman responsible for sitework if different from permittee)

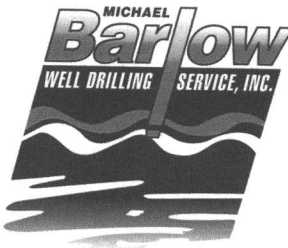

MICHAEL BARLOW WELL DRILLING & SERVICE, INC.
 522 Underwood Lane Bel Air, Maryland 21014
 (410) 838-6910 Fax (410) 838-3582

WELL YIELD REPORT

Date Test Completed: July 17, 2017

Well Depth: 300 feet

Customer Elm Street Development Permit # HO-17-0040
 Road Haviland Mill Road Subdivision Mill Creek
 City Clarksville Section
 State Maryland Lot # 3

Time	Water Level feet	Time to Fill 1-gallon bucket seconds	G.P.M.
9:30 AM	40	5	12.00
9:45 AM	120	7	8.57
10:00 AM	120	20	3.00
10:15 AM	120	20	3.00
10:30 AM	120	20	3.00
10:45 AM	120	20	3.00
11:00 AM	120	20	3.00
11:15 AM	120	20	3.00
11:30 AM	119	20	3.00
11:45 AM	119	20	3.00
12:00 PM	119	20	3.00
12:15 PM	119	20	3.00
12:30 PM	119	20	3.00
12:45 PM	118	20	3.00
1:00 PM	118	20	3.00
1:15 PM	118	20	3.00
1:30 PM	117	20	3.00
1:45 PM	117	20	3.00
2:00 PM	117	20	3.00
2:15 PM	116	20	3.00
2:30 PM	116	20	3.00
2:45 PM	116	20	3.00
3:00 PM	116	20	3.00
3:15 PM	115	20	3.00
3:30 PM	115	20	3.00
3:45 PM	115	20	3.00
4:00 PM	115	20	3.00
This yield test report is for informational purposes only. Please note the yield may increase or decrease over time and the GPM indicated above is not a guarantee.			

**HOWARD COUNTY HEALTH DEPARTMENT
BUREAU OF ENVIRONMENTAL HEALTH
WELL & SEPTIC PROGRAM
TEL: (410)313-1771 FAX: (410)313-2648**

Information Form for the Installation of the Well Pump, Pitless Adapter, and Supply Piping

NOTE: The installer is responsible for requesting an inspection prior to 9 am on the day of the desired inspection. No work is to be covered until approved by the Health Department. All installations must comply with the National Standard Plumbing Code (NSPC, as amended locally) and COMAR 26.04.04 (MD Well Construction Regulations). Submission of a complete form is required prior to Use and Occupancy approval.

Company Name: _____ Telephone #: _____
Address: _____

(Must circle one) Licensed Plumber Licensed Well Driller Licensed Well Pump Installer
License # and name of individual responsible for the field installation:
Name (Print): _____ License# _____

***A licensed individual must perform the actual installation. Apprentices must be under the supervision of a licensed journeyman or master plumber, pump installer or well driller. Licenses may be subjected to field verification. Unlicensed individuals may be reported to the appropriate licensing agency.**

Name of Property Owner: _____ Telephone #: _____
Subdivision: _____ Lot #: _____ Well Tag #: HO - ____ - ____
Site Address: _____

Submersible Pump Data

Make: _____
Model #: _____
Pump Capacity _____ GPM
Well Yield: _____ GPM

Pitless Adapter

Make: _____
Model#: _____
Depth: _____ (36" min)
NSF/WSC approved: _____

Well Cap and Electric Conduit

Two piece watertight cap: _____
Screened, vented well cap: _____
Cap secured to casing: _____
Conduit min 18" B.G.: _____
Conduit secured to well cap: _____

Depth of well encountered at time of pump installation: _____ (feet)
If pump capacity exceeds well yield, a low water cut off switch is required by NSPC 1990 Section 17.8.4
Torque arrestors, Cable guards, or other acceptable method used- Must circle one

Safety rope, if used, attached to brass rope adapter or other acceptable method inside of well casing _____

Piping to house

Type: _____
PSI: _____ (160 psi min)
Depth of supply line: _____ (36" min)

House Connection

PVC sleeve to undisturbed soil at wall penetration: _____
Length of sleeve (5' minimum from foundation): _____
Sleeve sealed properly: _____

The water supply line is required to be at least ten feet from the septic tank, pump chamber, sewage piping, distribution box, drainfields, and sewage reserve area. If this cannot be accomplished, contact this office for approval prior to installation.

Signature of company representative responsible for installation _____ date _____

For Health Department Use Only - Not to be completed by Installer

Date Insp. Requested: _____ Date Insp. Approved: 8/20/19 Inspector: ST
Inspection Data: Pitless adapter watertight & water supply line at least 36" below grade 38"
Two piece cap installed and attached to casing securely
Elec. conduit extends at least 18" below grade/attached to cap properly 33"
Safety rope not outside of well cap/casing
Correct well tag attached properly and casing 8" above finished grade 29"
Water supply line sleeved adequately at house connection 8"
Adequate grout observed below pitless adapter

4.5'

Maura J. Rossman, M.D., Health Officer

INTERIM CERTIFICATE OF POTABILITY
Expiration Date – APRIL 7, 2020

October 7, 2019

Homeowner
13816 Mill Creek Court
Clarksville, MD 21029

RE: Mill Creek, Lot 3
13816 Mill Creek Court
Building Permit: B19001404
Well Permit: HO-17-0040

Dear Homeowner:

This is to advise you that the septic system installation and water well construction for the above referenced property have been inspected and approved. Final approval of the septic system was granted on **8/20/2019**. Final approval of the well line connection to the dwelling was granted on **8/20/2019**. The well construction was completed on **7/17/2017**. Water samples were collected on **9/25/2019**.

The water sample results indicate that the water samples submitted for testing were free of coliform and fecal coliform bacteria at the time of sampling and are bacteriologically safe for drinking. This certifies that the initial sampling requirements of COMAR 26.04.04 "Well Regulations" have been met for the water supply system installed under well permit HO-17-0040. Although the submitted sample results are in compliance with COMAR standards, the Health Department does not guarantee water supplies.

This Interim Certificate of Potability will expire **six months** from the date of issuance. Submission of a second bacteriological test indicating the water is free of coliform and fecal coliform bacteria is required prior to the expiration date, after which time a Final Certificate of Potability will be issued. **Failure to submit an additional sample and obtain a Final Certificate of Potability will result in a Notice of Violation and is punishable as a misdemeanor under the Annotated Code of Maryland, Environment Article, 9-1311, subject to a fine of up to \$500 or imprisonment not to exceed three months.**

Please contact (410) 313-1773 to schedule a final water sample appointment or contact a Maryland certified water laboratory to schedule a water sample. A list of laboratories certified by the state of Maryland may be found at the following website:
<http://www.mde.state.md.us/assets/document/WSP-Labs-2010apr16.pdf>

Maura J. Rossman, M.D., Health Officer

In closing, please refer to our "Homeowner Fact Sheet" which illustrates a better understanding for your Onsite Sewage Disposal System. You will also find a link to Maryland Department of the Environment's website which describes in further detail operation and maintenance of your septic system.

Approving Authority,



Kevin M. Wolf, LEHS, R.S./REHS, Supervisor
Groundwater Management Section
Well & Septic Program

cc: Howard County Dept. of Inspections, Licenses, and Permits
Community Hygiene Program
File

FOUNTAIN VALLEY ANALYTICAL LABORATORY, INC.

1413 Old Taneytown Rd. Westminster, MD (410) 848-1014 (410) 876-4554 FAX (410) 848-0298

REPORT OF ANALYSIS

Laboratory ID #: 133100
Reference: Mill Creek Lot 3
Location: 13816 Mill Creek Court
Clarksville, MD 21029
Date/ Time Collected: 9/25/2019 1415
Date/Time Rec'd: 9/25/2019 1615
Chlorine ppm: Free: ND Total: ND
Collected By: B. Wilkerson 9315BW
Account #: 1933
Company: Fogles Well Pump & Treatment
Requested By: Dave Fogle
Source: Well Water
Site: Pressure Tank
Treatment: None
pH: 5.6
Well #: HO-17-0040

PARAMETERS	RESULTS	UNITS	REFERENCE	METHOD	DATE/TIME/ANALYST
Bacteria, Coliform, Total, MPN	<1.0 ✓	MPN/ 100 ml	<1.0	SM20 9223B	9/26/2019 / 1030 / CRS
Bacteria, E. coli, MPN	<1.0 ✓	MPN/ 100 ml	<1.0	SM20 9223B	9/26/2019 / 1030 / CRS
Nitrate	6.68 ✓	mg/L	10	601	9/26/2019 / 0700 / CRS
Turbidity	7.35 ✓	NTU	<10	SM20 2130B	9/26/2019 / 0730 / CRS
Sand	NS ✓	mg/L	5	Visual/Gravimetric	9/26/2019 / 0730 / CRS

OK. 

NOTES

- 1 mg/L = milligrams per liter (also, parts per million)
- 2 MPN/ 100 ml = Most Probable Number [of viable bacteria] per 100 ml of sample.
- 3 NS = None Seen (NS indicates less than 5 mg/L)
- 4 NTU = Nephelometric Turbidity Units
- 5 Results less than or within the reference range are considered satisfactory and within potable water limits at the time of sampling.
- 6 Sample collected by client, analyzed as received
- 7 ND = None Detected; N/A: Not Available
- 8 Visual well check: Sealed, vented cap
- 9 pH and Chlorine level tested in lab (pH tested after recommended holding time)

Reason for Test : Use & Occupancy

Building Permit # : 19001404

Date Reported: 9/26/2019

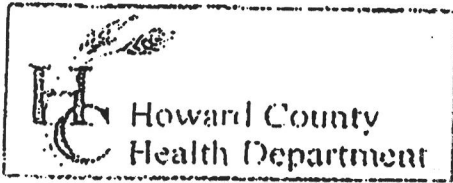

3525 H Ellicott Mills Drive, Ellicott City, MD 21043
(410) 313-2640 Fax (410) 313-2648
TDD (410) 313-2323 Toll Free 1-866-313-6300
website: www.hchealth.org

Penny E. Borenstein, M.D., M.P.H., Health Officer

TO ALL INTERESTED PARTIES

When submitting a well permit application for a proposed well for new construction, please indicate one of the following:

All individual well sites for lots 2-23 of Mill Creek are staked + properly labeled

The well site has been staked by Bohler Engineering, (professional land surveyor or company employing professional land surveyors) on 3/3/17 (date) and does not require a site inspection.

The well driller, builder or property owner will call the Health Department to schedule a time to meet in the field to verify the proposed well site location.

This sheet, along with two copies of an acceptable well site plan, must be attached to the green well permit application.

Revised 6/10/03

RECEIVED
MAR -6 2017
HOWARD COUNTY HEALTH DEPT.
COMMUNITY HYGIENE PROGRAM

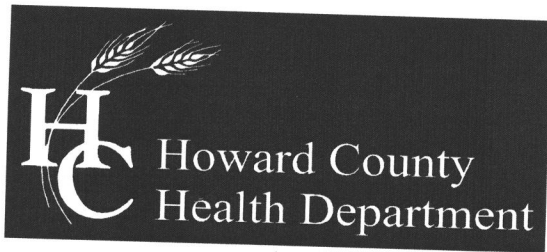

Bureau of Environmental Health

8930 Stanford Blvd, Columbia, MD 21045
Main: 410-313-2640 | Fax: 410-313-2648
TDD 410-313-2323 | Toll Free 1-866-313-6300
www.hchealth.org

Maura J. Rossman, M.D., Health Officer

LOT 3

MEMORANDUM

TO: Barlow Well Drilling
FROM: Ryan Rappaport, L.E.H.S. 
Well and Septic Program
DATE: March 1, 2017
RE: **State Water Appropriation and Use Permit for Crawford Property/Mill Creek Subdivision #HO2016G002(01) & Special Conditions**

The State Water Appropriation and Use Permit for the Crawford Property/Mill Creek Subdivision has a requirement regarding well spacing and testing:

15. The Permittee shall conduct simultaneous yield tests of wells closer than 100 feet apart, if at least one of the wells is on a lot less than one acre in size. The yield testing shall be conducted to ensure that the minimum yield requirements of COMAR 26.04.04.26 are met. In the event that a well that has been tested simultaneously with other wells does not meet minimum yield standards, the Permittee may relocate a well so as to achieve the 100-foot separation distance, deepen or otherwise modify the well to improve its yield or drill a second well to be used in tandem to meet the minimum yield standards during simultaneous testing. All wells shall comply with well construction standards.

The lots of the Crawford Property/Mill Creek Subdivision that are less than an acre are lots 2, 3, 12, 13 and 18. If a well on one of these lots is within 100' of another well, a simultaneous yield test of both wells will be required.

SPECIAL CONDITIONS

- All drilling, grouting and yields must be called into the Health Department for inspection. Call 410-313-1771 for scheduling.
- Since all 23 lots have the well locations staked and not the lot's well boxes it is required that if during the drilling a dry hole is encountered, the Health Department must be notified immediately before any additional drilling is completed on that particular lot.
- The wells on lots 1, 7, 15 and 19 will require TDS, sodium and chloride water samples during the yield test.
- The wells on lots 20 and 21 must be drilled using steel casing that extends to at least 50 feet depth or 10 feet into competent bedrock, whichever is deeper.

Feel free to contact me with any questions at 410-313-1781 or RRappaport@howardcountymd.gov.

Cc: File

PLAN VIEW

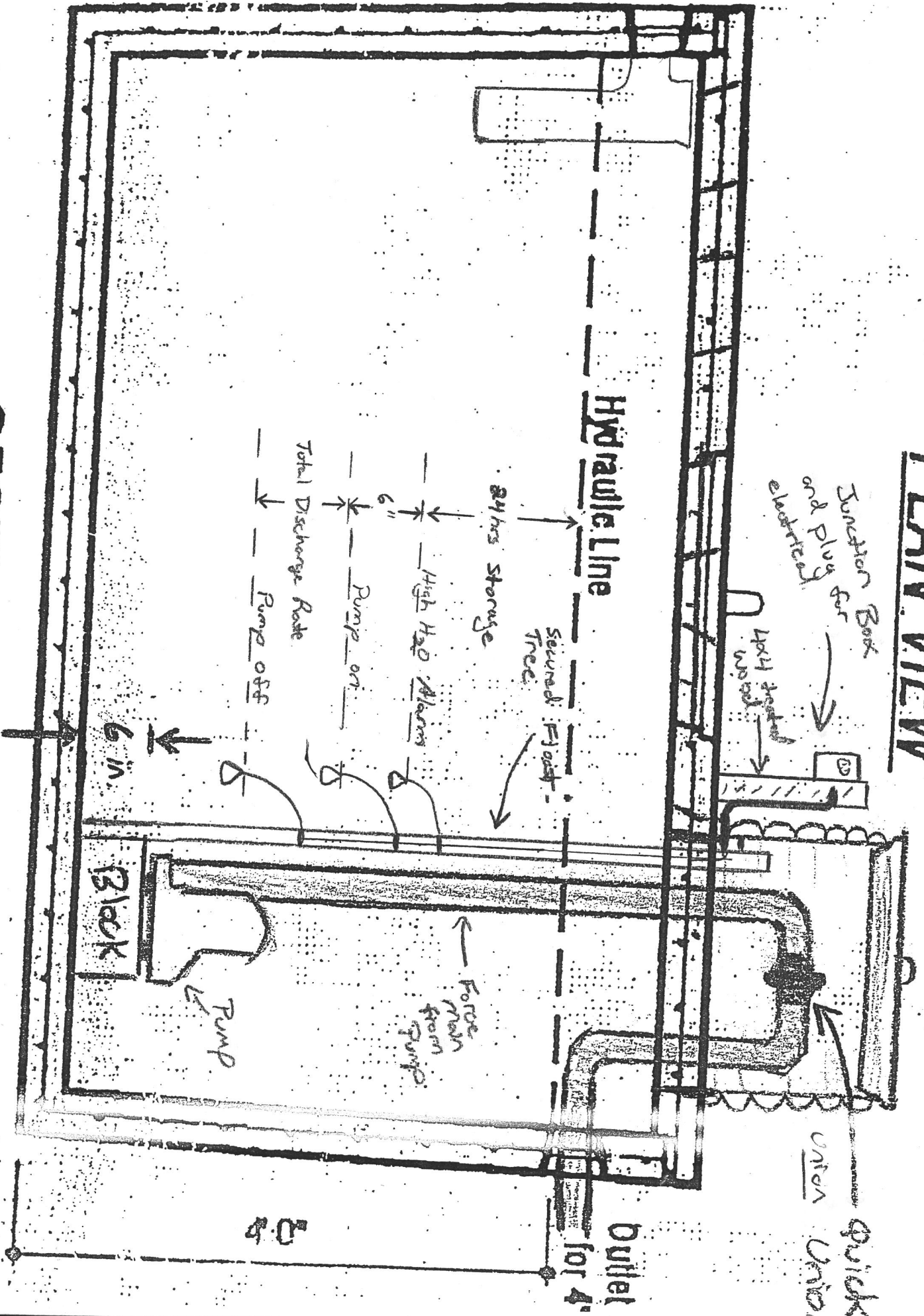

SECTION A-A

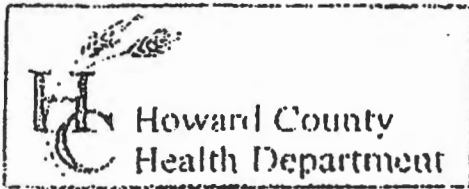

3525 H Ellicott Mills Drive, Ellicott City, MD 21043
(410) 313-2640 Fax (410) 313-2648
TDD (410) 313-2323 Toll Free 1-866-313-6300
website: www.hchealth.org

Penny E. Borenstein, M.D., M.P.H., Health Officer

TO ALL INTERESTED PARTIES

When submitting a well permit application for a proposed well for new construction, please indicate one of the following:

INDIVIDUAL

well sites have been staked for mill creek

The well site has been staked by Bohler Engineering,
(professional land surveyor or company employing professional land surveyors)
on 2/24/17 (date) and does not require a site inspection.

The well driller, builder or property owner will call the Health Department to schedule a time to meet in the field to verify the proposed well site location.

This sheet, along with two copies of an acceptable well site plan, must be attached to the green well permit application.

Revised 6/10/03

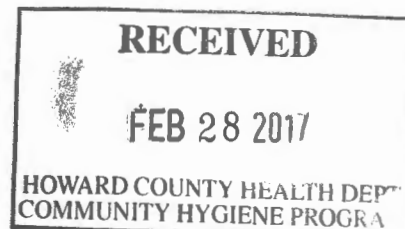



LEGEND

-  PROPERTY LINE
-  BUILDING RESTRICTION LINE
-  PROPOSED WELL BOX / WELL LOCATION
-  SEPTIC RESERVED AREA

RECEIVED
FEB 28 2017
 HOWARD COUNTY HEALTH DEPT.
 COMMUNITY HYGIENE PROGRAM

Well site ok
 (PK) 3/2/17

HO-17-0040

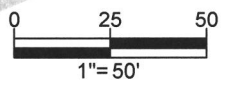

PROJECT NAME: **MILL CREEK SUBDIVISION**
PROPOSED LOTS 1-23 & NONBUILDABLE PRESERVATION PARCEL A - G
 6780 HAVILAND MILL ROAD, CLARKSVILLE, MD

SHEET TITLE: **WELL EXHIBIT - LOT 3**
 1 OF 1



BOHLER
ENGINEERING

22636 DAVIS DRIVE, SUITE 250 STERLING, VA 20164
 PHONE: (703) 709-9500 FAX: (703) 709-9501

SCALE: 1" = 50'	DATE: 11-01-16	CAD ID: EX0	PROJECT NUMBER: MD142038
--------------------	-------------------	----------------	-----------------------------