



Building Permit Application

Howard County Maryland
Department of Inspections, Licenses and Permits
3430 Court House Drive
Permits: 410-313-2455
www.howardcountymd.gov

DILP 2019 SEP 25 AM 8:59
Date Received: _____
Permit No.: B19003223

Building Address: 14534 OLD FRANKLICK ROAD
 City: COOKSVILLE State: MD Zip Code: 21723
 Suite/Apt. # _____ SDP/WP/BA #: _____
 Subdivision: QUARTZ HILL III
 Lot: 4 Tax Map: 8 Parcel: _____
 Existing Use: SFD
 Proposed Use: SCREENED IN PORCH
 Estimated Construction Cost: \$ 4,000
 Description of Work: N 16' X 18' MAINTENANCE FENCE DECKING
CONC' LANDING W/STAIRS TO BACK YARD
 Occupant/Tenant Name: _____
 Was tenant space previously occupied? Yes No
 Contact Name: _____
 Address: _____
 City: _____ State: _____ Zip Code: _____
 Phone: _____ Fax: _____
 Email: _____

Property Owner's Name: CATONSVILLE HOMES, LLC
 Address: 11175 STRATFIELD CT.
 City: MARRIOTTSVILLE State: MD Zip Code: 21104
 Phone: 410-442-2211 Fax: 410-442-2215
 Email: pwalter@catonsvillehomes.com
 Applicant's Name & Mailing Address, (If other than stated herein)
 Applicant's Name: _____
 Address: _____
 City: _____ State: _____ Zip Code: _____
 Phone: _____ Fax: _____
 Email: _____
 Contractor Company: CATONSVILLE HOMES, LLC
 Contact Person: PAM WALTER
 Address: 11175 STRATFIELD CT.
 City: MARRIOTTSVILLE State: MD Zip Code: 21104
 License No.: 13444079 MICR 990
 Phone: 410-442-2211 Fax: 410-442-2215
 Email: pwalter@catonsvillehomes.com
 Engineer/Architect Company: _____
 Responsible Design Prof.: _____
 Address: _____
 City: _____ State: _____ Zip Code: _____
 Phone: _____ Fax: _____
 Email: _____

Commercial Building Characteristics	Residential Building Characteristics	
Height:	<input type="checkbox"/> SF Dwelling <input type="checkbox"/> SF Townhouse	
No. of stories:	Depth	Width
Gross area, sq. ft./floor:	1 st floor:	
	2 nd floor:	
Area of construction (sq. ft.):	Basement:	
	<input type="checkbox"/> Finished Basement	
Use group:	<input type="checkbox"/> Unfinished Basement	
	<input type="checkbox"/> Crawl Space	
Construction type:	<input type="checkbox"/> Slab on Grade	
<input type="checkbox"/> Reinforced Concrete	No. of Bedrooms:	
<input type="checkbox"/> Structural Steel	Multi-family Dwelling	
<input type="checkbox"/> Masonry	No. of efficiency units:	
<input type="checkbox"/> Wood Frame	No. of 1 BR units:	
<input type="checkbox"/> State Certified Modular	No. of 2 BR units:	
	No. of 3 BR units:	
	Other Structure:	
	Dimensions:	
➤ Roadside Tree Project Permit	Footings:	
<input type="checkbox"/> Yes <input type="checkbox"/> No	Roof:	
Roadside Tree Project Permit #	<input type="checkbox"/> State Certified Modular	
	<input type="checkbox"/> Manufactured Home	

Utilities	
Electric:	<input checked="" type="checkbox"/> Yes <input type="checkbox"/> No
Gas:	<input checked="" type="checkbox"/> Yes <input type="checkbox"/> No
Water Supply	
<input type="checkbox"/> Public	
<input checked="" type="checkbox"/> Private	
Sewage Disposal	
<input type="checkbox"/> Public	
<input checked="" type="checkbox"/> Private	
Heating System	
<input type="checkbox"/> Electric <input type="checkbox"/> Oil	
<input type="checkbox"/> Natural Gas <input checked="" type="checkbox"/> Propane Gas	
<input type="checkbox"/> Other:	
Sprinkler System:	
<input checked="" type="checkbox"/> Yes <input type="checkbox"/> No	
Grading Permit Number:	
Building Shell Permit Number:	

THE UNDERSIGNED HEREBY CERTIFIES AND AGREES AS FOLLOWS: (1) THAT HE/SHE IS AUTHORIZED TO MAKE THIS APPLICATION; (2) THAT THE INFORMATION IS CORRECT; (3) THAT HE/SHE WILL COMPLY WITH ALL REGULATIONS OF HOWARD COUNTY WHICH ARE APPLICABLE THERETO; (4) THAT HE/SHE WILL PERFORM NO WORK ON THE ABOVE REFERENCED PROPERTY NOT SPECIFICALLY DESCRIBED IN THIS APPLICATION; (5) THAT HE/SHE GRANTS COUNTY OFFICIALS THE RIGHT TO ENTER ONTO THIS PROPERTY FOR THE PURPOSE OF INSPECTING THE WORK PERMITTED AND POSTING NOTICES.

Pam Walter
 Applicant's Signature _____ Print Name _____
pwalter@catonsvillehomes.com
 Email Address _____ Date 9/25/19
CATONSVILLE HOMES
 Title/Company _____

Checks Payable to: DIRECTOR OF FINANCE OF HOWARD COUNTY
 PLEASE WRITE NEATLY & LEGIBLY
 -FOR OFFICE USE ONLY-

AGENCY	DATE	SIGNATURE OF APPROVAL	DPZ SETBACK INFORMATION	Filing Fee	\$
State Highways			Front:	Permit Fee	\$ <u>31.00</u>
Building Officials			Rear:	Tech Fee	\$ <u>3.18</u>
PSZA (Zoning)			Side:	Excise Tax	\$
PSZA (Engineering)			Side St.:	PSFS	\$
Health	<u>10/1/2019</u>	<u>Pam Walter</u>	All minimum setbacks met? <input type="checkbox"/> Yes <input type="checkbox"/> No	Guaranty Fund	\$
Is Sediment Control approval required for issuance? <input type="checkbox"/> Yes <input type="checkbox"/> No			Is Entrance Permit Required? <input type="checkbox"/> Yes <input type="checkbox"/> No	Add'l per Fee	\$
<input type="checkbox"/> CONTINGENCY CONSTRUCTION START			Historic District? <input type="checkbox"/> Yes <input type="checkbox"/> No	Total Fees	\$
			Lot Coverage for New Town Zone:	Sub- Total Paid	\$ <u>32.02</u>
			SDP/Red-line approval date:	Balance Due	\$
				Check	#

NOTES:

- 1) THIS DRAWING IS OF BENEFIT TO A CONSUMER ONLY INsofar AS IT IS REQUIRED BY A LENDER OR A TITLE INSURANCE COMPANY OR ITS AGENT IN CONNECTION WITH CONTEMPLATED TRANSFER, FINANCING OR REFINANCING.
- 2) THIS DRAWING IS NOT TO BE RELIED UPON FOR THE ESTABLISHMENT OR LOCATION OF FENCES, GARAGES, BUILDINGS OR OTHER EXISTING OR FUTURE IMPROVEMENTS.
- 3) THIS DRAWING DOES NOT PROVIDE FOR ACCURATE IDENTIFICATION OF PROPERTY BOUNDARY LINES, BUT SUCH IDENTIFICATION MAY NOT BE REQUIRED FOR THE TRANSFER OF TITLE OR SECURING FINANCING OR REFINANCING.
- 4) THIS PROPERTY IS NOT LOCATED WITHIN A SPECIAL FLOOD HAZARD AREA AS PLOTTED BY SCALE ON NATIONAL FLOOD INSURANCE PROGRAM, FLOOD INSURANCE RATE MAP, COMMUNITY PANEL NUMBER 24027C0035D, DATED NOVEMBER 6, 2013.
- 5) BUILDING TIES ARE ±0.5' UNLESS OTHERWISE NOTED.

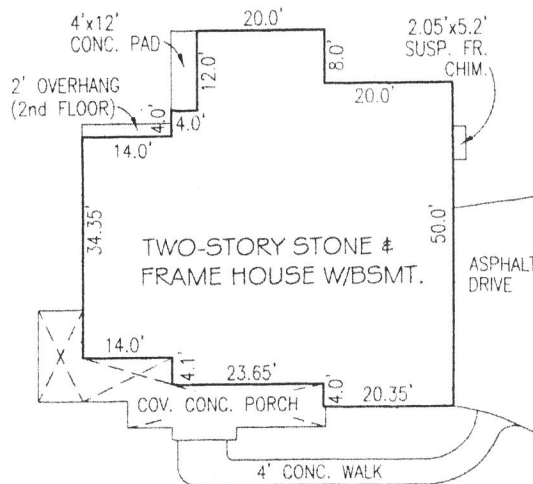

HOUSE DETAIL
SCALE: 1" = 30"

PRESERVATION
PARCEL 'A'
QUARTZ HILL III
PLAT# 22814



Approved 10/9/2019
RJE

OLD FREDERICK ROAD
MD SHA PLAT 56161

PROFESSIONAL CERTIFICATION:

I HEREBY CERTIFY THAT THESE DOCUMENTS WERE PREPARED BY ME OR UNDER MY RESPONSIBLE CHARGE, AND THAT I AM A DULY LICENSED PROFESSIONAL LAND SURVEYOR UNDER THE LAWS OF THE STATE OF MARYLAND, LICENSE NO. 21512, EXPIRATION DATE AUGUST 4, 2019 IN ACCORDANCE WITH COMAR 09.13.06.12

Jeffery W. Elkins JULY 3, 2018
For VanMar Associates, Inc. Date
Jeffery W. Elkins, Prof. Land Surveyor



B19003223

HOUSE LOCATION DRAWING
LOT 4
QUARTZ HILL
PLAT No. 22814
14534 OLD FREDERICK ROAD
FOURTH ELECTION DISTRICT
HOWARD COUNTY, MARYLAND
SCALE: 1" = 50' JULY, 2018

I CERTIFY THIS PLAT TO BE CORRECT; IT IS THE RESULT OF AN ACTUAL FIELD SURVEY, BASED ON DATA FOUND AMONG THE LAND RECORDS OF HOWARD COUNTY, MARYLAND, AS REFERENCED HEREON.

REFERENCE	JOB NO.
PLAT NO. 22814	B6-5595



VANMAR ASSOCIATES, INC.
Engineers Surveyors Planners
310 South Main Street Mount Airy, Maryland 21771
(301) 829-2890 (301) 831-5015 (410) 549-2751
©Copyright, Latest Date Shown