

CT 41744

SEQUENCE NO. (MDE USE ONLY)

STATE OF MARYLAND WELL COMPLETION REPORT FILL IN THIS FORM COMPLETELY PLEASE TYPE

THIS REPORT MUST BE SUBMITTED WITHIN 45 DAYS AFTER WELL IS COMPLETED.

COUNTY NUMBER

1 2 3 6 (THIS NUMBER IS TO BE PUNCHED IN COLS. 3-6 ON ALL CARDS)

ST/CO USE ONLY DATE Received MM 04 DD 30 YY 18

DATE WELL COMPLETED MM 4 DD 19 YY 18

Depth of Well 22 600 26 (TO NEAREST FOOT)

PERMIT NO. FROM "PERMIT TO DRILL WELL" OK 5/7/18 SC HO-17-0283

OWNER BOWEN, ANDY last name first name WELL SITE ADDRESS 13785 CHARLKVILLE AVE TOWN HIGHLAND SUBDIVISION SECTION LOT

WELL LOG

Not required for driven wells

STATE THE KIND OF FORMATIONS PENETRATED, THEIR COLOR, DEPTH, THICKNESS AND IF WATER BEARING

Table with columns: DESCRIPTION (Use additional sheets if needed), FEET (FROM, TO), check if water bearing. Rows include Top Soil, Brown Mica, Gray Mica, White Limestone, opening, Sand stone, Gray Mica.

GROUTING RECORD

WELL HAS BEEN GROUTED (Circle Appropriate Box) YES Y NO N TYPE OF GROUTING MATERIAL (Circle one) CEMENT CM BENTONITE CLAY BC NO. OF BAGS 7 NO. OF POUNDS 330 GALLONS OF WATER 161 DEPTH OF GROUT SEAL (to nearest foot) from 0 ft. to 57 ft.

CASING RECORD

MAIN CASING TYPE ST Nominal diameter top (main) casing (nearest inch)! 6 Total depth of main casing (nearest foot) 60

Table for OTHER CASING (if used) with columns for diameter and depth.

SCREEN RECORD

screen type or open hole (insert appropriate code below) ST BR HO PL OT

Table for DEPTH (nearest ft.) with columns for casing height and slot size.

C 3

PUMPING TEST

HOURS PUMPED (nearest hour) 3 PUMPING RATE (gal. per min.) 12 METHOD USED TO MEASURE PUMPING RATE Bucket WATER LEVEL (distance from land surface) BEFORE PUMPING 53 WHEN PUMPING 244 TYPE OF PUMP USED (for test) S submersible

PUMP INSTALLED

DRILLER INSTALLED PUMP YES NO IF DRILLER INSTALLS PUMP, THIS SECTION MUST BE COMPLETED FOR ALL WELLS. TYPE OF PUMP INSTALLED PLACE (A,C,J,P,R,S,T,O) IN BOX 29. CAPACITY: GALLONS PER MINUTE (to nearest gallon) 31 35 PUMP HORSE POWER 37 41 PUMP COLUMN LENGTH (nearest ft.) 43 47 CASING HEIGHT (circle appropriate box and enter casing height) + above LAND SURFACE - below (nearest foot)

LATITUDE 39.167528 LONGITUDE 76.946689 (DEFAULT COORD. WGS 84)

Pursuant to §10-624 of the State Govt. Article of the Maryland Code personal info. requested on this form is used in processing this form pursuant to COMAR 26.04.04. Failure to provide the info. may result in this form not being processed. You have the right to inspect, amend, or correct this form.

NUMBER OF UNSUCCESSFUL WELLS: 0 WELL HYDROFRACTURED YES Y NO N

CIRCLE APPROPRIATE LETTER A A WELL WAS ABANDONED AND SEALED WHEN THIS WELL WAS COMPLETED E ELECTRIC LOG OBTAINED P TEST WELL CONVERTED TO PRODUCTION WELL

I HEREBY CERTIFY THAT THIS WELL HAS BEEN CONSTRUCTED IN ACCORDANCE WITH COMAR 26.04.04 "WELL CONSTRUCTION" AND IN CONFORMANCE WITH ALL CONDITIONS STATED IN THE ABOVE CAPTIONED PERMIT, AND THAT THE INFORMATION PRESENTED HEREIN IS ACCURATE AND COMPLETE TO THE BEST OF MY KNOWLEDGE.

DRILLERS LIC. NO. 1 M UD 040 DRILLERS SIGNATURE (MUST MATCH SIGNATURE ON APPLICATION)

LIC. NO. 1 JS D 038

SITE SUPERVISOR (sign. of driller or journeyman responsible for sitework if different from permittee)

GRAVEL PACK IF WELL DRILLED WAS FLOWING WELL INSERT F IN BOX 68

MDE USE ONLY (NOT TO BE FILLED IN BY DRILLER) T (E.R.O.S.) W Q

TELESCOPE CASING LOG INDICATOR OTHER DATA

TAG: 4/19/18

B 1	SEQUENCE NO. (MDE USE ONLY) <b>52851</b>	STATE OF MARYLAND <b>APPLICATION FOR PERMIT TO DRILL WELL</b> please type <b>562479</b>	STATE PERMIT NUMBER <b>HO-17-0283</b> fill in this form completely
-----	---	--	--

**OWNER INFORMATION**

Date Received (APA) **02/20/18**

8 MM DD YY 13

**BOWEN ANDY**

15 Last Name Owner First Name 34

**10805 HICKORY RIDGE ROAD**

36 Street or RFD 55

**COLUMBIA MD 21044**

57 Town 70 State 72 Zip 76

**LOCATION OF WELL**

**Howard**

8 COUNTY 21

23 SUBDIVISION 42

SECTION 44 46 LOT 48 50

**Highland**

52 NEAREST TOWN 71

**DRILLER INFORMATION**

**George F. Easterday** M W D 040

Driller's Name 76 License No. 81

**L. Franklin Easterday, Inc.**

Firm Name

**9265 Brown Church Rd., Mt. Airy, Md. 21774**

Address

*George F. Easterday* 2/23/2018

Signature Date

**SOURCES OF DRILLING WATER**

1. **wells**

2.

3.

**13785 Clarksville Pike**

11 STREET ADDRESS 30

ON WHICH SIDE OF ROAD (CIRCLE APPROPRIATE BOX)

NORTH  
 WEST  
 EAST  
 SOUTH

34 300 37

DISTANCE FROM ROAD Ft.

ENTER FT OR MI 38 39

TAX MAP: **40** BLK: **16** PARCEL **109**

**WELL INFORMATION**

APPROX. PUMPING RATE (GAL. PER MIN.) **5**

8 12

AVERAGE DAILY QUANTITY NEEDED (GAL. PER DAY) **500**

14 20

**USE FOR WATER (CIRCLE APPROPRIATE BOX)**

DOMESTIC POTABLE SUPPLY & RESIDENTIAL IRRIGATION

FARMING (LIVESTOCK WATERING & AGRICULTURAL IRRIGATION)

INDUSTRIAL, COMMERCIAL, DEWATERING

PUBLIC WATER SUPPLY WELL

TEST, OBSERVATION, MONITORING

OPEN LOOP GEOTHERMAL

CLOSED LOOP GEOTHERMAL

**NOT TO BE FILLED IN BY DRILLER HEALTH DEPARTMENT APPROVAL**

**Howard** **13**

COUNTY NAME COUNTY NO.

STATE SIGNATURE INSERT S → 41

DATE ISSUED **3/23/18** **SI CLK** **3/23/19**

43 MM DD YY 48 CO SIGNATURE EXP. DATE

DNI

DON: 4/17/18 DOG: 4/19/18 DOY: 4/19/18

APPROXIMATE DEPTH OF WELL **300** FEET

24 28

APPROXIMATE DIAMETER OF WELL **6** NEAREST INCH

**METHOD OF DRILLING (circle one)**

BORED (or Augered) JETTED Jetted & DRIVEN

30 AIR-ROTary AIR-PERCussion ROTARY (Hydraulic Rotary)

37 CABLE REVerse-ROTary DRive-POINT

other \_\_\_\_\_

**REPLACEMENT OR DEEPEMED WELLS (CIRCLE APPROPRIATE BOX)**

THIS WELL WILL NOT REPLACE AN EXISTING WELL

THIS WELL WILL REPLACE A WELL THAT WILL BE ABANDONED AND SEALED

39  THIS WELL WILL REPLACE A WELL THAT WILL BE USED AS A STANDBY-CONTACT LOCAL APPROVING AUTHORITY FOR POLICY ON STANDBY WELLS

THIS WELL WILL DEEPEN AN EXISTING WELL

PERMIT NUMBER OF WELL TO BE REPLACED OR DEEPEMED (IF AVAILABLE) 41 \_\_\_\_\_ 52

**Not to be filled in by driller (MDE OR COUNTY USE ONLY)**

APPROP. PERMIT NUMBER \_\_\_\_\_ **G** \_\_\_\_\_

PERMIT No. **HO-17-0283**

70 71 72 73 74 75 76 77 78 79

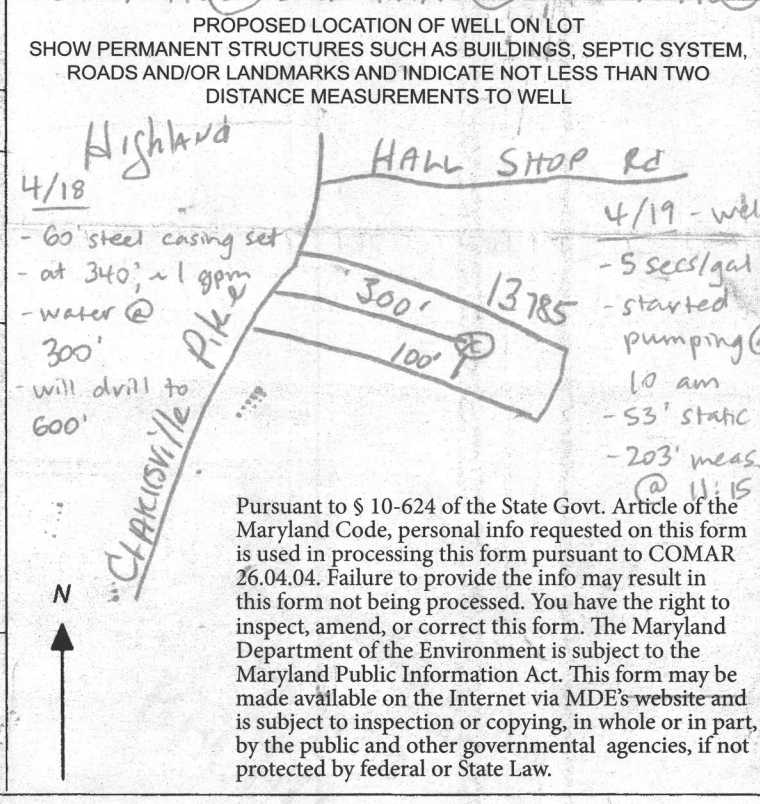

Pursuant to § 10-624 of the State Govt. Article of the Maryland Code, personal info requested on this form is used in processing this form pursuant to COMAR 26.04.04. Failure to provide the info may result in this form not being processed. You have the right to inspect, amend, or correct this form. The Maryland Department of the Environment is subject to the Maryland Public Information Act. This form may be made available on the Internet via MDE's website and is subject to inspection or copying, in whole or in part, by the public and other governmental agencies, if not protected by federal or State Law.



**HOWARD COUNTY HEALTH DEPARTMENT  
BUREAU OF ENVIRONMENTAL HEALTH  
WELL & SEPTIC PROGRAM  
TEL: (410)313-1771 FAX: (410)313-2648**

**Information Form for the Installation of the Well Pump, Pitless Adapter, and Supply Piping**

**NOTE:** The installer is responsible for requesting an inspection prior to 9 am on the day of the desired inspection. No work is to be covered until approved by the Health Department. All installations must comply with the National Standard Plumbing Code (NSPC, as amended locally) and COMAR 26.04.04 (MD Well Construction Regulations). Submission of a complete form is required prior to Use and Occupancy approval.

Company Name: Eastard, W. Ben Water Services Telephone #: 301-881-5170  
Address: 9205 Brown Church Rd.  
Mt. Airy MD 21771

(Must circle one) Licensed Plumber  **Licensed Well Driller**  Licensed Well Pump Installer   
License # and name of individual responsible for the field installation:  
Name (Print): Darren E. Wilson License# MDS 188

\*A licensed individual must perform the actual installation. Apprentices must be under the supervision of a licensed journeyman or master plumber, pump installer or well driller. Licenses may be subjected to field verification. Unlicensed individuals may be reported to the appropriate licensing agency.

Name of Property Owner: Andy Bowen Telephone #: 410-715-2759  
Subdivision: \_\_\_\_\_ Lot #: \_\_\_\_\_ Well Tag #: HO-17-0283  
Site Address: 13785 Clarksville Pk  
Highland MD 20777

<b><u>Submersible Pump Data</u></b>	<b><u>Pitless Adapter</u></b>	<b><u>Well Cap and Electric Conduit</u></b>
Make: <u>Grundfos</u>	Make: <u>BTE</u>	Two piece watertight cap: <u>Yes</u>
Model #: <u>16530-24</u>	Model#: <u>P-125-55</u>	Screened, vented well cap: <u>Yes</u>
Pump Capacity <u>16</u> GPM	Depth: <u>42"</u> (36" min)	Cap secured to casing: <u>Yes</u>
Well Yield: <u>12</u> GPM	NSF/WSC approved: <u>Yes</u>	Conduit min 18" B.G.: <u>Yes</u>
Depth of well encountered at time of pump installation: <u>600</u> (feet)		Conduit secured to well cap: <u>Yes</u>
If pump capacity exceeds well yield, a low water cut off switch is required by NSPC 1990 Section 17.8.4		
Torque arrestors, <u>Cable guards</u> , or other acceptable method used— Must circle one		
Safety rope, if used, attached to brass rope adapter or other acceptable method <u>inside of well casing</u> <u>Yes</u>		

<b><u>Piping to house</u></b>	<b><u>House Connection</u></b>
Type: <u>H.D.P.E</u>	PVC sleeve to undisturbed soil at wall penetration: <u>Yes</u>
PSI: <u>200</u> (160 psi min)	Length of sleeve(5' minimum from foundation): <u>5'</u>
Depth of supply line: <u>42"</u> (36" min)	Sleeve sealed properly: <u>Yes</u>

The water supply line is required to be at least ten feet from the septic tank, pump chamber, sewage piping, distribution box, drainfields, and sewage reserve area. If this cannot be accomplished, contact this office for approval prior to installation.

Signature of company representative responsible for installation \_\_\_\_\_ date 2-19-19

**For Health Department Use Only – Not to be completed by Installer**

Date Insp. Requested: \_\_\_\_\_ Date Insp. Approved: \_\_\_\_\_ Inspector: \_\_\_\_\_  
Inspection Data: Pitless adapter watertight & water supply line at least 36" below grade \_\_\_\_\_  
Two piece cap installed and attached to casing securely \_\_\_\_\_  
Elec. conduit extends at least 18" below grade/attached to cap properly \_\_\_\_\_  
Safety rope not outside of well cap/casing \_\_\_\_\_  
Correct well tag attached properly and casing 8" above finished grade \_\_\_\_\_  
Water supply line sleeved adequately at house connection \_\_\_\_\_  
Adequate grout observed below pitless adapter \_\_\_\_\_

Maura J. Rossman, M.D., Health Officer

**Information Form for the Installation of the Well Pump, Pitless Adapter, and Supply Piping**

**NOTE: The installer is responsible for requesting an inspection prior to 9 am on the day of the desired inspection. No work is to be covered until approved by the Health Department. All installations must comply with the National Standard Plumbing Code (NSPC, as amended locally) and COMAR 26.04.04 (MD Well Construction Regulations). Submission of a complete form is required prior to Use and Occupancy approval.**

Company Name: Easterday Telephone #: \_\_\_\_\_  
 Address: \_\_\_\_\_

(Must circle one) Licensed Plumber Licensed Well Driller Licensed Well Pump Installer  
 License # and name of individual responsible for the field installation:

Name (Print): \_\_\_\_\_ License# \_\_\_\_\_

**\*A licensed individual must perform the actual installation. Apprentices must be under the supervision of a licensed journeyman or master plumber, pump installer or well driller. Licenses may be subjected to field verification. Unlicensed individuals may be reported to the appropriate licensing agency.**

Name of Property Owner: \_\_\_\_\_ Telephone #: \_\_\_\_\_  
 Subdivision: \_\_\_\_\_ Lot #: \_\_\_\_\_ Well Tag #: HO - 17 - 0203  
 Site Address: 13785 Clarksville Pike

**Submersible Pump Data**

Make: \_\_\_\_\_ Model #: \_\_\_\_\_ Pump Capacity \_\_\_\_\_ Well Yield: \_\_\_\_\_  
 GPM Depth: \_\_\_\_\_ (36" min)  
 GPM NSF/WSC approved: \_\_\_\_\_  
 Depth of well encountered at time of pump installation: \_\_\_\_\_ (feet)

**Pitless Adapter**

Make: \_\_\_\_\_ +  
 Model#: \_\_\_\_\_

**Well Cap and Electric Conduit**

Two piece watertight cap: \_\_\_\_\_  
 Screened, vented well cap: \_\_\_\_\_  
 Cap secured to casing: \_\_\_\_\_  
 Conduit min 18" B.G.: \_\_\_\_\_  
 Conduit secured to well cap: \_\_\_\_\_

If pump capacity exceeds well yield, a low water cut off switch is required by NSPC 1990 Section 17.8.4

Torque arrestors, Cable guards, or other acceptable method used- Must circle one

Safety rope, if used, attached to brass rope adapter or other acceptable method inside of well casing

**Piping to house**

Type: \_\_\_\_\_  
 PSI: \_\_\_\_\_ (160 psi min)  
 Depth of supply line: \_\_\_\_\_ (36" min)

**House Connection**

PVC sleeve to undisturbed soil at wall penetration: \_\_\_\_\_  
 Length of sleeve(5' minimum from foundation): \_\_\_\_\_  
 Sleeve sealed properly: \_\_\_\_\_

**The water supply line is required to be at least ten feet from the septic tank, pump chamber, sewage piping, distribution box, drainfields, and sewage reserve area. If this cannot be accomplished, contact this office for approval prior to installation.**

Signature of company representative responsible for installation \_\_\_\_\_ date \_\_\_\_\_

**For Health Department Use Only - Not to be completed by Installer**

Date Insp. Requested: 2/19/19 Date Insp. Approved: 2/19/19 Inspector: SC

Inspection Data: Pitless adapter watertight & water supply line at least 36" below grade ✓

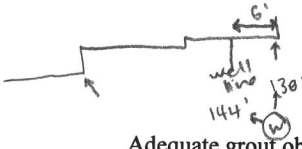

- Two piece cap installed and attached to casing securely ✓
- Elec. conduit extends at least 18" below grade/attached to cap properly ✓
- Safety rope not outside of well cap/casing ✓
- Correct well tag attached properly and casing 8" above finished grade ✓
- Water supply line sleeved adequately at house connection ✓

Adequate grout observed below pitless adapter ✓

(Revised form 10/24/2018)

Maura J. Rossman, M.D., Health Officer

**INTERIM CERTIFICATE OF POTABILITY**

**Expiration Date – APRIL 8, 2020**

October 8, 2019

Homeowner  
13785 Clarksville Pike  
Highland, MD 20777

**RE: Bowen Property, P. 109**  
**13785 Clarksville Pike**  
**Building Permit: B18002784**  
**Well Permit: HO-17-0283**

Dear Homeowner:

This is to advise you that the septic system installation and water well construction for the above referenced property have been inspected and approved. Final approval of the septic system was granted on **4/12/2019**. Final approval of the well line connection to the dwelling was granted on **2/19/2019**. The well construction was completed on **4/19/2018**. Water samples were collected on **8/29/2019**.

The water sample results indicate that the water samples submitted for testing were free of coliform and fecal coliform bacteria at the time of sampling and are bacteriologically safe for drinking. This certifies that the initial sampling requirements of COMAR 26.04.04 "Well Regulations" have been met for the water supply system installed under well permit HO-17-0283. Although the submitted sample results are in compliance with COMAR standards, the Health Department does not guarantee water supplies.

This Interim Certificate of Potability will expire **six months** from the date of issuance. Submission of a second bacteriological test indicating the water is free of coliform and fecal coliform bacteria is required prior to the expiration date, after which time a Final Certificate of Potability will be issued. **Failure to submit an additional sample and obtain a Final Certificate of Potability will result in a Notice of Violation and is punishable as a misdemeanor under the *Annotated Code of Maryland, Environment Article, 9-1311*, subject to a fine of up to \$500 or imprisonment not to exceed three months.**

Please contact (410) 313-1773 to schedule a final water sample appointment or contact a Maryland certified water laboratory to schedule a water sample. A list of laboratories certified by the state of Maryland may be found at the following website:  
<http://www.mde.state.md.us/assets/document/WSP-Labs-2010apr16.pdf>

---

**Maura J. Rossman, M.D., Health Officer**

In closing, please refer to our "Homeowner Fact Sheet" which illustrates a better understanding for your Onsite Sewage Disposal System. You will also find a link to Maryland Department of the Environment's website which describes in further detail operation and maintenance of your septic system.

Approving Authority,

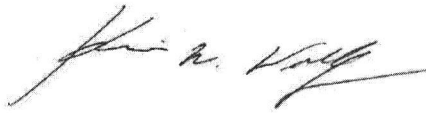

Kevin M. Wolf, LEHS, R.S./REHS, Supervisor  
Groundwater Management Section  
Well & Septic Program

cc: Howard County Dept. of Inspections, Licenses, and Permits  
Community Hygiene Program  
File

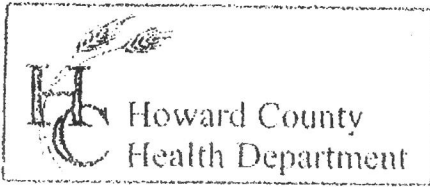

3525 H Ellicott Mills Drive, Ellicott City, MD 21043  
(410) 313-2640 Fax (410) 313-2648  
TDD (410) 313-2323 Toll Free 1-866-313-6300  
website: www.hchealth.org

Penny E. Borenstein, M.D., M.P.H., Health Officer

TO ALL INTERESTED PARTIES

When submitting a well permit application for a proposed well for new construction, please indicate one of the following:

- The well site has been staked by 2-2-18 - Benchmarks  
(professional land surveyor or company employing professional land surveyors)  
on 2-2-18 (date) and does not require a site inspection.
- The well driller, builder or property owner will call the Health Department to schedule a time to meet in the field to verify the proposed well site location.

This sheet, along with two copies of an acceptable well site plan, must be attached to the green well permit application.

Revised 6/10/03

13785 Clarksville Pike



# FOUNTAIN VALLEY ANALYTICAL LABORATORY, INC.

1413 Old Taneytown Rd. Westminster, MD (410) 848-1014 (410) 876-4554 FAX (410) 848-0298

## REPORT OF ANALYSIS

Laboratory ID #: 132510 Account #: 31617  
Reference: Andy Bowen Company: CASH ACCOUNT  
Location: 13785 Clarksville Pike Requested By: Andy Bowen  
Highland, MD 20777 Source: Well Water  
Date/ Time Collected: 8/29/2019 1225 Site: Pressure Tank ✓  
Date/Time Rec'd: 8/29/2019 1545 Treatment: Prior to Sediment Filter ✓  
Chlorine ppm: Free: ND Total: ND pH: 7.3  
Collected By: J. Yeager 6176JY Well #: HO-17-0283

PARAMETERS	RESULTS	UNITS	REFERENCE	METHOD	DATE/TIME/ANALYST
Bacteria, Coliform, Total, MPN	<1.0 ✓	MPN/ 100 ml	<1.0	SM20 9223B	8/30/2019 / 1045 / RER
Bacteria, E. coli, MPN	<1.0 ✓	MPN/ 100 ml	<1.0	SM20 9223B	8/30/2019 / 1045 / RER
Nitrate	<1.0 ✓	mg/L	10	601	8/30/2019 / 1035 / RER
Turbidity	2.52	NTU	<10	SM20 2130B	8/30/2019 / 1110 / RER
Sand	NS	mg/L	5	Visual/Gravimetric	8/30/2019 / 1110 / RER

OK

### NOTES

- 1 mg/L = milligrams per liter (also, parts per million)
- 2 MPN/ 100 ml = Most Probable Number [of viable bacteria] per 100 ml of sample.
- 3 NS = None Seen (NS indicates less than 5 mg/L)
- 4 NTU = Nephelometric Turbidity Units
- 5 Results less than or within the reference range are considered satisfactory and within potable water limits at the time of sampling.
- 6 ND:None Detected
- 7 Visual well check: Sealed, vented cap
- 8 pH & Chlorine level tested on site

Reason for Test : Use & Occupancy  
Building Permit # : B18002784

Date Reported: 8/30/2019