

PCB 8/19/19

Search Result for HOWARD COUNTY

[View Map](#)      [View GroundRent Redemption](#)      [View GroundRent Registration](#)

**Tax Exempt:**      **Special Tax Recapture:**  
**Exempt Class:**      NONE  
**Account Identifier:**      **District - 06 Account Number - 472931**

Owner Information

**Owner Name:** TA MID POINT PORTFOLIO LLC      **Use:** INDUSTRIAL  
 C/O TA REALTY LLC      **Principal Residence:** NO  
**Mailing Address:** 28 STATE ST      **Deed Reference:** /18483/ 00345  
 10TH FLOOR  
 BOSTON MA 02019-

Location & Structure Information

**Premises Address:** 8350 BRISTOL CT      **Legal Description:** PAR L BLK E 6.013 A  
 JESSUP 20794-0000      8350 BRISTOL CT ES  
 BALTO WASH IND PK BLK E

Map:	Grid:	Parcel:	Sub District:	Subdivision:	Section:	Block:	Lot:	Assessment Year:	Plat No:	18297
0048	0002	0173		0000			PAR L	2020	Plat Ref:	

**Special Tax Areas:**      **Town:** NONE  
**Ad Valorem:** 104  
**Tax Class:**

Primary Structure Built	Above Grade Living Area	Finished Basement Area	Property Land Area	County Use
1987	68,154 SF		6.0100 AC	

Stories	Basement	Type	Exterior	Full/Half Bath	Garage	Last Major Renovation
		STORAGE WAREHOUSE				

Value Information

	Base Value	Value As of 01/01/2017	Phase-in Assessments As of 07/01/2019	As of 07/01/2020
Land:	1,570,700	1,570,700		
Improvements	2,601,500	2,601,500		
Total:	4,172,200	4,172,200	4,172,200	
Preferential Land:	0			

Transfer Information

<b>Seller:</b> ICON OWNER POOL 2 WEST/NORTHEAST/ <b>Type:</b> ARMS LENGTH IMPROVED	<b>Date:</b> 12/13/2018 <b>Deed1:</b> /18483/ 00345	<b>Price:</b> \$9,080,326 <b>Deed2:</b>
<b>Seller:</b> BRE/DP MD LLC <b>Type:</b> NON-ARMS LENGTH OTHER	<b>Date:</b> 09/05/2018 <b>Deed1:</b> /18349/ 00277	<b>Price:</b> \$0 <b>Deed2:</b>
<b>Seller:</b> RPH INDUSTRIAL LLC <b>Type:</b> ARMS LENGTH MULTIPLE	<b>Date:</b> 06/28/2012 <b>Deed1:</b> /14111/ 00346	<b>Price:</b> \$10,100,000 <b>Deed2:</b>

Exemption Information

Partial Exempt Assessments:	Class	07/01/2019	07/01/2020
County:	000	0.00	
State:	000	0.00	
Municipal:	000	0.00	0.00

**Tax Exempt:**      **Special Tax Recapture:**  
**Exempt Class:**      NONE

Homestead Application Information

**Homestead Application Status:** No Application

**Homeowners' Tax Credit Application Status:** No Application

**Date:**

---

1. This screen allows you to search the Real Property database and display property records.
2. Click **here** for a glossary of terms.
3. Deleted accounts can only be selected by Property Account Identifier.
4. The following pages are for information purpose only. The data is not to be used for legal reports or documents. While we have confidence in the accuracy of these records, the Department makes no warranties, expressed or implied, regarding the information.

Permit  
4/5/83  
9:30 AM  
5/13/83  
9:30 A.M.

# APPLICATION

SEWAGE DISPOSAL TESTING

STATE OF MARYLAND - DEPARTMENT OF HEALTH AND MENTAL HYGIENE

A 32627

P \_\_\_\_\_

HOWARD COUNTY HEALTH DEPARTMENT  
ENVIRONMENTAL HEALTH SERVICES

P. O. BOX 473 ELLICOTT CITY, MARYLAND 21043  
TELEPHONE: 992-2330

DISTRICT 6

DATE 4/5/83

TO: THE COUNTY HEALTH OFFICER  
ELLICOTT CITY, MARYLAND

I, HEREBY, APPLY FOR THE NECESSARY TEST IN ORDER TO CONSTRUCT (OR RECONSTRUCT) A SEWAGE DISPOSAL SYSTEM.

PROPERTY OWNER B.W.I.P. Inc.

ADDRESS 110 West Rd Towson, Md 21204 PHONE 296-6400

PROPERTY LOCATION:

SUBDIVISION Balto Wash Ind Pk LOT NO. B

ROAD AND DESCRIPTION North side of Patuxent Range Rd  
650' West of Dorsey Run Rd

SIZE OF LOT 500' x 110' TYPE BLDG. \_\_\_\_\_ (NUMBER OF BEDROOMS)

THE SYSTEM INSTALLED UNDER THIS APPLICATION IS ACCEPTABLE ONLY UNTIL PUBLIC FACILITIES BECOME AVAILABLE. I FULLY UNDERSTAND THE FEE CONNECTED WITH THE FILING OF THIS PERC TEST APPLICATION IS NON-REFUNDABLE UNDER ANY CIRCUMSTANCES. I ALSO AGREE TO COMPLY WITH ALL M.O.S.H.A. REQUIREMENTS IN TESTING THIS LOT.

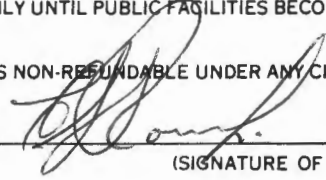

(SIGNATURE OF APPLICANT)

APPROVED BY \_\_\_\_\_ FOR \_\_\_\_\_ DATE \_\_\_\_\_

REJECTED BY \_\_\_\_\_ FOR \_\_\_\_\_ DATE \_\_\_\_\_

HOLD PENDING FURTHER TESTS \_\_\_\_\_ DATE \_\_\_\_\_

REASONS FOR REJECTION OR HOLDING 11 MAY 83 PERC OK HOLD FOR PERC  
CERT PLAT R/H FS SAID PUMP OK TO OSD  
FOR SEPT IC

# THIS IS NOT A PERMIT

SOIL PROFILE

0'

INDICATE NORTH - NAME ADJOINING ROADWAY AS BASE LINE.

DATE	TEST NO.	DEPTH	PRE-WET		TEST - 1" DROP		TIME
			START	STOP	START	STOP	

REMARKS \_\_\_\_\_

TYPE OF SOIL \_\_\_\_\_

TESTED BY \_\_\_\_\_ ALSO PRESENT \_\_\_\_\_

EH 12 1079

# APPLICATION

SEWAGE DISPOSAL TESTING

A 32627

STATE OF MARYLAND - DEPARTMENT OF HEALTH AND MENTAL HYGIENE

P \_\_\_\_\_

HOWARD COUNTY HEALTH DEPARTMENT  
ENVIRONMENTAL HEALTH SERVICES

P. O. BOX 476 ELLICOTT CITY, MARYLAND 21043  
TELEPHONE: 992-2330

DISTRICT 6th

DATE 4/5/83

TO: THE COUNTY HEALTH OFFICER  
ELLICOTT CITY, MARYLAND

I, HEREBY, APPLY FOR THE NECESSARY TEST IN ORDER TO CONSTRUCT (OR RECONSTRUCT) A SEWAGE DISPOSAL SYSTEM.

PROPERTY OWNER BWIP

ADDRESS 110 West Road, Towson, Md PHONE 296-4408

PROPERTY LOCATION:

SUBDIVISION \_\_\_\_\_ LOT NO. B.

ROAD AND DESCRIPTION \_\_\_\_\_

SIZE OF LOT \_\_\_\_\_ TYPE BLDG. \_\_\_\_\_ (NUMBER OF BEDROOMS)

THE SYSTEM INSTALLED UNDER THIS APPLICATION IS ACCEPTABLE ONLY UNTIL PUBLIC FACILITIES BECOME AVAILABLE. I FULLY UNDERSTAND THE FEE CONNECTED WITH THE FILING OF THIS PERC TEST APPLICATION IS NON-REFUNDABLE UNDER ANY CIRCUMSTANCES. I ALSO AGREE TO COMPLY WITH ALL M.O.S.H.A. REQUIREMENTS IN TESTING THIS LOT. \_\_\_\_\_

(SIGNATURE OF APPLICANT)

APPROVED BY \_\_\_\_\_ FOR \_\_\_\_\_ DATE \_\_\_\_\_

REJECTED BY \_\_\_\_\_ FOR \_\_\_\_\_ DATE \_\_\_\_\_

HOLD PENDING FURTHER TESTS \_\_\_\_\_ DATE \_\_\_\_\_

REASONS FOR REJECTION OR HOLDING \_\_\_\_\_

# THIS IS NOT A PERMIT

3

SOIL PROFILE

BED CLAY WITH STRAIN

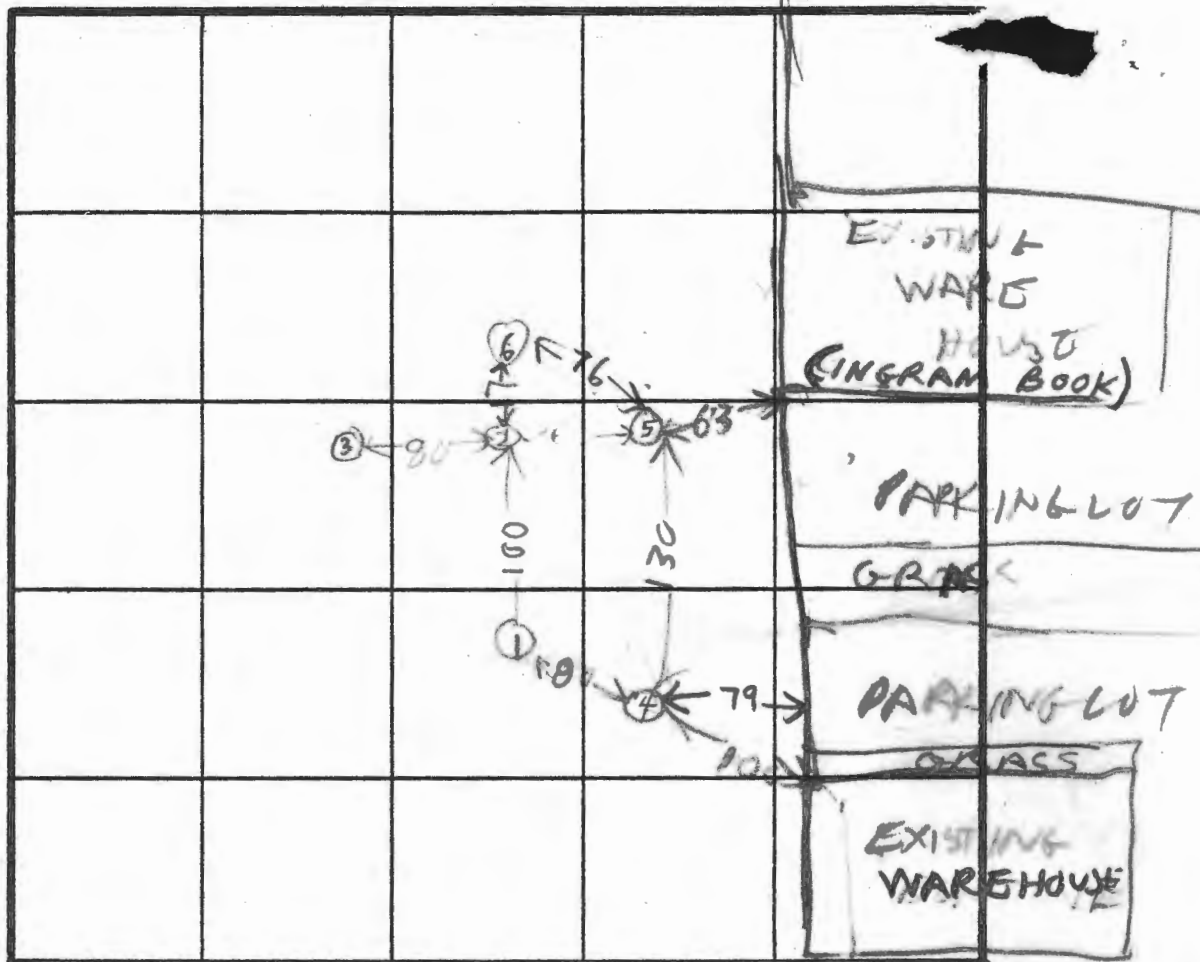

INDICATE NORTH - NAME ADJOINING ROADWAY AS BASE LINE.

4

CLAY SAND FILLER

BROWN CLAY SAND MIX

DATE	TEST NO.	DEPTH	PRE-WET		TEST - 1" DROP		TIME
			START	STOP	START	STOP	
5/11/63	1S	3	1019	1022	1022	1027	5
	1V	11	LOOKS	OK	ALL	SAND	
	2S	3	1033	1033 1/2	1033 1/2	1034	1/2
	2V	11	LOOKS	OK	ALL	SAND	
	3V	9					
	4S	4	1122	1123	1123	1125	2
12/1/63	4P	7 1/2	1201	1202	1202	1204	2
	4V	12	LOOKS	OK			
	5S	3	120	121	121	122	1
5/11/63	3V	11	LOOKS	OK	ALL	SAND	
	6V	11	ALL	SAND	LOOKS	OK	

HOLE ELEVATION  
A  
5' HIGH  
12' 6" LOW

REMARKS CITY WATER LOT ALMOST LEVEL

TYPE OF SOIL LOT NOT STAKED NEAR BY BUILDING USE

TESTED BY R. HODGES SIM, LEE RON DIGGERS  
ALSO PRESENT BOB ROESNER SURVEYOR

EH-12-1079

# APPLICATION

SEWAGE DISPOSAL TESTING

STATE OF MARYLAND - DEPARTMENT OF HEALTH AND MENTAL HYGIENE

A 32628  
P \_\_\_\_\_

HOWARD COUNTY HEALTH DEPARTMENT  
ENVIRONMENTAL HEALTH SERVICES

P. O. BOX 473 ELLICOTT CITY, MARYLAND 21043  
TELEPHONE: 992-2330

DISTRICT 6  
DATE 4/5/83

*Prep:*  
*4/13/83*  
*9:50 AM*  
*5/13/83*  
*9:30 AM*

TO: THE COUNTY HEALTH OFFICER  
ELLICOTT CITY, MARYLAND

I, HEREBY, APPLY FOR THE NECESSARY TEST IN ORDER TO CONSTRUCT (OR RECONSTRUCT) A SEWAGE DISPOSAL SYSTEM.

PROPERTY OWNER B.I.P. Inc  
ADDRESS 110 West Rd Towson, Md 21286 PHONE 296-6400

PROPERTY LOCATION:  
SUBDIVISION Balto. Wash-Ind. Pl. LOT NO. 6  
ROAD AND DESCRIPTION N.W. cor. of Patuxent Range Rd  
+ Dowsy Run Rd  
SIZE OF LOT 550' x 950' ± TYPE BLDG. 2 (NUMBER OF BEDROOMS)

THE SYSTEM INSTALLED UNDER THIS APPLICATION IS ACCEPTABLE ONLY UNTIL PUBLIC FACILITIES BECOME AVAILABLE. I FULLY UNDERSTAND THE FEE CONNECTED WITH THE FILING OF THIS PERC TEST APPLICATION IS NON-REFUNDABLE UNDER ANY CIRCUMSTANCES. I ALSO AGREE TO COMPLY WITH ALL M.O.S.H.A. REQUIREMENTS IN TESTING THIS LOT.

*[Signature]*  
(SIGNATURE OF APPLICANT)

APPROVED BY \_\_\_\_\_ FOR \_\_\_\_\_ DATE \_\_\_\_\_  
REJECTED BY \_\_\_\_\_ FOR \_\_\_\_\_ DATE \_\_\_\_\_  
HOLD PENDING FURTHER TESTS \_\_\_\_\_ DATE \_\_\_\_\_

REASONS FOR REJECTION OR HOLDING 13 MAY 83 - DIB MORE SLOW PERC SOIL & WATER PH  
H.S. SAID OK TO USE A PUMP FOR SEPTIC  
SYSTEM

# THIS IS NOT A PERMIT



# APPLICATION

SEWAGE DISPOSAL TESTING

STATE OF MARYLAND - DEPARTMENT OF HEALTH AND MENTAL HYGIENE

HOWARD COUNTY HEALTH DEPARTMENT  
ENVIRONMENTAL HEALTH SERVICES

P. O. BOX 476 ELLICOTT CITY, MARYLAND 21043  
TELEPHONE: 992-2330

A 32628

P \_\_\_\_\_

DISTRICT 6

DATE 4/5/83

TO: THE COUNTY HEALTH OFFICER  
ELLICOTT CITY, MARYLAND

I, HEREBY, APPLY FOR THE NECESSARY TEST IN ORDER TO CONSTRUCT (OR RECONSTRUCT) A SEWAGE DISPOSAL SYSTEM.

PROPERTY OWNER BWIP Inc

ADDRESS 110 West Rd, Towson, Md 21204 PHONE 296-4400

PROPERTY LOCATION:

SUBDIVISION \_\_\_\_\_ LOT NO. C

ROAD AND DESCRIPTION \_\_\_\_\_

SIZE OF LOT \_\_\_\_\_ TYPE BLDG. \_\_\_\_\_ (NUMBER OF BEDROOMS)

THE SYSTEM INSTALLED UNDER THIS APPLICATION IS ACCEPTABLE ONLY UNTIL PUBLIC FACILITIES BECOME AVAILABLE. I FULLY UNDERSTAND THE FEE CONNECTED WITH THE FILING OF THIS PERC TEST APPLICATION IS NON-REFUNDABLE UNDER ANY CIRCUMSTANCES. I ALSO AGREE TO COMPLY WITH ALL M.O.S.H.A. REQUIREMENTS IN TESTING THIS LOT. \_\_\_\_\_

(SIGNATURE OF APPLICANT)

APPROVED BY \_\_\_\_\_ FOR \_\_\_\_\_ DATE \_\_\_\_\_

REJECTED BY \_\_\_\_\_ FOR \_\_\_\_\_ DATE \_\_\_\_\_

HOLD PENDING FURTHER TESTS \_\_\_\_\_ DATE \_\_\_\_\_

REASONS FOR REJECTION OR HOLDING \_\_\_\_\_

# THIS IS NOT A PERMIT

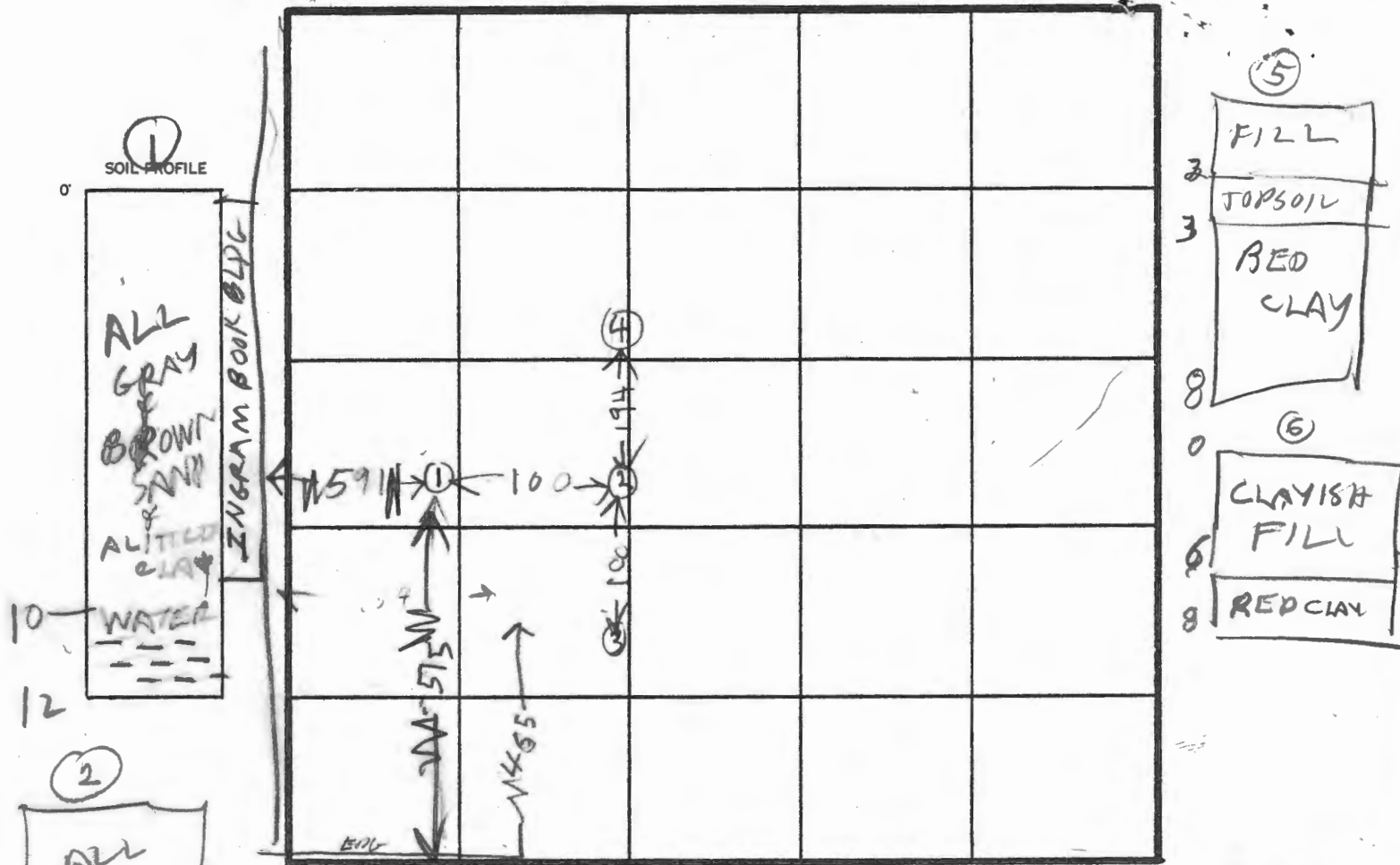

INDICATE NORTH - NAME ADJOINING ROADWAY AS BASE LINE.

PATUXENT RANGE RD

JODORSON RUN RD

DATE	TEST NO.	DEPTH	PRE-WET		TEST - 1" DROP		TIME
			START	STOP	START	STOP	
5/1/83	1S	3"	1006	1016	1016	1025	9
	1V	12"	WATER		1017		
	2S	2"	1022	1023	1023	1030	7
	2V	9"	WATER		8F7		
	3V	7 1/2"	WATER				
	4V	6"	LOOKS BAD				
	5V	8"	LOOKS BAD				
	6V	8"	LOOKS BAD				

REMARKS SEE PAGE 2 FOR HOLE 5 6 LOCATION

TYPE OF SOIL

TESTED BY R HODGES ALSO PRESENT

EH-12-1078

*Prel.*  
*4/13/83 cancelled*  
*9:30 AM*  
*4/20/83*  
*NO BACKFLOW*

# APPLICATION

*5/11/83 5/13/83*  
*9:30 A.M.*

SEWAGE DISPOSAL TESTING

STATE OF MARYLAND - DEPARTMENT OF HEALTH AND MENTAL HYGIENE

A 32626

P \_\_\_\_\_

HOWARD COUNTY HEALTH DEPARTMENT  
ENVIRONMENTAL HEALTH SERVICES  
P. O. BOX 473 ELLICOTT CITY, MARYLAND 21043  
TELEPHONE: 992-2330

DISTRICT 6

DATE 4/5/83

TO: THE COUNTY HEALTH OFFICER  
ELLICOTT CITY, MARYLAND

I, HEREBY, APPLY FOR THE NECESSARY TEST IN ORDER TO CONSTRUCT (OR RECONSTRUCT) A SEWAGE DISPOSAL SYSTEM.

PROPERTY OWNER B.W. L.P. Inc

ADDRESS 110 West Rd Towson, Md. 21204 PHONE 296-6400

PROPERTY LOCATION:  
SUBDIVISION Balto. Wash. Ind. Pl. LOT NO. A

ROAD AND DESCRIPTION S.W. cor. of Patuxent Range Rd  
+ Dorsey Run Rd.

SIZE OF LOT 650' x 1500' ± TYPE BLDG. \_\_\_\_\_ (NUMBER OF BEDROOMS)

THE SYSTEM INSTALLED UNDER THIS APPLICATION IS ACCEPTABLE ONLY UNTIL PUBLIC FACILITIES BECOME AVAILABLE. I FULLY UNDERSTAND THE FEE CONNECTED WITH THE FILING OF THIS PERC TEST APPLICATION IS NON-REFUNDABLE UNDER ANY CIRCUMSTANCES. I ALSO AGREE TO COMPLY WITH ALL M.O.S.H.A. REQUIREMENTS IN TESTING THIS LOT.

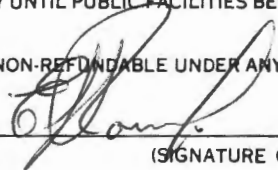

(SIGNATURE OF APPLICANT)

APPROVED BY \_\_\_\_\_ FOR \_\_\_\_\_ DATE \_\_\_\_\_

REJECTED BY \_\_\_\_\_ FOR \_\_\_\_\_ DATE \_\_\_\_\_

HOLD PENDING FURTHER TESTS \_\_\_\_\_ DATE \_\_\_\_\_

REASONS FOR REJECTION OR HOLDING 4/20/83 BACKHOE NO SHOW RH  
5/11/83 DIG MORE SLOW PERC & WATER

# THIS IS NOT A PERMIT

SOIL PROFILE

0'

INDICATE NORTH - NAME ADJOINING ROADWAY AS BASE LINE.

DATE	TEST NO.	DEPTH	PRE-WET		TEST - 1" DROP		TIME
			START	STOP	START	STOP	

REMARKS \_\_\_\_\_

TYPE OF SOIL \_\_\_\_\_

TESTED BY \_\_\_\_\_ ALSO PRESENT \_\_\_\_\_

EH 12 1079

# APPLICATION

SEWAGE DISPOSAL TESTING

STATE OF MARYLAND - DEPARTMENT OF HEALTH AND MENTAL HYGIENE

HOWARD COUNTY HEALTH DEPARTMENT  
ENVIRONMENTAL HEALTH SERVICES  
P. O. BOX 476 ELLICOTT CITY, MARYLAND 21043  
TELEPHONE: 992-2330

A 32626

P \_\_\_\_\_

DISTRICT 6

DATE 4/5/83

TO: THE COUNTY HEALTH OFFICER  
ELLICOTT CITY, MARYLAND

I, HEREBY, APPLY FOR THE NECESSARY TEST IN ORDER TO CONSTRUCT (OR RECONSTRUCT) A SEWAGE DISPOSAL SYSTEM.

PROPERTY OWNER BWIP, Inc

ADDRESS 110 West Road, Towson, Md 21204 PHONE 296-6400

PROPERTY LOCATION:

SUBDIVISION \_\_\_\_\_ LOT NO. A

ROAD AND DESCRIPTION \_\_\_\_\_

SIZE OF LOT \_\_\_\_\_ TYPE BLDG. \_\_\_\_\_ (NUMBER OF BEDROOMS)

THE SYSTEM INSTALLED UNDER THIS APPLICATION IS ACCEPTABLE ONLY UNTIL PUBLIC FACILITIES BECOME AVAILABLE. I FULLY UNDERSTAND THE FEE CONNECTED WITH THE FILING OF THIS PERC TEST APPLICATION IS NON-REFUNDABLE UNDER ANY CIRCUMSTANCES. I ALSO AGREE TO COMPLY WITH ALL M.O.S.H.A. REQUIREMENTS IN TESTING THIS LOT.

(SIGNATURE OF APPLICANT)

APPROVED BY \_\_\_\_\_ FOR \_\_\_\_\_ DATE \_\_\_\_\_

REJECTED BY \_\_\_\_\_ FOR \_\_\_\_\_ DATE \_\_\_\_\_

HOLD PENDING FURTHER TESTS \_\_\_\_\_ DATE \_\_\_\_\_

REASONS FOR REJECTION OR HOLDING \_\_\_\_\_

# THIS IS NOT A PERMIT

5

RED  
GRAY  
BROWN  
CLAY

SAND  
& CLAY

SOIL PROFILE

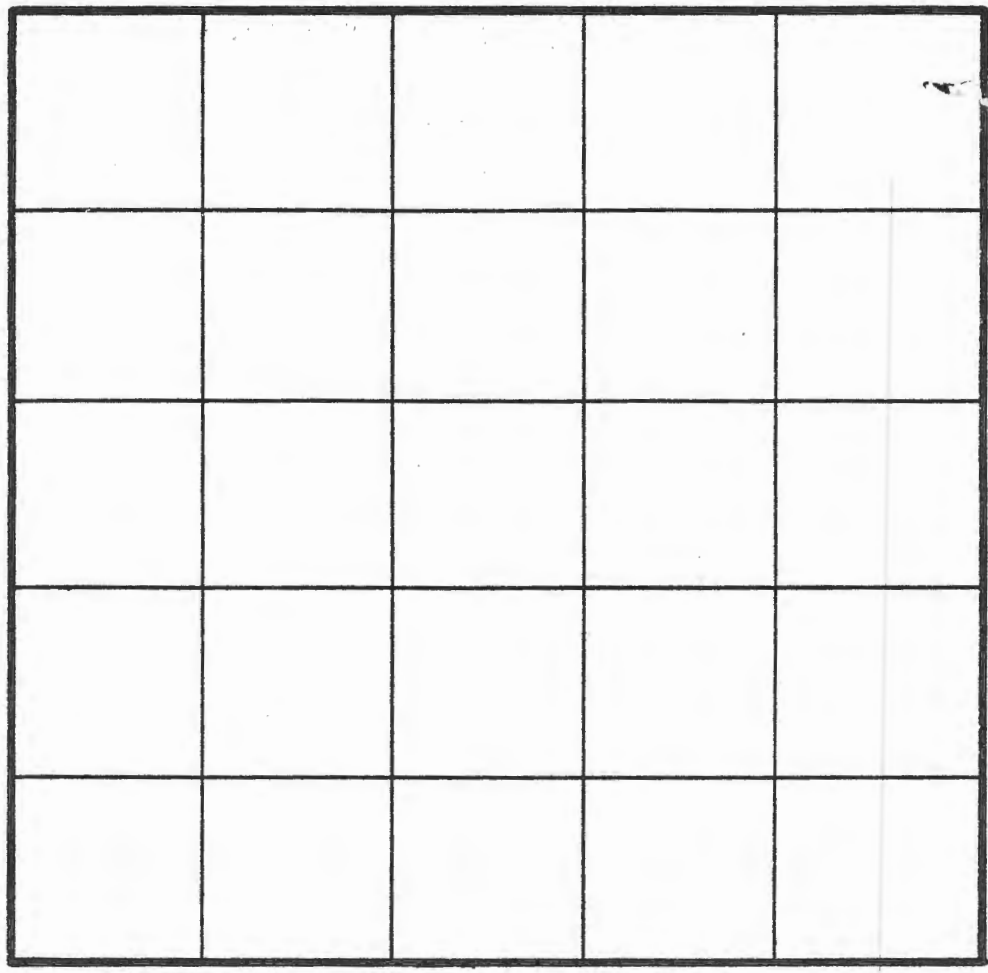
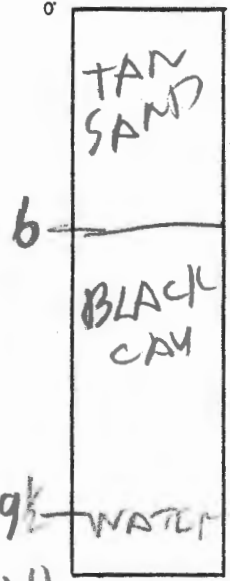

INDICATE NORTH - NAME ADJOINING ROADWAY AS BASE LINE.

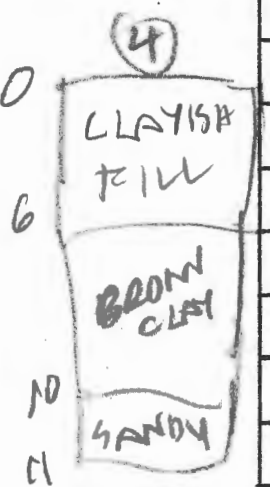

DATE	TEST NO.	DEPTH	PRE-WET		TEST - 1" DROP		TIME
			START	STOP	START	STOP	
5/11/83	1V	5	ALL	CLAY & FILL			
5/11/82	2V	10	LOOK	UNSATISFACTORY			
	3V	7 1/2	WATER	9 1/2			
	4V	11	CLAY IS	UNSATISFACTORY			
	5V	12	WATER	UNSATISFACTORY			

5

REMARKS 5/10/83 SURVEY OR WILL LOCATE ABOVE 5 UNSATISFACTORY HOLES LATER

TYPE OF SOIL \_\_\_\_\_

TESTED BY Raymond Hodge ALSO PRESENT \_\_\_\_\_

BALTIMORE WASHINGTON INDUSTRIAL PARK SALES PLAT

THE ARUNDEL CORPORATION BALTIMORE, MD.

SCALE: 1" = 200'  
 DATE: 5-15-77  
 DRAWN: JHC  
 TRACED: H &  
 REV: 5/17/77  
 CHECKED: DSK  
 10/17/77  
 APPROVED: DSK



NOTE:  
 PARCELS SOLD OR OCCUPIED SHOWN THUS: [Hatched Box]  
 PARCELS FOR FUTURE DEVELOPMENT SHOWN AREA ONLY - [Dotted Box]

246.633 AC ± TOTAL NET SALABLE AREA  
 274.879 AC ± GROSS AREA OF TRACT

1-95

KEY MAP  
 SCALE 1" = 2000'