

REB 8/19/19

Search Result for HOWARD COUNTY

View Map	View GroundRent Redemption	View GroundRent Registration
--------------------------	--	--

Tax Exempt:	Special Tax Recapture:
Exempt Class:	NONE
Account Identifier:	District - 06 Account Number - 430090

Owner Information			
Owner Name:	CI BALTIMORE I PRU LLC C/O COLONY NORTHSTAR INC	Use:	INDUSTRIAL
Mailing Address:	1412 MAIN ST STE 1500 DALLAS TX 75056-	Principal Residence:	NO
		Deed Reference:	/17931/ 00481

Location & Structure Information			
Premises Address:	8125 SE STAYTON DR JESSUP 20794-0000	Legal Description:	PAR A BL C 9.435 A 8125 STAYTON DR BALTO WASH IND PK

Map:	Grid:	Parcel:	Sub District:	Subdivision:	Section:	Block:	Lot:	Assessment Year:	Plat No:
0048	0001	0139		0000			PAR A	2020	Plat Ref:

Special Tax Areas:	Town:	NONE
	Ad Valorem:	104
	Tax Class:	

Primary Structure Built	Above Grade Living Area	Finished Basement Area	Property Land Area	County Use
1972	205,000 SF		9.4300 AC	

Stories	Basement	Type	Exterior	Full/Half Bath	Garage	Last Major Renovation
		DISTRIBUTION WAREHOUSE				

Value Information				
	Base Value	Value	Phase-in Assessments	
		As of	As of	As of
		01/01/2017	07/01/2019	07/01/2020
Land:	2,053,800	2,053,800		
Improvements	9,784,400	9,784,400		
Total:	11,838,200	11,838,200	11,838,200	
Preferential Land:	0			

Transfer Information		
Seller: COLFIN 2017-8 INDUSTRIAL OWNER	Date: 11/21/2017	Price: \$0
Type: NON-ARMS LENGTH OTHER	Deed1: /17931/ 00481	Deed2:
Seller: THE REALTY ASSOCIATES FUND X, L.P.	Date: 07/24/2017	Price: \$15,700,000
Type: ARMS LENGTH IMPROVED	Deed1: /17706/ 00118	Deed2:
Seller:	Date: 01/10/2013	Price: \$13,700,000
Type: ARMS LENGTH IMPROVED	Deed1: /14587/ 00475	Deed2:

Exemption Information			
Partial Exempt Assessments:	Class	07/01/2019	07/01/2020
County:	000	0.00	
State:	000	0.00	
Municipal:	000	0.00	0.00

Tax Exempt:	Special Tax Recapture:
Exempt Class:	NONE

Homestead Application Information
Homestead Application Status: No Application

Homeowners' Tax Credit Application Status: No Application

Date:

1. This screen allows you to search the Real Property database and display property records.
2. Click **here** for a glossary of terms.
3. Deleted accounts can only be selected by Property Account Identifier.
4. The following pages are for information purpose only. The data is not to be used for legal reports or documents. While we have confidence in the accuracy of these records, the Department makes no warranties, expressed or implied, regarding the information.

Permit
4/5/83
9:30 AM
5/13/83
9:30 A.M.

APPLICATION

SEWAGE DISPOSAL TESTING

STATE OF MARYLAND - DEPARTMENT OF HEALTH AND MENTAL HYGIENE

A 32627

P _____

HOWARD COUNTY HEALTH DEPARTMENT
ENVIRONMENTAL HEALTH SERVICES

P. O. BOX 473 ELLICOTT CITY, MARYLAND 21043
TELEPHONE: 992-2330

DISTRICT 6

DATE 4/5/83

TO: THE COUNTY HEALTH OFFICER
ELLICOTT CITY, MARYLAND

I, HEREBY, APPLY FOR THE NECESSARY TEST IN ORDER TO CONSTRUCT (OR RECONSTRUCT) A SEWAGE DISPOSAL SYSTEM.

PROPERTY OWNER B.W.I.P. Inc.

ADDRESS 110 West Rd Towson, Md 21204 PHONE 296-6400

PROPERTY LOCATION:

SUBDIVISION Balto Wash Ind Pk LOT NO. B

ROAD AND DESCRIPTION North side of Patuxent Range Rd
650' West of Dorsey Run Rd

SIZE OF LOT 500' x 1110' TYPE BLDG. _____ (NUMBER OF BEDROOMS)

THE SYSTEM INSTALLED UNDER THIS APPLICATION IS ACCEPTABLE ONLY UNTIL PUBLIC FACILITIES BECOME AVAILABLE. I FULLY UNDERSTAND THE FEE CONNECTED WITH THE FILING OF THIS PERC TEST APPLICATION IS NON-REFUNDABLE UNDER ANY CIRCUMSTANCES. I ALSO AGREE TO COMPLY WITH ALL M.O.S.H.A. REQUIREMENTS IN TESTING THIS LOT.

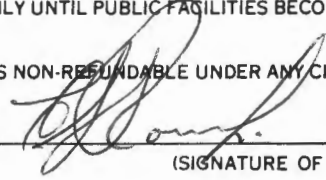

(SIGNATURE OF APPLICANT)

APPROVED BY _____ FOR _____ DATE _____

REJECTED BY _____ FOR _____ DATE _____

HOLD PENDING FURTHER TESTS _____ DATE _____

REASONS FOR REJECTION OR HOLDING 11 MAY 83 PERC OK HOLD FOR PERC
CERT PLAT R/H FS SAID PUMP OK TO OSD
FOR SEPTIC

THIS IS NOT A PERMIT

SOIL PROFILE

0'

Vertical rectangular box for soil profile drawing.

Large 5x5 grid for soil profile data.

INDICATE NORTH - NAME ADJOINING ROADWAY AS BASE LINE.

Table with columns: DATE, TEST NO., DEPTH, PRE-WET (START, STOP), TEST - 1" DROP (START, STOP), TIME.

REMARKS _____

TYPE OF SOIL _____

TESTED BY _____ ALSO PRESENT _____

EH 12 1079

APPLICATION

SEWAGE DISPOSAL TESTING

A 32627

STATE OF MARYLAND - DEPARTMENT OF HEALTH AND MENTAL HYGIENE

P _____

HOWARD COUNTY HEALTH DEPARTMENT
ENVIRONMENTAL HEALTH SERVICES

P. O. BOX 476 ELLICOTT CITY, MARYLAND 21043
TELEPHONE: 992-2330

DISTRICT 6th

DATE 4/5/83

TO: THE COUNTY HEALTH OFFICER
ELLICOTT CITY, MARYLAND

I, HEREBY, APPLY FOR THE NECESSARY TEST IN ORDER TO CONSTRUCT (OR RECONSTRUCT) A SEWAGE DISPOSAL SYSTEM.

PROPERTY OWNER BWIP

ADDRESS 110 West Road, Towson, Md PHONE 296-4408

PROPERTY LOCATION:

SUBDIVISION _____ LOT NO. B.

ROAD AND DESCRIPTION _____

SIZE OF LOT _____ TYPE BLDG. _____ (NUMBER OF BEDROOMS)

THE SYSTEM INSTALLED UNDER THIS APPLICATION IS ACCEPTABLE ONLY UNTIL PUBLIC FACILITIES BECOME AVAILABLE. I FULLY UNDERSTAND THE FEE CONNECTED WITH THE FILING OF THIS PERC TEST APPLICATION IS NON-REFUNDABLE UNDER ANY CIRCUMSTANCES. I ALSO AGREE TO COMPLY WITH ALL M.O.S.H.A. REQUIREMENTS IN TESTING THIS LOT. _____ (SIGNATURE OF APPLICANT)

APPROVED BY _____ FOR _____ DATE _____

REJECTED BY _____ FOR _____ DATE _____

HOLD PENDING FURTHER TESTS _____ DATE _____

REASONS FOR REJECTION OR HOLDING _____

THIS IS NOT A PERMIT

3

SOIL PROFILE

BED CLAY WITH STRAY

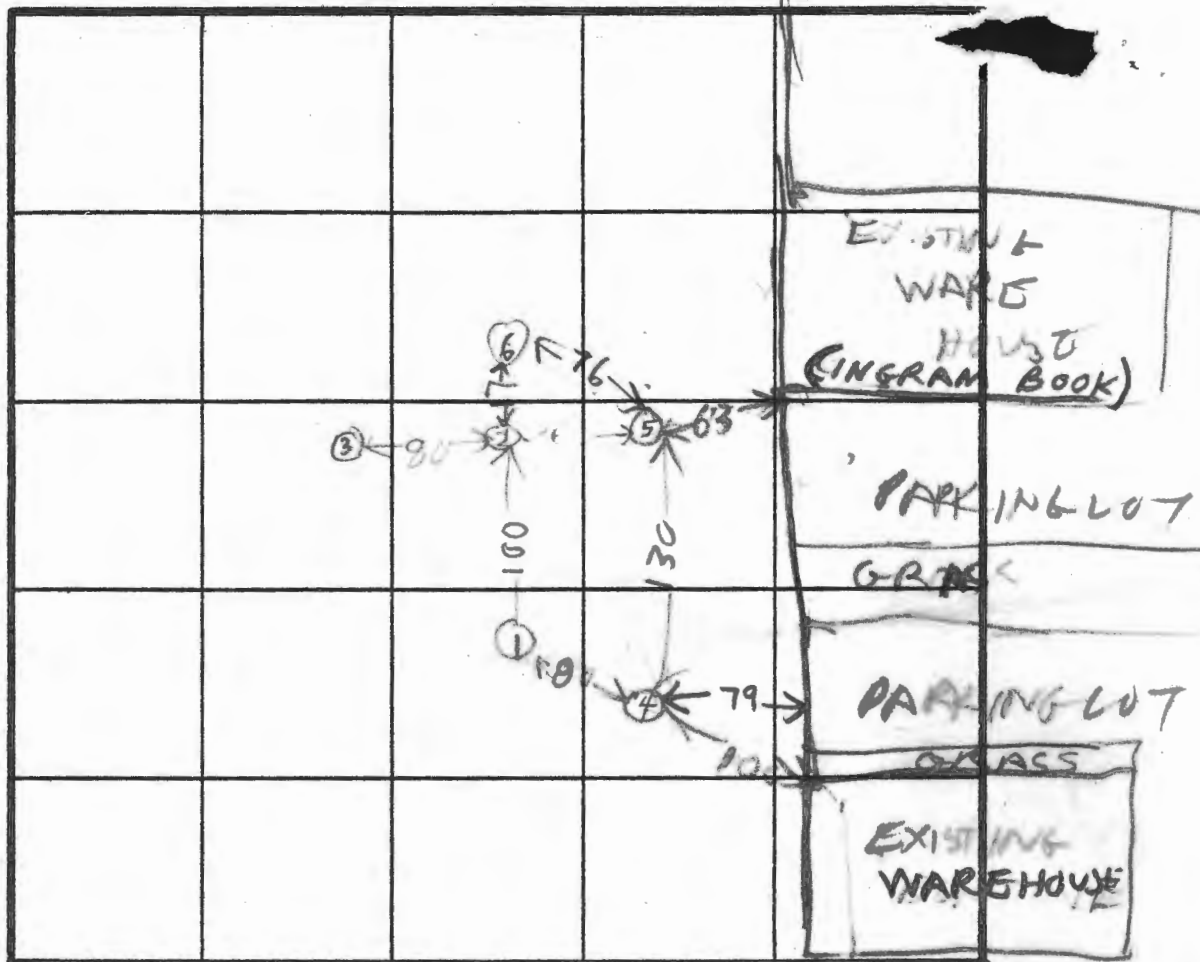

INDICATE NORTH - NAME ADJOINING ROADWAY AS BASE LINE.

4

CLAY SAND FILLER

BROWN CLAY SAND MIX

DATE	TEST NO.	DEPTH	PRE-WET		TEST - 1" DROP		TIME
			START	STOP	START	STOP	
5/11/83	1S	3	1019	1022	1022	1027	5
	1V	11	LOOKS	OK	ALL	SAND	
	2S	3	1033	1033 1/2	1033 1/2	1034	1/2
	2V	11	LOOKS	OK	ALL	SAND	
	3V	9					
	4S	4	1122	1123	1123	1125	2
12/1/83	4P	7 1/2	1201	1202	1202	1204	2
	4V	12	LOOKS	OK			
	5S	3	120	121	121	122	1
5/11/83	3V	11	LOOKS	OK	ALL	SAND	
	6V	11	ALL	SAND	LOOKS	OK	

HOLE ELEVATION
A
54 HIGH
126 LOW

REMARKS CITY WATER LOT ALMOST LEVEL

TYPE OF SOIL LOT NOT STAKED NEAR BY BUILDING USE

TESTED BY R. HODGES SIM, LEE RON DIGGERS
ALSO PRESENT BUD ROESNER SURVEYOR

EH-12-1079

APPLICATION

SEWAGE DISPOSAL TESTING

STATE OF MARYLAND - DEPARTMENT OF HEALTH AND MENTAL HYGIENE

A 32628
P _____

HOWARD COUNTY HEALTH DEPARTMENT
ENVIRONMENTAL HEALTH SERVICES

P. O. BOX 473 ELLICOTT CITY, MARYLAND 21043
TELEPHONE: 992-2330

DISTRICT 6
DATE 4/5/83

Prep:
4/13/83
9:50 AM
5/13/83
9:30 AM

TO: THE COUNTY HEALTH OFFICER
ELLICOTT CITY, MARYLAND

I, HEREBY, APPLY FOR THE NECESSARY TEST IN ORDER TO CONSTRUCT (OR RECONSTRUCT) A SEWAGE DISPOSAL SYSTEM.

PROPERTY OWNER B.L.P. Inc
ADDRESS 110 West Rd Towson, Md 21286 PHONE 296-6400

PROPERTY LOCATION:
SUBDIVISION Balto. Wash-Ind. Pl. LOT NO. 6
ROAD AND DESCRIPTION N.W. cor. of Patuxent Range Rd
+ Dowsy Run Rd
SIZE OF LOT 550' x 950' ± TYPE BLDG. 2 (NUMBER OF BEDROOMS)

THE SYSTEM INSTALLED UNDER THIS APPLICATION IS ACCEPTABLE ONLY UNTIL PUBLIC FACILITIES BECOME AVAILABLE. I FULLY UNDERSTAND THE FEE CONNECTED WITH THE FILING OF THIS PERC TEST APPLICATION IS NON-REFUNDABLE UNDER ANY CIRCUMSTANCES. I ALSO AGREE TO COMPLY WITH ALL M.O.S.H.A. REQUIREMENTS IN TESTING THIS LOT.

[Signature]
(SIGNATURE OF APPLICANT)

APPROVED BY _____ FOR _____ DATE _____
REJECTED BY _____ FOR _____ DATE _____
HOLD PENDING FURTHER TESTS _____ DATE _____

REASONS FOR REJECTION OR HOLDING 13 MAY 83 - DIB MORE SLOW PERC SOIL & WATER PH
H.S. SAID OK TO USE A PUMP FOR SEPTIC
SYSTEM

THIS IS NOT A PERMIT

APPLICATION

SEWAGE DISPOSAL TESTING

STATE OF MARYLAND - DEPARTMENT OF HEALTH AND MENTAL HYGIENE

HOWARD COUNTY HEALTH DEPARTMENT
ENVIRONMENTAL HEALTH SERVICES

P. O. BOX 476 ELLICOTT CITY, MARYLAND 21043
TELEPHONE: 992-2330

A 32628

P _____

DISTRICT 6

DATE 4/5/83

TO: THE COUNTY HEALTH OFFICER
ELLICOTT CITY, MARYLAND

I, HEREBY, APPLY FOR THE NECESSARY TEST IN ORDER TO CONSTRUCT (OR RECONSTRUCT) A SEWAGE DISPOSAL SYSTEM.

PROPERTY OWNER BWIP Inc

ADDRESS 110 West Rd, Towson, Md 21204 PHONE 296-4400

PROPERTY LOCATION:

SUBDIVISION _____ LOT NO. C

ROAD AND DESCRIPTION _____

SIZE OF LOT _____ TYPE BLDG. _____ (NUMBER OF BEDROOMS)

THE SYSTEM INSTALLED UNDER THIS APPLICATION IS ACCEPTABLE ONLY UNTIL PUBLIC FACILITIES BECOME AVAILABLE. I FULLY UNDERSTAND THE FEE CONNECTED WITH THE FILING OF THIS PERC TEST APPLICATION IS NON-REFUNDABLE UNDER ANY CIRCUMSTANCES. I ALSO AGREE TO COMPLY WITH ALL M.O.S.H.A. REQUIREMENTS IN TESTING THIS LOT. _____

(SIGNATURE OF APPLICANT)

APPROVED BY _____ FOR _____ DATE _____

REJECTED BY _____ FOR _____ DATE _____

HOLD PENDING FURTHER TESTS _____ DATE _____

REASONS FOR REJECTION OR HOLDING _____

THIS IS NOT A PERMIT

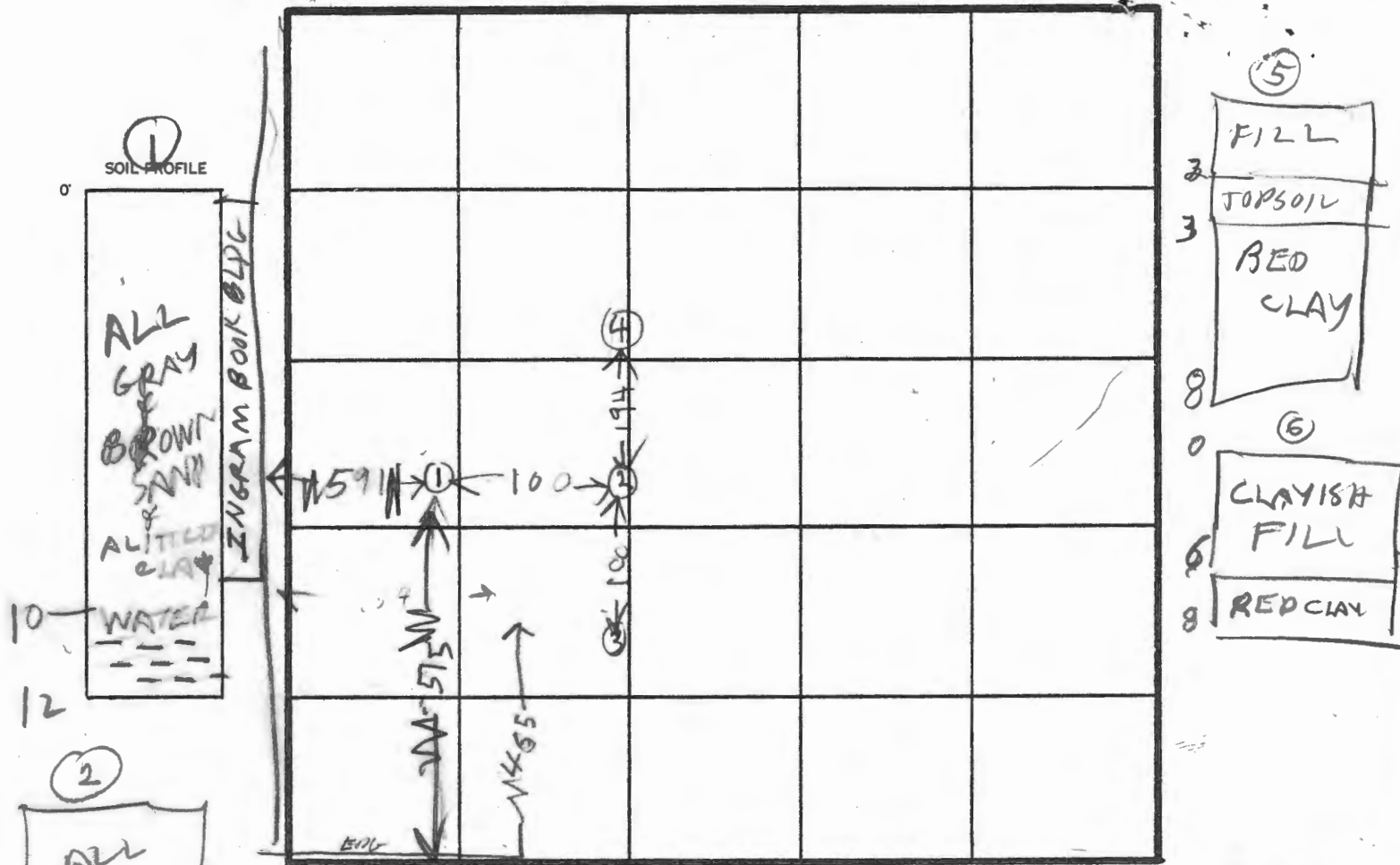

INDICATE NORTH - NAME ADJOINING ROADWAY AS BASE LINE.

RATUXENT RANGE RD

JODORSON RUN RD

DATE	TEST NO.	DEPTH	PRE-WET		TEST - 1" DROP		TIME
			START	STOP	START	STOP	
5/1/83	1S	3"	1006	1016	1016	1025	9
	1V	12"	WATER		1017		
	2S	2"	1022	1023	1023	1030	7
	2V	9"	WATER		8F7		
	3V	7 1/2"	WATER				
	4V	6"	LOOKS BAD				
	5V	8"	LOOKS BAD				
	6V	8"	LOOKS BAD				

REMARKS SEE PAGE 2 FOR HOLE 5 6 LOCATION

TYPE OF SOIL _____

TESTED BY R HODGES

ALSO PRESENT _____

EH-12-1078

Prel.
4/13/83 cancelled
9:30 AM
4/20/83
NO BACKFLOW

APPLICATION

5/11/83 5/13/83
9:30 A.M.

SEWAGE DISPOSAL TESTING

STATE OF MARYLAND - DEPARTMENT OF HEALTH AND MENTAL HYGIENE

A 32626

P _____

HOWARD COUNTY HEALTH DEPARTMENT
ENVIRONMENTAL HEALTH SERVICES
P. O. BOX 473 ELLICOTT CITY, MARYLAND 21043
TELEPHONE: 992-2330

DISTRICT 6

DATE 4/5/83

TO: THE COUNTY HEALTH OFFICER
ELLICOTT CITY, MARYLAND

I, HEREBY, APPLY FOR THE NECESSARY TEST IN ORDER TO CONSTRUCT (OR RECONSTRUCT) A SEWAGE DISPOSAL SYSTEM.

PROPERTY OWNER B.W. L.P. Inc

ADDRESS 110 West Rd Towson, Md. 21204 PHONE 296-6400

PROPERTY LOCATION:
SUBDIVISION Balto. Wash. Ind. Pl. LOT NO. A

ROAD AND DESCRIPTION S.W. cor. of Patuxent Range Rd
+ Dorsey Run Rd.

SIZE OF LOT 650' x 1500' ± TYPE BLDG. _____ (NUMBER OF BEDROOMS)

THE SYSTEM INSTALLED UNDER THIS APPLICATION IS ACCEPTABLE ONLY UNTIL PUBLIC FACILITIES BECOME AVAILABLE. I FULLY UNDERSTAND THE FEE CONNECTED WITH THE FILING OF THIS PERC TEST APPLICATION IS NON-REFUNDABLE UNDER ANY CIRCUMSTANCES. I ALSO AGREE TO COMPLY WITH ALL M.O.S.H.A. REQUIREMENTS IN TESTING THIS LOT.

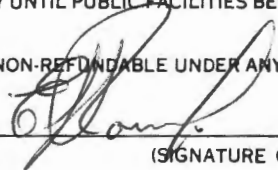

(SIGNATURE OF APPLICANT)

APPROVED BY _____ FOR _____ DATE _____

REJECTED BY _____ FOR _____ DATE _____

HOLD PENDING FURTHER TESTS _____ DATE _____

REASONS FOR REJECTION OR HOLDING 4/20/83 BACKHOE NO SHOW RH
5/11/83 DIG MORE SLOW PERC & WATER

THIS IS NOT A PERMIT

SOIL PROFILE

0'

INDICATE NORTH - NAME ADJOINING ROADWAY AS BASE LINE.

DATE	TEST NO.	DEPTH	PRE-WET		TEST - 1" DROP		TIME
			START	STOP	START	STOP	

REMARKS _____

TYPE OF SOIL _____

TESTED BY _____ ALSO PRESENT _____

EH 12 1079

APPLICATION

SEWAGE DISPOSAL TESTING

STATE OF MARYLAND - DEPARTMENT OF HEALTH AND MENTAL HYGIENE

HOWARD COUNTY HEALTH DEPARTMENT
ENVIRONMENTAL HEALTH SERVICES
P. O. BOX 476 ELLICOTT CITY, MARYLAND 21043
TELEPHONE: 992-2330

A 32626

P _____

DISTRICT 6

DATE 4/5/83

TO: THE COUNTY HEALTH OFFICER
ELLICOTT CITY, MARYLAND

I, HEREBY, APPLY FOR THE NECESSARY TEST IN ORDER TO CONSTRUCT (OR RECONSTRUCT) A SEWAGE DISPOSAL SYSTEM.

PROPERTY OWNER B W I P, Inc

ADDRESS 110 West Road, Towson, Md 21204 PHONE 296-6400

PROPERTY LOCATION:

SUBDIVISION _____ LOT NO. A

ROAD AND DESCRIPTION _____

SIZE OF LOT _____ TYPE BLDG. _____ (NUMBER OF BEDROOMS)

THE SYSTEM INSTALLED UNDER THIS APPLICATION IS ACCEPTABLE ONLY UNTIL PUBLIC FACILITIES BECOME AVAILABLE. I FULLY UNDERSTAND THE FEE CONNECTED WITH THE FILING OF THIS PERC TEST APPLICATION IS NON-REFUNDABLE UNDER ANY CIRCUMSTANCES. I ALSO AGREE TO COMPLY WITH ALL M.O.S.H.A. REQUIREMENTS IN TESTING THIS LOT. _____

(SIGNATURE OF APPLICANT)

APPROVED BY _____ FOR _____ DATE _____

REJECTED BY _____ FOR _____ DATE _____

HOLD PENDING FURTHER TESTS _____ DATE _____

REASONS FOR REJECTION OR HOLDING _____

THIS IS NOT A PERMIT

5

RED
GRAY
BROWN
CLAY

10 SAND
12 CLAY

SOIL PROFILE

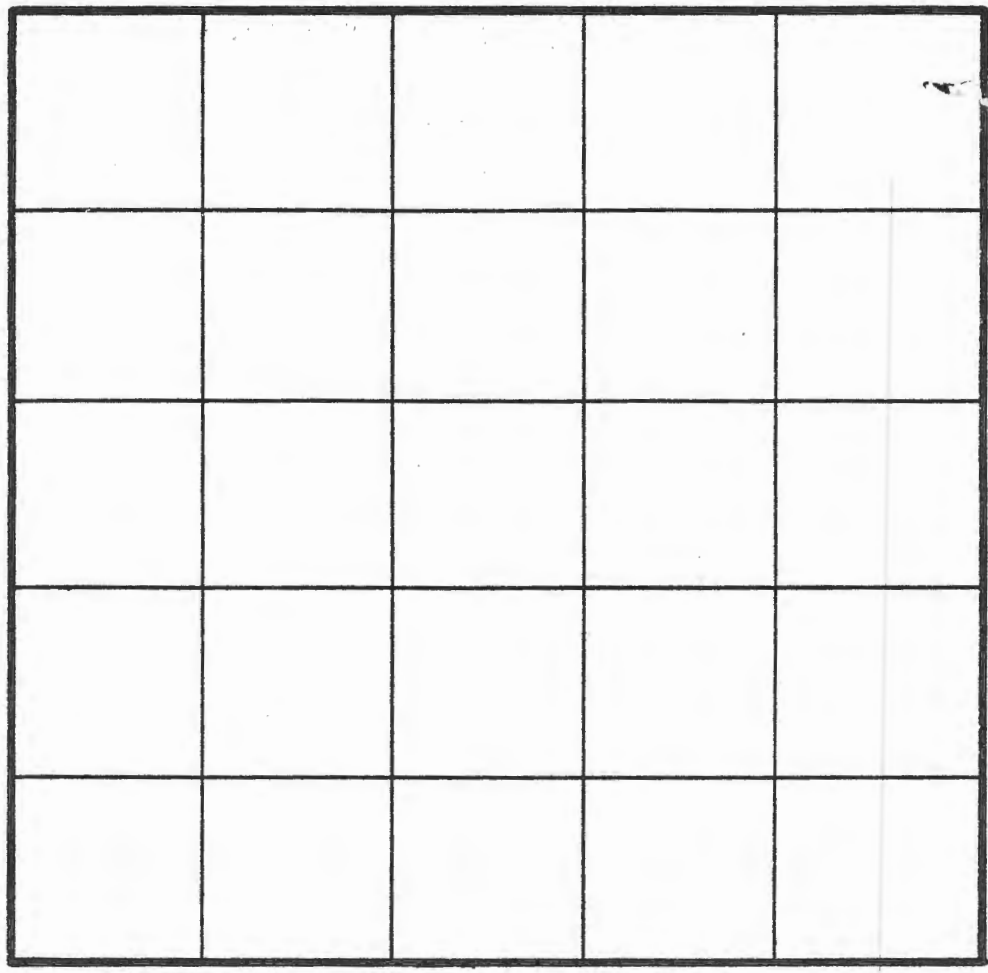
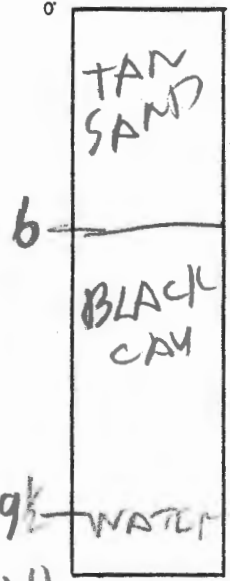

INDICATE NORTH - NAME ADJOINING ROADWAY AS BASE LINE.

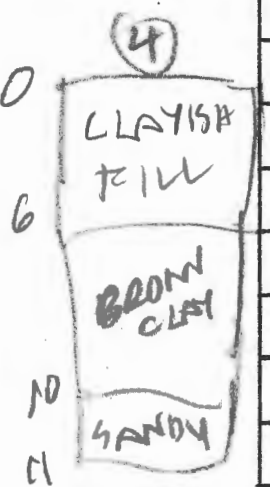

DATE	TEST NO.	DEPTH	PRE-WET		TEST - 1" DROP		TIME
			START	STOP	START	STOP	
5/11/83	1V	5	ALL	CLAY & FILL			
5/11/82	2V	10	LOOK	UNSATISFACTORY			
	3V	7 1/2	WATER	CLAY IS 4			UNSATISFACTORY
	4V	11	WATER	7F?			
	5V	12	LOOKS	UNSATISFACTORY			

EH-12-1079

5
REMARKS 5/10/83 SURVEY OR WILL LOCATE ABOVE 5 UNSATISFACTORY HOLES LATER

TYPE OF SOIL _____

TESTED BY Raymond Hodge ALSO PRESENT _____

BALTIMORE WASHINGTON INDUSTRIAL PARK SALES PLAT

THE ARUNDEL CORPORATION BALTIMORE, MD.

SCALE: 1" = 200'
 DATE: 5-15-77
 DRAWN: JHC
 TRACED: H &
 REV: 5/17/77
 CHECKED: DSK
 10/17/77
 APPROVED: DSK



NOTE:
 PARCELS SOLD OR OCCUPIED SHOWN THUS: [Hatched Box]
 PARCELS FOR FUTURE DEVELOPMENT SHOWN AREA ONLY - [Dotted Box]

246.633 AC ± TOTAL NET SALABLE AREA
 274.879 AC ± GROSS AREA OF TRACT

1-95

KEY MAP
 SCALE 1" = 2000'