

7/14/04

PH

PUB. SEWER STATUS VERIFIED BY _____

ISSUE DATE: 6/17/04

APPROVAL DATE: 7/14/04

PERMIT INDEXED

P 520426-1A
A 29310
UPGRADE

ON-SITE SEWAGE DISPOSAL SYSTEM HOWARD COUNTY HEALTH DEPARTMENT BUREAU OF ENVIRONMENTAL HEALTH

Sams Excavating 443-277-2912 IS PERMITTED TO INSTALL ALTER 05-387310

ADDRESS: PO Box 0157, Fulton, MD 20759 PHONE NUMBER: 301-498-0145

SUBDIVISION: Parsons Choice LOT NUMBER: 1

ADDRESS: 11950 Simpson Road PROPERTY OWNER: Kurt O'Neill

SEPTIC TANK CAPACITY (GALLONS): 1500

PUMP CHAMBER CAPACITY (GALLONS): -

NUMBER OF BEDROOMS: 5

SQUARE FEET PER BEDROOM: -

LINEAR FEET OF TRENCH REQUIRED: 180'

TRENCHES:	Trench to be <u>3</u> feet wide. Inlet <u>2</u> feet below original grade. Bottom maximum depth <u>5</u> feet below original grade. Effective area begins at <u>2</u> feet below original grade. <u>3</u> feet of stone below distribution pipe.
LOCATION:	
PURPOSE:	In support of B00148492. Call for inspection when ground is opened so sanitarian can recommend repair.

PLANS APPROVED: KJB DATE: 6/22/04

- NOTE: PERMIT VOID AFTER 2 YEARS
- NOTE: CONTRACTOR RESPONSIBLE FOR SCHEDULING A PRE-CONSTRUCTION INSPECTION FOR ALL INSTALLATIONS
- NOTE: WATERTIGHT SEPTIC TANKS REQUIRED
- NOTE: ALL PARTS OF SEPTIC SYSTEM SHALL BE 100 FEET FROM ANY WATER WELL
- NOTE: MANHOLE RISERS REQUIRED ON ALL SEPTIC TANKS AND PUMP CHAMBERS

NEITHER THE HOWARD COUNTY COUNCIL OR THE HEALTH DEPARTMENT IS RESPONSIBLE FOR THE SUCCESSFUL OPERATION OF ANY SYSTEM PERMITTEE RESPONSIBLE FOR OBTAINING FINAL APPROVAL ON THIS PERMIT CALL 410-313-2640 FOR INSPECTION OF SEPTIC SYSTEM

BUILDING PERMIT SIGNED AND RETURNED

TRAY B00148492 - CANBER

429310

NOT TO SCALE

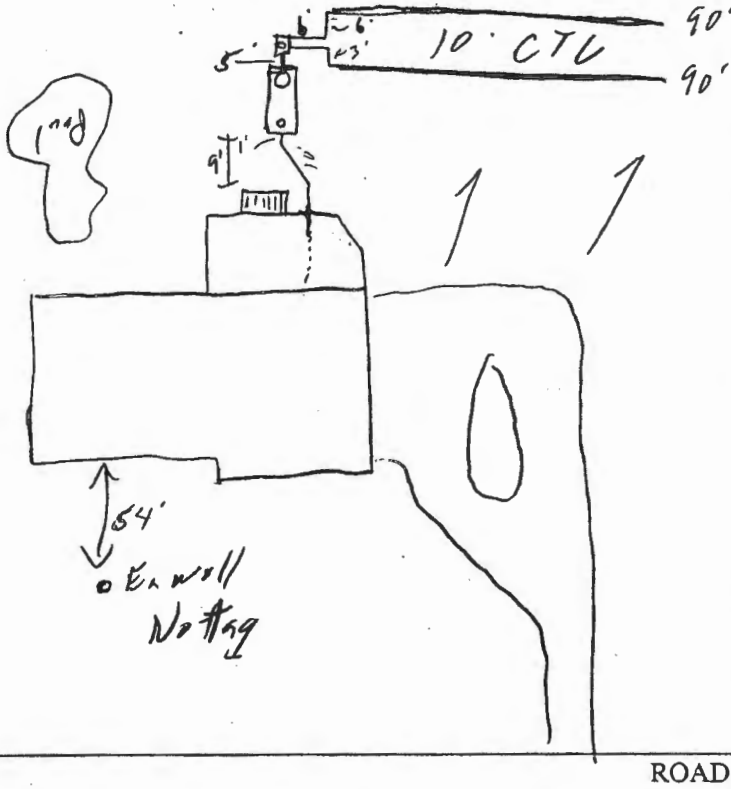

TRENCH/DRAINFIELD DATA		
WIDTH	INLET	BOTTOM
3'	2'	5'
NUMBER OF TRENCHES		2
TOTAL LENGTH		180
ABSORPTION AREA		540 sq
DISTRIBUTION BOX LEVEL		<input checked="" type="checkbox"/>
DISTRIBUTION BOX BAFFLE		<input checked="" type="checkbox"/>
DISTRIBUTION BOX PORT		<input checked="" type="checkbox"/>

SEPTIC TANK DATA	
SEPTIC TANK 1 LEVEL	<input checked="" type="checkbox"/>
CAPACITY	1500 GAL
SEAM LOC	Top
TANK LID DEPTH	1-2.5'
BAFFLES	<input checked="" type="checkbox"/>
BAFFLE FILTER	<input checked="" type="checkbox"/>
MANHOLE LOC	Back
6" PORT LOC	Front
WATERTIGHT TEST	<input checked="" type="checkbox"/>
SEPTIC TANK 2 LEVEL	<input type="checkbox"/>
CAPACITY	_____ GAL
SEAM LOC	_____
TANK LID DEPTH	_____
BAFFLES	_____
BAFFLE FILTER	_____
MANHOLE LOC	_____
6" PORT LOC	_____
WATERTIGHT TEST	_____

PRE-CONSTRUCTION See prev notes

INSTALLATION 7/14/64 - Complete system installed. OK to cover all work. Old ST. & D.W. Pumped, collapsed & filled in

FINAL INSPECTOR [Signature]

DATE OF APPROVAL 7/14/64

RECEIVED AND RETURNED