

Real Property Data Search (w1)

Search Result for HOWARD COUNTY

View Map		View GroundRent Redemption			View GroundRent Registration					
Tax Exempt:		Special Tax Recapture:								
Exempt Class:		NONE								
Account Identifier:		District - 02 Account Number - 232332								
Owner Information										
Owner Name:	HOWARD COUNTY MARYLAND FIRE STATION				Use:	EXEMPT COMMERCIAL NO				
Mailing Address:	6751 COLUMBIA GATEWAY DR ST400 COLUMBIA MD 21046-2164				Deed Reference:	/03544/ 00072				
Location & Structure Information										
Premises Address:		ROUTE 103 ROUTE 29 ELLCOTT CITY 21043-0000			Legal Description:	3.084 A PAR A-2 ROUTE 103 ROUTE 29 2ND DIST FIRE STATION				
Map:	Grid:	Parcel:	Sub District:	Subdivision:	Section:	Block:	Lot:	Assessment Year:	Plat No:	12360
0024	0023	0694		0000			A2	2018	Plat Ref:	
Special Tax Areas:					Town:	NONE				
					Ad Valorem:	102				
					Tax Class:					
Primary Structure Built	Above Grade Living Area		Finished Basement Area		Property Land Area		County Use			
1997	21,420 SF				3.0800 AC					
Stories	Basement	Type	Exterior	Full/Half Bath	Garage	Last Major Renovation				
		FIRE STATION								
Value Information										
		Base Value	Value		Phase-in Assessments					
			As of		As of		As of			
			01/01/2018		07/01/2019		07/01/2020			
Land:	806,000		1,209,000							
Improvements	1,499,600		3,999,600							
Total:	2,305,600		5,208,600		4,240,933		5,208,600			
Preferential Land:	0						0			
Transfer Information										
Seller: HOWARD COUNTY			Date: 08/17/1995			Price: \$200,000				
Type: NON-ARMS LENGTH OTHER			Deed1: /03544/ 00072			Deed2:				
Seller: SECURITY DEVELOPMENT CORPORATION			Date: 01/30/1991			Price: \$136,600				
Type: ARMS LENGTH IMPROVED			Deed1: /02777/ 00038			Deed2:				
Seller: MOUNT ETNA LTD PARTNERSHIP			Date: 01/05/1987			Price: \$94,000				
Type: ARMS LENGTH IMPROVED			Deed1: /01584/ 00337			Deed2:				
Exemption Information										
Partial Exempt Assessments:	Class		07/01/2019		07/01/2020					
County:	490		4,240,933.00		5,208,600.00					
State:	490		4,240,933.00		5,208,600.00					
Municipal:	490		0.00 0.00		0.00 0.00					
Tax Exempt:		Special Tax Recapture:								
Exempt Class:		NONE								

Homestead Application Information

Homestead Application Status: No Application

Homeowners' Tax Credit Application Information

Homeowners' Tax Credit Application Status: No Application **Date:**

1. This screen allows you to search the Real Property database and display property records.
2. Click **here** for a glossary of terms.
3. Deleted accounts can only be selected by Property Account Identifier.
4. The following pages are for information purpose only. The data is not to be used for legal reports or documents. While we have confidence in the accuracy of these records, the Department makes no warranties, expressed or implied, regarding the information.



10 results are available, use up and down arrow keys to navigate.

7/29/77
9:30 A.M.

APPLICATION

A 26494

P _____

SEWAGE DISPOSAL TESTING

STATE OF MARYLAND - DEPARTMENT OF HEALTH AND MENTAL HYGIENE

HOWARD COUNTY HEALTH DEPARTMENT
ENVIRONMENTAL HEALTH SERVICES
P. O. BOX 476, ELLICOTT CITY, MARYLAND 21043
TELEPHONE: 465-5000, EXT. 356

DISTRICT 2nd

DATE 7/26/77

TO: THE COUNTY HEALTH OFFICER
ELLICOTT CITY, MARYLAND

I, HEREBY, APPLY FOR THE NECESSARY TEST IN ORDER TO CONSTRUCT (OR RECONSTRUCT) A SEWAGE DISPOSAL SYSTEM.

PROPERTY OWNER Joseph Y. Binbinder

ADDRESS 6000 Baltimore National Pike PHONE _____

PROPERTY LOCATION:

SUBDIVISION _____ LOT NO. _____

ROAD AND DESCRIPTION Old Columbia Pkhw & Old Montgomery Road

SIZE OF LOT _____ TYPE BLDG. _____

NUMBER OF BEDROOMS _____

IF NOT SINGLE RESIDENCE DESCRIBE Movie Theatre Howard Cinema

THE SYSTEM INSTALLED UNDER THIS APPLICATION IS ACCEPTABLE ONLY UNTIL PUBLIC FACILITIES BECOME AVAILABLE.

SIGNATURE OF APPLICANT [Signature]

APPROVED BY _____ FOR _____ DATE _____

(KIND OF SYSTEM)

REJECTED BY Thomas S. Oyle FOR Any DATE 7/29/77

(KIND OF SYSTEM)

HOLD PENDING FURTHER TESTS _____ DATE _____

REASONS FOR REJECTION OR HOLDING High water table, impervious soil.

THIS IS NOT A PERMIT

hole #1 - clay-sand
 0-3 1/8 - sand
 3-8 - water
 8' water

hole #2
 0-6' clay
 6-11' clay-sand
 11-12' decaying rod
 & clay
 12-13' solid clay

hole #3
 0-8' moist,
 clay, sand,
 mica.
 8' water

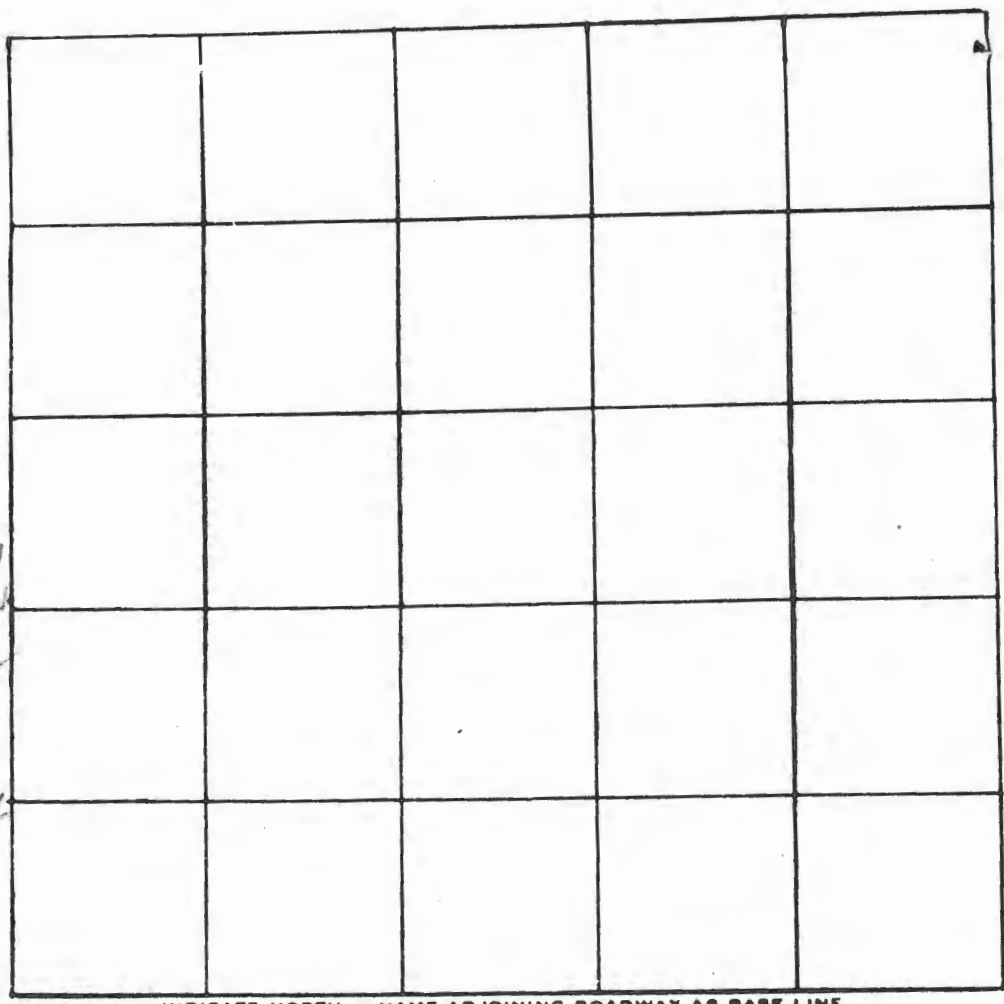

INDICATE NORTH. - NAME ADJOINING ROADWAY AS BASE LINE

DATE	TEST NO.	DEPTH	PRE-WET		TEST - 1" DROP		TIME
			START	STOP	START	STOP	
7/29/77	1	8 ft	water				
	2	13	solid clay - water @ 12'				
	3	8'	water				
	4	13'	35' from road				
	5	11'	35' from road - solid dark sand-clay				
			4 & 5 approx. 8' higher than 1, 2, & 3				

REMARKS High water table, impervious soil.

TYPE OF SOIL _____

TESTED BY Thomas S. Gile ALSO PRESENT: Mr. Donald Monaghan

APPROVED: FOR PUBLIC WATER AND PRIVATE SEWERAGE, STORM DRAINAGE SYSTEMS & ROADS, HOWARD COUNTY DEPARTMENT OF PUBLIC WORKS
 DIRECTOR
 DATE
 CHIEF, BUREAU OF HIGHWAYS
 DATE

APPROVED: HOWARD COUNTY OFFICE OF PLANNING AND ZONING
 PLANNING DIRECTOR
 DATE
 CHIEF, DIVISION OF LAND DEVELOPMENT & TRANSPORTATION
 DATE

APPROVED: FOR PUBLIC WATER AND PRIVATE SEWERAGE SYSTEMS, HOWARD COUNTY HEALTH DEPARTMENT
 COUNTY HEALTH OFFICER
 DATE

REVISIONS

NO.	BY	DATE	DESCRIPTION

PURDUM & JESCHKE
 CONSULTING ENGINEERS
 LAND SURVEYORS
 1023 North Chiswell Street
 Baltimore, Maryland 21202
 301/837-0198

OWNER & DEVELOPER
 JOSEPH Y. EINBINDER
 6000 BALTIMORE NATIONAL PIKE
 BALTIMORE, MARYLAND 21228

DESIGN
 DRAWN
 CHECKED
 SCALE
 DATE

CONVERT
 ZELINKA
 GARTER
 1" = 30'
 JULY 24, 1973
 CAT. G. (INCL. 1R)
 REG. NO. 8185

HOWARD CINEMAS
 2nd ELECTION DISTRICT HOWARD CO. MARYLAND
 TAX MAP NO. 24
 PARCEL 31
 SITE DEVELOPMENT PLAN

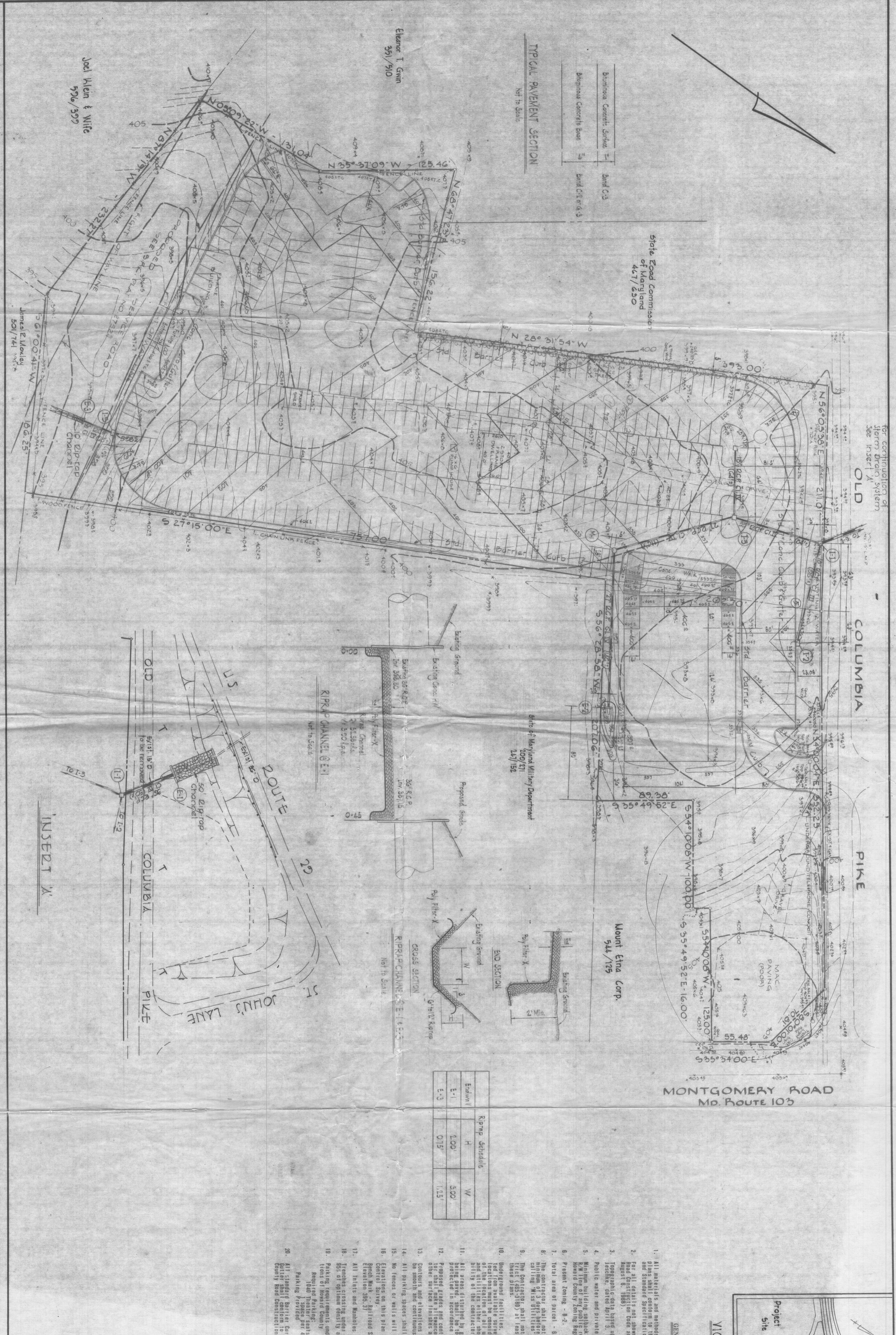

Elleanor T. Ginn
 351/510

Joel Klein & Wife
 596/399

State Road Commission
 of Maryland
 467/650

PURDUM & JESCHKE
 CONSULTING ENGINEERS
 LAND SURVEYORS
 1023 North Chiswell Street
 Baltimore, Maryland 21202
 301/837-0198

OWNER & DEVELOPER
 JOSEPH Y. EINBINDER
 6000 BALTIMORE NATIONAL PIKE
 BALTIMORE, MARYLAND 21228

DESIGN
 DRAWN
 CHECKED
 SCALE
 DATE

CONVERT
 ZELINKA
 GARTER
 1" = 30'
 JULY 24, 1973
 CAT. G. (INCL. 1R)
 REG. NO. 8185

HOWARD CINEMAS
 2nd ELECTION DISTRICT HOWARD CO. MARYLAND
 TAX MAP NO. 24
 PARCEL 31
 SITE DEVELOPMENT PLAN

