

4/30/81
1:30 P.M.
5/6/81 noon if possible
before

PERMIT

SEWAGE DISPOSAL SYSTEM

MARYLAND STATE DEPARTMENT OF HEALTH

HOWARD COUNTY

A Repair

ELLICOTT CITY

DISTRICT 2nd

DATE 4/29/81

TAXED 02-216736
INDEXED

MR. + SON

Mathena Septic Tank Service IS PERMITTED TO INSTALL ALTER X

ADDRESS 10302 Davis Avenue, Woodstock, Md. 21163 PHONE 328-2265

SUBDIVISION _____ ROAD 2625 N. Rogers Ave. LOT _____

PROPERTY OWNER Alva Hessler

ADDRESS 2625 N. Rogers Avenue, Ellicott City, Md. 21043

} PUBLIC WATER }
} TO BE USED }
ONLY

SPECIFICATIONS

SEPTIC TANK CAPACITY 1000 GALLONS - 3 Bedrooms

DRAIN FIELD _____ DEPTH _____ FEET, BOTTOM AREA _____ SQ. FT.

DEEP TRENCH _____ DEPTH _____ FEET, BOTTOM AREA _____ SQ. FT.

SEEPAGE PITS 15x15' ABSORBENT SIDE-WALL AREA 480 SQ. FT.

INLET PIPE 2'-3' FT. BELOW ORIGINAL GRADE. MAXIMUM DEPTH 10'-11" FT. BELOW ORIGINAL GRADE
EFFECTIVE DEPTH AT 2' FT. BELOW ORIGINAL GRADE.

LOCATE DISPOSAL AREA _____ FT. FROM _____ LOT LINE AND _____ FT. FROM _____ LOT LINE AS SEEN WHEN
FACING LOT FROM 50' TO REAR OF OLD WELL TO BE FILLED IN.

REPAIR - Call for an appointment when ground is opened up and Sanitarian will

recommend the repair system. 4/30/81 RECOMMEND FILL IN 5/6/81 FILLED IN OLD WATER
C.B.D.

WELL - USE PUBLIC WATER; 1 (15'x15') DRY WELL; SEE ABOVE;

C.B.D. FOR

PLANS APPROVED BY Palmer F. Wine DATE 4/29/81

COVER NO WORK UNTIL INSPECTED AND APPROVED.

NEITHER THE HOWARD COUNTY COUNCIL NOR THE HEALTH DEPARTMENT IS RESPONSIBLE FOR THE SUCCESSFUL OPERATION OF ANY SYSTEM.

NOTE: IF TRENCH IS USED CALL FOR INSPECTION BEFORE PLACING GRAVEL IN TRENCH.

NOTE: NO DRY WELL SHALL EXCEED 15 FOOT IN DIAMETER.

NOTE: ALL PIPE FROM HOUSE TO DISPOSAL AREA MUST BE CAST IRON.

PERMIT VOID AFTER THREE YEARS.

NOTE: INSTALL STAND PIPE ON SEPTIC TANK AND DRY WELL. STAND PIPES MUST BE 6 INCHES IN DIAMETER. CAST IRON, CONCRETE OR TERRA
COTTA ACCEPTED.

*INSTALLER IS RESPONSIBLE FOR OBTAINING FINAL APPROVAL ON THIS PERMIT.

31347

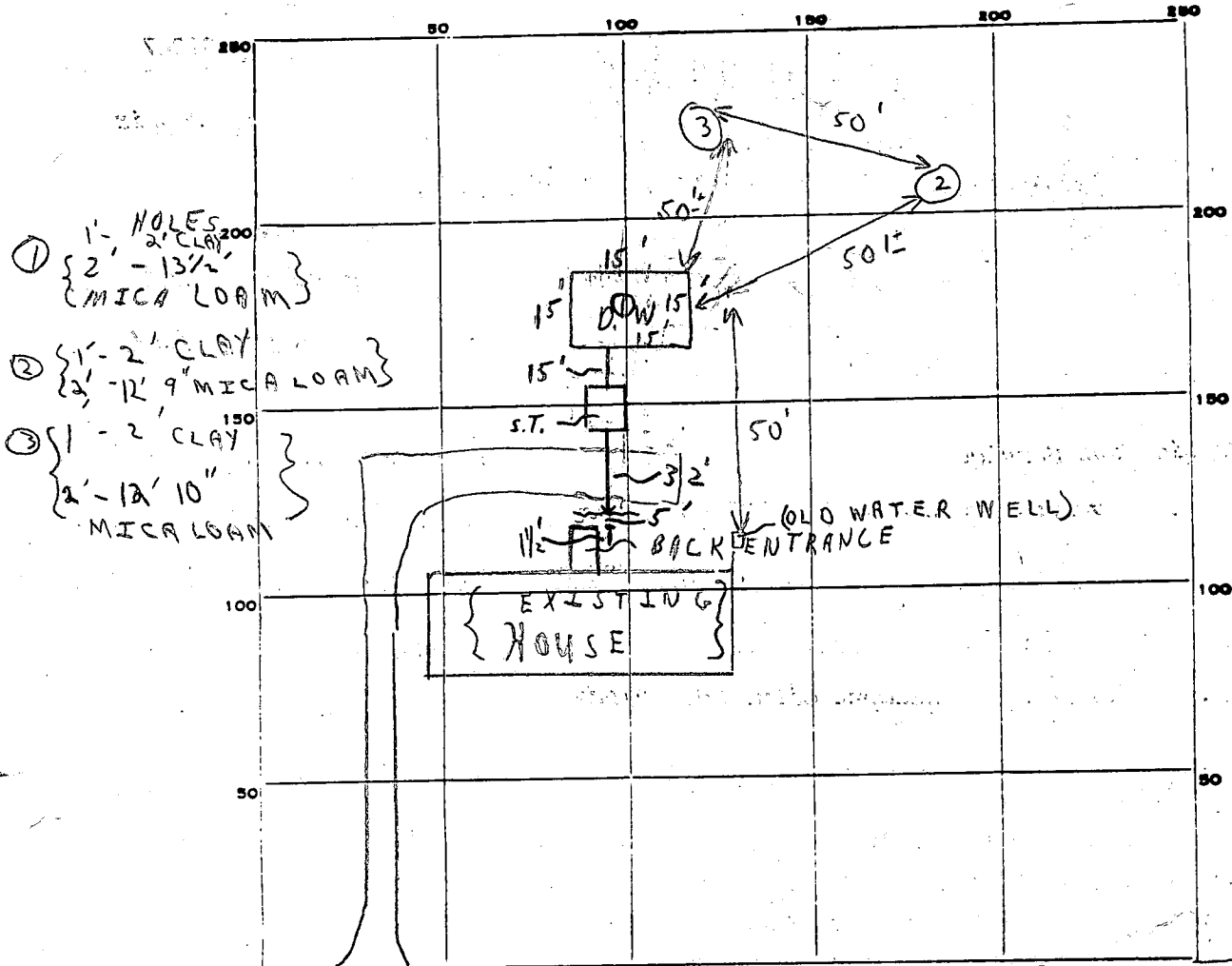

INDICATE NORTH. - NAME ADJOINING ROADWAY AS BASE LINE.

ROGERS AVENUE

RT. 70

PERMIT CARD

SEPTIC TANK, LEVEL S.T. D.W.

DISTRIBUTION BOX, LEVEL _____

TILE FIELD, DEPTH _____ FT. TRENCH WIDTH _____ FT.

GRAVEL DEPTH _____ IN. TOTAL LENGTH _____ FT.

NUMBER OF TRENCHES _____ TOTAL BOTTOM AREA _____

SEEPAGE PITS, INSIDE DIAMETER 60 FT. DEPTH BELOW INLET 8 FT.

ABSORBENT AREA 480 SQ. FT.

REMARKS 4/30/81 CHECKED-OK FOR DRYWELL IN #1 HOLE. 5/6/81 PARTIAL
NOT ALL STONE AROUND DRYWELL; COMPLETED WHILE SANITARIAN
PRESENT. C.B.S.

DATE SYSTEM APPROVED 5/6/81 INSPECTOR C.B. Streaker