

March 7, 2019

MEMORANDUM

To: Shauna Lu
Cathy Lowenkron
Water Quality Financing Administration
Maryland Department of the Environment

Kristin Mielcarek
Canaan Valley Institute

From: Jeff Williams
Program Supervisor, Well & Septic Program

Re: **BRF Proposal for connecting 4013 Font Hill Drive to public sewer**

The Howard County Health Department has identified a property in Howard County that meets the five requirements of HB 57 to receive BRF money for connecting an existing house to an existing public sewer line.

1. THE ENVIRONMENTAL IMPACT OF THE ONSITE SEWAGE DISPOSAL SYSTEM IS DOCUMENTED BY THE LOCAL GOVERNMENT AND CONFIRMED BY THE DEPARTMENT;

The existing on-site sewage disposal system serving the single family dwelling on the property is in a failing condition. Please see exhibit A containing a Health Department site evaluation form confirming the failing condition.

2. IT CAN BE DEMONSTRATED THAT:

A. THE REPLACEMENT OF THE ONSITE SEWAGE DISPOSAL SYSTEM WITH SERVICE TO AN EXISTING MUNICIPAL WASTEWATER FACILITY THAT IS ACHIEVING ENHANCED NUTRIENT REMOVAL LEVEL TREATMENT IS MORE COST-EFFECTIVE FOR NITROGEN REMOVAL THAN UPGRADING THE INDIVIDUAL ONSITE SEWAGE DISPOSAL SYSTEM; OR

B. THE INDIVIDUAL REPLACEMENT OF THE ONSITE SEWAGE DISPOSAL SYSTEM IS NOT FEASIBLE;

The Little Patuxent Wastewater Treatment Plant is currently constructed to meet to ENR standards. Therefore, it is more cost effective per pound of nitrogen removal than installing a BAT on an on-site sewage disposal system. The homeowner has received three (3) written quotes (exhibit B) from contractors to make the connection. The lowest quote is \$6850 from Fogle's

Maura J. Rossman, M.D., Health Officer

Septic Clean, Inc. **Please note that the highest bid from Sam's Creek includes the \$5100 connection fee in their bid while the other two do not. Subtracting \$5100 from the total bid still puts it higher than the other two bids. All three bids match each other in scope of work outside that discrepancy.** The homeowner has paid the Howard County connection cost of \$5100 (exhibit C). Additionally, connection to the public system is required by Howard County Code and installation of an on-site sewage disposal system would be inconsistent with the Howard County Master Plan for Water and Sewerage, and therefore, prohibited by COMAR 26.04.02.02.J.

3. THE PROJECT IS CONSISTENT WITH THE COUNTY'S COMPREHENSIVE PLAN AND WATER AND SEWER MASTER PLAN;

The Howard County Master Plan states that an individual sewerage system may not be installed on any parcel or lot where a public sewer system is adequate and available. The public sewer system is adequate and available to this property. Exhibit D is a Howard County GIS map illustrating the existing sewer line in red.

4. THE ONSITE SEWAGE DISPOSAL SYSTEM WAS INSTALLED AS OF OCTOBER 1, 2008, AND THE PROPERTY THE SYSTEM SERVES IS LOCATED IN A PRIORITY FUNDING AREA, IN ACCORDANCE WITH § 5-7B-02 OF THE STATE FINANCE AND PROCUREMENT ARTICLE; AND

The existing home was built before public sewer was available. Health Department records do not exist for the property. The State Department of Assessment and Taxation Real Property Form indicates the house was built in 1966 (exhibit E). 4013 Font Hill Dr is within the Priority Funding Area.

5. THE LOCAL GOVERNMENT HAS ADOPTED A POLICY OR PROCEDURE THAT WILL GUARANTEE THAT ANY FUTURE CONNECTION TO AN EXISTING MUNICIPAL WASTEWATER FACILITY THAT IS FUNDED UNDER PARAGRAPH (2)(I)1E OF THIS SUBSECTION WILL MEET ALL OF THE REQUIREMENTS UNDER THIS SUBPARAGRAPH.

The Howard County public sewer line has already been constructed. The connection will be for 4013 Font Hill Dr and no other homes will be connected to the sewer line house connection.

The Howard County Health Department does not like to maintain financial data of Howard County citizens, so I have requested that the owner provide their taxable income information directly to Canaan Valley Institute. Please feel free to contact me at (410) 313-1771 with any questions.

youngblood.carol@yahoo

Exhibit A

SITE INSPECTION SHEET

OWNER: Carol Ann Youngblood PHONE #: 410 465 6918

ADDRESS: 4013 Fort Hill Drive CONTRACTOR: N/A

WELL TAG #: _____

SUBDIVISION: _____ LOT: _____ COUNTY #: 13

PROPOSAL: Site Inspection for failing Drywell - Potential GRF

LOCATION DIAGRAM

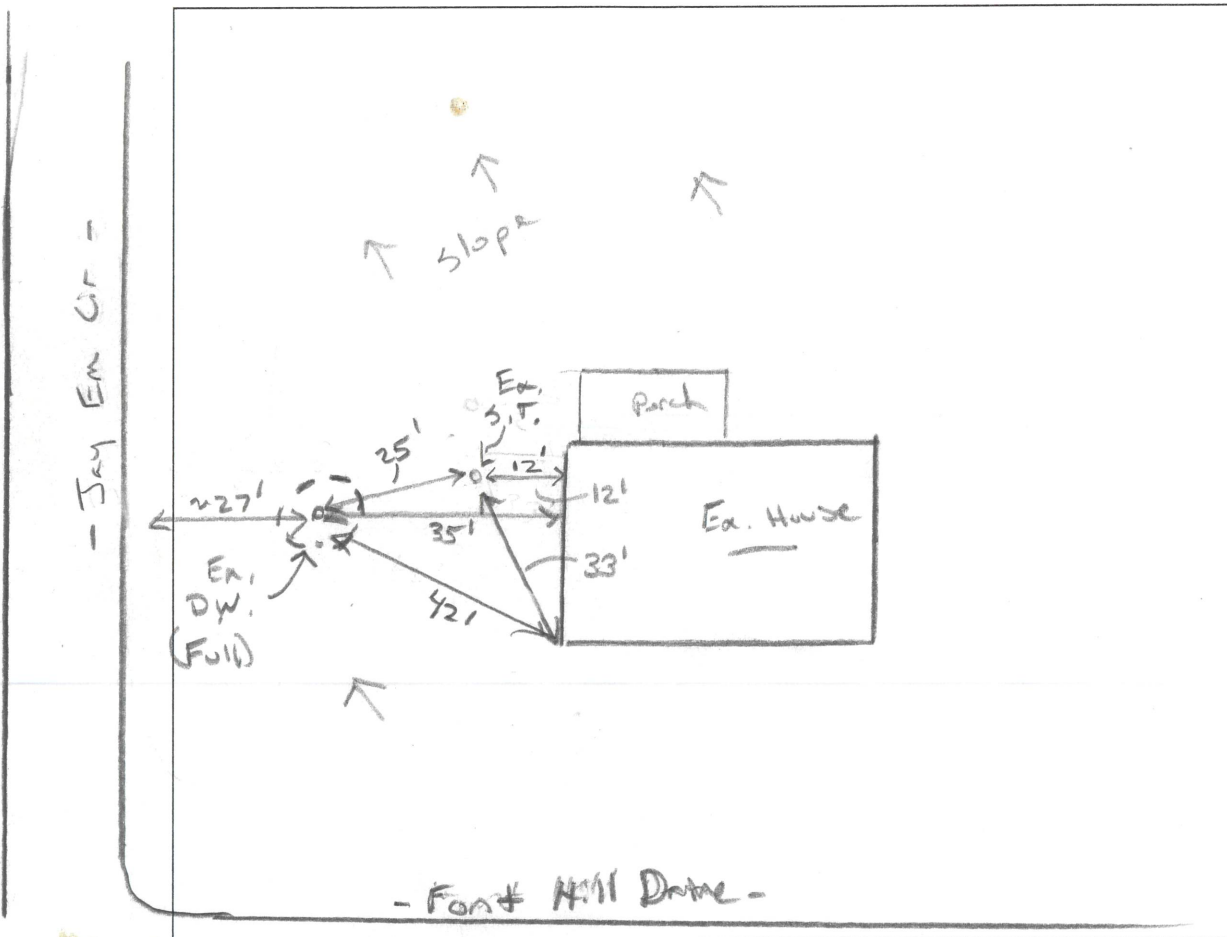

COMMENTS: Met owner onsite @ property, located ex. S.I.T and ex. Drywell. Drywell full up to c/o (sewerage). No signs of surface discharge.

DATE: 2/19/19 INSPECTOR: J. Wolf

Fogle's Septic Clean, Inc.
 580 Obrecht Road
 Sykesville, MD 21784
 Phone 410-795-5670



Propo

Proposal # 42397
 Proposal Date 2/28/2019

Proposal Submitted To		Job Location	
CAROL YOUNGBLOOD 4013 FONT HILL DR ELLCOTT CITY, MD 21042		CAROL YOUNGBLOOD 4013 FONT HILL DR ELLCOTT CITY, MD 21042	
Phone	410 465-6918	Total Cost:	\$6,850.00
E-mail	youngblood.carol@yahoo.com		

Description of work to be done

Permit
 Pump, crush and backfill existing septic system (tank & drywell)
 Install sewer line to county connection
 Backfill to a rough grade as soil and weather conditions permit
 Submit septic abandonment letter to Howard County
 A signature and deposit of \$2200 are required prior to starting work

*** Price DOES NOT include county connection fees ***
 Work described above is subject to Howard County Public Works approval

**Fogle's Septic is not responsible for ground settling after the work has been completed.
 Extra dirt and equipment for regrading at a later date can be done at an additional expense.**

Military Service Affidavit:

I, _____ am in the military service. Branch _____ ID# _____

I, _____ am not the military service. _____

_____ Date of Birth (mm/dd/yyyy) _____

Signature of Affidavit _____ Date (mm/dd/yyyy) _____

Exclusions: rock removal, cleaning, final grading, seed and straw, any damage to driveway or shrubbery due to the use of heavy equipment and trucks, extra dirt for/ damage to settling at a later date. Fogle's is not responsible for damage to private utility lines, we will call Ms. Utility to mark public utility lines but the homeowner is responsible to mark any private utility lines. We are not responsible for the working conditions of the septic system due to the design by the Health Department.

Payment to be made as follows:
 Payment is due within 30 days from the date of invoice. A finance charge of 1.5% per month (18% A.P.R.) to be applied on all balances over 30 days. If account is overdue & goes into collection, you will be responsible for collection fees, court costs and attorney fees 25%

All material is guaranteed to be as specified. All work to be completed in a workmanlike manner according to standard practices. Any alteration or deviation from above specifications involving extra costs will be executed only upon written order, and will become an extra charge over and above the estimate. All agreements are contingent upon strikes, accidents or delays beyond our control. Owner is to carry fire, tornado and other necessary insurance. Our workers are fully covered by Workman's Compensation Insurance.

Authorized Signature: *John Heatzman*

Notice: This proposal may be withdrawn if not accepted within 60 days

Customer signature and deposit are required prior to starting any work.

Acceptance of Proposal: The above prices, specifications and conditions are satisfactory and are hereby accepted. You are authorized to do the work as specified. Payment will be made as outlined above.

(SEAL)

Signature: _____

Signature: _____

Date of Acceptance: _____

If proposal accepted by Business or Corporation **Signature of Individual Responsible**

Hatfield's Equipment and Dedication Services, Inc.

P.O. Box 519 • Annapolis Junction, MD 20701-0519
Office: 301-490-4289 / 888-490-4289 • Fax: 301-490-5794

Carol Youngblood
4013 Font Hill Drive
Ellicott City, MD 21042

Septic to county sewer
Proposal # 9882

2/22/19

We propose to supply the labor, materials and equipment to complete the following:

- Apply for outside plumbing permit
- Pump, crush and fill the septic tank and drywell. Fill drywell under tree with stone.
- Install 4" schedule 40 PVC pipe from the existing inlet to the tank to the county tap.
- Cover pipe with stone
- Call for inspection
- Backfill and tamp soil back in place
- Fine grade, seed, fertilize and straw area disturbed
- Cost \$ 7,125.00

2/22/19

Exclusions: Export of fill, asphalt repair, concrete repair, sodding, tree replacement, root pruning, tree removal, any items not priced above.

All work to be billed as completed.

Customer agrees to pay Hatfield's Equipment And Dedication Services Inc. in full the amount due within 30 days.

A finance charge at the periodic rate of 2% per month which constitutes an annual percentage rate of 24%, will be applied to any balances not paid in 30 days

Customer agrees to pay 40% of amount due as attorney fees if placed in the hands of an attorney for collection.

Non-payment of any past due amount will be sufficient justification to stop work on the project.

Respectfully Submitted

Accepted by

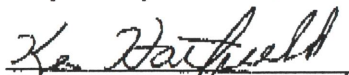
Ken Hatfield, president

Signature of Responsible Party

Print Name

Sams Creek

2810 Sams Creek Road
New Windsor, MD 21776
Ph # (443) 821-4932
Email: Sams.creek@aol.com

Contract For: Carol Youngblood

Job Site: 4013 Font Hill Drive; Howard County

Date: January 14, 2019

Project: Connect existing home to City Sewer & abandon existing septic system per county regulations

Sams Creek proposes to perform all labor and material necessary to complete the following for a total of \$14,370.00: ~~\$5100~~ = \$9270

Includes County fee of \$5,100 paid directly to county(Director of Finance); accompanied by attached sewer connection application

Utility Permit

Connect home to existing county sewer T at property line

All fittings and couples necessary

Install clean out by house & at T per code

Pump existing septic tank & drywell

Abandon existing septic tank & drywell; crush in, add gravel, & backfill

Produce Howard County Sanitarian with letter showing abandonment & hook up to city sewer

Backfill Disturbed septic area

Seed & Straw Disturbed septic area

OFFICE USE ONLY

CONTROL NO.: _____
 PERMIT NO.: _____
 INSPECTED BY: _____
 DATE INSPECTED: _____

SEWER CONNECTION APPLICATION HOWARD COUNTY

DEPARTMENT OF PUBLIC WORKS
 8430 COURT HOUSE DRIVE ELLICOTT CITY, MD 21043

Account No. N/A

OFFICE USE ONLY

APPLICATION NO.: _____
 CONTRACT NO.: 267
 REBATE CONTRACT NO.: _____
 SEWER ZONE: _____
 CONNECTION WORKSHEET Y ___ N X

FILL OUT APPLICATION COMPLETELY AND SIGN BELOW. IF LOCATION INFORMATION IS UNKNOWN, CONTACT THE OFFICE OF PLANNING AND ZONING (DPZ) FOR HOUSE NUMBER, STREET NAME, ETC. NOTE: COMMERCIAL AND INDUSTRIAL FACILITIES MAY BE SUBJECT TO REQUIREMENTS OF THE COUNTY CODE FOR SEWER SURCHARGES, INDUSTRIAL COST RECOVERY CHARGES, AND PRETREATMENT.

Application is herewith made for a water house connection to the property described below.

DATE OF APPLICATION _____

SUBDIVISION _____ SECTION _____ AREA TAX MAP 0024 LOT 6 BLOCK _____
 HOUSE NO. 4013 STREET Font Hill Dr GRID 0014 PARCEL 0991
 CITY, STATE Ellicott City ZIP CODE 21042 PHONE NO. _____
 NEW OR EXISTING BUILDING? Existing USE (SEE PROPERTY CLASSIFICATIONS ON REVERSE SIDE) _____

ITEM CHECK	CONNECTION TYPE	CON. DIA.	CHARGES DESCRIPTION	CHARGES AMOUNT	FUND	BA	G/L
<input checked="" type="checkbox"/>	SEWER CONNECTION	4"	INSTALLATION	\$ 4,500 ⁰⁰	7010008000	3100	431185
<input type="checkbox"/>	SEWER CONNECTION	6"	INSTALLATION		7010009000	3100	431185
<input type="checkbox"/>	SEWER CONNECTION	8"	INSTALLATION - ADO		7010003000	1300	102998
<input checked="" type="checkbox"/>			IN-AID-OF CONSTRUCTION AMOUNT CHARGED BASED ON METER SIZE	\$ 600 ⁰⁰	7030015100	3100	422000
<input type="checkbox"/>	ADO OR SURETY #		ADVANCED DEPOSIT ORDER OR SURETY DEPOSIT AMOUNT		7010003000	1300	102998
<input type="checkbox"/>			INSPECTION FEE AND PERMIT FEE		7010010000	3100	431105

*Refer to DPZ for estimates of Advanced Deposit (ADO). For installations requiring an ADO, the owner must enter into a cost agreement with Howard County prior to the commencement of any installation work.

\$5,100.00

TOTAL DUE

DATE _____
 CR # _____

THE INFORMATION REQUESTED BELOW MUST BE LEGIBLE FOR BILLING/REFUND PURPOSES.

COMPANY NAME _____
 COMPANY ADDRESS _____
 OWNER SIGNATURE _____
 OWNER NAME (PRINT) _____
 OWNER ADDRESS _____

FULL FEE MUST ACCOMPANY THIS COMPLETE APPLICATION, MAKE CHECKS PAYABLE TO: DIRECTOR OF FINANCE, HOWARD COUNTY CREDIT CARDS ARE NOT ACCEPTED.

THE TERMS & CONDITIONS OF THIS APPLICATION, INCLUDING ANYTHING ON THE REVERSE SIDE HEREOF ARE BINDING UPON THE OWNERS SIGNATURE & ALL SUCCEEDING OWNERS.

Exhibit D

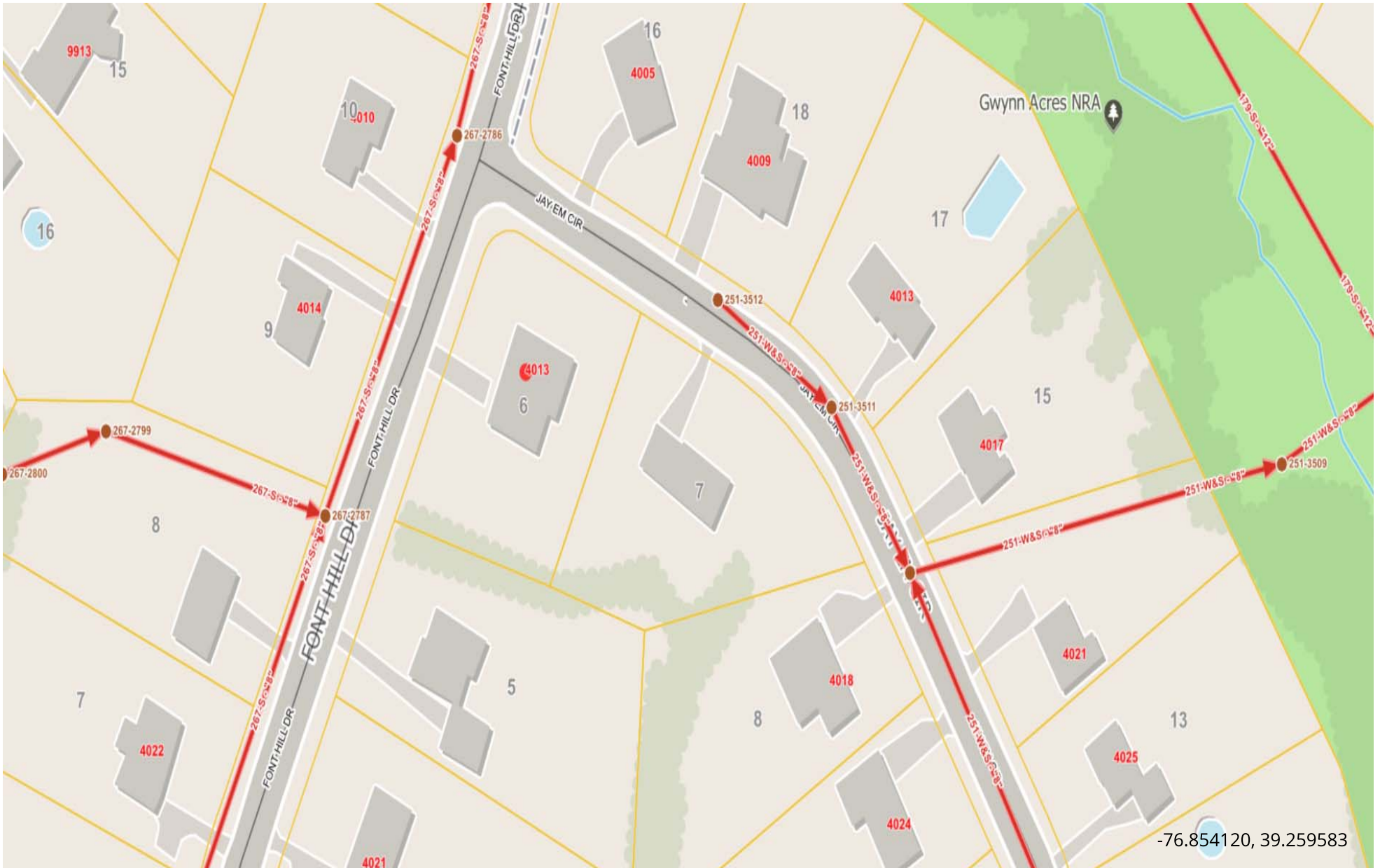



Real Property Data Search (w4)

Search Result for HOWARD COUNTY

View Map		View GroundRent Redemption			View GroundRent Registration				
Tax Exempt:		Special Tax Recapture:							
Exempt Class:		HOMEOWNERS TAX CREDIT							
Account Identifier:		District - 02 Account Number - 254239							
Owner Information									
Owner Name:		YOUNGBLOOD CAROL ANN			Use:		RESIDENTIAL		
Mailing Address:		4013 FONT HILL DR ELLCOTT CITY MD 21042-5638			Principal Residence:		YES		
					Deed Reference:		/00456/ 00186		
Location & Structure Information									
Premises Address:		4013 FONT HILL DR ELLCOTT CITY 21042-0000			Legal Description:		LOT 6 BL N S 8 4013 FONT HILL DR GWYNN ACRES		
Map:	Grid:	Parcel:	Sub District:	Subdivision:	Section:	Block:	Lot:	Assessment Year:	Plat No:
0024	0014	0991		7208			6	2019	Plat Ref:
Special Tax Areas:				Town:		NONE			
				Ad Valorem:		104			
				Tax Class:					
Primary Structure Built		Above Grade Living Area		Finished Basement Area		Property Land Area		County Use	
1966		2,226 SF		300 SF		25,613 SF			
Stories	Basement	Type	Exterior	Full/Half Bath	Garage	Last Major Renovation			
Split Foyer	YES	SPLIT FOYER	FRAME	1 full	1 Attached				
Value Information									
		Base Value		Value		Phase-in Assessments			
				As of		As of		As of	
				01/01/2019		07/01/2018		07/01/2019	
Land:		178,000		258,300					
Improvements		232,700		214,300					
Total:		410,700		472,600		410,700		431,333	
Preferential Land:		0						0	
Transfer Information									
Seller:		Date:			Price:				
Type:		Deed1:			Deed2:				
Seller:		Date:			Price:				
Type:		Deed1:			Deed2:				
Seller:		Date:			Price:				
Type:		Deed1:			Deed2:				
Exemption Information									
Partial Exempt Assessments:		Class		07/01/2018		07/01/2019			
County:		000		0.00					
State:		000		0.00					
Municipal:		000		0.00 0.00		0.00 0.00			
Tax Exempt:		Special Tax Recapture:							
Exempt Class:		HOMEOWNERS TAX CREDIT							
Homestead Application Information									
Homestead Application Status: Approved 02/07/2012									
Homeowners' Tax Credit Application Information									