

RCB 7/25/2019

Search Result for HOWARD COUNTY

View Map		View GroundRent Redemption				View GroundRent Registration			
Tax Exempt:		Special Tax Recapture:							
Exempt Class:		NONE							
Account Identifier:		District - 03 Account Number - 288005							
Owner Information									
Owner Name:		IRELAND CARROLL F HERZOG WILLIAM R JR TR				Use:		RESIDENTIAL	
Mailing Address:		11671 FREDERICK ROAD ELLCOTT CITY MD 21042				Principal Residence:		NO	
						Deed Reference:		/10092/ 00218	
Location & Structure Information									
Premises Address:		S ROUTE 144 ELLCOTT CITY 21042-0000				Legal Description:		1.9156 ACRES ROUTE 144	
Map:	Grid:	Parcel:	Sub District:	Subdivision:	Section:	Block:	Lot:	Assessment Year:	Plat No:
0016	0014	0131		2002				2019	Plat Ref:
Special Tax Areas:						Town:		NONE	
						Ad Valorem:		100	
						Tax Class:			
Primary Structure Built		Above Grade Living Area		Finished Basement Area		Property Land Area		County Use	
						1.9100 AC			
Stories	Basement	Type	Exterior	Full/Half Bath	Garage	Last Major Renovation			
Value Information									
		Base Value		Value		Phase-in Assessments			
				As of		As of		As of	
				01/01/2019		07/01/2018		07/01/2019	
Land:		165,300		224,100					
Improvements		0		0					
Total:		165,300		224,100		165,300		184,900	
Preferential Land:		0						0	
Transfer Information									
Seller: IRELAND CARROLL F AND WF				Date: 06/27/2006			Price: \$0		
Type: NON-ARMS LENGTH OTHER				Deed1: /10092/ 00218			Deed2:		
Seller:				Date:			Price:		
Type:				Deed1:			Deed2:		
Seller:				Date:			Price:		
Type:				Deed1:			Deed2:		
Exemption Information									
Partial Exempt Assessments:		Class		07/01/2018		07/01/2019			
County:		000		0.00					
State:		000		0.00					
Municipal:		000		0.00 0.00		0.00 0.00			
Tax Exempt:		Special Tax Recapture:							
Exempt Class:		NONE							
Homestead Application Information									
Homestead Application Status: No Application									
Homeowners' Tax Credit Application Information									
Homeowners' Tax Credit Application Status: No Application						Date:			

1. This screen allows you to search the Real Property database and display property records.
2. Click **here** for a glossary of terms.
3. Deleted accounts can only be selected by Property Account Identifier.
4. The following pages are for information purpose only. The data is not to be used for legal reports or documents. While we have confidence in the accuracy of these records, the Department makes no warranties, expressed or implied, regarding the information.

APPLICATION

A 09821

SEWAGE DISPOSAL TESTING

P _____

MARYLAND STATE DEPARTMENT OF HEALTH

HOWARD COUNTY

ELLICOTT CITY

DISTRICT 3

DATE 3/26/65

Septic Tank - 1000 gal.

Two Dry Wells - each Dry Well must be 12 diameter concrete top with 1 ft of gravel around block - giving total diameter of 14 ft. Depth of each dry well to be 9 ft below ~~ground~~ inlet pipes must be 3 ft below grade. Dry Wells

Place each Dry Well about 21 ft from edge of Triadelphia Road with one Dry Well about 125 ft from right ~~side~~ sideline and second Dry Well about 175 ft from right sideline. Right sideline determined as ~~you~~ face lot from Triadelphia Rd. Dry Wells must be 4 ft apart edge to edge.

TO: THE COUNTY HEALTH OFFICER
ELLICOTT CITY, MARYLAND

I, HEREBY, APPLY FOR THE NECESSARY TESTS IN ORDER TO CONSTRUCT (OR RECONSTRUCT) A SEWAGE DISPOSAL SYSTEM.

PROPERTY OWNER Mrs. Victor M. Phillips

ADDRESS 805 South Lakewood Drive, Baltimore 24, Md. PHONE OR 5-1195

PROPERTY LOCATION:

SUBDIVISION _____ LOT NO. _____

ROAD AND DESCRIPTION Rt. 144 & Triadelphia Rd. - ~~first~~ across from Gearhart's Store

OCCUPANT _____ PHONE _____

PERSON TO CONSTRUCT SYSTEM _____

ADDRESS _____ PHONE _____

SIZE OF LOT 2 acres TYPE BLDG. 4 NUMBER OF BEDROOMS

IF NOT SINGLE RESIDENCE DESCRIBE _____

SIGNATURE OF APPLICANT *Calvin Smith*

APPROVED BY *W. W. Minaghan* FOR *W. W. Minaghan (2)* DATE 3/30/65
(KIND OF SYSTEM)

REJECTED BY _____ FOR _____ DATE _____
(KIND OF SYSTEM)

HOLD PENDING FURTHER TESTS _____ DATE _____

REASONS FOR REJECTION OR HOLDING _____

THIS IS NOT A PERMIT

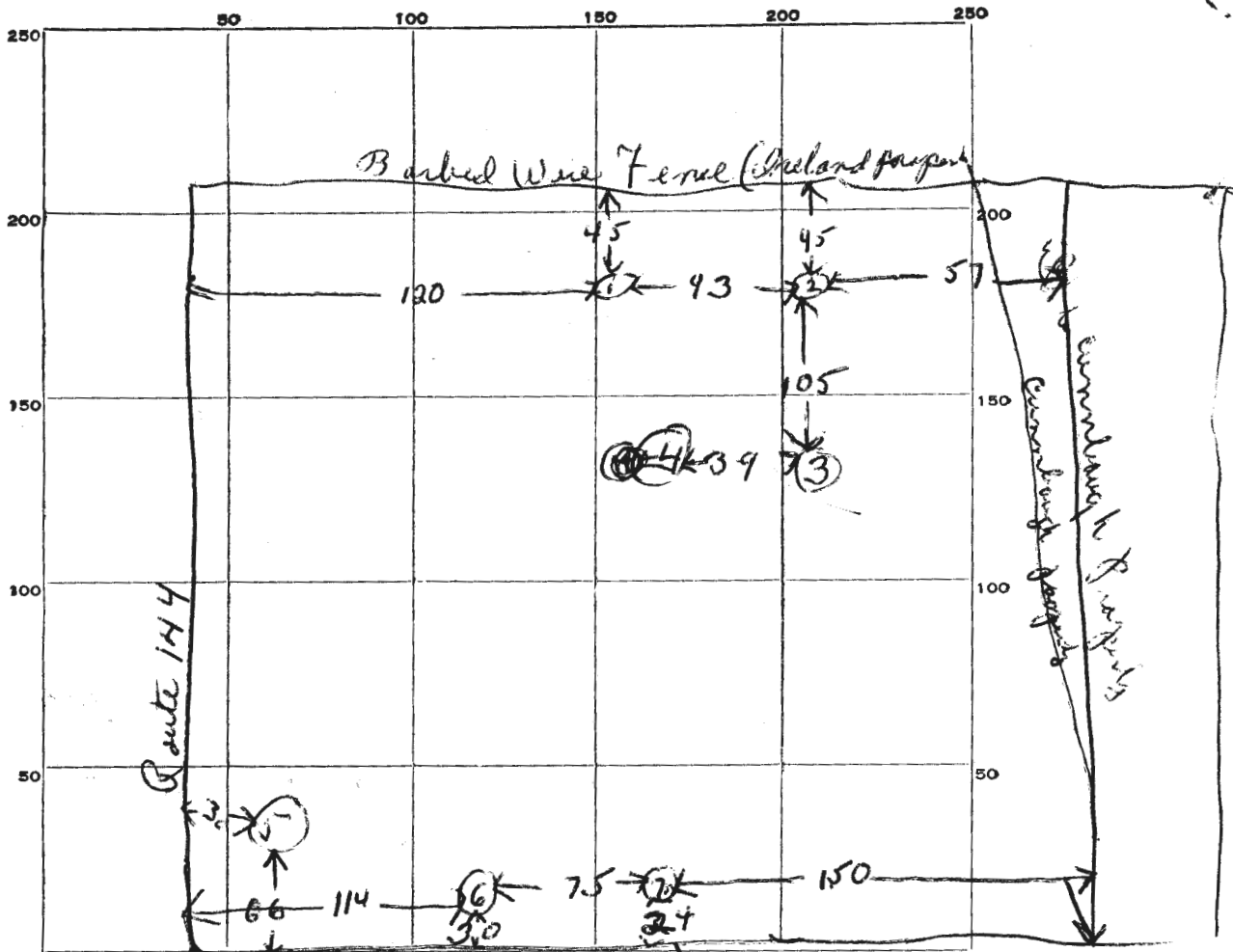

Sign 2T144
Triadelphia
INDICATE NORTH - NAME ADJOINING ROADWAY AS BASE LINE.
Triadelphia
C-1036 6th #2

DATE	TEST NO.	DEPTH	PRE-WET		TEST - 1" DROP		TIME
			START	STOP	START	STOP	
3/30/65	1	first 4ft clay then	rocky	-	solid rock	at 8 ft	
	2.	first 5 to 6 ft clay	then	rock	-	machine could not dig (trapped) surface	
	3	first 6 ft soil and clay	then	hard rock	at 8 ft	(water comes in at 3 ft)	
	4.	first 4 ft clay - some	rock	-	then	hard rock	
		comes in at 8 ft at bottom					
	5	some loose	rock	-	then	solid rock	at 5 ft
	6	12 ft	2:51	2:57	2:57	3:05	8 min
	7	12 ft	3:12	3:14	3:14	3:18	4 min
	8	5-9 ft	3:16	3:28	3:28	3:55	27 min

hole # 6 - first 6 ft is clay - then sand.

SOIL AUGER FINDING

TESTED BY Dum 3/30/65

REMARKS

ALSO PRESENT

LOT NO.