

Real Property Data Search

Search Result for HOWARD COUNTY

View Map		View GroundRent Redemption		View GroundRent Registration	
Tax Exempt:		Special Tax Recapture:			
Exempt Class:		NONE			
Account Identifier:		District - 06 Account Number - 396453			
Owner Information					
Owner Name:	HOWARD COUNTY HOUSING COMMISSION		Use:	EXEMPT	
Mailing Address:	6751 COLUMBIA GATEWAY DR COLUMBIA MD 21046-2164		Principal Residence:	NO	
			Deed Reference:	/06287/ 00277	
Location & Structure Information					
Premises Address:		ROUTE 32 JESSUP 20794-0000		Legal Description:	2 LOTS 8 9 3.5834 A. ROUTE 32 NORDAU SUBDV SEC E-4
Map:	Grid:	Parcel:	Sub District:	Subdivision:	Section:
0042	0024	0136		0000	
					Block:
					8 9
					Lot:
					2017
					Assessment Year:
					21417
					Plat No:
					Plat Ref:
Special Tax Areas:		Town:		NONE	
		Ad Valorem:		102	
		Tax Class:			
Primary Structure Built	Above Grade Living Area	Finished Basement Area	Property Land Area	County Use	
			3.5834 AC		
Stories	Basement	Type	Exterior	Full/Half Bath	Garage
					Last Major Renovation
Value Information					
		Base Value	Value	Phase-in Assessments	
			As of	As of	As of
			01/01/2017	07/01/2018	07/01/2019
Land:		162,200	162,200		
Improvements		0	0		
Total:		162,200	162,200	162,200	162,200
Preferential Land:		0			0
Transfer Information					
Seller: CHURCH ROAD CORP		Date: 07/17/2002		Price: \$625,000	
Type: NON-ARMS LENGTH OTHER		Deed1: /06287/ 00277		Deed2:	
Seller:		Date:		Price:	
Type:		Deed1:		Deed2:	
Seller:		Date:		Price:	
Type:		Deed1:		Deed2:	
Exemption Information					
Partial Exempt Assessments:	Class		07/01/2018	07/01/2019	
County:	510		162,200.00	162,200.00	
State:	510		162,200.00	162,200.00	
Municipal:	510		0.00 0.00	0.00 0.00	
Tax Exempt:		Special Tax Recapture:			
Exempt Class:		NONE			
Homestead Application Information					
Homestead Application Status: No Application					
Homeowners' Tax Credit Application Information					

9/17/99

KIM - (NO. 0000)

FOR MY EXPEDIENCE
OF YOUR "ENRICHMENT"

I'D LIKE YOU TO

PROGRAM THIS TEST

APPLICATION RESPONSE.
ITS COMPLEX.

CONSULT WITH ME

AT WHATEVER POINT

YOU'D LIKE . . .

THX

(CW)

Pub. Service
NOT
available

APPLICATION

PERCOLATION TESTING

RW FEE
SUBMITTED
AT THIS MEETING

TAX MAP
SHOWS 3 PARCELS

SOILS OVERLAY SHOWS
C1, B1 SOILS WITH

STAGN RUNDING
ON THE LOT BETWEEN
2 OF THESE LOTS

PUBLIC SEWER ELIGIBLE,
9/17/99 (CW)

HOWARD COUNTY HEALTH DEPARTMENT
BUREAU OF ENVIRONMENTAL HEALTH
3525-H ELLICOTT MILLS DRIVE/ELLICOTT CITY, MARYLAND 21043
TELEPHONE: 313-2640

A _____

P _____

DISTRICT _____

DATE _____

TO: THE COUNTY HEALTH OFFICER
ELLICOTT CITY, MARYLAND

I HEREBY APPLY FOR THE NECESSARY TEST PRIOR TO APPLICATION FOR PERMIT TO CONSTRUCT (OR RECONSTRUCT) A SEWAGE DISPOSAL SYSTEM.

PROPERTY OWNER William Bishop

ADDRESS 2997 Normandy Dr EC 21043 PHONE 410-465-4808

AGENT OR PROSPECTIVE BUYER _____

ADDRESS _____ PHONE _____

PROPERTY LOCATION:

SUBDIVISION Nordau section E-4 LOT NO. 3, 4, 5, 8, 9

ROAD AND DESCRIPTION Jones Rd (Guilford Area)

TAX MAP 42 PARCEL # 136, 138, 139

SIZE OF LOT _____ TYPE BLDG. _____
(SINGLE FAMILY DWELLING OR COMMERCIAL)

THE SYSTEM INSTALLED UNDER THIS APPLICATION IS ACCEPTABLE ONLY UNTIL PUBLIC FACILITIES BECOME AVAILABLE. I FULLY UNDERSTAND THE FEE CONNECTED WITH THE FILING OF THIS PERC TEST APPLICATION IS NON-REFUNDABLE UNDER ANY CIRCUMSTANCES. I ALSO AGREE TO COMPLY WITH ALL M.O.S.H.A. REQUIREMENTS IN TESTING THIS LOT.

William Bishop
(SIGNATURE OF APPLICANT)

APPROVED BY _____ FOR _____ DATE _____

DISAPPROVED BY _____ FOR _____ DATE _____

HOLD PENDING FURTHER TESTS _____

REASONS FOR REJECTION OR HOLDING _____

PERCOLATION TEST PLAT/PRELIMINARY PLAT - TITLE OR I.D. # _____ DATE _____

SITE DEVELOPMENT PLAN/FINAL PLAT - TITLE OR I.D. # _____ DATE _____

THIS IS NOT A PERMIT

COUNTY # _____

SOIL PROFILE

0'

SOIL PROFILE

0'

INDICATE NORTH - NAME ADJOINING ROADWAY AS BASE LINE.

DATE	TEST NO.	DEPTH	PRE-WET		TEST - 1" DROP		TIME
			START	STOP	START	STOP	

REMARKS _____

TYPE OF SOIL _____

TESTED BY _____ ALSO PRESENT _____

TRENCH DESIGN DATA: AVERAGE PERCOLATION TIME _____ TRENCH WIDTH _____

INLET DEPTH _____ MAXIMUM BOTTOM DEPTH _____ SQ. FT./BEDROOM _____

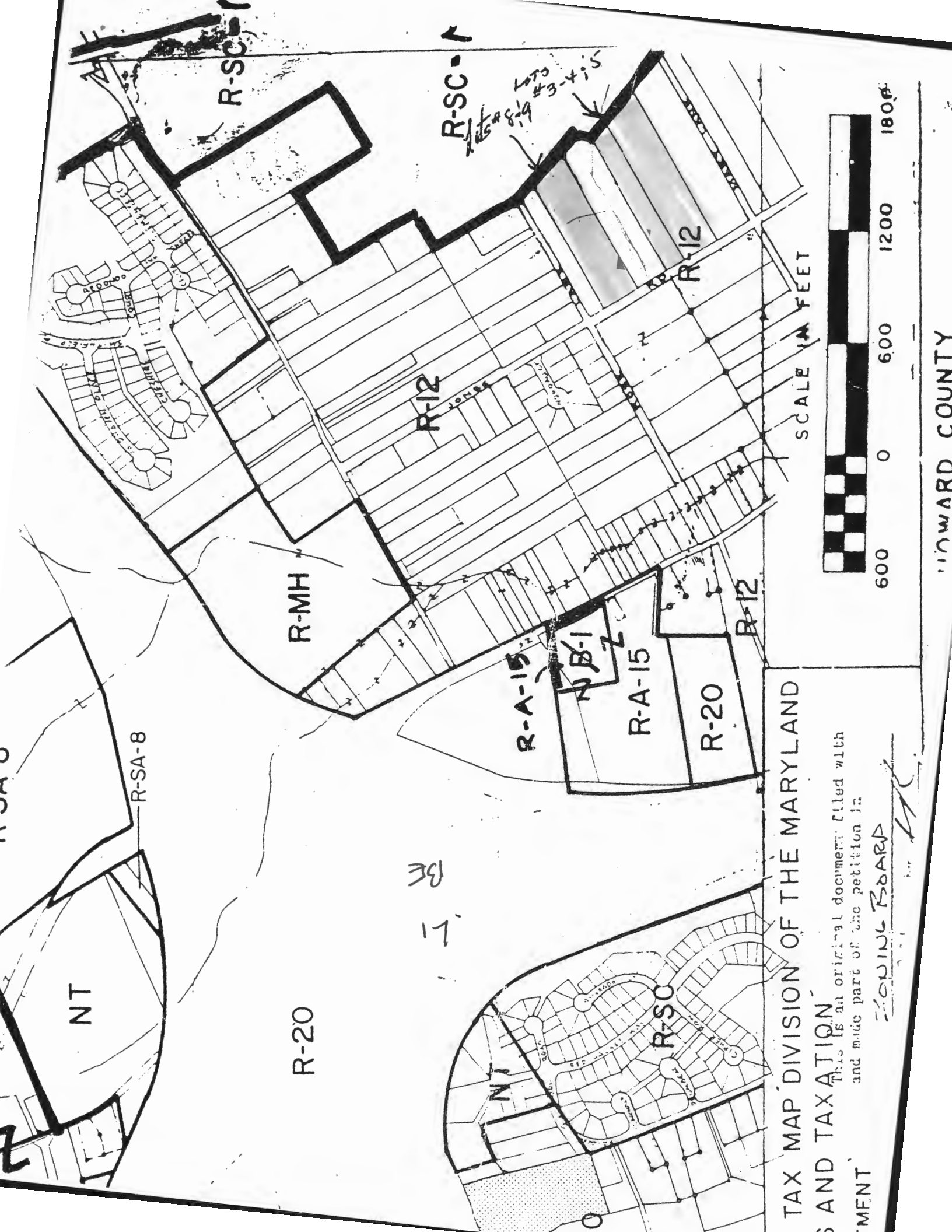

TAX MAP DIVISION OF THE MARYLAND
 DEPARTMENT OF REVENUE AND TAXATION

This is an original document filed with
 and made part of the petition in

PLANNING BOARD

HOWARD COUNTY

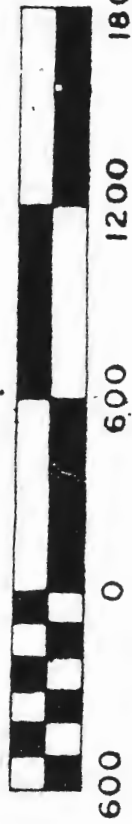

17
 BE

Lots #8-9
 Lots #3-4-5

R-SC

R-SC

R-12

R-12

R-MH

R-A-15

NB-1

R-A-15

R-20

R-12

R-SA-8

NT

R-20

R-SC



HOWARD COUNTY HEALTH DEPARTMENT

Diane L. Matuszak, M.D., M.P.H., County Health Officer

October 14, 1999

Mr. William Bishop
2997 Normandy Drive
Ellicott City, Maryland 21043

RE: **Percolation Test Application**
Property ID: Nordau S/D, Section E-4
Jones Road
Tax Map: 42 Parcel #'s 136, 138, 139
Lot #'s 3, 4, 5, 8, 9

Dear Mr. Bishop:

This office has recently received the above referenced percolation test application; however, we are unable to schedule testing at this time. Soils information indicates that the property is comprised of soil types that are designated to be tested only in the "wet season" of the year, which would be roughly Spring, 2000.

If you wish to proceed with your proposal, it shall be necessary for you to submit a scaled site plan and percolation test fees, in the amount of \$225 per lot, to this office. Once the "wet season" has been determined in the year 2000, then you shall receive a percolation test date for the property.

Please be advised that this office has confirmed that public sewerage is not available to the property.

If you have any questions or concerns, please contact me at the address below or by calling (410) 313-2640.

Sincerely,

Donna K. Soe, R.S.
Water and Sewerage Program

DKS

Cc: file

5/5/97

5/3/9

Applicant must do the following to hook into public sewer because they can't hit the sewer connection point without an ejector pump.

- Write letter to Ron Lepson requesting the use of an ejector pump (Chief of the Bureau of Engineering)
- Attach a copy of our letter stating the lot has failed the perc test

AM

Per. Lane Reed
at Engineering

APPLICATION



HOWARD COUNTY HEALTH DEPARTMENT

Joyce M. Boyd, M.D. County Health Officer
June 3, 1997

Mr. Jeff Geddes
Classic Custom Builders, Inc.
1002 Rock Spring Road
Bel Air, Maryland 21014

RE: Percolation Test Results - Application Number: 58118
Proposed Use: Recorded Lot
Property ID: Nordau S/D - Lot 23 - Mission Road
Tax Map: 42 Parcel: 448

Dear Mr. Geddes:

Follow-up percolation testing conducted May 5, 1997 on the above referenced property indicated unsatisfactory soil conditions. Shallow depth to water table was the primary limiting factor. At the time of testing, preliminary excavation was performed for sand mound system design. Two factors indicate that the site is unsuitable for a sand mound system;

- Slow perc rate at the surface indicate that the soil will probably not pass the infiltrometer test required for sand mound approval.
- The lot contains tree stumps of sufficient size and quantity as to limit proper site preparation. Stump removal would disturb the soil to an unacceptable degree.

In conclusion, it is in the opinion of this office that the above referenced lot is not buildable with on-site well and septic.

Should you wish to appeal this decision, please submit information that you feel is sufficient to warrant a reconsideration of our decision.

Short of a successful appeal, remaining options for this site would include:

1. Provision of an off-site septic location and suitable well site.
2. Provision of public water and/or sewer.
3. Provision for tax relief as a non-buildable lot based upon these findings.

If there are any questions regarding this matter, please contact me at the below address or by calling 410-313-2640.

Very truly yours,

Glen Savage

Glen Savage, R. S.
Water and Sewerage Program

GS:jr

cc: Tax Assessment Office
File

5/5/97

5/3/9

Applicant must do the following to hook into public sewer because they can't hit the sewer connection point without an ejector pump.

- Write letter to Ron Lepson requesting the use of an ejector pump (Chief of the Bureau of Engineering)
- Attach a copy of our letter stating the lot has failed the perc test

AM

Per. Lane Reed
at Engineering

APPLICATION



HOWARD COUNTY HEALTH DEPARTMENT

Joyce M. Boyd, M.D. County Health Officer
June 3, 1997

Mr. Jeff Geddes
Classic Custom Builders, Inc.
1002 Rock Spring Road
Bel Air, Maryland 21014

RE: Percolation Test Results - Application Number: 58118
Proposed Use: Recorded Lot
Property ID: Nordau S/D - Lot 23 - Mission Road
Tax Map: 42 Parcel: 448

Dear Mr. Geddes:

Follow-up percolation testing conducted May 5, 1997 on the above referenced property indicated unsatisfactory soil conditions. Shallow depth to water table was the primary limiting factor. At the time of testing, preliminary excavation was performed for sand mound system design. Two factors indicate that the site is unsuitable for a sand mound system;

- Slow perc rate at the surface indicate that the soil will probably not pass the infiltrometer test required for sand mound approval.
- The lot contains tree stumps of sufficient size and quantity as to limit proper site preparation. Stump removal would disturb the soil to an unacceptable degree.

In conclusion, it is in the opinion of this office that the above referenced lot is not buildable with on-site well and septic.

Should you wish to appeal this decision, please submit information that you feel is sufficient to warrant a reconsideration of our decision.

Short of a successful appeal, remaining options for this site would include:

1. Provision of an off-site septic location and suitable well site.
2. Provision of public water and/or sewer.
3. Provision for tax relief as a non-buildable lot based upon these findings.

If there are any questions regarding this matter, please contact me at the below address or by calling 410-313-2640.

Very truly yours,

Glen Savage

Glen Savage, R. S.
Water and Sewerage Program

GS:jr

cc: Tax Assessment Office
File