

## Real Property Data Search

## Search Result for HOWARD COUNTY

View Map		View GroundRent Redemption			View GroundRent Registration				
<b>Tax Exempt:</b>		<b>Special Tax Recapture:</b>							
<b>Exempt Class:</b>		NONE							
<b>Account Identifier:</b>		District - 01 Account Number - 178458							
Owner Information									
<b>Owner Name:</b>		OTTER POINT INVESTMENT LLC			<b>Use:</b>		INDUSTRIAL		
<b>Mailing Address:</b>		PO BOX 1303 LAUREL MD 20725-			<b>Principal Residence:</b>		NO		
					<b>Deed Reference:</b>		/09157/ 00489		
Location & Structure Information									
<b>Premises Address:</b>		6940 SE O'CONNOR LN HANOVER 21076-0000			<b>Legal Description:</b>		2.054 A 6940 O'CONNOR LANE & RAILROAD		
<b>Map:</b>	<b>Grid:</b>	<b>Parcel:</b>	<b>Sub District:</b>	<b>Subdivision:</b>	<b>Section:</b>	<b>Block:</b>	<b>Lot:</b>	<b>Assessment Year:</b>	<b>Plat No:</b>
0044	0001	0002		0000				2018	<b>Plat Ref:</b>
<b>Special Tax Areas:</b>					<b>Town:</b>		NONE		
					<b>Ad Valorem:</b>		104		
					<b>Tax Class:</b>				
<b>Primary Structure Built</b>	<b>Above Grade Living Area</b>	<b>Finished Basement Area</b>	<b>Property Land Area</b>	<b>County Use</b>					
1973	5616		2.0600 AC						
<b>Stories</b>	<b>Basement</b>	<b>Type</b>	<b>Exterior</b>	<b>Full/Half Bath</b>	<b>Garage</b>	<b>Last Major Renovation</b>			
		SERVICE GARAGE							
Value Information									
		<b>Base Value</b>	<b>Value</b>	<b>Phase-in Assessments</b>					
			As of	As of	As of				
			01/01/2018	07/01/2018	07/01/2019				
<b>Land:</b>		323,800	323,800						
<b>Improvements</b>		131,200	131,600						
<b>Total:</b>		455,000	455,400	455,133	455,267				
<b>Preferential Land:</b>		0			0				
Transfer Information									
<b>Seller:</b> NEWBERGER FREDERICK L			<b>Date:</b> 05/06/2005			<b>Price:</b> \$0			
<b>Type:</b> NON-ARMS LENGTH OTHER			<b>Deed1:</b> /09157/ 00489			<b>Deed2:</b>			
<b>Seller:</b> BALLANTINE ROBERT A SR			<b>Date:</b> 09/21/1990			<b>Price:</b> \$355,000			
<b>Type:</b> ARMS LENGTH IMPROVED			<b>Deed1:</b> /02232/ 00407			<b>Deed2:</b>			
<b>Seller:</b> RUTH ENGINEERING CO INC			<b>Date:</b> 08/08/1983			<b>Price:</b> \$157,000			
<b>Type:</b> ARMS LENGTH IMPROVED			<b>Deed1:</b> /01179/ 00439			<b>Deed2:</b>			
Exemption Information									
<b>Partial Exempt Assessments:</b>		<b>Class</b>	07/01/2018		07/01/2019				
<b>County:</b>		000	0.00						
<b>State:</b>		000	0.00						
<b>Municipal:</b>		000	0.00 0.00		0.00 0.00				

APPLICATION

HOWARD COUNTY

# PERMIT APPLICATION

DEPARTMENT OF PUBLIC WORKS  
BUREAU OF INSPECTIONS, LICENSES & PERMITS

COUNTY OFFICE BUILDING, ELLICOTT CITY, MARYLAND 21043

SERIAL NUMBER

1796  
PERMIT NUMBER

DATE ISSUED

BUILDING ADDRESS (HOUSE NO., STREET, TOWN OR AREA)

6940  
CONNERS ROAD  
HOWARD COUNTY

LOT NO. (OR TAX MAP & PARCEL NO.) BLOCK NO. LIBER FOLIO

Par 2 1 1ST

SUB DIVISION ZONE ZONE MAP NO. ELECTION DISTRICT

M-2 44 1ST

OWNER'S NAME AND ADDRESS PHONE NO.

MR CHARLES W. RUTH  
1700 FRIENDSHIP STREET  
BALTIMORE MARYLAND 21218 366-5300

OCCUPANT'S NAME AND ADDRESS PHONE NO.

MR. CHARLES W. RUTH Inglewood Pk. + Heat  
1700 FRIENDSHIP STREET  
BALTO MD 21218 366-5300

ARCHITECT OR ENGINEER'S NAME AND ADDRESS PHONE NO.

RICHARD CARROLL  
1800 N CHARLES ST.  
BALTIMORE MD 21201 752-3155

CONTRACTOR'S NAME AND ADDRESS PHONE NO.

SOUTHWESTERN CONTRACTORS INC  
4807 BENSON AVE  
BALTO. MD. 21227 247-3442

INTENDED USE OF STRUCTURE (BE SPECIFIC)

STORAGE FACILITY FOR MECHANICAL CONTRACTOR

EST. CONSTRUCTION COST LICENSE NUMBER PERMIT FEE

25,573 136974

DISTANCE IN FEET FROM R/W LINE TO FRONT BUILDING LINE 240'

SIDE YARD 12'

(DISTANCE IN FEET FROM SIDE BLDG. LINE TO SIDE PROPERTY LINE)

DISTANCE IN FEET FROM SIDE STREET R/W LINE

TO SIDE BUILDING LINE 230' Site approved Site plan 73-52

DISTANCE IN FEET, REAR YD. REQUIRING SET

BACK 230' (CORNER LOT ONLY)

CONDITIONS (IF ANY)

Checks payable to DIRECTOR OF FINANCE OF HOWARD COUNTY

QUALIFIED INSPECTOR OF CONSTRUCTION SEAL

Application is hereby made for a permit to (INDICATE ONE)  
ERECT USE ALTER EXTEND RAZE MOVE the (INDICATE ONE)  
PERMANENT TEMPORARY structure described.

DESCRIPTION OF WORK

ERECT (1) ONE METAL BLDG FOR STORAGE ONLY WITH NO HEAT, ELECTRIC, PLUMBING

SIZE OF BLDG.	FRONT	DEPTH	HEIGHT
60x50	60	50	24

TYPE OF BLDG.	AREA	VOLUME	ROOF
R. ROOMS			
ROOMS			
BATHS			
FIREPLACES			

FOOTINGS	FOUNDATION	S. WALLS

UTILITIES					
WATER/WELL	SEWER/SEPTIC	GAS	ELECTRICITY	TYPE OF HEAT	AC
NONE	NONE	NONE	NONE	NONE	NONE

I have carefully examined and read this application and know the same is true and correct, and that in doing this work, all provisions of Howard County Ordinances and the State Laws of Maryland will be complied with, whether specified or not, and I will notify the Bureau of Inspections, Licenses and Permits twenty four hours in advance when I am ready for the inspections called for elsewhere in this application; and that no work will be covered up until such inspections have been complied with.

Michael J Burke 21 FEB 73  
SIGNATURE DATE

### FOR OFFICE USE ONLY

AGENCY	DATE	SIGNATURE APPROVAL
ZONING/PLANNING	3/5/73	J. Heinrich
SRC		
HIGHWAYS		
BUILDING ENGINEER		
WATER & SEWER		
HEALTH DEPT.		
FIRE MARSHAL		

APPROVED DATE

RECEIVED  
HOWARD COUNTY  
HEALTH DEPT.  
ELLCOTT CITY, MD 21114-83

Dear Mr. Skinner,

Nov 17 9 42 AM '83

PLEASE RUSH! The  
people are going to be moving  
in and using the warehouse  
11/15/83 and there is no water.  
They want 2 wells drilled  
on the property if possible.  
The location of the old well  
is unknown and we could not  
locate the septic also. The well  
locations are supposed to be  
stated 11/15/83 by someone  
from Mr. Balentine's office.  
You can contact Julie Balentine  
at 796-1888 in reference to that.

11/21 3 PM voicemail @ 796-1888 J.S.  
11/22 9 AM voicemail 1... J.S.

SDP- 73-52

Thank You  
Belinda Ulreget  
Branch Office One  
255-8234

1 DA X 2044

6/15/61  
9.30

# APPLICATION

A 03876

P \_\_\_\_\_

SEWAGE DISPOSAL TESTING

MARYLAND STATE DEPARTMENT OF HEALTH

HOWARD COUNTY

ELLICOTT CITY

DISTRICT \_\_\_\_\_

DATE 6-12-61

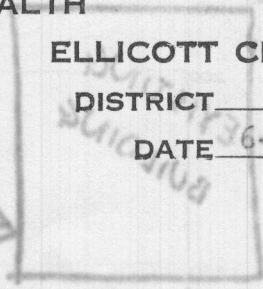
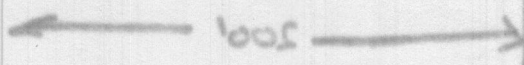
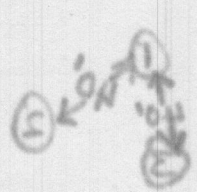

TO: THE COUNTY HEALTH OFFICER  
ELLICOTT CITY, MARYLAND

I, HEREBY, APPLY FOR THE NECESSARY TESTS IN ORDER TO CONSTRUCT (OR RECONSTRUCT) A SEWAGE DISPOSAL SYSTEM.

PROPERTY OWNER Engineering  
Ruth Engineering Co.

ADDRESS 5820 Johnny Cake Road PHONE EL 7-0900

PROPERTY LOCATION:

SUBDIVISION \_\_\_\_\_ LOT NO. \_\_\_\_\_

ROAD AND DESCRIPTION On ~~4 corners~~ 3 blocks  
On ~~4 corners~~ Road off Dorsey Rd. next to the railroad  
O'CONNOR DR. 9311010

OCCUPANT \_\_\_\_\_ PHONE \_\_\_\_\_

PERSON TO CONSTRUCT SYSTEM \_\_\_\_\_ PHONE \_\_\_\_\_

ADDRESS \_\_\_\_\_ PHONE \_\_\_\_\_

SIZE OF LOT 3 acre TYPE BLDG. Warehouse NUMBER OF BEDROOMS 2 people

IF NOT SINGLE RESIDENCE DESCRIBE 1 bathroom

SIGNATURE OF APPLICANT John W. Ruth

APPROVED BY \_\_\_\_\_ FOR \_\_\_\_\_ DATE \_\_\_\_\_  
(KIND OF SYSTEM)

REJECTED BY \_\_\_\_\_ FOR \_\_\_\_\_ DATE \_\_\_\_\_  
(KIND OF SYSTEM)

HOLD PENDING FURTHER TESTS W.T. Joewy DATE 6/15/61

REASONS FOR REJECTION OR HOLDING no percolation

# THIS IS NOT A PERMIT

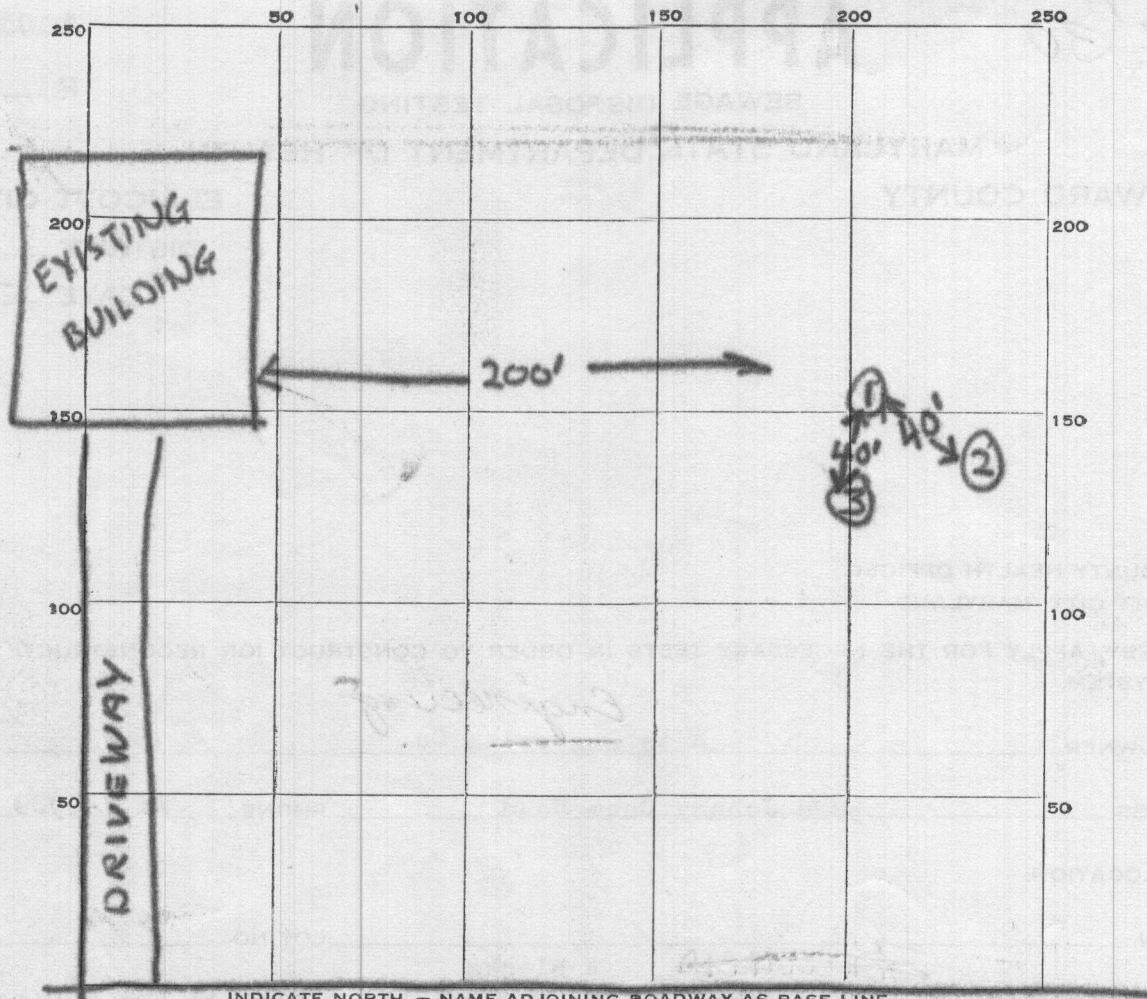

INDICATE NORTH. - NAME ADJOINING ROADWAY AS BASE LINE.

O'CONNOR RD.

DATE	TEST NO.	DEPTH	PRE-WET		TEST - 1" DROP		TIME
			START	STOP	START	STOP	
6/15/61	ONE	3'	1019				
6/15/61	TWO	3'	1030				
6/15/61	THREE	3'	1038				

NO PERC

SOIL AUGER FINDING wet sand and white clay

TESTED BY Walter T. Deery

REMARKS \_\_\_\_\_

ALSO PRESENT William J. DeWitt LOT NO. \_\_\_\_\_

# APPLICATION

A 03876

SEWAGE DISPOSAL TESTING

P \_\_\_\_\_

MARYLAND STATE DEPARTMENT OF HEALTH

HOWARD COUNTY

ELLICOTT CITY

DISTRICT \_\_\_\_\_

DATE 6-12-61

*LOTT 11  
10-11  
10-12  
10-13*

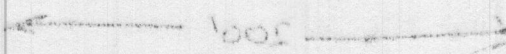

TO: THE COUNTY HEALTH OFFICER  
ELLICOTT CITY, MARYLAND

I, HEREBY, APPLY FOR THE NECESSARY TESTS IN ORDER TO CONSTRUCT (OR RECONSTRUCT) A SEWAGE DISPOSAL SYSTEM.

PROPERTY OWNER Ruth Engineering Co.

ADDRESS 5820 Johnny Cake Road PHONE Ri 7-0900

PROPERTY LOCATION:

SUBDIVISION O'CONNOR DR. LOT NO. \_\_\_\_\_

ROAD AND DESCRIPTION On 4 Connors Road off Dorsey Rd. next to the railroad  
*3 blocks*

OCCUPANT \_\_\_\_\_ PHONE \_\_\_\_\_

PERSON TO CONSTRUCT SYSTEM \_\_\_\_\_ PHONE \_\_\_\_\_

ADDRESS \_\_\_\_\_ PHONE \_\_\_\_\_

SIZE OF LOT 3 acre TYPE BLDG. Warehouse

NUMBER OF BEDROOMS 1 bathroom

IF NOT SINGLE RESIDENCE DESCRIBE \_\_\_\_\_

SIGNATURE OF APPLICANT John H. Ruth

APPROVED BY \_\_\_\_\_ FOR \_\_\_\_\_ DATE \_\_\_\_\_  
(KIND OF SYSTEM)

REJECTED BY \_\_\_\_\_ FOR \_\_\_\_\_ DATE \_\_\_\_\_  
(KIND OF SYSTEM)

HOLD PENDING FURTHER TESTS W.T. Joey DATE 6/15/61

REASONS FOR REJECTION OR HOLDING no percolation

# THIS IS NOT A PERMIT

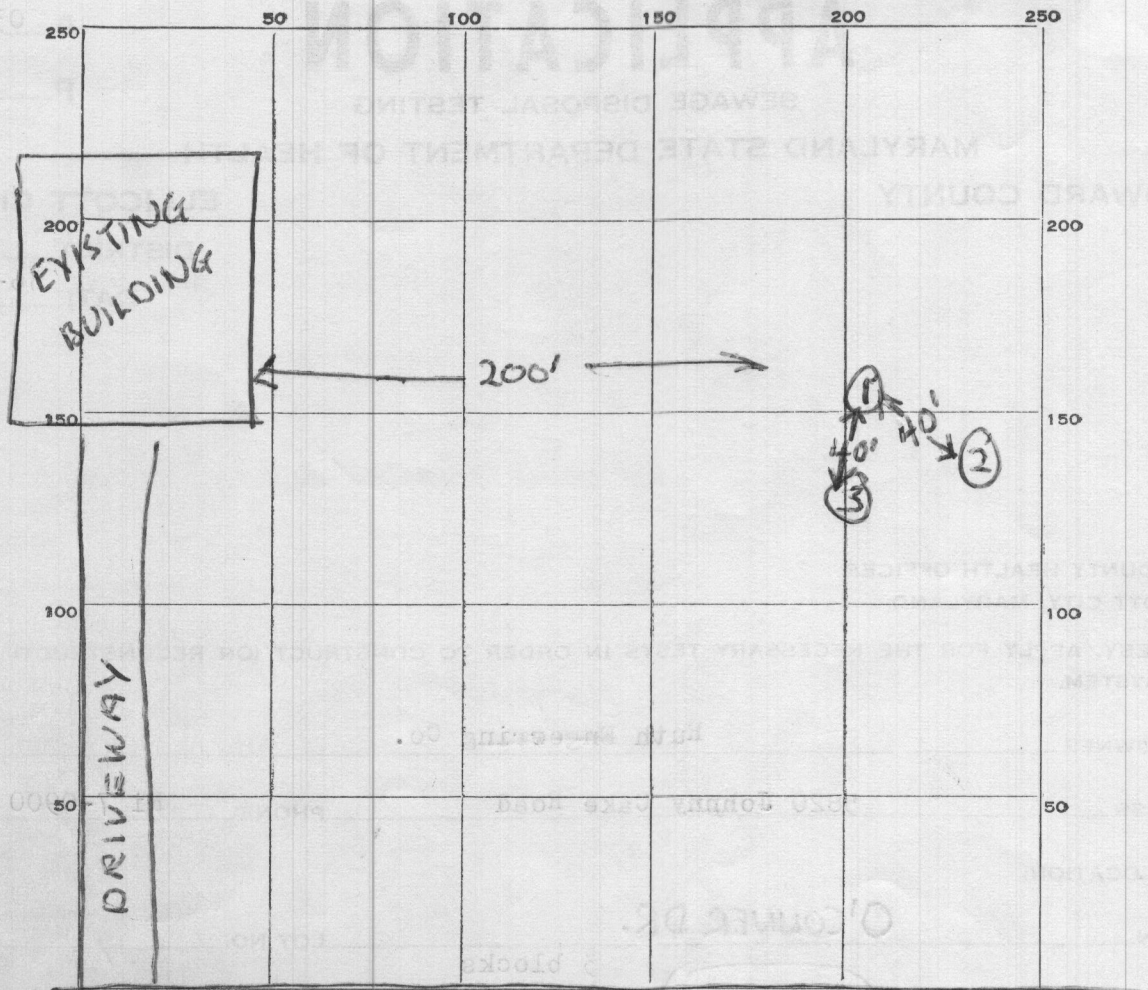

INDICATE NORTH. - NAME ADJOINING ROADWAY AS BASE LINE.

O'CONNOR RD.

DATE	TEST NO.	DEPTH	PRE-WET		TEST - 1" DROP		TIME
			START	STOP	START	STOP	
6/15/61	ONE	3'	1019				
6/15/61	TWO	3'	1030				
6/15/61	THREE	3'	1038				

} NO PERC

SOIL AUGER FINDING

wet sand and white clay

TESTED BY

Walter T. Dewey

REMARKS

ALSO PRESENT

William J. Knevell

LOT NO.



# HOWARD COUNTY HEALTH DEPARTMENT

JOYCE M. BOYD, M.D., M.P.H.  
COUNTY HEALTH OFFICER

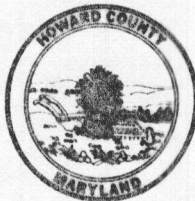

BUREAU OF ENVIRONMENTAL HEALTH  
TIBER PLACE  
8306B FORREST STREET  
ELLCOTT CITY, MARYLAND 21043  
TELEPHONE: 992-2330

November 22, 1983

Mr. Robert Balentine  
1797 Dorsey Road  
Hanover, Maryland 21076

RE: Well permit applications  
Tax Map 44, Parcel 2  
6940 O'Conner Lane

Dear Mr. Balentine:

This office has received two (2) well permit applications to construct wells on the above referenced property, the former Ruth Engineering property.

Presently, these permits cannot be issued, and are being returned to the driller, John Branham Contractors. This is due to the absence of an approved wastewater disposal system at the site.

Percolation testing to determine the soils suitability for a septic system were performed on June 15, 1961, and the tests failed due to poor soil type (white clay) and damp sand in the test pits.

A new building was erected in 1973 (see application #17196 copy enclosed). This building was to be for storage only, with no heat, electric or plumbing.

If you wish to discuss this matter or have any questions, please call me at 992-2330.

Very truly yours,

Frank A. Skinner, Director  
Water and Sewerage Program

FAS:hs

cc: John Branham Contractors

# APPLICATION FOR A PERMIT TO APPROPRIATE AND USE WATERS OF THE STATE

Water Resources Administration  
 Water Supply Section  
 Taves Office Building  
 Annapolis, Maryland 21401

- Surface Water  Groundwater  New Application  Change in Existing Permit

APPLICATION

Robert Balentine  
 (Owner's Name)  
 1797 Dorsey Road Hanover Md 21076  
 (Owner's Address) (Street) (Town) (State) (Zip Code)  
 796-1888  
 (Telephone Number)

WITHDRAWAL

## GROUNDWATER

Appropriate and use a yearly average of 2000 gallons per day,  
 [total annual use - 365 days]  
 and 2500 gallons  
 [highest total monthly use + days in month]  
 for the average day of the maximum month, from  
 well(s) having a diameter of 7 inches, and a depth of 100 ft.  
 [estimate]  
 [estimate]

## SURFACE WATER

Appropriate and use a yearly average of \_\_\_\_\_ gallons per  
 [total annual use - 365 days] day, and a maximum use of \_\_\_\_\_  
 gallons in any one day, from: \_\_\_\_\_  
 [name of stream]  
 [exact location of withdrawal]

PROJECT LOCATION

Formerly  
 Dranner Ln. formerly  
 off Dorsey Rd  
 Location - be specific  
 County Howard  
 Subdivision or town Hanover  
 Warehouse  
 Name and type of business  
 Phone number 796-1888

ALL APPLICATIONS MUST INCLUDE A COPY OF LOCATION MAP SHOWING THE PROJECT SITE

PURPOSE

- The water will be used for:
- Community Water Supply
  - Non-Potable supply (sanitary uses, not for drinking water)
  - Potable Supply (drinking water, etc.)
  - Cooling Water
  - Irrigation
  - Process Water
  - Other

[explain]

SIGNATURE

Please sign here

[signature]

John E. Brannan President 11-9-83  
 [please print name, title, and date here]

THIS APPLICATION WILL NOT BE PROCESSED WITHOUT A SIGNATURE AND A LOCATION MAP

REVIEW BY COUNTY HEALTH DEPARTMENT OR DESIGNATED AGENCY

THIS SECTION NOT TO BE COMPLETED BY APPLICANT

Is this Project consistent with the County Water and Sewerage Plan and local planning and zoning?

- YES  NO, explain

Signature of county representative

[signature]

[title]

[date]

May 19, 1983

Ruth Engineering Co. Inc., Property: -- 7.10 Acres + Land and Improvements

FACTUAL DATA RELEVANT TO SUBJECT PROPERTY:

Owner: Ruth Engineering Co., Inc.

Location: First Election District, Howard County  
O'Connor Road  
Hanover, Maryland

Identification: Tax Map #44      Parcels #2  
Copy Enclosed, Subject Property Marked In Red

Deed Ref: Liber #360, Folio #53

Plot Size: 7.10 Acres +

Zoning: M-2 Manufacturing Heavy

Utilities: All public utilities available except  
water and sewer

Description  
of Land: The Parcel of land has approximately 1500 frontage  
on the east side of O'Connor Road, with access to Maryland Rt. 176.

The configuration is rectangular in shape extending  
to an average depth of approximately 900 feet. The topography is  
level, sloping gently toward the East from the Chessie Railroad  
Tracks which are to the West.

The land, obviously, where the Improvements are  
located is cleared with the remainder growing in scrub trees and  
dense undercover.