

## Real Property Data Search

## Search Result for HOWARD COUNTY

View Map		View GroundRent Redemption			View GroundRent Registration				
<b>Tax Exempt:</b>		<b>Special Tax Recapture:</b>							
<b>Exempt Class:</b>		NONE							
<b>Account Identifier:</b>		<b>District - 05 Account Number - 348129</b>							
Owner Information									
<b>Owner Name:</b>		MIRSAIDI MIRHASSAN MIRSAIDI SHERYL T/E			<b>Use:</b>		RESIDENTIAL		
<b>Mailing Address:</b>		4083 HERITAGE HILL LN ELLCOTT CITY MD 21042-1205			<b>Principal Residence:</b>		YES		
					<b>Deed Reference:</b>		/03522/ 00140		
Location & Structure Information									
<b>Premises Address:</b>		4083 HERITAGE HILL LN ELLCOTT CITY 21042-0000			<b>Legal Description:</b>		P/O LOT 6 5.910 AR 4083 HERITAGE HILL LN S GLENELG MANOR PRO		
<b>Map:</b>	<b>Grid:</b>	<b>Parcel:</b>	<b>Sub District:</b>	<b>Subdivision:</b>	<b>Section:</b>	<b>Block:</b>	<b>Lot:</b>	<b>Assessment Year:</b>	<b>Plat No:</b>
0022	0023	0278		0000			6	2017	Plat Ref:
<b>Special Tax Areas:</b>				<b>Town:</b>		NONE			
				<b>Ad Valorem:</b>		100			
				<b>Tax Class:</b>					
<b>Primary Structure Built</b>		<b>Above Grade Living Area</b>		<b>Finished Basement Area</b>		<b>Property Land Area</b>		<b>County Use</b>	
1984		2,842 SF				5.9100 AC			
<b>Stories</b>	<b>Basement</b>	<b>Type</b>	<b>Exterior</b>	<b>Full/Half Bath</b>	<b>Garage</b>	<b>Last Major Renovation</b>			
2	YES	STANDARD UNIT	BRICK	2 full/ 1 half	1 Attached				
Value Information									
		<b>Base Value</b>		<b>Value</b>		<b>Phase-in Assessments</b>			
				As of		As of		As of	
				01/01/2017		07/01/2018		07/01/2019	
<b>Land:</b>		316,800		316,800					
<b>Improvements</b>		316,900		365,800					
<b>Total:</b>		633,700		682,600		666,300		682,600	
<b>Preferential Land:</b>		0						0	
Transfer Information									
<b>Seller:</b> RETTALIATA ANTHONY F				<b>Date:</b> 07/18/1995		<b>Price:</b> \$350,000			
<b>Type:</b> ARMS LENGTH IMPROVED				<b>Deed1:</b> /03522/ 00140		<b>Deed2:</b>			
<b>Seller:</b>				<b>Date:</b>		<b>Price:</b>			
<b>Type:</b>				<b>Deed1:</b>		<b>Deed2:</b>			
<b>Seller:</b>				<b>Date:</b>		<b>Price:</b>			
<b>Type:</b>				<b>Deed1:</b>		<b>Deed2:</b>			
Exemption Information									
<b>Partial Exempt Assessments:</b>		<b>Class</b>		07/01/2018		07/01/2019			
<b>County:</b>		000		0.00					

PUB. SEWER STATUS VERIFIED BY \_\_\_\_\_

ISSUE DATE: 4/25/08

P 528915

APPROVAL DATE: 5/7/08

# Repair Permit

A REPAIR

Tax ID # 05-348129

**ON-SITE SEWAGE DISPOSAL SYSTEM  
HOWARD COUNTY HEALTH DEPARTMENT  
BUREAU OF ENVIRONMENTAL HEALTH**

Hatfield's Equipment IS PERMITTED TO INSTALL  ALTER

ADDRESS: PO Box 519, Annapolis Junction MD PHONE NUMBER: 301-854-6172

SUBDIVISION: Glencelg Manor I LOT NUMBER: 6

ADDRESS: 4083 Heritage Hill Lane PROPERTY OWNER: Sheryl Mirsaidi

SEPTIC TANK CAPACITY (GALLONS): Ex 1500

PUMP CHAMBER CAPACITY (GALLONS): N/A

NUMBER OF BEDROOMS: 4

SQUARE FEET PER BEDROOM: 08

LINEAR FEET OF TRENCH REQUIRED: 125 (2) 62.5

TRENCHES:	Trench to be 3 feet wide. Inlet 3 feet below original grade. Bottom maximum depth 6 feet below original grade. Effective area begins at 3 feet below original grade. 3 feet of stone below distribution pipe.
LOCATION:	<i>Install 2 trenches on contour splitting the distance between old trench &amp; trees w/ new 2-box</i>
PURPOSE:	Existing septic system has failed. Call for inspection when ground is opened so sanitarian can recommend repair.

PLANS APPROVED: *[Signature]* DATE: 5/6/08

- NOTE: PERMIT VOID AFTER 2 YEARS
- NOTE: CONTRACTOR RESPONSIBLE FOR SCHEDULING A PRE-CONSTRUCTION INSPECTION FOR ALL INSTALLATIONS
- NOTE: WATERTIGHT SEPTIC TANKS REQUIRED
- NOTE: ALL PARTS OF SEPTIC SYSTEM SHALL BE 100 FEET FROM ANY WATER WELL
- NOTE: MANHOLE RISERS REQUIRED ON ALL SEPTIC TANKS AND PUMP CHAMBERS

**NEITHER THE HOWARD COUNTY COUNCIL OR THE HEALTH DEPARTMENT IS RESPONSIBLE FOR THE SUCCESSFUL OPERATION OF ANY SYSTEM PERMITTEE RESPONSIBLE FOR OBTAINING FINAL APPROVAL ON THIS PERMIT CALL 410-313-2640 FOR INSPECTION OF SEPTIC SYSTEM**

NOT TO SCALE

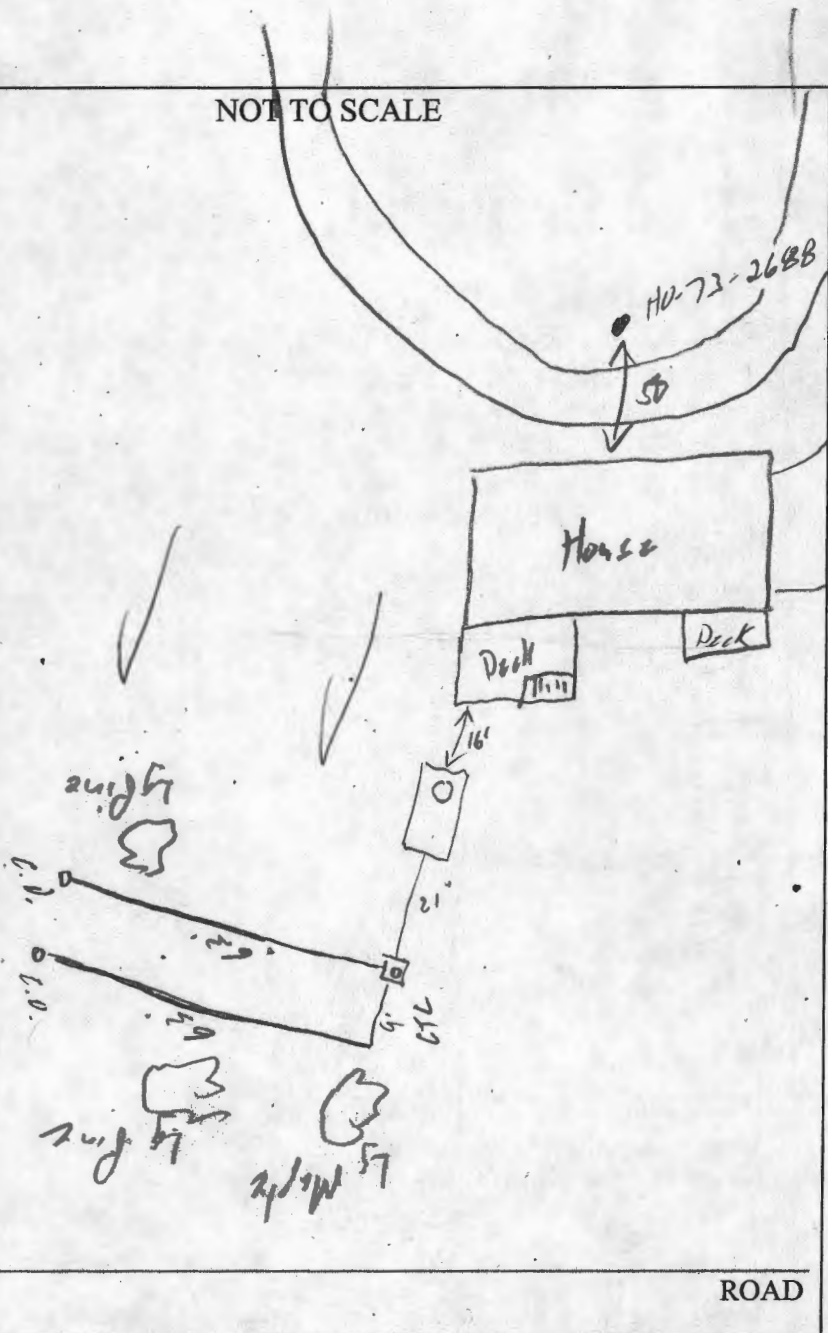

TRENCH/DRAINFIELD DATA		
WIDTH	INLET	BOTTOM
3'	3'	6'
NUMBER OF TRENCHES		2
TOTAL LENGTH		126'
ABSORPTION AREA		3784 + 54
DISTRIBUTION BOX LEVEL		<input checked="" type="checkbox"/>
DISTRIBUTION BOX BAFFLE		<input checked="" type="checkbox"/>
DISTRIBUTION BOX PORT		<input checked="" type="checkbox"/>

SEPTIC TANK DATA	
SEPTIC TANK 1 LEVEL	
CAPACITY	6 x 1500 GAL
SEAM LOC	
TANK LID DEPTH	
BAFFLES	
BAFFLE FILTER	
MANHOLE LOC	
6" PORT LOC	
WATERTIGHT TEST	
SEPTIC TANK 2 LEVEL	
CAPACITY	GAL
SEAM LOC	
TANK LID DEPTH	
BAFFLES	
BAFFLE FILTER	
MANHOLE LOC	
6" PORT LOC	
WATERTIGHT TEST	

PRE-CONSTRUCTION 5/6/07 - Perceid, wrote specs

INSTALLATION 5/7/07 - Installed per specs

FINAL INSPECTOR \_\_\_\_\_ DATE OF APPROVAL \_\_\_\_\_

**SEPTIC SYSTEM REPAIR / UPGRADE / EVALUATION REQUEST**

**Please fill out this form completely and check off the reason for the request:**

Date requested: \_\_\_\_\_

**Reason for Request**

Failing System (includes surface discharge or inadequate treatment zone)

Has the contractor verified through excavation/pumping evaluation, that there are no pipe blockages? \_\_\_\_\_

In support of a building permit. Type of building addition: \_\_\_\_\_

\*System relocation for proposed addition for setback compliance \_\_\_\_\_

\*Verification of adequate system capacity per COMAR 26.04.02.02D (4) \_\_\_\_\_

To replace collapsed septic tank or upgrade tank capacity \_\_\_\_\_

To replace collapsed drywell \_\_\_\_\_

\*\*\*\*\*

Septic Contractor: Hutfields Equipment

Contractor's Address: PO Box 519  
Annapolis Junction Md

Contractor's Phone #: 301 854-6172

Property Address: 4085 Heritage Hill Ln

Property (Subdivision) & Lot # Heritage Hill

Owner's Name: Cheryl Mercede

Is public sewer available/nearby: N/A

Names of Any Previous Owners: \_\_\_\_\_

Year House Built: 1984

# of Existing Bedrooms: 4

# of Bedrooms after completion of addition: \_\_\_\_\_

Has this request been discussed previously with a Sanitarian, who? ASAP Please!

*If public sewer is close, further research will be performed to verify availability and possible hook up to public sewer.*

A Sanitarian will be in contact within three business days depending upon the urgency of the situation to coordinate the scheduling of the repair /upgrade/evaluation. No inspection will be performed without fee collection at the office.

Environmental Sanitarian tentatively assigned \_\_\_\_\_

1/17/84-1/19/84  
3:11 PM  
12/27/83  
C. J. [unclear]

Approved 1/19/84

Stager

P 53418

A 19910

# PERMIT

SEWAGE DISPOSAL SYSTEM

MARYLAND STATE DEPARTMENT OF HEALTH

HOWARD COUNTY  
BUREAU OF ENVIRONMENTAL HEALTH  
992-2330

ELLICOTT CITY

DISTRICT 5th

DATE 12/22/83

INDEX

Olen Kotterman IS PERMITTED TO INSTALL  ALTER

ADDRESS 14960 Frederick Road, Woodbine, Maryland PHONE 442-1336

SUBDIVISION Glencly Manor I ROAD 12605 Folly Quarter Rd LOT Parcel 6

PROPERTY OWNER Anthony F. Rettaliata  
220 Chorrydale Road

ADDRESS Catonsville, Maryland 21228

IF GARBAGE GRINDER IS USED INCREASE SEPTIC TANK CAPACITY BY 50% AND ABSORPTION

GAP

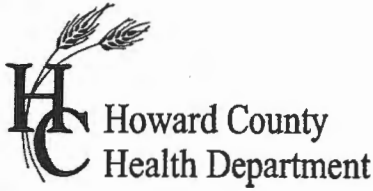

# APPLICATION

## FOR PERCOLATION TESTING AND SITE EVALUATION

TEST DATE(S) \_\_\_\_\_ TEST TIME \_\_\_\_\_

(A/P) 528912

AGENCY REVIEW: \_\_\_\_\_

DATE 4/25/08

DO NOT WRITE ABOVE THIS LINE

I HEREBY APPLY FOR THE NECESSARY TESTING/EVALUATION PRIOR TO ISSUANCE OF SEWAGE DISPOSAL SYSTEM PERMIT(S) TO:

CHECK AS NEEDED:

- CONSTRUCT NEW SEPTIC SYSTEM(S)
- REPAIR/ADD TO AN EXISTING SEPTIC SYSTEM
- REPLACE AN EXISTING SEPTIC SYSTEM

CHECK AS NEEDED:

- NEW STRUCTURE(S)
- ADDITION TO AN EXISTING STRUCTURE
- REPLACE AN EXISTING STRUCTURE

CHECK ONE:

- CREATE NEW LOT(S)
- BUILD ON AN EXISTING LOT IN A SUBDIVISION
- BUILD ON AN EXISTING PARCEL OF RECORD

IS THE PROPERTY WITHIN 2500' OF ANY RESERVOIR?

- YES
- NO

THE TYPE OF STRUCTURE IS:

- RESIDENTIAL WITH 4 PROPOSED BEDROOMS IN THE COMPLETED STRUCTURE (NOTE **UNKNOWN** IF APPROPRIATE)
- COMMERCIAL (PROVIDE DETAIL OF NUMBERS AND TYPES OF EMPLOYEES/ CUSTOMERS ON ACCOMPANYING PLAN)
- INSTITUTIONAL/GOVERNMENT (PROVIDE DETAIL OF NUMBERS AND TYPES OF EMPLOYEES/USERS ON ACCOMPANYING PLAN)

PROPERTY OWNER(S) Cherl Mercedes

DAYTIME PHONE ~~301 854-6172~~ 410 531-9421 CELL \_\_\_\_\_ FAX \_\_\_\_\_

MAILING ADDRESS 4085 Heritage Hills Ln Elliot City MD 21042  
STREET CITY/TOWN STATE ZIP

APPLICANT Hatfields

DAYTIME PHONE 301 854-6172 CELL 410 984-0047 FAX 301 990

MAILING ADDRESS P.O. Box 579 Annapolis Junction MD  
STREET CITY/TOWN STATE ZIP

APPLICANT'S ROLE: DEVELOPER BUILDER BUYER RELATIVE/FRIEND REALTOR CONSULTANT

PROPERTY LOCATION  
SUBDIVISION/PROPERTY NAME 4085 Heritage Hill Ln LOT NO. \_\_\_\_\_

PROPERTY ADDRESS Heritage Hills  
STREET TOWN/POST OFFICE

TAX MAP PAGE(S) \_\_\_\_\_ GRID \_\_\_\_\_ PARCEL(S) \_\_\_\_\_ PROPOSED LOT SIZE \_\_\_\_\_

AS APPLICANT, I UNDERSTAND THE FOLLOWING: THE SYSTEM INSTALLED SUBSEQUENT TO THIS APPLICATION IS ACCEPTABLE ONLY UNTIL PUBLIC SEWERAGE IS AVAILABLE. THIS APPLICATION IS COMPLETE WHEN ALL APPLICABLE FEES AND A SUITABLE SITE PLAN HAVE BEEN RECEIVED. I ACCEPT THE RESPONSIBILITY FOR COMPLIANCE WITH ALL M.O.S.H.A. AND "MISS UTILITY" REQUIREMENTS. APPROVAL IS BASED UPON SATISFACTORY REVIEW OF A PERC CERTIFICATION PLAN.

TEST RESULTS WILL BE MAILED TO APPLICANT.

Jeff Reut  
SIGNATURE OF APPLICANT

HOWARD COUNTY HEALTH DEPARTMENT, BUREAU OF ENVIRONMENTAL HEALTH, WELL AND SEPTIC PROGRAM  
7178 COLUMBIA GATEWAY DRIVE COLUMBIA, MARYLAND 21046 (410) 313-1771 FAX (410) 313-2648  
TDD (410) 313-2323 TOLL FREE 1-877-4MD-DHMH

4 x 150 / 0.6 / 2 = 101.25

