

**Bureau of Environmental Health**  
 8930 Stanford Boulevard, Columbia, MD 21045  
 Main: 410-313-2640 | Fax: 410-313-2648  
 TDD 410-313-2323 | Toll Free 1-866-313-6300  
[www.hchealth.org](http://www.hchealth.org)  
 Facebook: [www.facebook.com/hocohealth](http://www.facebook.com/hocohealth)

Maura J. Rossman, M.D., Health Officer

RECEIPT DATE: 3/4/19 **ONSITE SEWAGE DISPOSAL SYSTEM** P 564774  
 APPROVAL DATE: 07/11/2019 **PERMIT:** **REPAIR** A \_\_\_\_\_  
 PROPERTY ADDRESS: 9455 Ellsworth Court  
 SUBDIVISION: \_\_\_\_\_ LOT: 18 TAX ID: 05-378974  
 CONTRACTOR: Fogles Septic Clean Inc. EMAIL: kim@foglesinc.com  
 CONTRACTOR ADDRESS: 580 Obrecht Road PHONE: 410-795-5670  
 PROPERTY OWNER: William and Karen England EMAIL: KarenEngland@verizon.net  
 OWNER ADDRESS: 9455 Ellsworth Court, Fulton, MD 20759 PHONE: 301-213-6234

SEPTIC TANK SIZE (GALLONS): Existing PUMP CHAMBER CAPACITY (GALLONS): N/A PUMP SIZE: N/A  
 NUMBER OF BEDROOMS: 5 HOUSE SQ. FT. — APPLICATION RATE: 1.2  
 DISTRIBUTION SYSTEM: GRAVITY FED  LOW PRESSURE DOSED

TRENCHES:	LINEAR FEET REQUIRED: <u>129</u>	INLET DEPTH: <u>2 1/2</u>
	TRENCH WIDTH: <u>3'</u>	MAXIMUM BOTTOM DEPTH: <u>5'</u>
	MINIMUM SPACE BETWEEN TRENCHES: <u>11' 6"</u>	EFFECTIVE AREA BEGINNING DEPTH: <u>3'</u>

LOCATION: **TO BE STAKED BY SANITARIAN DURING PRE-CONSTRUCTION INSPECTION.**

NOTES: Install 2x65' trenches on contour running towards fence/prop. line. Pump/collapse ex. Drywell

ISSUED BY: K. Wolf ISSUE DATE: 3/12/19 EXPIRATION DATE: 3/12/20

- NOTE: **CONTRACTOR MUST SCHEDULE A PRE-CONSTRUCTION INSPECTION PRIOR TO BEGINNING ANY INSTALLATION**
- NOTE: CONTRACTOR MUST SCHEDULE AN INSPECTION AND GAIN APPROVAL OF ALL COMPONENTS PRIOR TO COVERING
- NOTE: STONE MUST BE APPROVED BY HEALTH DEPARTMENT AND GRAVEL TICKET MUST BE AVAILABLE FOR REVIEW.
- NOTE: WATERTIGHT SEPTIC TANKS REQUIRED
- NOTE: ALL PARTS OF SEPTIC SYSTEM SHALL BE AT LEAST 100 FEET DOWNGRADIENT FROM ANY WATER WELL
- NOTE: MANHOLE RISERS REQUIRED ON ALL SEPTIC TANKS AND PUMP CHAMBERS
- NOTE: **AN ELECTRICAL PERMIT IS REQUIRED FOR INSTALLATION OF ANY ELECTRICAL COMPONENTS OF THE SYSTEM**  
 ELECTRICAL PERMIT ISSUED E N/A
- NOTE: **THE HCHD DOES NOT WARRANT ANY SYSTEM AND CANNOT GUARANTEE THE PERFORMANCE OF THIS SYSTEM AS DESIGNED. BY ACCEPTING THIS PERMIT, THE OWNER AND/OR APPLICANT ACKNOWLEDGE THAT THE SPECIFICATIONS DETAILED IN THIS DESIGN ARE ONE POSSIBLE OPTION AND THAT THE HCHD WILL REVIEW OTHER PROPOSALS. YOU HAVE THE OPTION TO SEEK THE ADVICE OF A QUALIFIED DESIGN CONSULTANT OR PROFESSIONAL ENGINEER FOR FURTHER GUIDANCE.**
- NOTE: MDE RECOMMENDS SEPTIC TANKS, BAT, AND OTHER PRETREATMENT UNITS BE PUMPED AT A FREQUENCY ADEQUATE TO ENSURE THAT SOLIDS ARE NOT DISCHARGED TO THE DISPOSAL AREA

**NEITHER THE HOWARD COUNTY COUNCIL NOR THE HEALTH DEPARTMENT IS RESPONSIBLE FOR THE SUCCESSFUL OPERATION OF ANY SYSTEM.  
 PERMITTEE RESPONSIBLE FOR OBTAINING FINAL APPROVAL ON THIS PERMIT.  
 CALL 410-313-1771 TO SCHEDULE INSPECTIONS.**

NOT TO SCALE

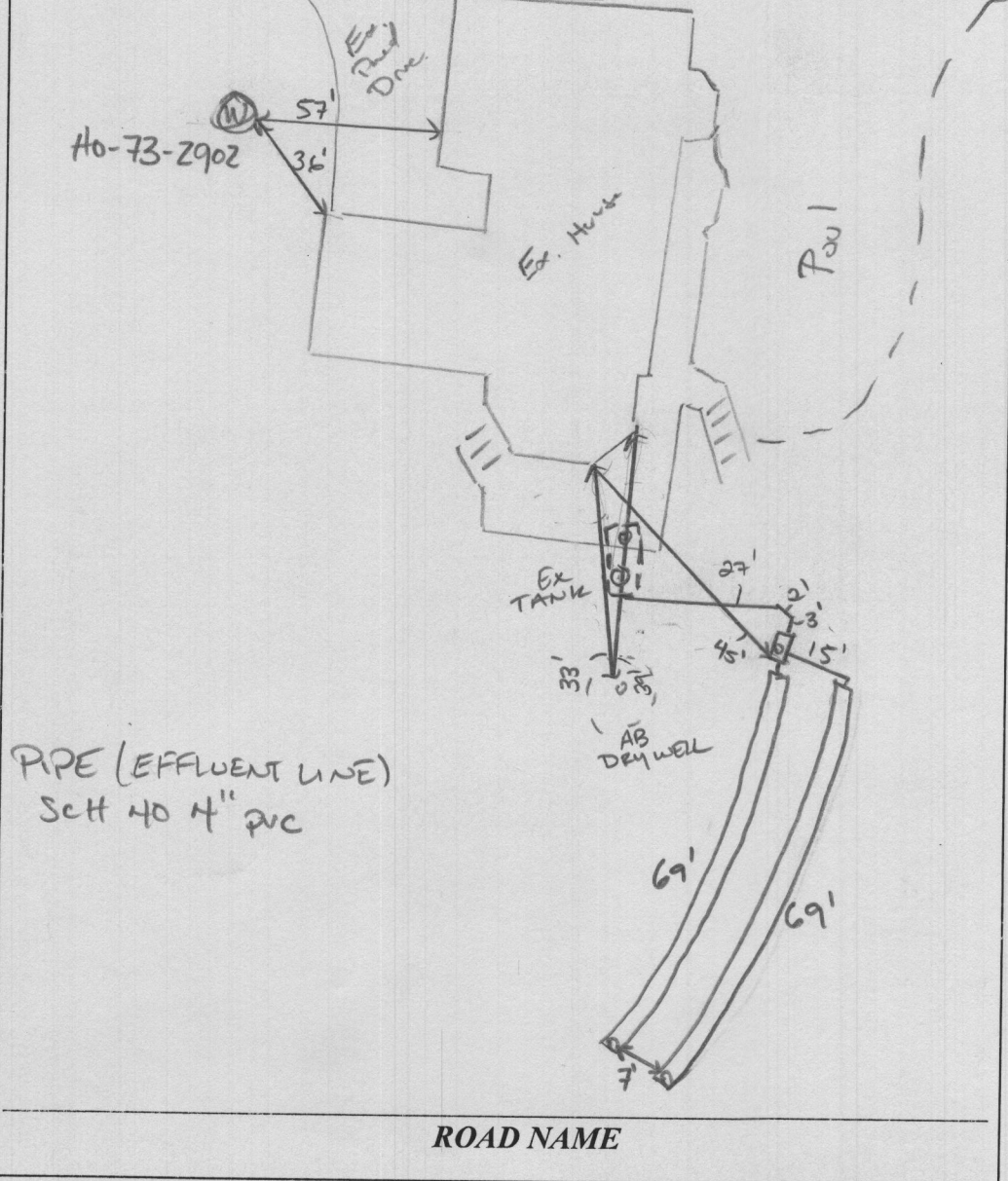

**TRENCH/DRAINFIELD DATA**

WIDTH	INLET	BOTTOM
3'	2.5'	5'
NUMBER OF TRENCHES		2
TOTAL LENGTH		138 F
ABSORPTION AREA		414 SF
DISTRIBUTION BOX LEVEL		SPEED
DISTRIBUTION BOX BAFFLE		YES
DISTRIBUTION BOX PORT		YES

**SEPTIC TANK DATA**

EXISTING (1978 MOVED 1998)

SEPTIC TANK I LEVEL \_\_\_\_\_

MANUFACTURER \_\_\_\_\_

CAPACITY 1000 GAL

SEAM LOC \_\_\_\_\_

TANK LID DEPTH ~3'-5' (EST)

BAFFLES \_\_\_\_\_

BAFFLE FILTER \_\_\_\_\_

MANHOLE LOC \_\_\_\_\_

6" PORT LOC \_\_\_\_\_

WATERTIGHT TEST \_\_\_\_\_

SLOTTED \_\_\_\_\_

DATE ON LID \_\_\_\_\_

PUMP/SEPTIC TANK LEVEL \_\_\_\_\_

MANUFACTURER \_\_\_\_\_

CAPACITY \_\_\_\_\_ GAL

SEAM LOC \_\_\_\_\_

TANK LID DEPTH \_\_\_\_\_

BAFFLES \_\_\_\_\_

BAFFLE FILTER \_\_\_\_\_

MANHOLE LOC \_\_\_\_\_

6" PORT LOC \_\_\_\_\_

WATERTIGHT TEST \_\_\_\_\_

SLOTTED \_\_\_\_\_

DATE ON LID \_\_\_\_\_

ROAD NAME

**PRE-CONSTRUCTION:**

3/12/19 Install 2x65' trenches on contour running out away from house on contour. Pump collapse ex. Dry well. (KAW)

4/3/19 owner called, may switch contractor (KAW)

**INSTALLATION:**

7/10/19 UPPER TRENCH DUG. SOIL LOOKED GREAT. 5000 g PUMPED OUT OF EX SEPTIC DRY WELL. 7/11/2019 TRENCHES COMPLETE OK TO BACKFILL. D BOX SET AND TIED INTO EX TANK AND NEW TRENCHES. D BOX LEVELED w/ SPEED LEVELS. OK TO COVER (+)

FINAL INSPECTOR

*Joseph Calabro*

DATE OF APPROVAL

07/11/2019



Bureau of Environmental Health  
 8930 Stanford Boulevard, Columbia, MD 21045  
 Main: 410-313-2640 | Fax: 410-313-2648  
 TDD 410-313-2323 | Toll Free 1-866-313-6300  
 www.hchealth.org  
 Facebook: www.facebook.com/hchohealth  
 Twitter: HowardCoHealthDep

Dr. Maura J. Rossman, M.D., Health Officer

**INFORMATION FORM - SEPTIC SYSTEM REPAIR/UPGRADE**

Reason for Request:

- Failing System
- System relocation for proposed addition
- System upgrade for proposed addition
- Inadequate treatment zone
- Collapsed septic tank
- Collapsed drywell

Has the septic tank been pumped within the last month?

- Yes Date pumped: 10/2018
- No

Was a visual inspection of the septic tank and/or drain fields conducted?

- Yes Explain observations: \_\_\_\_\_
- No

Was a visual inspection of the sewage line conducted?

- Yes
  - Blockage leading to the tank
    - Yes Explain: Dug up with mini & snaked line
    - No
  - Blockage leading to the field
    - Yes Explain: \_\_\_\_\_
    - No

Existing system design

- Drywell
- Trench
- Mound
- Unknown
- Other: \_\_\_\_\_

Is discharge surfacing on the ground?

- Yes
- No

Additional Comments: \_\_\_\_\_

\*For REPAIRS, are the owners proposing, or do they plan to add in the future, any additions or modifications to the property, i.e. pools, living space additions, garages, etc? This information must be disclosed at the time of this application. The Health Department will not be able to accommodate requests in the field for property modifications unrelated to the repair request. Such requests may require an additional fee, testing, and submittal of a Percolation Certification Plan, if the property does not meet current Code and Regulation.

Septic Contractor: Fogles Cyclic Clean Contractor's Phone: 410-795-5670  
 Contractor's Address: 580 Obrecht Rd 2184

Property Address: 9455 Ellsworth Ct County file: \_\_\_\_\_

Subdivision: \_\_\_\_\_ Lot: 18 Year Built: 1979

Owner's Name: William England Owner's Phone: 301-213-6234

Name of previous owners: Robert's Edwards Existing bedrooms: 5

Proposed bedrooms: \_\_\_\_\_

Has this request been previously discussed with a Sanitarian? (Name): \_\_\_\_\_

Public Sewer available/nearby: \_\_\_\_\_

\*A Sanitarian will be in contact within three business days, depending upon the urgency of the situation, to coordinate the scheduling/review of the repair or upgrade.

\*Prior to scheduling inspections, scaled plans should be submitted to clarify the nature of the addition.\*

Print out a copy of Real Property Data via Dept. of Taxation website \_\_\_\_\_ Indexed file found \_\_\_\_\_

If public sewer may be nearby, verify whether sewer is technically "available" through the Bureau of Engineering.

If sewer is available and the property is within the Metropolitan District, connection to sewer is required. If the owner believes reason for exemption exists, the owner should justify the request in writing.

If soil/site conditions are limited and sewer and/or Metro District status is not conducive to connection, the Sanitarian may recommend pursuit of Emergency Sewer Extension or Emergency Metro District Inclusion. The Owner should contact the Bureau of Utilities for details.

No permit is to be issued nor inspection to be scheduled without prior fee collection at the office unless an emergency situation exists. The contractor is to notify office of the emergency situation as soon as possible.



HOWARD COUNTY HEALTH DEPARTMENT

64774

DATE 3/19/19

Received From

Fogloss Septic Clean

PHONE #

PS 410 795-5670

CASH

CHECK

For

Perce/Repair 9455  
Ellsworth Ct

NO.

03121

Three hundred thirty

Dollars

\$

331(x)

Received By

King

RECEIVED  
MAR 04 2019  
HOWARD COUNTY HEALTH DEPT.  
FOOD PROTECTION PROGRAM