

RUB 6/7/19

Search Result for HOWARD COUNTY

View Map		View GroundRent Redemption				View GroundRent Registration				
Tax Exempt:		Special Tax Recapture:								
Exempt Class:		AGRICULTURAL TRANSFER TAX								
Account Identifier:		District - 04 Account Number - 317858								
Owner Information										
Owner Name:		HERRON EDWARD LEE JR HERRON THERESA W			Use:		AGRICULTURAL			
Mailing Address:		15094 FREDERICK RD WOODBINE MD 21797-8608			Principal Residence:		YES			
					Deed Reference:		/17398/ 00118			
Location & Structure Information										
Premises Address:		15094 FREDERICK RD WOODBINE 21797-0000			Legal Description:		PAR A 43.1827 A PRES 15094 FREDERICK RD R/W THE WOODS @ RIDGEVIEW			
Map:	Grid:	Parcel:	Sub District:	Subdivision:	Section:	Block:	Lot:	Assessment Year:	Plat No:	13954
0008	0015	0386		0000			PAR A	2017	Plat Ref:	
Special Tax Areas:				Town:		NONE				
				Ad Valorem:		100				
				Tax Class:						
Primary Structure Built		Above Grade Living Area		Finished Basement Area		Property Land Area		County Use		
2000		3,089 SF				43.1800 AC				
Stories	Basement	Type	Exterior	Full/Half Bath	Garage	Last Major Renovation				
1 1/2	YES	STANDARD UNIT	SIDING	3 full/ 1 half	2Att/1Det					
Value Information										
		Base Value		Value		Phase-in Assessments				
				As of		As of		As of		
				01/01/2017		07/01/2018		07/01/2019		
Land:		214,400		194,400						
Improvements		456,400		480,900						
Total:		670,800		675,300		673,800		675,300		
Preferential Land:		14,400						14,400		
Transfer Information										
Seller: SCHEUCH STEPHEN W				Date: 01/20/2017		Price: \$800,000				
Type: NON-ARMS LENGTH OTHER				Deed1: /17398/ 00118		Deed2:				
Seller: SCHEUCH STEPHEN W				Date: 03/24/2005		Price: \$0				
Type: NON-ARMS LENGTH OTHER				Deed1: /00000/ 00000		Deed2:				
Seller: RIDGE VIEW L L C				Date: 10/14/1999		Price: \$370,000				
Type: NON-ARMS LENGTH OTHER				Deed1: /04911/ 00321		Deed2:				
Exemption Information										
Partial Exempt Assessments:		Class		07/01/2018		07/01/2019				
County:		000		0.00						
State:		000		0.00						
Municipal:		000		0.00 0.00		0.00 0.00				
Tax Exempt:		Special Tax Recapture:								
Exempt Class:		AGRICULTURAL TRANSFER TAX								
Homestead Application Information										
Homestead Application Status: Approved 09/20/2017										
Homeowners' Tax Credit Application Information										

1. This screen allows you to search the Real Property database and display property records.
2. Click [here](#) for a glossary of terms.
3. Deleted accounts can only be selected by Property Account Identifier.
4. The following pages are for information purpose only. The data is not to be used for legal reports or documents. While we have confidence in the accuracy of these records, the Department makes no warranties, expressed or implied, regarding the information.



DAEDALEAN, Incorporated
 18110 FREDERICK ROAD,
 WOODBINE, MD. 21797
 (301) 442-1100 (202) 924-4800

LETTER OF TRANSMITTAL

DATE 1 October 87	JOB NO
ATTENTION Mr. Eric Dougherty	
RE Maryland Groundwater Pollution Control and Prevention System	

TO State Department of the Environment
Waste Management Administration
201 West Preston Street
Baltimore, Md. 21201

GENTLEMEN:

WE ARE SENDING YOU Attached Under separate cover via _____ the following items:

- Shop drawings Prints Plans Samples Specifications
 Copy of letter Change order Applications

COPIES	DATE	NO.	DESCRIPTION
1	1 Oct 87		Application for Star/Butler common septic system
1	1 Oct 87		Application for Graphic Arts Facility septic system

THESE ARE TRANSMITTED as checked below:

- For approval Approved as submitted Resubmit _____ copies for approval
 For your use Approved as noted Submit _____ copies for distribution
 As requested Returned for corrections Return _____ corrected prints
 For review and comment _____
 FOR BIDS DUE _____ 19 _____ PRINTS RETURNED AFTER LOAN TO US

REMARKS These applications are being filed per Mr. Michael J. Caughlin's (Acting Director,
Howard County Technical Services Program) letter to David S. Slick (Daedalean, Inc.)
dated 28 September 87.

COPY TO Caughlin (Acting Director, Howard Co. Tech. Services Program)
Craig Williams (Howard Co. Bureau of Environmental Health)
Simmons (DAI)

SIGNED: David S. Slick

MARYLAND GROUNDWATER POLLUTION CONTROL AND PREVENTION SYSTEM

APPLICATION FOR PERMIT TO DISCHARGE* TO UNDERGROUND WATERS AND FOR APPROVAL OF PLANS AND SPECIFICATIONS FOR A FACILITY WHICH MAY DISCHARGE

LOCATION: (name and address of facility producing discharge or potential discharge)

NAME Daedalean, Inc.

ADDRESS 15110 Frederick Road

COUNTY/CITY Howard / Woodbine Maryland ZIP CODE 21797

*Include a copy of a U.S.G.S. 7.5 minute quadrangle map showing the exact location of discharge or facility.

TYPE OF DISCHARGE OR FACILITY (check all appropriate boxes)

DISCHARGES (DISCHARGE PERMIT REQUIRED)

- LAND APPLICATION OF WASTEWATER
- IRRIGATION (spray or other) OVERLAND FLOW INFILTRATION-PERCOLATION BASIN
- OTHER, DESCRIBE Standard dry well septic system
- UNDERGROUND WASTE INJECTION WELLS
- RECHARGE WELLS
- SUB-SURFACE SOIL ABSORPTION SYSTEM (drainfield, seepage pit, etc.; industrial only)
- LANDFILLS
- LANDFILLS FOR INDUSTRIAL WASTES AND SLUDGES
- LANDFILLS FOR MUNICIPAL WASTEWATER TREATMENT PLANT SLUDGES
- SANITARY LANDFILLS FOR MUNICIPAL AND COMMERCIAL WASTES
- OTHER, DESCRIBE _____

FACILITIES WHICH MAY DISCHARGE (APPROVAL OF PLANS AND SPECIFICATIONS REQUIRED)

- HOLDING PONDS AND LAGOONS FOR CHEMICALS, WASTES OR OTHER MATERIALS
- WASTEPILES AND STOCKPILES
- STRIP MINE SPOILPILES CHEMICAL STOCKPILES SALT STOCKPILES
- OTHER, DESCRIBE Star/Butler Building common septic system

NATURE OF WASTE, WASTEWATER, OR POTENTIAL POLLUTANT (check all appropriate boxes)

- SANITARY INDUSTRIAL COOLING WATER
- SOLID WASTES SLUDGES LIQUID WASTES
- DESCRIBE Routine septage; provisions are made to segregate any other wastes prior to effluent entering septic system.

QUANTITY OF WASTE, WASTEWATER, OR POTENTIAL POLLUTANT

- LIQUIDS: AVG. GAL/DAY 300 MAX. GAL/DAY 500
- SOLIDS OR SLUDGES: AVG. TONS/DAY _____ MAX. TONS/DAY _____
- PERIOD OF DISCHARGE OR OPERATION OF FACILITY:
FROM 7:30 A.M. TO 5:00 P.M.

(See Reverse Side)

DISCHARGES TO PLACES OTHER THAN GROUNDWATER

Not Applicable

 SURFACE WATERS, NAME OF RECEIVING WATER _____ MUNICIPAL SEWER SYSTEM OTHER _____

SOURCE OF WATER SUPPLY

 GROUNDWATER (wells) PUBLIC WATER SUPPLY, NAME _____ SURFACE WATER NO WATER USED IN OPEATION

OTHER ADMINISTRATION PERMITS APPLIED FOR

 NO YES, KIND OF PERMIT _____

APPLICANT

NAME Daedalean, Inc.ADDRESS 15110 Frederick RoadCOUNTY/CITY Howard / Woodbine, Md. ZIP CODE 21797 PHONE (301) 442-1100

OWNER

(If different from above)

NAME Same as above

ADDRESS _____

COUNTY/CITY _____ ZIP CODE _____ PHONE _____

OPERATOR

(if different from above)

NAME Same as above

ADDRESS _____

COUNTY/CITY _____ ZIP CODE _____ PHONE _____

SIGNATURE OF APPLICANT OR AGENT

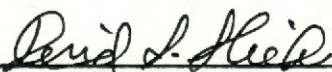
SIGNATURE David S. Slick1 October 87

DATE

NOTICE: UPON RECEIPT, THE WASTE MANAGEMENT ADMINISTRATION WILL EVALUATE THIS APPLICATION AND NOTIFY THE APPLICANT OF REQUIREMENTS, IF ANY, FOR ADDITIONAL INFORMATION AND WHETHER OR NOT A DISCHARGE PERMIT WILL BE REQUIRED FOR A FACILITY WHICH MAY DISCHARGE.

*Section 8-1413 of the Natural Resources Article requires that a permit be obtained to discharge any pollutant into surface or underground waters of the State. "Discharge" means the addition, introduction, leaking, spilling, or emitting any pollutant to State waters or the placing of any pollutant in a location where it is likely to pollute.

SEND TO:

WASTE MANAGEMENT ADMINISTRATION
DEPARTMENT OF THE ENVIRONMENT
201 WEST PRESTON STREET
BALTIMORE, MARYLAND 21201

If there are any questions, telephone (301) 225-5659

MARYLAND GROUNDWATER POLLUTION CONTROL AND PREVENTION SYSTEM

APPLICATION FOR PERMIT TO DISCHARGE* TO UNDERGROUND WATERS AND FOR APPROVAL OF PLANS AND SPECIFICATIONS FOR A FACILITY WHICH MAY DISCHARGE

LOCATION: (name and address of facility producing discharge or potential discharge)

NAME Daedalean, Inc.

ADDRESS 15110 Frederick Road

COUNTY/CITY Howard / Woodbine Maryland ZIP CODE 21797

*Include a copy of a U.S.G.S. 7.5 minute quadrangle map showing the exact location of discharge or facility.

TYPE OF DISCHARGE OR FACILITY (check all appropriate boxes)

DISCHARGES
(DISCHARGE PERMIT REQUIRED)

LAND APPLICATION OF WASTEWATER
 IRRIGATION (spray or other) OVERLAND FLOW INFILTRATION-PERCOLATION BASIN
 OTHER, DESCRIBE Standard deep trench septic system

UNDERGROUND WASTE INJECTION WELLS

RECHARGE WELLS

SUB-SURFACE SOIL ABSORPTION SYSTEM (drainfield, seepage pit, etc.; industrial only)

LANDFILLS
 LANDFILLS FOR INDUSTRIAL WASTES AND SLUDGES
 LANDFILLS FOR MUNICIPAL WASTEWATER TREATMENT PLANT SLUDGES
 SANITARY LANDFILLS FOR MUNICIPAL AND COMMERCIAL WASTES
 OTHER, DESCRIBE _____

FACILITIES WHICH MAY DISCHARGE
(APPROVAL OF PLANS AND SPECIFICATIONS REQUIRED)

HOLDING PONDS AND LAGOONS FOR CHEMICALS, WASTES OR OTHER MATERIALS

WASTEPILES AND STOCKPILES
 STRIP MINE SPOILPILES CHEMICAL STOCKPILES SALT STOCKPILES
 OTHER, DESCRIBE Graphic Arts Facility septic system

NATURE OF WASTE, WASTEWATER, OR POTENTIAL POLLUTANT (check all appropriate boxes)

SANITARY INDUSTRIAL COOLING WATER
 SOLID WASTES SLUDGES LIQUID WASTES
 DESCRIBE Routine septage; provisions are made to segregate any other wastes prior to effluent entering septic system.

QUANTITY OF WASTE, WASTEWATER, OR POTENTIAL POLLUTANT

LIQUIDS: AVG. GAL/DAY 200 MAX. GAL/DAY 300
 SOLIDS OR SLUDGES: AVG. TONS/DAY _____ MAX. TONS/DAY _____

PERIOD OF DISCHARGE OR OPERATION OF FACILITY:
 FROM 7:30 A.M. TO 4:00 P.M.

DISCHARGES TO PLACES OTHER THAN GROUNDWATER

Not Applicable

 SURFACE WATERS, NAME OF RECEIVING WATER _____ MUNICIPAL SEWER SYSTEM OTHER _____

SOURCE OF WATER SUPPLY

 GROUNDWATER (wells) PUBLIC WATER SUPPLY, NAME _____ SURFACE WATER NO WATER USED IN OPERATION

OTHER ADMINISTRATION PERMITS APPLIED FOR

 NO YES, KIND OF PERMIT _____

APPLICANT

NAME Daedalean, Inc.ADDRESS 15110 Frederick RoadCOUNTY/CITY Howard / Woodbine, Md. ZIP CODE 21797 PHONE (301) 442-1100

OWNER (If different from above)

NAME Same as above

ADDRESS _____

COUNTY/CITY _____ ZIP CODE _____ PHONE _____

OPERATOR (if different from above)

NAME Same as above

ADDRESS _____

COUNTY/CITY _____ ZIP CODE _____ PHONE _____

SIGNATURE OF APPLICANT OR AGENT

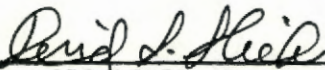
SIGNATURE David S. Slick1 October 87

DATE

NOTICE: UPON RECEIPT, THE WASTE MANAGEMENT ADMINISTRATION WILL EVALUATE THIS APPLICATION AND NOTIFY THE APPLICANT OF REQUIREMENTS, IF ANY, FOR ADDITIONAL INFORMATION AND WHETHER OR NOT A DISCHARGE PERMIT WILL BE REQUIRED FOR A FACILITY WHICH MAY DISCHARGE.

*Section 8-1413 of the Natural Resources Article requires that a permit be obtained to discharge any pollutant into surface or underground waters of the State. "Discharge" means the addition, introduction, leaking, spilling, or emitting any pollutant to State waters or the placing of any pollutant in a location where it is likely to pollute.

SEND TO:

WASTE MANAGEMENT ADMINISTRATION
DEPARTMENT OF THE ENVIRONMENT
201 WEST PRESTON STREET
BALTIMORE, MARYLAND 21201

If there are any questions, telephone (301) 225-5659

Howard County Health Department

To: _____

DADALGAN

PROPOSAL MUST
BE CHANGED TO
HOLDING TANK

PENC FAILED.

~~WHO~~
WHO REVISES APPLICATION?
WHO SHOULD BE NOTIFIED?

From: Craig _____

Date: 10/9/87 _____

HD-170

Mr. Edward Ball, Jr.
Daedalean Associates, Inc.
Re: Two Story Office Building
Springlake Research Center
Permit Serial #41776 (Amendment)
SDP 79-162

December 1, 1980
Page 2

If I can be of further assistance, please do not hesitate to contact me at 992-2436.

Very truly yours,

David W. Krebs, Chief
Plan Review Division

DWK/k

cc: George Martin
Building Inspector
Mechanical Inspector
Electrical Inspector
William Gottschalk
Health Department
John Riddle
William Knight

RECEIVED
ENVIRONMENTAL
DIVISION OF

DEC 5 4 54 PM '80

HEALTH
DIVISION

Health Dept

December 1, 1980

Mr. Edward Ball, Jr.
Daedalean Associates, Inc.
Springlake Research Center
15110 Frederick Road
Woodbine, MD 21797

RECEIVED
HOWARD COUNTY
HEALTH DEPT.
ELICOTT CITY, MD.
DEC 3 3 10 AM '80

Dear Mr. Ball:

Subject: Daedalean Associates, Inc.
Two Story Office Building
Springlake Research Center
15110 Frederick Road, Woodbine, Md.
Permit Serial #41776 (Amendment)
SDP 79-162

The revised plans dated November 12, 1980 and accompanying letter requesting amendment to the above referenced building permit have been reviewed by this Bureau and the following comments are noted.

1. The change in structural floor system from steel bar joist to wood frame is acceptable.
2. It is understood that the improvements to the second level will not be made at this time. When work on that level is planned, an additional building permit will be acquired.
3. A temporary occupancy permit can be granted for the first floor only once the following inspections have been approved:
 - a. Fire protection
 - b. Plumbing
 - c. Electrical
 - d. Health Department
 - e. Building
 - f. Sediment control
 - g. Site design

For information on the process for requesting and receiving the temporary occupancy permit, please contact Ms. Cathy Hideoy or Mr. George Martin at 992-2455.

9016

APPLICATION

PERMIT APPLICATION

DEPARTMENT OF PUBLIC WORKS
BUREAU OF INSPECTIONS LICENSES & PERMITS
3430 COURT HOUSE DRIVE, ELLICOTT CITY, MARYLAND 21043

BUILDING ADDRESS (HOUSE NO., STREET, TOWN OR AREA)

15110 Inglewood Rd.
Woodbine 21793

GRADING/SEDIMENT CONTROL YES NO

SDP #

DESCRIPTION OF WORK AUTHORIZED

Removing underground
gas storage tank

LOT NO.	PARCEL NO.	SEC.	AREA	BLOCK NO.	LIBER	FOLIO
	2					
SUB DIVISION		ZONE	ZONE MAP	ELEC. DIST.	CENSUS TR.	
		R	7	4	6046	

OWNER'S NAME AND ADDRESS
Dardalean Inc

PHONE NO.
442-1100

OCCUPANT'S NAME AND ADDRESS

PHONE NO.

ARCHITECT OR ENGINEER'S NAME AND ADDRESS

PHONE NO.

CONTRACTOR'S NAME AND ADDRESS

Allen's Barkhol

PHONE NO.

SIZE OF BLDG.	FRONT	DEPTH	HEIGHT

TYPE OF BLDG.	AREA	VOLUME	ROOF
B. ROOMS			
ROOMS			
BATHS			
FIREPLACES			

FOOTINGS	FOUNDATION	S. WALLS

UTILITIES				
WATER/WELL	SEWER/SEPTIC	GAS	ELECTRICITY	TYPE OF HEAT
				AC

I have carefully examined and read this application and know the same is true and correct, and that in doing this work, all provisions of Howard County Ordinances and the State Laws of Maryland will be complied with, whether specified or not; and I will notify the Bureau of Inspections, and Permits twenty-four hours in advance when I am ready for the inspections called for elsewhere in this application; and that no work will be covered up until such inspections have been complied with.

SIGNATURE
TITLE DATE

EXISTING USE	PROPOSED USE	
EST. CONSTRUCTION COST	LICENSE NUMBER	PERMIT FEE

FOR OFFICE USE ONLY

W/S CODE
DISTANCE IN FEET FROM R/W LINE TO FRONT BUILDING LINE
SIDE YARD
(DISTANCE IN FEET FROM SIDE BLDG. LINE TO SIDE PROPERTY LINE)
DISTANCE IN FEET FROM SIDE STREET R/W LINE
TO SIDE BUILDING LINE
DISTANCE IN FEET, REAR YD. REQUIRING SET
BACK (CORNER LOT ONLY)
CONDITIONS (IF ANY) SDP #

FUNCTION	DATE	SIGNATURE APPROVAL
ZONING/PLANNING		
SHA		
SEDIMENT/GRADING		
BUILDING OFFICIAL		
WATER & SEWER		
HEALTH DEPT.	X 11/12/86	[Signature]
FIRE PROTECTION		
STORM WATER MGM.		

Checks payable to DIRECTOR OF FINANCE OF HOWARD COUNTY
CAUTION
To begin construction before a permit placard has been issued and displayed on the job is a violation of the law.
Use and occupancy permit must be applied for two weeks before it will be issued.

APPROVED DATE
Distribution of Copies:
White - Building Official
Yellow - Engineering
Pink - Health Dept.
Gold - S.H.A.

IMPORTANT: PLEASE SHOW ZIP CODES AND AREA CODES WHEREVER REQUIRED.

2943

SEQUENCE NO. (WRA USE ONLY)

STATE OF MARYLAND

W.A. PERMIT NUMBER

WATER RESOURCES ADMINISTRATION
TAXES STATE OFFICE BLDG., ANNAPOLIS, MARYLAND 21401
APPLICATION FOR PERMIT TO DRILL WELL

FILL IN THIS FORM COMPLETELY

1 2 3 (SEQ. NO.) 5
(THIS NUMBER IS TO BE PUNCHED IN COLUMNS 3-6 ON ALL CARDS)

DATE RECEIVED (WRA USE ONLY)
3/28/79
1:30 P.M.

OWNER HOCHFEIN Ambrose A Jr.
COL 15 LAST NAME FIRST NAME
STREET OR RFD 15110 Frederick Rd.
COL 36
POST OFFICE Woodhine Md. 21797
COL 87

DRILLER INFORMATION
1 2 3 (SEQ. NO.) 6
DATE 3/23/79 LICENSE NUMBER 308
77 80
Stanley W. Bollinger Jr.
FIRST NAME DRILLER LAST NAME
SIGNATURE Stanley W. Bollinger Jr.

LOCATION OF WELL
1 2 3 (SEQ. NO.) 6
COUNTY Howard
8 (DO NOT ABBREVIATE COUNTY NAME)
SUBDIVISION _____
23
SECTION _____ LOT _____
44 48 48
NEAREST TOWN Cooksville
52
MILES FROM TOWN (ENTER 0 IF IN TOWN) 1
73

WELL INFORMATION
1 2 3 (SEQ. NO.) 6
MAXIMUM PUMPING RATE (GALLONS PER MINUTE) 5
8 12
AVERAGE DAILY QUANTITY NEEDED (GALLONS PER DAY) 500
16 20

DIRECTION FROM TOWN
(CIRCLE APPROPRIATE BOX)
1 2 3 (SEQ. NO.) 6
N NORTH E EAST NE NORTHEAST SE SOUTHEAST
S SOUTH W WEST NW NORTHWEST SW SOUTHWEST
8 8 8 8
NEAR WHAT ROAD Md. 144
11 NORTH SOUTH EAST WEST 30
ON WHICH SIDE OF ROAD (CIRCLE APPROPRIATE BOX) (N) (S) (E) (W) 32
DISTANCE FROM ROAD (ENTER DISTANCE AND CIRCLE APPROPRIATE BOX) 4.00
34

USE FOR WATER (CIRCLE APPROPRIATE BOX)
 HOME (SINGLE OR DOUBLE HOUSEHOLD UNIT ONLY)
 FARMING, AGRICULTURE, IRRIGATION
 INDUSTRIAL, COMMERCIAL, STATE AND FEDERAL GOVERNMENT.
 MUNICIPAL WATER SUPPLY } MUST HAVE STATE HEALTH DEPT. APPROVAL
 PRIVATE WATER COMPANY }
 TEST

APPROXIMATE DEPTH OF WELL 200 FEET
24 28
APPROXIMATE DIAMETER OF WELL 6 (NEAREST INCH)

METHOD OF DRILLING USED (CIRCLE APPROPRIATE METHOD)
BORED (OR AUGERED) JETTED DRIVEN
30-37 AIR-ROTARY AIR-PERCUSSION ROTARY (HYDRAULIC ROTARY)
CABLE REVERSE-ROTARY DRIVE-POINT
OTHER (DESCRIBE) _____

REPLACEMENT OR DEEPEINED WELLS (CIRCLE APPROPRIATE BOX)
 THIS WELL WILL NOT REPLACE AN EXISTING WELL
 THIS WELL WILL REPLACE A WELL THAT WILL BE ABANDONED AND SEALED
 THIS WELL WILL REPLACE A WELL THAT WILL BE USED AS A STANDBY
 THIS WELL WILL DEEPEIN AN EXISTING WELL PERMIT NUMBER OF WELL TO BE REPLACED OR DEEPEINED (IF AVAILABLE) _____
41 62

NOT TO BE FILLED IN BY DRILLER (WRA USE ONLY)
APPROPRIATION PERMIT NUMBER _____ ENGINEER REVIEW DISTRICT NO. _____
54 65
FORCE _____ WRITE INITIALS IN BOX _____ CONDITIONS _____
67 68 70 71 72 73 74 75 76 77 78 79

HEALTH DEPARTMENT APPROVAL
1 2 3 (SEQ. NO.) 6
41 S STATE HEALTH (CIRCLE BOX) COUNTY NAME Howard COUNTY NO. W29614
MO. DAY YR. 032379
DATE APPROVED BY Donald W. Monaghan
43 48 Sanitarian

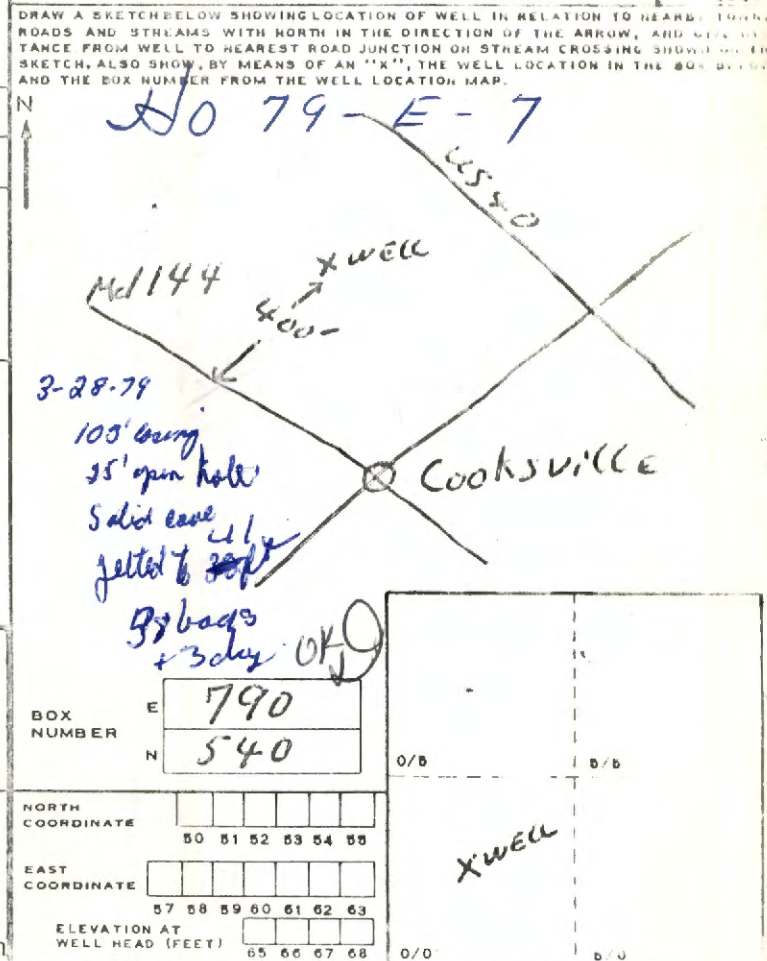

SPECIAL CONDITIONS 8-03 (WRA USE ONLY)

Mr. Henderson issued well permit no. after original request had been denied by...

FILE Emergency Well Imp. DATE REPORTED 3/22/79

PROPERTY OWNER Maedalen Association

P.O. ADDRESS 15110 Frederick Road TELEPHONE 442-2620 or 2621

DIRECTIONS TO PROPERTY Woodbine, Md. Ron Hudson

Spring Lake research assoc.

INFORMANT Small Cottage on this property behind new building that has been constructed.

Well Driller - Bollinger
Phone: 876-6952

CONDITION FOUND Summer cottage well at bottom of hill. 10' casing, cased in. People use cottage into Library 8 hrs./day. Not a residence. Long way to other facilities. Tried Feaser. Sometimes ~~is~~ used by executives for weekends. ~~2 weeks~~ problem = water has dirt + clogs plumbing + toilets don't work. No H₂O for 2 weeks. "J.B." gave me this info. on phone. RB 3/23/79

ACTION TAKEN 5 people work on the cottage. It is at least 1500 ft down a steep, wooded hill to a shop where there is a bathroom. There is a privy at the cottage, but the seat needs to be replaced and it has no ventilation at all. It would be very impractical to move the people and equipment to other quarters temporarily and in fact there doesn't seem to be another place on the property to move them to. RB 3/23/79

FINAL DISPOSITION Discussed with O'Neill. OK for emergency permit. RB 3/23/79 12:14pm

2943

SEQUENCE NO. (WRA USE ONLY)

STATE OF MARYLAND WATER RESOURCES ADMINISTRATION TAWES STATE OFFICE BLDG., ANNAPOLIS, MARYLAND 21401 APPLICATION FOR PERMIT TO DRILL WELL

WRA PERMIT NUMBER

HO 73 3203

FILL IN THIS FORM COMPLETELY

DATE RECEIVED (WRA USE ONLY)

OWNER: Hochstein Ambrose A Jr. COL 15 LAST NAME FIRST NAME COL. 34 STREET OR RFD: 15110 Frederick Rd. COL 36 COL. 55 POST OFFICE: Woodbine Md. COL 57 COL. 76

B 1 CONTINUED DRILLER INFORMATION DATE: 3/23/79 LICENSE NUMBER: 308 DRILLER: Stanley W. Ballinger Jr.

B 3 LOCATION OF WELL COUNTY: Howard SUBDIVISION: 23 SECTION: 44 LOT: 46 NEAREST TOWN: Cooksville MILES FROM TOWN: 1

B 2 WELL INFORMATION MAXIMUM PUMPING RATE: 5 AVERAGE DAILY QUANTITY NEEDED: 500

B 4 DIRECTION FROM TOWN: W WEST DISTANCE FROM ROAD: 400

USE FOR WATER: D HOME (SINGLE OR DOUBLE HOUSEHOLD UNIT ONLY)

DRAW A SKETCH BELOW SHOWING LOCATION OF WELL IN RELATION TO NEARBY TOWNS, ROADS AND STREAMS WITH NORTH IN THE DIRECTION OF THE ARROW...

APPROXIMATE DEPTH OF WELL: 200 FEET

APPROXIMATE DIAMETER OF WELL: 6 (NEAREST INCH)

METHOD OF DRILLING USED: BORED (OR AUGERED) JETTED DRIVEN AIR-ROTARY AIR-PERCUSSION ROTARY (HYDRAULIC ROTARY) CABLE REVERSE-ROTARY DRIVE-POINT

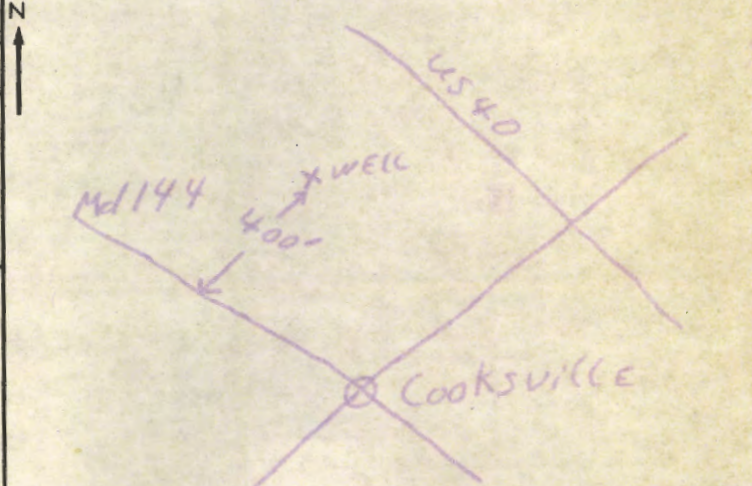

REPLACEMENT OR DEEPEINED WELLS: THIS WELL WILL REPLACE A WELL THAT WILL BE ABANDONED AND SEALED

NOT TO BE FILLED IN BY DRILLER (WRA USE ONLY) APPROPRIATION PERMIT NUMBER: 54 ENGINEER REVIEW DISTRICT NO. 63

BOX NUMBER: E 790 N 540 NORTH COORDINATE: 50 51 52 53 54 55 EAST COORDINATE: 57 58 59 60 61 62 63 ELEVATION AT WELL HEAD (FEET): 65 66 67 68

3 4 CONTINUED HEALTH DEPARTMENT APPROVAL STATE HEALTH COUNTY NAME: Howard COUNTY NO. 29614 APPROVED BY: Donald W. Monahan Sanitarian

5 SPECIAL CONDITIONS 8-63 (WRA USE ONLY)

B 1 **1660** SEQUENCE NO. (OEP USE ONLY)
 (THIS NUMBER IS TO BE PUNCHED IN COLS. 3-6 ON ALL CARDS)

STATE OF MARYLAND
 PERMIT TO DRILL WELL
 please print or type

OEP PERMIT NUMBER
40-81-1209
 fill in this form completely

Date Received **7/27/83**
 OWNER INFORMATION
 Last Name **DAEDALEAN** Owner First Name **INC**
 Street or RFD **15110 FREDERICK RD**
 Town **WOODBINE** State **MD** Zip **21792**

B 3 LOCATION OF WELL
 COUNTY **HOWARD**
 SUBDIVISION **MONS**
 SECTION **44** LOT **46**
 NEAREST TOWN **COOKSVILLE**
 MILES FROM TOWN (enter 0 if in town) **MI**

DRILLER INFORMATION
 Driller's Name **Ralph MAYWE** License No. **253**
 Firm Name **Ralph Maywe (well Drilling)**
 Address **9120 Brown Church Rd. Mt. Airy**
 Signature **Ralph Maywe** Date **10/14/85**

B 4 DIRECTION OF WELL FROM TOWN (CIRCLE BOX)

 NEAR WHAT ROAD **MD RT. 144**
 ON WHICH SIDE OF ROAD (CIRCLE APPROPRIATE BOX)
 DISTANCE FROM ROAD **1200** FT
 ENTER FT or MI **FT**

B 2 WELL INFORMATION
 APPROX. PUMPING RATE (GAL. PER MIN.) **5**
 AVERAGE DAILY QUANTITY NEEDED (GAL. PER DAY) **500**

USE FOR WATER (CIRCLE APPROPRIATE BOX)
 HOME (SINGLE OR DOUBLE HOUSEHOLD UNIT ONLY)
 FARMING (LIVESTOCK WATERING & AGRICULTURAL IRRIGATION)
 INDUSTRIAL, COMMERCIAL, STATE AND FEDERAL GOV. OTHER (REQUIRES APPROPRIATION PERMIT)
 PUBLIC OR PRIVATE WATER COMPANY (REQUIRES APPROPRIATION PERMIT AND STATE HEALTH DEPARTMENT APPROVAL)
 TEST, OBSERVATION, MONITORING (MAY REQUIRE APPROPRIATION PERMIT)

NOT TO BE FILLED IN BY DRILLER HEALTH DEPARTMENT APPROVAL
 COUNTY NAME **HOWARD** COUNTY NO. **A-26536**
 OEP SIGNATURE _____ STATE HEALTH INSERT S _____
 DATE ISSUED **4/2/86**
 CO SIGNATURE _____ EXP. DATE _____
 NORTH GRID **544000** EAST GRID **0789000**

APPROXIMATE DEPTH OF WELL **150** FEET

APPROXIMATE DIAMETER OF WELL **6"** NEAREST INCH

METHOD OF DRILLING (circle one)
 BORED (or Augered) JETTED Jetted & DRIVEN
 AIR-ROTary AIR-PERCussion ROTARY (Hydraulic Rotary)
 CABLE REVERSE-ROTary DRIVE-POINT
 other _____

REPLACEMENT OR DEEPEINED WELLS (CIRCLE APPROPRIATE BOX)
 THIS WELL WILL NOT REPLACE AN EXISTING WELL
 THIS WELL WILL REPLACE A WELL THAT WILL BE ABANDONED AND SEALED
 THIS WELL WILL REPLACE A WELL THAT WILL BE USED AS A STANDBY
 THIS WELL WILL DEEPEN AN EXISTING WELL
 PERMIT NUMBER OF WELL TO BE REPLACED OR DEEPEINED (IF AVAILABLE) _____

Not to be filled in by driller (OEP USE ONLY)
 APPROP. PERMIT NUMBER _____
 FORCE **54** WRITE INITIALS IN BOX PERMIT No. **40-81-1209**

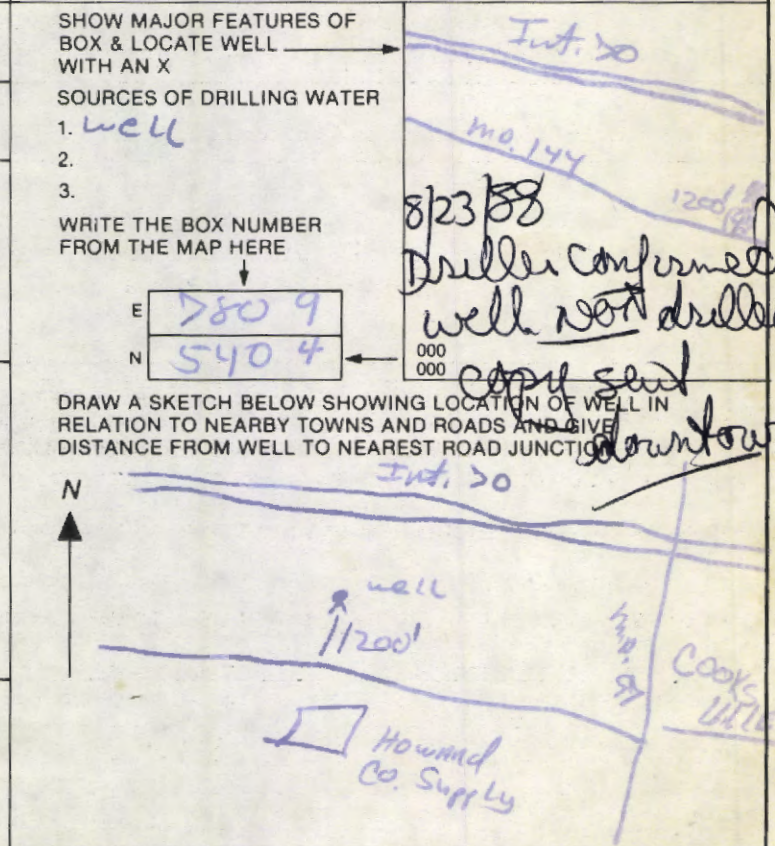

Well Site Inspection
Daedalus Estates
Office Complex Building
- Located in back of Pond

10/14/85

Well site OK in approx
area shown

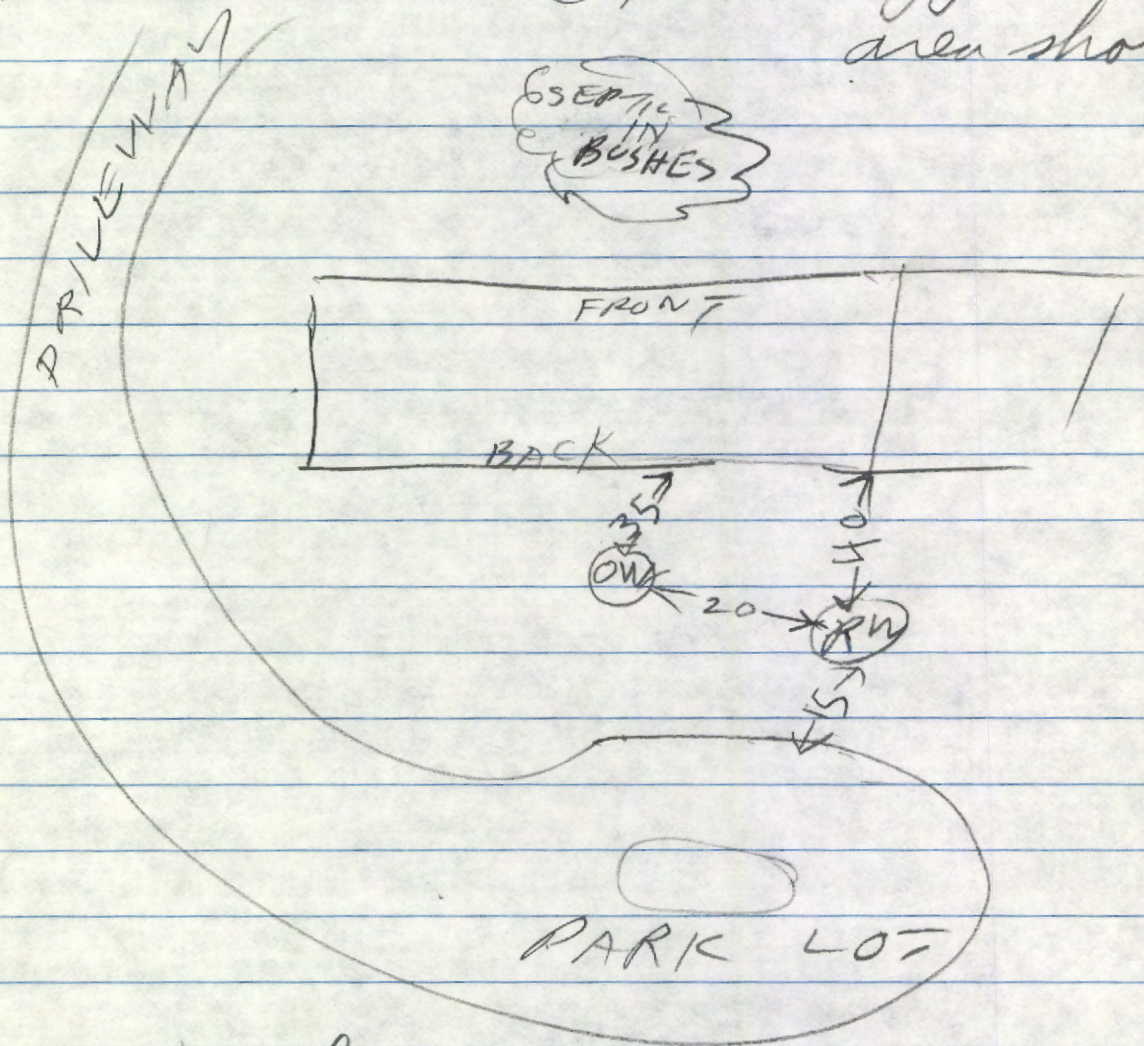

OW = Old Well
RW = Proposed Well
(Replacement)

R J Fudge

Appears to be well for admin. building
(office)

3/8/99 The Woods @ Ridgeview - Perc Cert

add testing
Record SBA on
lot 1
away from wells

Agricultural well

Lot 1 ~~Does not appear to have a well~~ HO 73 2788
Written Request to convert 3/17/99 OK

Lot 2 Only shows one well - there are two on the lot
HO-94-2169 & HO 94 1746 3-16-99 OK

Lot 3 ~~location of HO-94-1903~~ Additional testing
~~Does not show location of HO-94-1903~~ needed 3/17/99 OK

Parcel 1 SBA different from what is shown on the record plat - Additional testing 3-11-99 OK

Parcel 2 OK

Parcel 3 ~~Does not show the location of HO 94 1425~~ on new SBA
Well should be on the lot - no easements
OK - see letter from owner & developer 3/17/99

Parcel 4 Septic easement different than shown on approved building permit plan 3-11-99 OK

Parcel 5 OK

Parcel 6 OK

Parcel 7 OK

Parcel 8 OK

Parcel 9 Test hole locations E, F & G not shown in new SBA at front of lot 3-11-99 OK

RESOLVED
Signed

MARCH, 17, 1999

WE DANIEL DRENNER AND
(OWNER PARCEL #3)
DEVELOPER CHARLES SHARP

REQUEST APPROVAL OF OFFSITE
WELL FOR PARCEL 3 AT THE
WOODS OF RIDGEVIEW,

Daniel Drenner
Charles A Sharp

P. 32678 A Repair
DATE 7/22/83

LOCATION 15920 Frederick Road APPLICATION
HOLD APPROVED
REJECTED
LOT _____
APPLICANT _____
OWNER Michael Maruck INSTALLATION
HOLD APPROVED
PERMITTEE Fogle Septic Service APPROVED 4/22/83
DATE _____

HD - 11

P. 32635 A Repair
DATE 7/23/83

LOCATION 15271 Frederick Road APPLICATION
HOLD APPROVED
REJECTED
LOT _____
APPLICANT _____
OWNER Mr. Joseph Reeman INSTALLATION
HOLD APPROVED
PERMITTEE Fogle Septic Service APPROVED 4/23/83
DATE _____

HD - 11

P. 33280 A 33101
DATE November 3, 1983

LOCATION 14825 Frederick Road APPLICATION
HOLD APPROVED
REJECTED
LOT Tax Map & Parcel 82
APPLICANT William Hopkins INSTALLATION
HOLD APPROVED
OWNER Calvin + Grace Livesay APPROVED 12/21/83
PERMITTEE William Hopkins DATE _____

HD - 11

✓ P. 30498 A 26536
DATE 1/21/80

✓ LOCATION 15110 Frederick Road APPLICATION
HOLD APPROVED
REJECTED
LOT _____
APPLICANT Daedalus Assoc. INSTALLATION
HOLD APPROVED
OWNER Spring Lake Church Ctr. APPROVED 8/19/81
PERMITTEE Mid Maryland Mechanical DATE _____

HD - 11

P. 09541 A. 01874
 Date 1/4/65 11/4/59

Location Lt. 144
in front of Ho. Co. Supply

Lot _____

Applicant Marion Hasless

Owner _____

Permittee Earl Givens

Application
 Hold _____
 Approved
 Rejected _____

Installation
 Hold
 Approved

Approved Date 6/21/65

P. 21285 A. 20737
 DATE 3/31/75 9/26/74

LOCATION Route 144

LOT _____

APPLICANT Olen Ketterman

OWNER Joe W. Moyers

PERMITTEE Joseph Hartland, Inc.

APPLICATION
 HOLD _____
 APPROVED
 REJECTED _____

INSTALLATION
 HOLD _____
 APPROVED
 DATE 4/4/75

P. 03676 A. 03298
 Date 4/4/61 1-6-61

PERMITTEE William Warren

LOCATION Frederick Rd.
1/2 mi W. Rt 97

APPLICANT _____

OWNER C & P Telephone Co.

REMARKS (over)

APPLICATION
 Hold _____
 Approved
 Rejected _____

INSTALLATION
 Hold _____
 Approved 5/12/61

P. 16039 A. 15379
 DATE 6/2/71 7/14/70

LOCATION Lt. 144
between Co. & Lincoln

LOT _____

APPLICANT John L. Fletcher, Sr.

OWNER John L. Fletcher

PERMITTEE Harold Link

APPLICATION
 HOLD _____
 APPROVED
 REJECTED _____

INSTALLATION
 HOLD _____
 APPROVED
 DATE 6/2/71