



Bureau of Environmental Health

8930 Stanford Boulevard, Columbia, MD 21045

Main: 410-313-2640 | Fax: 410-313-2648

TDD 410-313-2323 | Toll Free 1-866-313-6300

www.hchealth.org

Facebook: www.facebook.com/hocohealth

Maura J. Rossman, M.D., Health Officer

RECEIPT DATE: 1/8/19 ONSITE SEWAGE DISPOSAL SYSTEM P 564711

APPROVAL DATE: 02/08/2019 PERMIT: REPAIR A

PROPERTY ADDRESS: 609 Gaither Road

SUBDIVISION: LOT: P/7 TAX ID: 03-282228

CONTRACTOR: Freedom Septic EMAIL:

CONTRACTOR ADDRESS: 2809 Liberty Road, Sykesville, MD 21784 PHONE: 410-795-2947

PROPERTY OWNER: Santiago Ortega EMAIL:

OWNER ADDRESS: 609 Gaither Road, Sykesville, MD 21784 PHONE: 443-878-2530

SEPTIC TANK SIZE (GALLONS): PUMP CHAMBER CAPACITY (GALLONS): PUMP SIZE:

NUMBER OF BEDROOMS: HOUSE SQ. FT. APPLICATION RATE:

DISTRIBUTION SYSTEM: GRAVITY FED [ ] LOW PRESSURE DOSED [ ]

Table with 2 columns: Field Name (TRENCHES, LOCATION, NOTES) and Field Value (N/A, TO BE STAKED BY SANITARIAN DURING PRE-CONSTRUCTION INSPECTION, Drywell collapsed. Trenches exposed. No sewage, water or biomat. Ok to fill in existing drywell and install 4' plumbing to existing trenches. Call for inspection.)

ISSUED BY: K. Wolf ISSUE DATE: 1/22/19 EXPIRATION DATE: 1/22/20

- NOTE: CONTRACTOR MUST SCHEDULE A PRE-CONSTRUCTION INSPECTION PRIOR TO BEGINNING ANY INSTALLATION
NOTE: CONTRACTOR MUST SCHEDULE AN INSPECTION AND GAIN APPROVAL OF ALL COMPONENTS PRIOR TO COVERING
NOTE: STONE MUST BE APPROVED BY HEALTH DEPARTMENT AND GRAVEL TICKET MUST BE AVAILABLE FOR REVIEW.
NOTE: WATERTIGHT SEPTIC TANKS REQUIRED
NOTE: ALL PARTS OF SEPTIC SYSTEM SHALL BE AT LEAST 100 FEET DOWNGRADIENT FROM ANY WATER WELL
NOTE: MANHOLE RISERS REQUIRED ON ALL SEPTIC TANKS AND PUMP CHAMBERS
NOTE: AN ELECTRICAL PERMIT IS REQUIRED FOR INSTALLATION OF ANY ELECTRICAL COMPONENTS OF THE SYSTEM
NOTE: THE HCHD DOES NOT WARRANTY ANY SYSTEM AND CANNOT GUARANTEE THE PERFORMANCE OF THIS SYSTEM AS DESIGNED.
NOTE: MDE RECOMMENDS SEPTIC TANKS, BAT, AND OTHER PRETREATMENT UNITS BE PUMPED AT A FREQUENCY ADEQUATE TO ENSURE THAT SOLIDS ARE NOT DISCHARGED TO THE DISPOSAL AREA

NEITHER THE HOWARD COUNTY COUNCIL NOR THE HEALTH DEPARTMENT IS RESPONSIBLE FOR THE SUCCESSFUL OPERATION OF ANY SYSTEM.

PERMITTEE RESPONSIBLE FOR OBTAINING FINAL APPROVAL ON THIS PERMIT.

CALL 410-313-1771 TO SCHEDULE INSPECTIONS.

NOT TO SCALE

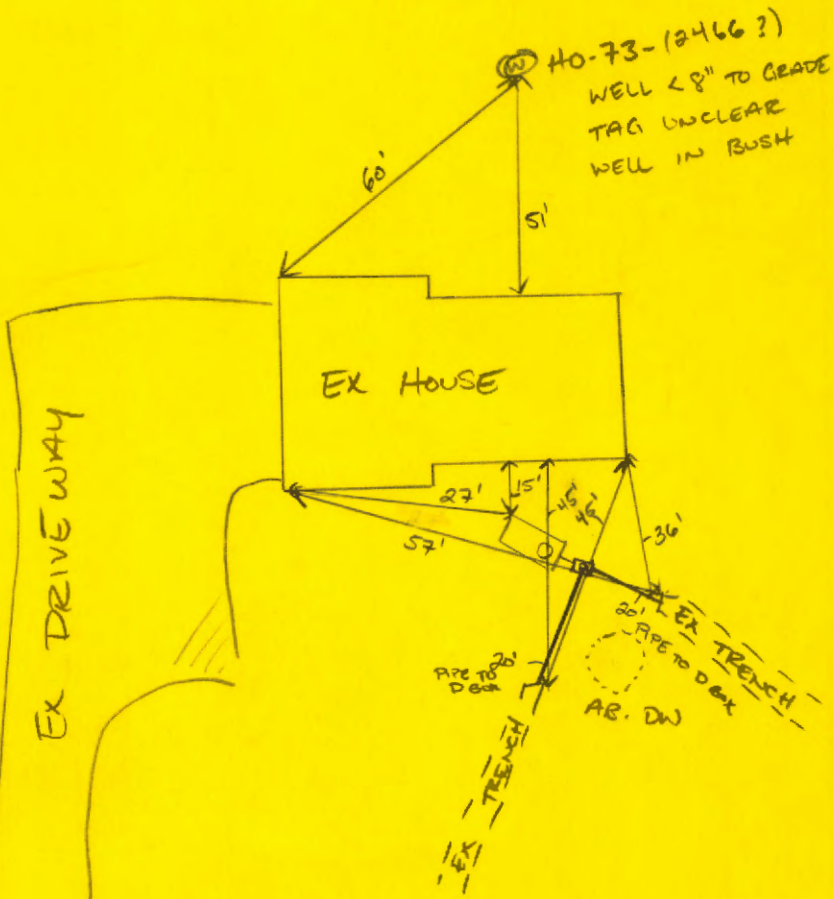

ROAD NAME  
GAITHER ROAD

**TRENCH/DRAINFIELD DATA**

WIDTH      INLET      BOTTOM

EXISTING

NUMBER OF TRENCHES \_\_\_\_\_

TOTAL LENGTH \_\_\_\_\_

ABSORPTION AREA \_\_\_\_\_

DISTRIBUTION BOX LEVEL YES

DISTRIBUTION BOX BAFFLE YES

DISTRIBUTION BOX PORT YES

**SEPTIC TANK DATA**

EXISTING

SEPTIC TANK I LEVEL \_\_\_\_\_

MANUFACTURER \_\_\_\_\_

CAPACITY \_\_\_\_\_ GAL

SEAM LOC \_\_\_\_\_

TANK LID DEPTH \_\_\_\_\_

BAFFLES OUTLET

BAFFLE FILTER \_\_\_\_\_

MANHOLE LOC \_\_\_\_\_

6" PORT LOC \_\_\_\_\_

WATERTIGHT TEST \_\_\_\_\_

SLOTTED \_\_\_\_\_

DATE ON LID \_\_\_\_\_

PUMP/SEPTIC TANK LEVEL \_\_\_\_\_

MANUFACTURER \_\_\_\_\_

CAPACITY \_\_\_\_\_ GAL

SEAM LOC \_\_\_\_\_

TANK LID DEPTH \_\_\_\_\_

BAFFLES \_\_\_\_\_

BAFFLE FILTER \_\_\_\_\_

MANHOLE LOC \_\_\_\_\_

6" PORT LOC \_\_\_\_\_

WATERTIGHT TEST \_\_\_\_\_

SLOTTED \_\_\_\_\_

DATE ON LID \_\_\_\_\_

PRE-CONSTRUCTION:

1/22/2019 PHONE CALL - KMW SEE INQUIRY NOTES

INSTALLATION: 2/8/2019 EX DW FILLED. TRENCHES CONNECTED TO EX TANK VIA NEW D. BOX. D BOX SET W/ SPEED LEVELS. ORANGEBERG PIPE FROM TANK OUTLET REPLACED W/ NEW 4" SCH 40 PVC. (L)

FINAL INSPECTOR

DATE OF APPROVAL

02/08/2019

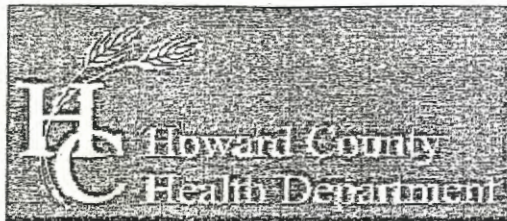

Bureau of Environmental Health

8930 Stanford Boulevard, Columbia, MD 21045
Main: 410-313-2640 | Fax: 410-313-2648
TDD 410-313-2323 | Toll Free 1-866-313-6300
www.hchealth.org
Facebook: www.facebook.com/hocohealth
Twitter: HowardCoHealthDep

Dr. Maura J. Rossman, M.D., Health Officer

INFORMATION FORM - SEPTIC SYSTEM REPAIR/UPGRADE

Reason for Request:

- Failing System
System relocation for proposed addition
System upgrade for proposed addition
Inadequate treatment zone
Collapsed septic tank
Collapsed drywell

Has the septic tank been pumped within the last month?

- Yes Date pumped:
No

Was a visual inspection of the septic tank and/or drain fields conducted?

- Yes Explain observations:
No

Was a visual inspection of the sewage line conducted?

- Yes
Blockage leading to the tank
Yes Explain:
No
Blockage leading to the field
Yes Explain:
No

Existing system design

- Drywell
Trench
Mound
Unknown
Other:

Is discharge surfacing on the ground?

- Yes
No

Additional Comments:

\*For REPAIRS, are the owners proposing, or do they plan to add in the future, any additions or modifications to the property, i.e. pools, living space additions, garages, etc? This information must be disclosed at the time of this application. The Health Department will not be able to accommodate requests in the field for property modifications unrelated to the repair request. Such requests may require an additional fee, testing, and submittal of a Percolation Certification Plan, if the property does not meet current Code and Regulation.

Septic Contractor: Freedom Septic Contractor's Phone: 410-984-6863
Contractor's Address: 2309 Liberty Rd Sykesville, MD 21784

Property Address: 609 GATHER ROAD County file:
Subdivision: Sykesville Lot: 7 Year Built: 1974
Owner's Name: Santiago + Michelle Ortega Owner's Phone: 443-875-2530

Name of previous owners: Thomas Glinka Existing bedrooms: 4
Proposed bedrooms: 4

Has this request been previously discussed with a Sanitarian? (Name):
Public Sewer available/nearby:

\*A Sanitarian will be in contact within three business days, depending upon the urgency of the situation, to coordinate the scheduling/review of the repair or upgrade.

\*Prior to scheduling inspections, scaled plans should be submitted to clarify the nature of the addition.\*

Print out a copy of Real Property Data via Dept. of Taxation website Indexed file found

If public sewer may be nearby, verify whether sewer is technically "available" through the Bureau of Engineering.

If sewer is available and the property is within the Metropolitan District, connection to sewer is required: If the owner believes reason for exemption exists, the owner should justify the request in writing.

If soil/site conditions are limited and sewer and/or Metro District status is not conducive to connection, the Sanitarian may recommend pursuit of Emergency Sewer Extension or Emergency Metro District Inclusion. The Owner should contact the Bureau of Utilities for details.

No permit is to be issued nor inspection to be scheduled without prior fee collection at the office unless an emergency situation exists. The contractor is to notify office of the emergency situation as soon as possible.

