

12-27-96  
11:00 & later C.O.  
12-30-96  
11:00 C.O.  
5-19-97  
WPI am

05-405963

# PERMIT

## SEWAGE DISPOSAL SYSTEM

### DEPARTMENT OF HEALTH AND MENTAL HYGIENE

P 57316  
A 37265  
DISTRICT 5th

**HOWARD COUNTY HEALTH DEPARTMENT**

**BUREAU OF ENVIRONMENTAL HEALTH**

461-9933 313-2640

DATE 10-10-96

# INDEXED

DATE SYSTEM APPROVED 12/31/96

INSPECTOR [Signature]

South Carroll Backhoe, Inc.

IS PERMITTED TO INSTALL  ALTER

ADDRESS 4410 Salem Bottom Road, Westminster, MD 21157 PHONE \_\_\_\_\_

SUBDIVISION Lilienfield LOT 4 ROAD 8683 Reservoir Road

PROPERTY OWNER Neil Garner

ADDRESS \_\_\_\_\_

SEPTIC TANK CAPACITY 1250 GALLONS

Manhole to grade required.

NUMBER OF BEDROOMS 4

180 SQUARE FEET PER BEDROOM

LINEAR FEET OF TRENCH REQUIRED 240

TRENCHES - Trench to be 2 feet wide. Inlet 5 feet below original grade. Bottom maximum depth 8 feet below original grade. Effective area begins at 5 feet below original grade. 3 feet of stone below distribution pipe.

LOCATION - Place distribution box 280' down the right lot line (477') and 130' from the right lot line as seen when facing the property from Reservoir Road. Run trench(s) along contour to front of lot. Maintain at least 100' from well to all parts of septic system.

NOTES - No trench to exceed 100 feet in length. Provide 6" - 8" diameter cleanout and cap to grade or above on septic tank.

OK/MR

PLANS APPROVED BY Craig Williams/Mark Rifkin Revised \_\_\_\_\_ DATE 2/11/87, 11/1/95

COVER NO WORK UNTIL INSPECTED AND APPROVED.

NEITHER THE HOWARD COUNTY COUNCIL NOR THE HEALTH DEPARTMENT IS RESPONSIBLE FOR THE SUCCESSFUL OPERATION OF ANY SYSTEM

NOTE: CLEANOUT REQUIRED EVERY 70 FEET OF SEWER LINE AND/OR AT 90° SWEEPS IN LINES FROM HOUSE TO DRAIN FIELDS, 90° ELBOWS NOT ACCEPTABLE.

NOTE: ALL PARTS OF SEPTIC SYSTEMS (I.E. TANK, DISTRIBUTION BOX TRENCHES) TO BE 100 FEET FROM WELL (UNLESS OTHERWISE SPECIFICALLY AUTHORIZED)

NOTE: IF DEEP TRENCH(ES) ARE USED CALL FOR INSPECTION BEFORE AND AFTER PLACING GRAVEL IN TRENCH(ES)

NOTE: NO DRY WELL SHALL EXCEED 15 FOOT IN DIAMETER NO ABSORPTION TRENCH TO EXCEED 100 FEET IN LENGTH

NOTE: ALL PIPE FROM HOUSE TO SEPTIC TANK MUST BE CAST IRON OR SCHEDULE 35/40 PVC OR ABS

PERMIT VOID AFTER TWO YEARS

NOTE: INSTALL STAND PIPE ON SEPTIC TANK AND DRY WELL STAND PIPES MUST BE 6 INCHES IN DIAMETER CAST IRON. CONCRETE OR TERRA COTTA OR PVA OR ABS ACCEPTED. IF TOP OF SEPTIC TANK IS DEEPER THAN 3 FEET. MANHOLE TO GRADE REQUIRED.

NOTE: DISTRIBUTION BOXES MUST HAVE BAFFLES

**\*INSTALLER IS RESPONSIBLE FOR OBTAINING FINAL APPROVAL ON THIS PERMIT**

A 37265

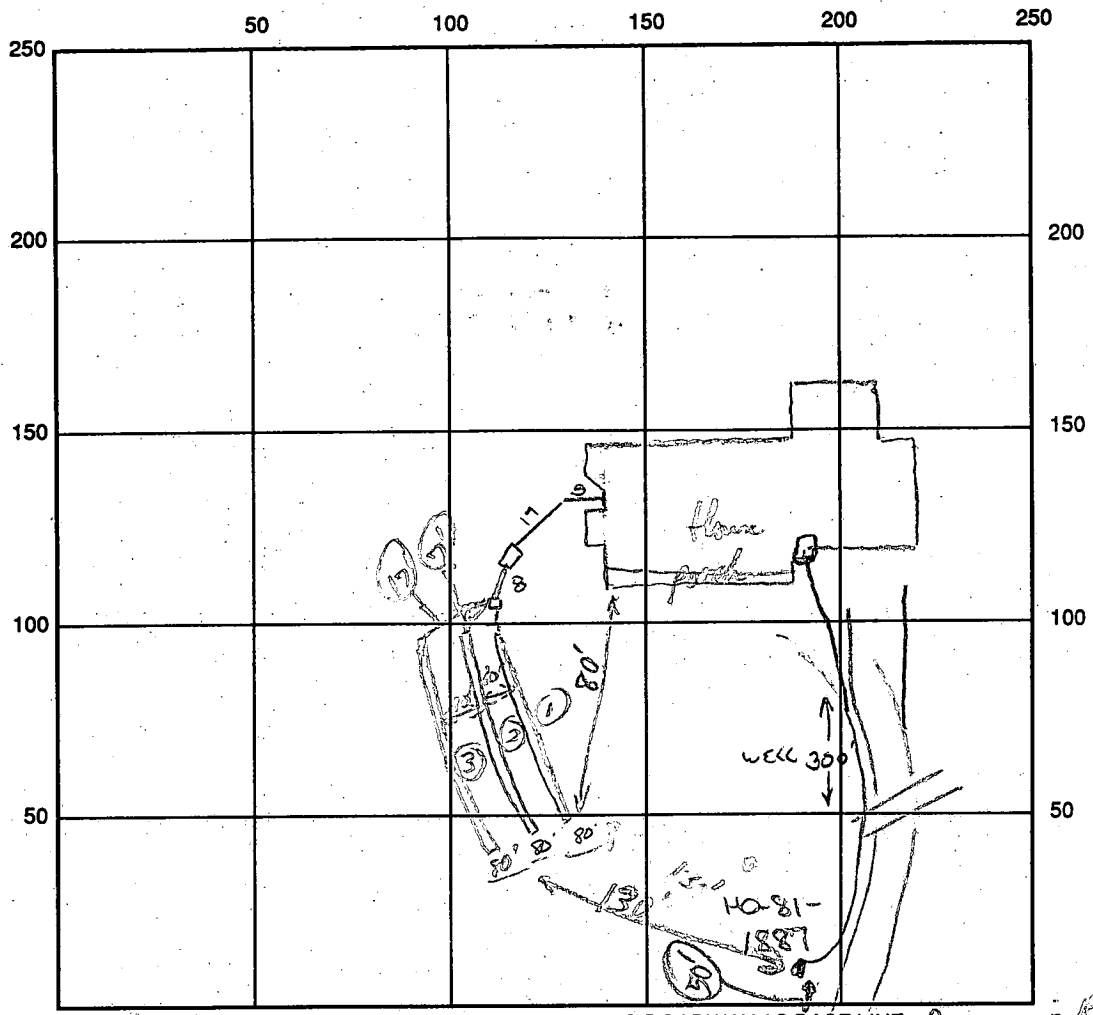

INDICATE NORTH - NAME ADJOINING ROADWAY AS BASE LINE Reservoir Rd

SEPTIC TANK LEVEL OK CLEANOUTS manhole on site

DISTRIBUTION BOX LEVEL OK

DRAIN FIELD/TITLE DEPTH 8.0 (9.0 #30" d) FT. TRENCH WIDTH 2.0 FT. INLET DEPTH 5.0 FT.

EFFECTIVE GRAVEL DEPTH 3.0 FT. TOTAL LENGTH 150 FT.

NUMBER OF TRENCHES \_\_\_\_\_ ONE SIDEWALL/BOTTOM AREA \_\_\_\_\_ SQ. FT.

DRYWALL INSIDE DIAMETER \_\_\_\_\_ FT. EFFECTIVE DEPTH BELOW INLET \_\_\_\_\_ FT.

ABSORBENT AREA \_\_\_\_\_ SQ. FT.

REMARKS: 12/27/96 OK to stone trenches and continue. OK to cover from house to dist. box. DCS 12/30/96 OK to cover 1st two trenches AL OK to line from trench to D.BOX RPT 12/31/96 5-19-97 W.P.I., NEEDS SEALED CAP, PUMP NOT INSTALLED. OK TO COVER PITRESS ADAPTER + WELL LINE.

DATE SYSTEM APPROVED 12/31/96 INSPECTOR [Signature]

S 28°05'40"W 197.38'

# Approved Septic System Plan

LOT 4  
Howard County Health Department  
OR 3.152 AC.



*[Signature]*  
Signature

11/14/95  
Date

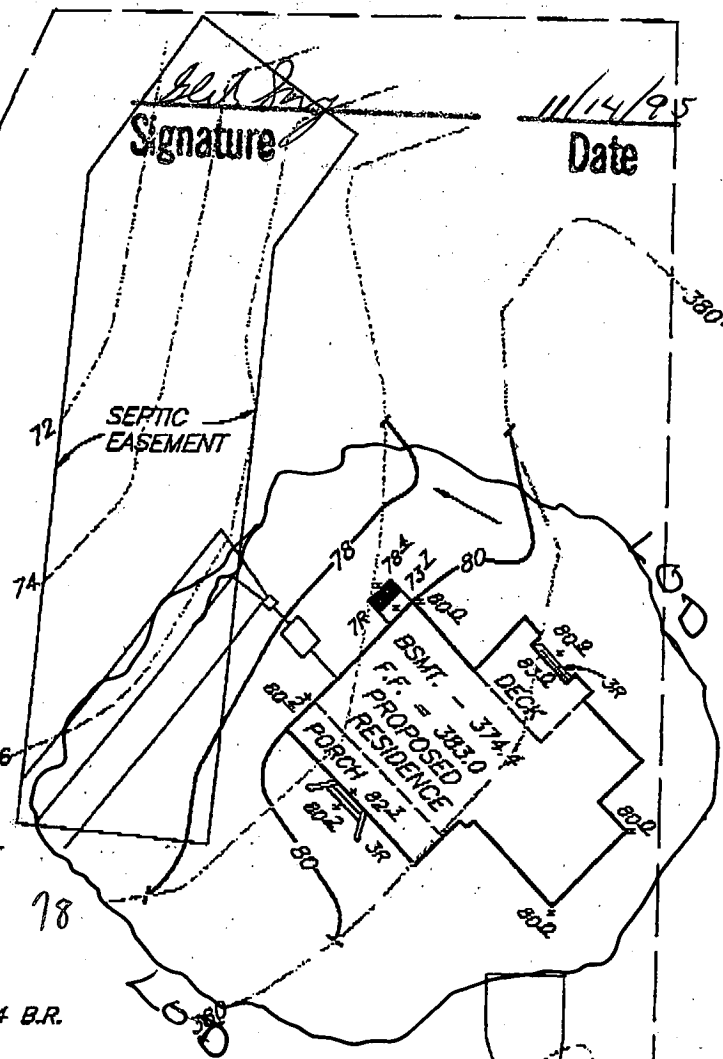

S 37°42'30"E 435.77'

N 61°54'20"W 477.47'

INV. @ HOUSE - 72.9  
SEPTIC TANK - 1250 GAL.  
INV. IN - 72.7  
INV. OUT - 72.4  
DISTRIBUTION BOX  
EX. GROUND - 76.8  
INV. - 71.8

240 L.F. REQUIRED FOR 4 B.R.  
3 - 80" LINES PROVIDED

NOTE: REPOSITIONING OF HOUSE AND/OR  
CHANGES IN SEPTIC SYSTEM ELEVATIONS  
MAY JEOPARDIZE GRAVITY FLOW SEWER  
FROM BASEMENT.

WELL

PROPOSED DRIVEWAY

A = 125.71'

R = 439.26'

RESERVOIR ROAD

N 68°40'42"E 81.56'

N 25°26'30"W 145.87'

N 64°33'29"E 99.00'

378.00'

### NOTES:

- 1) TOPOGRAPHY FIELD RUN BY LAVELLE & ASSOCIATES, INC. 10/17/95 BASED UPON ASSUMD DATUM.

PLOT PLAN  
LOT 4 SECTION 3  
**LILIENFIELD SUBDIVISION**  
SITUATED ON RESERVOIR ROAD  
5th ELECTION DISTRICT  
HOWARD COUNTY, MARYLAND  
SCALE: 1" = 50' DATE: OCT. 31, 1995

## LAVELLE & ASSOCIATES INCORPORATED

ENGINEERS • PLANNERS • SURVEYORS

336 EAST SECOND STREET • FREDERICK, MARYLAND 21701  
OFFICE • (301) 695-9722 • FAX (301) 695-9766