

-
1. This screen allows you to search the Real Property database and display property records.
 2. Click [here](#) for a glossary of terms.
 3. Deleted accounts can only be selected by Property Account Identifier.
 4. The following pages are for information purpose only. The data is not to be used for legal reports or documents. While we have confidence in the accuracy of these records, the Department makes no warranties, expressed or implied, regarding the information.

PRELIMINARY

APPLICATION

A 31552

SEWAGE DISPOSAL TESTING

STATE OF MARYLAND - DEPARTMENT OF HEALTH AND MENTAL HYGIENE

P _____

HOWARD COUNTY HEALTH DEPARTMENT
ENVIRONMENTAL HEALTH SERVICES

P. O. BOX 473 ELLICOTT CITY, MARYLAND 21043
TELEPHONE: 992-2330

DISTRICT 4th

DATE 8/4/81

TO: THE COUNTY HEALTH OFFICER
ELLICOTT CITY, MARYLAND

I, HEREBY, APPLY FOR THE NECESSARY TEST IN ORDER TO CONSTRUCT (OR RECONSTRUCT) A SEWAGE DISPOSAL SYSTEM.

PROPERTY OWNER Hubert E. Snapp, Inc.

ADDRESS 25641 Ridge Road, Damascus, Maryland 20750 PHONE _____

PROPERTY LOCATION:

SUBDIVISION Florence Estates LOT NO. 2623

ROAD AND DESCRIPTION Florence Road

SIZE OF LOT 3 acres more or less TYPE BLDG. _____ (NUMBER OF BEDROOMS)

THE SYSTEM INSTALLED UNDER THIS APPLICATION IS ACCEPTABLE ONLY UNTIL PUBLIC FACILITIES BECOME AVAILABLE. I FULLY UNDERSTAND THE FEE CONNECTED WITH THE FILING OF THIS PERC TEST APPLICATION IS NON-REFUNDABLE UNDER ANY CIRCUMSTANCES. I ALSO AGREE TO COMPLY WITH ALL M.O.S.H.A. REQUIREMENTS IN TESTING THIS LOT. /s/ Hubert E. Snapp

(SIGNATURE OF APPLICANT)

APPROVED BY _____ FOR _____ DATE _____

REJECTED BY _____ FOR _____ DATE _____

HOLD PENDING FURTHER TESTS _____ DATE _____

REASONS FOR REJECTION OR HOLDING _____

THIS IS NOT A PERMIT

#26

Py 1/4

SOIL PROFILE

SEE EACH HOLE BELOW

FIELD SHEET

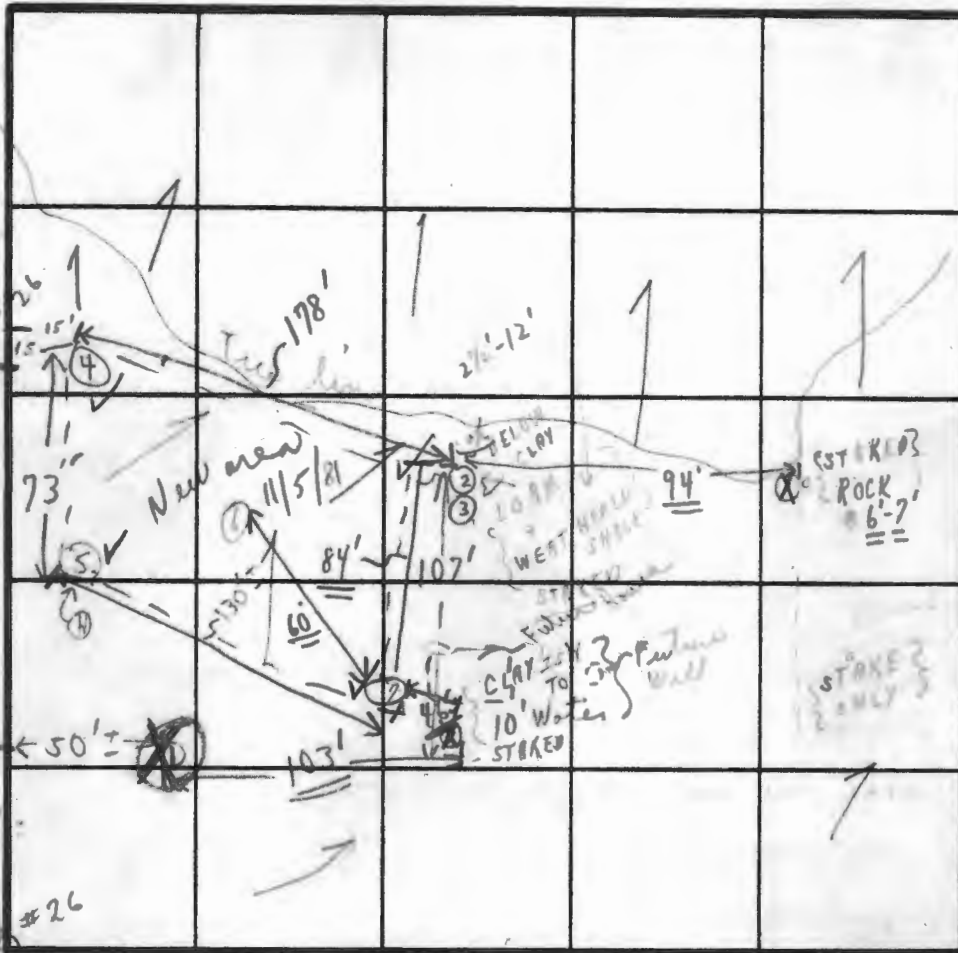

INDICATE NORTH - NAME ADJOINING ROADWAY AS BASE LINE.

CABIN BRANCH COURT

SOIL PROFILE

SOIL PROFILE	DATE	TEST NO.	DEPTH'	PRE-WET		TEST - 1" DROP		TIME
				START	STOP	START	STOP	
1'-5' CLAY 5' TO 10' WEATHERED SHALE CLAYEY 3'	9/24/81	1 S	5'	9:42	9:52	9:52	10:22	3/4" X (1)
		1 M	13'					
1'-2' 2" CLAY WEATHERED SHALE + LOAM TO 12'		2 S						
		2 M	NOTE'	NOT TESTED (ON REST OF 10,000 SQ FT AREA)				
1'-3' CLAY 3' WEATHERED SHALE TO 12'	11/5/81	3 S	3 1/2' d.	2:31	2:34	2:34	2:40	6 in
		3 M	8'	2:31	2:39	2:39	2:47	8 in
1'-3' clay 3'-10 1/2' LOAM + WEATHERED SHALE TO 10 1/2'		4 S	2 1/2'	2:41	2:48	2:48	3:22	3/4'
		4 M	10 1/2'	(No tests similar all the way)				
1'-5' CLAY 5' LOAM + WEATHERED SHALE TO 12 1/2'		5 S	5'	2:27	2:32	2:33	2:36	3 in
		5 M	8 1/2'	2:27	2:33	2:32	2:37	5 in

11/5/81 Hole Use #7 to #5

9 min. avg inlet 3 1/2'

REMARKS
TYPE OF SOIL

11/24/81 NOTE HOLE 1 DUG @ ARRIVAL + WATER SIGN + NET IF APPROVED s.h. on...

TESTED BY C. B. D. ALSO PRESENT C.M. Clark + ...

EH-12-1079

PRELIMINARY

APPLICATION

System Final

SEWAGE DISPOSAL TESTING

STATE OF MARYLAND - DEPARTMENT OF HEALTH AND MENTAL HYGIENE

A 31552

P _____

HOWARD COUNTY HEALTH DEPARTMENT
ENVIRONMENTAL HEALTH SERVICES

P. O. BOX 473 ELLICOTT CITY, MARYLAND 21043
TELEPHONE: 992-2330

DISTRICT 4th

DATE 8/4/81

TO: THE COUNTY HEALTH OFFICER
ELLICOTT CITY, MARYLAND

I, HEREBY, APPLY FOR THE NECESSARY TEST IN ORDER TO CONSTRUCT (OR RECONSTRUCT) A SEWAGE DISPOSAL SYSTEM.

PROPERTY OWNER Hubert E. Snapp, Inc.

ADDRESS 25641 Ridge Road, Damascus, Maryland 20750 PHONE _____

PROPERTY LOCATION:

SUBDIVISION Florence Estates LOT NO. 23

ROAD AND DESCRIPTION Florence Road

SIZE OF LOT 3 acres more or less TYPE BLDG. _____
(NUMBER OF BEDROOMS)

THE SYSTEM INSTALLED UNDER THIS APPLICATION IS ACCEPTABLE ONLY UNTIL PUBLIC FACILITIES BECOME AVAILABLE. I FULLY UNDERSTAND THE FEE CONNECTED WITH THE FILING OF THIS PERC TEST APPLICATION IS NON-REFUNDABLE UNDER ANY CIRCUMSTANCES. I ALSO AGREE TO COMPLY

WITH ALL M.O.S.H.A. REQUIREMENTS IN TESTING THIS LOT. /s/ Hubert E. Snapp
(SIGNATURE OF APPLICANT)

APPROVED BY _____ FOR _____ DATE _____

REJECTED BY _____ FOR _____ DATE _____

HOLD PENDING FURTHER TESTS _____ DATE _____

REASONS FOR REJECTION OR HOLDING 11/6/81 for certified holes house site
and/or water well acceptable to Health Dept.

11/6/81 { NOTE Restricted House Site Disrupted with Mr. Skinner. }
F.D.V. C.B.D. C.B.D.

THIS IS NOT A PERMIT

#26
 8/22

SOIL PROFILE

0'

INDICATE NORTH - NAME ADJOINING ROADWAY AS BASE LINE.

Soil Profile
 1'-4" CLAY
 4" LOM + some
 rotten rock
 to 12'

DATE	TEST NO.	DEPTH	PRE-WET		TEST - 1" DROP		TIME
			START	STOP	START	STOP	
	✓ 75	4'	3:03	3:10	3:10	3:30	20 min
	7 M	12'	DRY				

REMARKS _____

TYPE OF SOIL _____

TESTED BY _____ ALSO PRESENT _____

EH-12-1079

System
Front

Reaccomplished

~~#26~~ ²³ Florence Estate

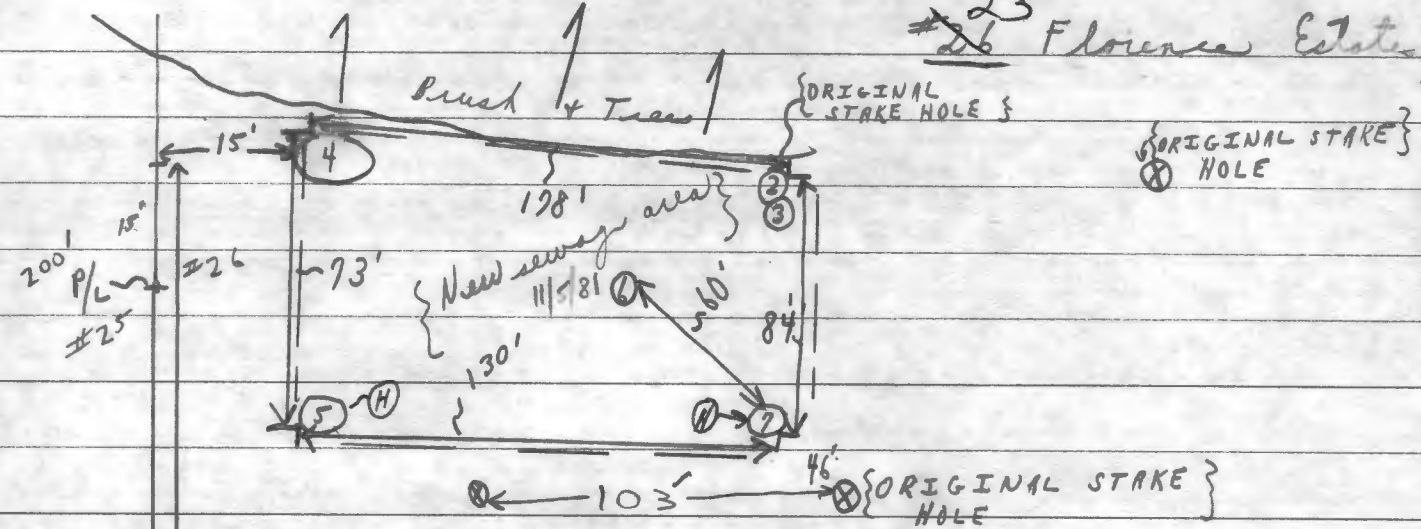

9 min avg.
inlet 3 1/2 ft.

New area
of sewage
essence

