



South Carroll Backhoe, Inc.

4410 Salem Bottom Road • Westminster, Maryland 21157
Phone: 875-4197

March 15, 2019

Bob Houston
11391 Harding Road
Laurel, MD 20723

To Whom It May Concern:

South Carroll Backhoe, Inc. pumped and filled the septic tank with dirt located at the above address. We dug and followed the pipe on the outlet side of septic tank and determined the pipe was connected to a drainfield. Dug a 20' x 30' area where old drywell was on the drawing and no drywell was found.

Sincerely,

A handwritten signature in dark ink, appearing to read "Donald C. Schissler". The signature is written in a cursive style with a large, stylized initial "D".

Donald C. Schissler
Vice President

cc

OFFICE USE ONLY

SEWER CONNECTION APPLICATION

HOWARD COUNTY

DEPARTMENT OF PUBLIC WORKS

3430 COURT HOUSE DRIVE ELLICOTT CITY, MD 21043

OFFICE USE ONLY

CONTROL #: _____
 ERMIT #: _____
 INSPECTED BY: _____
 DATE INSPECTED: _____

APPLICATION #: Ho. Co. Sewer Extension
 CONTRACT #: 24-3671-D, 18, 2
 REBATE CONTRACT #: _____
 SEWER ZONE: _____
 CONNECTION WORKSHEET Y____N____

FILL OUT APPLICATION COMPLETELY AND SIGN BELOW. IF LOCATION INFORMATION IS UNKNOWN, CONTACT THE OFFICE OF PLANNING AND ZONING (DPZ) FOR HOUSE NUMBER, STREET NAME, ETC. NOTE: COMMERCIAL AND INDUSTRIAL FACILITIES MAY BE SUBJECT TO REQUIREMENTS OF THE COUNTY CODE FOR SEWER SURCHARGES, INDUSTRIAL COST RECOVERY CHARGES, AND PRETREATMENT.

DATE OF APPLICATION 2/26/19

Application is herewith made for a sewer house connection to the property described below:
 SUBDIVISION Reservoir Overlook SECTION _____ AREA _____ LOT _____ BLOCK _____
 HOUSE # 11391 STREET Harding Rd. TAX MAP 46 GRID 15 PARCEL 278
 CITY, STATE Laurel, MD ZIP CODE 20723 PHONE # (410) 880-1968
 NEW OR EXISTING BUILDING Existing USE (SEE PROPERTY CLASSIFICATIONS ON REVERSE SIDE) _____

ITEMS CHECK	CONNECTION TYPE	CON. DIA.	CHARGES DESCRIPTION	CHARGES AMOUNT	FUND	BA	G/L
<input checked="" type="checkbox"/>	SEWER CONNECTION	4"	INSTALLATION	4,500.00	7010009000	3100	431185
<input type="checkbox"/>	SEWER CONNECTION	6"	INSTALLATION		7010009000	3100	431185
<input type="checkbox"/>	SEWER CONNECTION	8"	INSTALLATION - ADO		7010003000	1300	102998
<input checked="" type="checkbox"/>			IN-AID-OF CONSTRUCTION AMOUNT CHARGED BASED ON METER SIZE	600.00	7030015100	3100	422000
<input type="checkbox"/>	ADO or SURETY #		ADVANCED DEPOSIT ORDER OR SURETY DEPOSIT AMOUNT		7010003000	1300	102998
<input type="checkbox"/>			INSPECTION FEE AND PERMIT FEE		7010010000	3100	431105

*Refer to DPZ for estimates of Advanced Deposit (ADO). For installations requiring an ADO, the owner must enter into a cost agreement with Howard County prior to the commencement of any installation work.

\$ 5,100.00
 TOTAL DUE

DATE _____
 CR # _____

THE INFORMATION REQUESTED BELOW MUST BE LEGIBLE FOR BILLING/REFUND PURPOSES.

COMPANY NAME _____
 COMPANY ADDRESS _____
 OWNER SIGNATURE Brenda Houston
 OWNER NAME (PRINT) Brenda Houston
 OWNER ADDRESS 11391 Harding Rd.
Laurel, Md. 20723

FULL FEE MUST ACCOMPANY THIS COMPLETE APPLICATION, MAKE CHECKS PAYABLE TO: DIRECTOR OF FINANCE, HOWARD COUNTY. CREDIT CARDS ARE NOT ACCEPTED.

THE TERMS & CONDITIONS OF THIS APPLICATION, INCLUDING ANYTHING ON THE REVERSE SIDE HEREOF ARE BINDING UPON THE OWNERS SIGNATURE & ALL SUCCEEDING OWNERS.

Howard County, Maryland
Department of Finance
3430 Court House Drive
Ellicott City, MD 21043

2/26/2019 02:47 PM Cashier 0065
T/Ref 0004301389 Reg 0004 Tran No 1224
Cash Report: 190227-01 for 2/27/2019

01 - Main Location
W/S Connection 500-5019
7010009000-3100-431185-3100000000-999999
9999999999
CONTRACT #: 243671D
Validation Number: 829497 \$4,500.00
Sewer-In-Aid (730-009-7120)
7030015100-3100-422000-3100000000-999999
9999999999
Contract Number: 243671D
Validation Number: 829498 \$600.00
=====

Total	\$5,100.00
Check	(\$5,100.00)
Check No. 3860	

Thank You!



CANAAN VALLEY INSTITUTE

March 7, 2019

RE: FY 2019 Howard County Bay Restoration Fund OSDS Upgrade Program

Robert & Brenda Houston
11391 Harding Road
Laurel, MD 20723

Dear Mr. and Mrs. Houston:

Thank you for your application to participate in the Howard County Bay Restoration Fund OSDS Upgrade Program. The Howard County Health Department has verified that the existing septic system is failing and that a connection to the Little Patuxent Sewage Treatment Plant is the most cost effective and environmentally sensitive solution. Maryland Department of the Environment (MDE) has reviewed the proposal for the cost to extend sewer to your property, and has approved it eligible to be paid using a Bay Restoration Fund grant.

Based on your 2017 tax information, you are eligible to receive funding to cover **100%** of the total cost of your connection to public sewer. The total cost of includes the low contractor bid of **\$6080** and any portion of the Howard County Sewer Connection fee that is not reimbursed by the county. If you select a contractor whose installation cost is higher than the low bid of \$6080, you will be responsible for additional costs. Upon project completion, CVI will request payment from MDE and will reimburse the Howard County Sewer Connection Fee of **\$5100** to you, and will pay the grant award of **\$6080** directly to the contractor.

To accept the conditions of this grant award, please sign and return this letter to me prior to scheduling construction. If assistance is needed or if you have any questions, you may contact me at 304-940-3443 or kristin.mielcarek@canaanvi.org.

Sincerely,

Kristin Mielcarek,
Executive Director

I have read and agree to the conditions of this Agreement Letter.
Accepted by: Robert Houston, Property Owner

Signature

Date

Accepted by: Brenda Houston, Property Owner

Signature

Date

10624 Appalachian Highway | Davis, WV 26260
Phone: (304) 259.4739
www.canaanvi.org

December 3, 2018

MEMORANDUM

To: Shauna Lu
Cathy Lowenkron
Water Quality Financing Administration
Maryland Department of the Environment

Kristin Mielcarek
Canaan Valley Institute

From: Jeff Williams
Program Supervisor, Well & Septic Program

Re: **BRF Proposal for connecting 11391 Harding Road to public sewer**

The Howard County Health Department has identified a property in Howard County that meets the five requirements of HB 57 to receive BRF money for connecting an existing house to an existing public sewer line.

1. THE ENVIRONMENTAL IMPACT OF THE ONSITE SEWAGE DISPOSAL SYSTEM IS DOCUMENTED BY THE LOCAL GOVERNMENT AND CONFIRMED BY THE DEPARTMENT;

The existing on-site sewage disposal system serving the single family dwelling on the property is in a failing condition. Please see exhibit A containing a Health Department site evaluation form confirming the failing condition.

2. IT CAN BE DEMONSTRATED THAT:

A. THE REPLACEMENT OF THE ONSITE SEWAGE DISPOSAL SYSTEM WITH SERVICE TO AN EXISTING MUNICIPAL WASTEWATER FACILITY THAT IS ACHIEVING ENHANCED NUTRIENT REMOVAL LEVEL TREATMENT IS MORE COST-EFFECTIVE FOR NITROGEN REMOVAL THAN UPGRADING THE INDIVIDUAL ONSITE SEWAGE DISPOSAL SYSTEM; OR

B. THE INDIVIDUAL REPLACEMENT OF THE ONSITE SEWAGE DISPOSAL SYSTEM IS NOT FEASIBLE;

The Little Patuxent Wastewater Treatment Plant is currently constructed to meet to ENR standards. Therefore, it is more cost effective per pound of nitrogen removal than installing a BAT on an on-site sewage disposal system. The homeowner has received three (3) written quotes (exhibit B) from contractors to make the connection. The lowest quote is \$6080 from South Carroll Backhoe. The homeowner has paid the Howard County connection cost of \$5100 (exhibit

Maura J. Rossman, M.D., Health Officer

C). Additionally, connection to the public system is required by Howard County Code and installation of an on-site sewage disposal system would be inconsistent with the Howard County Master Plan for Water and Sewerage, and therefore, prohibited by COMAR 26.04.02.02.J.

3. THE PROJECT IS CONSISTENT WITH THE COUNTY'S COMPREHENSIVE PLAN AND WATER AND SEWER MASTER PLAN;

The Howard County Master Plan states that an individual sewerage system may not be installed on any parcel or lot where a public sewer system is adequate and available. The public sewer system is adequate and available to this property. Exhibit D is a Howard County GIS map illustrating the existing sewer line in red.

4. THE ONSITE SEWAGE DISPOSAL SYSTEM WAS INSTALLED AS OF OCTOBER 1, 2008, AND THE PROPERTY THE SYSTEM SERVES IS LOCATED IN A PRIORITY FUNDING AREA, IN ACCORDANCE WITH § 5-7B-02 OF THE STATE FINANCE AND PROCUREMENT ARTICLE; AND

The existing home was built before public sewer was available. Health Department records indicate the system was installed in 1976. 11391 Harding Road is within the Priority Funding Area.

5. THE LOCAL GOVERNMENT HAS ADOPTED A POLICY OR PROCEDURE THAT WILL GUARANTEE THAT ANY FUTURE CONNECTION TO AN EXISTING MUNICIPAL WASTEWATER FACILITY THAT IS FUNDED UNDER PARAGRAPH (2)(1)E OF THIS SUBSECTION WILL MEET ALL OF THE REQUIREMENTS UNDER THIS SUBPARAGRAPH.

The Howard County public sewer line has already been constructed. The connection will be for 11391 Harding Road and no other homes will be connected to the sewer line house connection.

The Howard County Health Department does not like to maintain financial data of Howard County citizens, so I have requested that the owner provide their taxable income information directly to Canaan Valley Institute. Please feel free to contact me at (410) 313-1771 with any questions.

SITE INSPECTION SHEET

OWNER: _____ PHONE #: _____
ADDRESS: 11391 Harding Rd CONTRACTOR: _____
_____ WELL TAG #: _____
SUBDIVISION: _____ LOT: _____ COUNTY #: _____
PROPOSAL: PRF

LOCATION DIAGRAM

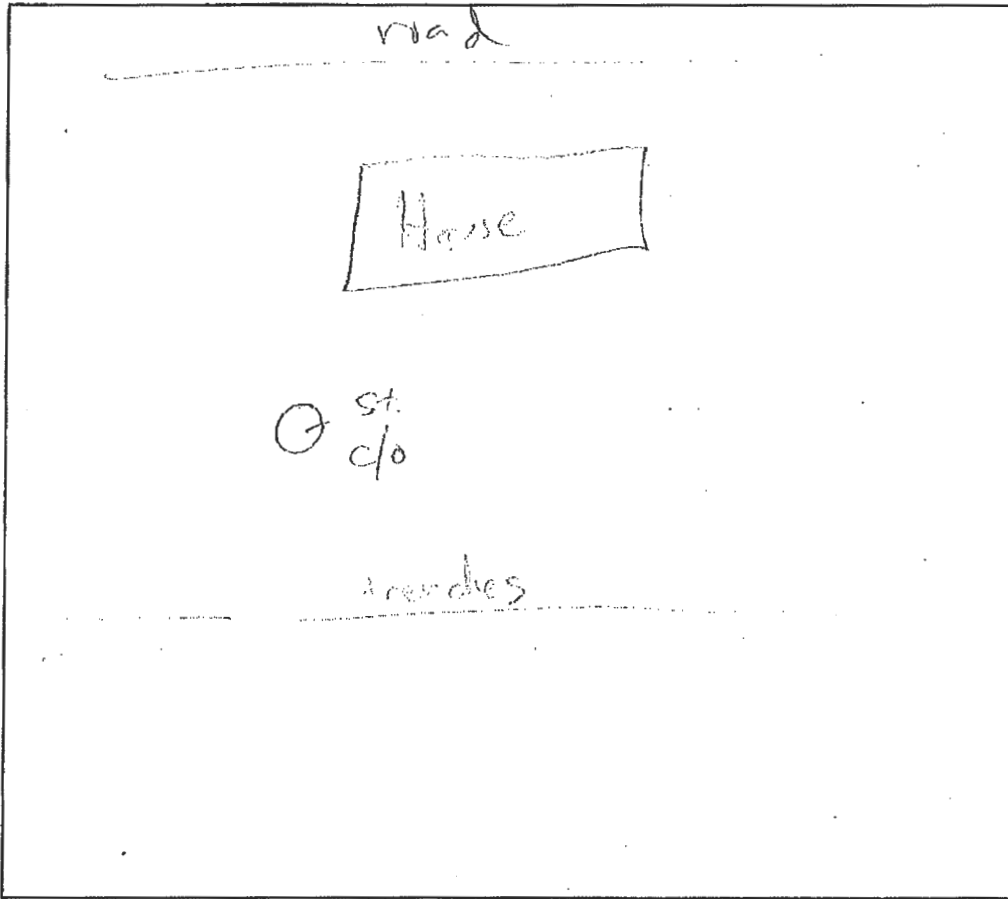

COMMENTS: - solids built up in tank up to lid - evidence
of overflow at tank

DATE: 8/2/18 INSPECTOR: J. Williams

PROPOSAL SUBMITTED TO Bob Houston		PHONE 410-880-1968	DATE 11/15/18
STREET 11391 Harding Road		JOB NAME Houston	
CITY, STATE and ZIP CODE Laurel MD 20723		JOB LOCATION 11391 Harding Road	
ARCHITECT	DATE OF PLANS	JOB PHONE	
		Howard County	

We hereby submit specifications and estimates for:
Sewer Changeover:

We propose to dig and install 4" PVC sewer based on 70' with two cleanouts from in front of septic tank to proposed sewer connection. Pump and fill septic tank and one drywell with dirt. Obtain permit and have inspected. We will call Miss Utility before digging. Sewer connection fees to be paid by others. Backfill, seed & straw (germination not guaranteed, watering by others). Not responsible for: lawn, trees, shrubs, deck, fence, private or mismarked utilities, undo settlement, etc. Guarantee for 3 years.

Payment to be paid by Bay Restoration within 60 days.

Note: If 3 tandems of dirt is left on site from sewer connection deduct \$750.

PLEASE NOTE: EXCESSIVE ROCK AND WATER WILL BE AN ADDITIONAL CHARGE.
 EXTRA ABSORBENT AREA AVAILABLE @ \$ _____ per square foot.
 EXTRA PIPE AVAILABLE @ \$ _____ per foot.
 WE WILL BACKFILL, LEAVING EXCESS DIRT PILED IN SEPTIC AREA.

SERVICE CHARGE: A service charge of 1-1/2% per month (ANNUAL RATE OF 18%) will apply to balances over 30 days past due. Buyer agrees to pay reasonable attorney fees if placed in the hands of an attorney for collection.

We propose hereby to furnish material and labor - complete in accordance with above specifications, for the sum of:
Six thousand eighty and _____/100 dollars (\$ 6080.00)

Payment to be made as follows:

Payment by Bay Restoration within 60 days.

All material is guaranteed to be as specified. All work to be completed in a workmanlike manner according to standard practices. Any attention or deviation from above specifications involving extra costs will be executed only upon written orders, and will become an extra charge over and above the estimate. All agreements contingent upon strikes, accidents or delays beyond our control. Owner to carry fire, tornado and other necessary insurance. Our workers are fully covered by Workman's Compensation Insurance.

Authorized Signature

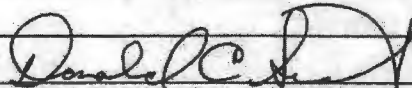

Donald C. Schissler, Vice President

Note: This proposal may be withdrawn by us if not accepted within _____ days.

Acceptance of Proposal - The above prices, specifications and conditions are satisfactory and are hereby accepted. You are authorized to do the work as specified. Payment will be made as outlined above.

Signature _____

Date of Acceptance: _____

Signature _____

Hatfield's Equipment and Dedication Services, Inc.

P.O. Box 519 • Annapolis Junction, MD 20701-0519
Office: 301-490-4289 / 888-490-4289 • Fax: 301-490-5794

Robert Houston
11391 Harding Road
Laurel, MD 20723

Gravity Sewer Lateral
Proposal # 9585, revised

November 21, 2018

We propose to supply the labor, materials and equipment to complete the following:

Apply for outside permit for sewer lateral
Pump, crush and fill the existing tank
Tie 2 existing sewer outlet pipes from the house
Extend 4" schedule 40 PVC pipe to the tap (tap installed by others)
Inspected
Fine grade, seed and straw area disturbed
Cost \$ 6,130.00

Exclusions: Stakeouts, bonds, taps, export of fill, asphalt repair, concrete repair, sediment control, seeding, any items not priced above.

All work to be billed as completed.

Customer agrees to pay Hatfield's Equipment And Dedication Services Inc. in full the amount due within 30 days.

A finance charge at the periodic rate of 2% per month which constitutes an annual percentage rate of 24%, will be applied to any balances not paid in 30 days

Customer agrees to pay 40% of amount due as attorney fees if placed in the hands of an attorney for collection.

Non-payment of any past due amount will be sufficient justification to stop work on the project.

Respectfully Submitted

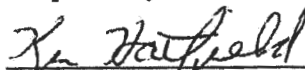

Ken Hatfield, president

Accepted by

Signature of Responsible Party

Print Name



8177 Mission Rd.
 Jessup, Maryland 20794
 (410) 799-7727
 office@heilplumbing.com

Estimate

ESTIMATE#	13612356
DATE	07/30/2018
PO#	

CUSTOMER
Bob Houston 11391 Harding Road Laurel, MD 20723 (301) 957-5964 (M)

SERVICE LOCATION
11391 Harding Road Laurel, MD 20723

DESCRIPTION	
Private Property work. Beginning near the rear of the house excavate an area 2' wide x approximately 145 +/- linear feet at a minimum depth required to provide a continuous downhill grade from the front of the house, to the Howard County sanitary sewer connection. Connect to the existing sewer and washer drain in the rear of the house with a Femco or equivalent flexible connector, supply and install approximately 145+/- linear feet of 4" (schedule 40) PVC from the building to the Howard County Sewer House Connection. Install a cleanout near the house, additional cleanouts shall be installed every 75' LF and at the SHC. Work shall be inspected by Howard County Pump septic tank, collapse lid and fill with dirt. Backfill with native soil, grass seed and straw the disturbed area.	

Description	Qty	Rate	Total
Sewer New Installation This cost is for the sewer installation on your property: Beginning near the rear of the house excavate an area 2' wide x approximately 145 +/- linear feet at a minimum depth required to provide a continuous downhill grade from the front of the house, to the Howard County sanitary sewer connection.HC. Connect to the existing sewer and washer drain in the rear of the house with a Femco or equivalent flexible connector, supply and install approximately 145+/- linear feet of 4" (schedule 40) PVC from the building to the Howard County Sewer House Connection. Install a cleanout near the house, additional cleanouts shall be installed every 75' LF and at the SHC. Work shall be inspected by Howard County Pump septic tank, collapse lid and fill with dirt. Backfill with native soil, grass seed and straw the disturbed a	1.00	\$6,750.00	\$6,750.00
Subcontractor Pump and dispose of the contents of the septic tank	1.00	\$750.00	\$750.00
Permit Required by County Estimated permit fee required by the county.	1.00	\$350.00	\$350.00

CUSTOMER MESSAGE

The prices listed are estimates only. If you are interested in completing the work with Heil Plumbing, please contact us for a formal contract with final pricing. Should you have any questions or concerns, please feel free to email at mengning.heil@heilplumbing.com or call us at 410-799-7727 Monday - Friday 7:30AM-4:30PM.

PRE-WORK SIGNATURE

Estimate Total: \$7,850.00

OFFICE USE ONLY

CONTROL NO.: _____
 PERMIT NO.: _____
 INSPECTED BY: _____
 DATE INSPECTED: _____

SEWER CONNECTION APPLICATION
HOWARD COUNTY
 DEPARTMENT OF PUBLIC WORKS
 3430 COURT HOUSE DRIVE ELLICOTT CITY, MD 21043

Account No. _____

OFFICE USE ONLY

APPLICATION NO.: _____
 O.D.: 7777
 REBATE CONTRACT NO.: _____
 SEWER ZONE: _____
 CONNECTION WORK SHEET Y__N_X

FILL OUT APPLICATION COMPLETELY AND SIGN BELOW. IF LOCATION INFORMATION IS UNKNOWN, CONTACT THE OFFICE OF PLANNING AND ZONING (DPZ) FOR HOUSE NUMBER, STREET NAME, ETC. NOTE: COMMERCIAL AND INDUSTRIAL FACILITIES MAY BE SUBJECT TO REQUIREMENTS OF THE COUNTY CODE FOR SEWER SURCHARGES, INDUSTRIAL COST RECOVERY CHARGES, AND PRETREATMENT.

Application is herewith made for a water house connection to the property described below.

DATE OF APPLICATION _____

SUBDIVISION _____ SECTION _____ AREA _____ LOT _____ BLOCK _____
 11391 STREET Harding Rd 0046 0015 0278
 Laurel 20723

NEW OR EXISTING BUILDING? Existing USE (SEE PROPERTY CLASSIFICATIONS ON REVERSE SIDE)

ITEM CHECK	CONNECTION TYPE	CON. DIA.	CHARGES DESCRIPTION	CHARGES AMOUNT	FUND	BA	G/L
<input checked="" type="checkbox"/>	SEWER CONNECTION	4"	INSTALLATION	\$ 4,500 ⁰⁰	7010009000	3100	431185
<input type="checkbox"/>	SEWER CONNECTION	6"	INSTALLATION		7010009000	3100	431185
<input type="checkbox"/>	SEWER CONNECTION	8"	INSTALLATION - ADO		7010003000	1300	102998
<input checked="" type="checkbox"/>			HEAD OF CONSTRUCTION AMOUNT CHARGED BASED ON METER SIZE	\$ 600 ⁰⁰	7030015100	3100	422000
<input type="checkbox"/>	ADO OR SURETY #		ADVANCED DEPOSIT ORDER OR SURETY DEPOSIT AMOUNT		7010003000	1300	102998
<input type="checkbox"/>			INSPECTION FEE AND PERMIT FEE		7010010000	3100	431105

*Refer to DPZ for estimates of Advanced Deposit (ADO). For installations requiring an ADO, the owner must enter into a cost agreement with Howard County prior to the commencement of any installation work.

\$5,100.00
 TOTAL DUE
 DATE _____
 CR # _____

THE INFORMATION REQUESTED BELOW MUST BE LEGIBLE FOR BILLING/REFUND PURPOSES.

COMPANY NAME _____
 COMPANY ADDRESS _____
 OWNER SIGNATURE _____
 OWNER NAME (PRINT) _____
 CONTACT ADDRESS _____

FULL FEE MUST ACCOMPANY THIS COMPLETE APPLICATION, MAKE CHECKS PAYABLE TO: DIRECTOR OF FINANCE, HOWARD COUNTY CREDIT CARDS ARE NOT ACCEPTED.

THE TERMS & CONDITIONS OF THIS APPLICATION, INCLUDING ANYTHING ON THE REVERSE SIDE HEREOF ARE BINDING UPON THE OWNERS SIGNATURE & ALL SUCCEEDING OWNERS.

