

C 1 07509

SEQUENCE NO. (MDE USE ONLY)

STATE OF MARYLAND WELL COMPLETION REPORT

FILL IN THIS FORM COMPLETELY PLEASE TYPE

THIS REPORT MUST BE SUBMITTED AFTER WELL IS COMPLETED.

COUNTY NUMBER W512691

ST/CO USE ONLY DATE Received MM DD YY

DATE WELL COMPLETED MM DD YY 12/6/99

Depth of Well 22 260 26 (TO NEAREST FOOT)

PERMIT NO. FROM "PERMIT TO DRILL WELL" HO-94-2479

OWNER Healey David Reps Road TOWN Cooksville SUBDIVISION HEALEY PROP SECTION LOT Map 8, P. 145

WELL LOG

Not required for driven wells STATE THE KIND OF FORMATIONS PENETRATED, THEIR COLOR, DEPTH, THICKNESS AND IF WATER BEARING

Table with columns: DESCRIPTION (Use additional sheets if needed), FEET (FROM, TO), check if water bearing. Rows include Topsoil, Micaceous clay, Br. Mica, Tan Mica, Gray Mica, etc.

GROUTING RECORD

WELL HAS BEEN GROUTED (Circle Appropriate Box) YES Y NO N TYPE OF GROUTING MATERIAL (Circle one) CEMENT CM BENTONITE CLAY BC NO. OF BAGS 24 NO. OF POUNDS 2100 GALLONS OF WATER 144 DEPTH OF GROUT SEAL (to nearest foot) from 0 ft. to 37 ft.

CASING RECORD

MAIN CASING TYPE ST Nominal diameter top (main) casing (nearest inch)! 6 Total depth of main casing (nearest foot) 40

OTHER CASING (if used)

Table for other casing with columns for diameter and depth.

SCREEN RECORD

screen type or open hole (insert appropriate code below) ST BR HO PL OT

C 2

DEPTH (nearest ft.) 1 160 2 38 3 260 8 9 11 15 17 21 23 24 26 30 32 36 38 39 41 45 47 51 SLOT SIZE 1 2 3 DIAMETER OF SCREEN (NEAREST INCH) 56 60 from to

C 3

PUMPING TEST

HOURS PUMPED (nearest hour) 3 PUMPING RATE (gal. per min.) 30 METHOD USED TO MEASURE PUMPING RATE Bucket WATER LEVEL (distance from land surface) BEFORE PUMPING 50 ft. WHEN PUMPING 260 ft. TYPE OF PUMP USED (for test) A air P piston T turbine C centrifugal R rotary O other J jet S submersible

PUMP INSTALLED

DRILLER INSTALLED PUMP YES NO IF DRILLER INSTALLS PUMP, THIS SECTION MUST BE COMPLETED FOR ALL WELLS. TYPE OF PUMP INSTALLED PLACE (A,C,J,P,R,S,T,O) IN BOX 29. CAPACITY: GALLONS PER MINUTE (to nearest gallon) 31 35 PUMP HORSE POWER 37 41 PUMP COLUMN LENGTH (nearest ft.) 43 47 CASING HEIGHT (circle appropriate box and enter casing height) + above - below LAND SURFACE 2 (nearest foot)

LOCATION OF WELL ON LOT SHOW PERMANENT STRUCTURES AND INDICATE NOT LESS THAN TWO DISTANCES (MEASUREMENTS TO WELL)

NUMBER OF UNSUCCESSFUL WELLS: 0 WELL HYDROFRACTURED YES Y NO N

CIRCLE APPROPRIATE LETTER A A WELL WAS ABANDONED AND SEALED WHEN THIS WELL WAS COMPLETED E ELECTRIC LOG OBTAINED P TEST WELL CONVERTED TO PRODUCTION WELL

I HEREBY CERTIFY THAT THIS WELL HAS BEEN CONSTRUCTED IN ACCORDANCE WITH COMAR 26.04.04 "WELL CONSTRUCTION" AND IN CONFORMANCE WITH ALL CONDITIONS STATED IN THE ABOVE CAPTIONED PERMIT, AND THAT THE INFORMATION PRESENTED HEREIN IS ACCURATE AND COMPLETE TO THE BEST OF MY KNOWLEDGE.

DRILLERS LIC. NO. 1 MW D 040 George F. Easterday DRILLERS SIGNATURE (MUST MATCH SIGNATURE ON APPLICATION) LIC. NO. 1 MW D 386 Wesley K. Blomquist

GRAVEL PACK IF WELL DRILLED WAS FLOWING WELL INSERT F IN BOX 68

MDE USE ONLY (NOT TO BE FILLED IN BY DRILLER) T (E.R.O.S.) W Q

SITE SUPERVISOR (sign. of driller or journeyman responsible for sitework if different from permittee)

TELESCOPE CASING LOG INDICATOR OTHER DATA

B 1 14746

SEQUENCE NO. (MDE USE ONLY)

STATE OF MARYLAND PERMIT TO DRILL WELL please print or type

STATE PERMIT NUMBER

HO-94-2479

Date Received (APA) 08 30 99

OWNER INFORMATION RN 8003

LOCATION OF WELL HOWARD COUNTY

Healey David 1 Reprs Rd Cooksville, Md 21723

SECTION 44 46 LOT 48 50 Cooksville

MILES FROM TOWN 1

DRILLER INFORMATION George F. Easterday M W D 040

Franklin Easterdav, Inc. 9265 Brown Church Rd.. MT. Airv. Md. 21771

DIRECTION OF WELL FROM TOWN (CIRCLE BOX)

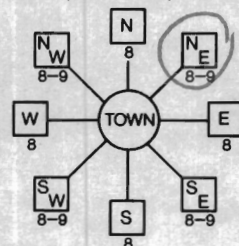

1 Reprs Rd NEAR WHAT ROAD

ON WHICH SIDE OF ROAD (CIRCLE APPROPRIATE BOX) NORTH WEST EAST SOUTH

DISTANCE FROM ROAD 200 FT. TAX MAP: 8 BLK: 18 PARCEL 145

WELL INFORMATION APPROX. PUMPING RATE 5

AVERAGE DAILY QUANTITY NEEDED 500

USE FOR WATER (CIRCLE APPROPRIATE BOX)

- DOMESTIC POTABLE SUPPLY & RESIDENTIAL IRRIGATION
FARMING (LIVESTOCK WATERING & AGRICULTURAL IRRIGATION)
INDUSTRIAL, COMMERCIAL, DEWATERING
PUBLIC WATER SUPPLY WELL
TEST, OBSERVATION, MONITORING
GEO-THERMAL

NOT TO BE FILLED IN BY DRILLER HEALTH DEPARTMENT APPROVAL

Howard W512691 COUNTY NAME COUNTY NO.

STATE SIGNATURE DATE ISSUED 10 26 99 Mark E. Ripkin 10/26/00

APPROXIMATE DEPTH OF WELL 300 FEET

APPROXIMATE DIAMETER OF WELL 6 INCH

METHOD OF DRILLING (circle one)

BORED (or Augered) AIR-ROTary JETTED AIR-PERCussion ROTARY (Hydraulic Rotary) CABLE REVERSE-ROTary DRIVE-POINT

REPLACEMENT OR DEEPEMED WELLS (CIRCLE APPROPRIATE BOX)

- THIS WELL WILL NOT REPLACE AN EXISTING WELL
THIS WELL WILL REPLACE A WELL THAT WILL BE ABANDONED AND SEALED
THIS WELL WILL REPLACE A WELL THAT WILL BE USED AS A STANDBY-CONTACT LOCAL APPROVING AUTHORITY FOR POLICY ON STANDBY WELLS
THIS WELL WILL DEEPEMED AN EXISTING WELL

PERMIT NUMBER OF WELL TO BE REPLACED OR DEEPEMED (IF AVAILABLE)

Not to be filled in by driller (MDE OR COUNTY USE ONLY)

APPROX. PERMIT NUMBER 4090 GAP 6002601 PERMIT No. HO-94-2479

SHOW MAJOR FEATURES OF BOX & LOCATE WELL WITH AN X 12/6/99 Grout 8AM No insp

SOURCES OF DRILLING WATER 1. wells

WRITE THE BOX NUMBER FROM THE MAP HERE E 798 4 N 540 4

DRAW A SKETCH BELOW SHOWING LOCATION OF WELL IN RELATION TO NEARBY TOWNS AND ROADS AND GIVE DISTANCE FROM WELL TO NEAREST ROAD JUNCTION



Location for New Well

Dend - Monette Heapy
1 Repps Road (410) 442-2388
Cooksville Md 21723
Tax Map #9 - Parcel 145

Well Site OK

No Insp
MR 10/26/99

North
↑

New Well - Location marked
with Stake +
Flagging Tape
⊗ - 4' -

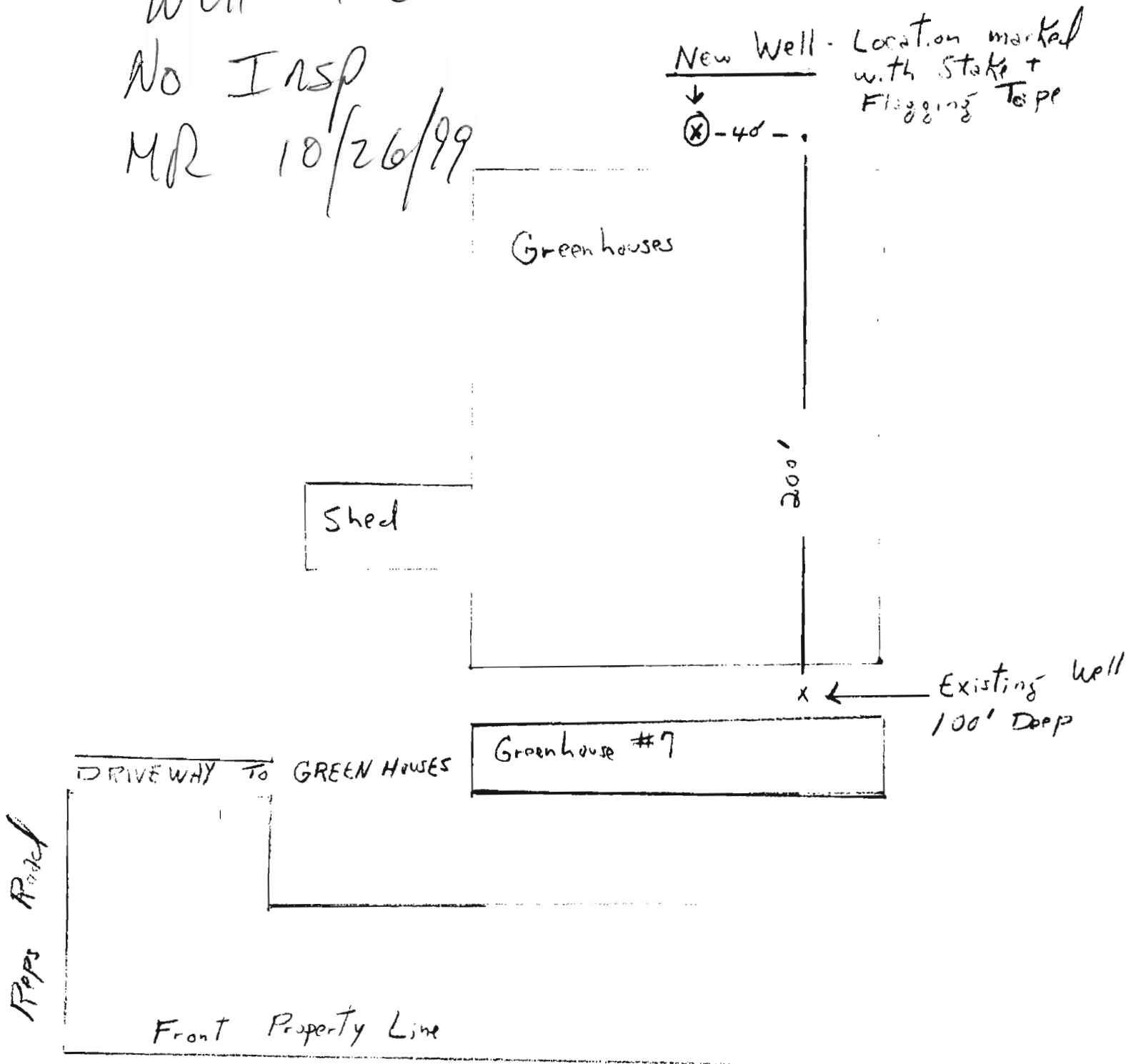

STATE OF MARYLAND
DEPARTMENT OF NATURAL RESOURCES
WATER RESOURCES ADMINISTRATION

WATER APPROPRIATION AND USE PERMIT

PERMIT NUMBER: HO9OG002 (01)

EFFECTIVE DATE: JANUARY 1, 1990

EXPIRATION DATE: JANUARY 1, 2002

FIRST APPROPRIATION: JANUARY 1, 1990



DAVID AND MARIANNE HEALEY

HEREINAFTER REFERRED TO AS THE "PERMITTEE", IS AUTHORIZED BY THE WATER RESOURCES ADMINISTRATION, HEREINAFTER REFERRED TO AS THE "ADMINISTRATION" PURSUANT TO THE PROVISIONS OF TITLE 8 OF THE NATURAL RESOURCES ARTICLE, ANNOTATED CODE OF MARYLAND (1983 REPLACEMENT VOLUME) AS AMENDED, TO APPROPRIATE AND USE WATERS OF THE STATE SUBJECT TO THE FOLLOWING CONDITIONS:

1. ALLOCATION - THE WATER WITHDRAWAL GRANTED BY THIS PERMIT IS LIMITED TO A DAILY AVERAGE OF 3,000 GALLONS ON A YEARLY BASIS AND A DAILY AVERAGE OF 12,000 GALLONS FOR THE MONTH OF MAXIMUM USE.
2. USE - THE WATER IS TO BE USED FOR THE IRRIGATION OF GREENHOUSE AND CONTAINER GROWN NURSERY STOCK.
3. SOURCE - THE WATER SHALL BE TAKEN FROM TWO WELLS IN THE BOULDER GNEISS OF THE WISSAHICKON FORMATION.
4. LOCATION - THE POINT(S) OF WITHDRAWAL SHALL BE LOCATED AT THE NORTH END OF REPS ROAD, 0.2 MILE NORTH OF THE MONTICELLO AVENUE JUNCTION, 1.0 MILE NORTHEAST OF COOKSVILLE, HOWARD COUNTY, MARYLAND.



MARYLAND DEPARTMENT OF THE ENVIRONMENT

2500 Broening Highway • Baltimore, Maryland 21224
(410) 631-3000 • 1-800-633-6101 • <http://www.mde.state.md.us>

Parris N. Glendening
Governor

Jane T. Nishida
Secretary

February 28, 2002

DAVID AND MARIANNE HEALEY
GREENWAY FARMS
1 REPS ROAD
COOKSVILLE, MD 21723

RE: State Water Appropriation
Permit No. HO1990G002(02)
Revision 02

Dear Permittee:

Enclosed is your State Water Appropriation Permit. The permittee is responsible for complying with all permit conditions. Accordingly, you are advised to carefully read the Permit and become thoroughly familiar with its requirements.

If you have any questions, please contact this office at (410) 631-3591.

Sincerely,

MARK T. FILAR
Water Rights Division

cc: HOWARD COUNTY HEALTH DEPARTMENT

STATE OF MARYLAND
DEPARTMENT OF THE ENVIRONMENT
WATER MANAGEMENT ADMINISTRATION

WATER APPROPRIATION AND USE PERMIT

PERMIT NUMBER: HO1990G002(02)

EFFECTIVE DATE: MARCH 1, 2002

EXPIRATION DATE: MARCH 1, 2014

FIRST APPROPRIATION: JANUARY 1, 1990



DAVID AND MARIANNE HEALEY

HEREINAFTER REFERRED TO AS THE "PERMITTEE", IS AUTHORIZED BY THE WATER MANAGEMENT ADMINISTRATION, HEREINAFTER REFERRED TO AS THE "ADMINISTRATION" PURSUANT TO THE PROVISIONS OF TITLE 5 OF THE ENVIRONMENT ARTICLE, ANNOTATED CODE OF MARYLAND (1996 REPLACEMENT VOLUME) AS AMENDED, TO APPROPRIATE AND USE WATERS OF THE STATE SUBJECT TO THE FOLLOWING CONDITIONS:

1. ALLOCATION - THE WATER WITHDRAWAL GRANTED BY THIS PERMIT IS LIMITED TO:
A DAILY AVERAGE OF 3,000 GALLONS ON A YEARLY BASIS AND
A DAILY AVERAGE OF 12,000 GALLONS FOR THE MONTH OF MAXIMUM USE.
2. USE - THE WATER IS TO BE USED FOR THE IRRIGATION OF GREENHOUSE AND CONTAINER GROWN NURSERY STOCK.
3. SOURCE - THE WATER SHALL BE TAKEN FROM TWO WELLS IN THE BOULDER GNEISS OF THE WISSAHICKON FORMATION.
4. LOCATION - THE POINT(S) OF WITHDRAWAL SHALL BE LOCATED AT GREENWAY FARMS, 1 REPS ROAD, COOKSVILLE, HOWARD COUNTY, MARYLAND.

CONTINUED ON PAGE 2.

5. RIGHT OF ENTRY - THE PERMITTEE SHALL ALLOW AUTHORIZED REPRESENTATIVES OF THE ADMINISTRATION ACCESS TO THE PERMITTEE'S FACILITY TO CONDUCT INSPECTIONS AND EVALUATIONS NECESSARY TO ASSURE COMPLIANCE WITH THE CONDITIONS OF THIS PERMIT. THE PERMITTEE SHALL PROVIDE SUCH ASSISTANCE AS MAY BE NECESSARY TO EFFECTIVELY AND SAFELY CONDUCT SUCH INSPECTIONS AND EVALUATIONS.
6. PERMIT RENEWAL - THIS PERMIT WILL EXPIRE ON THE DATE INDICATED ON THE FIRST PAGE OF THIS PERMIT. IN ORDER TO RENEW THE PERMIT THE PERMITTEE SHALL FILE A RENEWAL APPLICATION WITH THE ADMINISTRATION NO LATER THAN 45 DAYS PRIOR TO THE EXPIRATION.
7. PERMIT SUSPENSION OR REVOCATION - THIS PERMIT MAY BE SUSPENDED OR REVOKED BY THE ADMINISTRATION UPON VIOLATION OF THE CONDITIONS OF THIS PERMIT, OR UPON VIOLATION OF ANY REGULATION PROMULGATED PURSUANT TO TITLE 5 OF THE ENVIRONMENT ARTICLE, ANNOTATED CODE OF MARYLAND (1996 REPLACEMENT VOLUME) AS AMENDED.
8. CHANGE OF OPERATIONS - ANY ANTICIPATED CHANGE IN APPROPRIATION WHICH MAY RESULT IN A NEW OR DIFFERENT USE, QUANTITY, SOURCE, OR PLACE OF USE OF WATER SHALL BE REPORTED TO THE ADMINISTRATION BY THE PERMITTEE BY SUBMISSION OF A NEW APPLICATION.
9. ADDITIONAL PERMIT CONDITIONS - THE ADMINISTRATION MAY AT ANYTIME (INCLUDING TRIENNIAL PERMIT REVIEW OR WHEN A CHANGE APPLICATION IS SUBMITTED) REVISE ANY CONDITION OF THIS PERMIT OR ADD ADDITIONAL CONDITIONS CONCERNING THE CHARACTER, AMOUNT, MEANS AND MANNER OF THE APPROPRIATION OR USE, WHICH MAY BE NECESSARY TO PROPERLY PROTECT, CONTROL AND MANAGE THE WATER RESOURCES OF THE STATE. CONDITION REVISIONS AND ADDITIONS WILL BE ACCOMPLISHED BY ISSUANCE OF A REVISED PERMIT.

PERMIT NUMBER: HO1990G002(02)
PAGE NUMBER THREE

10. NON-TRANSFERRABLE - THIS PERMIT IS NON-TRANSFERRABLE. A NEW OWNER MAY ACQUIRE AUTHORIZATION TO CONTINUE THIS APPROPRIATION BY FILING A NEW APPLICATION WITH THE ADMINISTRATION. AUTHORIZATION WILL BE ACCOMPLISHED BY ISSUANCE OF A NEW PERMIT.
11. DROUGHT PERIOD EMERGENCY RESTRICTIONS - IF THE DEPARTMENT DETERMINES THAT A DROUGHT PERIOD OR EMERGENCY EXISTS, THE PERMITTEE MAY BE REQUIRED UNDER THE DEPARTMENT'S DIRECTION TO STOP OR REDUCE WATER USE. ANY CESSATION OR REDUCTION OF WATER USE MUST CONTINUE FOR THE DURATION OF THE DROUGHT PERIOD OR EMERGENCY, OR UNTIL THE DEPARTMENT DIRECTS THE PERMITTEE THAT WATER USE UNDER STANDARD PERMIT CONDITIONS MAY BE RESUMED.
12. PERMIT SUPERSESSION - THIS PERMIT HAS BEEN REVIEWED AND REVISED AND SUPERSEDES THE APPROPRIATION AND USE GRANTED BY THE FOLLOWING PRIOR PERMIT ISSUED TO:
DAVID AND MARIANNE HEALEY ON JANUARY 1, 1990 (HO90G002(01))

BY AUTHORITY OF THE DIRECTOR
WATER MANAGEMENT ADMINISTRATION

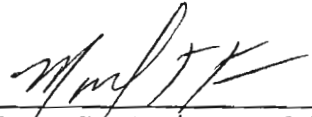
 3/8/02
Matthew G. Pajerowski, Chief
WATER RIGHTS DIVISION

WTS