

APPLICATION

A 16123

SEWAGE DISPOSAL TESTING

P _____

MARYLAND STATE DEPARTMENT OF HEALTH

HOWARD COUNTY

1000 gallon Septic Tank

ELLICOTT CITY

DISTRICT 1

DATE 7/19/71

8/4/71 4:30 Dry Well. 409 sq. ft absorbent side wall area to begin below the first 3 1/2 ft of non absorbent ground. Max depth permitted for Dry Well is 12 ft below orig. grade.

Place Dry Well about 185 ft from front lot line and 160 ft from left side line as seen when facing lot from S.W. Rd.

TO: THE COUNTY HEALTH OFFICER
ELLICOTT CITY, MARYLAND

I, HEREBY, APPLY FOR THE NECESSARY TESTS IN ORDER TO CONSTRUCT (OR RECONSTRUCT) A SEWAGE DISPOSAL SYSTEM.

PROPERTY OWNER Geo. P. Garratt, Jr.

ADDRESS _____ PHONE _____

PROPERTY LOCATION:

SUBDIVISION _____ LOT NO. 1

ROAD AND DESCRIPTION Day Rd. - off Rt. 22 - approx. 1/4 mile in on right

Make sure lot has sign

OCCUPANT _____ PHONE _____

PERSON TO CONSTRUCT SYSTEM _____

ADDRESS _____ PHONE _____

SIZE OF LOT 5.251 acres TYPE BLDG. 1

NUMBER OF BEDROOMS
(Single Family Dwellg.)

IF NOT SINGLE RESIDENCE DESCRIBE _____

SIGNATURE OF APPLICANT Walter H. Huller

APPROVED BY D. Monaghan & B. Streater FOR Dry Well DATE 8-4-71
(KIND OF SYSTEM)

REJECTED BY _____ FOR _____ DATE _____
(KIND OF SYSTEM)

HOLD PENDING FURTHER TESTS _____ DATE _____

REASONS FOR REJECTION OR HOLDING _____

THIS IS NOT A PERMIT

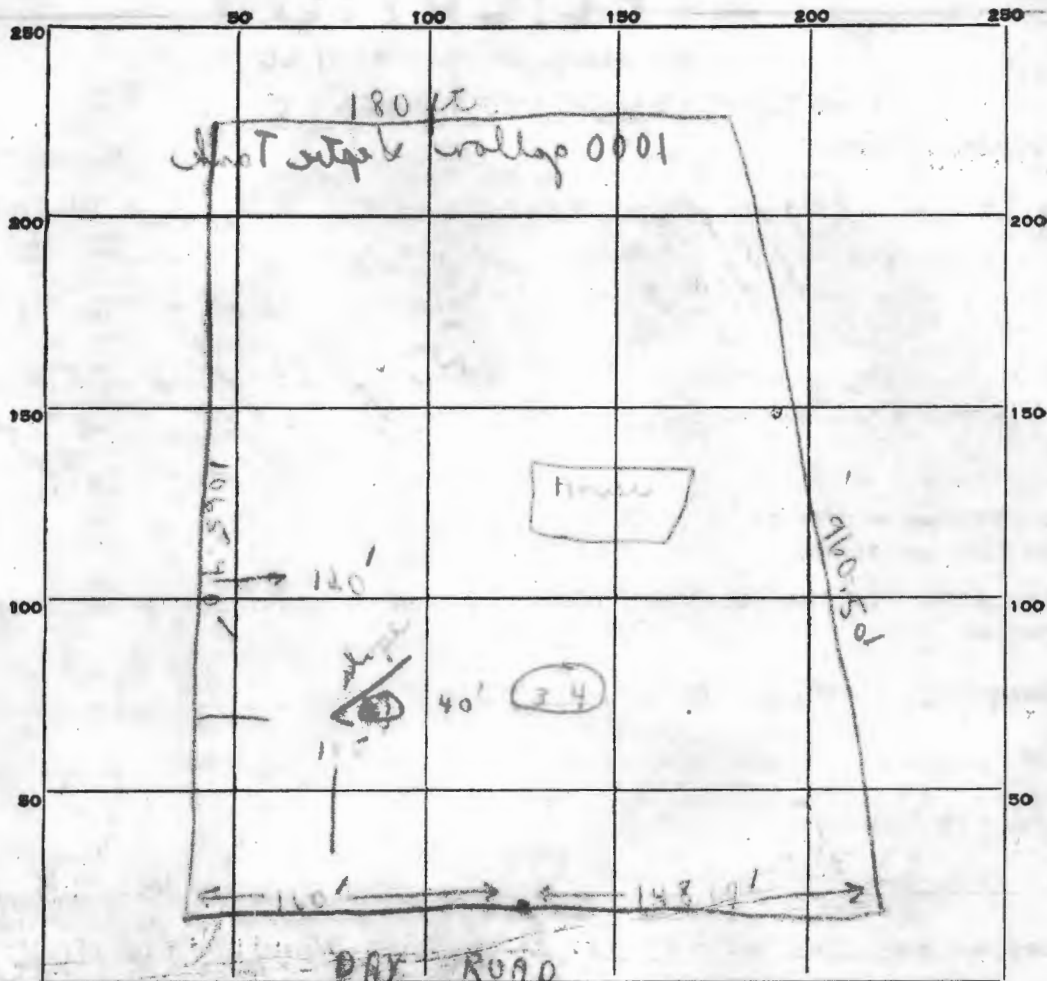

INDICATE NORTH. - NAME ADJOINING ROADWAY AS BASE LINE.

DATE	TEST NO.	DEPTH	PRE-WET		TEST - 1" DROP		TIME
			START	STOP	START	STOP	
8/4/77	1	12'	10 ¹⁶	10 ²¹	10 ²¹	10 ³²	11
8/4/77	2	4'	10 ¹⁷	10 ²¹	10 ²¹	10 ³⁰	9
8/4/77	3	12'	10 ²⁴	10 ³¹	10 ³¹	10 ⁵⁰	19
8/4/77	4	4'	10 ²⁵	10 ³²	10 ³²	10 ⁴²	10

3:15 PM

SOIL AUGER FINDING _____

TESTED BY _____

REMARKS _____

APPLICATION

A 16123

SEWAGE DISPOSAL TESTING

P _____

MARYLAND STATE DEPARTMENT OF HEALTH

HOWARD COUNTY

ELLICOTT CITY

DISTRICT 3

DATE 7/19/71

TO: THE COUNTY HEALTH OFFICER
ELLICOTT CITY, MARYLAND

I, HEREBY, APPLY FOR THE NECESSARY TESTS IN ORDER TO CONSTRUCT (OR RECONSTRUCT) A SEWAGE DISPOSAL SYSTEM.

PROPERTY OWNER Geo. P. Garratt, Jr.

ADDRESS _____ PHONE _____

PROPERTY LOCATION:

SUBDIVISION _____ LOT NO. 2

ROAD AND DESCRIPTION Day Rd. - off Rt. 32 - approx. 3/4 mile in on right

look for KELUSA on sign

OCCUPANT _____ PHONE _____

PERSON TO CONSTRUCT SYSTEM _____

ADDRESS _____ PHONE _____

SIZE OF LOT 5.351 acres TYPE BLDG. 3

NUMBER OF BEDROOMS

(Single Family Dwlg.)

IF NOT SINGLE RESIDENCE DESCRIBE _____

SIGNATURE OF APPLICANT Walter H. Sullivan

APPROVED BY Dec. Monaghan & B. Strecker FOR Dry Well DATE 8-4-71

(KIND OF SYSTEM)

REJECTED BY _____ FOR _____ DATE _____

(KIND OF SYSTEM)

HOLD PENDING FURTHER TESTS _____ DATE _____

REASONS FOR REJECTION OR HOLDING _____

THIS IS NOT A PERMIT

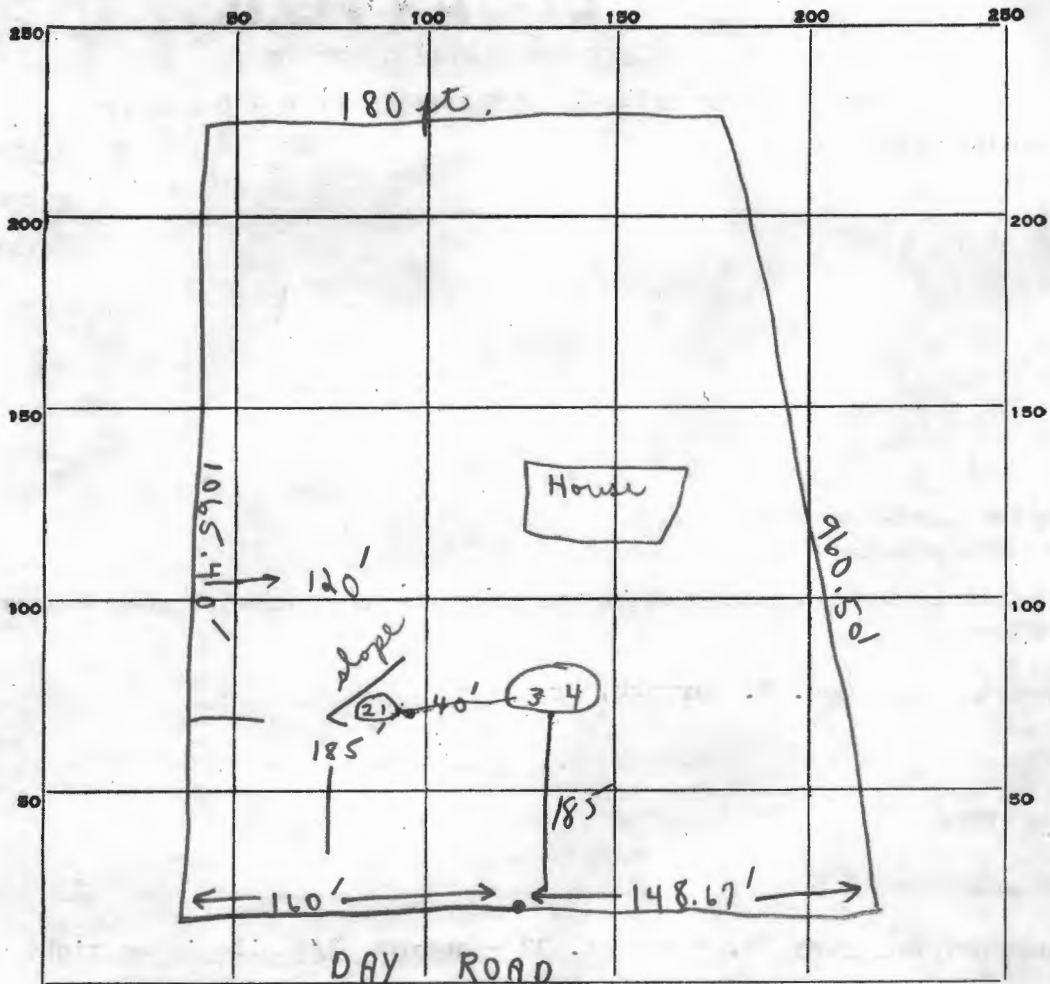

INDICATE NORTH. - NAME ADJOINING ROADWAY AS BASE LINE.

DATE	TEST NO.	DEPTH	PRE-WET		TEST - 1" DROP		TIME
			START	STOP	START	STOP	
8/4/71	1	12'	10 ¹⁶	10 ²¹	10 ²¹	10 ³²	11
8/4/71	2	4'	10 ¹⁷	10 ²¹	10 ²¹	10 ³⁰	9
8/4/71	3	12'	10 ²⁴	10 ³¹	10 ³¹	10 ⁵⁰	19
8/4/71	4	4'	10 ²⁵	10 ³²	10 ³²	10 ⁴²	10

3 15 min

SOIL AUGER FINDING _____

TESTED BY _____

REMARKS _____



PLAT OF SURVEY
 FOR
 GEORGE P. GARRATT JR.
 THIRD ELECTION DISTRICT OF HOWARD COUNTY
 SYKESVILLE, MARYLAND
 SCALE: 1 IN. = 200 FT. JANUARY 25, 1971

Claude M. Skinner Jr.

Claude M. Skinner Jr. Reg. Engineer & Land Surveyor No. 2237



Real Property Data Search (w1)

Search Result for HOWARD COUNTY

View Map		View GroundRent Redemption			View GroundRent Registration				
Tax Exempt:		Special Tax Recapture:							
Exempt Class:		NONE							
Account Identifier:		District - 03 Account Number - 284751							
Owner Information									
Owner Name:		CORBIN MICHAEL R CORBIN CAROL WU T/E			Use:		RESIDENTIAL		
Mailing Address:		990 DAY RD SYKESVILLE MD 21784-5603			Principal Residence:		YES		
					Deed Reference:		/12702/ 00491		
Location & Structure Information									
Premises Address:		990 DAY RD SYKESVILLE 21784-0000			Legal Description:		5.351 A 990 DAY RD SYKESVILLE		
Map:	Grid:	Parcel:	Sub District:	Subdivision:	Section:	Block:	Lot:	Assessment Year:	Plat No:
0009	0003	0168		0001				2019	Plat Ref:
Special Tax Areas:				Town:		NONE			
				Ad Valorem:		100			
				Tax Class:					
Primary Structure Built		Above Grade Living Area		Finished Basement Area		Property Land Area		County Use	
1975		2,352 SF				5.3500 AC			
Stories	Basement	Type	Exterior	Full/Half Bath	Garage	Last Major Renovation			
2	YES	STANDARD UNIT	BRICK	2 full/ 1 half	1Att/1Det				
Value Information									
		Base Value		Value		Phase-in Assessments			
				As of		As of		As of	
				01/01/2019		07/01/2018		07/01/2019	
Land:		216,100		242,600					
Improvements		341,800		291,200					
Total:		557,900		533,800		557,900		533,800	
Preferential Land:		0						0	
Transfer Information									
Seller: STORES THOMAS MALCOM				Date: 09/21/2010		Price: \$510,000			
Type: ARMS LENGTH IMPROVED				Deed1: /12702/ 00491		Deed2:			
Seller: EMMERICH ERNEST C JR., &				Date: 06/14/1982		Price: \$120,000			
Type: ARMS LENGTH IMPROVED				Deed1: /011105/ 00543		Deed2:			
Seller:				Date:		Price:			
Type:				Deed1:		Deed2:			
Exemption Information									
Partial Exempt Assessments:		Class		07/01/2018		07/01/2019			
County:		000		0.00					
State:		000		0.00					
Municipal:		000		0.00 0.00		0.00 0.00			
Tax Exempt:		Special Tax Recapture:							
Exempt Class:		NONE							
Homestead Application Information									

Homestead Application Status: Approved 03/25/2011

Homeowners' Tax Credit Application Information

Homeowners' Tax Credit Application Status: No Application **Date:**

1. This screen allows you to search the Real Property database and display property records.
2. Click **here** for a glossary of terms.
3. Deleted accounts can only be selected by Property Account Identifier.
4. The following pages are for information purpose only. The data is not to be used for legal reports or documents. While we have confidence in the accuracy of these records, the Department makes no warranties, expressed or implied, regarding the information.