



Howard County
Health Department

Bureau of Environmental Health

8930 Stanford Boulevard, Columbia, MD 21045

Main: 410-313-2640 | Fax: 410-313-2648

TDD 410-313-2323 | Toll Free 1-866-313-6300

www.hchealth.org

Facebook: www.facebook.com/hocohealth

Maura J. Rossman, M.D., Health Officer

RECEIPT DATE: 1/8/19 **ONSITE SEWAGE DISPOSAL SYSTEM** P 564714

APPROVAL DATE: 3/6/19 SEC **PERMIT:** **REPAIR** A _____

PROPERTY ADDRESS: 3829 Folly Quarter Road

SUBDIVISION: _____ LOT: _____ TAX ID: 03-280233

CONTRACTOR: Hatfields Equipment EMAIL: ken@hatfieldsequipment.com

CONTRACTOR ADDRESS: P.O. Box 419, Annapolis Junction, MD 21701 PHONE: 301-490-4289

PROPERTY OWNER: Michael Pearson EMAIL: _____

OWNER ADDRESS: 3829 Folly Quarter Road, Ellicott City, MD 21042 PHONE: _____

SEPTIC TANK SIZE (GALLONS): Existing PUMP CHAMBER CAPACITY (GALLONS): 1250 PUMP SIZE: 1/2 HP

NUMBER OF BEDROOMS: 3 HOUSE SQ. FT. — APPLICATION RATE: 0.8

DISTRIBUTION SYSTEM: GRAVITY FED LOW PRESSURE DOSED

TRENCHES:	LINEAR FEET REQUIRED: <u>116</u>	INLET DEPTH: <u>2</u>
	TRENCH WIDTH: <u>3</u>	MAXIMUM BOTTOM DEPTH: <u>5</u>
	MINIMUM SPACE BETWEEN TRENCHES: _____	EFFECTIVE AREA BEGINNING DEPTH: <u>3</u>
LOCATION:	TO BE STAKED BY SANITARIAN DURING PRE-CONSTRUCTION INSPECTION.	
NOTES:	Install 2 x 58' trenches above and below perc test @. must see trench open before covering. Trenches staked in field. Pump tank to be set after S.T. call for inspection.	

ISSUED BY: K. Wolf ISSUE DATE: 1/8/19 EXPIRATION DATE: 1/8/20

- NOTE: CONTRACTOR MUST SCHEDULE A PRE-CONSTRUCTION INSPECTION PRIOR TO BEGINNING ANY INSTALLATION
- NOTE: CONTRACTOR MUST SCHEDULE AN INSPECTION AND GAIN APPROVAL OF ALL COMPONENTS PRIOR TO COVERING
- NOTE: STONE MUST BE APPROVED BY HEALTH DEPARTMENT AND GRAVEL TICKET MUST BE AVAILABLE FOR REVIEW.
- NOTE: WATERTIGHT SEPTIC TANKS REQUIRED
- NOTE: ALL PARTS OF SEPTIC SYSTEM SHALL BE AT LEAST 100 FEET DOWNGRADE FROM ANY WATER WELL
- NOTE: MANHOLE RISERS REQUIRED ON ALL SEPTIC TANKS AND PUMP CHAMBERS
- NOTE: AN ELECTRICAL PERMIT IS REQUIRED FOR INSTALLATION OF ANY ELECTRICAL COMPONENTS OF THE SYSTEM
- ELECTRICAL PERMIT ISSUED E 19000544
- NOTE: THE HCHD DOES NOT WARRANT ANY SYSTEM AND CANNOT GUARANTEE THE PERFORMANCE OF THIS SYSTEM AS DESIGNED. BY ACCEPTING THIS PERMIT, THE OWNER AND/OR APPLICANT ACKNOWLEDGE THAT THE SPECIFICATIONS DETAILED IN THIS DESIGN ARE ONE POSSIBLE OPTION AND THAT THE HCHD WILL REVIEW OTHER PROPOSALS. YOU HAVE THE OPTION TO SEEK THE ADVICE OF A QUALIFIED DESIGN CONSULTANT OR PROFESSIONAL ENGINEER FOR FURTHER GUIDANCE.
- NOTE: MDE RECOMMENDS SEPTIC TANKS, BAT, AND OTHER PRETREATMENT UNITS BE PUMPED AT A FREQUENCY ADEQUATE TO ENSURE THAT SOLIDS ARE NOT DISCHARGED TO THE DISPOSAL AREA

NEITHER THE HOWARD COUNTY COUNCIL NOR THE HEALTH DEPARTMENT IS RESPONSIBLE FOR THE SUCCESSFUL OPERATION OF ANY SYSTEM.
 PERMITTEE RESPONSIBLE FOR OBTAINING FINAL APPROVAL ON THIS PERMIT.
 CALL 410-313-1771 TO SCHEDULE INSPECTIONS.

NOT TO SCALE

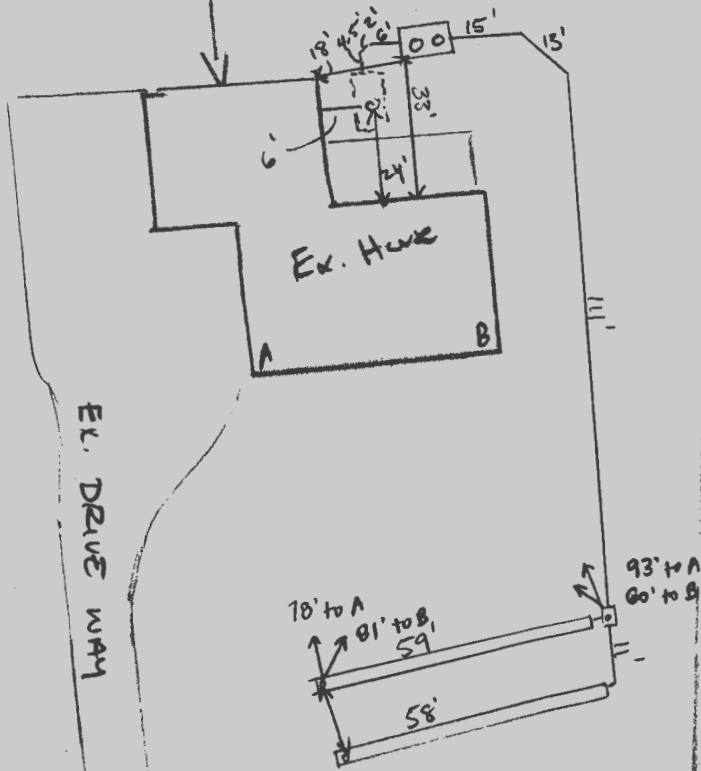

ROAD NAME

— Fully quarter —

TRENCH/DRAINFIELD DATA

WIDTH	INLET	BOTTOM
3'	2'	5'
NUMBER OF TRENCHES		2
TOTAL LENGTH		117'
APPROXIMATION AREA		351' + SIDEWALL
DISTRIBUTION BOX LEVEL		YES
DISTRIBUTION BOX BAFFLE		YES
DISTRIBUTION BOX PORT		YES

Existing SEPTIC TANK DATA

SEPTIC TANK I LEVEL	Yes
MANUFACTURER	—
CAPACITY	1250 GAL
LOC	mid
DEPTH	1.5'
COVER	YES
FILTER	NO
FRONT LOC	FRONT
REAR LOC	NONE
TIGHT TEST	OK
LEAK	NO
CONCRETE LID	N/A
PUMP SEPTIC TANK LEVEL	YES
MANUFACTURER	BABYLON
CAPACITY	1250 GAL
LOC	TOP
DEPTH	2'
COVER	NO
FILTER	NO
FRONT LOC	FRONT
REAR LOC	N/A
TIGHT TEST	N/A
LEAK	N/A
CONCRETE LID	11/5/2018

Pumps: Gould's 1/3 hp

PRE-CONSTRUCTION:

10/18/18 Install 2x58' trenches above and below Parc B. Must see trench dug open before adding stone. System dependent on <50% rd. Set pump tank just after existing septic tank. Trenches staked in field. **(KMO)**

INSTALLATION:

2/1/19 Trenches dug, overall minimal rocks with a couple spots of larger ones. 3' wide 6' bottom. **(SC)** 2/11/2019 (PM) FINAL STONE ARRIVED AND INSTALLED INTO TRENCH. OK TO BACKFILL. **(P)** 2/4/2019 FORCE MAIN AND PUMP TANK INSTALLED AND CONNECTED TO D BOX AND EX. SEPTIC TANK. EX DW. PUMPED, COLLAPSED, AND FILLED. OK TO BACKFILL WORK. REINSR P+A. **(L)** 3/6/19 Met Hatfield's on site for pump + alarm. Alarm sounds, pump pumps effluent to D-box.

FINAL INSPECTOR

Sarah Collins

DATE OF APPROVAL

3/6/19



HOWARD COUNTY HEALTH DEPARTMENT

64714

DATE
11/19

Received From

PHONE #

190-4259

CASH
 CHECK

NO.

4116

FOR

Report of 3829 Tolling
Quilts etc.

One hundred and fifty four

Dollars

\$

105.00

Received By

[Signature]